

This device is not intended for sale in the USA.

Part 15.21 statement

" Change or Modifications that are not expressly approved by the manufacturer could void the user's authority to operate the equipment. "

Part 15.105 statement

This equipment has been tested and found to comply with the limits for a class B digital device, pursuant to Part 15 of the FCC Rules.

These limits are designed to provide reasonable protection against harmful interference in a residential installation. This equipment generates uses and can radiate radio frequency energy and, if not installed and used in accordance with the instructions, may cause harmful interference to radio communications. However, there is no guarantee that interference will not occur in a particular installation. If this equipment does cause harmful interference or television reception, which can be determined by turning the equipment off and on, the user is encouraged to try to correct the interference by one or more of the following measures:

- Reorient or relocate the receiving antenna.
- Increase the separation between the equipment and receiver.
- Connect the equipment into an outlet on a circuit different from that to which the receiver is connected.
- Consult the dealer or an experienced radio/TV technician for help.

FCC Part 15 Class B Compliance

This device and its accessories comply with part 15 of FCC rules and ICES-003 Class B digital apparatus requirements for Industry Canada. Operation is subject to the following two conditions:(1) This device and its accessories may not cause harmful interference, and (2) this device and its accessories must accept any interference received, including interference that may cause undesired operation.

Body-worn Operation

This device was tested for typical body-worn operations with the back of the phone kept 2cm (0.79 inches) between the user's body and the back of the phone. To comply with FCC RF exposure requirements, a minimum separation distance of 2cm (0.79 inches) must be maintained between the user's body and the back of the phone. Third-party belt-clips, holsters, and similar accessories containing metallic components should not be used. Body-worn accessories that cannot maintain 2cm (0.79 inches) separation distance between the user's body and the back of the phone, and have not been tested for typical body-worn operations may not comply with FCC RF exposure limits and should be avoided.

Conformité aux normes FCC Part 15 Class B

Cet appareil et ses accessoires sont conformes aux normes FCC Part 15 Class B de la Federal Communications Commission et aux exigences pour appareils numériques ICES-003 Class B d'Industrie Canada. Son fonctionnement est sujet aux deux conditions suivantes : (1) Cet appareil et ses accessoires ne doivent pas provoquer de brouillage préjudiciable, et (2) cet appareil et ses accessoires doivent accepter toutes les interférences reçues, y compris celles pouvant causer un fonctionnement indésirable.

Utilisation comme appareil portatif

Ce téléphone a été testé en vue d'une utilisation type comme appareil portatif, avec une distance de 2 cm (0,79 pouces) entre l'arrière de l'appareil et le corps de l'utilisateur. Pour satisfaire aux exigences de la FCC en matière d'exposition aux radiofréquences, une distance d'au moins 2 cm (0,79 pouces) doit être maintenue entre le corps de l'utilisateur et l'arrière du téléphone. Les pinces de ceinture, les étuis et autres accessoires semblables d'autres marques et contenant des composants métalliques ne doivent pas être utilisés. Les accessoires portatifs empêchant le maintien d'une distance de 2 cm (0,79 pouces) entre le corps de l'utilisateur et l'arrière du téléphone et qui n'ont pas été testés en vue d'une utilisation type comme accessoires portatifs peuvent ne pas satisfaire aux limites d'exposition aux radiofréquences stipulées par la FCC et, par conséquent, ne doivent pas être utilisés.



CE 0168

LG-A250 USER GUIDE

This manual may differ from the phone depending on the phone software version and service provider used.



Disposal of your old appliance

- When this crossed-out wheeled bin symbol is attached to a product it means the product is covered by the European Directive 2002/96/EC.
- All electrical and electronic products should be disposed of separately from the municipal waste stream via designated collection facilities appointed by the government or the local authorities.
- The correct disposal of your old appliance will help prevent potential negative consequences for the environment and human health.
- For more detailed information about disposal of your old appliance, please contact your city office, waste disposal service or the shop where you purchased the product.

P/N: MMBB000000 (1.0)

Turning Your Phone On and Off

- Press and hold the End key until the power comes on.
- Press and hold the End key until the power goes off.

Making a call

- Enter a phone number including the area code.
- Press the key to call the number.
- To end the call, press the key.

Making an international call

- Press and hold the key for the international prefix. The '+' character automatically selects the international access code.
- Enter the country code, area code, and the phone number.
- Press [Send] key to call the number.

Answering a call

- When you receive a call, the phone rings.
- If the **Press any key** has been set as the **Answer mode** (Settings > Call > Answer mode), any key press will answer a call except for the key.
- To end the call, press the key.

Anti Theft Mobile Tracker (ATMT)

Anti-theft mobile tracker (ATMT) allows you to track your lost phone. When someone uses your phone without your permission, the tracking service will be activated. You are reminded by a text message sent to the default phone number you have set, without the unauthorised user's knowledge. You can always activate the ATMT and configure your personal settings.

To activate Anti-theft mobile tracker

- From the main menu, select **Settings > Security > Anti-theft mobile tracker** and press **Select**.
- Select **Set Anti-theft** and press **Select**.
- Switch **On** or **Off** and press **Select**.
- Input the security code to enable or disable this function.
- Then in the Anti-theft mobile tracker menu, edit and save the name in **Sender name** and numbers in **Sending number list**.

Note

> The default ATMT code is "0000". You have to enter the code before configuring the ATMT settings.

Call log Menu 3

| | |
|----------------------------|---|
| Call log | You can view all lists of outgoing or incoming calls. |
| Missed calls | You can view the unanswered calls. |
| Received calls | You can view the Received calls. |
| Dialled numbers | You can view the outgoing call numbers. |
| Call duration | Allows you to view the duration of your incoming and outgoing calls. You can also reset the call timers. |
| Packet Data counter | You can check the amount of data transferred over the network. |
| Call costs | View the charges applied to your dialled numbers and the call duration of all your received and dialled calls. Also you can do Cost Settings. |

Installing the SIM card and the handset battery

Installing the SIM Card

When you subscribe to a cellular network, you are provided with a plug-in SIM card loaded with your subscription details, such as your PIN, any optional services available and many others.

Important! > The plug-in SIM card and its contacts can be easily damaged by scratches or bending, so be careful when handling, inserting or removing the card. Keep all SIM cards out of the reach of small children.

Illustrations

Always switch the device off and disconnect the charger before removing the battery.

- Remove the back cover.
- Lift battery away.
- Insert the SIM card.
- Insert the battery pack.
- Attach the back cover.
- Charge the battery.

Note: Fully charge the battery before using it for the first time.

Selecting functions and options

Your phone offers a set of functions that allow you to customize the phone. These functions are arranged in menus and sub-menus, accessed via the two soft keys marked and . Each menu and sub-menu lets you view and alter the settings of a particular function.

The roles of the soft keys vary according to the current context; the label on the bottom line of the screen just above each key indicates its current role.

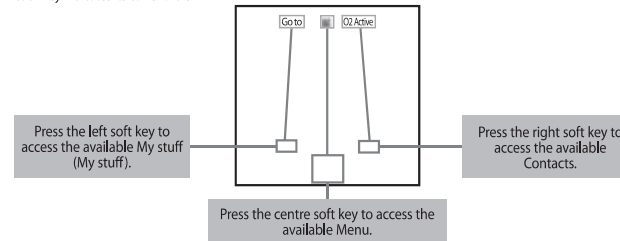

Quick feature reference

This section provides brief explanations of features on your phone.

Messaging Menu 1

| | |
|-------------------------|--|
| Create message | This menu includes functions related to SMS (Short Message Service) and MMS (Multimedia Message Service). |
| Inbox | You will be alerted when you have received messages. They will be stored in Inbox. |
| My mailbox | My Email lets you get your favourite emails on your mobile for a fixed price each month. |
| Drafts | You can save the message temporarily in Drafts. |
| Outbox | This is a temporary storage folder for the unsent messages or messages that you have sent but fail to deliver. |
| Sent items | After sending out the message, the text message or multimedia message is saved in the Sent folder. |
| Saved items | You can access your saved messages, text templates and multimedia templates. |
| Emoticons | A list of useful Emoticons, already written for a quick reply. |
| Message settings | This menu allows you to set features of your network service provider. |

Settings Menu 4

| | |
|----------------------|---|
| Profiles | You can adjust and customize the phone tones for different events, or environments. |
| Display | You can change settings for the phone display. |
| Data and time | You can set functions relating to the date and time. |
| Connectivity | You can set up the condition or data for the phone to connect with other device or network. |
| Call | You can set the menu relevant to a call. |
| Phone | Allows you to set the phone <ul style="list-style-type: none"> > My Navi Key: Allows you to change the preferences on the Hotkeys that are currently assigned for your navigation keys (when in standby mode). > Language: You can change the Language for the display texts in your phone. This change will also affect the Language Input mode. > Power save: Choose among the followings, Off/Night only/Always On, to change the factory set power saving settings. > Handset information: Shows your phone number, model number and S/W version. |
| Network | You can set select network and network mode settings using this menu. Also you can add a preferable network to be connected to Preferred lists. |

Phone Components

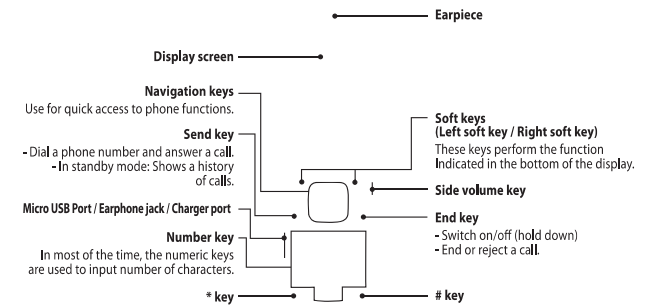

Entering Text

You can enter alphanumeric characters by using the phone's keypad.

T9 Mode

The T9 predictive text input mode lets you enter words easily with a minimum number of key presses. As you press each key, the phone begins to display the characters that it thinks you are typing based on the built-in dictionary.

123 Mode (Numbers Mode)

Type numbers using pressing and holding the button keys.

Symbol Mode

The symbol mode enables you to enter various symbols or special characters. To enter a symbol, select **Options** → **Insert Symbol**. Use the navigation keys to select the desired symbol and press the OK key.

Installing a Memory Card

Lift the memory card cover and insert a microSD card with the gold contact area facing downward. Close the memory card cover so that it clicks shut.

To remove the memory card, gently push it as shown in the diagram.

Note: A memory card is an optional accessory.

-
-
-
-

Contacts Menu 2

| | |
|-----------------------------|---|
| Names | Select Names and enter the name that you want to search from the contact list. You can register a new contact address. You can enter the name, different phone numbers, email addresses, groups and image of a new contact. |
| Settings | You can set the contact display option. |
| Groups | You can list up to the members per each group. |
| Speed dials | You can assign any of the keys from 2 to 8 with a name list entry. You can call directly by pressing this key when you are in idle screen. |
| Service dial numbers | Use this function to access a particular list of services provided by your network operator (if supported by the SIM card). |
| Own number | You can save and check your own number in SIM card. |
| My business card | This option allows you to create your own business card featuring name and any numbers. |

Settings Menu 4 (Continued)

| | |
|--------------------------|--|
| Internet profiles | This menu shows the Internet profiles. You can create new profiles, delete or edit them using the options menu. However, you cannot delete or edit default configurations. |
| Access points | This menu shows the access points list. You can create new profiles, delete or edit them by using the options menu. However, you cannot delete or edit default configurations. |
| Packet data conn. | If you select the 'When available' option, your phone is automatically registered to a GPRS network when you switch the phone on. If you select 'When needed', the GPRS connection is established for the duration of a WAP or application connection. |
| Security | This menu allows you to set the phone's safety. <ul style="list-style-type: none"> > PIN code request: You can set the phone to ask for the PIN code of your SIM card when the phone is switched on. > Handset lock: You can use a security code to avoid unauthorised use of the phone. > Lock if SIM in changed: Set the lock function if SIM changed. > Anti-theft mobile tracker: The ATMT feature of this phone provides you with the ability to have a tracking system in place for your mobile in case you lose or misplace it. > Change codes: PIN is an abbreviation of Personal Identification Number to prevent use by unauthorised persons. You can change the access codes: Security code, PIN code, PIN2 code, ATMT code. |

Settings Menu 4 (Continued)

| | |
|---------------------------------|---|
| Memory info. | You can check free space and memory usage of phone, SIM card and external memory (if inserted). |
| Restore factory settings | You can initialize all factory defaults. You need Security code to activate this function. |

Gallery Menu 5

| | |
|----------------------------|--|
| My memory card | If your phone has a memory card in the card slot, you can save images, sounds, and videos onto it. |
| My images | Shows the list of image files. |
| My sounds | Saved audio files are displayed in the list. |
| My videos | Displays the list of video files. |
| My games & apps | You can access a great selection of games and applications on your phone. |
| Others | When you receive files of an undefined format via email, the files are saved in this folder. |

Organiser Menu 7 (Continued)

| | |
|-------------------|---|
| World time | The World time function provides time information on major cities worldwide. |
| Go to | It helps you to go to the menu you search for. You can set the item as Go to. |

Applications Menu 8

Your LG-A250 comes with preloaded games to keep you amused when you have time to spare. If you choose to download any additional games or applications they will be saved into this folder. Press **Menu** and select **Games & Apps**. Choose **My games & apps**.

Note: An additional cost is incurred when connecting to this service. Check your data charges with your network provider.

Media Menu 6

| | |
|-----------------------|---|
| Camera | You can take photos with the built in camera and adjust its settings to suit your needs. |
| Video | You can record a video clip through the built-in camera. |
| Music | Using the songs in your phone, you can easily enjoy various music. |
| FM radio | You can receive FM radio with your external earphone. You can listen to your favourite radio station anytime. Note: You have to insert Ear-mic into Handsfree connector in order to listen to the Radio and keep the good radio reception. |
| Voice recorder | You can record voice memo. |

Web Menu 9

| | |
|-------------------------|--|
| Home | Connects to a homepage. The homepage will be the site which is defined in the activated profile. |
| Google Search | You can access Google web page directly from here. |
| Bookmarks | This menu allows you to store the URL of favorite web pages for easy access at a later time. |
| Last web address | This menu shows the history of recently browsed pages. |
| Settings | You can set the profile, cache and security related to internet service. |
| Go to address | You can connect directly to the site you want. After entering a specific URL, press OK key to make the connection done to connect to the site. |
| Saved pages | Allows you to view your saved web pages. |

Organiser Menu 7

| | |
|-----------------------|---|
| Alarm clock | You can set the alarm clock to go on at a specified time. |
| Calendar | You can see the calendar and add the events here in selected date. |
| To-do list | You can view, edit and add tasks to do. |
| Notes | You can add new memo, view and manage saved memos. |
| Secret notes | You can write the private memo to protect your privacy. You enter the security code to use this menu. |
| Cash Book | Cash book is a simple accounting book that is used to record basic information about cash receipts and payments. |
| BMI calculator | BMI(Body Mass Index) is a measure of body fat based on height and weight. |
| Calculator | The calculator provides the basic arithmetic functions: addition, subtraction, multiplication and division. |
| Stopwatch | This option allows you to use the function of a stopwatch. |
| Date finder | You can count the target date by adding(After) or subtracting(Before) days. |
| Converter | This converts any measurement into a unit you want. There are many types that can be converted into units: Currency, Area, Length, Weight, Temperature, Volume, Velocity. |