

This device is not intended for sale in the USA.

Part 15.21 statement

" Change or Modifications that are not expressly approved by the manufacturer could void the user's authority to operate the equipment. "

Part 15.105 statement

This equipment has been tested and found to comply with the limits for a class B digital device, pursuant to Part 15 of the FCC Rules.

These limits are designed to provide reasonable protection against harmful interference in a residential installation. This equipment generates uses and can radiate radio frequency energy and, if not installed and used in accordance with the instructions, may cause harmful interference to radio communications. However, there is no guarantee that interference will not occur in a particular installation. If this equipment does cause harmful interference or television reception, which can be determined by turning the equipment off and on, the user is encouraged to try to correct the interference by one or more of the following measures:

- Reorient or relocate the receiving antenna.
- Increase the separation between the equipment and receiver.
- Connect the equipment into an outlet on a circuit different from that to which the receiver is connected.
- Consult the dealer or an experienced radio/TV technician for help.

FCC Part 15 Class B Compliance

This device and its accessories comply with part 15 of FCC rules and ICES-003 Class B digital apparatus requirements for Industry Canada. Operation is subject to the following two conditions:(1) This device and its accessories may not cause harmful interference, and (2) this device and its accessories must accept any interference received, including interference that may cause undesired operation.

Body-worn Operation

This device was tested for typical body-worn operations with the back of the phone kept 2cm (0.79 inches) between the user's body and the back of the phone. To comply with FCC RF exposure requirements, a minimum separation distance of 2cm (0.79 inches) must be maintained between the user's body and the back of the phone. Third-party belt-clips, holsters, and similar accessories containing metallic components should not be used. Body-worn accessories that cannot maintain 2cm (0.79 inches) separation distance between the user's body and the back of the phone, and have not been tested for typical body-worn operations may not comply with FCC RF exposure limits and should be avoided.

Conformité aux normes FCC Part 15 Class B

Cet appareil et ses accessoires sont conformes aux normes FCC Part 15 Class B de la Federal Communications Commission et aux exigences pour appareils numériques ICES-003 Class B d'Industrie Canada. Son fonctionnement est sujet aux deux conditions suivantes : (1) Cet appareil et ses accessoires ne doivent pas provoquer de brouillage préjudiciable, et (2) cet appareil et ses accessoires doivent accepter toutes les interférences reçues, y compris celles pouvant causer un fonctionnement indésirable.

Utilisation comme appareil portatif

Ce téléphone a été testé en vue d'une utilisation type comme appareil portatif, avec une distance de 2 cm (0,79 pouces) entre l'arrière de l'appareil et le corps de l'utilisateur. Pour satisfaire aux exigences de la FCC en matière d'exposition aux radiofréquences, une distance d'au moins 2 cm (0,79 pouces) doit être maintenue entre le corps de l'utilisateur et l'arrière du téléphone. Les pinces de ceinture, les étuis et autres accessoires semblables d'autres marques et contenant des composants métalliques ne doivent pas être utilisés. Les accessoires portatifs empêchant le maintien d'une distance de 2 cm (0,79 pouces) entre le corps de l'utilisateur et l'arrière du téléphone et qui n'ont pas été testés en vue d'une utilisation type comme accessoires portatifs peuvent ne pas satisfaire aux limites d'exposition aux radiofréquences stipulées par la FCC et, par conséquent, ne doivent pas être utilisés.



LG-E300 User Guide - English

Some of the contents in this manual may differ from your phone depending on the software of the phone or your service provider.



Disposal of your old appliance

- 1 When this crossed-out wheeled bin symbol is attached to a product it means the product is covered by the European Directive 2002/96/EC.
- 2 All electrical and electronic products should be disposed of separately from the municipal waste stream via designated collection facilities appointed by the government or the local authorities.
- 3 The correct disposal of your old appliance will help prevent potential negative consequences for the environment and human health.
- 4 For more detailed information about disposal of your old appliance, please contact your city office, waste disposal service or the shop where you purchased the product.

P/N: MMBB0000000 (1.0)



CE0168

Bluetooth OD ID B000000

Using your touch screen

Touch screen tips

- To select an item, touch the centre of the icon.
- Do not press too hard. The touchscreen is sensitive enough to pick up a light, firm touch.
- Use the tip of your finger to touch the option you require. Be careful not to touch any other keys.
- Whenever your LG-E300 is not in use, it will return to the lock screen.

Control the touch screen

The controls on the LG-E300 touch screen change dynamically depending on the task you are carrying out.

Messaging

Your LG-E300 combines SMS and MMS into one intuitive and easy-to-use menu.

Sending a message

- 1 Touch **Messages** in menu and touch **Write message** to begin composing a new message.
- 2 Touch **Insert** to add an image, video, sound, template and so on.
- 3 Touch **To** at the top of the screen to enter the recipients. Then enter the number or touch **+** to select a contact. You can even add multiple contacts.
- 4 Touch **Send** when ready.

WARNING: If an image, video or sound is added to an SMS it will be automatically converted to an MMS and you will be charged accordingly.

TIP: To switch to the camera mode or video mode, slide up/down the camera or video icon on the centre-right of the viewfinder.

After taking a photo

Your captured photo will appear on the screen. The following options are available.

Touch **[]**.

Send - Touch to send the photo as a **Message, Email** or via **Bluetooth**.

Set as - Touch to set as **Homescreen wallpaper, Lockscreen wallpaper, Contacts image, Incoming call image, Outgoing call image, Startup image** and **Shut down image**.

Rename - Touch to rename the photo.

Edit - Touch to edit the photo.

[] Touch to delete the image.

[] Touch to take another photo immediately.

[] Touch to view a gallery of your saved photos.

Using the advanced settings

From the viewfinder, touch **[]** to open all advanced settings options.

After selecting the option, touch the **OK** button.

Size - Change the size of the photo to save memory

White balance - Choose between **Auto, Incandescent, Sunny, Fluorescent, and Cloudy**.

Colour effect - Choose a colour tone for your new photo.

Continuous shot - Position the subject in the viewfinder, then press the capture button as if taking a normal photo. The camera will take shots in quick succession.

Self-timer - The self-timer allows you to set a delay after the shutter is pressed. Select **Off, 3 seconds, 5 seconds, or 10 seconds**. This is ideal if you want to be included in a photo.

Night mode - Useful to user in dark places.

Installing the SIM card and the handset battery

Installing the SIM Card

When you subscribe to a cellular network, you are provided with a plug-in SIM card loaded with your subscription details, such as your PIN, any optional services available and many others.

Important!

The plug-in SIM card and its contacts can be easily damaged by scratches or bending, so be careful when handling, inserting or removing the card. Keep all SIM cards out of the reach of small children.

Illustrations

Always switch the device off and disconnect the charger before removing the battery.

- 1 Remove the back cover.
- 2 Lift battery away.
- 3 Insert the SIM card.
- 4 Insert the battery pack.
- 5 Attach the back cover.
- 6 Charge the battery.

- 3 From the filtered list, touch the **Call** icon next to the contact you want to call. The call will use the default number if there is more than one for that contact.
- 4 Or, you can touch the contact name and select the number to use if there is more than one for that contact to use. You can also touch **[]** to initiate the call to the default number.

Answering and rejecting a call

When your phone rings, press **[]** key to answer the call.

To mute the ringing, touch on **Silent** tab in alerting screen. This is useful if you forgot to change your profile to **Silent** for a meeting. Touch on **Reject** tab to reject an incoming call in alerting screen.

Changing the common call setting

- 1 Touch **Call settings** in the **Settings** menu.
- 2 Scroll and touch **Common settings**.

Changing your text message settings

Touch **Messages** and touch **Settings**. Select **Text message**.

Text message centre - Enter the details of your message centre.

Delivery report - Slide the switch left to receive confirmation that your messages have been delivered.

Validity period - Choose how long your messages are stored at the message centre.

Message types - Convert your text into **Text, Voice, Fax, X.400 or E-mail**.

Character encoding - Choose how your characters are encoded. This impacts the size of your messages and therefore data charges.

Send long text as - Choose to send long messages as **Multiple SMS** or as an **MMS**.

Image quality - Choose between **Super fine, Fine, and Normal**. The finer the quality, the sharper the photo. However, the file size will increase as a result, which means you'll be able to store fewer photos in the memory.

Select storage - Choose whether to save your photos to the Handset memory or to the External memory.

Hide icons - Choose the camera setting icons to hide manually or automatically.

Show captured image - Choose On to check the picture you took right away.

Shutter sound - Select one of the three shutter sounds.

Grid screen - Choose between **Off, Simple cross, or Trisection**.

Reset settings - Restore all camera default settings.

- **Call reject** - Slide the switch left for ON. You can touch the **Reject** list to choose **All calls, Contacts, Groups, All unknown callers** and **All unknown numbers**.
- **Send my number** - Choose whether to display your number on an outgoing call.
- **Auto-redial** - Slide the switch left for ON or right for OFF.
- **Answer mode**
Press send key: Allows you to only answer an incoming call by pressing the **[]** key.
Press any key: Allows you to answer an incoming call by pressing any key, except the **[]** key.
- **Minute minder** - Slide the switch left to ON to hear a tone every minute during a call.
- **BT answer mode** - Select **Handsfree** to be able to answer a call using a Bluetooth headset, or select **Handset** to press a handset key to answer a call.
- **Save new number** - Select ON or OFF to save a new number.

Changing your multimedia message settings

Touch **Messages** and, touch **Settings** and **Multimedia message**.

Retrieval mode - Choose between **Home network** or **Roaming network**. If you then choose **Manual** you will receive only notifications of MMS and you can then decide whether to download them in full.

Delivery report - Choose to request and/or allow a delivery report.

Read receipt - Choose to request and/or allow a reply.

Priority - Choose the priority level of your MMS.

Validity period - Choose how long your message is stored at the message centre.

Slide duration - Choose how long your slides appear on the screen.

Video camera

Making a quick video

To switch to the camera mode or video mode, slide up/down the camera or video icon on the right centre of the viewfinder.

1 Holding the phone horizontally, point the lens towards the subject of the video.

2 Press the red dot **[]**.

3 **[]** **Rec** will appear at the bottom of the viewfinder with a timer at the bottom showing the length of the video.

4 To pause the video, touch **[]** and resume by selecting **[]**.

5 Touch **[]** on screen to stop video recording.

Phone Components

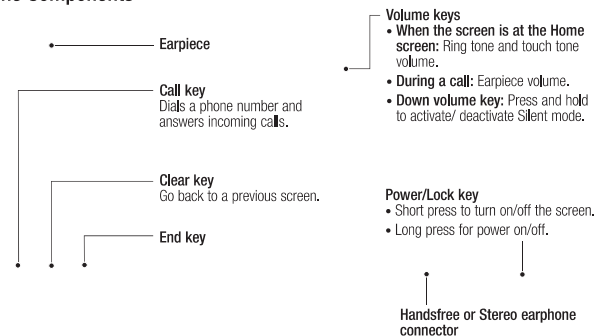

Contacts

Searching for a contact

- 1 Touch **Contacts**.
- 2 You see a list of contacts. Typing in the first letter of a contact's name in the Name field will jump the menu to that alphabetical area of the list.

Adding a new contact

- 1 Touch **Contacts** and touch **Add**.
- 2 Choose whether to save the contact to your **Internal memory** or **SIM**.
- 3 Enter your first and last name.
- 4 You can enter up to five different numbers per contact.
- 5 Add an email addresses. You can enter up to two different email addresses per contact.
- 6 Assign the contact to one or more groups.
- 7 Touch **Save** to save the contact.

Unsupported attachment - Choose whether the unsupported attachment is restricted or not.

Delivery time - Choose how long to wait before a message is delivered.

MMS centre - Choose one from the list or add a new message centre.

Social network services (SNS)

Your LG-E300 has SNS that lets you enjoy and manage your social network.

NOTE: SNS feature is a data intensive application. An additional costs may be incurred when connecting and using online services. Check your data charges with your network provider.

Changing your contact settings

You can adapt your contact settings so that your **Contacts** suits your own preferences.

- Touch **Options key []** and touch **Settings**.
- **Display name** - Choose whether to display the first last name of a contact first.
- **Copy** - Copy your contacts from your SIM to Internal memory, or vice versa.
- **Move** - This works in the same way as Copy, but the contact is stored at the new location only. Therefore, once a contact is moved from the SIM to the Internal memory it will be deleted from the SIM memory.
- **Send all contacts via Bluetooth** - Sends all contacts to other handset via Bluetooth.
- **Back up contacts/ Restore contacts** - Save or restore the contacts data to the other storage.
- **Delete all contacts** - Delete all your contacts. Touch Yes if you are sure you want to delete all your contacts.

Facebook (Continued SNS)

Home: Log in and you will see your friend's updated status. Input your comment about new status or check others.

Profile: You can select the **Wall > Status updates** and write the current status. See your info detail and upload the photo by touching **Album > Upload Photo**.

Friends: Search your friends in facebook by selecting Search tap.

Message: You can see the Inbox/Sent folder, and write a SN message.

Camera

Taking a quick photo

- 1 Touch **Camera** menu.
- 2 When the camera has focused on your subject, touch the **[]** on the right-center of the screen to take a photo.

Using the advanced settings

From the viewfinder, touch **[]** to open all advanced settings options. You can change the video camera setting after selecting the option, touch the **OK** button.

Colour Effect - Choose a colour tone to use for your new view.

White balance - The white balance ensures any the white areas in your video are realistic. To enable your camera to adjust the white balance correctly, you may need to determine the light conditions. Choose between **Auto, Incandescent, Sunny, Fluorescent, and Cloudy**.

Quality - Choose between **Super fine, Fine and Normal**. The finer the quality, the sharper a video will be, but the file size will increase. As a result, you will be able to store fewer videos in the phone's memory.

Duration - Set a duration limit for your video. Choose between **Normal** and **MMS** to limit the maximum size to send as an MMS message.

Select storage - Choose whether to save your videos to the Handset memory or to the External memory.

Audio recording - Choose Mute to record a video without sound.

Hide icons - Select whether to hide the icons in the camera menu automatically or manually.

Reset settings - Reset all the video camera settings.

Music

To access the music player, touch **Music**. From here, you can access a number of folders:

Recently played - Plays the songs you have played recently.

All tracks - Contains the songs you have on your phone except the pre-loaded default music.

Artists - Browse through your music collection by artist.

Albums - Browse through your music collection by album.

Genres - Browse through your music collection by genre.

Playlists - Contains all the playlists you have created.
Shuffle tracks - Play your tracks in a random order.

Transferring music onto your phone

The easiest way to transfer music onto your phone is via Bluetooth or the data cable.

To transfer music using Bluetooth:

1 Make sure both devices have Bluetooth switched on and are connected to each other.

2 Select the music file on the other device and select send via Bluetooth.

3 When the file is sent, you will have to accept it on your phone by touching **Yes**.

4 The file should appear in **Music > All tracks**.

To receive a file:

1 To receive files, your Bluetooth must be both **ON** and **Visible**. See **Changing your Bluetooth settings** below for more information.

2 A message will prompt you to accept the file from the sender. Touch Yes to receive the file.

3 You will see where the file has been saved. For image files, you can choose to **View** the file. Files will usually be saved to the appropriate folder in **My stuff**.

Changing your Bluetooth settings:

Touch **Bluetooth** then select **Options**  and choose **Settings**.

Managing files

You can store multimedia files in your phone's memory so you have easy access to all your pictures, sounds, videos and games. You can also save your files to a memory card. Using a memory card allows you to free up space in your phone's memory.

By touching **My stuff**, you can open a list of the folders that store all your multimedia files.

Games and Applications

You can download new games and applications to your phone to keep you enjoy.

Application

Adding an event to your calendar

1 Touch **Calendar**.

2 Select the date you would like to add an event to.

3 Touch **Add**.

Pairing with another Bluetooth device

By pairing your LG-E300 and another device, you can set up a passcode protected connection.

1 Check that your Bluetooth is **ON** and **Visible**. You can change your visibility in the **Settings** menu.

2 Touch **Search**.

3 Your LG-E300 will search for devices. When the search is completed, **Refresh** will appear on screen.

4 Choose the device you want to pair with and enter the passcode, then touch **OK**.

5 Your phone will then connect to the other device, on which you will need to enter the same passcode.

6 Your passcode protected Bluetooth connection is now ready.

Setting your alarm

1 Touch **Alarms**.

2 Touch **Add**, then you can set and save your alarm in this menu.

Voice recorder

Use your voice recorder to record voice memos or other audio files.

Using your calculator

1 Touch **Calculator**.

2 Touch the number keys to enter numbers.

Converting a unit

1 Touch **Unit converter**.

2 Choose whether you want to convert Currency, Area, Length, Weight, Temperature, Volume or Velocity.

3 Then select the unit and enter the value you would like to convert from.

The web

Tesco Mobile gives you a fast, full-colour world of games, music, news, sport, entertainment and loads more, straight to your mobile phone. Wherever you are and whatever you're into.

Accessing the web

1 Touch the **Tesco Mobile**.

2 To go straight to the Tesco Mobile home page, select **Home**. Alternately, select **Enter address** and type in the URL, followed by **Connect**.

NOTE: You will incur extra cost by connecting to these services and downloading content. Check data charges with your network provider.

Access to Google Service

Access to Google Service Touch **Google** Search to launch google earch application.

Settings

Personalising your profiles

You can personalise each profile setting using the settings menu.

1 Touch **Profiles**.

2 Choose the profile you want to edit.

3 You can then change all the sounds and alert options available in the list, including your Ringtone and Volume, Message tone settings and more.

Changing your phone settings

Use the freedom of adapting the LG-E300 to your own preferences.

From the home screen, select  and touch **Settings** then scroll to **Device settings**.