



English

LG Electronics BLUETOOTH® Mono Headset HBM-235 User manual



All rights reserved.
LG Electronics Inc., 2010

Note : For the best performance and to prevent any damage to, or misuse of the HBM-235, please read all of the information carefully prior to using the HBM-235.

Any modifications or changes to this manual due to typographical errors or inaccuracies of stated information shall only be made by LG Electronics Inc.

Description of parts

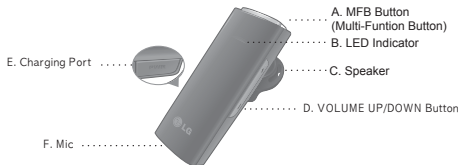

Accessory



G. Ear loop



H. Charger

Ear Loop Attachment

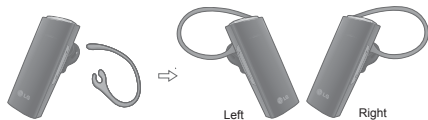

I. * Note: The ear loop can be attached to the headset, as an option, if necessary. Not every user will need to attach the ear loop.

Charging Your Headset

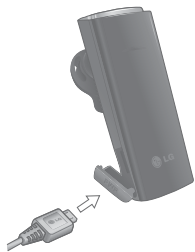

Pairing Your Headset

SETTINGS	DEVICES FOUND	LG HBM-235	HANDSFREE
Sounds Settings	LG HBM-235		LG HBM-235 added.
BLUETOOTH TURN ON		Passkey: 0000	The handsfree is now ready for use
Display Settings			
Phone Settings			
Call Setting			
SELECT	SELECT	OK	SELECT

Specification

ITEM	Description
Bluetooth® specification	V2.1 (Headset / HFP)
Battery	Battery 3.7V / 110mAh Li-Polymer
Standby time / Talk time	Up to 300Hrs / Up to 8Hrs
Charging time	< 2Hrs
Operation temperature	-10°C ~ 50°C
Dimension / Weight	18.2mm(W) X 48mm(L) X 10mm(H) / 9.8g

Description of parts

- A. MFB Button (Multi-Funtion Button)
- B. LED Indicator
- C. Speaker
- D. VOLUME UP/DOWN Button
- E. Charging Port
- F. Mic
- G. Ear loop
- H. Charger
- I. Ear loop Attachment

* Note : The ear loop can be attached to the headset, as an option, if necessary.
Not every user will need to attach the ear loop.

Contents

Specification	3
How to use	4
LED indication	7
Troubleshooting	7

Pairing

- Before using the headset for the first time, you must pair it with a Bluetooth-enabled handset.
- To pair your headset with an additional handset, the headset must be placed in Pairing Mode.
- There are 3 Pairing Mode Methods with the HBM-235.

Easy Pairing (First Time Pairing)

1. Press and hold the MFB Button for 3 seconds, to turn on the HBM-235. When the headset enters Pairing Mode, the LED indicator will show a solid white light.
2. Using your handset, find the Bluetooth Menu and "search for" or "add" new devices.
 - Select "LG HBM-235" from the list of devices and pair it with your handset.
3. If asked for the Pass/PIN code please enter "0000" (4 Zeros).*
 - * Note : If your handset supports Secure Simple Pairing (SSP), you will not need to enter Pass/PIN code.
 - Once pairing has completed successfully, you will hear a beep.
4. Some handsets might ask for permission to access the phone's contact list. If you receive a message from your handset, please select "OK" or "Allow access"
 - The HBM-235 will automatically turn off if not paired within 3 minutes.

Manual Pairing (Pairing with another phone or re-pairing)

- With the Power off, press and hold the MFB Button for 6 seconds.
- When the headset enters Pairing Mode, the LED indicator will show a solid white light. After the procedure repeat Easy Pairing steps 2 through 4.

Proximate pairing (Headset Initiated Pairing)

- When entering pairing mode, HBM-235 automatically searches and tries to connect the handset in close proximity and discoverable mode.

Multipoint

- The LG HBM-235 is capable of having two handsets connected to the headset.
- To use this feature, you must enable Multipoint set up. (see "Enable/Disable Multipoint" on page 4 for help)

Multipoint Connect

- Pair the headset with one of your Bluetooth-enabled handsets. (per the pairing instructions on Manual Pairing).
- Now, pair and connect the headset with your other Bluetooth-enabled handset. (This will be your Primary handset).
- Once this headset is paired and connected, go back and connect the first paired handset to the headset. (This will be your Secondary handset).

Note: When the HBM-235 is connected to two handsets at the same time (Multipoint), the headset calling functions will work with the Primary handset (or handset which made the last outgoing call).

Controls

Power on / Power off

- Press the MFB Button for 3 seconds.

Volume Control

- Briefly press the VOLUME button.

Charging

- When the charger is connected, with the power on or off, the headset will turn off.
- While charging, the LED indicator will show a solid white light.
- When charging is complete, the LED indicator will turn off.

Battery Status Alert

- Press and hold the VOLUME DOWN button for 3 seconds.
- There are 3 levels of battery status : "Battery high", "Battery Medium", "Battery low"

Low battery

- An announcement will be made once every 2 minutes.
- If the battery is not charged, the headset will turn off.

Answering a call / Ending a call

- Briefly press the MFB button.

Last number redial*

- Press and hold the MFB button for 1 second to activate "Last Number Redial". The headset will beep, and call the last number dialed.

Making a call

- If you make a call from the handset, the call will (subject to phone settings) automatically transfer to the headset. If the call is not automatically transferred, you can manually transfer the call by briefly pressing the MFB button.

Voice dialing

- Briefly press the MFB button to activate "Voice Command".
- NOTE: If the handset does not support Voice Dialing, it is possible that performing this action will activate Last Number Redial.

Transferring a call*

- While on a call on your handset, briefly press the MFB button on the headset to transfer the audio to the headset. And to transfer a call from the headset to handset, press and hold VOLUME UP button for 3 seconds.

Call waiting*

- Answer a second call without hanging up the first call by pressing the MFB button for 1 second (you will hear a beep). Press the MFB button for 1 second to turn to the original call.
- Briefly press the MFB button to terminate the active call or both calls at once. (subject to handset's support)

Call Reject*

- Press the MFB button for 1 second when the handset rings.

Calling Function

- Voice Dialing and Last Number Redial features work with the Primary handset (or handset which made the last outgoing call).

Enable/Disable Multipoint

- With the Power off, press and hold the VOLUME UP and MFB button for 3 seconds to power on as Multipoint enabled.
- With the Power off, press and hold the VOLUME DOWN and MFB button for 3 seconds to power on as Multipoint disabled

Note : With the advanced multipoint, two calls using two handsets are available.

Out of range

- Operating range up to 10 meters (approximately 33 ft)
- If the headset and handset do not automatically reconnect when they are back within the required range, briefly press the MFB button on the HBM-235 to reconnect manually.

* It is possible to use these functions only when your handset supports them. For further information about using these features, please consult your handset's user manual.

LED indication

Function	HBM-235 Status	Action
Operating	Power on	The white LED light flickers 4 times.
	Power off	The white LED light flickers 4 times and then turns off.
	Pairing mode	The white LED light stays on.
	headset/ hands-free profile connected	The white LED light flickers 2 times every 5 seconds.
	Call connected	The white LED light flickers 2 times every 5 seconds.
Charging	Proximity Pairing mode	Fast LED light flicking 20 seconds
	Charging	The white LED stays on.
	Charging complete	LED is turns off.

Troubleshooting

Does not turn on	Check whether the battery of the HBM-235 is fully charged.	Charge the battery.
Unable to communicate with the LG Bluetooth® Headset HBM-235	Check whether the headset supports the headset or hands-free Bluetooth profiles.	Determine whether your headset supports the headset or hands-free Bluetooth profiles.
	Check whether the battery of the HBM-235 is low.	Charge the battery.
Unable to pair the HBM-235 with the Bluetooth® device	Check and make sure the headset is on.	Press and hold the MFB button for 3 seconds to turn on the headset.
	Check and make sure the headset is placed in pairing mode.	With the power off, press and hold the MFB button for 6 seconds to manually place the headset in pairing mode.
Low sound (speaker)	Check the speaker volume.	Increase the volume level.

Precautions

Do not drop the unit from high places.

Do not modify, repair, or take apart.

Do not expose directly to water, alcohol, benzene, etc. for cleaning.

Do not expose directly to flammables.

Do not place or keep the unit near flammables.

Keep unit away from humidity & dust.

Do not place heavy objects on the unit.

Only use the headset with an original LG charger, otherwise it may be damaged.

- Changes or modifications not expressly approved by the party responsible for compliance could void the user's authority to operate the equipment.
- There is a risk of explosion if the battery is replaced by an incorrect type.
- Dispose of used batteries according to the instructions.

Declaration of Confirmation

FCC NOTICE TO USERS :

This device complies with part 15 of the FCC rules.

Operation is subject to the following two conditions:

- (1) This device may not cause harmful interference and
- (2) This device must accept any interference received, including interference that may cause undesired operation.

IMPORTANT NOTE :

To comply with the FCC RF exposure compliance requirements, no change to the antenna or the device is permitted. Any change to the antenna or the device could result in the device exceeding the RF exposure requirements and void user's authority to operate the device.

Hereby, LG Electronics Inc. declares that this HBM-235 is in compliance with the essential requirements and other relevant provisions of Directive 1999/5/EC.

 **Bluetooth®** **CE1177** FCC ID:BEJHBM235

Additional Information

1. Radio frequency exposure

This Bluetooth® Headset, HBM-235, is a radio transmitter and receiver. When in operation, it communicates with a Bluetooth® equipped mobile device by receiving and transmitting radio frequency (RF) electromagnetic fields (microwaves) in the frequency range 2.4 to 2.4835 GHz. The output power of the radio transmitter is low. Your Bluetooth® Headset is designed to operate in compliance with the RF exposure guidelines and limits set by national authorities and international health agencies when used any compatible LG Electronics mobile phone.

2. Potentially explosive atmosphere

Turn off your electronic device when in any area with a potentially explosive atmosphere. It is rare, but your electronic device could generate sparks. Sparks in such areas could cause an explosion or fire resulting in bodily injury or even death. Areas with a potentially explosive atmosphere are often, but not always, clearly marked.

3. Battery information

A rechargeable battery has a long service life if treated properly. A new battery or one that has not been used for a long period of time could have reduced capacity the first few times it is used. Do not expose the battery to extreme temperatures, never above +60°(+140°F) or under -20°(-4°F). For maximum battery capacity, use the battery in room temperature. If the battery is used in low temperatures, the battery capacity will be reduced. The battery can only be charged in temperatures between +10°(+50°F) and +45°(+113°F). For your safety, do not remove the battery incorporated in the product. If you need to replace the battery, take it to the nearest authorised LG Electronics service point or dealer for assistance.

5. Recycling the battery in your Bluetooth® Headset

The battery in your Bluetooth® Headset must be disposed of properly and should never be placed in municipal waste. The LG Electronics service partner removing battery will dispose of it according to local regulations.

6. Conditions

- The warranty is valid only if the original receipt issued to the original purchaser by the dealer, specifying the date of purchase and serial number, is presented with the product to be repaired or replaced. LG Electronics reserves the right to refuse warranty service if this information has been removed or changed after the original purchase of the product from the dealer.

