



English
Español
Français

LG Electronics
BLUETOOTH® Mono Headset
HBM-310 User manual



All rights reserved.
LG Electronics Inc., 2008

Note : For the best performance and to prevent any damage to, or misuse of the HBM-310, please read all of the information carefully prior to using the HBM-310.

Any modifications or changes to this manual due to typographical errors or inaccuracies of stated information shall only be made by LG Electronics Inc.

Introduction	3
Part Description	4
How to use	5
- Charging	5
- Low battery	5
- Power on	5
- Power off	5
- Pairing	5
- Auto Reconnect	7
- Volume control	7
- Calling	8
• Answering a call	8
• Making a call	8
• Voice dialing	8
• Last number redial	8
• Ending a call	8
• Transferring a call	8
• Call waiting	8
• Call Reject	8
Summary of button functions	9
LED indication	9
Troubleshooting	10
Specification	10
Precautions	11
Declaration of confirmation	13
Additional information	13
Limited warranty	16
Important safety information	16

The LG Bluetooth® Headset HBM-310 is a light weight wireless Headset utilizing Bluetooth® technology. This product can be used as an audio accessory for devices supporting either the Headset or Handsfree Bluetooth® Profiles.

Included in package



Bluetooth® Headset



User manual



Charger



Warranty Card

Part Description

Front



Back

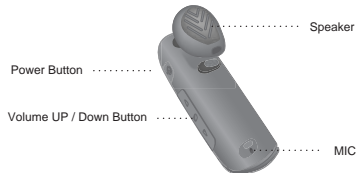

How to use

Charging

- Remove the cover on the charging port and connect the charger.
- When the charger is connected, with power on or off, the Headset will turn off. While charging, the LED indicator will show a solid blue light.
- The buttons will not function while the device is charging.
- It takes 2 hours to fully charge the Headset.
- When charging is complete, the LED indicator will turn off.

Low battery

- A low battery tone will play once every 30 seconds.
- If the battery is not charged, the Headset will turn off.

Power on

- Press and Hold the PWR button for 4 seconds.
 - The power will turn on and a booting tone will play.

Power off

- Press and hold the PWR button for 2 seconds.
 - A shutdown tone will play, the Bluetooth link will disconnect, and the power will turn off.

Pairing

- Prior to using the Headset for the first time, you must pair it with a Bluetooth-enabled handset.
- There are 2 Pairing Mode Methods with the HBM-310.

1) Easy Pairing

- With the Power off, press and hold the PWR button for 5 seconds, to turn on the HBM-310.
- The Headset will enter Auto-Reconnect mode, for 10 seconds (If your headset has been previously paired to the handset, the headset will automatically reconnect to the handset, when the HBM-310 is powered on.)
- After 10 seconds, the HBM-310 will automatically enter Pairing Mode.
- When the headset enters Pairing Mode, the LED indicator will show a solid blue light
- Using your handset, find the Bluetooth Menu and "search for" or "add" new devices.
- Select "LG HBM-310" from the list of devices and pair it with your handset.
- When asked for the Pass/PIN code during the pairing procedure, please enter "0000" (4 Zeros).
- Once pairing has completed successfully, you will hear a beep.
- After pairing successfully, be sure to "Connect" to the LG HBM-310.
- If you want to pair with a different device in the future, the Headset must be placed in Pairing Mode.
- If the headset is in Pairing mode for three minutes without being connected to a handset, the HBM-310 will automatically turn off.

2) Manual Pairing

- With the Power off, press and hold the PWR button for 7 seconds.
- When the Headset enters Pairing Mode, the LED indicator will show a solid blue light.
- Using your handset, find the Bluetooth Menu and "search for" or "add" new devices.
- Select "LG HBM-310" from the list of devices and pair it with your handset.

- When asked for the Pass/Pin code during the pairing procedure, please enter "0000" (4 Zeros)
- Once pairing has completed successfully, you will hear a beep.
- After pairing successfully, be sure to "Connect" to the LG HBM-310.
- If you want to pair with a different device in the future, the Headset must be placed in Pairing Mode.
- If the headset is in Pairing mode for three minutes without being connected to a handset, the HBM-310 will automatically turn off.

Auto Reconnect

- When the HBM-310 turns off (accidentally or intentionally) while connected to a handset, the headset and handset will disconnect. The Headset and handset will automatically reconnect when the HBM-310 is turned back on (as long as both devices are within the required range of 33ft. or 10m).

[Out of range]

- When the HBM-310 and your handset are separated by a distance of 33 feet (10 meters) or more, the Headset and handset will disconnect. When the handset and HBM-310 are brought back within the required distance, the HBM-310 will automatically reconnect with the handset.
- If the Headset and handset do not automatically reconnect when they are back within the required range, briefly press the CALL button on the HBM-310 to reconnect manually.

Volume control

- Press the VOLUME UP or VOLUME DOWN button to adjust the speaker volume.
- There are eight levels of speaker volume.

How to use

Calling

Answering a call

- When there is an incoming call, the Headset will ring.
- Briefly press the CALL button to answer an incoming call.

Making a call

- If you make a call from the handset, the call will (subject to phone settings) automatically transfer to the Headset. If the call is not automatically transferred, you can manually transfer the call by briefly pressing the CALL button on the HBM-310 (handset and headset must be paired).

Voice dialing*

- Briefly press the CALL button to activate "Voice Command". You will get the best results if you record the voice dialing tag through your Headset.

NOTE: If the handset does not support Voice Dialing, it is possible that performing this action will activate Last Number redial.

Last number redial*

- Press and hold the CALL button for 1 second to activate "Last Number Redial". The headset will beep, and call the last number dialed.

Ending a call

- Briefly press the CALL button.

Transferring a call*

- While on a call on your handset, briefly press the CALL button to transfer the audio to the Headset. (handset and headset must be paired).
- And to transfer a call from the Headset to Handset, press and hold VOLUME UP button for 5 seconds.

Call waiting*

- Answer a second call without hanging up the first call by pressing the CALL button for 1 second. Press the CALL button for 1 second to return to the original call.
- Briefly press the CALL button to terminate both calls at once.

Call Reject*

- Activate Call Reject by pressing the CALL button for 1 second when the handset rings.

* It is possible to use these functions only when your handset supports them. For further information about using these features, please consult your handset's user manual.

Summary of button functions

Function	HBM-310 Status	Action
Power on	Power off	Press the PWR button for 4 seconds.
Power off	Power on	Press the PWR button for at least 2 seconds.
Volume up	Talking	Briefly press the Volume Up button.
Volume down	Talking	Briefly press the Volume Down button.
Transferring a call	Talking	- Handset to Headset Briefly press the CALL button (must be paired) - Headset to Handset Press and hold the VOLUME UP button for 5 seconds.
Answering a call	Ringing	Briefly press the CALL button.
Ending a call	Talking	Briefly press the CALL button.
Call waiting	Talking	Press the CALL button for 1 second.
Last number redial	Idle	Press the CALL button for 1 second.
Voice dialing (handset must support)	Idle	Briefly press the CALL button.
Pairing mode	Power off	Press the PWR button for 7 seconds.
Call reject	Ringing	Press the CALL button for 1 second.

LED indication

Function	HBM-310 Status	Action
Operating	Power on	The blue LED light flickers 4 times.
	Power off	The blue LED light flickers 4 times and then turns off.
	Pairing mode	The blue LED light stays on.
	Headset/handsfree Profile connected	The blue LED light flickers 2 times every 5 seconds.
	Call connected	The blue LED light flickers 2 times every 5 seconds.
Charging	Charging	The blue LED stays on.
	Charging complete	LED is turned off.

Troubleshooting

Does not turn on	Check whether the battery of the HBM-310 is fully charged.	Charge the battery.
Unable to communicate with the LG Bluetooth® Headset HBM-310	Check whether the headset supports the Headset or Handsfree Bluetooth profiles.	Determine whether your headset supports the Headset or Handsfree Bluetooth profiles.
	Check whether the battery of the HBM-310 is low.	Charge the battery.
Unable to pair the HBM-310 with the Bluetooth® device	Check and make sure the Headset is on.	Press and hold the PWR button for at least 4 seconds to turn on the Headset.
	Check and make sure the Headset is placed in pairing mode.	With the power off, press and hold the PWR button for 7 seconds to place the headset in pairing mode.
Low sound (speaker)	Check the speaker volume.	Increase the volume level.

Specification

ITEM	Description
Bluetooth® specification	V2.0 (Handsfree / Headset profiles)
Battery	3.7V, Li- Polymer
Stand by time	Up to 150Hrs
Talk Time	Up to 6Hrs
Charging time	< 2Hrs
Operation temperature	-10°C ~ 60°C
Dimension / weight	19.1mm(W) X 52.9mm(L) X 11.1mm(H) / 11.0g

Precautions

Do not drop the unit from high places.



Do not modify, repair, or take apart.



Do not expose directly to water, alcohol, benzene, etc. for cleaning.



Do not expose directly to flammables.



Do not place or keep the unit near flammables.



Precautions

Keep unit away from humidity & dust.



Do not place heavy objects on the unit.



Please only use the headset with an LG original charger (Travel Adaptor, Vehicle Power Charger). Otherwise the headset might be damaged.



- Changes or modifications not expressly approved by the party responsible for compliance could void the user's authority to operate the equipment.
- There is a risk of explosion if the battery is replaced by an incorrect type.
- Dispose of used batteries according to the instructions.
- The earloop is made of a durable plastic. However, bending the earloop repeatedly is not recommended.



Declaration of Confirmation

FCC NOTICE TO USERS :

This device complies with part 15 of the FCC rules.

Operation is subject to the following two conditions

- (1) This device may not cause harmful interference and
- (2) This device must accept any interference received, including interference that may cause undesired operation.

IMPORTANT NOTE :

To comply with the FCC RF exposure compliance requirements, no change to the antenna or the device is permitted. Any change to the antenna or the device could result in the device exceeding the RF exposure requirements and void user's authority to operate the device.

User information Statement

Hereby, LG Electronics Inc. declares that this HBM-310 is in compliance with the essential requirements and other relevant provisions of directive 1999/5/EC.

Additional Information

1. Radio frequency exposure

This Bluetooth® Headset, HBM - 310, is a radio transmitter and receiver. When in operation, it communicates with a Bluetooth® equipped mobile device by receiving and transmitting radio frequency (RF) electromagnetic fields (microwaves) in the frequency range 2.4 to 2.4836 GHz. The output power of the radio transmitter is low, 0.001 watt. Your Bluetooth® Headset is designed to operate in compliance with the RF exposure guidelines and limits set by national authorities and international health agencies when used any compatible LG Electronics mobile phone.

2. Potentially explosive atmosphere

Turn off your electronic device when in any area with a potentially explosive atmosphere. It is rare, but your electronic device could generate sparks. Sparks in such areas could cause an explosion or fire resulting in bodily injury or even death. Areas with a potentially explosive atmosphere are often, but not always, clearly marked.

3. Emergency calls

IMPORTANT!

This Bluetooth® Headset and the electronic device connected to the Headset operate using radio signals, cellular and landline networks as well as user-programmed functions, which cannot guarantee connection under all conditions. Therefore you should never rely solely upon any electronic device for essential communications (e.g. medical emergencies). Remember, in order to make or receive calls, the Headset and the electronic device connected to the Headset must be switched on and in a service area with adequate cellular signal strength. Emergency calls may not be possible on all cellular phone networks or when certain network services and/or phone features are in use. Check with your local service provider.

4. Battery information

A rechargeable battery has a long service life if treated properly. A new battery or one that has not been used for a long period of time could have reduced capacity the first few times it is used. Do not expose the battery to extreme temperatures, never above + 60° (+140°F) or under -20° (-4°F). For maximum battery capacity, use the battery in room temperature. If the battery is used in low temperatures, the battery capacity will be reduced. The battery can only be charged in temperatures between + 10° (+50°F) and + 45° (+ 113°F).

5. Recycling the battery in your Bluetooth® Headset

The battery in your Bluetooth® Headset must be disposed of properly and should never be placed in municipal waste. The LG Electronics service partner removing battery will dispose of it according to local regulations.

6. Conditions

- The warranty is valid only if the original receipt issued to the original purchaser by the dealer, specifying the date of purchase and serial number, is presented with the product to be repaired or replaced. LG Electronics reserves the right to refuse warranty service if this information has been removed or changed after the original purchase of the product from the dealer.

- If LG Electronics repairs or replaces the product, the repaired or replaced product shall be warranted for the remaining time of the original warranty period or for ninety (90) days from the date of repair, whichever is longer. Repair or replacement may involve the use of functionally equivalent reconditioned units. Replaced parts or components will become the property of LG Electronics.
- This Warranty does not cover any failure of the product due to normal wear and tear, or due to misuse, including but not limited to use in other than the normal and customary manner, in accordance with instructions for use and maintenance of the product. Nor does this warranty cover any failure of the product due to accident, modification or adjustment, acts of God or damage resulting from liquid.
- This warranty does not cover product failures due to improper repair installations, modifications or service performed by a non-LG Electronics authorized person. Tampering with any of the seals on the product will void the warranty.
- THERE ARE NO EXPRESS WARRANTIES, WHETHER WRITTEN OR ORAL, OTHER THAN THIS PRINTED INCLUDING WITHOUT LIMITATION THE IMPLIED WARRANTIES OF MERCHANTABILITY OR FITNESS FOR A PARTICULAR PURPOSE, ARE LIMITED TO THE DURATION OF THIS LIMITED WARRANTY. IN NO EVENT SHALL LG ELECTRONICS OR ITS VENDORS BE LIABLE FOR INCIDENTAL OR CONSEQUENTIAL DAMAGES OF ANY NATURE WHATSOEVER, INCLUDING BUT NOT LIMITED TO LOST PROFITS OR COMMERCIAL LOSS, TO THE FULL EXTENT THOSE DAMAGES CAN BE DISCLAIMED BY LAW.
- Some countries/states do not allow the exclusion or limitation of incidental or consequential damages, or limitation of the duration of implied warranties, so the preceding limitations or exclusions may not apply to you. The warranty provided does not affect the consumer's statutory rights under applicable national legislation in force, nor the consumer's rights against the dealer arising from their sales/purchase contract.

Limited Warranty

Subject to the conditions of this Limited Warranty, LG Electronics warrants this product to be free from defects in design, material and workmanship at the time of its original purchase by a consumer, and for a subsequent period of one (1) year. Should your product need warranty service, please return it to the dealer from whom it was purchased or contact your local LG Electronics contact center to get further information.

IMPORTANT SAFETY INFORMATION

Avoiding hearing damage Permanent hearing loss may occur if you use your headset at a high volume. Set the volume to a safe level. You can adapt over time to a higher volume of sound that may sound normal but can be damaging to your hearing. If you experience ringing in your ears or muffled speech, stop listening and have your hearing checked. The louder the volume, the less time is required before your hearing could be affected. Hearing experts suggest that to protect your hearing:

- Limit the amount of time you use headset at high volume.
- Avoid turning up the volume to block out noisy surroundings.
- Turn the volume down if you can't hear people speaking near you.

For information about how to set a maximum volume limit on your handset, please refer to the features guide for your handset.

Using headsets safely Use of headsets to listen to music while operating a vehicle is not recommended and is illegal in some areas. Be careful and attentive while driving. Stop using this device if you find it disruptive or distracting while operating any type of vehicle or performing any other activity that requires your full attention.



Español
English
Français

LG Electronics BLUETOOTH® Mono Headset HBM-310 Manual de usuarios



reservados todos los derechos.
LG Electronics Inc., 2008

Nota : Para la mayor funcionamiento y para prevenir cualquier daño o mal uso de HBM-310, por favor lean toda la información antes de usar el producto.

Cualesquier modificación o cambio a este manual debido a los errores tipográficos o a las inexactitudes de la información indicada serán realizados solamente por la Electrónica inc. de LG.