

User's Guide
LG TONE PRO™
Bluetooth® Stereo Headset



Rev 1.0 US
All rights reserved.
LG Electronics Inc., 2015

Please read the Important Safety Precautions for the proper use of this product.

After reading, store this User's Guide in an easily accessible place for all users.

NOTE : Please read all information carefully prior to using the HBS-910 in order to prevent damages to the product and to enjoy the best performance.

WARNING : This product contains chemicals known to the State of California to cause cancer and birth defects or other reproductive harm. Call (800) 243-0000 for more information.

Wash hands after handling.

Contents

Safety Cautions.....	2
HD Speaker.....	2
apt-X®.....	3
Product Components.....	3
Product Tour.....	4
Battery Charging and Alerts.....	4
HBS-910 Registration/Connection.....	5
Indicator lamp.....	6
Mobile Calling Functions.....	7
Playing Music.....	7
Vibration Alert Settings.....	8
Out of Range.....	8
Find Me.....	8
Tone & Talk.....	9
Summary of HBS-910 Functions.....	9
Troubleshooting.....	10
Specifications and Features.....	11
Declaration of Confirmation.....	11
Additional Information.....	12
Limited Warranty.....	14
Important Safety Information.....	14

The LG TONE PRO™ (HBS-910) is a lightweight wireless headset that uses Bluetooth® technology.

This product can be used as an audio accessory for devices supporting either the A2DP or Hands-Free Bluetooth® Profile.

The Bluetooth® work mark and logo are registered trademarks of Bluetooth® SIG, Inc. and the use of all trademarks should follow the license agreement.

Safety Cautions

CAUTION

- Do not disassemble, adjust or repair the product arbitrarily.
- Make sure there are no flammable materials close or in contact with the product.
- Do not arbitrarily replace the battery as it may explode.
- The product may be damaged if an incompatible recharger is used.
- Make sure that any infant or child does not swallow a magnet or a small component of the product.
- If you have a medical device implanted, contact your doctor before use.

WARNING

- Do not drop the product from a high place.
- Make sure there is no water, alcohol, or benzene in contact with the product.
- Do not store the product in a wet or dusty place.
- Do not place any heavy objects on the product.
- This product is not waterproof. Avoid humidity and water.

HD Speaker

If the communication network of the device you are connecting to supports "HD Voice Calling", you can enjoy making voice calls and listening to music in high definition.

apt-X®

This product supports apt-X®.

The apt-X® is Bluetooth® wireless technology that provides clearer audio for listening to music and watching movies. (It operates automatically only with a mobile phone or audio device that supports apt-x®.)

Product Components



LG TONE PRO™ HBS-910
(Medium ear gels installed)



Extra Ear Gels
(small & large)



USB Charging Cable



User Manual



Warranty Card

- Actual product design may differ from images shown in manual.

CAUTION

Make sure authentic LG Electronics components are used. Using a non-authentic component may damage the product and thus void the warranty.

Product Tour

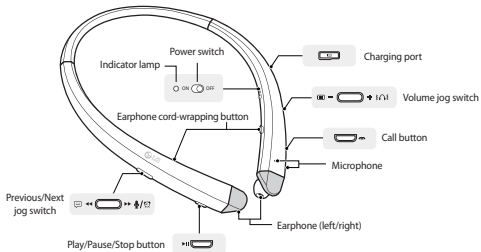

- NOTE: When you control the volume(level 16), you will hear a control sound two times or as a long sound from volume level 6 and higher.

Battery Charging and Alerts

Open the charging port cover and connect the charger to the charging port.

- NOTE: You cannot use functions such as Power on/off, Auto reconnection, Play/Pause, Make/Hang up Calls, Reject Calls, and Adjust Volume.

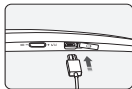

Slide the Volume jog switch in the "-" direction for 1 second to check the battery level by voice and indicator lamp.

Battery Status	Sufficient	Normal	Insufficient
Indicator lamp	Blue flashes three times	Purple flashes three times	Red flashes three times

HBS-910 Registration/Connection

If you start the process after putting in your earphones, you can easily register and connect following the voice prompts.

- NOTE: If you are prompted for the authorization code (PIN Code), type "0000".

If you hear that the battery is insufficient, recharge the battery before proceeding with the registration.

If registration is not completed within three minutes, the power automatically turns off.



Connecting Quickly

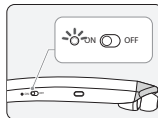
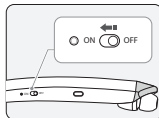

- Slide the Power switch towards [ON] to turn on the Power.
- The blue indicator lamp turns on and the HBS-910 switches to search mode.
- From the mobile phone or device list, select [LG HBS910] to connect.
- Once the connection is complete, a voice message indicates that the connection is complete.
- Use the same process to register the HBS-910 to other devices.

Connecting Manually

- Hold down the Call button and slide Power switch to [ON] to turn it on.
- The blue indicator lamp turns on and the HBS-910 switches to search mode.
- Select [LG HBS910] from the device list to connect.

Multiple Connections

The HBS-910 can be connected to a mobile phone and a PC simultaneously.

- NOTE: If simultaneously connected to two devices, the main functions work based on the "Main Connected Device".

- 1 Hold down the Call button and slide Power switch to [ON] to turn it on.
- 2 Perform Steps 2 to 4 in [Connecting Quickly]. This device becomes the "Main Connected Device".
- 3 Try to connect to HBS-910 using a previously connected device. This device becomes the "Sub Connected Device".

Automatic Reconnection

If you turn on the product, it automatically searches for the devices whose connection settings are configured to connect to them.

If the product does not automatically connect to the device you want, search for your product in the device you want to connect to and connect it manually.

Indicator lamp

Functions	HBS-910 Status	Description
Operation	Power On	The blue indicator lamp flashes four times.
	Power Off	The blue indicator lamp flashes four times.
	Search Mode	The blue indicator lamp is on.
	Headset/Hands-free Profile Connected	The blue indicator lamp flashes once every 5 seconds.
	Call Connected	The blue indicator lamp flashes once every 5 seconds.

Mobile Calling Functions

Functions	Description
Receiving a Call/ Hanging Up	Briefly press the Call button. To turn off the vibration, briefly slide the Volume jog switch in the "-" direction.
Making a Call	If you make a call using a mobile phone, the call is automatically connected to the HBS-910. On some mobile phones, you should briefly press the Play/Pause/Stop button two times to switch calls.
Redial	Press the Call button for 1 second.
Voice Dial	Briefly press the Call button. If the mobile does not support the voice dial function, you can use the redial function.
Switching Calls	Briefly press the Play/Pause/Stop button two times during a call. (Every time you press one of these buttons, the call switches to the mobile phone or the HBS-910.)
Receiving a Call While on the Phone	You can receive another call while on the phone by pressing the Call button for 1 second. The existing call switches to a call waiting status. Press the Call button again for 1 second to switch back to the previous call. Briefly press the Call button to hang up in the middle of a call, or to hang up both calls. (It works differently depending on the mobile phone settings.)
Rejecting a Call	Press the Call button for 2 seconds.
Enabling/Disabling Mute	Slide the Volume jog switch in the "+" direction, and slide the Previous/Next jog switch in the Previous direction for 1 second at the same time.

- CAUTION : Do not disable/enable the mute while driving, as you need to use both hands.
- NOTE : The voice dial and redial functions work on the "Main Connected Device" or on the device on which you made the last call. (The voice dial and redial functions may work differently depending on some mobile phones.)

Playing Music

Functions	Description
Play	Briefly press the Play/Pause/Stop button. Music will play from the activated player of the connected device.
Pause	Briefly press the Play/Pause/Stop button.
Stop	Press the Play/Pause/Stop button for 1 second.

Play Previous/Next Song	Briefly slide the Previous/Next jog switch in the Previous or Next direction.
Fast Rewind/Forward	Slide the Previous/Next jog switch in the Previous or Next direction until you reach the desired section of the track.
Change Equalizer Mode	Briefly press the Play/Pause/Stop button. Changes modes with a beeping sound in the following order: Ultra Boost (Default setting) > Bass Boost > Normal > Treble Boost (Enhanced treble)

Switching Music Players

If you stop in the middle of playback and then play music on either of the two connected devices, the HBS-910's music playback and control changes to that device.

Vibration Alert Settings

Slide the Volume jog switch in the "+" direction for 2 seconds when the HBS-910 is not in use.

If you turn off the vibration alerts, it will not vibrate even when a call is being received or you are out of communication range.

- NOTE : The vibration alert is automatically set to [ON] when you turn on the power.

Out of Range

If the device connected to the product is out of effective communication range (33 feet / 10 meters), the communication signal becomes weak and the communication is lost.

If the device comes back within effective communication range, the product automatically reconnects to the device. If the device is not automatically reconnected, press the Call button on the product to connect to it manually.

If a device that is not in use goes out of communication range when multiple devices are connected, the product vibrates and a voice message indicates that the connection is lost. In this case, the automatic reconnection function is not supported.

Find Me

To find handset, slide the Volume jog switch and Previous/Next jog switch to same direction at the same time. for example,

- Slide the Volume jog switch to the + position and the Previous/Next jog switch to the Previous position.
- Slide the Volume jog switch to the - position and the Previous/Next jog switch to the Next Position.

Tone & Talk

LG Tone & Talk supports various functions including text and voice directions, and calling. Go to the Google Play Store and search for "LG Tone & Talk" or scan the QR code on the right to install LG Tone & Talk.



- NOTE : LG Tone & Talk can be used on Android smartphones.

Function	Action
Current time alert or Voice memo	1. Select Current time alert or Voice memo from application. 2. Slide the Previous/Next jog switch to the Next position for 1 second.
Reading Recent Messages	Slide the Previous/Next jog switch in the Previous direction for 1 second.
Find Me	Slide the Volume jog switch and Previous/Next jog switch to same direction at the same time.
Using Speed Dial to Make a Call	1. Go to LG Tone & Talk and select a speed dial contact. 2. Briefly press the Call button two times. (The number should be specified in the LG Tone & Talk app.)
Using Favorites to Make a Call	1. Go to LG Tone & Talk and select a favorite contact. 2. Briefly press the Call button two times. 3. Slide the Previous/Next jog switch previous or next for 1 second to select a number. 4. Briefly press the Call button two times.
Making a Call from Call History	1. Go to LG Tone & Talk and select Call History. 2. Briefly press the Call button two times. 3. Slide the Previous/Next jog switch previous or next for 1 second to select a Call History number. 4. Briefly press the Call button two times.

Summary of HBS-910 Functions

Function	HBS-910 Status	Action
Power on	Power off	Slide the Power switch to the ON position.
Power off	Power on	Slide the Power switch to the OFF position.

Volume up	Talking / Music on	Slide the Volume jog switch to the + position.
Volume down	Talking / Music on	Slide the Volume jog switch to the - position.
Transferring a call	Talking	Press the Play/Pause/Stop button twice.
Answering a call	Ringling	Briefly press the Call button.
Stop incoming call vibration alerting	Ringling	Briefly slide the Volume jog switch to the - position.
Vibration on/off	Idle	Slide the Volume jog switch to the + position for 2 seconds.
Find Me	Power on	Slide the Volume jog switch and Previous/Next jog switch to same direction at the same time.
Ending a call	Talking	Briefly press the Call button.
Call waiting	Talking	Press the Call button for 1 second.
Last number redial	Idle	Press the Call button for 1 second.
Voice dialing (handset must support)	Idle	Briefly press the Call button.
Call reject	Ringling	Press the Call button for 2 seconds.
Mic mute on/off	Talking	Slide the Volume jog switch to the + position and the Previous/Next jog switch to the Previous position at the same time for 1 second.
Pairing mode (Manual)	Power off	Press the Call button and slide the Power switch to the ON position at the same time for 2 seconds.
Battery status check	Idle	Slide the Volume jog switch to the - position for 1 second.
Play	Power on	Briefly press the Play/Pause/Stop button.
Pause	Music on	Briefly press the Play/Pause/Stop button.
Stop	Music on	Press and hold the Play/Pause/Stop button for 1 second.
Next song	Music on	Briefly slide the Previous/Next jog switch to the Next position.
Previous song	Music on	Briefly slide the Previous/Next jog switch to the Previous position.
Fast forward	Music on	Slide and hold the Previous/Next jog switch in the Next position.
Rewind	Music on	Slide and hold the Previous/Next jog switch in the Previous position.
Equalizer settings	Music on	Press the Play/Pause/Stop button twice.

Troubleshooting

Problems	Solutions
The power does not turn on	Check the battery level and charge it.
Cannot make a call with the HBS-910	If the mobile phone does not support headset and hands-free functions, you cannot use the calling features. Check the battery level and charge it.
Cannot register the HBS-910 to the mobile phone	Check whether the HBS-910 is turned on. Check whether the HBS-910 is in search mode. - Hold down the Call button and slide Power switch to [ON] and the HBS-910 switches to search mode.
The sound is low	Control the sound level of the device connected to the HBS-910.

Specifications and Features

Item	Comments
Bluetooth® Specifications	V 4.1 (Headset/Hands-Free/A2DP/AVRCP profiles)
Battery	Battery 3.7 V / 210 mAh , Li-Polymer
Waiting Time	Up to 540 hours
Call Time	Up to 16 hours
Music Playback Time	Up to 12 hours
Charging Time	Less than 2 hours ~
Rated input voltage	DC 4.75 V ~ 5.6 V, 400 mA
Operating Temperature	-20 °C ~ 50 °C
Dimensions/Weight	145 mm (W) X 175 mm (L) x 14.7 mm (H) / 51 g
Operating Frequency	2402 MHz to 2480 MHz

Declaration of Confirmation

FCC NOTICE TO USERS:

This device complies with part 15 of the FCC rules.

Operation is subject to the following two conditions:

- (1) This device may not cause harmful interference and
- (2) This device must accept any interference received, including interference that may cause undesired operation.

IMPORTANT NOTE:

To comply with the FCC RF exposure compliance requirements, no change to the antenna or the device is permitted. Any change to the antenna or the device could result in the device exceeding the RF exposure requirements and void user's authority to operate the device.

This equipment has been tested and found to comply with the limits for a Class B digital device, pursuant to Part 15 of the FCC Rules. These limits are designed to provide reasonable protection against harmful interference in a residential installation. This equipment generates, uses, and can radiate radio frequency energy, and if not installed and used in accordance with the instructions, may cause harmful interference to radio communications. However, there is no guarantee that interference will not occur in a particular installation. If this equipment does cause harmful interference to radio or television reception, which can be determined by turning the equipment off and on, the user is encouraged to try and correct the interference by one or more of the following measures:

- Reorient or relocate the receiving antenna.
- Increase the distance between the equipment and the receiver.
- Connect the equipment to an outlet on a circuit different from that to which the receiver is connected.
- Consult the dealer or an experienced radio/TV technician for help.

IC NOTICE TO USERS:

This device complies with Industry Canada licence-exempt RSS standard(s).

Operation is subject to the following two conditions:

- (1) This device may not cause interference, and
- (2) This device must accept any interference, including interference that may cause undesired operation of the device.

Le présent appareil est conforme aux CNR d'Industrie Canada applicables aux appareils radio exempts de licence. L'exploitation est autorisée aux deux conditions suivantes:

- (1) L'appareil ne doit pas produire de brouillage, et
- (2) L'utilisateur de l'appareil doit accepter tout brouillage, radioélectrique subi, même si le brouillage est susceptible d'en compromettre le fonctionnement.

CE NOTICE TO USERS:

Hereby, LG Electronics Inc. declares that this HBS-910 is in compliance with the essential requirements and other relevant provisions of Directive 1999/5/EC.

Additional Information

1. Radio frequency exposure

This Bluetooth® Stereo Headset HBS-910 is a radio transmitter and receiver. When in operation it communicates with a Bluetooth® equipped mobile device by receiving and transmitting radio frequency (RF) electromagnetic fields (microwaves) in the frequency range 2.4 to 2.4835 GHz. Your Bluetooth® Headset is designed to operate in compliance with the RF exposure guidelines and limits set by national authorities and international health agencies when used with any compatible LG Electronics mobile phone.

2. Potentially explosive atmosphere

Turn off your electronic device when in any area with a potentially explosive atmosphere. Although this is uncommon, your electronic device could generate sparks. Sparks in such areas could cause an explosion or fire resulting in bodily injury or even death. Areas with a potentially explosive atmosphere are often, but not always, clearly marked.

3. Emergency calls

IMPORTANT!

This Bluetooth® headset and the electronic device connected to the headset operate using radio signals, mobile and landline networks as well as user-programmed functions, which cannot guarantee connection under all conditions. Therefore you should never rely solely upon any electronic device for essential communications (e.g. medical emergencies). Remember, in order to make or receive calls, the headset and the electronic device connected to the headset must be switched on and in a service area with adequate mobile signal strength. Emergency calls may not be possible on all mobile phone networks or when certain network services and/or phone features are in use. Check with your local service provider.

4. Battery information

A rechargeable battery has a long service life if treated properly. A new battery or one that has not been used for a long period of time could have reduced capacity the first few times it is used. Do not expose the battery to extreme temperatures, never above +60°C (+140°F) or below -20°C (-4°F). For maximum battery capacity, use the battery at room temperature. If the battery is used in low temperatures, the battery capacity will be reduced. The battery can only be charged in temperatures between +10°C (+50°F) and +45°C (+113°F). For your safety, do not remove the battery incorporated with the product. If you need to replace the battery, take it to the nearest authorised LG Electronics service point or dealer for assistance.

5. Recycling the battery in your Bluetooth® headset

The battery in your Bluetooth® Headset must be disposed of properly and should never be placed in municipal waste. The LG Electronics service partner who removes the battery will dispose of it according to local regulations.

6. Conditions

- The warranty is valid only if the original receipt issued to the original purchaser by the dealer, specifying the date of purchase and serial number, is presented with the product to be repaired or replaced. LG Electronics reserves the right to refuse warranty service if this information has been removed or changed after the original purchase of the product from the dealer.
- If LG Electronics repairs or replaces the product, the repaired or replaced product shall be warranted for the remaining time of the original warranty period or for ninety (90) days from the date of repair, whichever is longer. Repair or replacement may involve the use of functionally equivalent reconditioned units. Replaced parts or components will become the property of LG Electronics.
- This Warranty does not cover any failure of the product due to normal wear and tear, or due to misuse, including but not limited to use in other than the normal and customary manner, in accordance with instructions for use and maintenance of the product. Nor does this warranty cover any failure of the product due to accident, modification or adjustment, acts of God or damage resulting from liquid.
- This warranty does not cover product failures due to improper repair installations, modifications or service performed by a non- LG Electronics authorized person. Tampering with any of the seals on the product will void the warranty.
- THERE ARE NO EXPRESS WARRANTIES, WHETHER WRITTEN OR ORAL, OTHER THAN THIS PRINTED INCLUDING WITHOUT LIMITATION THE IMPLIED WARRANTIES OF MERCHANTABILITY OR FITNESS FOR A PARTICULAR PURPOSE, ARE LIMITED TO THE DURATION OF THIS LIMITED WARRANTY. IN NO EVENT SHALL LG ELECTRONICS OR ITS VENDORS BE LIABLE FOR INCIDENTAL OR CONSEQUENTIAL DAMAGES OF ANY NATURE WHATSOEVER, INCLUDING BUT NOT LIMITED TO LOST PROFITS OR COMMERCIAL LOSS, TO THE FULL EXTENT THOSE DAMAGES CAN BE DISCLAIMED BY LAW.
- Some countries/states do not allow the exclusion or limitation of incidental or consequential damages, or limitation of the duration of implied warranties, so the preceding limitations or exclusions may not apply to you. The warranty provided does not affect the consumer's statutory rights under applicable national legislation in force, nor the consumer's rights against the dealer arising from their sales/purchase contract.

Limited Warranty

Subject to the conditions of this Limited Warranty, LG Electronics warrants this product to be free from defects in design, material and workmanship at the time of its original purchase by a consumer, and for a subsequent period of one (1) year. Should your product need warranty service, please return it to the dealer from whom it was purchased or contact your local LG Electronics contact center to get further information.

Important Safety Information

Avoiding hearing damage

- Permanent hearing loss may occur if you use your headset at a high volume. Set the volume to a safe level. Over time you can become accustomed to a higher volume that may sound normal but can be damaging to your hearing.
- If you experience ringing in your ears or muffled speech, stop listening and have your hearing checked. The louder the volume, the less time is required before your hearing could be affected.
- Hearing experts suggest that to protect your hearing:
- Limit the amount of time you use the headset at high volume.
 - Avoid turning up the volume to block out noisy surroundings.
 - Turn the volume down if you can't hear people speaking near you.



Using headsets safely

Use of headsets to listen to music while operating a vehicle is not recommended and is illegal in some areas. Be careful and attentive while driving. Stop using this device if you find it disruptive or distracting while operating any type of vehicle or performing any other activity that requires your full attention.

 **Bluetooth®**
FCC ID: ZNFHBS910

