

| KG800 USER GUIDE |

- ENGLISH



Disposal of your old appliance

1. When this crossed-out wheeled bin symbol is attached to a product it means the product is covered by the European Directive 2002/96/CE.
2. All electrical and electronic products should be disposed of separately from the municipal waste stream via designated collection facilities appointed by the government or the local authorities.
3. The correct disposal of your old appliance will help prevent potential negative consequences for the environment and human health.
4. For more detailed information about disposal of your old appliance, please contact your city office, waste disposal service or the shop where you purchased the product.

TABLE OF CONTENTS

HOW TO USE TOUCH BUTTON	
INTRODUCTION	5
GUIDELINES FOR SAFE AND EFFICIENT USE	6
KG800 FEATURES	10
Parts of the phone	
Display information	14
On-Screen Icons	15
INSTALLATION	16
Installing the SIM card and the handset battery	
Charging the battery	18
Disconnecting the charger	19
GENERAL FUNCTIONS	22
Making a calls	
Adjusting the Volume	27
Answering a Call	

Entering Text	28
SELECTING FUNCTIONS AND OPTIONS	24
IN-CALL MENU	25
During a Call	27
Conference Calls	28
MENU TREE	30
GAMES & APPS	32
Games & Apps	
Profiles	
CONTACTS	33
Search	
Add new	
Caller groups	34
Speed dial	
Own number	
My business card	
Settings	

ORGANISER	35
Calendar	
Add new	
View daily schedules	
Delete past	
Delete all	
Go to date	
Set alarm tone	
Memo	
MULTIMEDIA	38
Camera	
Video camera	
Voice recorder	
Record	
View list	
MP3	
MP3 player	
Playlis	
Settings	
Photo album	

Video album**Settings**

Camera

Video camera

MESSAGES 41**New message**

Write text message

Write multimedia message

Write email message

Inbox**Mailbox****Drafts****Outbox****Listen to voice mail****Info message**

Read

Topics

Templates

Text templates

Multimedia templates

Settings

Text message

Multimedia message

Email

Voice mailbox number

Info message

Push message

MYSTUFF 47**Videos****Photos****Music****Text****Images****Sounds****Others****Games & Apps**

DISPLAY 57**Wallpaper**

Menu Colour**Standby text****Backlight****Network name**

PROFILES 67

Activate

Personalise

Rename

TOOLS 74**Favourites****Alarm clock****Bluetooth**

Paired devices

Handsfree devices

Settings

Supported services

Modem**Calculator****Unit converter**

TABLE OF CONTENTS

World time	
SIM-Menu	77

BROWSER	78
---------	----

Home

Bookmarks

Go to URL

Settings

Profiles

Cache

Clear cache

Clear cookie

Security

CALL REGISTER	83
---------------	----

Missed calls

Received calls

Dialled calls

All calls

Delete recent calls

Call charges

Call duration

Call costs

Setting

GPRS information

Call duration

Data volumes

SETTINGS	84
----------	----

Date & Time

Set date

Set time

Language

Call

Call divert

Answer mode

Send my number

Call waiting

Minute minder

Auto redial

Security

PIN code request

Handset lock

Call barring

Fixed dial number

Change codes

Network

Network selection

Band selection

GPRS Attach

Switch on

When needed

Memory status

Reset settings

ACCESSORIES	22
-------------	----

TECHNICAL DATA	22
----------------	----

HOW TO USE TOUCH BUTTON

- ▶ This product's buttons on the slide are touch buttons.
- ▶ Be sure to read “Cautions for Touch Buttons” before using touch buttons.

CAUTIONS FOR TOUCH BUTTONS



Touch Button

1. Make sure your hands are clean and dry.
 - Remove all moisture from the surface of your hands or the touch buttons in a humid environment.
2. You don't need to press hard on the touch buttons to make it work normally.
Keep product from severe impact, as sensors of touch buttons may be damaged.
3. Use the **tip** of the finger to press exactly on the touch button you want, being careful not to touch the buttons for other functions.
4. When both waiting screen and touch button light are off, pressing a touch button will not turn on the waiting screen light. Press Quit button and use after waiting screen light is on (touch buttons do not work when touch button lights are off).
5. If your slide is closed, **Touch Protection** function is on, and during calls, **Touch button Lock** function is automatically on. (For details, see 'Touch Button Status When Using Mobile Phone'.)
6. Touch button may not work normally if mobile phone case or plastic is covering the touch button. Also, touch button may not work normally if you are using it wearing a glove.
7. Keep metal and other conductive material away from the surface of touch buttons, as contact with them may result in error.

INTRODUCTION

Congratulations on your purchase of the advanced and compact KG800 cellular phone, designed to operate with the latest digital mobile communication technology.



This user's guide contains important information on the use and operation of this phone. Please read all the information carefully for optimal performance and to prevent any damage to or misuse of the phone. Any changes or modifications not expressly approved in this user's guide could void your warranty for this equipment.

Use of phone cases with magnetic locks with slide type phones has caused problems such as loss of network signal and phones powering off.

Please read these simple guidelines. Not following these guidelines may be dangerous or illegal. Further detailed information is given in this manual.

WARNING

- Mobile Phones must be switched off at all times in aircrafts.
- Do not hold the phone in your hand while driving.
- Do not use your phone near petrol stations, fuel depots, chemical plants or blasting operations.
- For your safety, use **ONLY** specified **ORIGINAL** batteries and chargers.
- Do not handle the phone with wet hands while it is being charged. It may cause an electric shock or seriously damage your phone.
- Keep the phone in a safe place out of small children's reach. It includes small parts which, if detached, may cause a choking hazard.

CAUTION

- Switch off the phone in any area where required by special regulations. For example, do not use your phone in hospitals or it may affect sensitive medical equipment.
- Emergency calls may not be available under all mobile networks. Therefore, you should never depend solely on your mobile phone for emergency calls.
- Only use **ORIGINAL** accessories to avoid damage to your phone.
- All radio transmitters carry risks of interference with electronics in close proximity. Minor interference may affect TVs, radios, PCs, etc.
- Batteries should be disposed of in accordance with relevant legislation.
- Do not dismantle the phone or battery.

GUIDELINES FOR SAFE AND EFFICIENT USE

Radio wave exposure and Specific Absorption Rate (SAR) information

This mobile phone model KG800 has been designed to comply with applicable safety requirement for exposure to radio waves. This requirement is based on scientific guidelines the include safety margins designed to assure the safety of all persons, regardless of age and health.

- The radio wave exposure guidelines employ a unit of measurement known as the Specific Absorption Rate, or SAR. Tests for SAR are conducted using standardized methods with the phone transmitting at its highest certified power level in all used frequency bands.
- While there may be differences between the SAR levels of various LG phone models, they are all designed to meet the relevant guidelines for exposure to radio waves.
- The SAR limit recommended by the international Commission on Non-Ionizing Radiation Protection (ICNIRP), which is 2W/kg averaged over ten (10) gram of tissue.

- The highest SAR value for this model phone tested by DASY4 for use at the ear is 0.366 W/kg (10g).
- SAR data information for residents in countries/ regions that have adopted the SAR limit recommended by the Institute of Electrical and Electronics Engineers (IEEE), which is 1.6 W/kg averaged over one (1) gram of tissue.

PRODUCT CARE AND MAINTENANCE

WARNING!

Use only batteries, chargers and accessories approved for use with this particular phone model. The use of any other types may invalidate any approval or warranty applying to the phone, and may be dangerous.

- Do not disassemble this unit. Take it to a qualified service technician when repair work is required.
- Keep away from electrical appliances such as a TV, radio or personal computer.
- The unit should be kept away from heat sources such as radiators or cookers.

- Do not drop.
- Do not subject this unit to mechanical vibration or shock.
- The coating of the phone may be damaged if covered with wrap or vinyl wrapper.
- Do not use harsh chemicals (such as alcohol, benzene, thinners, etc.) or detergents to clean your phone. There is a risk of this causing a fire.
- Do not subject this unit to excessive smoke or dust.
- Do not keep the phone next to credit cards or transport tickets; it can affect the information on the magnetic strips.
- Do not tap the screen with sharp objects as, it may damage the phone.
- Do not expose the phone to liquid or moisture.
- Use the accessories like an earphone cautiously.
- If you put your phone in a pocket or bag without covering the receptacle of the phone (power plug pin), metallic articles (such as a coin, paperclip or pen) may short-circuit the phone. Always cover the receptacle when not in use.

- Never place your phone in a microwave oven as it will cause the battery to explode.
- Only authorized personnel should service the phone and its accessories. Faulty installation or service may result in accidents and consequently invalidate the warranty.
- Do not use the phone if the antenna is damaged. If a damaged antenna contacts skin, it may cause a slight burn. Please contact an LG Authorized Service Centre to replace the damaged antenna.
- The label on the phone contains important information for customer support purposes. Do not remove it.

EFFICIENT PHONE OPERATION

To enjoy optimum performance with minimum power consumption please:

- Hold the phone as you speak to any other telephone. While speaking directly into the microphone, angle the antenna in a direction up and over your shoulder. If the antenna is extendable/retractable, it

GUIDELINES FOR SAFE AND EFFICIENT USE

should be extended during a call.

- Do not hold the antenna when the phone is in use. If you hold it, it can affect call quality, it also may cause the phone to operate at a higher power level than needed and shorten talk and standby times.
- If your mobile phone supports infrared, never direct the infrared ray at anyone's eyes.

ELECTRONICS DEVICES

All mobile phones may get interference, which could affect performance.

- Do not use your mobile phone near medical equipment without requesting permission. Avoid placing the phone over pacemakers, (i.e. in your breast pocket).
- Some hearing aids might be disturbed by mobile phones.
- Minor interference may affect TVs, radios, PCs, etc.
- Do not bend, scratch, or expose to static electricity.

ROAD SAFETY

Check the laws and regulations on the use of mobile phones in the areas when you drive.

- Do not use a hand-held phone while driving.
- Give full attention to driving.
- Use a hands-free kit, if available.
- Pull off the road and park before making or answering a call if driving conditions so require.
- RF energy may affect some electronic systems in your motor vehicle such as a car stereo or safety equipment.
- When riding in a car, do not leave your phone or set up the hands-free kit near to the air bag. If wireless equipment is improperly installed and the air bag is activated, you may be seriously injured.

BLASTING AREA

Do not use the phone where blasting is in progress. Observe restrictions, and follow any regulations or rules.

POTENTIALLY EXPLOSIVE ATMOSPHERES

- Do not use the phone at a refueling point. Don't use near fuel or chemicals.
- Do not transport or store flammable gas, liquid, or explosives in the compartment of your vehicle, which contains your mobile phone and accessories.

IN AIRCRAFT

Wireless devices can cause interference in aircraft.

- Turn off your mobile phone before boarding any aircraft.
- Do not use it on the ground without crew permission.

BATTERY INFORMATION AND CARE

- You do not need to completely discharge the battery before recharging. Unlike other battery systems, there is no memory effect that could

compromise the battery's performance.

- Use only LG batteries and chargers. LG chargers are designed to maximize the battery life.
- Do not disassemble or short-circuit the battery pack.
- Keep the metal contacts of the battery pack clean.
- Replace the battery when it no longer provides acceptable performance. The battery pack may be recharged hundreds of times until it needs replacing.
- Recharge the battery if it has not been used for a long time to maximize usability.
- Do not expose the battery charger to direct sunlight or use it in high humidity, such as the bathroom.
- Do not leave the battery in hot or cold places, this may deteriorate the battery performance.

NETWORK SERVICE

- Some services and functions described in this user's guide are dependent on network or subscription. Therefore, all menus may not be available in your phone. Please consult your network operator for more information about your subscription.

KG800 FEATURES

PARTS OF THE PHONE

Front view

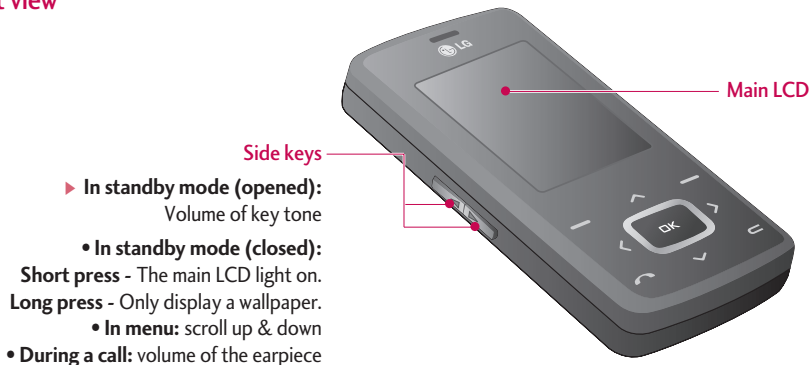

▶ **In standby mode (opened):**

Volume of key tone

• **In standby mode (closed):**

Short press - The main LCD light on.

Long press - Only display a wallpaper.

• **In menu:** scroll up & down

• **During a call:** volume of the earpiece

Note

- ▶ To protect the sense of hearing while Slide open, maximum volume level is 3.

Right side view



End key

- ▶ Switch on/off (hold down)
- ▶ End or reject a call.

Camera and Multimedia hot key

- ▶ Activates the camera (long press) and Multimedia menu (short press) directly.

Rear view

