

Part 15.21 statement

" Change or Modifications that are not expressly approved by the manufacturer could void the user's authority to operate the equipment. "

Part 15.105 statement

This equipment has been tested and found to comply with the limits for a class B digital device, pursuant to Part 15 of the FCC Rules.

These limits are designed to provide reasonable protection against harmful interference in a residential installation.

This equipment generates uses and can radiate radio frequency energy and, if not installed and used in accordance with the instructions, may cause harmful interference to radio communications.

However, there is no guarantee that interference will not occur in a particular installation. if this equipment does cause harmful interference or television reception, which can be determined by turning the equipment off and on, the user is encouraged to try to correct the interference by one or more of the following measures:

- Reorient or relocate the receiving antenna.
- Increase the separation between the equipment and receiver.
- Connect the equipment into an outlet on a circuit different from that to which the receiver is connected
- Consult the dealer or an experienced radio/TV technician for help.

LIMITED WARRANTY STATEMENT

1. WHAT THIS WARRANTY COVERS:

LG offers you a limited warranty that the enclosed subscriber unit and its enclosed accessories will be free from defects in material and workmanship, according to the following terms and conditions:

- (1) The limited warranty for the product extends for ONE (1) year beginning on the date of purchase of the product.
- (2) The limited warranty extends on to the original purchaser of the product and is not assignable or transferable to any subsequent purchaser/end user.
- (3) This warranty is good only to the original purchaser of the product during the warranty period as long as it is in the U.S., including Alaska, Hawaii, U.S. Territories and Canada.
- (4) The external housing and cosmetic parts shall not be covered under these limited warranty terms.
- (5) Upon request from LG, the consumer must provide information to reasonably prove the date of purchase.
- (6) The customer shall bear the cost of shipping the product to the Customer Service Department of LG. LG shall bear the cost of shipping the product back to the consumer after the completion of service under this limited warranty.

2. WHAT THIS WARRANTY DOES NOT COVER:

- (1) Defects or damages resulting from use of the product in other than its normal and customary manner.
- (2) Defects or damages from abnormal use, abnormal conditions, improper storage, exposure to moisture or dampness, unauthorized modifications, unauthorized connections, unauthorized repair, misuse, neglect, abuse, accident, alteration, improper installation, or other acts which are not the fault of LG, including damage caused by shipping blown fuses spills of food or liquid.
- (3) Breakage or damage to antennas unless caused directly by defects in material or workmanship.
- (4) That the Customer Service Department at LG was not notified by consumer of the alleged defect or malfunction of the product during the applicable limited warranty period.
- (5) Products which have had the serial number removed or made illegible.
- (6) The limited warranty is in lieu of all other warranties, express or implied either in fact or by operations law, statutory or otherwise, including, but limited to any implied warranty of marketability or fitness for a particular use.
- (7) Damage resulting from use of non-LG approved accessories.
- (8) All plastic surfaces and all other externally exposed parts that are scratched or damaged due to normal customer use.
- (9) Products operated outside published maximum ratings.
3
- (10) Products used or obtained in a rental program.
- (11) Consumables (such as fuses).

3. STATE LAW RIGHTS:

No other express warranty is applicable to this product. THE DURATION OF ANY IMPLIED WARRANTIES, INCLUDING THE IMPLIED WARRANTY OF MARKETABILITY, IS LIMITED TO THE DURATION OF THE EXPRESS WARRANTY HEREIN. LG INFOCOMM INC. SHALL NOT BE LIABLE FOR THE LOSS OF THE USE OF THE PRODUCT, INCONVENIENCE, LOSS OR ANY OTHER DAMAGES, DIRECT OR CONSEQUENTIAL, ARISING OUT OF THE USE OF, OR INABILITY TO USE, THIS PRODUCT OR FOR ANY BREACH OF ANY EXPRESS OR IMPLIED WARRANTY, INCLUDING THE IMPLIED WARRANTY OF MARKETABILITY APPLICABLE TO THIS PRODUCT. Some states do not allow the exclusion of incidental or consequential damages or limitations on how long an implied warranty lasts; so these limitations or exclusions may not apply to you. This warranty gives you specific legal rights and you may also have other rights which vary from state to state.

4. HOW TO GET WARRANTY SERVICE:

To obtain warranty service, please call the following web address:

www.lgeservice.com

For Your Safety

Important Information

This user guide contains important information on the use and operation of this phone. Please read all the information carefully for optimal performance and to prevent any damage to or misuse of the phone. Any changes or modifications not expressly approved in this user guide could void your warranty for this equipment.

Before You Start

Safety Instructions

WARNING! To reduce the possibility of electric shock, do not expose your phone to high humidity areas, such as the bathroom, swimming pool, etc.

Always store your phone away from heat. Never store your phone in settings that may expose it to temperatures less than 32°F or greater than 104°F, such as outside during extreme weather conditions or in your car on a hot day. Exposure to excessive cold or heat will result in malfunction, damage and/or catastrophic failure.

Be careful when using your phone near other electronic devices. RF emissions from your mobile phone may affect nearby in adequately shielded electronic equipment. You should consult with manufacturers of any personal medical devices such as pacemakers and hearing aides to determine if they are susceptible to interference from your mobile phone.

Turn off your phone in a medical facility or at a gas station. Never place your phone in a microwave oven as this will cause the battery to explode.

IMPORTANT! Please read the TIA SAFETY INFORMATION on page 78 before using your phone.

Safety Information

Read these simple guidelines. Breaking the rules may be dangerous or illegal. Further detailed information is given in this user guide.

- ▶ Never use an unapproved battery since this could damage the phone and/or battery and could cause the battery to explode.
- ▶ Never place your phone in a microwave oven as it will cause the battery to explode.
- ▶ Do not dispose of your battery by fire or with hazardous or flammable materials.
- ▶ Make sure that no sharp-edged items come into contact with the battery. There is a risk of this causing a fire.
- ▶ Store the battery in a place out of reach of children.
- ▶ Be careful that children do not swallow any parts such as rubber plugs (earphone, connection parts of the phone, etc.). This could cause asphyxiation or suffocation.

- ▶ Unplug the power cord and charger during lightning storms to avoid electric shock or fire.
- ▶ When riding in a car, do not leave your phone or set up the hands-free kit near to the air bag. If wireless equipment is improperly installed and the air bag is activated, you may be seriously injured.
- ▶ Do not use a hand-held phone while driving.
- ▶ Do not use the phone in areas where its use is prohibited. (For example: aircraft).
- ▶ Do not expose the battery charger or adapter to direct sunlight or use it in places with high humidity, such as a bathroom.
- ▶ Never store your phone in temperatures less than -4°F or greater than 122°F.
- ▶ Do not use harsh chemicals (such as alcohol, benzene, thinners, etc.) or detergents to clean your phone. There is a risk of this causing a fire.
- ▶ Do not drop, strike, or shake your phone severely. Such actions may harm the internal circuit boards of the phone.
- ▶ Do not use your phone in high explosive areas as the phone may generate sparks.
- ▶ Do not damage the power cord by bending, twisting, pulling, or heating. Do not use the plug if it is loose as it may cause a fire or electric shock.
- ▶ Do not place any heavy items on the power cord. Do not allow the power cord to be crimped as it may cause fire or electric shock.
- ▶ Do not handle the phone with wet hands while it is being charged. It may cause an electric shock or seriously damage your phone.
- ▶ Do not disassemble the phone.
- ▶ Do not place or answer calls while charging the phone as it may short-circuit the phone and/or cause electric shock or fire.
- ▶ Only use the batteries, antennas, and chargers provided by LG. The warranty will not be applied to products provided by other suppliers.
- ▶ Only authorized personnel should service the phone and its accessories. Faulty installation or service may result in accidents and consequently invalidate the warranty.
- ▶ Do not hold or let the antenna come in contact with your body during a call.
- ▶ An emergency call can be made only within a service area. For an emergency call, make sure that you are within a service area and that the phone is turned on.

FCC RF Exposure Information

WARNING! Read this information before operating the phone. In August 1996, the Federal Communications (FCC) of the United States, with its action in Report and Order FCC 96-326, adopted an updated safety standard for human exposure to radio frequency (RF) electromagnetic energy emitted by FCC regulated transmitters. Those guidelines are consistent with the safety standard previously set by both U.S. and international standards bodies.

The design of this phone complies with the FCC guidelines and these international standards.

CAUTION

Use only the supplied and approved antenna. Use of unauthorized antennas or modifications could impair call quality, damage the phone, void your warranty and/or result in violation of FCC regulations. Do not use the phone with a damaged antenna. If a damaged antenna comes into contact with skin, a minor burn may result. Contact your local dealer for a replacement antenna.

Body-worn Operation

This device was tested for typical body-worn operations with the back of the phone kept 0.79 inches (2cm) between the user's body and the back of the phone. To comply with FCC RF exposure requirements, a minimum separation distance of 0.79 inches(2cm) must be maintained between the user's body and the back of the phone. Third-party belt-clips, holsters, and similar accessories containing metallic components should not be used. Body-worn accessories that cannot maintain 0.79 inches(2cm) separation distance between the user's body and the back of the phone, and have not been tested for typical body-worn operations may not comply with FCC RF exposure limits and should be avoided.

Vehicle Mounted External Antenna (optional, if available)

A minimum separation distance of 8 inches (20cm) must be maintained between the user/bystander and the vehicle mounted external antenna to satisfy FCC RF exposure requirements. For more information about RF exposure, visit the FCC website at www.fcc.gov

FCC Part 15 Class B Compliance

This device and its accessories comply with part 15 of FCC rules. Operation is subject to the following two conditions: (1) This device and its accessories may not cause harmful interference, and (2) this device and its accessories must accept any interference received, including interference that may cause undesired operation.

Cautions for Battery

- ▶ Do not disassemble.
- ▶ Do not short-circuit.
- ▶ Do not expose to high temperature: 60°C (140°F).]
- ▶ Do not incinerate.

Battery Disposal

- ▶ Please dispose of your battery properly or bring to your local wireless carrier for recycling.
- ▶ Do not dispose in fire or with hazardous or flammable materials.

Adapter (Charger) Cautions

- ▶ Using the wrong battery charger could damage your phone and void your warranty.
- ▶ The adapter or battery charger is intended for indoor use only.

Do not expose the adapter or battery charger to direct sunlight or use it in places with high humidity, such as the bathroom.

LG KP130a USER GUIDE

Please read this manual carefully before operating your mobile phone. Retain it for future reference.

Installing the SIM Card and Charging the Battery

Installing the SIM Card

When you subscribe to a mobile network, you are provided with a plug-in SIM card loaded with your subscription details, such as your PIN, any optional services available and many others.

Important!

- › The plug-in SIM card and its contacts can be easily damaged by scratches or bending, so be careful when handling, inserting or removing the card. Keep all SIM cards out of the reach of small children.

Illustrations

- 1 Open battery cover
- 2 Insert your SIM
- 3 Close the battery cover as your PIN, any optional services available and many others.
- 4 Charge your battery

Phone Components

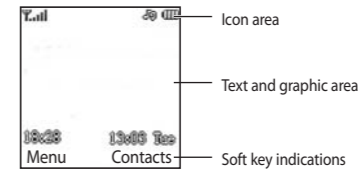
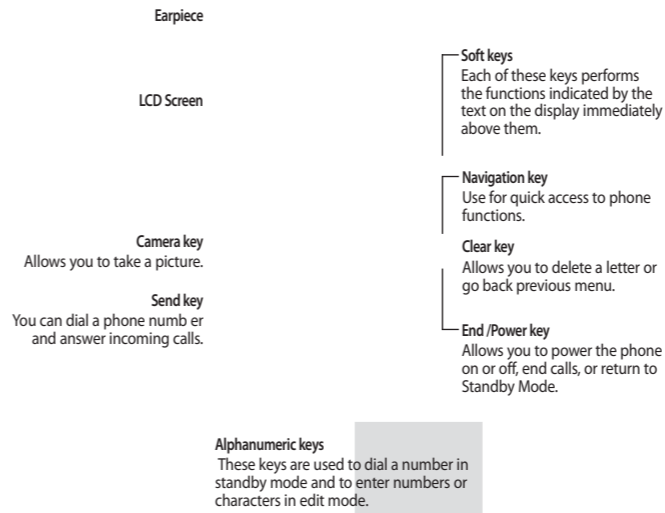

| | |
|--|---|
| | Tells you the strength of the network signal. |
| | You can use GPRS service. |
| | Shows that you are using a roaming service. |
| | Line 1/2 is in use for outgoing calls. |
| | The alarm has been set and is on. |
| | Tells you the status of the battery. |
| | You have received a text message. |
| | You have received a voice mail. |
| | You have received a push message. |
| | You can view your schedule. |
| | Vibrate only profile is active. |
| | General profile is active. |
| | Outdoor profile is active. |
| | Silent profile is active. |
| | Headset profile is active. |
| | All calls divert has been set. |

Turning Your Phone On and Off

1. Hold down the [END] key until the phone switches on.
2. To switch the phone off, hold down the [END] key until the power-off image displays.

Making a Call

1. Enter a phone number including the area code.
2. Press the [SEND] key to call the number.
3. When finished, press the [END] key.

Making an international call

1. Press and hold the [+] key for the international prefix. The '+' character automatically selects the international access code.
2. Enter the country code, area code, and the phone number.
3. Press [send] key to call the number.

Making a call from the phonebook

You can save the names and phone numbers dialled regularly in the SIM card and/or phone memory. You can dial a number by simply looking up the desired name in the contacts and pressing the [call] key. For shortcut of the phonebook, you can press [call] in standby mode.

Answering a Call

1. When the phone rings and the phone icon flashes on the screen, press the [SEND] key or the left soft key to answer.
2. End the call by pressing the [END] key

Note

- › After the call ends, the phone will go back to standby mode.

Selecting Functions and Options

Your phone offers a set of functions which are arranged to customise it. These functions are arranged in menus and sub-menus, accessed via the left and right soft keys. The label on the bottom of the display screen immediately above the soft keys indicates their current function.

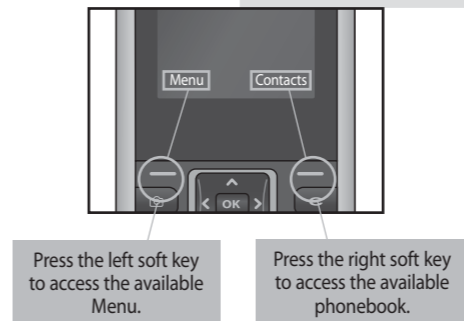

Entering Text

You can enter alphanumeric characters by using the phone's keypad. For example, storing names in the phonebook, writing a message, creating a personal greeting.

T9 Mode

This mode lets you enter words with only one keystroke per letter. Each key on the keypad has more than one letter. The T9 mode automatically compares your keystrokes with an internal dictionary to determine the correct word, thus requiring far fewer keystrokes than the traditional ABC mode.

ABC Mode

This mode lets you enter letters by pressing the key labeled with the required letter once, twice, three or four times until the letter is displayed.

123 Mode (Numbers Mode)

Type numbers using one keystroke per number.

Symbol Mode

This mode allows you to enter special characters by pressing [symbol] key.

Menu Tree

› The menu in this phone can be displayed in 2 ways. One is by grid type or secondly in list format. Please note that menu number options are different in each view. The default setting on the phone is set to show the menu in grid type, so therefore all the menu number selections throughout the manual are set according to that setting.

| | | |
|------------------------|------------------------------------|----------------------------|
| 1. t-zones | 3.8 World clock 3.9 SIM Service | 7.4 Outdoor 7.5 Headset |
| 1.1 Home | 4. Multimedia | 8. Contacts |
| 1.2 Bookmarks | 4.1 Camera | 8.1 Search |
| 1.3 Go to URL | 4.2 Voice recorder | 8.2 New contact |
| 1.4 History | 5. Messaging | 8.3 Speed dial |
| 1.5 Saved pages | 5.1 New message | 8.4 Groups |
| 1.6 Settings | 5.2 Inbox | 8.5 Copy all |
| 1.7 Information | 5.3 Drafts | 8.6 Delete all |
| 2. Call history | 5.4 Outbox | 8.7 Settings |
| 2.1 All calls | 5.5 Sent | 8.8 Information |
| 2.2 Missed calls | 5.6 Listen voicemail | 9. Settings |
| 2.3 Dialed calls | 5.7 Info messages | 9.1 Time and Date |
| 2.4 Received calls | 5.8 Templates | 9.2 Language |
| 2.5 Call duration | 5.9 Settings | 9.3 Display |
| 2.6 Call costs | 6. My stuff | 9.4 Call |
| 2.7 Data information | 6.1 Images | 9.5 Network settings |
| 3. Tools | 6.2 Sounds | 9.6 Security settings |
| 3.1 Alarm clock | 7. Profiles | 9.7 Flight mode |
| 3.2 Calendar | 7.1 General | 9.8 Power save |
| 3.3 Memo | 7.2 Silent | 9.9 Reset |
| 3.4 To do | 7.3 Vibrate only | 9.0 Memory status |
| 3.5 Calculator | | |
| 3.6 Stopwatch | | |
| 3.7 Unit converter | | |

Quick Feature Reference

This section provides brief explanations of features on your phone.

t-zones Menu 1

t-zones provide information such as news, weather forecast, information on sports or traffic whenever you need it. In addition, t-zones provides superior multimedia services such as the latest music or ring tones, wallpapers or games for you to download.

Note: Please note that additional charges may occur under another name depending on your SIM card and that additional changes may occur when using this service.

Call history Menu 2

You can check the record of missed, received, and dialled calls only if the network supports Caller Line Identification (CL) within the service area. The number and name/photo (if available) are displayed together with the date and time at which the call was made. You can also view call durations.

| Tools Menu 3 (Continued) | |
|--------------------------|--|
| Alarm clock | You can set up to 5 alarm clocks to go off at a specified time. |
| Calendar | When you enter this menu, a calendar appears. |
| Memo | You can register your own memos here. |
| To do | You can create, view, delete to do list. |
| Calculator | The calculator provides the basic arithmetic functions: addition, subtraction, multiplication and division. |
| Stopwatch | This option allows you to use the function of a stopwatch. |
| Unit converter | This converts many measurement into a unit you want. |
| World clock | You can check the current time of Greenwich Mean Time (GMT) and major cities around the world. |
| SIM Service | Your service provider can offer special applications through the SIM card. Note: Please note that additional charges may occur under another name depending on your SIM card and that additional changes may occur when using this service. |

| Multimedia Menu 4 (Continued) | |
|-------------------------------|--|
| Camera | This application enables you to take a still picture. You can take a picture in your desired size, and use it for the contacts photo, home screen and other more general purposes. Once taken, a still image can be sent via a Multimedia message. › Select the menu Multimedia → Camera. › Focus on the subject to capture the image, and then press the [call] key. › If you want to save it, press the left soft key [Options] and select Album. |
| Voice recorder | You can record a voice memo in the Voice recorder menu. |

| Messaging Menu 5 | |
|--|---|
| This menu includes functions related to SMS (Short Message Services) and MMS (Multimedia Message Service). | |
| New message | Create and send a text or multimedia message to one or more recipients. |
| Inbox | You will be alerted when you have received a message. |
| Drafts | This menu shows the unsent message list. |
| Outbox | This menu allows to view the message which is about to be sent or has failed to be sent. |
| Sent | This menu allows you to view the messages which have already been sent, including time and content. |
| Listen voicemail | This menu provides you with a quick way of accessing your voice mailbox (if provided by your network). |
| Info messages | Info service messages are text messages delivered by the network to your handset. |
| Templates | There are pre-defined messages in the list. You can view and edit the template messages or create new messages. |
| Settings | This menu allows you to configure messaging functions to work with your network provider. |

| My stuff Menu 6 | |
|--|--------------------------------|
| You can access the following menus for your convenience and preferences. | |
| Images | Shows the list of image files. |
| Sounds | Shows the list of sound files. |

| Profiles Menu 7 | |
|--|--|
| You can select ringtone or vibration for an incoming call and configure the sound and volume of the ringtone, key tone, and sound effect, according to a profile. The profiles provided include [General], [Silent], [Vibrate only], [Outdoor], [Headset]. | |

| Contacts Menu 8 | |
|--------------------|---|
| Search | You can Search for contacts in Phonebook. Note: Instant searching is available by inputting the initial letter of the name you want to search. |
| New contact | You can add phonebook entries by using this menu. |
| Speed dial | Assign contacts to any of the keys between 1 and 9 . |
| Groups | You can add members to each group, with up to a maximum of 7 groups in total. |
| Copy all | You can copy all entries from the SIM card memory to Phone memory. |
| Delete all | You can delete all entries from the SIM card memory or Phone memory. |
| Settings | You can set the Contact display option. |
| Information | <ul style="list-style-type: none"> › Service dial numbers: Access the list of service numbers as your service provider. › Own numbers: You can save and check your own numbers in the SIM card. › My Business card: This option allows you to create your own business card featuring your name, mobile phone number and so on. |

| Settings Menu 9 | |
|----------------------|--|
| Time and Date | You can set functions relating to the date and time. |
| Language | You can change the language for the display texts in your phone. |
| Display | You can change the settings for the phone display. |
| Call | <ul style="list-style-type: none"> › Call divert: You can divert a call when you do not receive a call. › Call barring: The Call barring service prevents your phone from making or receiving a certain category of calls. This function requires the call barring password. › Fixed dial number (SIM dependent): You can restrict your outgoing calls to selected phone numbers. The numbers are protected by your PIN2 code. The numbers you wish to allow access to once this service has been enabled, must be added to the contacts after enabling Fixed dial number. › Answer mode: Allows you to set the answering method (Any key/ Send key only) › Send my number: You can configure to send my phone number when making a call. › Call waiting: Allows to display requesting message and animation when activating the service. › Minute minder: Determines whether to sound a 1 minute tone every one minute when you are on the phone. › Auto redial: Allows you to set auto redial function when a call attempt has failed. › Send DTMF tones: You can send DTMF tones when using banking service and so on. <p>* DTMF: Dual Tones Multiple Frequency</p> |

| Settings Menu 9 (Continued) | |
|-----------------------------|--|
| Network settings | You can set a type of network to search for when networks are searched in the Select network menu. |
| Security settings | This menu allows you to protect your phone from unauthorized use. <ul style="list-style-type: none"> › PIN code request: You can set the phone to ask for the PIN code of your SIM card when the phone is switched on. › Auto key lock: This menu allows to set the time of Auto key lock. › Phone lock: You can use a security code to avoid unauthorized use of the phone. |
| Flight mode | If set to On, the connection between the phone and network service will be cut off. |
| Power save | This function saves battery power by keeping the backlight brightness to max 40%. (Off/ Night only/ Always on) |
| Reset | You can initialise all factory defaults. You will need the Security code to activate this function. |
| Memory status | You can check the capacity of free memory. |

☐ Guidelines for Safe and Efficient Use

Please read these simple guidelines. Ignoring them may be dangerous or illegal. Further detailed information is given in this manual.

Warning

- › For your safety, use ONLY specified ORIGINAL batteries and chargers.
- › Switch off the phone in any area where required by special regulations, e.g. in a hospital where it may affect medical equipment.
- › Batteries should be disposed of in accordance with relevant legislation.

Product care and maintenance

- WARNING!** Only use batteries, chargers and accessories approved for use with this particular phone model. The use of any other types may invalidate any approval or warranty applying to the phone, and may be dangerous.
- › Do not disassemble this unit. Take it to a qualified service technician when repair work is required.
 - › The unit should be kept away from heat sources such as radiators or cookers.
 - › Use a dry cloth to clean the exterior of the unit. (Do not use any solvents.)
 - › Do not keep the phone next to credit cards or transport tickets; it can affect the information on the magnetic strips.

☐ Guidelines for Safe and Efficient Use (Continued)

Electronic devices

- All mobile phones may get interference, which could affect performance.
- › Do not use your mobile phone near medical equipment without requesting permission. Avoid placing the phone over a pacemaker, i.e. in your breast pocket.

☐ Guidelines for Safe and Efficient Use (Continued)

Road safety

- Check the laws and regulations on the use of mobile phones in the areas when you drive.
- › Do not use a hand-held phone while driving.
 - › Use a hands-free kit, if available.
 - › Pull off the road and park before making or answering a call if driving conditions so require.

Blasting area

Do not use the phone where blasting is in progress. Observe restrictions, and follow any regulations or rules.

Potentially explosive atmospheres

Do not use the phone at a refueling point. Do not use near fuel or chemicals.

☐ Guidelines for Safe and Efficient Use (Continued)

In aircraft

Wireless devices can cause interference in aircraft.

- › Turn off your mobile phone before boarding any aircraft.

Children

Keep the phone in a safe place out of children's reach. It includes small parts which if detached may cause a choking hazard.

Emergency calls

Emergency calls may not be available under all mobile networks. Therefore, you should never depend solely on the phone for emergency calls. Check with your local service provider.

☐ Guidelines for Safe and Efficient Use (Continued)

Battery information and care

- › You do not need to completely discharge the battery before recharging. Unlike other battery systems, there is no memory effect that could compromise the battery's performance.
- › Use only LG batteries and chargers. LG chargers are designed to maximize the battery life.
- › Do not disassemble or short-circuit the battery pack.
- › Replace the battery when it no longer provides acceptable performance. The battery pack may be recharged hundreds of times before it needs to be replaced.
- › Do not expose the battery charger to direct sunlight or use it in high humidity, such as the bathroom.
- › Risk of explosion if battery is replaced by an incorrect type.
- › Dispose of appliance according to the manufacturer's instructions.

☐ Guidelines for Safe and Efficient Use (Continued)

Exposure to radio frequency energy

Radio wave exposure and Specific Absorption Rate (SAR) information

This mobile phone model KP130 has been designed to comply with applicable safety requirement for exposure to radio waves. This requirement is based on scientific guidelines that include safety margins designed to ensure safety of all persons, regardless of age and health.

- › The radio wave exposure guidelines employ a unit of measurement known as the Specific Absorption Rate, or SAR. Tests for SAR are conducted using standardised methods with the phone transmitting at its highest certified power level in all used frequency bands.
- › While there may be differences between the SAR levels of various LG phone models, they are all designed to meet the relevant guidelines for exposure to radio waves.
- › The SAR limit recommended by the International Commission on Non-Ionizing Radiation Protection (ICNIRP) is 2W/kg averaged over ten (10) gram of tissue.
- › The highest SAR value for this model phone tested by DASY4 for use at the ear is 0.514 W/kg (10g) and when worn on the body is 0.426 W/kg (10g).
- › SAR data information for residents in countries/regions that have adopted the SAR limit recommended by the Institute of Electrical and Electronics Engineers (IEEE) is 1.6 W/kg averaged over one (1) gram of tissue.