

3. Configuration settings

3.1.3. Saving device configuration settings

Press [#] in the main menu to save device configuration settings.
The following screen appears:



Save?
[Y=1/N=2] : _

Press [1] to save changes.
If not, press [2].



If there are no changes in device configuration settings, it goes out of this setting mode without going through the above screen.



If there is no input for a certain period of time while changing the device configuration settings, the setting process finishes. If there are changes in device configuration settings, the above screen “Save?” appears. If not, it goes out of this setting mode and the initial screen appears.

3. Configuration settings

3.2. Menu configuration

□ Press [*] for over 2 sec. to enter the menu.

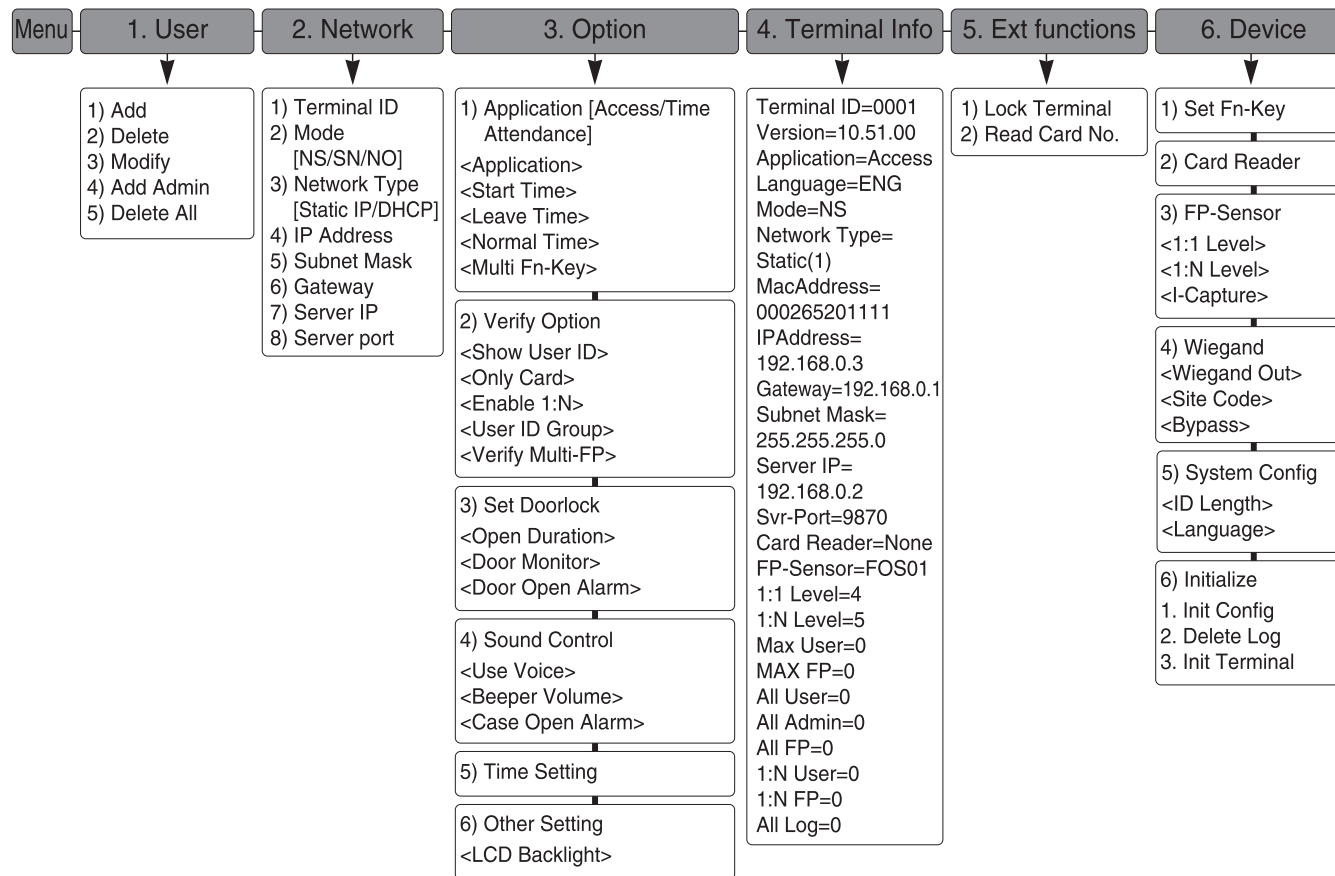

3. Configuration settings

3.3. User account

3.3.1. User registration

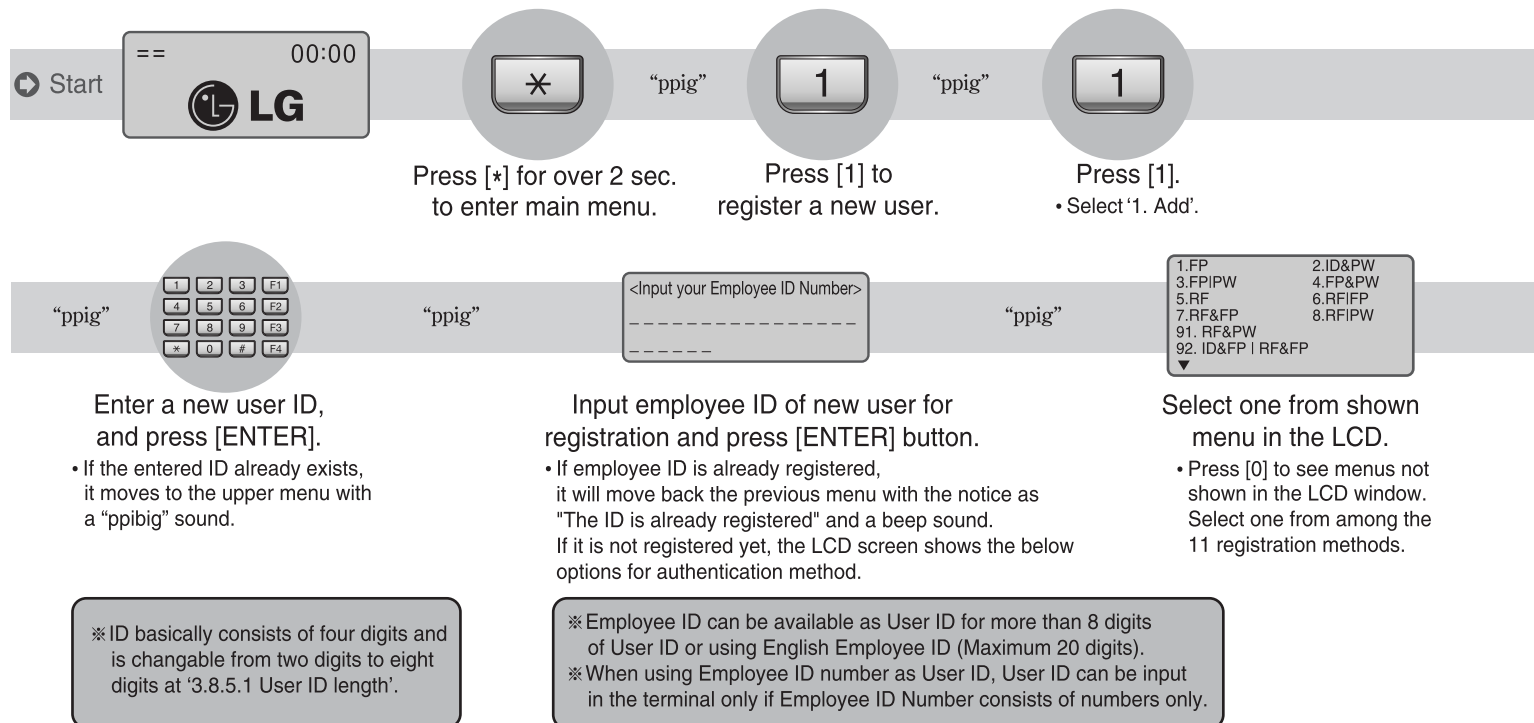

3. Configuration settings

3.3.1.1. '1. FP' registration

□ Fingerprint registration and fingerprint authentication.

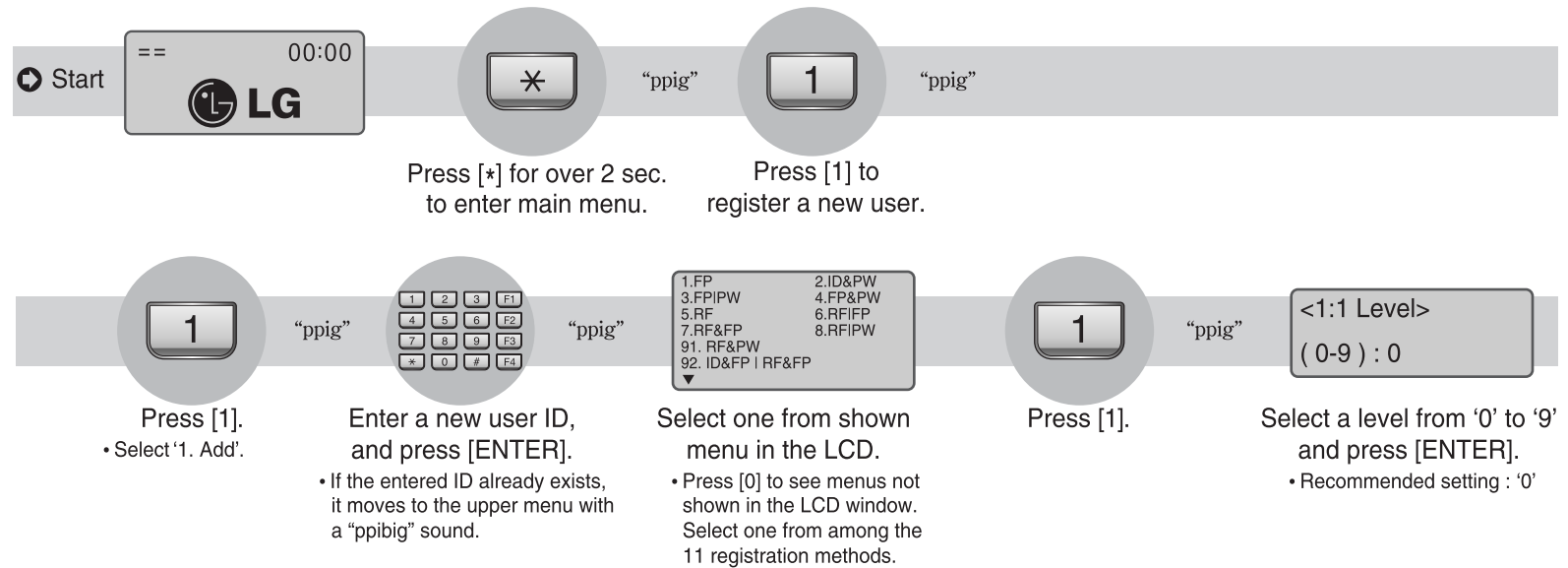

3. Configuration settings

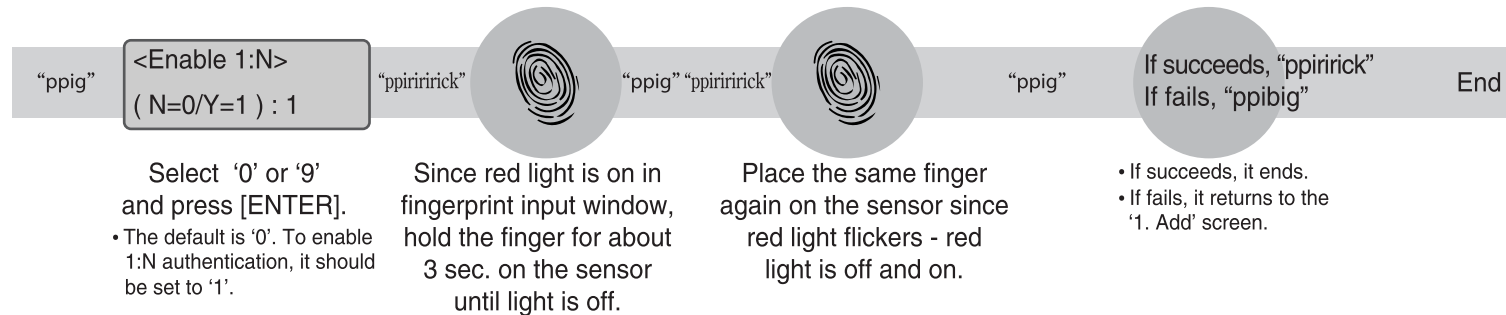

※ **1:1 Level** : A Different authentication level can be assigned to respectively different users. If the authentication level for a user is set to ‘0’, the authentication level for the terminal is changed, the applied authentication level for all users respectively set to ‘0’ is simultaneously changed.

※ **Enable 1:N** : In case that there are not many users or for the convenience of a specific user, a fingerprint only without ID can be used for authentication. For authentication without ID, it shall be set to ‘1’. For authentication with ID, it shall be set to ‘0’.

※ **Add FP** : A “ppiririck” buzzer sound rings twice and a light on the fingerprint sensor turns on. Place a finger onto the fingerprint input window and wait for 2~3 seconds until the light turns off and the fingerprint is saved. Please note that the same fingerprint must be inputted twice. To enter the same fingerprint again, remove the finger from the window and place the same finger again onto the window. If registration succeeds, a “ppiririck” buzzer sound rings. Then, it returns to the “1.Add” screen. If the fingerprint image is not in good conditions or there is no input in the window for 10 seconds after the fingerprint sensor light turns on, it returns to the “1. Add” screen with a failure buzzer sound “ppibig”. In case that the fingerprint to be registered is in bad conditions, repeat to try the registration process more than 2 or 3 times or register other fingerprint. For remarkably few people having fingerprints in bad conditions which are not properly accepted for registration process, it is recommended to use a password for authentication.

3. Configuration settings

3.3.1.2. '2. ID&PW' registration

□ Password registration and password authentication for a user.

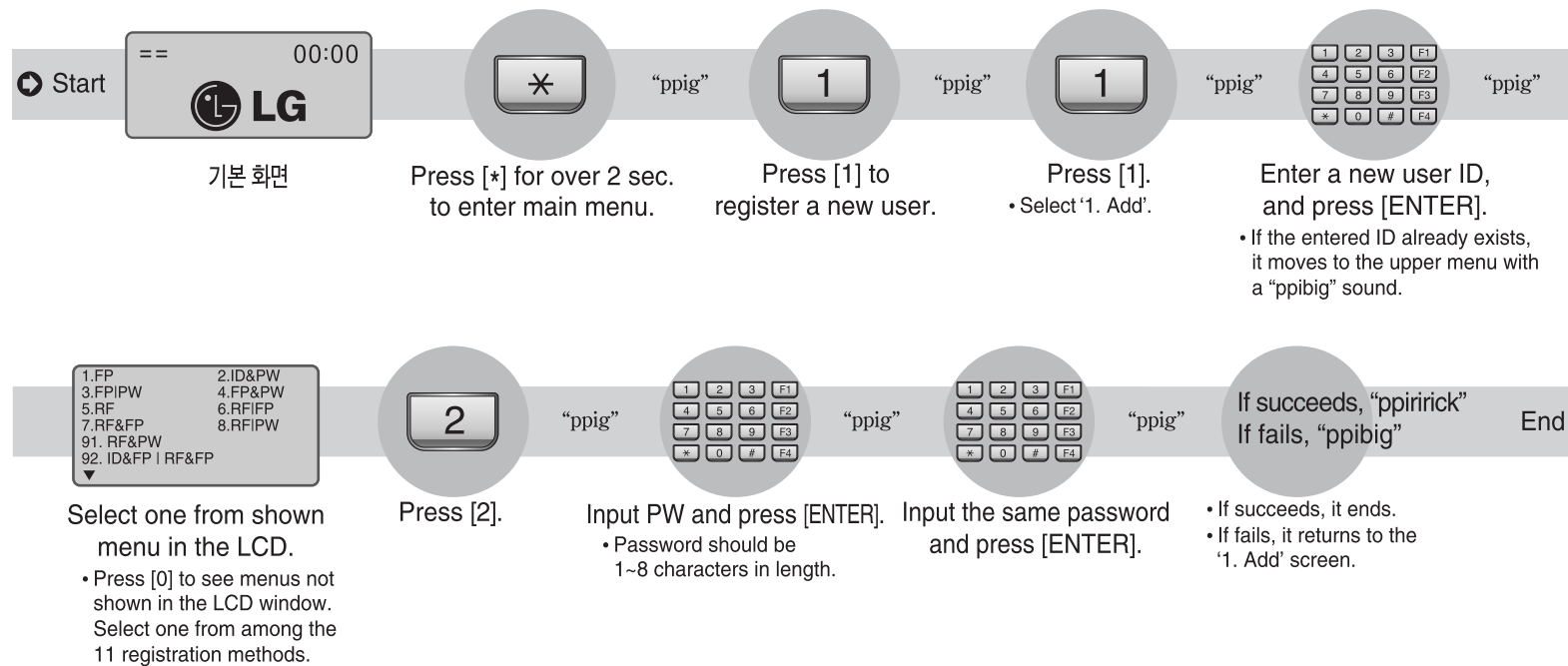

3. Configuration settings

3.3.1.3. '3. FPIPW' registration

□ After both fingerprint and password are registered, authentication method is selectable during fingerprint or password.

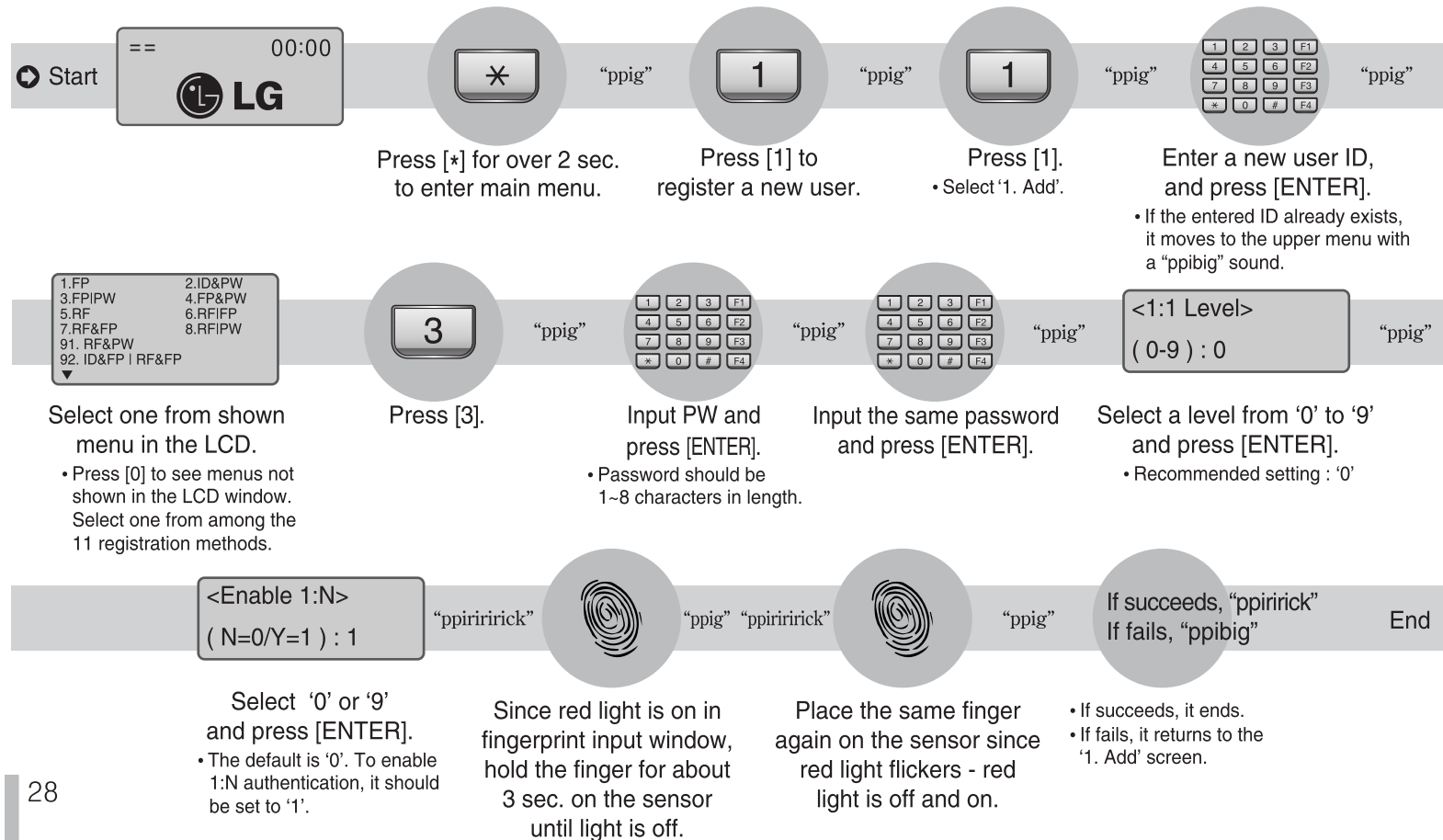

3. Configuration settings

3.3.1.4. '4. FP&PW' registration

- After both fingerprint and password are registered, fingerprint authentication and password authentication should be done for access. Fingerprint authentication precedes password authentication. selectable during fingerprint or password.

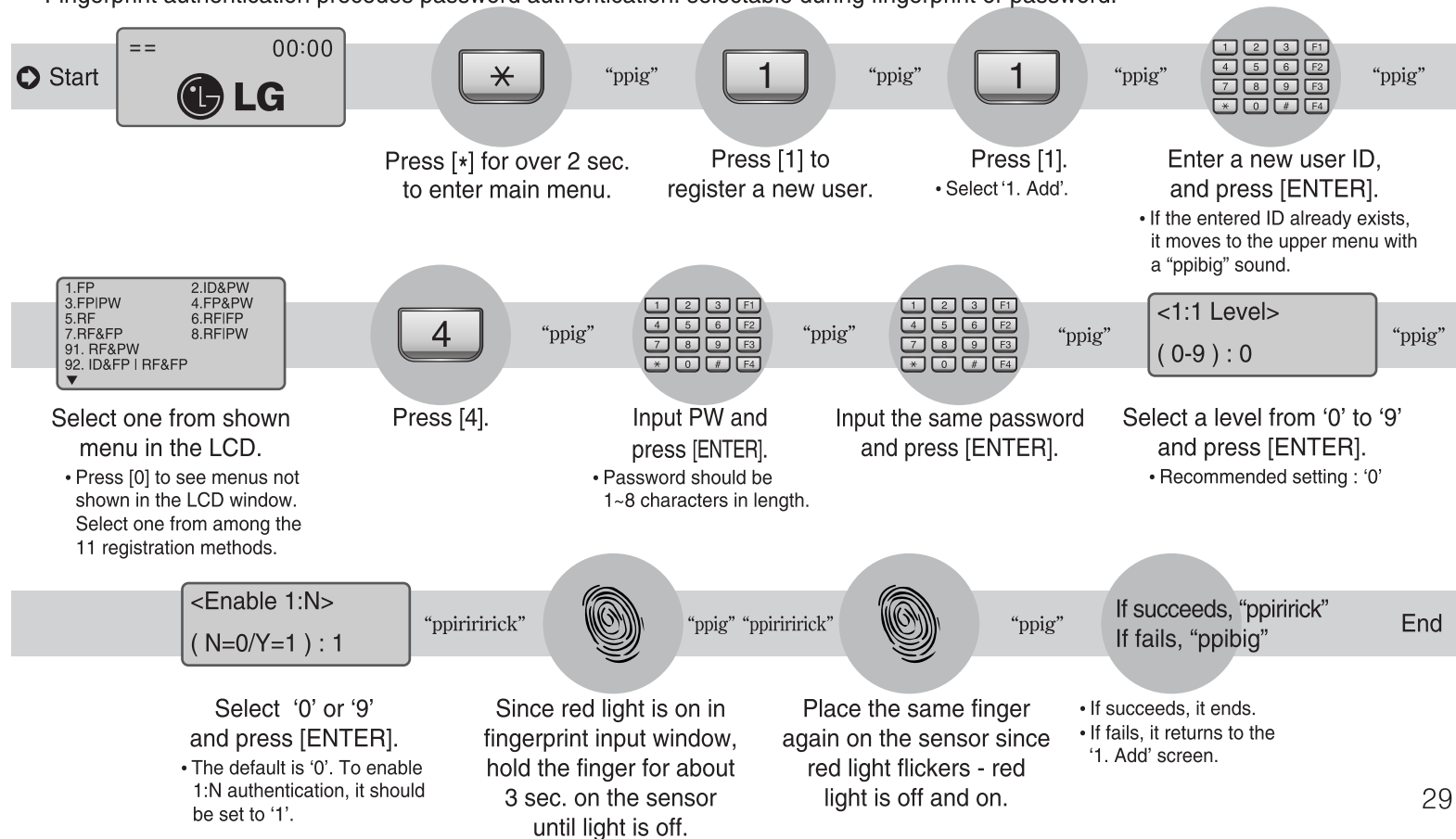

3. Configuration settings

3.3.1.5. '5. RF' registration

Card registration and card authentication.

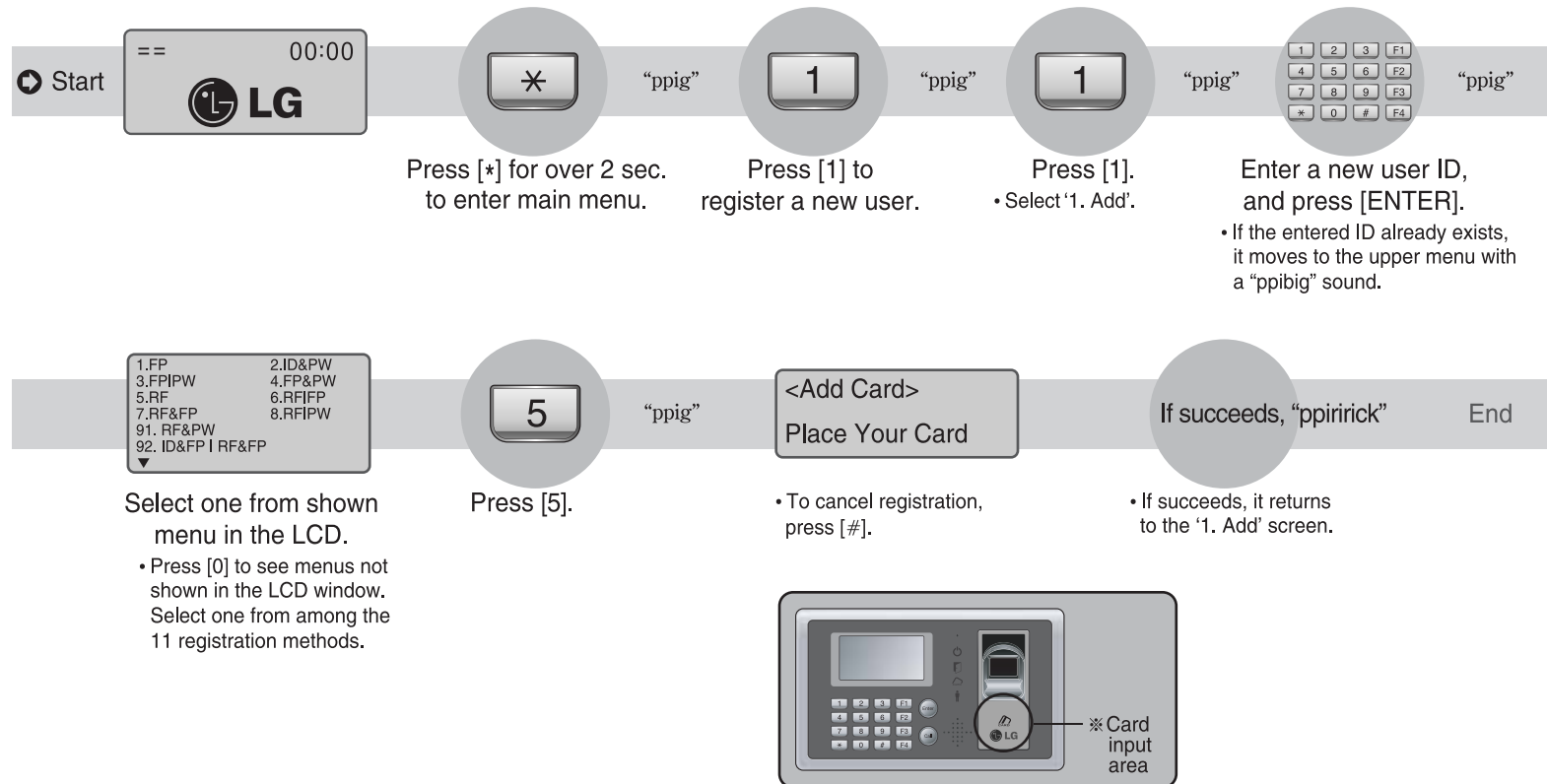

3. Configuration settings

3.3.1.6. '6. RFIFP' registration

□ After both card and fingerprint are registered, authentication method is selectable during card or fingerprint.

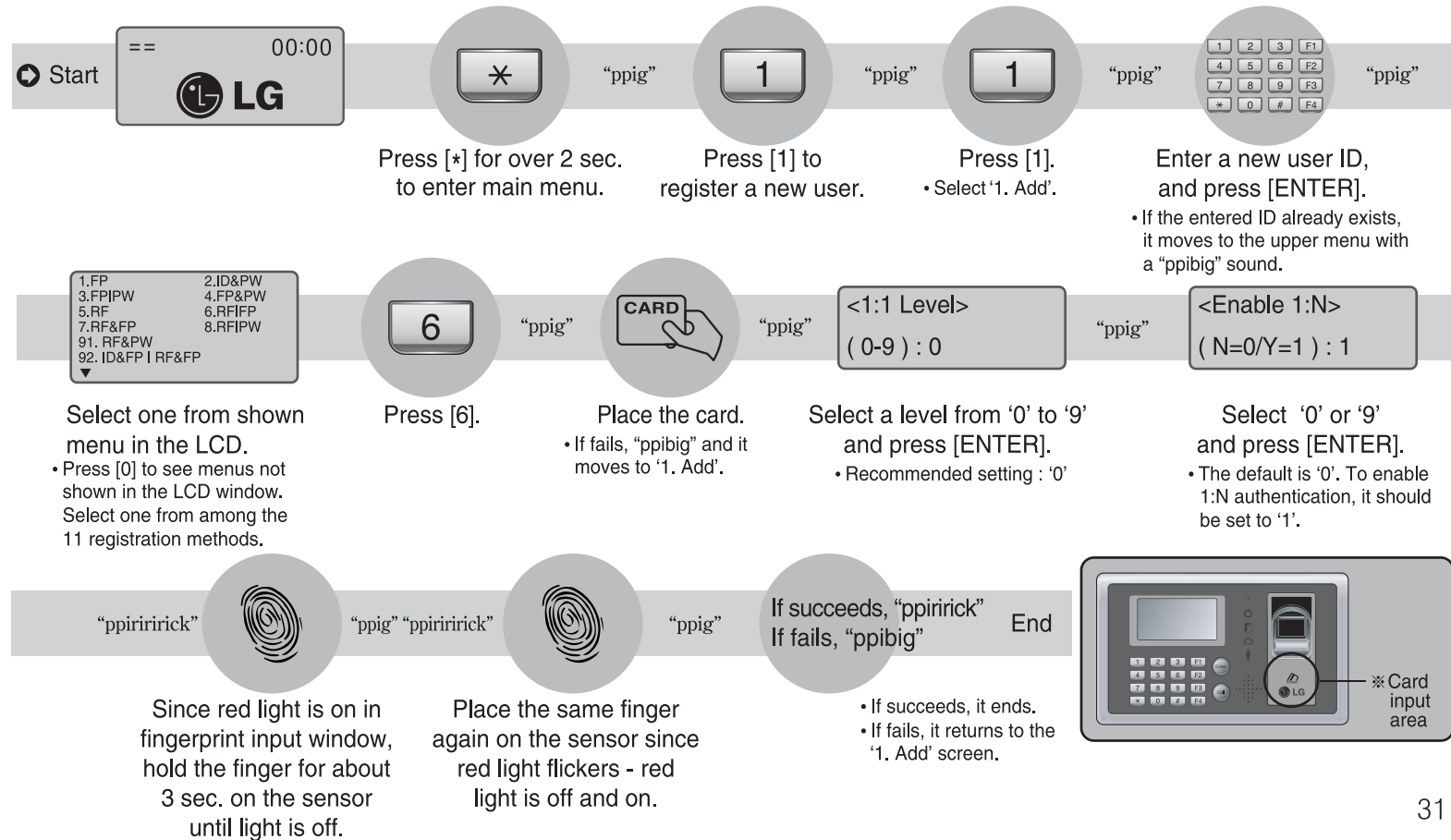

3. Configuration settings

3.3.1.7. '7. RF&FP' registration

- After both card and fingerprint are registered, card authentication and fingerprint authentication should be done for access.
Card authentication precedes fingerprint authentication.

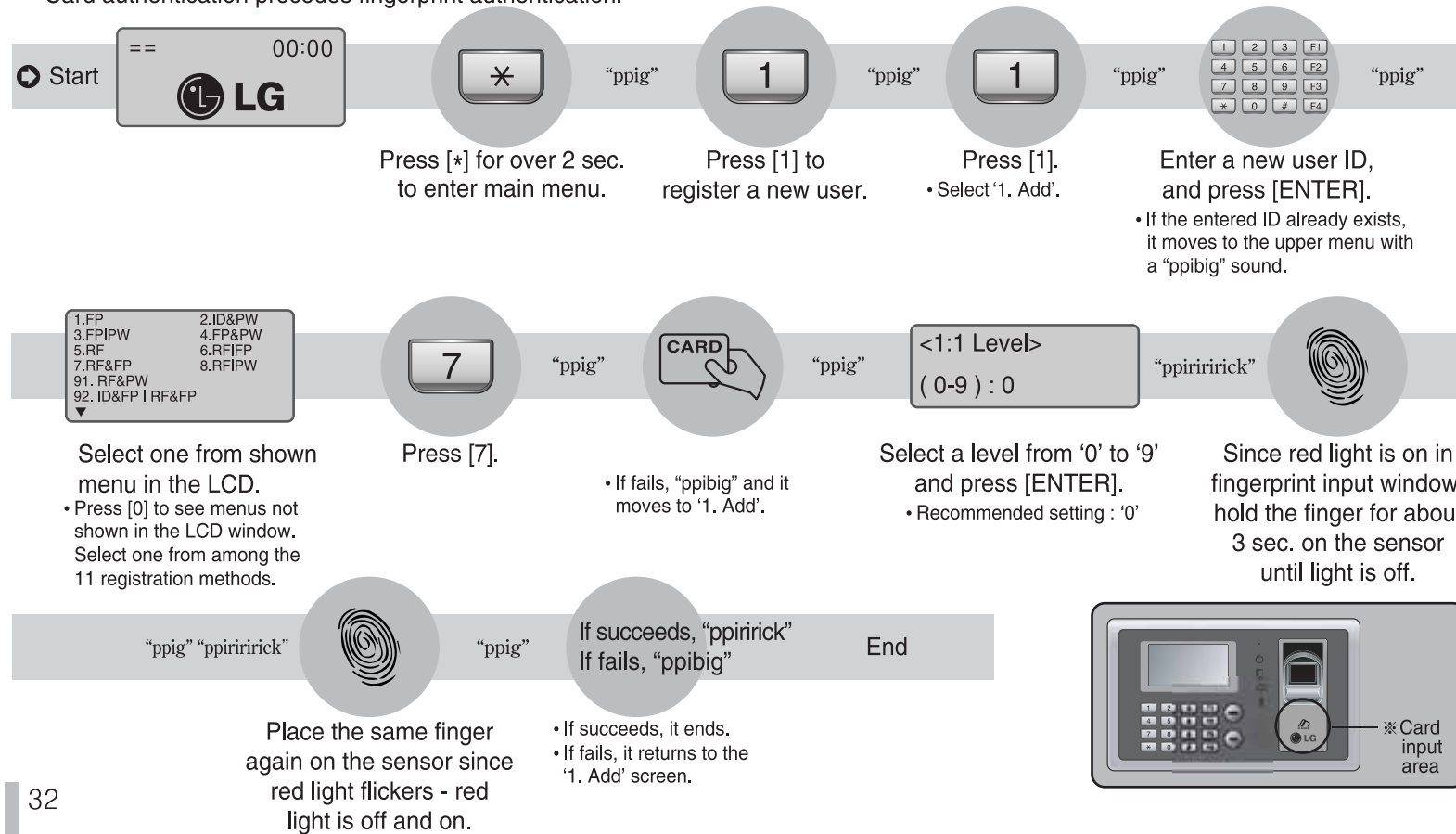

3. Configuration settings

3.3.1.8. '8. RFIPW' registration

□ After both card and password are registered, authentication method is selectable during card or password.

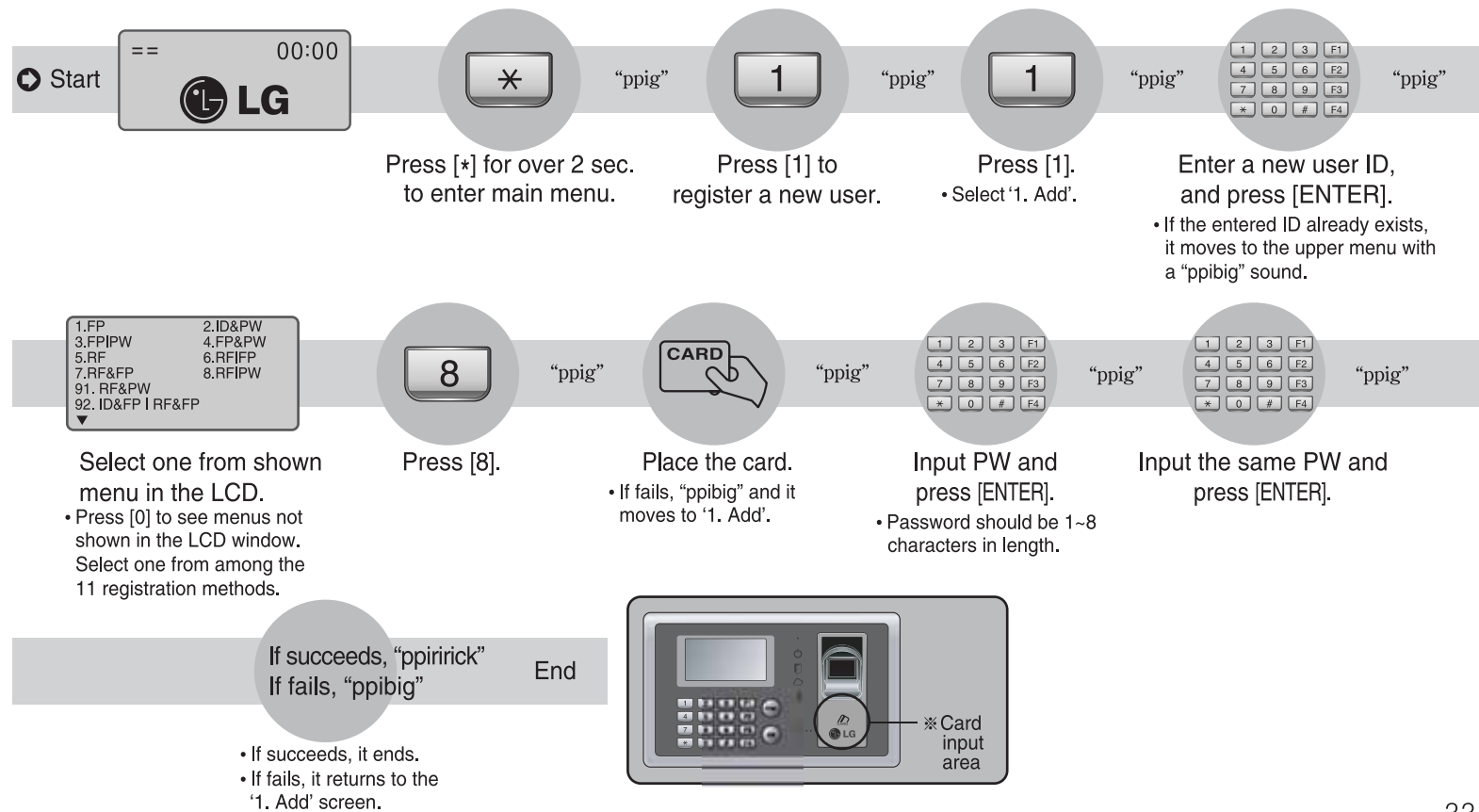

3. Configuration settings

3.3.1.9. '91. RF&PW' registration

- After both card and password are registered, card authentication and password authentication should be done for access.
Card authentication precedes password authentication.

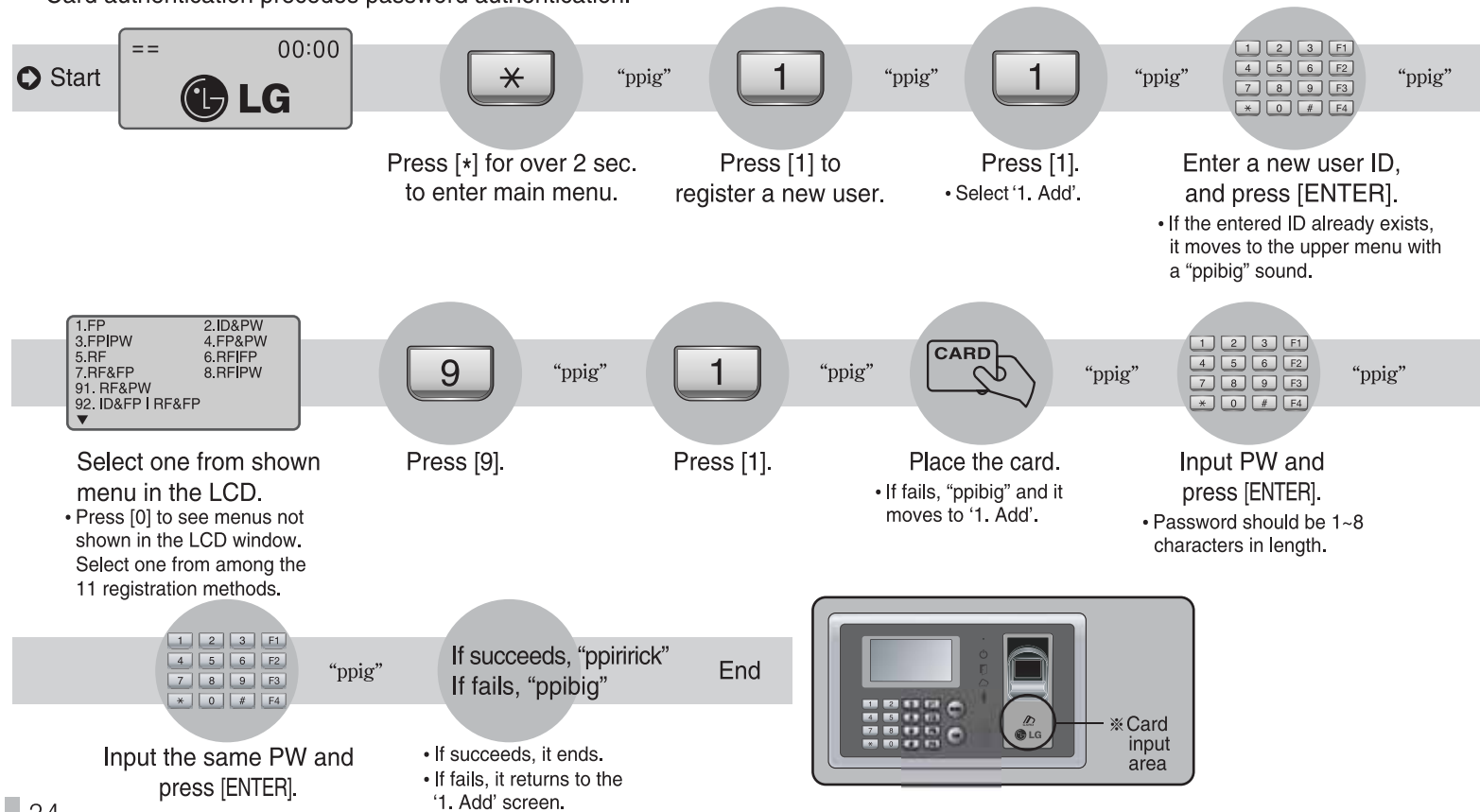

3. Configuration settings

3.3.1.10. '92. ID&FPIRF&FP' registration

- After both card and fingerprint are registered, authentication method is selectable during ID and fingerprint authentication or card and fingerprint authentication.
- If a user feels difficult in inputting ID, a card can be used instead of ID input for authentication.

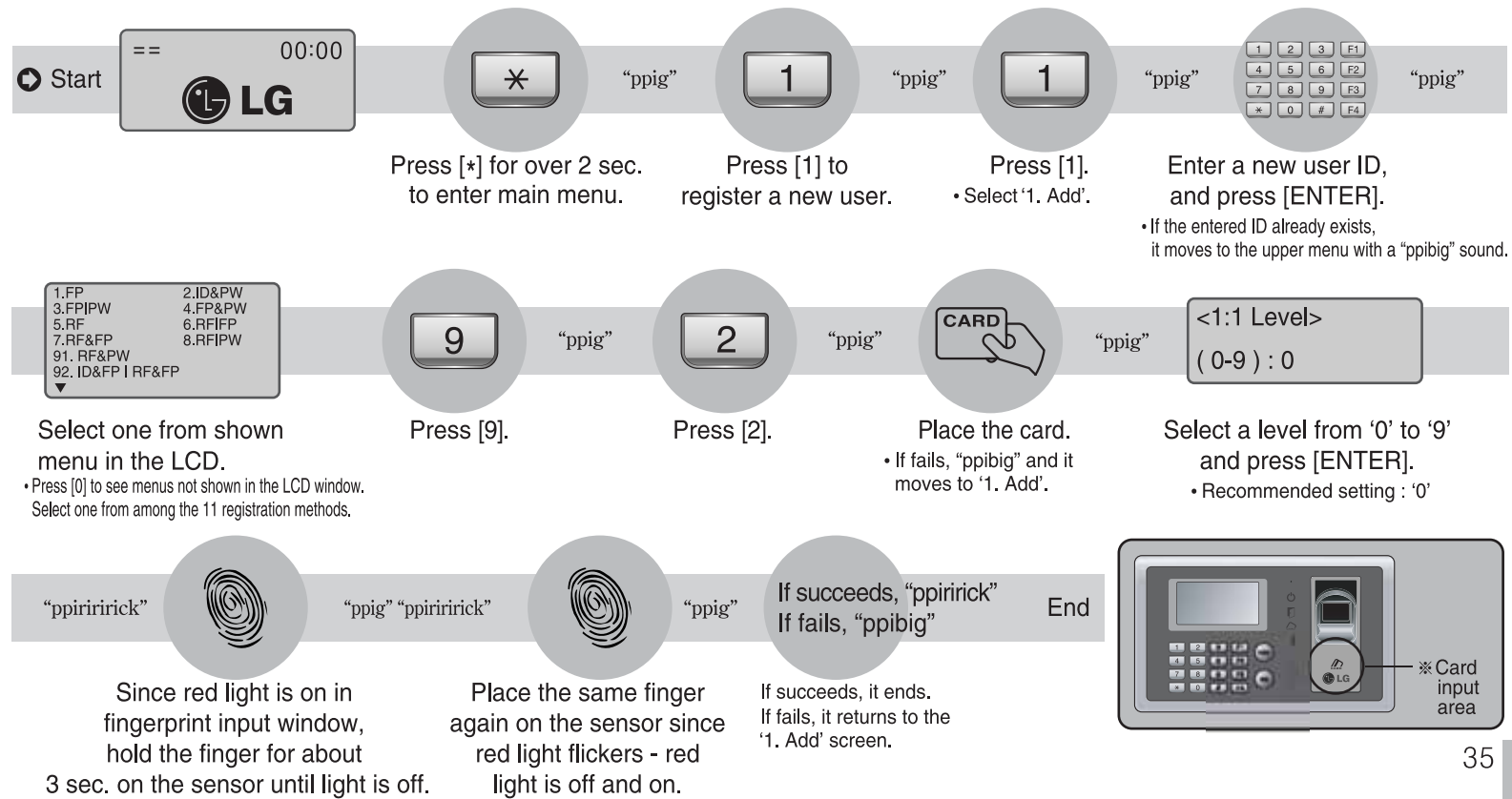

3. Configuration settings

3.3.1.11. '93. ID&PWIRF&PW' registration

- After both card and password are registered, authentication method is selectable during ID and password authentication or card and password authentication.
- If a user feels difficult in inputting ID, a card can be used instead of ID input for authentication.

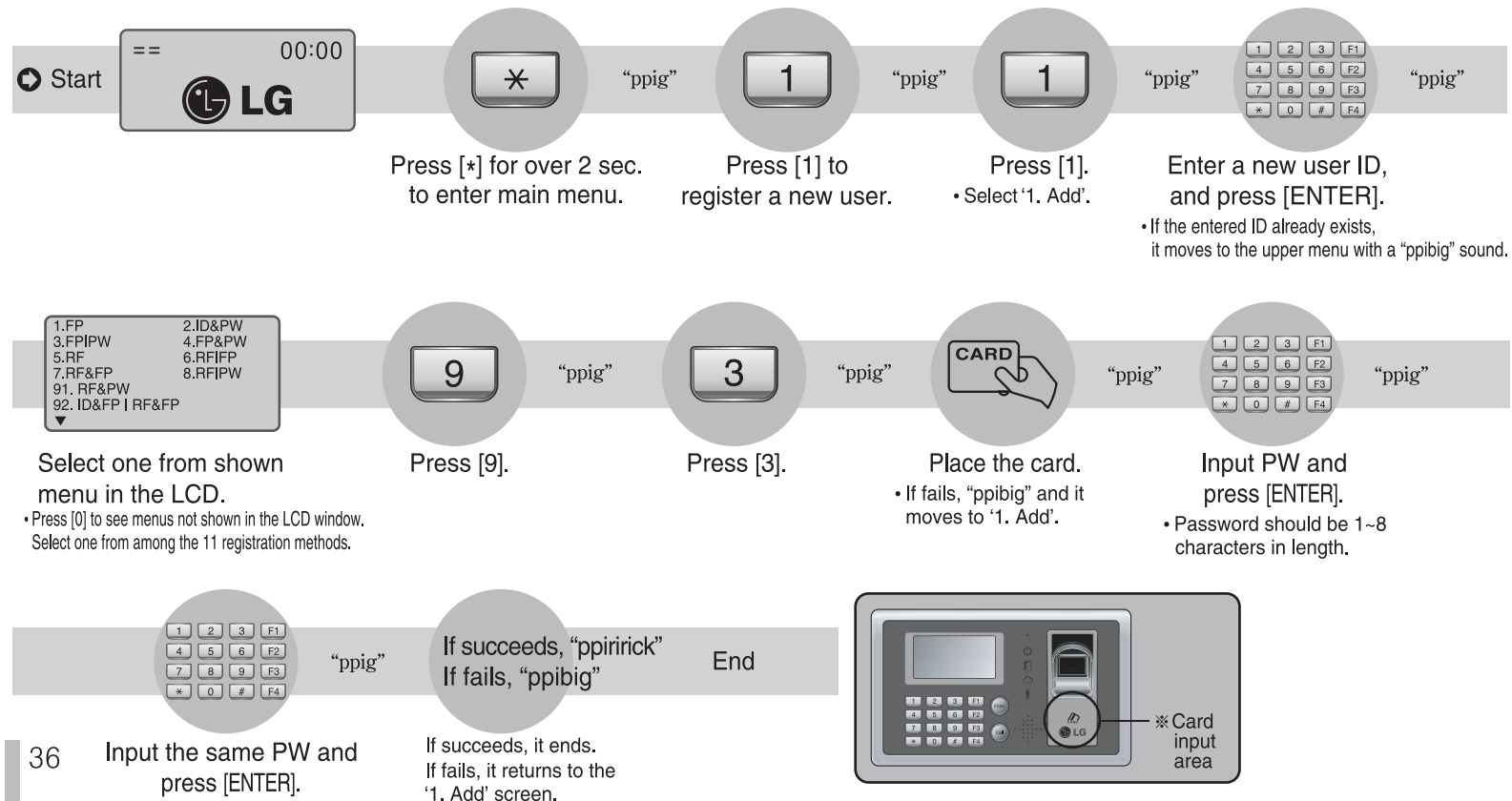

3. Configuration settings

3.3.2. Deleting User

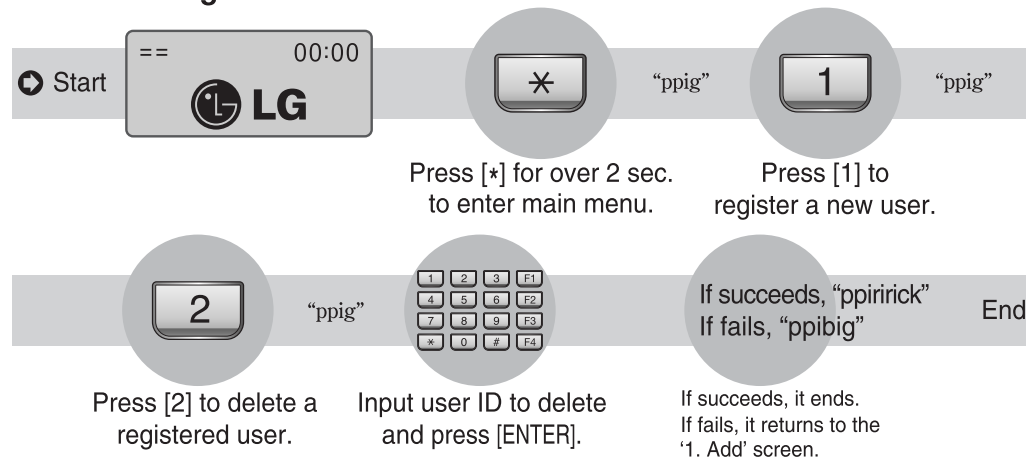

※ After entering the user ID to be deleted, press [ENTER]. All the information about the user in the local terminal is deleted together with a "ppiririck" buzzer sound. However, the information about the user is still stored in the server. To completely delete this information, the data in the server should be deleted.

※ If a non-registered user ID is entered, '2.Delete' appears together with a "ppibig" sound.

1. Add
2. Delete
3. Modify
4. Add Admin
5. Delete All

※ Caution is required when deleting a user or an administrator as there is no differential procedure for deleting their information. Also, carefully note that user's information stored just in the local terminal-not in the server-is not recoverable after deletion is completely done.

3. Configuration settings

3.3.3. Modifying User

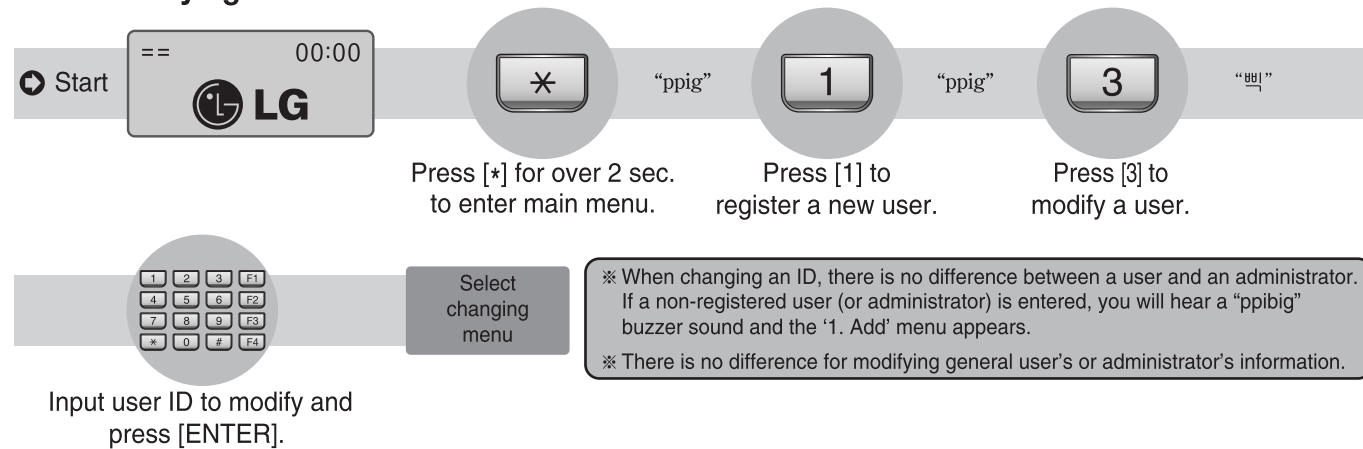

3.3.3.1. ‘1. FP’ user

1. 1:1 Level
2. Add FP

<1:1 Level>
(0-9) : 0

<Add FP>
Input Your FP

Default screen ◀[*] ▶[1] ▶[3] ▶[ID]+[ENTER] ▶[Select changing menu]

- To change the authentication level, press [1]. To add a fingerprint to the corresponding ID, press [2].
- A maximum of 5 fingerprints can be added to an ID. If there is an attempt to add more than 5 fingerprints, a “ppibig” buzzer sound rings when [2] is pressed.
- ‘Fingerprint registration’ user
 - 1) When modifying 1:1 authentication level is selected.
 - Recommended setting : ‘0’
 - To change this value, press the [#] to delete the current value and enter the new value.
 - 2) When registering additional fingerprints is selected.
 - This is same as ‘Add FP’ in 3.3.1.1. ‘1. FP’ registration. The same fingerprint must be inputted twice.
 - If additional fingerprint registration succeeds, a “ppiririck” buzzer sound rings. If not, a “ppibig” buzzer sound rings and the ‘1. Add’ menu appears.

3. Configuration settings

3.3.3.2. '2. ID&PW' user

1. Modify PW

Default screen ◂[*] ◂[1] ◂[3] ◂[ID]+[ENTER] ◂
[Select changing menu]

<Input PW >
PW:_____

<Confirm PW>
PW:_____

- To modify a password, press [1].
 - Input password. Password should be 1~8 characters in length.
 - Press [ENTER] after inputting the password.
 - Input the same password once more for confirmation.
 - Press [ENTER] to confirm the password.
- To cancel this operation, press [#].
- If password modification succeeds, a “ppirrick” buzzer sound rings. If not, a “ppibig” buzzer sound rings and the “1. Add” menu appears.

3.3.3.3. '3. FPIPW', '4. FP&PW' user

1. 1:1 Level
2. Add FP
3. Modify PW

Default screen ◂[*] ◂[1] ◂[3] ◂[ID]+[ENTER] ◂
[Select changing menu]

- Press [1] to modify the 1:1 Level (refer to '3.3.3.1').
- Press [2] to register additional fingerprints (refer to '3.3.3.1').
- Press [3] to modify password (refer to '3.3.3.2').
- To cancel, press [#].

3. Configuration settings

3.3.3.4. '5. RF' user

1. Change Card

Default screen ◂[*] ◂[1] ◂[3] ◂[ID]+[ENTER] ◂[Select changing menu]

- To change the card, press [1].
- To cancel, press [#].

Change Card>
Place Your Card

- If a user places the card close to the unit, a “ppirick” buzzer sound in case of successful modification rings and the ‘1. Add’ menu appears.

3.3.3.5. '6. RFIFP', '7. RF&FP', '92. ID&FPIRF&FP' user

1. 1:1 Level
2. Add FP
3. Change Card

Default screen ◂[*] ◂[1] ◂[3] ◂[ID]+[ENTER] ◂[Select changing menu]

- Press [1] to modify the 1:1 Level (refer to '3.3.3.1').
- Press [2] to register additional fingerprints (refer to 3.3.3.1).
- Press [3] to change the card (refer to '3.3.3.4').
- To cancel, press [#].

3.3.3.6. '8. RFIPW', '91. RF&PW', '93. ID&PWIRF&PW' user

1. Modify PW
2. Change Card

Default screen ◂[*] ◂[1] ◂[3] ◂[ID]+[ENTER] ◂[Select changing menu]

- Press [1] to modify password (refer to '3.3.3.2').
- Press [2] to change the card (refer to '3.3.3.4').
- To cancel, press [#].

3. Configuration settings

3.3.4. Administrator registration

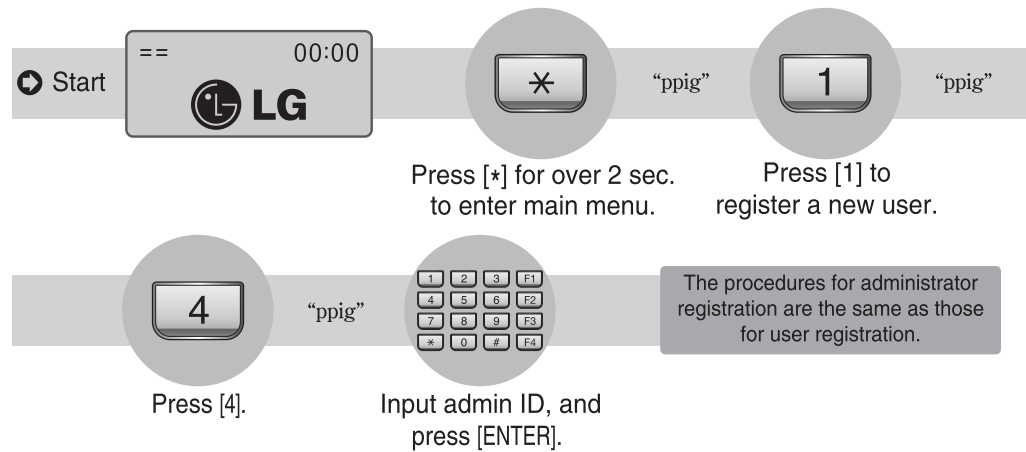

※ ID basically consists of four digits and is changable from two digits to eight digits at '3.8.5. System configuration setting'.

※ Be careful to register new administrator as the registered administrator can change the terminal configuration settings including registration/modification/deletion of user information.