

## Installing the SIM and battery

### Install the SIM card

Slide the SIM card into the SIM card holder. Make sure that the gold contact area on the card is facing downwards. To remove the SIM card, pull it gently in the reverse direction.

**WARNING:** Do not replace or remove the SIM card while your phone is being used or turned on.

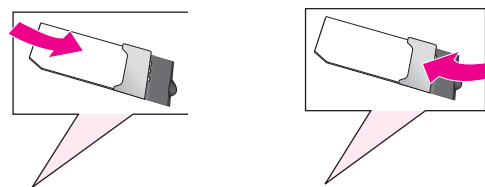

### Removing the Battery

1. With your phone turned off, push forward from the bottom of the battery cover (1) on the back of your phone, slide the battery cover up and lift off (2).



2. Lift the battery up (1) and away (2) from the phone, as shown.



**WARNING:** Do not remove the battery when the phone is switched on, as this may damage the phone.

### Charging your phone

Pull out the cover of the charger socket on the left side of your LG320G. Plug in the charger and plug the other end into a wall socket. Your LG320G will need to be charged until a message reading "Battery full" appears on screen.



## Icon Description

Your phone displays the following status indicators on the top of the screen:

- Indicates the strength of the network signal.
- Indicates that GPRS service is available.
- Indicates the status of the battery charge.
- Indicates a call is in progress.
- Indicates the alarm has been set and is on.
- Indicates a Calendar event for the day.
- Indicates the receipt of a message.
- Indicates the receipt of a voicemail message.
- Indicates Ring has been set as the Ringtone volume.
- Indicates Silent has been set as the Ringtone volume.
- Indicates Vibration has been set as the Ringtone volume.
- Indicates the TTY has been set and is on.

- Depending on the software installed or your service provider or country, some of the descriptions in this guide may not match your phone exactly.
- Depending on your country, your phone and accessories may appear different from the picture in this guide.

P/N: MHK63465601 (1.0) H  
Printed in China

## Phone layout and key functions

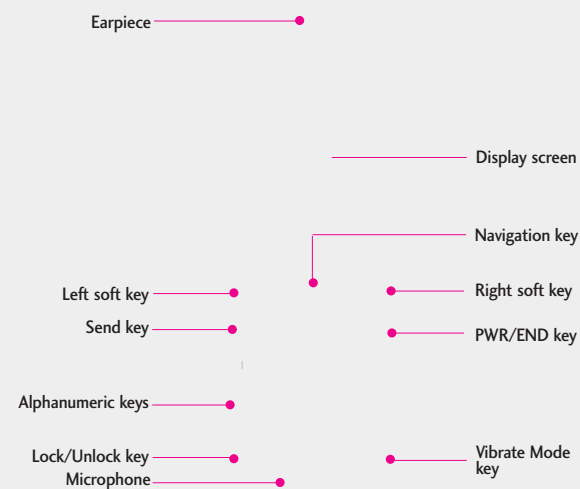

### Phone features include:

- Easy-to-read, LCD with status icons.
- Messaging, voice mail, and caller ID.
- 17-key keypad.
- Speakerphone feature.
- Menu-driven interface with prompts for easy operation and configuration.
- Any Key answer, Auto Redial, One-Touch dial and Speed Dial (with 9 locations).
- Bilingual (English and Spanish) capabilities.
- Internal Antenna.

### Display

Idle mode is when you are not on a call or using a menu. You must be in Idle mode to enter a phone number to dial.

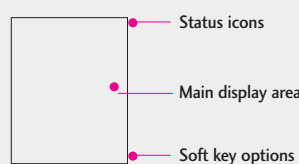

### Turning the Phone On or Off

1. To turn on, install a charged battery.
2. Then press **END** until the LCD screen lights up.
3. To turn off, press and hold **END** until the display turns off.

### Changing the display language

Allows you to use the bilingual feature according to your preference. Choose between English and Spanish.

1. In Idle mode, press the Left soft key **Menu**.
2. Select **ENG** → **4 GH** → **2 ABC**.
3. Use **Navigation** to select **Automatic**, **English** or **Español**, then press **OK**.

### Making Calls

1. Make sure the phone is turned on.
2. Enter the phone number (include the area code if needed).
3. Press **SEND** to dial.
4. Press **END** to end the call.

### Recent Calls

The Recent Calls Menu is a list of the last phone numbers or Contacts entries for calls missed, received, or dialed. It is continually updated as new numbers are added to the beginning of the list and the oldest entries are removed from the bottom of the list.

**Note:** To view a quick list of all your recent calls, press **SEND** Key while in standby mode.

1. Call Logs : Allows you to view the list of the most recent missed, received and dialed calls.  
Press Left Soft Key **Menu**, **4 GH**, **1 CD**
2. Missed Calls : Allows you to view a list of the most recent missed calls.  
Press Left Soft Key **Menu**, **4 GH**, **2 ABC** → Use **Navigation** to highlight an entry.
3. Received Calls : Allows you to view a list of the most recent received calls.  
Press Left Soft Key **Menu**, **4 GH**, **3 DEF** → Use **Navigation** to highlight an entry.
4. Dialed Numbers : Allows you to view a list of the most recent dialed calls.  
Press Left Soft Key **Menu**, **4 GH**, **4 GH** → Use **Navigation** to highlight an entry.
5. Call duration : Allows you to view the duration of the calls, by type.  
Press Left Soft Key **Menu**, **4 GH**, **5 JKL** → Use **Navigation** to highlight one of the call types (below).  
Last Call/ Dialed Calls/Received Calls/ All Calls

### Profiles

Options to customize your phone's sounds:

1. Press the Left Soft Key **Menu**, **5 MNO**.
2. Use **Navigation** to highlight the profile type.
3. Press the Left Soft Key **Options**.

Select to set the ringtone to your phone.

Edit to set Voice ringtone, Ring volume, Message tone, Message volume, Message alert, Vibrate alert, Key tone, Key tone volume, Confirmation tone, Start-up sound, Select start-up sound, or Select shut down sound.

View to check the customized settings.

### Using the menus

Selecting or Modifying a Menu or Feature :

1. Press the Left soft key **Menu** to access Main menu.
2. Use the Navigation keys **Navigation** to reach a desired menu and then press the Right soft key **OK**.
3. If the menu contains any submenus, locate the one you want by using the Navigation keys **Navigation**. Press the Right soft key **OK** to enter the submenu.

If the selected menu contains additional submenus, repeat this step.

## Menu map

### 1. Prepaid

- 1.1 Add Airtime
- 1.2 Buy Airtime
- 1.3 My Phone Number
- 1.4 Airtime Info.
- 1.5 Airtime Display
- 1.6 Serial Number
- 1.7 SIM Number
- 1.8 Code Entry Mode

### 2. Contacts

- 2.1 Names
- 2.2 Settings
- 2.3 Speed dials
- 2.4 Service dial number
- 2.5 Own Number
- 2.6 My Business Card

### 3. Messages

- 3.1 Create message
- 3.2 Inbox
- 3.3 Drafts
- 3.4 Outbox
- 5.5 Message settings

### 4. Recent Calls

- 4.1 Call Logs
- 4.2 Missed Calls
- 4.3 Received Calls
- 4.4 Dialed Number
- 4.5 Call Duration

### 5. Games

- 5.1 Sudoku
- 5.2 ZooZooClub

### 6. Profiles

- 6.1 Normal
- 6.2 Silent
- 6.3 Outdoor
- 6.4 Flight mode
- 6.5 Customised1
- 6.6 Customised2
- 6.7 Customised3

### 7. Tools

- 7.1 Calculator
- 7.2 Stop Watch
- 7.3 Converter
- 7.4 World time

### 8. Organiser

- 8.1 Alarm clock
- 8.2 Calendar
- 8.3 Notes
- 8.4 Secret Notes
- 8.5 Date Finder

### 9. Settings

- 9.1 Display
- 9.2 Date & Time
- 9.3 Call
- 9.4 Phone
- 9.5 Security
- 9.6 Memory Info.
- 9.7 Restore factory settings

## Entering text

In a text input field, press the key to toggle between capitalization and **123** modes. To switch between **T9word** mode and **ABC** mode, press and hold the key. To access Symbols, press and select **Symbols**.

### Using T9Word mode

- Press **2** to **9** to start entering a word. Press each key once for one letter. The word you are entering appears on the display. Options may change with each keypress.

For example: To enter “Hello” in **T9Word** mode, press **4**, **3**, **5**, **5**, and **6**.

- Press to insert a space and enter the next word.

### Using ABC mode

Press the keys labeled with the letter you want once for the first letter, twice for the second letter, and so on.

For example, press three times to enter “C” and two times to enter “K”.

### Using 123 mode

Press the keys that correspond with the digits you want to enter.

### Using Symbols mode

Use the navigation keys to find the symbol you want and press OK. Only some of the symbols available can be displayed at one time, scroll down to display more symbols.

### Tips for entering text

- To move the cursor, use the navigation keys .
- To delete characters one by one, press the Left soft key Clear. To delete all of the characters, press and hold the Left soft key Clear.
- To insert a space between characters, press .
- To enter punctuation in **T9Word** mode or **ABC** mode, press .

## Sending an SMS message

Allows you to send text and email messages.

- Press **Menu**, and **New Message**.
- Enter your message.
- Press the Right soft key **Options**.
- Highlight **Send To** and press the Right soft key **OK**.
- Enter the number or address.
  - Press the Right soft key **Options** to import a Contact already saved in your Contacts List.
- Press the Right soft key **Options**.
- Highlight **Send** and press the Right soft key **OK** to send the message.

## Quick feature reference

This section provides instructions on how to access some of your phone's features (Not all options are listed below).

Menu	Description
,  ,	Service dial number
,  ,	Own Number
,  ,	My Business Card allows you to view, enter and edit more of your personal Contact information, including name and phone numbers. You can also send this Business Card via Text Message.
,  ,	Create message
,  ,	Inbox allows you to view your received messages.
,  ,	Drafts allows you to view the saved (message) Drafts.
,  ,	Outbox
,  ,	Message Settings allows you to configure settings for Messaging.
,  ,	Call Logs
,  ,	Missed Calls allows you to view the list of missed calls.
,  ,	Received Calls allows you to view the list of received calls.
,  ,	Dialed Number
,  ,	Call Duration allows you to view the duration of calls by call type.
,	Games
,	Profiles
,  ,	Add Airtime allows you to start an over-the-air request for additional airtime.
,  ,	Buy Airtime allows you to start an over-the-air request to purchase additional airtime.
,  ,	My Phone Number displays the phone's phone number.
,  ,	Airtime Info. displays the airtime balance and due date information.
,  ,	Airtime Display allows you to disable/enable the display of Balance and Due Date info on the idle screen.
,  ,	Serial Number simply displays the phone's serial number.
,  ,	SIM Number
,  ,	Code Entry Mode will allow the phone to accept Tracfone-related codes in order to add units, modify specific data and troubleshoot the phone. In using the Code Entry Mode, you can't receive incoming calls or use events alert.
,  ,	Names
,  ,	Settings
,  ,	Speed dials

Menu	Description
,  ,	Service dial number
,  ,	Own Number
,  ,	My Business Card allows you to view, enter and edit more of your personal Contact information, including name and phone numbers. You can also send this Business Card via Text Message.
,  ,	Create message
,  ,	Inbox allows you to view your received messages.
,  ,	Drafts allows you to view the saved (message) Drafts.
,  ,	Outbox
,  ,	Message Settings allows you to configure settings for Messaging.
,  ,	Call Logs
,  ,	Missed Calls allows you to view the list of missed calls.
,  ,	Received Calls allows you to view the list of received calls.
,  ,	Dialed Number
,  ,	Call Duration allows you to view the duration of calls by call type.
,	Games
,	Profiles

Menu	Description
,  ,	Calculator allows you to perform simple mathematical calculations.
,  ,	Stop Watch allows you to use your phone as a stopwatch.
,  ,	Converter allows you to convert units of Currency, Area, Length, Weight, Temperature, Volume and Velocity.
,  ,	World Clock allows you to determine the current time in another time zone or city.
,  ,	Alarm Clock allows you to set up to five alarms. At the alarm time, any set alarm will sound (depending on your Master Volume settings) the tone of your choice, and an alarm message will be displayed on the LCD screen.
,  ,	Calendar allows you to access your Calendar appointments. Simply enter your appointments in the Calendar, and your phone can alert you with a reminder.
,  ,	Notes
,  ,	Secret Notes
,  ,	Date Finder
,  ,	Options to customize your phone's display. <ol style="list-style-type: none"> <li>1.1 Wallpapers</li> <li>1.2 Dialing</li> <li>1.3 Backlight</li> </ol>
,  ,	Date & Time allows you to select your display preferences. <ol style="list-style-type: none"> <li>2.1 Time</li> <li>2.2 Date</li> <li>2.3 Auto update date/time</li> <li>2.4 Daylight saving</li> </ol>

Menu	Description
,  ,	Call allows you to select your display preferences. <ol style="list-style-type: none"> <li>3.1 Call divert</li> <li>3.2 Fixed Dial Numbers</li> <li>3.3 Call waiting</li> <li>3.4 Send My Number</li> <li>3.5 Auto Redial</li> <li>3.6 Answer mode</li> <li>3.7 Minute Minder</li> <li>3.8 Save new number</li> </ol>
,  ,	Phone allows you to select your display preferences. <ol style="list-style-type: none"> <li>4.1 Auto keylock</li> <li>4.2 Language</li> <li>4.3 Power Save</li> <li>4.4 Handset Information</li> </ol>
,  ,	Security allows you the electronically secure your phone. <ol style="list-style-type: none"> <li>5.1 PIN Code Request</li> <li>5.2 Handset lock</li> <li>5.4 FLock If SIM is Changed</li> <li>5.4 Change Codes</li> </ol>
,  ,	Memory Info. allows you to select your display preferences. <ol style="list-style-type: none"> <li>6.1 Handset reserved memory</li> <li>6.2 SIM memory</li> </ol>
,  ,	Restore factory settings allows you to select your display preferences. <ol style="list-style-type: none"> <li>7.1 Settings only</li> <li>7.2 Date &amp; settings</li> </ol>

## Part 15.21 statement

"Change or Modifications that are not expressly approved by the manufacturer could void the user's authority to operate the equipment."

## Part 15.105 statement

This equipment has been tested and found to comply with the limits for a class B digital device, pursuant to Part 15 of the FCC Rules.

These limits are designed to provide reasonable protection against harmful interference in a residential installation.

This equipment generates uses and can radiate radio frequency energy and, if not installed and used in accordance with the instructions, may cause harmful interference to radio communications.

However, there is no guarantee that interference will not occur in a particular installation.

If this equipment does cause harmful interference or television reception, which can be determined by turning the equipment off and on, the user is encouraged to try to correct the interference by one or more of the following measures:

- Reorient or relocate the receiving antenna.
- Increase the separation between the equipment and receiver.
- Connect the equipment into an outlet on a circuit different from that to which the receiver is connected.
- Consult the dealer or an experienced radio/TV technician for help.

## Part 15 Class B Compliance

This device and its accessories comply with part15 of FCC rules.

Operation is subject to the following two conditions:

- (1) This device & its accessories may not cause harmful interference.
- (2) This device & its accessories must accept any interference received, including interference that may cause undesired operation.

## Body-worn Operation

This device has been tested for typical body-worn operations with the distance of 0.79inches (2.0cm) from the user's body. To comply with FCC RF exposure requirements, a minimum separation distance of 0.79inches(2.0cm) must be maintained from the user's body. For example, this device must be maintained from the user's body with an appropriate belt-clip accessory. Additionally, Belt clips, holsters & other body-worn accessories may not contain metallic components.