



ENGLISH

SIMPLE MANUAL

Multimedia Speaker System

Please read this manual carefully before operating your set and retain it for future reference.
To view the instructions of advanced features, visit <http://www.lg.com> and then download Owner's Manual. Some of the content in this manual may differ from your unit.

MODEL
LK72B



www.lg.com
Copyright © 2019 LG Electronics Inc. All Rights Reserved.
1805_Rev01



Front Panel

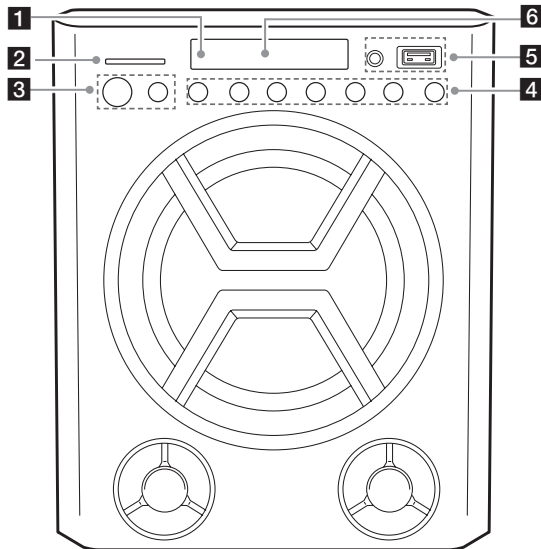

1 Remote sensor

2 SD card slot

You can play sound files by connecting the SD card.

3 (Standby)

Turns the power on or off.

F (Function)

Selects the function and input source.

4 **VOL** (Volume) **-/+**

Adjusts speaker volume.

(Skip/Search)

- Skips backward or forwards.

- Searches for a section within a file.

- Selects the radio stations.

(Play/Pause)

Starts or pauses playback.

BASS **-/+**

Adjusts bass level.

5 USB port

You can play sound files by connecting the USB device.

PORT. (Portable) **IN**

Connect a portable device.

6 Display window

Rear Panel

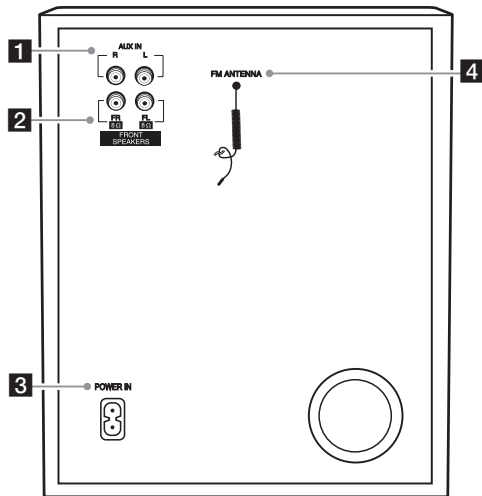

Speaker Connection

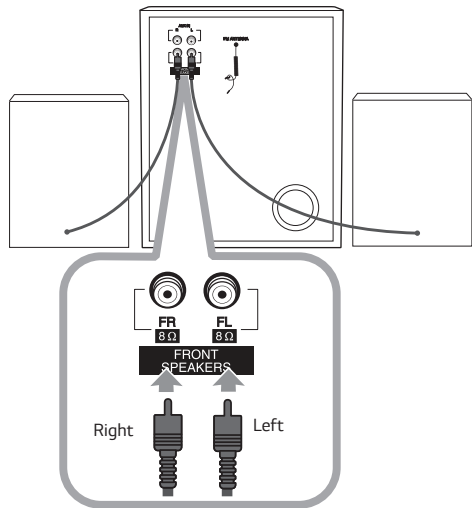

1 AUX IN (L/R)

Connect an auxiliary device.

2 FRONT SPEAKERS (FL/FR) connector

3 POWER IN

4 FM ANTENNA

Additional information

LED Display table

LED displays and descriptions are as follows.

LED Display	Description
HELLO	HELLO
BYE	BYE
USB	USB
Sd	SD
AUX AUDIO	AUX
🔊 PORTABLE AUDIO	PORTABLE
📶 bt	BT
87.50	FM (Displays current radio frequency)
READ	READ
PAUSE	PAUSE
ONE	ONE
ALL	ALL
RAND	RANDOM
DEL ALL	DEL ALL
DELETED ALL	DELETED ALL
NO USB	NO USB
NO Sd	NO SD
NO SONG	NO SONG
NOT SUPPORT	NOT SUPPORT

Specifications

Power Requirements	Refer to the main label on the unit.
Power Consumption	Refer to the main label on the unit.
Dimensions (W x H x D)	Approx. 196.0 mm x 239.0 mm x 205.0 mm (7.7 inch x 9.4 inch x 8.1 inch)
Bus Power Supply (USB)	5 V  500 mA
Amplifier (Total RMS output power)	40 W RMS

Design and specifications are subject to change without notice.

Replacement of battery

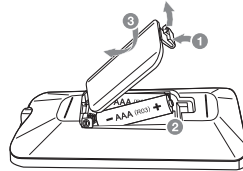

FCC Compliance Statement

This equipment has been tested and found to comply with the limits for a Class B digital device, pursuant to Part 15 of the FCC Rules. These limits are designed to provide reasonable protection against harmful interference in a residential installation. This equipment generates, uses, and can radiate radio frequency energy and, if not installed and used in accordance with the instructions, may cause harmful interference to radio communications. However, there is no guarantee that interference will not occur in a particular installation. If this equipment does cause harmful interference to radio or television reception, which can be determined by turning the equipment off and on, the user is encouraged to try to correct the interference by one or more of the following measures:

- Reorient or relocate the receiving antenna.
- Increase the separation between the equipment and the receiver.
- Connect the equipment to an outlet on a circuit different from that to which the receiver is connected.
- Consult the dealer or an experienced radio/TV technician for help.

This device complies with part 15 of the FCC Rules. Operation is subject to the following two conditions:
(1) this device may not cause harmful interference and
(2) this device must accept any interference received, including interference that may cause undesired operation. Any changes or modifications in construction of this device which are not expressly approved by the party responsible for compliance could void the user's authority to operate the equipment.

FCC RF Radiation Exposure Statement: This equipment complies with FCC radiation exposure limits set forth for an uncontrolled environment. This transmitter must not be co-located or operating in conjunction with any other antenna or transmitter.

This equipment should be installed and operated with minimum distance 20 cm (7.8 inches) between the antenna and your body. Users must follow the specific operating instructions for satisfying RF exposure compliance.

Supplier's Declaration of Conformity

Trade Name	LG
Responsible Party	LG Electronics USA, Inc.
Address	1000 Sylvan Ave Englewood Cliffs, NJ 07632
Telephone	(201)266-2215

Industry Canada Statement

[For having wireless function (WLAN, Bluetooth,...)]

This device contains licence-exempt transmitter(s)/ receiver(s) that comply with Innovation, Science and Economic Development Canada's licence-exempt RSS(s). Operation is subject to the following two conditions:

- (1) This device may not cause interference.
- (2) This device must accept any interference, including interference that may cause undesired operation of the device.

CAN ICES-3 (B)/NMB-3 (B)

IC Radiation Exposure Statement

[For having wireless function (WLAN, Bluetooth,...)]

This equipment complies with IC radiation exposure limits set forth for an uncontrolled environment. This equipment should be installed and operated with minimum distance 20 cm (7.8 inches) between the antenna & your body.

NOTE: THE MANUFACTURER IS NOT RESPONSIBLE FOR ANY RADIO OR TV INTERFERENCE CAUSED BY UNAUTHORIZED MODIFICATIONS TO THIS EQUIPMENT. SUCH MODIFICATIONS COULD VOID THE USER'S AUTHORITY TO OPERATE THE EQUIPMENT.

L'émetteur/récepteur exempt de licence contenu dans le présent appareil est conforme aux CNR d'Innovation, Sciences et Développement économique Canada applicables aux appareils radio exempts de licence. L'exploitation est autorisée aux deux conditions suivantes :

- (1) L'appareil ne doit pas produire de brouillage;*
- (2) L'appareil doit accepter tout brouillage radioélectrique subi, même si le brouillage est susceptible d'en compromettre le fonctionnement.*

RF du IC d'exposition aux radiations: Cet équipement est conforme à l'exposition de la IC rayonnements RF limites établies pour un environnement non contrôlé.

L'antenne pour ce transmetteur ne doit pas être même endroit avec d'autres émetteur sauf conformément à la IC procédures de produits Multi-émetteur.

WARNING

[For product having the wireless function using 5 GHz frequency bands]

- i. the device for operation in the band 5150–5250 MHz is only for indoor use to reduce the potential for harmful interference to co-channel mobile satellite systems;
- ii. for devices with detachable antenna(s), the maximum antenna gain permitted for devices in the bands 5250–5350 MHz and 5470–5725 MHz shall be such that the equipment still complies with the e.i.r.p. limit;
- iii. for devices with detachable antenna(s), the maximum antenna gain permitted for devices in the band 5725–5850 MHz shall be such that the equipment still complies with the e.i.r.p. limits as appropriate; and
- iv. [for devices operating in the band 5250–5350 MHz having an e.i.r.p. greater than 200 mW] antenna type(s), antenna models(s), and worst-case tilt angle(s) necessary to remain compliant with the e.i.r.p. elevation mask requirement set forth in section 6.2.2.3 of RSS-247 shall be clearly indicated.

Users should also be advised that high-power radars are allocated as primary users (i.e. priority users) of the bands 5250–5350 MHz and 5650–5850 MHz and that these radars could cause interference and/or damage to LE-LAN devices.



LG Customer Information Center	
1-888-542-2623	CANADA
Register your product Online!	
www.lg.com	