

| LSP-410R | USER GUIDE

Please read this manual carefully before operating your set. Retain it for future reference.

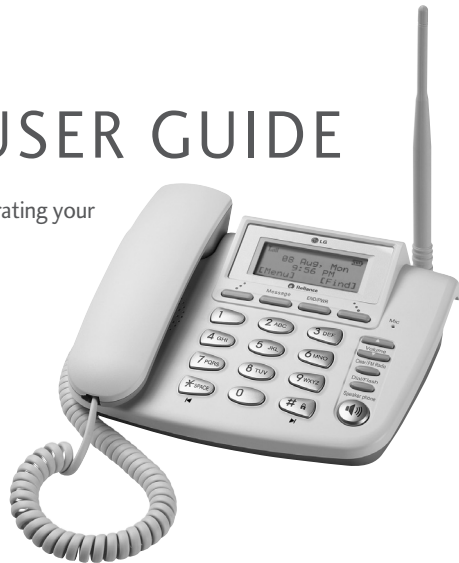

Highlights

Congratulations on your subscription to the LSP-410R Fixed Wireless Phone. This phone has been designed to operate on the IS-2000 Air Protocol over the 800MHz band. And the phone has the advanced user interface similar to mobile phone. It has greatly enhanced voice clarity and provides various advanced features.

Key phone features:

- ▶ FM Radio
- ▶ Display is 3 lines text + 1 Icon line. Yellow/Green LCD & Keypad back light
- ▶ Polyphonic Ring tones: A choice of 10 melodies and 5 bell sounds available
- ▶ Large Phonebook with 300 entries
- ▶ Speed Dialling for up to 300 numbers
- ▶ Total of 50 Missed, Received, Dialed calls, and/or In Call Memo stored under Call History Menu
- ▶ 3 Way call conferencing
- ▶ Enhanced SMS features - 1234 Services

- ▶ Hands free Speaker Phone
- ▶ Receiver Off-Hook tone
- ▶ Recent Call History can be dialled by Dial / Flash key
- ▶ Adjustable Ringer volume, Key volume, Earpiece volume
- ▶ Fast charging battery.

Contents

1. Important Information	4	3.8 In Call Memo	17
1.1 Safety Instruction	4	3.9 Lock Mode	17
1.2 Optimal Phone Performance	4	3.10 Entering and Editing Information	18
1.3 Care and Service	5		
1.4 Safety Information	6	4. Menu Tree	20
		4.1 Menu	24
2. Introduction	9	4.2 Message	33
2.1 Front View of the Phone	9	4.3 Find	38
2.2 LCD Display	10		
2.3 Installation	11	5. Speaker Phone	43
2.4 Installation Steps	14	6. Troubleshooting	44
		7. General Information	45
3. Basic Operations	15	7.1 Main Unit	45
3.1 Making a Call	15	7.2 AC/DC Adapter	45
3.2 Messaging	15	7.3 Battery	45
3.3 Redialing Last Number	15		
3.4 3 way call conferencing	16	TIA Safety Information	47
3.5 Call Waiting	16	FCC RF Exposure Information	58
3.6 Volume Control	16	Limited Warranty Statement	59
3.7 Receiving a Call	17	Authorized LGE Service Center List	62

Important Information

1.1 Safety Instruction

WARNING / CAUTION

To reduce the risk of fire or electric shock, do not expose this phone to rain or moisture. Do not use this phone in swimming pools or other water bodies.

1.2 Optimal Phone Performance

- ▶ Do not hold the antenna when operating the phone, or operate the phone when someone is within four inches (ten centimeters) of the antenna. Both cases affect the call quality and may cause the phone to operate at a higher power level than required.
- ▶ For the best call quality, keep the antenna free from obstructions and position the antenna upright.
- ▶ Do not use the phone if the antenna is damaged. Replace the damaged antenna immediately by a qualified technician. Use only a manufacturer-approved antenna.
Non-approved antennas, modifications or attachments may impair call quality and damage the phone.

- ▶ RF energy may affect improperly installed or inadequately shielded personal medical devices such as pace-makers or hospital monitors. Consult the manufacturer of any personal medical devices to determine whether they are adequately shielded from external RF energy. Turn your phone OFF in health care centers if any regulations posted in the area instruct you to do so. Hospitals or health care centers may be using equipment that may be sensitive to external RF energy.
- ▶ If this phone causes harmful interference to radio or television reception, which can be determined by turning the equipment off and on, the user is encouraged to try to correct the interference by one or more of the following measures:
 - Reorient or relocate the receiving antenna
 - Place the radio or television farther away from the phone.
 - Connect the equipment to an outlet on a circuit different from that to which the phone is presently connected.
 - Consult the Authorized LGE Dealer for assistance of an experienced radio/TV technician.
- ▶ Use battery, antenna and AC/DC power adapter provided by LGE. Using parts made by any other

manufactures may invalidate the warranty.

- ▶ Only authorized personnel should service the phone and its accessories. Faulty installation or service can be dangerous and may invalidate the warranty.
- ▶ Do not use the phone in any designated “cellular phone use” area.
- ▶ Avoid using the phone in high temperature or humidity.
- ▶ Avoid spilling any liquid on the phone. If the phone gets wet, turn the power off immediately. If the phone doesn't work, please contact the service provider immediately.
- ▶ Avoid shock or impact.
- ▶ We recommend you to charge the backup battery before initial use. The backup battery may be discharged during delivery.

Important Information

1.3 Care and Service

Before cleaning, always unplug the phone from the wall outlet and remove the antenna (or disconnect the antenna cable). Do not use liquid or aerosol cleaners; use a damp cloth for cleaning.

If the phone doesn't work, do not attempt to disassemble it, contact the authorized LGE Service center for assistance.

If any of the following conditions exist, unplug the phone from the wall plug, remove the battery and call the qualified engineer.

- ▶ The power supply cord is damaged or frayed.
- ▶ Liquid has spilled into the phone.
- ▶ The phone has been exposed to rain or water.
- ▶ The phone has been dropped or damaged.
- ▶ The phone does not function normally even after following the operating instructions.

Important Information

1.4 Safety Information

WARNING

- ▶ For safety, use only an adapter approved by LG.
LG does not bear responsibility for any faults that may arise due to non-conformation to this guide.
Example: LSP-410R
(LG Power Adapter Source: DC 5V / 1A)
- ▶ Do not, in any way, cause a short-circuit. It may start a fire or the phone may explode causing injury.
- ▶ Do not create a sudden impact on the battery by throwing it. Do not dispose off batteries by putting them in a fire. They may explode or catch fire due to the electrolyte within.



CAUTION

- ▶ Do not use the phone with a car battery. It may cause electric shock, fire, breakdown or transformation.
- ▶ Avoid using the phone in high temperature or humidity. Avoid spilling any liquid on this phone. If the phone gets wet, Switch off phone and turn off AC power supply.
- ▶ Keep the phone dry. Submersion, humidity, and liquids contain minerals that may corrode internal electronic circuits.
- ▶ Do not store or use the phone in dusty or dirty areas as this can damage the moving parts.
- ▶ Do not store the phone in hot areas. High temperatures can shorten the life of electronic devices, damage batteries, and



- warp or melt certain plastics.
- ▶ Do not store the phone in cold areas. When the phone warms up to its normal operating temperature, moisture can form inside the phone, which can damage the internal electronic circuit boards.
- ▶ Do not attempt to open it. Non-expert handling of the phone could damage it. It may cause fire, electric shock and breakdown. Consult your authorized LG dealer for assistance.
- ▶ Do not drop, knock or shake the phone. Rough handling may break the internal circuit boards.
- ▶ Do not use harsh chemicals, cleaning solvents or strong detergents to clean the phone. Wipe it with a soft cloth that has been slightly dampened in a mild soap and water solution.

Important Information

- ▶ Do not paint the phone. Paint can clog the phone's moving parts and prevent proper functioning.
- ▶ During lightning, do not touch the power plug or the phone line. It may result in an electric shock or death.
- ▶ Do not install the phone under direct sunlight or on an uneven surface.
- ▶ Before using the plug, check the available power voltage. Inaccurate power voltage may cause fire and damage.
Example: LSP-410R Input Voltage: 100 ~ 240V.
- ▶ Do not plug many power cords into one outlet. It may cause fire or electric shock.



Important Information



▶ Do not remodel the power cord or disassemble it. If the power cord or plug is impaired, do not use it. It may cause fire or electric shock.



▶ Do not install the phone in an ill-ventilated place. It may cause fire or a breakdown.



▶ Do not touch the plug with wet hands. When disconnecting the power cord of any accessory, grasp and pull out the plug itself and not the cord. It may cause fire or electric shock.



▶ Do not put heavy objects on the power cord. Do not bend the power cord too much. It may cause fire or electric shock.

▶ Use only an LG-approved battery and adapter. If not, it may cause an explosion or result in a short-



circuit. LG does not bear any responsibility for the damage.

▶ When you disconnect the power cord of any accessory, grasp and pull the plug itself and not the cord. It may cause the adapter to breakdown.

2.1 Front View of the Phone

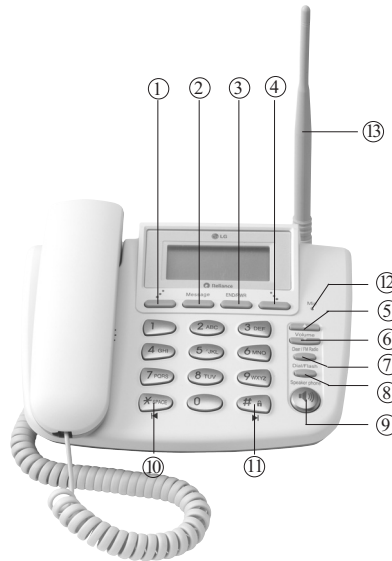

- ① Soft key 1 : Activates Main Menu state
- ② Message : Activates SMS Menu state
- ③ END/PWR : Deactivates states, or Power ON/OFF
- ④ Soft key 2 : Activates Find Menu state
- ⑤ Up Key (▲) : Moves up in the Menu or Volume Up
- ⑥ Down Key (▼) : Moves down in the Menu or Volume Down
- ⑦ Clear / FM Radio : Deletes the last digit / Moves previous MENU, Activates FM Radio
- ⑧ Dial/Flash : Activates Dial/Flash state, or views Call History
- ⑨ (📢) : Activates hands free speaker phone function
- ⑩ * : Inputs Symbol '*', or makes a phone input 'space' during text entry operation, or search frequency during a FM radio play.
- ⑪ # : Inputs Symbol '#', or makes a phone lock after long-press, or search frequency during a FM radio play.
- ⑫ MIC : Microphone for hands free speaker phone function.
- ⑬ Attached Antenna

Introduction

2.2 LCD Display

The LCD shows icons on the top of the LCD screen. Different indicators appear based on the phone's operating mode.

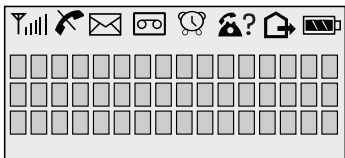

Icon	Operating Condition
	RSSI indicator: Indicates the signal strength in the service area.
	No service: The phone is not receiving any system signal.
	In use: Displayed when a call is in progress or the phone is in offhook state.
	Text message: Displayed when a text message is received.
	Voice message: Displayed when a voice message is received.
	Alarm: Displayed when alarm time is set.
	Incoming Call Indicator : Displayed when the Incoming Call is received
	Not used
	Battery charge level: Indicates charged battery level.

Introduction

2.3 Installation

You should follow each step carefully as shown below in order to guarantee the proper operation of CDMA Fixed Wireless Phone.



Main Unit



Dipole Antenna

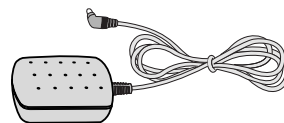

AC/DC Power Adapter

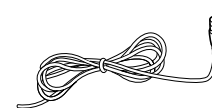

FM Radio Antenna



User Guide

STEP I. Check Components

▶ The following components are supplied Fixed Wireless Phone.

1. LSP-41 OR Main Phone with Handset
(Including inner backup battery) -1 EA-
2. Dipole Antenna -1 EA-
3. AC/DC Power Adapter -1 EA-
4. User Guide -1 EA-
5. FM Radio Antenna -1 EA-

▶ Please make sure that these components are present before you begin to install the phone. If any of the components are missing or damaged, contact your service provider immediately.

STEP II. Place the Terminal

▶ Place the phone on the stable flat surface area (desk, table, etc.). Serious damage may result if the phone is dropped. Do not place the phone within 1 meter of heaters or radiators.

This phone is designed for desktop usage. Avoid the direct exposure to sunlight and dampness.

▶ Read the SAFETY INFORMATION located in the first part of this document before you place the phone.

STEP III. Connect Components (Please refer to “Installation Steps” in 2.4)

▶ Connect the antenna to the TNC antenna connector located at the top of the phone.

If you have placed the phone on a flat surface, position the antenna pright.

▶ Connect the curl cord of the handset to the RJ-11 port located on the left side of the phone.

▶ Connect the AC/DC Adapter cable to the DC input port located at the top of the phone.

- If it is correct, a beep tone will be heard.

- If it is not correct (Booting fails or beep tone is not heard), you will have to reconnect the adapter or reset the battery switch to “on”.

▶ Please observe the following to get better voice quality.

1. Keep away from electrical appliances such as TV, computer, radio etc.
2. Keep the phone in a high and central location without any obstructions.
3. Raise the integral antenna of the phone to get maximum strength as shown in the figure.

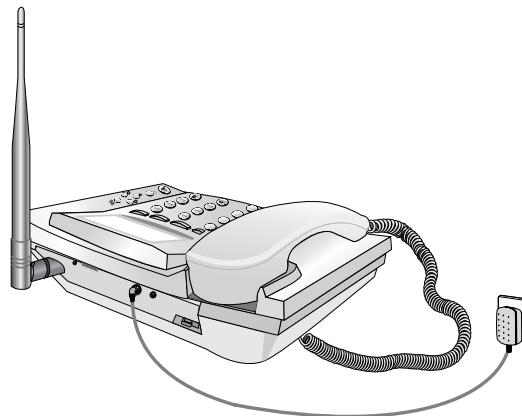

STEP IV. Check the LCD Display

▶ After you follow the installation instruction step I to step III, please check the LCD for normal operation.

▶ If you do not see the status of service, please repeat the 4th instruction of step III.

Then confirm the status of phone to get the proper signal strength from the service operator system.

2.4 Installation Steps

Please follow the procedure below to install the phone properly.



1 Connect basehandset to the handset connector.

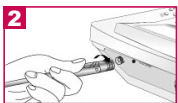

2 Connect the antenna to the TNC connector (Turn right).

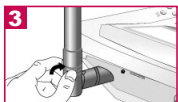

3 Turn the antenna upright.

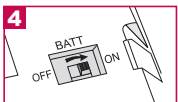

4 When you first use the phone, please Turn "on" the battery switch.

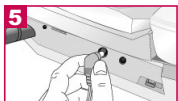

5 Connect the AC power supply.



6 Press END/PWR button to operate initially.

Notice

- ▶ Before using the phone, please check that the battery switch is "on".
- ▶ After switching if on, use the phone.
- ▶ When charging the battery, check that the battery switch is "on".
- ▶ The battery will be charged only when the battery switch is "on".

3.1 Making a Call

You can make a call as follows.

1. Pick up the handset or press button.
2. Listen for dial tone.
3. Enter the phone number with area code if needed.
4. Wait for the Auto Time-out or Press Dial/Flash button.
5. The call is connected and you may start conversation.
6. To disconnect the call, replace the handset or press button.

When the user presses the Dial/Flash button after dialing any desired number, if the user picks up the handset or presses the Speaker Phone button, the phone makes a call immediately.

3.2 Messaging

You can send or receive a short message. If you want to send SMS, press **Message** button + 1 **Write** in on-hook state and write "send to" number / message that you want and send your message. When the message received in idle state or during a call, you can confirm your message as follows.

1. Press **Message** button + 2 (**Inbox**) + 1 (**View SMS**).
2. Press Soft key 1 **View** to confirm desired message.

3.3 Redialing Last Number

You can make a redial to last number, shown in All Calls.

1. Pick up the handset or press button.
2. Listen for dial tone.
3. Press Dial/Flash button.

Basic Operations

- The call is connected and you may start conversation.
 - To disconnect the call, replace the handset or press **Mute** button.
- ※ You can also dial any of the last 50 (Missed+Received+Dialled+In Call Memo) numbers stored in All Calls.

3.4 3 way call conferencing

You can start 3 way call conferencing.

- Dial second party phone number while you are in conversation with the first party.
- To make conference call, press '3' + **Dial/Flash** button.
This service should be provided by your service provider.

3.5 Call Waiting

While a call is in progress, you may hear two beeps indicating another incoming call.

When call wait is enabled, you may put the active call on hold while you answer the other incoming call.

- Press **Clear** or **END/PWR** button, Call Waiting window then disappears.
- Press **Dial/Flash** button, you may start conversation with called number.
- Re-press **Dial/Flash** button, you may start conversation with previous number.

3.6 Volume Control

- Press Up/Down button of navigation while in a call, to adjust earpiece volume.
- Press Soft key 2 **Mute** to prevent sound from your end during the call. To cancel Mute, Press again Soft key 2 **Unmute**.

..... Message END/PWR

Soft Key 1 Soft Key 2

To scroll in Menu, press **▲** or **▼** button.

- Press Soft key 1 **Menu** + 3(**Mic Level**) during a call and select Low or High by pressing Soft key 2 **Next** or Press Up/Down button, to adjust MIC volume.

3.7 Receiving a Call

When the bell rings in idle state, you can receive a call as follows

- Pick up the handset or press the **Speaker Phone** button.
- Start a conversation.
- To disconnect the call, replace the handset or press the **Speaker Phone** button.

Basic Operations

3.8 In Call Memo

Allow you to store number during the call.

To store number:

- Press Soft key 1 **Menu** + 1 (**In Call Memo**).
- Enter up to 32 numbers using the keypad.
- Press Soft key 1 **Add** to save.

To retrieve an In Call Memo:

- Press Dial/Flash button to see saved number.

Note: You can store the number by pressing Soft key 1 **Add**.

3.9 Lock Mode

Protects your phone from unauthorized use. Once the phone is locked, it is in restricted mode, until the in lock code is entered. This will allow you to receive phone calls and still make emergency calls. The lock

code/password on your phone is "0000" by default.

If you need to modify the lock code, you may modify it using the change code within the security Menu [4.1.4.6 page no. 34].

You can lock your phone using the '#' (🔒 :Lock) key, also you can lock your phone manually as explained [4.1.4.1 page no. 32].

Under Lock Mode

1. Press '#' button for some time.

The phone is now locked.

2. To unlock, press Soft key 1 **Unlock** .

••••• **Message** **END/PWR** •••••

Soft Key 1

Soft Key 2

3. Enter unlock code. (Default "0000").

3.10 Entering and Editing Information

You can edit the phone book and short messages using various text input mode.

Key Functions

Soft key 2 : Press to scroll and select a mode through menus.

- Soft key 2 : Press to scroll and select a mode through Menus. You can scroll through the modes using Soft key 2 in the following order: ABC, abc, Sym1, Sym2.

-  SPACE key : Press to insert a space.

- Clear key : Press to delete a single space or character. Press and hold to delete entire words.

Input Mode

Text Input provides four modes for entering text, special characters, and punctuation.

- **ABC / abc Mode** : Use ABC or abc mode to input text in English.

⇒ ABC Mode : All subsequent letters are capitalized.

⇒ abc Mode : All subsequent letters are lowercase.

- **Sym1 / Sym2 Mode** : Insert special characters and punctuation. You may use any of the special characters. When the special characters are displayed, you can select the number corresponding to the character that you want to input.

- For number entry, first select the key button you want to input in ABC / abc mode and then press the key button until the number is displayed.

4. Menu Tree

Main MENU	Sub-MENU	Setting Value
1. MENU		
1. Sound	1. Ring Type	1 5ea. Midi(10ea) + Bell(5ea)
	2. Ringer Volume	4 steps
	3. Key Volume	5 steps (including silent step)
	4. EarpieceVolume	4 steps
	5. Radio Volume	
2. Settings	1. Alarm	Set Time / Set Ringer
	2. Call	Call Forward / Call Waiting
	3. Version	Ok / More
	4. Backlight	Always Off / For 10 Seconds / For 30 Seconds / Always On
3. Dial Features	1. Hot Line	Disable / Enable
	2. Hot Line Time	Time 2-9 Sec
	3. Auto Time Out	2-9 Sec
	4. Speed Dialing	Enable / Disable
4. Security	1. Lock Mode	Disable / Enable
	2. Clear Calls	Yes / No

Main Menu	Sub-Menu	Setting Value
	3. Clear Memory	Yes / No
	4. Emergency Calls	Emergency 1 / Emergency 2 / Emergency 3
	5. Restrict Call	Set Restrict / Permit Memory / Deny Memory
	6. Change Code	Ok / Back
5. FM Radio		Option / Back
2. Message		
1. Write		ABC / abc / Sym 1 / Sym 2
2. Inbox	1. View SMS	View / Erase
	2. Voice Mail	Reply / Erase
	3. Erase All	Yes / No
3. 1234 Services	1. News	NEWS / NEWS NAT / NEWS INT / NEWS BUS / NEWS TECH / NEWS SPORTS / NEWS BOLLY
	2. Cricket	CRI
	3. Joke	JOKE
	4. Thought	THO

Menu Tree

Main Menu	Sub-Menu	Setting Value
	5. Contest	CON / CRICON
	6. Beauty Tips	Tips BEAUTY
	7. Health	HEALTH
	8. Horoscope	HORO ARO / HORO TAU / HORO GEM / HORO CAN / HORO LEO / HORO VIR / HORO LIB / HORO SCO / HORO SAG / HORO CAP / HORO AQU / HORO PIS
	9. Bill Info	BILL
	0. Unbilled Info	UNBILL
	*. Help	HELP
4. Outbox	1. View	View / Erase
	2. Erase All	All Yes / No
5. Settings	1. MSG Alert	Off / Once / Every 2 Min
	2. MSG Ringer	SMS Alarm 1 ~ 5
	3. Defer Delivery	Immediate / After 30 Min. / After 1 Hour / After 2 Hours / After 12 Hours / After 1 Day / After 2 Days

Menu Tree

Main Menu	Sub-Menu	Setting Value
	4. Valid Period	Default / 30 Minutes / 1 Hour / 2 Hours / 12 Hours / 1 Day / 2 Days
	5. Auto DEL Inbox	Disable / Enable
3. Find		
1. Call History	1. All Calls	View / Erase
	2. Missed	View / Erase
	3. Received	View / Erase
	4. Dialed	View / Erase
	5. In Call Memo	View / Erase
	6. Erase History	Erase All Calls / Erase Missed / Erase Received / Erase Dialed / Erase Memo
2. Phone Book	1. By Name	Find / ABC
	2. By Address	Find
	3. By Number	Find

4.1 Menu

You may select from four Main Menu (Sound, Settings, Dial Features, Security) for this item.

If you press Soft key 1 **Menu** is activated.

..... **Message** **END/PWR**

Soft Key 1

Soft Key 2

To scroll in Menu, press ▲ or ▼ button.

To return to the initial screen, press END/PWR button and to return to the previous screen, press Clear button.

4.1.1 Sound

Allows you to set various volume settings and Ring Type.

Press Soft key 1 **Menu** + 1 (**Sound**) in on-hook state.

4.1.1.1 Ring Type

You can select the various ring types.

1. Press Soft key 1 **Menu** + 1 (**Sound**) + 1 (**Ring Type**) in on-hook state.

2. Press Up/Down button or Soft key 2 **Next** to select desired ring type.

3. Press Soft key 1 **Ok** to save setting.

Note: Choose from 15 different ring types (Aahat / Aarti / Dillagi / Nachtmusik / Hamnavaz / SaareJahan / ShubAarti / Symphony / TereSang / ToccataNFugue / Bell_01 / Bell_02 / Bell_03 / Bell_04 / Bell_05).

4.1.1.2 Ringer Volume

You can adjust the ringing volume level of incoming call alert.

1. Press Soft key 1 **Menu** + 1 (**Sound**) +

2 (**Ringer Volume**) in on-hook state.

2. Press Up/Down button or Soft key 2 **Next** to adjust Ring Volume.

3. Press Soft key 1 **Ok** to save setting.

4.1.1.3 Key Volume

The tone when you press a key can be adjusted.

1. Press Soft key 1 **Menu** + 1 (**Sound**) +

3 (**Key Volume**) in on-hook state.

2. Press Up/Down button or Soft key 2 **Next** to adjust key volume.

3. Press Soft key 1 **Ok** to save setting.

4.1.1.4 Earpiece Volume

The voice of the other party can be adjusted.

1. Press Soft key 1 **Menu** + 1 (**Sound**) +

4 (**Earpiece Volume**) in on-hook state.

2. Press Up/Down button or Soft key 2 **Next** to adjust earpiece volume.

3. Press Soft key 1 **Ok** to save setting.

Note : Press Up/Down button to adjust the volume during a conversation.

4.1.1.5 Radio Volume

You can adjust the radio volume.

1. Press Soft Key 1 **Menu** + 1 (**Sound**) +

5 (**Radio Volume**) in on-hook state.

2. Press Up/Down button or Soft Key 2 **Next** to adjust radio volume.

3. Press Soft Key 1 **Ok** to save setting.

Note: Press Up/Down button to adjust the volume during a radio play.

4.1.2 Settings

You can use additional features like Alarm, Call, Backlight etc.

Press Soft key 1 **Menu** + 2(**Settings**) in on-hook state.

4.1.2.1 Alarm

[Set Time]

This function allows you to set alarm time.

1. Press Soft key 1 **Menu** + 2(**Settings**) + 1(**Alarm**) + 1(**Set Time**) in on-hook state.
2. Press Up/Down button or Soft key 2 **Next** to select from Off, Once or Always and press Soft key 1 **Ok**.
3. Enter alarm time and press Soft key 1 **AM/PM** and select AM or PM.
4. If you want to modify the time, press Clear

button and reset.

5. Press Soft key 2 **Ok** to save and exit.

[Set Ringer]

This function allows you to select ringer for alarm alert.

1. Press Soft key 1 **Menu** + 2(**Settings**) + 1(**Alarm**) + 2(**Set Ringer**) in on-hook state.
2. Press Up/Down button or Soft key 2 **Next** to select from Alarm Ring 1, Alarm Ring 2, Alarm Ring 3, Alarm Ring 4 or Alarm Ring 5.
3. Press Soft key 1 **Ok** to save and exit.

4.1.2.2 Call

[Call Forward]

“Call Forward” lets you forward all your incoming calls to another number or Voice Mail connection.

1. Press Soft key 1 **Menu** + 2(**Settings**) + 2(**Call**) + 1(**Call Forward**) in on-hook state.

2. Select from Immediate / When Busy / No Reply / Disable All.

“Disable All” deactivates all the activated call forwarding options.

3. Select Enable or Disable.

⇒ If you select Enable, Enter the phone number that you want. Press Soft Key 1 **Ok** to save and exit.

[Call Waiting]

While a call is in progress, you may hear two beeps indicating another incoming call. When call waiting is enabled, you may put the active call on hold while you answer the other incoming call.

1. Press Soft key 1 **Menu** + 2(**Settings**) + 2(**Call**) + 2(**Call Waiting**) in on-hook state.
2. Select Enable or Disable and press Soft key 1

Ok.

⇒ Contact your service provider for more information on Call Forward and Call Waiting.

4.1.2.3 Version

You can confirm your phone S/W version.

1. Press Soft key 1 **Menu** + 2(**Settings**) + 3(**Version**) in on-hook state.
2. To confirm next page, press Soft key 2 **More**, and press Soft key 1 **Ok** to exit.

4.1.2.4 Backlight

Allows you to choose the settings of the LCD and keypad backlight.

1. Press Soft key 1 **Menu** + 2(**Settings**) + 4(**Backlight**) in on-hook state.
2. Select among Always Off / For 10 Seconds / For

30 Seconds / Always On

4.1.3 Dial Features

Press Soft key 1 **Menu** + 3(**Dial Features**) in on-hook state.

4.1.3.1 Hot Line

HotLine automatically calls to registered number by passing setup time in off-hook state.

1. Press Soft key 1 **Menu** + 3(**Dial Features**) + 1(**Hot Line**) in on-hook state.
2. Press Up/Down button or Soft key 2 **Next** to select Enable or Disable and press Soft key 1 **Ok** .
3. Press Soft key 2 **Edit** and enter the Hot Line phone number.
4. Press Soft key 1 **Ok** to save and exit.

If you have selected 'Enable' and enter the HotLine Number and Time,

HotLine functions as follows:

When you pick up the handset or press **☎** button, the phone automatically dials the HotLine Number that you have already saved if any number is not dialed for duration specified in HotLine Time.

4.1.3.2 Hot Line Time

1. Press Soft key 1 **Menu** + 3(**Dial Features**) + 2(**Hot Line Time**) in on-hook state.
2. Press Up/Down button or Soft key 2 **Next** to select hot line connection time (2~9 Sec.).
3. Press **Soft key 1 Ok** to select.

4.1.3.3 Auto Time Out

Setting the length of time the phone waits before automatically dialing a number. You can select this

duration to be between 2 and 9 seconds.

1. Press Soft key 1 **Menu** + 3(**Dial Features**) + 3(**Auto Time Out**) in on-hook state.
2. Press Up/Down button or Soft key 2 **Next** to select Auto Time Out between 2 and 9 Sec.
3. Press Soft key 1 **Ok** to select.

4.1.3.4 Speed Dialing

This function allows you to make a call faster by just pressing a corresponding number.

Up to 300 memory locations can be assigned for speed dial. To speed dialing press the memory number (1 through 300) corresponding to the appropriate memory location and hold for a few seconds.

⇒ This function can be used when the speed dialing is set to enable.

1. Press Soft key 1 **Menu** + 3(**Dial Features**) +

- 4(**Speed Dialing**) in on-hook state.
2. Press Up/Down button or Soft key 2 **Next** to select Enable or Disable.
3. Press Soft key 1 **Ok** to save and exit.

4.1.4 Security

4.1.4.1 Lock Mode

This function prevents the usage of your phone without your permission. You can protect your phone by 4 digits lock code/password. Possible settings are Enable or Disable. Disable indicates that the phone is not locked. Enable sets the phone locks immediately.

1. Press Soft key 1 **Menu** + 4(**Security**).
2. Enter 4 digits lock code.
3. Press 1(**Lock Mode**).
4. Press Up/Down button or Soft key 2 **Next** to select Enable or Disable.

5. Press Soft key 1 **Ok** to save and exit.
⇒ Default lock code is "0000".

4.1.4.2 Clear Calls

Clear Calls deletes complete Call History. Dialed, Received, Missed Calls & In Call Memo, all calls are deleted.

1. Press Soft key 1 **Menu** + 4(**Security**).
2. Enter lock code.
3. Press 2(**Clear Calls**).
4. Press Up/Down button or Soft key 2 **Next** to Select Yes or No.
5. Press Soft key 1 **Ok** to exit.

Note : Deleted call history can not be retrieved.

To return to the initial screen, press END/PWR button.

The phone can store a total of 50 Received, Dialed,

Missed Calls and/or In Call Memos in Call History.

4.1.4.3 Clear Memory

This function allows you to erase complete phone book memory.

1. Press Soft key 1 **Menu** + 4(**Security**).
2. Enter lock code.
3. Press 3(**Clear Memory**).
4. Press Up/Down button or Soft key 2 **Next** to select Yes or No.
5. Press Soft key 1 **Ok** to exit.

Note : Deleted phone book memory can not be retrieved.

4.1.4.4 Emergency Calls

Emergency number can store up to three numbers (default 100, 101, 102).

1. Press Soft key 1 **Menu** + 4(**Security**) in on-hook state.
2. Enter lock code.
3. Press 4(**Emergency Calls**).
4. To edit a number, press Soft key 1 **Edit** .
5. Press Soft key 1 **Ok** to save.

4.1.4.5 Restrict Call

You can restrict your outgoing calls including numbers / numbers beginning with specified digit in the Deny Memory.

For example: If "9" is stored in the Deny Memory, all number beginning with "9" cannot be called. However if "92" is stored in Permit Memory, you can call numbers beginning with "92" successfully.

1. Press Soft key 1 **Menu** + 4(**Security**) + 5(**Restrict Call**) + 1(**Set Restrict**) in on-hook state.

2. Select among No Restriction, Restriction or Emergency Only and press Soft key 1 **Ok** .
3. If **Restriction** is selected,
 - Enter the numbers / starting digit of specific numbers to be restricted in the Deny Memory.
 - Enter the number / starting digits of the numbers to be allowed in the Permit Memory.
 - Press Soft key 1 **Ok** to save and press Clear button to exit.
4. If **Emergency** Only is selected, your phone is enabled for only emergency numbers (default 100, 101, 102).

4.1.4.6 Change Code

Change Code allows you to enter a new four-digit lock code.

1. Press Soft key 1 **Menu** + 4(**Security**).

2. Enter lock code.
3. Press 6(**Change Code**).
4. Enter the new four-digit lock code that you want.
5. Press Soft key 1 **Ok** to go next state.
6. For confirmation, it will ask you to enter the new lock code again.
7. Press Soft key 1 **Ok** to save and press Clear or Soft key 2 **Back** button to exit.

4.1.5 FM Radio

This function allows you to play FM Radio.

1. Press Soft Key 1 **Menu** + 5(**FM Radio**).
 - Default frequency is 87.50 MHz and default name is "FM Radio".
2. Press Star(*) or Pound(#) key to search radio frequency manually.

- If you press for short time, increased or decreased 10 KHz. If you press for long time, the radio frequency is detected to auto scanning function.
3. For listen to saved radio frequency press key button (1 through 9).
 - If the frequency is not saved in the channel, the name is <empty> and the frequency is 87.50 MHz.
 4. To save, delete, change headset or speaker, and edit name correspond to the frequency, Press Soft Key 1 **Option** .
 5. Press Up/Down button and key button between 1 and 4 to select list.
 6. To save, delete, or edit name correspond to frequency, Press key button between 1 and 9.
 7. If you press channel in Naming list, You can change and edit name until 12 pos.
 8. Press Soft Key 1 **Ok** to save name.

Note:

- If a call is incoming during a radio play, The radio is stopped. When you disconnect a call, The radio is played again.
- The radio Hot key is Clear key.
- If you want to listen to radio, Connect a Headset. When you disconnect a headset during a radio play, "Connect a Headset" message is displayed in the LCD.

4.2 Messages

Text messaging, page and voice mailbox become available as soon as the power is on.

You may access the above type of messages using the Message key. The phone can store up to 50 messages in each Inbox and Outbox.

If you press Message Key, SMS Menu is activated.

..... **Message** **END/PWR**

Soft Key 1

Soft Key 2

To scroll in SMS Menu, press ▲ or ▼ button.

At any point of time, to return to the initial screen, press END/ PWR button and to return to the previous screen, press Clear button.

In the list of Inbox, all sorts of the icon have the meaning as follows:

! : Unread message

V : Read message

4.2.1 Write

This function allows you to compose and send SMS.

1. Press **Message** + 1(**Write**) in on-hook state.
2. Enter phone number or press **Ok** .
Soft key 2 **Find** .
3. Write messages. Refer to the 3.10 (page 19) Entering and Editing Information about text input.

4. Select option as following.

Delivery ACK: This function allows you to know

whether the messages have been successfully transmitted to the recipient. If you want to activate

this function, set to Yes.

Store Message: This function allows you to choose whether the sent message shall be saved or not.

You may select Yes or No.

Set Priority: This function allows you to give priority to message as Normal, Urgent or Emergency.

5. Press Soft key 1 **Ok** to send message.

4.2.2 Inbox

4.2.2.1 View SMS

Received messages are stored here.

1. Press **Message** + 2(**Inbox**) + 1(**View SMS**) in on-hook state.
2. To view desired message, select Soft key 1 **View** .
3. To reply the message, select Soft key 1 **Reply** .
4. To erase message, select Soft key 2 **Erase** .

⇒ For example, the meaning of (2/3) in View SMS is that 2 out of 3 messages are unread.

4.2.2.2 Voice Mail

Voice Mail notifications indicate the number of new voice messages in your mailbox.

Only the most recent voice mail notification will be stored in your phone, previous message will be

overwritten.

1. Press **Message** + 2(**Inbox**) + 2(**Voice Mail**) in on-hook state.
2. Pick up the handset or press Speaker Phone button to make a call back your voice mailbox if the number of the voice mailbox is provided by the telecom service company's system.

4.2.2.3 Erase All

This function allows you to erase all received messages.

1. Press **Message** + 2(**Inbox**) + 3(**Erase All**) in on-hook state.
2. Press Up/Down button or Soft key 2 **Next** to select No or Yes.
3. Press Soft key 1 **Ok** to exit.

4.2.3 1234 Services

Exciting SMS-based Infotainment services such as News, Jokes, Horoscope etc are available to Reliance subscribers. Using the SMS 1234 services, the user will be able to access interesting information on common subjects through SMS. User needs to send Keyword in specified format to 1234 to access these services.

1. Press **Message** + 3(**1234 Services**) in on-hook state.
2. You may select from eleven items
(1. News / 2. Cricket / 3. Joke / 4. Thought / 5. Contest / 6. Beauty Tips / 7. Health / 8. Horoscope / 9. Bill Info / 0. Unbilled Info / *. Help)
3. You may select the number corresponding to the item that you want to send in subsequent-menu.

4.2.4 Outbox

4.2.4.1 View

All your successfully sent messages are saved here.

1. Press **Message** + 4(**Outbox**) + 1(**View**) in on-hook state.
2. To erase message, select Soft key 2 **Erase** .
3. To view or edit desired message, select Soft key 1 **Edit** .

4.2.4.2 Erase All

To erase all sending messages, select this function.

1. Press **Message** + 4(**Outbox**) + 2(**Erase All**) in on-hook state.
2. Press Up/Down button or Soft key 2 **Next** to select Yes or No.
3. Press Soft key 1 **Ok** to exit.

4.2.5 Settings

4.2.5.1 MSG Alert

This function allows you to set the frequency of notification when message is received.

1. Press **Message** + 5(**Settings**) + 1(**MSG Alert**) in on-hook state.
2. Select among Off, Once or Every 2 Min by pressing Up/Down button or Soft key 2 **Next** .
3. Press Soft key 1 **Ok** to save and exit.

4.2.5.2 MSG Ringer

This function allows you to set the ringer-type for notification when message is received.

You can select from 5 choices.

1. Press **Message** + 5(**Settings**) + 2(**MSG Ringer**) in on-hook state.
2. Select a desired ringer type by pressing

Up/Down button or Soft key 2 **Next** .

3. Press Soft key 1 **Ok** to save and exit.

4.2.5.3 Defer Delivery

1. Press **Message** + 5(**Settings**) + 3(**Defer Delivery**) in on-hook state.
2. Select one of the following by pressing Up/Down button or Soft key 2 **Next** :
Immediate **After 30 Min.** **After 1 Hour**
After 2 Hours **After 12 Hours** **After 1 Day**
After 2 Days
3. Press Soft key 1 **Ok** to save.

4.2.5.4 Valid Period

1. Press **Message** + 5(**Settings**) + 4(**Valid Period**) in on-hook state.

2. Select desired time by pressing Up/Down button or Soft key 2 **Next** :

Default **30 Minutes** **1 Hour** **2 Hours**

12 Hours **1 Day** **2 Days**

3. Press Soft key 1 **Ok** to save.

4.2.5.5 Auto DEL Inbox

1. Press **Message** + 5(**Settings**) + 5(**Auto DEL Inbox**) in on-hook state.
2. Press Up/Down button or Soft key 2 **Next** to select Enable or Disable.
3. Press Soft key 1 **Ok** to save.

4.3 Find

This function allows you to search the phone numbers that you have stored in the phone book memory. You may search the numbers from call history also.

If you press Soft key 2, Find menu is activated.

..... Message END/PWR

Soft Key 1

Soft Key 2

To scroll in Menu, press ▲, ◀, ▶ or ▼ button.

To return to the initial screen, press END/PWR button and to return to the previous screen, press Clear button.

4.3.1 Call History

The phone can store a total of 50 Received, Dialed, Missed Calls and/or In

Call Memos in Call History.

When you press the Dial/Flash button, all calls are displayed. In the list of all calls, all sorts of the icons have the meaning as follows :

- Received : ←
- Dialed : →

- Missed : !

- In call Memo : ↵

- Call Waiting : ⤴

- 3 Way Call : ☎

4.3.1.1 All Calls

[In on-hook state]

1. Press Find + 1 (Call History) + 1 (All Calls) or Dial/Flash button.
2. Press Up/Down button to select a number or name in the call history list.
3. To view desired item, select Soft key 1 View .
4. To erase desired number, select Soft key 2 Erase .
5. Press Soft key 2 Time to see more information and press Soft key 1 Save to save the number in the phone book.

[While in a Call]

1. Press Menu +2 (Find) +1 (Call History) + 1 (All Calls) .
2. Press Up/Down button to select a number or name in the call history list.
3. To view desired item, select Soft key 1 View .
4. To erase desired number, select Soft key 2 Erase .
5. Press Soft key 2 Time to see more information and press Soft key 1 Save to save the number in the phone book.

4.3.1.2 Missed

1. Press Find + 1 (Call History) + 2 (Missed) in on-hook state.
2. Press Up/Down button to select a number or

name in the missed call list.

3. To view desired item, select Soft key 1 View .
4. To erase missed call, select Soft key 2 Erase .
5. Press Soft key 2 Time to see more information and press Soft key 1 Save to save the number in the phone book.

4.3.1.3 Received

1. Press Find + 1 (Call History) + 3 (Received) in on-hook state.
2. Press Up/Down button to select a number or name in the received call list.
3. To view desired item, select Soft key 1 View .
4. To erase received call, select Soft key 2 Erase .
5. Press Soft key 2 Time to see more information and press Soft key 1 Save to save the number in the phone book.

4.3.1.4 Dialed

1. Press **Find** + 1 (**Call History**) + 4 (**Dialed**) in on-hook state.
2. Press Up/Down button to select a number or name in the dialed call list.
3. To view desired item, select Soft key 1 **View** .
4. To erase dialed number, select Soft key 2 **Erase** .
5. Press Soft key 2 **Time** to see more information and press Soft key 1 **Save** to save the number in the phone book.

4.3.1.5 In Call Memo

1. Press **Find** + 1 (**Call History**) + 5 (**In Call Memo**) in on-hook state.
2. Press Up/Down button to select desired item in the In Call Memo list.

3. To view desired item, select Soft key 1 **View** .
4. To erase In Call Memo, select Soft key 2 **Erase** .
5. Press Soft key 2 **Time** to see more information and press Soft key 1 **Save** to save the number in the phone book.

4.3.1.6 Erase History

You may erase all history from five options (1. Erase AllCalls, 2. Erase Missed, 3. Erase Received, 4. Erase Dialed, 5. Erase Memo).

1. Press **Find** + 1 (**Call History**) + 6 (**Erase history**) in on-hook state.
2. Select history that you want to erase and press Soft key 1 **Ok** .

4.3.2 Phone Book

This function allows you to search the phone number in three way By Name, By Address and By Number, which you have stored in the phone book memory. Up to 300 entries can be listed here.

To store phone number

1. Enter the area code and phone number (Max. 32 digits) in on-hook state.
2. Press Soft key 1 **Save** .
3. Enter the name. Refer to the 3.1.0 (page 23) Entering and Editing Information about text input.
4. Enter the desired memory location.
5. The phone will display a message asking you whether to keep your number as secret or not. Select No or Yes using Up/Down button or Soft key 2 **Next** and press Soft key 1 **Ok** .
⇒ You will see a confirmation message and the

status of memory used.

[Fast Searching]

Press Soft key 2 **Find** and press Soft key 2 **Find** again.

4.3.2.1 By Name

1. Press Soft key 2 **Find** + 2 (**Phone Book**) + 1 (**By Name**), to retrieve a phone number by name.
2. Enter the name you want and press Soft key 2 **Find** . To find all phone numbers you have stored, press Soft key 2 **Find** .

4.3.2.2 By Address

1. Press Soft key 2 **Find** + 2 (**Phone Book**) + 2 (**By Address**), to retrieve a phone number by address.

2. Enter a memory address to retrieve phone number and press Soft key 2 **Find** . To find all phone numbers you have stored, press Soft key 2 **Find** .

4.3.2.3 By Number

1. Press Soft key 2 **Find** + 2(**Phone Book**) + 3(**By Number**), to retrieve a phone number by number.
2. Enter the phone number that you want to fine and press Soft key 2 **Find** . To find all phone numbers you have stored, press Soft key 2 **Find** .

5. Speaker Phone

This function is a convenient feature, which enables you to make a call using the Speaker Phone () button in on-hook state.

Troubleshooting

6. Troubleshooting

Please check the following items before contacting Authorized LGE service center.

Item	Remedy
Phone doesn't operate at all.	<ul style="list-style-type: none"> • Check that the phone is installed correctly. • Check that the battery is fully charged. • Check that the power is on.
Because of noise and cross talking, call status is bad.	Keep away from electrical application such as TV, computer, radio and so on.
When buttons are pressed to call, can't hear the dial tone..	Check that phone cord or power is connected correctly.
Battery fails to charge.	Check that the authorized adaptor (5V/1A) for LSP-410R is correctly connected to the DC power connector of the phone and Battery ON/OFF switch is ON.
Bell sound isn't heard	If bell sound is low, please adjust the volume level.
<ul style="list-style-type: none"> • The LCD repeats on and off when you plug-in the adapter while battery switch is off. • Phone repeats abnormally power-on and power-off after a few second when you plug-in the adapter while battery switch is on and phone is power-off. • There is no charging display when you plug-in the adapter while the phone is power on. 	Check that the adapter is the approved from LG. Adapter should be 5V(DC), 1A

General Information

7. General Information

▶ Main unit

Item	LSP-410R
Tx Frequency	Digital: 824 ~ 849 MHz
Rx Frequency	Digital: 869 ~ 894 MHz
Channel Bandwidth	1.25 MHz
Tx Power	0.282W
Rx Sensitivity	-104 ~ -25dBm
Size (mm)	195 X 163 X 73 (L X W X H)
Weight (gms)	553 (included Li-ion battery)
Operating Temperature	-10 ~ 50° C

▶ AC/DC Adapter

Item	SMPS Type Description
Rated Input Voltage	AC 100 ~ 240V
Operating Input voltage	AC 80 ~ 420V
Rated Input Frequency	50 / 60Hz
Operating Input Frequency	47 ~ 63Hz
Rated Output Voltage, Current	5V(DC), 1A

General Information

▶ Battery

Item	Description
Capacity	3.7V Li-ion (Nominal)
Talk time / Standby time	4 Hours / 120Hours
Charging time duration	3.5 Hours (Standby condition)

Note : Talk time condition : Output Power about 10dBm & full data rate Standby time condition : sector power -90dBm & slot cycle index 2

TIA Safety Information

TIA Safety Information

Provided herein is the complete TIA Safety Information for Wireless Handheld phones. Inclusion of the text covering Pacemakers, Hearing Aids, and Other Medical Devices is required in the owner's manual for CTIA Certification. Use of the remaining TIA language is encouraged when appropriate.

Exposure to Radio Frequency Signal

Your wireless handheld portable phone is a low power radio transmitter and receiver. When it is ON, it receives and also sends out radiofrequency (RF) signals. In August, 1996, the Federal Communications Commissions (FCC) adopted RF exposure guidelines with safety levels for hand-held wireless phones. Those guidelines are consistent with the safety standards previously

set by both U.S. and international standards bodies:

ANSI C95.1 (1992) *

NCRP Report 86 (1986)

ICNIRP (1996)

Those standards were based on comprehensive and periodic evaluations of the relevant scientific literature. For example, over 120 scientists, engineers, and physicians from universities, government health agencies, and industry reviewed the available body of research to develop the ANSI Standard (C95.1). The design of your phone complies with the FCC guidelines (and those standards).

Antenna Care

Use only the supplied or an approved replacement antenna. Unauthorized antennas, modifications, or attachments could damage the phone and may violate FCC regulations.

Phone Operation

Tips on Efficient Operation:

- For your phone to operate most efficiently: Do not

TIA Safety Information

touch the antenna unnecessarily when the phone is in use. Contact with the antenna affects call quality and may cause the phone to operate at a higher power level

than otherwise needed.

- American National Standards Institute; National Council on Radiation Protection and Measurements; International Commission on Non-ionizing Radiation Protection.

Electronic Devices

Most modern electronic equipment is shielded from RF signals. However, certain electronic equipment may not be shielded against the RF signals from your wireless phone.

Pacemakers

The Health Industry Manufacturers Association recommends that a minimum separation of six (6") inches be maintained between a handheld wireless

phone and a pacemaker to avoid potential interference with the pacemaker. These recommendations are consistent with the independent research by and recommendations of Wireless Technology Research Persons with

pacemakers:

- Should ALWAYS keep the phone more than six inches from their pacemaker when the phone is turned ON.
- Should use the ear opposite the pacemaker to minimize the potential for interference.
- If you have any reason to suspect that interference is taking place, turn your phone OFF immediately.

Hearing Aids

Some digital wireless phones may interfere with some hearing aids. In the event of such interference, you may want to consult your service provider [or call the customer service line to discuss alternatives.]

Optional for each phone

manufacturer.

Other Medical Devices

If you use any other personal medical device, consult the manufacturer of your device to determine if they are adequately shielded from external RF energy. Your physician may be able to assist you in obtaining this information.

Turn your phone OFF in health care facilities when any regulations posted in these areas instruct you to do so. Hospitals or health care facilities may be using equipment that could be sensitive to external RF energy.

Potentially Explosive Atmosphere

Do not install the phone in potentially explosive atmosphere.

Sparks in such areas could cause an explosion or fire resulting in bodily injury or even death.

Areas with a potentially explosive atmosphere are often, but not always marked clearly. Potential areas

TIA Safety Information

may include: fueling areas (such as gasoline stations); below deck on boats; fuel or chemical transfer or storage facilities; vehicles using liquefied petroleum gas (such as propane or butane); areas where the air contains chemicals or particles (such as grain, dust, or metal

powders); and any other area where you would normally be advised to turn off your vehicle engine.

For Vehicles Equipped with an Air Bag

An air bag inflates with great force. DO NOT place objects, including either installed or portable wireless equipment, in the area over the air bag or in the air bag deployment area. If invehicle wireless equipment is improperly installed and the air bag inflates, serious injury could result.

FDA Consumer Update

The U.S. Food and Drug Administration's Center for Devices and Radiological Health Consumer Update on Mobile Phones.

TIA Safety Information

1. Do wireless phones pose a health hazard?

The available scientific evidence does not show that any health problems are associated with using wireless phones. There is no proof, however, that wireless phones are absolutely safe.

Wireless phones emit low levels of radiofrequency energy (RF) in the microwave range while being used. They also emit very low levels of RF when in the stand-by mode. Whereas high levels of RF can produce health effects (by heating tissue), exposure to low level RF that does not produce heating effects causes no known adverse health effects. Many studies of low level RF exposures have not found any biological effects. Some studies have suggested that some biological effects may occur, but such findings have not been confirmed by additional research.

In some cases, other researchers have had difficulty in reproducing those studies, or in determining the reasons for inconsistent results.

2. What is FDA's role concerning the safety of wireless phones?

Under the law, FDA does not review the safety of radiation-emitting consumer products such as wireless phones before they can be sold, as it does with new drugs or medical devices. However, the agency has authority to take action if wireless phones are shown to emit radiofrequency

energy (RF) at a level that is hazardous to the user. In such a case, FDA could require the manufacturers of wireless phones to notify users of the health hazard and to repair, replace or recall the phones so that the hazard no longer exists. Although the existing scientific data do not justify FDA regulatory actions, FDA has urged the wireless phone industry to take a number of steps, including the following:

- Support needed research into possible biological effects of RF of the type emitted by wireless phones;
- Design wireless phones in a way that minimizes any RF exposure to the user that is not necessary for device function; and
- Cooperate in providing users of wireless phones

with the best possible information on possible effects of wireless phone use on human health. FDA belongs to an interagency working group of the federal agencies that have responsibility for different aspects of RF safety to ensure coordinated efforts at the federal level. The following agencies belong to

this working group:

- National Institute for Occupational Safety and Health
 - Environmental Protection Agency
 - Occupational Safety and Health Administration
 - National Telecommunications and Information Administration
- The National Institutes of Health participates in some interagency working group activities, as well. The FDA shares regulatory responsibilities for wireless phones with the Federal Communications Commission (FCC). All phones that are sold in the United States must comply with FCC safety guidelines that limit RF exposure. FCC relies on FDA and other health agencies for safety questions about wireless phones. FCC also regulates the base stations that the wireless phone

TIA Safety Information

networks rely upon. While these base stations operate at higher power than do the wireless phones themselves, the RF exposures that people get from these base stations are typically thousands of times lower than those they can get from wireless phones. Base stations are thus not the subject of the safety

questions discussed in this document.

3. What kinds of phones are the subject of this update?

The term "wireless phone" refers here to hand-held wireless phone with built-in antennas, often called "cell", "mobile", or "PCS" phones. These types of wireless phones can expose the user to measurable radiofrequency energy (RF) because of the short distance between the phone and the user's

head. These RF exposures are limited by Federal Communications Commission safety guidelines that were developed with the advice of FDA and other federal health and safety agencies.

When the phone is located at greater distances from

TIA Safety Information

the user, the exposure to RF is drastically lower because a person's RF exposure decreases rapidly with increasing distance from the source. The so-called "cordless phones," which have a base unit connected to the phone wiring in a house, typically operate at far lower power levels, and thus produce RF exposures far below the FCC safety limits.

4. What are the results of the research done already?

The research done thus far has produced conflicting results, and many studies have suffered from flaws in their research methods. Animal experiments investigating the effects of radiofrequency energy (RF) exposures characteristic of wireless phones have yielded conflicting

results that often cannot be repeated in other laboratories. A few animal studies, however, have suggested that low levels of RF could accelerate the development of cancer in laboratory animals. However, many of the studies that showed increased tumor development used animals that had been genetically engineered or treated with cancer-causing

chemicals so as to be predisposed to develop cancer in the absence of RF exposure. Other studies exposed the animals to RF for up to 22 hours per day. These conditions are not similar to the conditions under which people use wireless phones, so we don't know with certainty what the results of such studies mean for

human health.

Three large epidemiology studies have been published since December 2000. Between them, the studies investigated any possible association between the use of wireless phones and primary brain cancer, glioma, meningioma, or acoustic neuroma, tumors of the brain or salivary

gland, leukemia, or other cancers. None of the studies demonstrated the existence of any harmful health effects from wireless phone RF exposures. However, none of the studies can answer questions about longterm exposures, since the average period of phone use in these studies was

around three years.

5. What research is needed to decide whether RF exposure from wireless phones poses a health risk?

A combination of laboratory studies and epidemiological studies of people actually using wireless phones would provide some of the data that are needed. Lifetime animal exposure studies could be completed in a few years. However, very large numbers of animals would be needed to provide reliable proof of a cancer promoting effect if one exists. Epidemiological studies can provide data that is directly applicable to human populations, but 10 or more years follow-up may be needed to provide answers about some health effects, such as cancer. This is because the interval between the time of exposure to a cancer-causing agent and the time tumors develop - if they do - may be many, many years. The interpretation of epidemiological studies is hampered by difficulties in measuring actual RF exposure during dayto- day use of wireless phones. Many factors affect this measurement, such as the angle at which the phone is held, or which model of phone is used.

TIA Safety Information

6. What is FDA doing to find out more about the possible health effects of wireless phone RF?

FDA is working with the U.S. National Toxicology Program and with groups of investigators around the world to ensure that high priority animal studies are conducted to address important questions about the effects of

exposure to radiofrequency energy (RF).

FDA has been a leading participant in the World Health Organization International Electromagnetic Fields (EMF) Project since its inception in 1996. An influential result of this work has been the development of a detailed agenda of research needs that has driven the establishment of new research programs around the world. The Project has also helped develop

a series of public information documents on EMF issues. FDA and the Cellular Telecommunications & Internet Association (CTIA) have a formal Cooperative Research and Development Agreement (CRADA) to

do research on wireless phone safety.

FDA provides the scientific oversight, obtaining input

TIA Safety Information

from experts in government, industry, and academic organizations. CTIA-funded research is conducted through contracts to independent investigators. The initial research will include both laboratory studies and studies of wireless

phone users. The CRADA will also include a broad assessment of additional research needs in the context of the latest research developments around the world.

7. What steps can I take to reduce my exposure to radiofrequency energy from my wireless phone?

If there is a risk from these products--and at this point we do not know that there is--it is probably very small. But if you are concerned about avoiding even potential risks, you can take a few simple steps to minimize your exposure to radiofrequency energy (RF). Since time is a key factor in how much exposure a person receives, reducing the amount of time spent using a wireless phone will reduce RF exposure.

- If you must conduct extended conversations by wireless phone every day, you could place more distance between your body and the source of the

RF, since the exposure level drops off dramatically with distance. For example, you could use a headset and carry the wireless phone away from your body or use a wireless phone connected to a remote antenna. Again, the scientific data do not demonstrate that wireless phones are harmful. But if you are concerned about the RF exposure from these products, you can use measures like those described above to reduce your RF exposure from wireless phone use.

8. What about children using wireless phones?

The scientific evidence does not show a danger to users of wireless phones, including children and teenagers. If you want to take steps to lower exposure to radiofrequency energy (RF), the measures described above would apply to children and teenagers using wireless phones.

Reducing the time of wireless phone use and increasing the distance between the user and the RF source will reduce RF exposure. Some groups sponsored by other national governments have advised that children be discouraged from using

wireless phones at all. For example, the government in the United Kingdom distributed leaflets containing such a recommendation in December 2000. They noted that no evidence exists that using a wireless phone causes brain tumors or other ill effects.

Their recommendation to limit wireless phone use by children was strictly precautionary; it was not based on scientific evidence that any health hazard exists.

9. What about wireless phone interference with medical equipment?

Radiofrequency energy (RF) from wireless phones can interact with some electronic devices.

For this reason, FDA helped develop a detailed test method to measure electromagnetic interference (EMI) of implanted cardiac pacemakers and defibrillators from wireless phones.

This test method is now part of a standard sponsored by the Association for the Advancement of Medical Instrumentation (AAMI). The final draft, a joint effort by FDA, medical device manufacturers, and many

TIA Safety Information

other groups, was completed in late 2000. This standard will allow

manufacturers to ensure that cardiac pacemakers and defibrillators are

safe from wireless phone EMI.

FDA has tested hearing aids for interference from handheld wireless phones and helped develop a voluntary standard sponsored by the Institute of Electrical and Electronic Engineers (IEEE). This standard specifies test methods and performance requirements for hearing aids

and wireless phones so that no interference occurs when a person uses a "compatible" phone and a "compatible" hearing aid at the same time.

This standard was approved by the IEEE in 2000. FDA continues to monitor the use of wireless phones for possible interactions with other medical devices. Should harmful interference be found to occur, FDA will conduct testing to assess the interference and work to resolve the problem.

TIA Safety Information

10. Where can I find additional information?

For additional information, please refer to the following resources:

- FDA web page on wireless phones
(<http://www.fda.gov/cdrh/phones/index.html>)
- Federal Communications Commission(FCC)RF Safety Program
(<http://www.fcc.gov/oet/rfsafety>)
- International Commission on Non-Ionizing Radiation Protection
(<http://www.icnirp.de>)
- World Health Organization(WHO) International EMF Project
(<http://www.who.int/emf>)
- National Radiological Protection Board(UK)
(<http://www.nrp.org.uk/>)

FCC RF Exposure Information

Contact your local dealer for a replacement of antenna.

FCC Part 15 Class B Compliance

This device and its accessories comply with part 15 of FCC rules.

Operation is subject to the following two conditions:

- (1) This device and its accessories may not cause harmful interference, and (2) this device and its accessories must accept any interference received, including interference that may cause undesired operation.

FCC RF Exposure Information

WARNING!

The antenna used for this transmitter must not exceed 3.0dBi and must be installed to provide a minimum separation distance of 20 cm from all persons.

CAUTION

Use only the supplied and approved antenna. Use of unauthorized antennas or modifications could impair call quality, damage the phone, void your warranty and/or result in violation of FCC regulations. Do not use the phone with a damaged antenna. If a damaged antenna comes into contact with skin, a minor burn may result.

Limited Warranty Statement

Limited Warranty Statement

LG ELECTRONICS Inc. represents and warrants that this subscriber unit and its accessories ("PRODUCT") is free from defects in material and workmanship.

This warranty is subject to the following terms and conditions;

1. This warranty of the PRODUCT extends for a period of 12 months commencing from the date of the activation or 16 months from the date of manufacture whichever is less, except for the battery, for which the warranty is 9 months from the date of activation or 12 months from the date of manufacture whichever is less.
2. During the warranty period, LG ELECTRONICS Inc. or its authorized service network will repair or replace, at LG ELECTRONICS Inc.'s option, the PRODUCT or any relevant parts thereof in the event that the

PRODUCT is found to be defective.

The repaired PRODUCT or the Product/part provided as a replacement for a defective

PRODUCT/part, shall be free from defects. The END USER/consumer purchaser of the PRODUCT or his/her assignee ("CONSUMER") shall not be charged (whether for parts, labour or otherwise) for the repair or replacement of a defective PRODUCT during the warranty period. All replaced parts, boards or equipment shall become

the property of LG ELECTRONICS Inc.

3. The warranty in respect of a repaired or replaced PRODUCT/part shall extend for the remaining warranty period of the repaired PRODUCT or replacement thereof to the CONSUMER.
4. Upon request from LG ELECTRONICS Inc., the CONSUMER may be required to provide the purchase receipt or other documentation or information in respect of the date and place of purchase.
5. The CONSUMER shall have no coverage or benefits under this warranty in the event that any of the following conditions are applicable:

(a) The PRODUCT has been subject to abnormal use or conditions, improper storage, exposure to excessive moisture or dampness, exposure to

excessive temperatures, unauthorized modifications, unauthorized repair (including but not limited to use of unauthorized spare parts in repairs), abuse, accident, Acts of God, spills of food or liquids, improper installation and breakage or damage to antennae (otherwise than by reason of any defects in material or workmanship).

(b) LG ELECTRONICS Inc. has not been notified by the CONSUMER of the defects of the PRODUCT during the applicable warranty period.

(c) The PRODUCT serial number code or the accessory date code has been removed, defaced or altered.

(d) The PRODUCT has been used with or connected to an accessory (i) not supplied by LG ELECTRONICS Inc. or its affiliates, (ii) not fit for use with the PRODUCT or (iii) used otherwise than in the manner intended.

(e) The seals of the PRODUCT'S battery enclosure have been broken or show evidence of tampering or the PRODUCT'S battery has been used in equipment other than that for which it has been

Limited Warranty Statement

specified usable by LG ELECTRONICS Inc.

(f) All plastic surfaces and all other externally exposed parts that are scratched or damages due to normal customer use.

(g) Breakage or damage to antenna unless caused by defects in material or workmanship.

6. In order to derive benefits of this warranty in respect of any defects in the

PRODUCT, the CONSUMER shall ship the PRODUCTS or part thereof at its cost to the authorized service center of LG ELECTRONICS Inc. LG

ELECTRONICS Inc.

shall bear the cost of shipping the PRODUCT or part thereof back to the

CONSUMER after the completion of the service under this limited warranty.

Limited Warranty Statement

NO OTHER EXPRESS WARRANTY IS APPLICABLE TO THIS PRODUCT. THE DURATION OF ANY IMPLIED WARRANTIES, INCLUDING THE IMPLIED WARRANTY OF MARKETABILITY OR MERCHANTABILITY OR FITNESS FOR A PARTICULAR PURPOSE OR USE IS LIMITED TO THE DURATION OF THE

EXPRESS WARRANTY HEREIN. LG ELECTRONICS Inc. SHALL NOT BE LIABLE FOR THE LOSS OF USE OF THE PRODUCT, INCONVENIENCE, LOSS OR ANY OTHER CONSEQUENTIAL DAMAGE, ARISING OUT OF THE USE OF, OR INABILITY OF USE, OF THIS PRODUCT OR FOR BREACH OF ANY EXPRESS OR IMPLIED WARRANTY, INCLUDING THE IMPLIED WARRANTY OF MARKETABILITY OR MERCHANTABILITY OR FITNESS

APPLICABLE TO THIS PRODUCT.

THE CONSUMER UNDERSTANDS THAT LG ELECTRONICS INC. HAS EMBEDDED RELIANCE SOFTWARE AND ITS NETWORK PARAMETERS IN THE PRODUCT. IN CASE THE CONSUMER DELETES,

REMOVES, ALTERS OR MODIFIES SUCH SOFTWARE AND THE PARAMETERS AND/OR INSTALLS ANY THIRD PARTY SOFTWARE, THE WARRANTY AND REMEDIES HEREUNDER

SHALL NOT BE AVAILABLE TO THE CONSUMER.

7. It is hereby expressly clarified that all warranties (express or implied) in respect of the PRODUCT are provided by LG ELECTRONICS Inc. alone.

Authorized LGE Service Center List

Sr	Circle	City Name	ASCs	Address Person	Contact	Phone
1	Andhra Pradesh	Guntur	Vasavi Associates Guntur-522003	Door no 6-20-4, Swarnalok complex, 4/1 Arandal Pet,	MR.Satyam	0863-2233678, 9848105789, 0863-3155554
2	Andhra Pradesh	Hydrabad	Sri Varun Electronics	D.No 5-8-344/1, " DHAN BHAGYA ESTATE ", Chirag Ali Lane, Abids, Next to Raghava Ratna Towers, Hyderabad - 500 001	Mr.Raghavendra	040-55781999, 040-55253888, 040-56878822, 040-31001463
3	Andhra Pradesh	Hydrabad	JVR Infotech Pvt Ltd	Shop No 8 ,Vaniya Vihar, Nalanda Building, Dilsukh Nagar Main Road, Hyderabad-500060	EV Ramakanth	040-24161848, 040-55109604, 040-56524157, 040-31131067, 040-36060606
4	Andhra Pradesh	Hydrabad	S V Electronics	Shop No. 41, Nilagiri Block, Aditya Enclave, Ameerpet Main Road, Hyderabad-500038	Mr.Vanktेशwara Rao	040-55754477, 55343030
5	Andhra Pradesh	Hydrabad	Reliable Communication	G-8, 3-6-561, AALTO'S A & M Trade Centre, HIMAYATNAGAR, HYDERABAD - 500029	Mr Mahesh Heda	040-30913251, 040-31045556, 09849251173
6	Andhra Pradesh	Kurnool	R K LG WLL	#40-37-11, Opp. Indian Bank, Near Balaji Hotel, Kurnool- 518002.	Mr.G Rama Krishna	08518-220201, 08518-310688
7	Andhra Pradesh	Nellore	Siri Enterprises	Opp.Archana Thearter,A C Centre,Nellore PIN-524001	Mr.Paraveen	0861-3209571, 0861-3100309
8	Andhra Pradesh	Rajamund-hary	Siri Infotech	Police Welfare Complex, City Hospitals Junction, Danvai Pet Main Road, Rajhamundry-533103	Mr Raghvendra	0883-2421567, 0883-3125799
9	Andhra Pradesh	Secunderabad	Shweta Computers	# 1-7-69/1 & 2, OPP Aditya Delux Hotel,Near Paradise circel Sarojini Devi Road, Secunderabad - 500003	Mr.Jagdish	040-55334180, 040-27721076, 040-36532358, 040-31041673
10	Andhra	Tirupathi	CMT Computer	18-1-624 VV Mahal Road, OPP HDFC BANK,	Mr.K Vasu Naidu	0877-5561979,

LGE ASC List

Sr	Circle	City Name	ASCs	Address Person	Contact	Phone
	Pradesh		Services	Tirupathi, PIN-517501	0877-3120209	
11	Andhra Pradesh	Vijaywada	K L Computer House	39-9-46 SVS Temple Street, Labbipet, Vijaywada PIN- 520010	Mr.Kartik	0866-5520461, 5671461, 0866-3105222
12	Andhra Pradesh	Visakha -patnam	S V Electronics	D No.30-15-111, Daba Garden, Main Road, Visakhapatnam PIN-530020	Mr.Nani	0891-2598610, 0891-2706074, 0891-3706074
13	Andhra Pradesh	Warrangal	S S Marketers	6-1-73/1, Sai Bhavan, Sridevi Theatre Road, Hanamkonda, Warrangal-506001	Mr.L.Srinivas Rao	0870-2552223, 0870-3100708
14	Bihar	Jamshedpur	Tirupati Teletech	Chakravarti Compound, Near Hotel Castel, Contractors area, Bistupur, Jamshedpur-831001	Abhijeet Mukherjee	0657-3100350
15	Bihar	Patna	Infotek Trading Company	1st floor, City Palace, New Dak Bunglow Road, Patna-800001	Sanjay Chowbey	0612-2227166
16	Bihar	Ranchi	Satya Systems	158, Opp Hotel Palace, Kadru, Ranchi-834002& Solutions	Amit Rastogi	0651-2341361, 667
17	Delhi	Delhi	Comhard Systems	D-30, 31, First floor, Near Hotel Shipra, Main Vikas Marg, Lakshmi Nagar	Mr Ravi Kant Gupta	011-30955887, 9818867678
18	Delhi	Delhi	Innovative Telecom	305, Aggarwal Millenium Tower, Netaji Subash Place, Pitam Pura, Delhi-110088	Mr Manoj Garg	011-55154343, 9811682453, 1130925753
19	Delhi	Delhi	Sagar Technologies	W-8, First Floor, Main Patel Road, West Patel Nagar, New Delhi- 110008	Mr Deepak/ Mr Amit	9810320170 011 55433100
20	Delhi	Delhi	Sagar Technologies	J-39, Central Mkt, Lajpat Nagar-II, New Delhi - 110024	Mr Prabhat	1155186929, 9350224692
21	Delhi	Delhi	Ucom Technologies Pvt Ltd.	45, 1st Flr, Corner Mrkt, Malviya Nagar, New Delhi - 110017	Bhuwan Chandra	011-26675900, 55655382, 011-33088818
22	Delhi	Delhi	Nice Tele -communication	15/23, First Floor, DDA Complex, Nangal raya, D Block, Janakpuri, Delhi - 110046	Ripul Garg	011-28521044, 9810778310
23	Delhi	Delhi	Touch Tone Telecom	B-52, First Floor, Kalkaji, New Delhi	Ashish Dey	11 30939031
24	Delhi	Delhi	Cube Engineers	A-65, Naraina Industrial Area, Phase-1, New Delhi	Atul Gupta	011-31004103,

LGE ASC List

Sr	Circle	City Name	ASCs	Address Person	Contact	Phone
				and Consultants Pvt Ltd		011-55450272, 51411623
25	Delhi	Delhi	Comhard Systems	B-120, Hardev Puri, 100 Feet Main Road, Near MTNL Office, Nathu Colony Chowk, Shahdra, New Delhi - 110093	Mr. Ravi Kant Gupta.	011-39572430, 011-39572427
26	Delhi	Delhi	R K Communications	2516 Hudson Lines , Kingsway Camp-Nr. Kamla Nagar , New Delhi	Mr. Pradeep Aggarwal	011-35908861
27	Gujarat	Ahmedabad	Visual Enterprises	104, Saarthak Complex, behind Urja House, Swastik Char Rasta, Navrangpura, Ahmedabad-380009	Mirza Patel	079-6438609, 31037582
28	Gujarat	Ahmedabad	Silicon Valley	F/6, Silver lake, Jagabhai Park, Rambaug Road, Maninagar, Ahmedabad -380008	Rajesh Patel	079-5430634, 36163645, 9824025430
29	Gujarat	Ahmedabad	Mishree Communication	75, Management Enclave, Opp. Indraprastha Bungalows, Vastrapur, Ahmedabad	Mitesh Patel	079-31037582, 079-30920724
30	Gujarat	Ahmedabad	A Com Technologies	Shop No-40, 1st Floor, Shubh Complex, Near Rajasthan Hospital, Camp Road, S habibaug, Ahmedabad-380004	Vijay.S.Gohel	9824544230
31	Gujarat	Bhavnagar	Teletext Gold	G/8, Radheshyam Complex, Radha Mandir, Vaghavadi Road, Bhavnagar-364001	Nilesh Bagadia	0278-2415545, 9825206498
32	Gujarat	Gandhinagar	Creative Communications	Shop No 102, Suman City, Sector 11, Gandhinagar-382011	K.J.Barot	079-23226241, 9825059590
33	Gujarat	Jamnagar	Sudarshan Infosys	3, Prerna Building, Cricket Bunglow-3, Indira Nagar, Jamnagar	Amit Unadkat	0288-2552696, 9824478203
34	Gujarat	Rajkot	Roopang infocare	Vinod Nivas, 4, Sardarnagar (West), Nr Astron Cinema, Rajkot-360001	Kalpesh Rugani	0281-2464485, 3103622, 9824068880
35	Gujarat	Surat	Excel Solutions	G-48, Ascon Plaza, Anand Mahal Road, Adajan Surat-395009	Nitesh Ghosal	0261-5544500, 3344500, 9825399870
36	Gujarat	Surat	Omsai Services	37, Golden Point, Near Science Laboratory, Ring Road, Surat -394003	Dharmesh Patel	(0261)3110610
37	Gujarat	Vadodra	Aashnik Infotech	F 50, National Plaza, R.C. Dutt Road, Alkapuri, Vadodra-390005	Aashish Parmar	0265-2323216, 3090969, 3112123

LGE ASC List

Sr	Circle	City Name	ASCs	Address Person	Contact	Phone
38	Haryana	Ambala	Bee Ess Aar Communication	92-93, Gandhi market, Ambala Cantt-133001	Rajiv Gupta	0171-2641234, 9416021234
39	Haryana	Faridabad	Hi - Tech Communication	105, Sector 10, Faridabad-121006	Rahul Jindal	0129-2223422, 9810456665
40	Haryana	Gurgaon	Signature Communications	B-100 A , South City -1 , Opposite - Huda Gymkhana Club - Gurgaon 122001	Raj Kumar Garg	0124-3097955, 9811465111, 0124-3956565
41	Haryana	Karnal	Mass Communication	7, Dayal Singh Colony, Kunj Pura Road, Karnal -132001	Ms Pinki	0184-3090717, 09896354205
42	Haryana	Panipat	INS Telecom	2,Bishan Sarup Colony, Opp Bus Stand, Near Hotel Deep, Panipat	Jagdeep Sachdeva	0180-3091860, 5005360, 9812072860
43	Haryana	Rohtak	Telecentre	Shakti Market, Civil Hospital Road, Near Chhotu Ram Chowk, Rohtak-124001	Mr.Madaan	01262-247242, 9896243092, 01262-371666
44	Haryana	Sonipat	Teleworld	Ground Floor, Main Market, Main Railway Road, Opp. Old Civil Hospital, Sonipat - 138001	Vipin Dua	1303090889
45	Karnataka	Bangalore	Meenakshi Electronics	#129,Lalbagh Main Road, Bangalore-560027	Mr. Ramesh.	080-56992943, 30617345, 31810375, 51146822
46	Karnataka	Bangalore	Optima Mobile Services	591-B, Dr Rajkumar road, 2nd block, Rajajinagar, Bangalore-560010	Unni Krishnan	080-3131953, 8031866656
47	Karnataka	Bangalore	Optima Mobile Services	B-3, Mallikarjun Complex, Opp R T Nagar Police Station, 80 Feet Road, R T Nagar, Bangalore-560032	Prasad	080-30610202
48	Karnataka	Bangalore	Pranav infocom	91/92 ,Hemachandra complex,Near VGP Show room, 4th block,jayanagar, Bangalore-560011	S.V.Sirish	080-56697937, 31860269, 26552551
49	Karnataka	Bangalore	Pranav infocom	267/1,1st Main Road,6th Cross, Behind Shanti Sagar, Domlur Layout, Bangalore-560071	S.V.Sirish	80- 56969937, 51256309
50	Karnataka	Bangalore	Ascent Communication	No:113, St Johns Church road,Bangalore - 5	Naveen	080-30914856

LGE ASC List

Sr	Circle	City Name	ASCs	Address Person	Contact	Phone
51	Karnataka	Belgaum	Hello India Telecom	G-4,Maratha Mandir Complex, Khanapur Road, Near Railway Flyover, Belgaum - 590001.	Sanjay	9845327531, 0831-3101800, 2420533
52	Karnataka	Hubli	Networld	shop no : B6, Laxmi complex, Court circle , Hubli- 580020	Mr.Mahendar	0836-3090671, 98452-54251, 0836-3090671
53	Karnataka	Mangalore	City Talk Communication	GURU PLAZA, G-5, Near KSRTC Bus stand, Bejai, Mangalore - 575001	A V Prabhu	0824-3344528, 5277528
54	Karnataka	Mysore	K.K. Marketing	1432/9, Tribhuvan Towers, opp Vetenary Hospital, Dewan's Road, Dhanwantri Road Cross, Mysore -570001	Mr. Karunakaran	0821-3115003, 821 3120789
55	Kerala	Ernakulam	Zenicon Infocom(P) limited	2nd floor, Tharian's Building,opp. Ship Yard, M.G. Road, Ernakulam -682015	Jaimon Joseph	0484-2359511, 9349271511
56	Kerala	Irinjalakuda	Akbar Mobiles	376-44, Near St. Josephs college junction, Irinjalakuda-680121	Mr Sebastian	0480-830796
57	Kerala	Karuna-gapally	Supreme Enterprises	Opp to KSRTC Bus stand,Karunagapally -690518	Mr. Ratish	0476-2620282
58	Kerala	Kollam	Digital Infosystems	MC-3087, New Block, Bishop Jeromi Nagar, Chinnakada, Kollem-691001	Johnson Lawrence	0474-2760647, 9846007059
59	Kerala	Kottayam	SVM Technologies	NSS Bulbing, Near Pallippurathukavu Temple, Kodimapha, Kottayam- 686002	Rajesh K S	0481-2565303, 9847310123
60	Kerala	Kozhikode	Domain Infosystems	Domain Infosystems, 2nd Floor, Darussalam Complex, Mavoor Road, Kozhikode - 673004	Mukundan	0495-2722222
61	Kerala	Manjeri	Akbar Mobiles	16-870A, Ooty Road, Manjeri-676121	Mr Harry	0483-2766835
62	Kerala	Mavellikarra	Ettutharayil Agency	Ettutharayil complex, K P Road,Kayamkulam -690502	Anu T cheriyan	0479-2441760, 0479-3100025
63	Kerala	Pallakad	Akbar Mobiles	N.S. Towers,Kalamandapam junction, Palakkad - 678001	Suresh	0491-2529829, 9847086446
64	Kerala	Thiruvananthapuram	Appolo Systems	TC 20/2392, Kalpalayam, Karamana P.O., Thiruvananthapuram	Santosh	0471-2340523
65	Kerala	Tirur	Akbar Mobiles	7-2,Ancila Building, Terivazhiambalam, Tirur - 676101	Mr Byju	0494-2427444
66	Kerala	Trichur	Akbar Mobiles	Kadarathodh Building, North Bus stand, Trichur - 680 001	Sojan	0487-2323424
67	Madhya Pradesh	Bhopal	Neha Sales Corporation	F-104, Anmol Tower, E-5/14, Commercial Zone, Arera Colony, Bhopal-462016	Ashok Hirwani	0755-5277247, 2424088.

LGE ASC List

LGE ASC List

Sr	Circle	City Name	ASCs	Address Person	Contact	Phone
						9826072327
68	Madhya Pradesh	Gwalior	Computer Clinic	Global Appartments, City Centre, Opp Income Tax Office, Gwalior	Rishi Sharma	0751-3202200
69	Madhya Pradesh	Indore	Neha Sales Corporation	M-8,Mezanine Floor, Akash Deep Shopping Complex, Sneha Nagar, Sapana Sangeeta Road, INDORE - 452001 (M.P)	Ashok Hirwani	0731-5091833, 9826072327
70	Madhya Pradesh	Jabalpur	S M Shopee	846, Chattarpur Bhavan, Nr. Ashoka Hotel, Wright Town, Jabalpur, Pin 482002	Vikas Jain	0761-5063183
71	Madhya Pradesh	Raipur	Cybernet Systems	B-2,1st Floor, Garchaz Complex, Jail Road, Raipur - 492001	Anand Singh	0771-2524033, 9826132918
72	Maha rashtra	Amravati	Scorpio Services	Shop No. 84, Ground Floor, Gulshan Towers, Nr. Panchasheel Cinema, Amravati, Pin-444601	Mr. Pramod	0721-2567302, 0721 3151826, 9422156874
73	Maha rashtra	Aurangabad	Unique Teletmatics	Shop no.108/B, Behind Sajawat Handloom, Tapdiya Super Market, Nirala Bazar, Aurangabad-431001	Mr. Mahesh	0240-2356447, 9823007730, 0240 3110364
74	Maha rashtra	Chinchwad (Pimpri)	Ritz Communication	Shop No 22, Gawde Kunal garden, Pimpri-Chinchwad Link Road, Chinchwad, Pune-411033	Mr Reyaz	020-7485613, 020 31029777, 020 30961900, 09890339777
75	Maha rashtra	Kohlapur	SMS Services	S5, Diwan Tower, Opp. Nutan Marathi School, Near Mirajkar Tikky, Kohlapur, Pin -416005.	Prakash Patil	0231-2541120, 9823026120
76	Maha rashtra	Margao	Comlink Synergies India Pvt Limited.	Ground Floor, Shop No. i, Garden view building, Next to UTI Bank, Near Margao Municipal Garden, Margao-403601	Sunil	0832 3105629, 9822101522, 0832 3105637
77	Maha rashtra	Nagpur	Spectrum Marketing	Shop No.2, Dharampeth Towers, West High Court (WHC) Road, Dharampeth, Nagpur - 440010	Sonali	0712-3095700, 5618186, 2527823
78	Maha rashtra	Nasik	MOBS Associates	SHOP NO. 12, FIRST FLOOR, 'KAPOTE-MEHER' MARKET, RENUKA NAGAR, WADALA NAKA, DAWRKA, NASIK- 422001	Girish Bhangre	0253-5623613, 0253-3291070, 0253-3331078
79	Maha rashtra	Panjim	Comlink Synergies India Pvt Ltd	Shop No.5, Dr Atmaram Borkar Road, Next to RIL Mutual Fund, Panjim, Goa-403001	Sunil	0832-3105629

LGE ASC List

LGE ASC List

Sr	Circle	City Name	ASCs	Address Person	Contact	Phone
80	Maha rashtra	Pune	Digital Concepts	Shop No. 5, Indulal Complex, Besides Kaka Halvai, LBS Marg, Navi Peth, Pune-411030	A Ahmed	020-4012921, 020 31029798
81	Maha rashtra	Sangli	Ramesh Electronics	Opp. Kanya Purohit prashala, Rajwada, Sangli-416416	Suresh Shegane	0233-2327601, 9823085176, 0233 3107601
82	Maha rashtra	Solapur	Jawaharlal Radio Service	184, Gold Finch Peth, nr Hotel Ritesh, Solapur- 413007	Prasanna J Chavan	0217-2725030, 9422458830, 9823317081
83	Mumbai	Kalyan	Vintech Solutions	SHOP- 14, GROUND FLR, ARCHIES APARTMENT, OAK BAUG, KALYAN -421301	Pawan	022-32977555
84	Mumbai	Vasai	E-Link Solutions	Shop No.5, Type C, Bldg no.5/6, Shanti Vihar, Mira Road -E, Pin Code : 401107	Kamlesh	022-28552087, 022-33482084
85	Mumbai	Mumbai	Everest International Pvt Ltd	SHOP NO 6 AMBIKA COOPERATIVE HOUSING SOCIETY, JAWAHAR NAGAR ROAD NO 2 NEAR RAILWAY CROSSING, GOREGAON WEST, MUMBAI 400062	Chetan	022-56299540, 39533603, 9820188338
86	Mumbai	Mumbai	LG Service Centre	Third Floor, Trade World, Kamala Mills Compound, Senapati Bapat Marg, Lower Parel, Mumbai -400013	Rajib Saha	022-24947375, 022 33490401
87	Mumbai	Navi Mumbai	LG Service Centre-DAKC	A Block, Ground Floor, Dhirubhai Ambani Knowledge City, Navi Mumbai-400709	Rajnish	022-30388052, 022-33490405
88	Mumbai	Thane	Vinay Technologies Pvt Ltd	Shop no 3, Minal Chhaya Aptt, Municipal Corporation Road, Panch Pakhadi, Thane (W) - 400601	Vinod Jakotiya	022-25304960, 9821068231, 022-31013342
89	Mumbai	Navi Mumbai	Hello World	Shop No 53, CF, Welfare Chambers, Sector-17, Vashi, Mumbai-400703	Mahesh	022-27657705, 022 32741396
90	Mumbai	Khar(W)	Komplex Telecom Corporation	1, Satguru Shopping Center, Illrd road, Khar(W), Mumbai	Mr Mohammad	022-26461917, 34195024
91	Mumbai	Panvel	Oceanic Tele System	Shop No.10, Prajapati Arcade, Sector 15, New Panvel (E), Dist. Raigad.	Shailash Bobade	022-56104542, 022-31017221
92	Orissa	Bhubr neshwa	S.A.INFOSYS	291.Bomikhal, Opp. Akamra cinema hall, Bhubaneswar-751010	Sarabjeet Singh	0674-2573113/4

LGE ASC List

Sr	Circle	City Name	ASCs	Address Person	Contact	Phone
93	Orissa	Cuttack	O.A.	Behind Govt Bus Stand, Badambadi, Cuttack INFOTECH	Manas Mahapatro	0671-2312613-753012
94	Punjab	Amritsar	Bajaj Telecommuni-cation	87, G Floor, Nehru Complex, Lawrence Road, Amritsar-143001	Suman Bajaj	0183-3124827, 9814650314
95	Punjab	Barnala	Unique Infotech	Mittal Street, Near M C Office, Barnala-148101	Pankaj Goyal	01679-238007, 01679-310667
96	Punjab	Bathinda	Lalli's Electronic Gallery	1139-A, First Floor, Amrik Singh Road, Nr Gole Digg, Bhatinda-151005	Ashok Kakria	0164-2239500, 2236337, 9814222310
97	Punjab	Chandigarh	Vignesh Services	S.C.O- 189-90, Sec- 34, Chandigarh	Mukesh Arya	0172-3018028, 09316134655
98	Punjab	Hoshiarpur	Kuldip's Mobile Care	Dhobian Wali Gali, Phagwara Road, Hoshiarpur-146001	Kuldip	01882-226906, 9815073906
99	Punjab	Jalandhar	Mobile Center	Shop No-7, Gobind Market,,Opp-Beri Hospital, Nakodar Road,Jalandhar	Jogesh Diwan	0181-3092666, 9814029696, 9815314060
100	Punjab	Ludhiana	Shahi Communication	Shop No.5, 4X International, 583 L, Model Town, Ludhiana	Amit Shahi	0161-3944190
101	Punjab	Malerkotla	Prime Infocomm	Opp. Main gate, Govt College, Malerkotla -148023	Raj Verma	01675-253899, 9814040066, 01675-331979
102	Punjab	Moga	Super Communication	Pawan Market, Opp shankar Batteries, Court Road, Moga-142001	Jai Deep Mehta	01636-314398
103	Punjab	Patiala	Image Services	84, First Floor, Leela Bhawan, Patiala-147001	Rohit Bansal	0175-2222796, 9814040066
104	Rajasthan	Jaipur	Kamakshi Telecom	105, 1st floor, Paradise, C-61 (A), Sarojini Marg, C-Scheme, Jaipur-302001	Rahul Bhargav	0141-2365575, 0141-3112863
105	Rajasthan	Jaipur	Alpha Infotech Systems	F-1, First Floor, Krishna Mall, Lakshmi Mandir Crossing, Tonk Road, Jaipur-302015	Shatrughan Mangal	0141-5106777, 9829077136, 0141-3099724
106	Rajasthan	Jodhpur	Omega Electronics	UG/4, Adeshwar Tower, Main Chopasani Road,	Pratap Singh	0291-3091214, 3117171

LGE ASC List

Sr	Circle	City Name	ASCs	Address Person	Contact	Phone
				Opp.Gehlot Watch Co, Jodhpur-342003		
107	Rajasthan	Kota	Cyber Infosystems	26, Ground floor, Kalawati Paliwal market, Gumanpura, Kota-324007	Shyam Maheshwari	0744-2398153, 07443103354, 07443320153
108	Rajasthan	Udaipur	Ficusa Enterprises	13.Darshanpura.Opp.M.B.Commerce CollegeGate, Nr Computer Zone, Udaipur-313002	Virendra Ranka	0294-2410002, 2413002, 3410002
109	Tamilnadu	Chennai	Unicare Infocomm Services	73, Nutech Plaza, Shop no G-3, G Floor, Arcot Road, Kodambakkam, Chennai - 600 024	R M Rajesh/ Kartik	044-24724666, 9841036466
110	Tamilnadu	Chennai	GS Systems	547/352, F M Towers, Mount Road, Nandanam, Chennai-6000035	Kanirajan	044-24330889, 9884160010
111	Tamilnadu	Chennai	U Com Tech -nologies Pvt. Ltd.	Shop #3, Door # 24, New #30, Balfour Apartments, Balfour Road, Kilpauk, Chennai - 600010	Shyam	044-52174656, 52175115, 9884187800
112	Tamilnadu	Chennai	Escomm Systems India P Ltd	No 57-7, Arunodaya Apartments Next to Hotel Sindhoori, Near by Everest Bus Stop, Ponnmalai High Road, Chennai-600003	Mrs N S Vijaysri	044-30901688, 25612212
113	Tamilnadu	Chennai	Genesis Communication	63/3, First main road, Gandhi Nagar, Adyar, Chennai-600020	Mr Suresh	044-24401188
114	Tamilnadu	Coimbatore	Fast Track	Sudera Complex, 354B, 100 Feet Road, COIMBATORE - 641012	Anand Prakash	0422-2490577, 9843080040, 0422-3100080
115	Tamilnadu	Cuddalore	Kasturi Cellular Service	NO: 37 (2C) BHARATHI ROAD, CUDDALORE. 607 001, CUDDALORE DISTRICT, TAMIL NADU.	Mr Raghupati	04142 - 220183
116	Tamilnadu	Erode	JANS Electronics	148, Mettur Road, Opposite shakti vinayak temple, Dana Complex, Erode-638011	M Kanan	0424-2258526, 9443263508
117	Tamilnadu	Madurai	Devaa Electronics	No.4, Thirumakulam North Street, Near Ayyappan koil, Thhallakulam, Madurai-625002	Guna	0452-5360995, 0452-2526179 3107995
118	Tamilnadu	Pondicherry	Digital Logistics	126/2, Perumal Koil Street (Bharathi Street Cutting), Pondicherry-605001	G Singaravelu	9843093348, 0413-3155351, 0413-5210148

LGE ASC List

Sr	Circle	City Name	ASCs	Address Person	Contact	Phone
119	Tamilnadu	Salem	Global Care	262-A, Advitha Ashram Road, Salem - 636004	Vasudev Nayak	0427-2335787, 0427-3102124
120	Tamilnadu	Thanjavur	Z M Electronics	33,New Municipal Shopping Complex,Opp LIC,Gandhi ji road,Thanjavur-613001	Ziauddin	04362-272595, 04362-313254
121	Tamilnadu	Tirunevelli	Classic Electronic	39, Trivendrum Road, Opposite Kalimark, Welcome Complex, Palayamkottai, Tirunilveli-627002	Erkins	0462-2575801
122	Tamilnadu	Tirupur	Shri Vasavi Electronics	#155-303, Mangalam Road,Karuvam palayam, Tirupur -641604	MR.U.B. Bala Murali	0421-3091438, 98422-74300, 0421-3105560
123	Tamilnadu	Trichy	S K Electronics	Raj Complex, 9/A EVR Road, Puthur, Trichy- 620017	Krishnan	0431-2771946, 9843178104, 0431-3101502
124	Tamilnadu	Vellore	Matha Communication	4, S.L.N Plaza, Opposite Odai Pilliar Koil, Gandhinagar,Vellore - 632006	Gunaa Shekhar	0416-2240800
125	Uttar pradesh	Agra	NSC Computers	Shop No G-124, Block No- 29, Sanjay Place, Agra - 282002	Rajiv Singhal	0562-2520032, 562 3111350
126	Uttar pradesh	Agra	Space Consultancy & Services	UG 1 & 2, Opp. Jaihind Hotel, Merchant Chamber, Sadar Bazar, Agra-282001	Tanvir	9358311202
127	Uttar pradesh	Aligarh	A V Computer Services	G-1,Ganpati Plaza ,Jha Compund, Marris Rd, Aligarh-202001	Vaibhav	0571-2506148, 9412274391
128	Uttar pradesh	Allahbad	B.P.Electronics	G-11, Indira Bhawan, Ground Floor, Civil Lines, Allahbad-211001	Ms Naina Pandey	0532-2608088
129	Uttar pradesh	Bareilly	Sapan Infotech	G - 64 A Kunwar Complex, Near Gupta Watch Co, 116 Civil Lines,Bareilly	Sanjeev Singh	0581 - 3102467
130	Uttar pradesh	Dehradun	Krishna Communication	Shop No 15A, Meedo Plaza, Rajpur Road, Dehradun, Uttaranchal-248001	Vinod	135 3090895, 135 3112922 135 3119696
131	Uttar	Ghaziabad	Concessionair Documentation India Pvt Ltd(CDIL)	C-83, Rajnagar District(Center (RDC), Ghaziabad	Arun Sharma	0120-3092011
132	Uttar pradesh	Gorakhpur	Eternal Electronics	Shop No.11, Pandey Complex,33, Kasya Road, Opp DIG Bungalow, Gorakhpur -273001	Ram Pratap	0551-2204520

LGE ASC List

Sr	Circle	City Name	ASCs	Address Person	Contact	Phone
133	Uttar pradesh	Kanpur	AR Infotech	111/402 Ashok Nagar,Kanpur Pin 208012	Manoj Shukla	0512-3111662, 9839068734, 0512-3093011
134	Uttar pradesh	Lucknow	NET COM	3 way road, City Point, Opp Krishi Bhawan, Lucknow-226024	Kawaljeet	0522-3094222
135	Uttar pradesh	Meerut	Systech Computers	F-124/125 1st floor Ganga Plaza, Begum Bridge Road, Meerut-250002	Vineet Goyal	0121-2691167, 121 3116631
136	Uttar pradesh	Muza -farnagar	Jai Computer	Shop No. 4, 1st floor, Roorkee road, Near Shiv Chowk,Central Bank Mkt, Muzaffarnagar-251001	Manohar Singh	0131-2635483, 9412110215
137	Uttar	Noida	M R Telecom	J-45, First Floor, Sector-18, NOIDA-201301	Kailash Aggarwal	0120-2591440, 9871197801
138	Uttar pradesh	Saharanpur	Maharaj Communications	Near Maharaja Palace,Delhi Road, Saharanpur-247001	Pankaj Malhotra	0132-2720881, 132 3111202
139	Uttar pradesh	Varanasi	Shivam Mobile Distributers	Shop No.5,B37/115-B-1 Baradari Complex,Rathyatra Crossing, Varansi Pin 221010	Rishi Mohan	0542-2363296, 9839241004
140	W Bengal	Assansol	Sky Computer & Telecom	Islam Market, Nuruddin Road, Assansol-713301	Syed Arshad Ali	0341 - 2207719, 9832160886
141	W Bengal	Burdwan	San Infosys	Central Mkt, GT Road, Burdawan-713101	Sanjit Debnath	0342-3090265, 9832192170
142	W Bengal	Calcutta	Benma Infosol Pvt Ltd	P-168/1 CIT Road, Scheme VIII, KOLKATA 700067	Arun Surana	033-30943176/7
143	W Bengal	Calcutta	JP Computers	5B Ekdalia Place, Kolkata- 700019	Somim Kabir	033-24401923
144	W Bengal	Calcutta	Jaksom Engineering Pvt Ltd	Block-A, Shop-1, Ambika Vihar,1/1 Harduttrai Chamaria Road, Howrah- 711001	P.Mukherjee	033- 30950383
145	W Bengal	Calcutta	Skylink	8/1A, Little Russel Street, Calcutta-700071	HR Molla	033-30903814, 033-32091037
146	W Bengal	Durgapur	Tech International	Red Cross Road, City Centre, Durgapur-713216	Amitava Banerjee	0343-2546893, 9434002244

LGE CDMA Fixed Wireless Phone LSP-410R



Licensed by QUALCOMM Incorporated under one or more of the following Patents:
U.S. Patent No. 4,901,307 U.S. Patent No. 5,056,109 U.S. Patent No. 5,099,204
U.S. Patent No. 5,101,501 U.S. Patent No. 5,103,459 U.S. Patent No. 5,107,225

P/N : MMBB0204201

FEB/2006/ISSUE 1.0
PRINTED IN KOREA