

English
Español



RCB-100 User Manual

Bluetooth Mobile Wireless Remote Controller



Rev 1.0 US

All rights reserved.
LG Electronics Inc., 2012

Note: Please read all information carefully prior to using RCB-100 in order to prevent damages to the product and to enjoy the best performance.

WARNING :

This product contains chemicals known to the State of California to cause cancer and birth defects or reproductive harm.

Wash hands after handling.

Table of Contents

Introduction	3
- Included in the package	3
Name and Function	4
- Basic Remote Control Functions	4
How to Use	5
- Pairing Remote Control	5
- Function	5
- Replacing Remote Control Battery	6
Status Indicator	7
Q&A on Troubleshooting	7
Specification	8
Precautions	8
Declaration of Confirmation	9
Additional Information	9
Limited Warranty	11

The LG RCB-100 is a light weight wireless remote controller that uses Bluetooth® technology.

This product can be used as a remote controller accessory for devices supporting Bluetooth V4.0 and RCB-100 remote controller.

Included in the Package



RCB-100



Battery



User Manual



Warranty Card

Name and Function

ENG



Basic Remote Control Functions

The LG mobile wireless remote control RCB-100 with Bluetooth V4.0 provides the following basic functions.

Function	Operation	LED Status
Music		
Play/Pause song	Press the Select button once shortly for play or pause.	Green LED blinking once
Go to the next song	Press the Select button twice shortly.	Green LED blinking twice
Go to the first/previous song	Press the Select button three times shortly.	Green LED blinking three times
Camera		
Take photo	Enter into the camera mode on a mobile phone and press the Select button once shortly.	Green LED blinking once
Take video	Enter into the video mode on a mobile phone and press the Select button once shortly.	Green LED blinking once
Enter into camera mode	Press and hold the Select button for 2 seconds or longer and release the button. The mobile phone enters into the camera mode.	Green LED blinking four times
Receiving Call		
Answer an incoming call	When the mobile phone rings, press the Select button once shortly. (The default is speakerphone.)	Green LED blinking once
Searching Mobile Phone		
Make the phone ring	Press the Select button five times shortly when a mobile phone is connected to the RCB-100. You can hear the sound that notifies of the mobile phone location.	Green LED blinking five times

Note: The Bluetooth wireless remote control (RCB-100) works properly when the distance between a mobile phone and the remote control is within about 10 m.

Pairing Remote Control

- The wireless remote control works with a mobile phone that supports Bluetooth V4.0 and RCB-100 remote control function.
- You must pair the RCB-100 remote control with a mobile phone that supports a wireless remote control.

Pairing Remote Control

1. Insert a battery in a correct direction.
2. Press and hold the Select button of RCB-100 remote control for 6 seconds to enter into the pairing mode. The LED indicator is blinking red and green for 1 minute in turn and then the remote control enters into the pairing mode.
3. Turn on the Bluetooth device of the mobile phone. When you turn on the device, the Bluetooth setting icon is displayed on the home screen of the mobile phone.
4. Go to Menu > Settings > Bluetooth > Setting and then search for a device.
5. In the list of searched devices, select "LG RCB100" and pair with it.
6. If the remote control and mobile phone are successfully paired, the green indicator is blinking fast several times.

Note: If the connection is lost for 1 minute in the above step, the remote control exits the pairing mode.

Function

- The following functions work only when the remote control is connected to a mobile phone.

Music

- Press the Select button on the remote control once shortly to play or pause a song.
- Press the Select button on the remote control twice shortly to go to the next song.
- Press the Select button on the remote control three times shortly to return to the first or previous song.

Camera

- Open the basic camera on a mobile phone.
- Set the mode to Camera and press the Select button on the remote control once shortly.
- Set the mode to Video and press the Select button on the remote control once shortly.

Note: Music function is supported only in the basic music player of a mobile phone.

How to Use

Receiving Call

- When the mobile phone rings, press the Select button of the remote control once shortly. The default is speakerphone.

Notifying Mobile Phone Location

- This function helps to find a mobile phone when the remote control is connected to a mobile phone.
- Press the Select button on the remote control five times shortly, the mobile phone rings through its speakerphone and also vibrates.

Note: It may not work properly if the distance between the remote control and mobile phone is over 10 m, or the connection is lost since the Bluetooth signal between them is weak due to the wireless environment conditions.

Low Battery

- If a mobile phone is connected to the remote control and only the red indicator is blinking when you press the Select key, it means the battery level is low.
- Replace the battery with a CR2032 battery.

Replacing Remote Control Battery

- Remove the battery cover using a coin.
- Remove the battery from the remote control.
- Insert a new CR2032 battery with its positive pole (+) upward.
- Put the battery cover back on the remote control and tighten it using a coin.

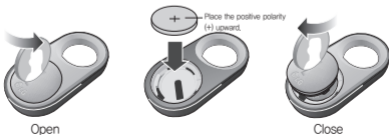

Note: The usage duration of RCB-100 may depend on the frequency of use.

Function	Status	Operation
Pairing mode	Power on	The red and green LEDs are blinking in turn.
Operation mode	Connected to a mobile phone	The green LED is blinking when using buttons.
	Not connected to a mobile phone	The red and green LEDs are blinking shortly when using buttons.
Low power notification	Power on	The red LED is blinking when using buttons.

Q&A on Troubleshooting

Problem	Inspection	Troubleshooting
Power fault	Check if the LED turns on during the button operation.	Replace the battery or insert it in a correct direction.
Not connected to a mobile phone	Check if the RCB-100 is under the pairing mode.	Press and hold the Select button for 6 seconds to switch the RCB-100 to the pairing mode.
	Check if a mobile phone supports the wireless remote control function.	Refer to the user manual of the mobile phone and check if a mobile phone supports the wireless remote control function.
Function not work	Check the connection to a mobile phone.	If the green and red LEDs are blinking once in turn when using buttons, it means the connection is lost. Try to connect again. Keep 10 meters distance when connecting RCB-100.

Specification

Item	Description
Bluetooth specification	Ver. 4.0 (Bluetooth Low Energy)
Frequency range	2.402 - 2.480 GHz
Battery	CR2032 3.0V primary cell
Usage duration	About 6 months (depending on the frequency of use)
IP rating	JIS IPX Level 4
Operating temperature	14°F ~ 140°F (-10°C ~ 60°C)
Dimension/Weight	30.7(W) x 59.5(L) x 12.5(H) mm / 14.9g

Precautions

Do not drop the device.

Do not modify, repair, or disassemble.

Do not expose directly to water, alcohol, benzene, etc for cleaning.

Do not expose directly to flammables.

Do not place or keep the device near flammables.

Keep the device away from excessive humidity and dust.

Do not place heavy objects on the device.

- Changes or modifications not expressly approved by the party responsible for compliance could void the user's authority to operate the equipment.
- There is a risk of explosion if the battery is replaced by an incorrect type.
- Dispose of used batteries according to the instructions.

FCC NOTICE TO USERS:

This device complies with part 15 of the FCC rules.

Operation is subject to the following two conditions:

- (1) This device may not cause harmful interference and
- (2) This device must accept any interference received, including interference that may cause undesired operation.

IMPORTANT NOTE:

To comply with the FCC RF exposure compliance requirements, no change to the antenna or the device is permitted. Any change to the antenna or the device could result in the device exceeding the RF exposure requirements and void user's authority to operate the device.

CE NOTICE TO USERS:

Hereby, LG Electronics Inc. declares that this RCB-100 is in compliance with the essential requirements and other relevant provisions of Directive 1999/5/EC.

 **Bluetooth®**  **1177**
FCC ID: BEJRCB100

Additional Information**1. Radio frequency exposure**

This Bluetooth Mobile Wireless Remote Controller, RCB-100, is a radio transmitter and receiver. When in operation it communicates with a Bluetooth® equipped mobile device by receiving and transmitting radio frequency (RF) electromagnetic fields (microwaves) in the frequency range 2.4 to 2.4835 GHz. The output power of the radio transmitter is low (0.001 watts). Your Bluetooth Mobile Wireless Remote Controller is designed to operate in compliance with the RF exposure guidelines and limits set by national authorities and international health agencies when used any compatible LG Electronics mobile phone.

2. Potentially explosive atmosphere

Turn off your electronic device when in any area with a potentially explosive atmosphere. Although this is uncommon, your electronic device could generate sparks. Sparks in such areas could cause an explosion or fire resulting in bodily injury or even death. Areas with a potentially explosive atmosphere are often, but not always, clearly marked.

3. Battery information

Do not expose the battery to extreme temperatures, never above +70°C(+158°F) or under -20°C(-4°F). For maximum battery capacity, use the battery at room temperature. If the battery is used in low temperatures, the battery capacity will be reduced. For your safety, Lithium coin batteries lodged in the esophagus should be removed immediately. Leakage, chemical burns and potential perforation can occur within hours of ingestion. Seek medical attention immediately.

4. Recycling the battery in your Bluetooth® headset

The battery in your Bluetooth Mobile Wireless Remote Controller must be disposed of properly and should never be placed in municipal waste. The LG Electronics service partner who removes the battery will dispose of it according to local regulations.

5. Conditions

- The warranty is valid only if the original receipt issued to the original purchaser by the dealer, specifying the date of purchase and serial number, is presented with the product to be repaired or replaced. LG Electronics reserves the right to refuse warranty service if this information has been removed or changed after the original purchase of the product from the dealer.
- If LG Electronics repairs or replaces the product, the repaired or replaced product shall be warranted for the remaining time of the original warranty period or for ninety (90) days from the date of repair, whichever is longer. Repair or replacement may involve the use of functionally equivalent reconditioned units. Replaced parts or components will become the property of LG Electronics.
- This Warranty does not cover any failure of the product due to normal wear and tear, or due to misuse, including but not limited to use in other than the normal and customary manner, in accordance with instructions for use and maintenance of the product. Nor does this warranty cover any failure of the

product due to accident, modification or adjustment, acts of God or damage resulting from liquid.

- This warranty does not cover product failures due to improper repair installations, modifications or service performed by a non- LG Electronics authorised person. Tampering with any of the seals on the product will void the warranty.
- THERE ARE NO EXPRESS WARRANTIES, WHETHER WRITTEN OR ORAL, OTHER THAN THIS PRINTED INCLUDING WITHOUT LIMITATION THE IMPLIED WARRANTIES OF MERCHANTABILITY OR FITNESS FOR A PARTICULAR PURPOSE, ARE LIMITED TO THE DURATION OF THIS LIMITED WARRANTY. IN NO EVENT SHALL LG ELECTRONICS OR ITS VENDORS BE LIABLE FOR INCIDENTAL OR CONSEQUENTIAL DAMAGES OF ANY NATURE WHATSOEVER, INCLUDING BUT NOT LIMITED TO LOST PROFITS OR COMMERCIAL LOSS, TO THE FULL EXTENT THOSE DAMAGES CAN BE DISCLAIMED BY LAW.
- Some countries/states do not allow the exclusion or limitation of incidental or consequential damages, or limitation of the duration of implied warranties, so the preceding limitations or exclusions may not apply to you. The warranty provided does not affect the consumer's statutory rights under applicable national legislation in force, nor the consumer's rights against the dealer arising from their sales/purchase contract.

Limited Warranty

Subject to the conditions of this Limited Warranty, LG Electronics warrants this product to be free from defects in design, material and workmanship at the time of its original purchase by a consumer, and for a subsequent period of one (1) year. Should your product need warranty service, please return it to the dealer from whom it was purchased or contact your local LG Electronics contact centre to get further information.