



**LG**

Life's Good

OWNER'S MANUAL

# 3D Glasses

Please read the safety information carefully before using the product.

AG-S360

## ABOUT THE PRODUCT

The AG-S360 is a pair of 3D glasses that use radio frequency (RF) (2.4 GHz) wireless communication.

- Connect them to any TV compatible with RF glasses and enjoy vivid 3D images.
- Watch 3D movies and view 3D photos with 3D glasses.
- When using 3D glasses for the first time, make sure the coin cell battery is inserted correctly.

## ACCESSORIES



3D Glasses  
(Body, Leg)



Nose Pad  
(for users wearing regular eyeglasses)



Coin Cell Battery  
(CR2025)



Manual CD



Quick Guide



Cleaning Pad

**NOTE** ▶ The accessories may look different from those shown here.

## PART NAMES

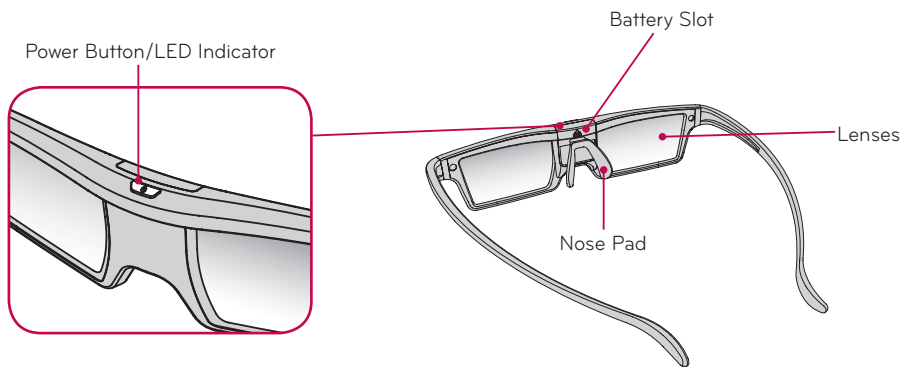

## PAIRING 3D GLASSES WITH 3D TV \*1

\*1 Pairing means establishing a wireless connection between the 3D TV and 3D glasses. The 3D glasses pair with the 3D TV that has the strongest wireless signal. If there is more than one TV, place the 3D glasses within 10 cm of the 3D TV you want to pair with.

| Recommended Pairing Distance:<br>10 cm | Pairing the Glasses  | Re-pairing the Glasses   |
|--|--|--|
|  | 1. Turn the 3D TV on and activate 3D mode.   | 1. Press and hold the power button on the 3D glasses for at least eight seconds until the LED indicator turns green. |
|  | 2. Place your 3D glasses within the recommended pairing distance and turn them on.           | 2. After the green LED indicator flashes three times, the glasses are ready to pair.                                 |
|  | 3. During pairing, the LED indicator flashes green and red alternately.                      | 3. Turn the 3D TV on and activate 3D mode.   |
|  | 4. When pairing is complete, the LED indicator goes off and the 3D glasses are ready to use. | 4. Place your 3D glasses within the recommended pairing distance and turn them on.                                   |
|  | 5. It is unnecessary to pair the 3D glasses with the same 3D TV again.                       | 5. During pairing, the LED indicator flashes green and red alternately.  |
|  |  |  |

**NOTE** ▶ The 3D glasses detect the unique ID of the TV within the recommended pairing distance; a pair of 3D glasses cannot detect more than one TV.  
▶ If you want to connect the glasses to another TV, see "Re-syncing the Glasses."

# USING 3D GLASSES

|                        | Button Operation   | LED Indicator  |
|------------------------|--|--|
| Power On               | Press and hold the power button for one to two seconds.                                    | The red LED indicator flashes once.  |
| Power Off              | Press and hold the power button for one to two seconds until the LED indicator turns red.  | The red LED indicator flashes three times.   |
| Auto Off <sup>*1</sup> | The product is automatically turned off if there is no 3D signal for more than one minute. | The red LED flashes three times.   |
| Battery discharge      | -  | The red LED flashes for one minute and turns off automatically.  |
| Re-syncing the Glasses | Press the power button for at least eight seconds.   | When the LED indicator turns green, release the power button. The green LED indicator flashes three times and turns off. If you turn the power on again, the 3D glasses detect the TV with the strongest signal. |

\*1 The Auto Off function automatically turns the power off when there is no signal between the TV and glasses for more than one minute. You cannot watch 3D images when the Auto Off function automatically turns the power off. This can happen when the distance or angle between the TV and glasses is out of range; when there is a barrier between the TV and glasses; or when the TV is switched from 3D to 2D mode.

**NOTE** ▶ Make sure to turn off the 3D glasses when they are not in use. Otherwise, the battery life shortens.

## ASSEMBLING THE GLASSES

The temple arms of the glasses are provided in the package. Attach them to the frame according to the instructions below.

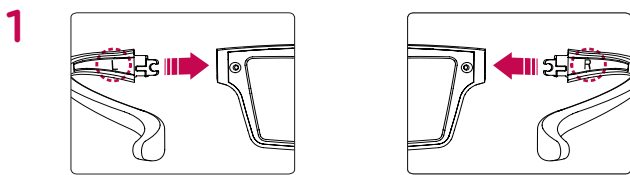

Insert each arm into the frame in the direction shown in the figure until it clicks.

**NOTE** ▶ Make sure that the left and right arms are attached to the corresponding side of the frame.

## REPLACING THE BATTERY

The coin cell battery is not rechargeable. Please replace it when the red LED indicator flashes continuously.

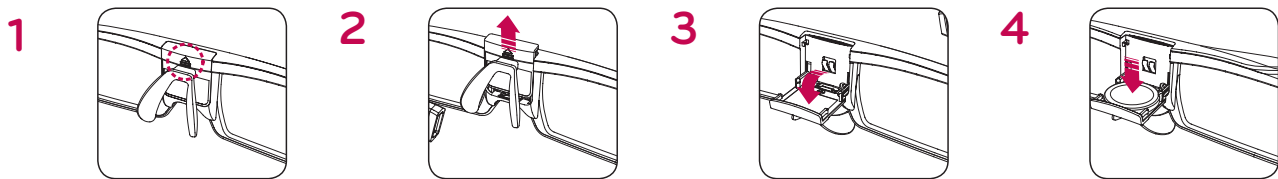

1 Locate the battery cover.

2 Press the cover slightly, then lift it up.

3 Pull the cover open.

4 Place the battery onto the cover, then close the cover.

**NOTE** ▶ Make sure that the battery is inserted correctly with the plus sign facing towards the same sign marked on the cover.

**CAUTION** ▶ Risk of explosion if battery is replaced by an incorrect type.  
▶ dispose of used batteries according to the instruction.

## ATTACHING THE NOSE PAD

Using 3D glasses may not be comfortable for users wearing regular eyeglasses. Adjusting the nose pad can improve your viewing comfort.



- Pull the nose pad in the direction shown by the arrow in the image. Be careful not to twist or lift the nose pad, as this can cause damage.
- Remove the nose pad when the battery cover is fully closed.

**NOTE** ▶ Follow the instructions in reverse order to reattach the nose pad.  
▶ The nose pad can be adjusted even if you are not wearing glasses.

## SAFETY PRECAUTIONS

Please read these safety precautions carefully to ensure your personal safety and prevent damage.

- 1 If you view 3D images too closely for a long period of time, you may experience blurred vision.
- 2 You may also develop headache or fatigue if you watch for a long period of time.  
Stop watching and take a rest if you experience headache, fatigue or dizziness.
- 3 Do not drop anything onto the glasses or allow anything to strike them.  
This may result in electric shock or fire.
- 4 Do not use your glasses near a humidifier or kitchen counter.  
This may result in electric shock or fire.
- 5 Do not disassemble, repair or modify the glasses or its parts.  
Failing to follow this precaution may result in damage or malfunction.
- 6 Some people may find that the glasses do not fit.
- 7 If you are pregnant, are a senior, have heart problems, or are prone to motion sickness, we recommend you do not view 3D images.  
Because 3D images can appear to be reality and cause disorientation and confusion, some viewers may experience surprise or excitement.
- 8 Do not watch 3D images near fragile objects or objects that can be knocked over easily.  
If you mistake 3D images for reality, you could knock over a nearby object or injure yourself when moving your body.
- 9 Only use this product for watching 3D images.  
Do not use 3D glasses as sunglasses.
- 10 Do not spray cleaner directly onto the surface of the glasses.  
This may result in discoloration and cracks and cause the coating on the lenses to peel off.
- 11 Do not let water come into contact with the product when cleaning it.  
This may result in electric shock or fire.
- 12 The lenses of the glasses can be easily scratched. Use a soft cloth when cleaning them.  
Foreign particles on the cloth may cause scratches. Make sure to shake off any dust before using it.
- 13 Do not scratch the surface of the lenses with sharp objects or wipe them with chemicals.
- 14 Do not drop, bend, or allow the glasses to come into contact with other objects.
- 15 When watching 3D images, stay within the reception range. (For more information, refer to the owner's manual of the TV.)  
If you are out of the reception range, images may not appear in 3D.
- 16 Flickering may occur when watching 3D images under a magnetic fluorescent light (50 Hz) due to interference between the 3D glasses (60 Hz) and the light.  
If you encounter this issue, turn off the light and continue watching.
- 17 This product is a wireless communications device that uses the 2.4 GHz frequency. It may be affected by interference from another device, such as a microwave oven or wireless LAN.  
Wireless performance may also be affected by a physical barrier between the TV and the glasses.
- 18 Children should be closely supervised when they use 3D glasses. They should stop using the glasses if they experience fatigue, twitching of the eye or face muscles or other involuntary movements.
- 19 Do not use the 3D glasses with the nose pad if you are not wearing regular eyeglasses. Otherwise, this may hurt your eyes.
- 20 Use a coin cell battery with the same specifications as the one provided. When replacing the battery, make sure to insert it with the polarity (+, -) in the right direction.  
Otherwise, personal injury, fire or contamination (damage) due to battery leakage or rupture can occur.
- 21 Dispose of used batteries carefully to ensure that a small child does not consume them.  
Please seek Doctor- Medical Attention immediately if child consumes batteries.

## TROUBLESHOOTING

| Problem                                  | Action   |
|--|--|
| Q. The product does not work.            | A. The battery may be dead.<br>Replace the battery with a new one.                         |
|  | A. Check the 3D settings on the TV.  |
| Q. The red LED indicator keeps flashing. | A. The coin cell battery is at the end of its life.<br>Replace the battery with a new one. |

**NOTE** ▶ Make sure to use a coin cell battery with the same specifications (CR2025) as the one provided.

## SPECIFICATIONS

|                       | AG-S360   |
|-----------------------|---|
| Frequency Range       | 2.400 to 2.4835 GHz   |
| Transmission Output   | 4 dBm   |
| Reception Sensitivity | -86 dBm   |
| Shutter               | Liquid crystal  |
| Contrast Ratio        | Max. 500:1  |
| Transmittance         | 34% or more   |
| Field Rate            | 120 fields/sec  |
| Shutter Open Time     | 3.8 ms or less  |
| Shutter Close Time    | 0.5 ms or less  |
| Weight                | TBD   |
| Power Supply          | Coin Cell Battery: 165 mA/h, 3.0 V (CR2025)<br>Continuous Operating Time: 150 hours or less |
| Operating Temperature | 0 to 40°C   |
| Storage Temperature   | -20 to 45°C   |

☞ The images used and specifications stated in this owner's manual are subject to change to improve the performance of the product.

☞ The continuous operating time may vary depending on the wireless environment and the operating conditions.

### Warranty Period: 1 year (2 years for Europe)

If you find a technical defect or problem in the course of normal use during the warranty period, please contact your dealer.

This warranty applies only to the purchaser in the region where the product was purchased.



## (1) Federal Communications Commission (FCC) Statement

You are cautioned that changes or modifications not expressly approved by the part responsible for compliance could void the user's authority to operate the equipment. This equipment has been tested and found to comply with the limits for a Class B digital device, pursuant to part 15 of the FCC rules. These limits are designed to provide reasonable protection against harmful interference in a residential installation. This equipment generates, uses and can radiate radio frequency energy and, if not installed and used in accordance with the instructions, may cause harmful interference to radio communications. However, there is no guarantee that interference will not occur in a particular installation. If this equipment does cause harmful interference to radio or television reception, which can be determined by turning the equipment off and on, the user is encouraged to try to correct the interference by one or more of the following measures:

- Reorient or relocate the receiving antenna.
- Increase the separation between the equipment and receiver.
- Connect the equipment into an outlet on a circuit different from that to which the receiver is connected.
- Consult the dealer or an experienced radio/TV technician for help.

This device complies with Part 15 of the FCC Rules. Operation is subject to the following two conditions:

- 1) this device may not cause harmful interference, and
- 2) this device must accept any interference received, including interference that may cause undesired operation of the device of the device.

### FCC Caution

Any changes or modifications not expressly approved by the party responsible for compliance could void the user's authority to operate this equipment and For indoor use only, use outdoors or in other modes not covered by this manual may violate the FCC regulation and violate the user authority to use the product.

### FCC RF Radiation Exposure Statement:

This equipment complies with FCC radiation exposure limits set forth for an uncontrolled environment. End users must follow the specific operating instructions for satisfying RF exposure compliance.

**WARNING:** This product contains chemicals known to the State of California to cause cancer and birth defects or other reproductive harm. ***Wash hands after handling.***

## (2) Industry Canada Statement:

This device complies with RSS-210 of the Industry Canada Rules. Operation is subject to the following two conditions:

- 1) this device may not cause interference and
- 2) this device must accept any interference, including interference that may cause undesired operation of the device

### Avis d'Industrie Canada :

Cet appareil est conforme à la norme CNR-210 des règlements d'Industrie Canada. Son fonctionnement est sujet aux deux conditions suivantes :

- 1) Cet appareil ne doit pas provoquer d'interférences et
- 2) Cet appareil doit accepter toutes les interférences, y compris celles pouvant entraîner son dysfonctionnement.

### IC Radiation Exposure Statement:

This equipment complies with IC radiation exposure limits set forth for an uncontrolled environment.

**NOTE:** THE MANUFACTURER IS NOT RESPONSIBLE FOR ANY RADIO OR TV INTERFERENCE CAUSED BY UNAUTHORIZED MODIFICATIONS TO THIS EQUIPMENT. SUCH MODIFICATIONS COULD VOID THE USER'S AUTHORITY TO OPERATE THE EQUIPMENT.

### Avis d'Industrie Canada sur l'exposition aux rayonnements

Cet appareil est conforme aux limites d'exposition aux rayonnements d'Industrie Canada pour un environnement non contrôlé.

**REMARQUE:** LE FABRICANT N'EST PAS RESPONSABLE DES INTERFÉRENCES RADIOÉLECTRIQUES CAUSÉES PAR DES MODIFICATIONS NON AUTORISÉES APPORTÉES À CET APPAREIL. DE TELLES MODIFICATIONS POURRAIT ANNULER L'AUTORISATION ACCORDÉE À L'UTILISATEUR DE FAIRE FONCTIONNER L'APPAREIL.

### (3) ANATEL (Para Brazil)

Este equipamento opera em caráter secundário, isto é, não tem direito a proteção contra interferência prejudicial, mesmo de estações do mesmo tipo, e não pode causar interferência a sistemas operando em caráter primário.

### (4) COFETEL(Mexico)

La operación de este equipo está sujeta a las siguientes dos condiciones:

(1) es posible que este equipo o dispositivo no cause interferencia perjudicial y (2) este equipo o dispositivo debe aceptar cualquier interferencia, incluyendo la que pueda causar su operación no deseada.

### (5) EU Conformity Notice:

# CE 0197

LG Electronics hereby declares that this product is in compliance with the following Directives.

R&TTE Directive 1999/5/EC

The products described above comply with the essential requirements of the directives specified.

This device is a 2.4 GHz wideband transmission system, intended for use in all EU member states and EFTA countries

European representative:

LG Electronics Inc. Krijgsman 1, 1186 DM Amstelveen, The Netherlands

CE Notified Body statement:

This is a Class B product. In a domestic environment, this product may cause radio interference, in which case the user may be required to take adequate measures.

Explosive device proximity warning – Do not operate a portable transmitter (such as a wireless network device) near unshielded blasting caps or in an explosive environment unless the device has been modified to be qualified for such use.

This CE marking is valid for EU non-harmonized telecommunications products R&TTE Directive (1999/5/EC) issued by the Commission of the European Community.

[DEUTSCH]

#### **EU-Konformitätserklärung:**

LG Electronics erklärt hiermit, dass dieses Produkt den folgenden Richtlinien entspricht:

R&TTE-Richtlinie 1999/5/EC

Die oben beschriebenen Produkte entsprechen den grundlegenden Anforderungen der angegebenen Richtlinien.

Vertreter für Europa:

LG Electronics Inc. Krijgsman 1, 1186 DM Amstelveen, Niederlande



## [FRANÇAIS]

**Notice de conformité UE:**

LG Electronics atteste que ces produits est en conformité avec les Directives suivantes.

Directive 1999/5/CE des R&TTE

Les produits décrits ci-dessus sont en conformité avec les exigences essentiels des directives spéci-fiées.

Représentant en Europe :

LG Electronics Inc. Krijgsman 1, 1186 DM Amstelveen, Pays-Bas

## [ITALIANO]

**Avviso di conformità EU:**

LG dichiara che questo prodotto è conforme alle seguenti direttive.

Direttiva R&TTE 1999/5/CE

I prodotti descritti sopra sono conformi ai requisiti essenziali delle direttive specificate.

Rappresentante europeo:

LG Electronics Inc. Krijgsman 1, 1186 DM Amstelveen, Paesi Bassi

## [ESPAÑOL]

**Aviso de conformidad con la UE:**

Por la presente, LG Electronics declara que este producto cumple con las siguientes directivas.

Directiva sobre equipos radioeléctricos y equipos terminales de telecomunicación 1999/5/CE

Los productos descritos anteriormente cumplen con los requisitos esenciales de las directivas especificadas.

Representante europeo:

LG Electronics Inc. Krijgsman 1, 1186 DM Amstelveen, Países Bajos

## [PORTUGUÉS]

**Aviso de conformidade da UE:**

A LG Electronics declara por este meio que este produto está em conformidade com as seguintes Directivas.

Directiva R&TTE 1999/5/CE

Os produtos acima descritos estão em conformidade com os requisitos essenciais das directivas especificadas.

Representante europeu:

LG Electronics Inc. Krijgsman 1, 1186 DM Amstelveen, Holanda

## [NEDERLANDS]

**Conformiteitsverklaring (EU):**

LG verklaart hierbij dat dit product voldoet aan de volgende richtlijnen.

R&TTE-richtlijn 1999/5/EC

De hierboven genoemde producten voldoen aan de essentiële voorwaarden van de gespecificeerde richtlijnen.

Europees hoofdkantoor:

LG Electronics Inc. Krijgsman 1, 1186 DM Amstelveen, Nederland

## [ΕΛΛΗΝΙΚΑ]

**Δήλωση συμμόρφωσης Ε.Ε.:**

Η LG Electronics δηλώνει ότι το παρόν προϊόν συμμορφώνεται με τις εξής Οδηγίες:

Οδηγία 1999/5/ΕΚ περί Ραδιοεξοπλισμού και Τηλεπικοινωνιακού Τερματικού Εξοπλισμού (R&TTE)

Τα παραπάνω προϊόντα συμμορφώνονται με τις ουσιώδεις απαιτήσεις των ανωτέρω οδηγιών.

Ευρωπαϊκός αντιπρόσωπος:

LG Electronics Krijgsman 1, 1186 DM Amstelveen, Ολλανδία

## [MAGYAR]

**EU megfeleléségi nyilatkozat:**

Az LG Electronics ezúton kijelenti, hogy a termék megfelel a következő irányelvek előírásainak:

1999/5/EK R&TTE irányelv

A fentiekben bemutatott termékek teljesítik a megadott irányelvek alapvető előírásait.

Európai képviselő:

LG Electronics Krijgsman 1, 1186 DM Amstelveen, Hollandia

## [POLSKI]

**Deklaracja zgodności z normami UE:**

Firma LG Electronics niniejszym zaświadcza, że ten produkt spełnia wymagania poniższych dyrektyw.

Dyrektywa 1999/5/WE w sprawie urządzeń radiowych i końcowych urządzeń telekomunikacyjnych

Powyżej wymienione produkty spełniają zasadnicze wymagania wymienionych dyrektyw.

Przedstawiciel na Europie:

LG Electronics Krijgsman 1, 1186 DM Amstelveen, Holandia

## [ČESKY]

**Prohlášení o shodě s legislativou EU:**

Společnost LG Electronics tímto prohlašuje, že tento výrobek je ve shodě s následujícími směnicemi.

Směnice o radiokomunikačních a telekomunikačních koncových zařízeních 1999/5/EC

Výše popisované produkty jsou v souladu se základními požadavky uvedených směrnic.

Zastoupení v Evropě:

LG Electronics Krijgsman 1, 1186 DM Amstelveen, Nizozemsko

## [SLOVENSKY]

**Vyhlasenie o zhode pre oblasť EÚ:**

Spoločnosť LG Electronics týmto vyhlasuje, že tento výrobok dosahuje súlad s nasledujúcimi smernicami.

Smernica R&TTE 1999/5/ES

Vyššie popísané výrobky vyhovujú základným požiadavkám uvedených smerníc.

Európske zastupiteľstvo:

LG Electronics Krijgsman 1, 1186 DM Amstelveen, Holandsko

## [ROMANESTE]

**Declarație de conformitate UE:**

Prin prezenta, LG Electronics declară că acest produs este conform cu următoarele Directive.

Directiva R&TTE 1999/5/CE

Produsul descris mai sus este conform cu cerințele esențiale ale directivelor specificate.

Reprezentant european:

LG Electronics Krijgsman 1, 1186 DM Amstelveen, Olanda

## [БЪЛГАРСКИ]

**Бележка относно съответствие с нормите на ЕС:**

С настоящото LG Electronics декларира, че този продукт съответства на следните директиви.

R&TTE директива 1999/5/EC

Описаният по-горе продукт съответства на основните изисквания на посочените директиви.

Европейски представител:

LG Electronics Krijgsman 1, 1186 DM Amstelveen, Нидерландия

## [SVENSKA]

**Meddelande om EU-regelefterlevnad:**

LG Electronics intygar härmed att den här produkten uppfyller följande gällande direktiv:

R&TTE-direktivet 1999/5/EG

Ovan nämnda produkter stämmer överens med de grundläggande kraven som anges i direktiven.

Europeisk representant:

LG Electronics Krijgsman 1, 1186 DM Amstelveen, Nederländerna

## [NORSK]

**Samsvarserklæring for EU:**

LG Electronics erklærer herved at dette produktet er i henhold til de følgende direktivene.

R&TTE-direktiv 1999/5/EC

Produktene som beskrives ovenfor, overholder kravene i de angitte direktivene.

Europeisk representant:

LG Electronics Krijgsman 1, 1186 DM Amstelveen, Nederland

## [DANSK]

**EU-overensstemmelseserklæring:**

LG Electronics erklærer hermed, at dette produkt overholder følgende direktiver.

R&TTE-direktiv 1999/5/EC

De produkter, der er beskrevet ovenfor, overholder de vigtigste krav i de angivne direktiver.

Europæisk repræsentant:

LG Electronics Krijgsman 1, 1186 DM Amstelveen, Holland

## [SUOMI]

**EU-vaatimustenmukaisuusilmoitus:**

LG Electronics vakuuttaa täten, että tämä tuote on seuraavien direktiivien mukainen.

R&TTE-direktiivi 1999/5/EC

Edellä mainitut tuotteet ovat eriteltyjen direktiivien oleellisten vaatimusten mukaisia.

Edustaja Euroopassa:

LG Electronics Krijgsman 1, 1186 DM Amstelveen, Alankomaat

[EESTI]

**EÜ vastavuskinnitus:**

Käesolevaga kinnitab LG Electronics, et see toode õhildub järgmiste direktiividega.

Raadioseadmete ja telekommunikatsioonivõrgu lõppseadmete direktiiv 1999/5/EÜ

Eelnimetatud tooted vastavad märgitud direktiivide olulistele nõuetele.

Euroopa esindus:

LG Electronics Krijgsman 1, 1186 DM Amstelveen, Holland

[LIETUVIŲ K.]

**EB atitikties deklaracija:**

„LG Electronics“ pareiškia, kad šis produktas atitinka tokias direktyvas.

R&amp;TTE direktyvą 1999/5/EB

Aukščiau įvardinti produktai atitinka nurodytų direktyvų esminius reikalavimus.

Atstovas Europoje:

LG Electronics Krijgsman 1, 1186 DM Amstelveen, Nyderlandai

[LATVIEŠU]

**Paziņojums par atbilstību ES direktīvām:**

LG Electronics ar šo paziņo, ka šis izstrādājums atbilst turpmāk minētajām direktīvām.

R&amp;TTE direktīva 1999/5/EK

Iepriekš aprakstītie izstrādājumi atbilst norādīto direktīvu būtiskajām prasībām.

Pārstāvniecība Eiropā:

LG Electronics Krijgsman 1, 1186 DM Amstelveen, Nīderlande

[SLOVENŠČINA]

**Izjava o skladnosti EU:**

LG Electronics izjavlja, da je ta izdelek v skladu z naslednjimi direktivami.

Direktiva 1999/5/ES o radijski opremi in telekomunikacijski terminalski opremi ter medsebojnem priznavanju skladnosti te opreme

Zgoraj opisani izdelki izpolnjujejo bistvene zahteve navedenih direktiv.

Evropski zastopnik:

LG Electronics Krijgsman 1, 1186 DM Amstelveen, Nizozemska

[SRPSKI]

**Napomena o uskladenosti sa standardima:**

LG Electronics ovim izjavljuje da je ovaj proizvod uskladen sa sledećim direktivama:.

R&amp;TTE direktiva 1999/5/EC

Prethodno opisani proizvodi usklađeni su s osnovnim zahtevima iz navedenih direktiva.

Evropski predstavnik:

LG Electronics Krijgsman 1, 1186 DM Amstelveen, Holandija

[HRVATSKI]

**Napomena o sukladnosti s EU standardima:**

LG Electronics ovim putem izjavljuje da je ovaj proizvod sukladan sljedećim Direktivama.

R&amp;TTE direktiva 1999/5/EC

Gore opisan proizvod sukladan je osnovnim zahtjevima navedenih direktiva.

Zastupnik za Europu:

LG Electronics Krijgsman 1, 1186 DM Amstelveen, Nizozemska

[TÜRKÇE]

**AB Uygunluk Bildirimi:**

LG Electronics, burada bu ürünün aşağıdaki Direktifler ile uyumlu olduğunu beyan eder.

R&amp;TTE Direktifi 1999/5/EC

Yukanda anlatılan ürünler, belirtilen direktiflerin gereklilikleri ile uyumludur.

Avrupa temsilciliği :

LG Electronics Krijgsman 1, 1186 DM Amstelveen, Hollanda

[SHQIP]

**Deklarata e Konformitetit për BE-në:**

LG Electronics nëpërmjet kësaj deklaron se ky produkt është në përputhje me Direktivat e mëposhtme.

Direktivën R&amp;TTE 1999/5/KE

Produktet e përshkuara më lart përputhen me kërkesat thelbësore të direktivave të specifikuara.

Përfaqësuesi evropian:

LG Electronics Krijgsman 1, 1186 DM Amstelveen, Holandë

[BOSANSKI]

**Напомена о усклађености са прописима ЕУ:**

LG Electronics овим путем изјављује да је овај производ усклађен са слједећим директивама:

Директива о радијској опреми и телекомуникацијској терминалној опреми 1999/5/ЕЦ

Описани производи усклађени су са кључним захтевима наведених директива.

Представник за Европу:

LG Electronics Krijgsman 1, 1186 DM Amstelveen, Холандија

[МАКЕДОНСКИ]

**Известување за усогласеност со ЕУ:**

LG Electronics јавно изјавува дека овој производ е во согласност со следните директиви.

R&TTE директива 1999/5/ЕЦ

Производите опишани погоре ги исполнуваат основните услови од посочените директиви.

Европски претставник:

LG Electronics Krijgsman 1, 1186 DM Amstelveen, Холандија

[ҚАЗАҚША]

**ЕО сәйкестік туралы ескерту:**

LG Electronics осы құжат арқылы бұл құрылғының мына директиваларға сай екенін мәлімдейді.

Радио және телекоммуникациялық жабдықтардың 1999/5/ЕЦ директивасы

Жоғарыда сипатталған өнімдер көрсетілген директивалардың негізгі талаптарына сай келеді.

Еуропадағы өкілдік:

LG Electronics Krijgsman 1, 1186 DM Amstelveen, Нидерланд

[РУССКИЙ]

**Уведомление о соответствии нормам ЕС:**

Компания LG Electronics настоящим заявляет о том, что данное изделие соответствует следующим директивам.

Директива R&TTE 1999/5/ЕЦ

Описанные выше изделия соответствуют основным требованиям указанных директив.

Представительство в Европе:

LG Electronics Krijgsman 1, 1186 DM Amstelveen, Нидерланды

[Українська]

**Підтвердження відповідності стандартам ЄС:**

Ця компанія LG Electronics підтверджує відповідність цього продукту вимогам директив, що перелічені нижче.

Директива R&TTE, 1999/5/ЕЦ

Описані вище продукти відповідають основним вимогам вказаних директив.

Уповноважена особа у Європі:

LG Electronics Krijgsman 1, 1186 DM Amstelveen, Нідерланди

**(6) [Українська]**

**Україна обмеження на наявність небезпечних речовин**

Устаткування відповідає вимогам технічного регламенту щодо обмеженого використання небезпечних речовин в електричному і електронному обладнанні

[English]

**Ukraine Restriction of Hazardous Substances**

The equipment complies with requirements of the Technical Regulation, in terms of restrictions for the use of certain dangerous substances in electrical and electronic equipment.

