

Charging Your Watch

Before using your watch for the first time, you should charge the battery. Use the charging cord and cradle provided with your watch to charge its battery.

The supplied charging cord will allow you to charge from a power outlet or from a computer.



- When the battery power is low, the battery icon may show as empty. If the battery charge is completely empty, the watch cannot be turned on immediately after connecting the charger. Leave an empty battery to charge for a few minutes before turning the device on. Some features are not available while the battery is charging.



- To charge your device, always use the included power adapter, USB cable, and charging cradle that come with your device. Using third-party charging solutions can cause fire, electric shock, injury, or damage to your device or other property.
- Your device has an internal rechargeable battery. For your safety, do not remove the embedded battery.

- 1 Connect the USB cable to the USB/Charger port on the charging cradle.

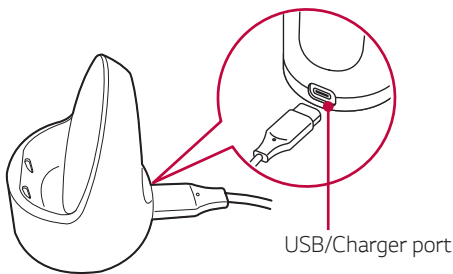

- 2 Plug the charger adapter into a power outlet.
- To charge from a power outlet, connect the USB plug on the charging cord to the charger adaptor, then plug the charger adaptor into an outlet.
 - To charge from a PC, insert the USB plug on the charging cord into a USB port on the PC.



- A power source connected a PC may result in a slower charging speed due to a lower electric current than a power outlet.

- 3 Place the your device on the charging cradle as shown below.

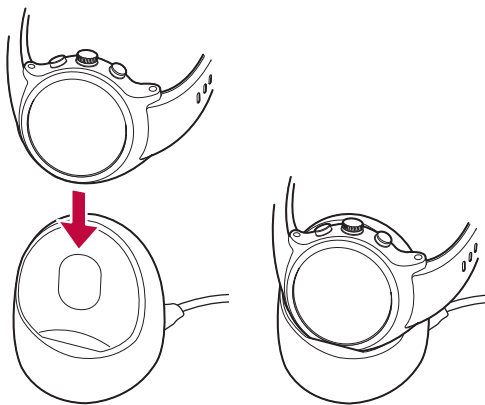

- The charging cord is designed to only be used with the watch and is not compatible with other devices.
- To maximize battery life, make sure that the battery is fully charged before you use the device for the first time.
- Exposure to liquids or other foreign materials while using your device may affect the charging cradle, causing it to disconnect from the watch while charging.
- If the charging screen does not display after connection to a power source, adjust your device's position on the charging cradle.

- 4 While your watch is charging, the screen will show the time, battery percentage and charging progress (indicated by the ring around the outside).

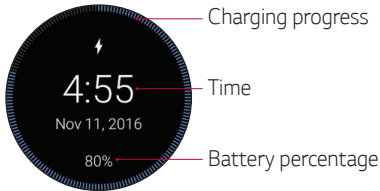

- 5 Once the battery is fully charged, remove it from the charging cradle.



- The watch may become warm while charging. If the device becomes hotter than usual, discontinue charging until it cools.

FCC NOTICE TO USERS

This device complies with part 15 of the FCC Rules. Operation is subject to the following two conditions: (1) This device may not cause harmful interference, and (2) this device must accept any interference received, including interference that may cause undesired operation.

Changes or modifications are not expressly approved by the manufacturer (or party responsible) for compliance could void the user's authority to operate the equipment.

IMPORTANT NOTE:

To comply with the FCC RF exposure compliance requirements, no change to the antenna or the device is permitted. Any change to the antenna or the device could result in the device exceeding the RF exposure requirements and void the user's authority to operate the device.

This equipment should be installed and operated with a minimum distance of 20 cm between the radiator and your body.

IC NOTICE TO USERS

This device complies with Industry Canada licence-exempt RSS standard(s). Operation is subject to the following two conditions: (1) this device may not cause interference, and (2) this device must accept any interference, including interference that may cause undesired operation of the device.

Le présent appareil est conforme aux CNR d'Industrie Canada applicables aux appareils radio exempts de licence. L'exploitation est autorisée aux deux conditions suivantes : (1) l'appareil ne doit pas produire de brouillage, et (2) l'utilisateur de l'appareil doit accepter tout brouillage radioélectrique subi, même si le brouillage est susceptible d'en compromettre le fonctionnement.

IC Radiation Exposure Statement

This equipment complies with IC RF Radiation exposure limits set forth for an uncontrolled environment. This device and its antenna must not be co-located or operating in conjunction with any other antenna or transmitter. This equipment should be installed and operated with a minimum distance of 20cm between the radiator and your body.

Cet équipement est conforme aux limites établies par Industrie Canada en matière d'exposition aux radiations dans un environnement non contrôlé.

Cet équipement ne doivent pas être colocalisés ou fonctionner en conjonction avec tout autre antenne ou émetteur.

Cet équipement doit être installé et utilisé avec une distance minimale de 20 cm entre le radiateur et votre corps.