



VX5500

Quick Start Guide



Bluetooth® Pairing



Sending Contacts
via Bluetooth



Taking a Picture

 Bluetooth®



www.LGmobilephones.com/VX5500

Getting to Know Your Phone



*Customizable.

Bluetooth® Pairing

Enjoy the freedom of Bluetooth wireless technology. The VX5500 easily connects with headsets, phones, and more!

1. Set your Bluetooth accessory into pairing mode.*
2. From standby mode and with the flip open, press **OK** and then select **Settings & Tools (9)**.
3. Select **Bluetooth Menu (3)** and then **Add New Device (1)**.
4. If Bluetooth is off, you will be prompted to turn it on by pressing **OK**.
5. Press **OK** to begin searching for the accessory. Once it is found, highlight it and press **OK** to pair.*
6. Press **OK** to connect with the device.

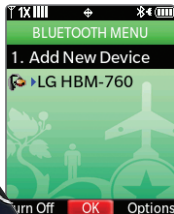
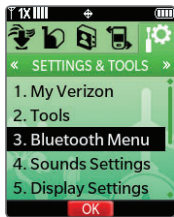

**Refer to your Bluetooth accessory's user guide for information about initiating pairing mode and the passkey if asked (typically "0000"). If the accessory supports the headset/hands-free profile, your phone will automatically pair for you without having to input the passkey.*

Note: Bluetooth accessories sold separately.



Sending Contacts via Bluetooth®

Transferring multiple contacts at once via Bluetooth is simple with the VX5500, making it convenient to share contact information with clients and friends without having to worry about typos!

1. From standby mode and with the flip open, press the **Right Soft Key** for **Contacts**.
2. Select a contact from the list, and then press the **Right Soft Key** for **Options**.
3. Select **Send Name Card (9)** and then **Via Bluetooth (4)**.
You can select all contacts by pressing the **Right Soft Key** for **Options** and then choosing **Mark All (2)**.
4. When you're finished, press the **Left Soft Key** for **Done**.
5. You will be prompted to select a device to send the contact(s) to. With the device highlighted, press **OK**.

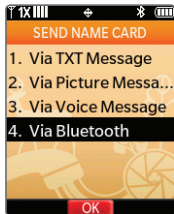
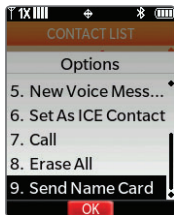





Taking a Picture

Never be caught without a camera again. You're always ready with the VX5500's easy-to-use camera.

1. From standby mode and with the flip open, press the side **Camera Key** .
2. Press **left** or **right** on the **Directional Key** to zoom.* Press **up** or **down** to adjust the brightness. Press the **Right Soft Key** to access additional camera options.
3. Press **OK** to take a photo.
4. Press the **Left Soft Key** to save the picture, or press **OK** to send it.

**Camera setting of 640 x 480 pixels does not support zoom function.*

Note: To take a self-portrait with the flip closed, press and **hold** , and then quickly press the side **Volume Keys**  . Press  again to take a picture.



Optional Accessories

Accessories for convenience and fashion are available at www.VerizonWireless.com.



Bluetooth Headset
(HBM-760)



Swivel Holster



Headset



Vehicle Power Charger



Extended Battery
(1,500 mAh)



©2008 LG Electronics, Inc. All rights reserved. LG is a registered trademark of LG Electronics, Inc. All other marks are proprietary to their respective owners. All phone images are simulated. The Bluetooth® trademark and logos are owned by the Bluetooth SIG, Inc. and any use of such marks by LG Electronics is under license.



Mixed Sources

Product group from well-managed forests, controlled sources and recycled wood or fiber
www.fsc.org Cert no. XXXX-XXXX-XXXX
© 1996 Forest Stewardship Council