

.25"

.25"

.25"

.25"

LINKSYS

**NEXT-GEN AC
MAX-STREAM™ Wi-Fi ADAPTER**

2

Quick Start Guide

2



Model WUSB6400M

.25"

.25"

.25"

.25"

8820-02558 Rev. A01
957CBK0008

Setup

Insert the USB adapter into an open USB port on your computer.

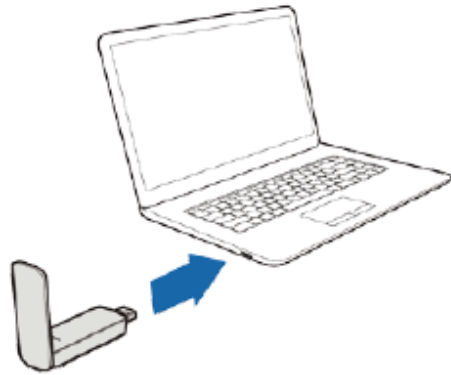

1 Install the adapter

- Windows 7, Windows 8 and Windows 10 users:
Insert the adapter into a USB port and the adapter will automatically install.
- Windows XP and Windows Vista users:
Insert the included CD and follow the onscreen steps to install the adapter.
 - You can also download and run the driver installation file available at linksys.com/support/wusb6400m.
- Mac OS X users:
Insert the included CD. Find the Mac OSX Driver folder and double-click on the version.zip file to unzip the installer file. Double-click on Installer.pkg and follow the onscreen steps to install the adapter.

Note—If the LED on the adapter is solid orange, the driver did not install correctly.

2 Check to confirm the driver is installed.

- For Windows, go to Control Panel > Device Manager

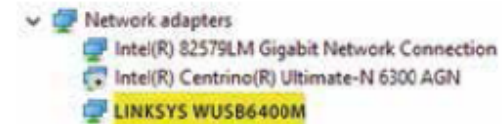

- For Mac OS X, go to System Preferences > Network



3 Connect to your wireless network.

- All Windows users:
Use your computer's Wi-Fi manager to select a Wi-Fi name. Enter the Wi-Fi password.
- Mac OS X users:
Click on the USB utility in the menu bar and select a Wi-Fi name to connect to. Enter the Wi-Fi password.