



SM-9661 Wireless Mouse /SD-9080 USB Transceiver Product Guide

Getting Started

Thank you for choosing this 2.4G Wireless Mouse Kits. It operates with digital radio technology to ensure no hinder communication between the mouse and your computer without connecting cable.

The transmission and receiving of mouse are free from angle restriction.

Preparing mouse and Dongle

Before working with your new mouse, look at the "Hardware Installation", and take a few one-time preparations.

Hardware Installation

- Place the dongle at least 20 cm from other electrical devices (e.g. monitor) to achieve optimum performance.
- The distance between the mouse and dongle should not exceed 10 M.
- Do not place the dongle on metal surfaces.
- Do not move optical mouse on following surface - Glass or any transparent materials; Mirror or reflecting surface; Mouse pad with too many colors; Rough surface.

Step 1: Connect the USB transceiver

- Plug the dongle connector into an USB port.
- SYSTEM will take around 10 sec to find your keyboard and mouse automatically.

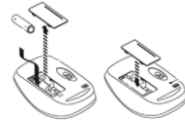

Step 2: Insert batteries

Inserting batteries in mouse

The mouse requires one alkaline AA battery.

- Open the battery compartment cover on the bottom of the mouse.
- First push the battery puller in then insert one AA battery into battery compartment.
- Fix the battery compartment cover on the bottom of mouse again.

CAUTION: Risk of explosion if battery is replaced by an incorrect type. Use and replace only with correct size and type (alkaline or zinc-carbon)of battery.

Working mouse

USB Transceiver and mouse electrical specification

In addition to two buttons, the mouse also has a wheel that can be used as follows:

- As a 3rd button: press on the wheel.
- For scrolling, e.g. in documents or on Internet pages: turn the wheel forward or back.

The Transceiver will have one main function: translate radio communications from the mouse to the PC via USB Full Speed USB Specification Compliance., meets Universal Serial Bus Specification version 2.0. Support USB Suspend Mode.

	Designation	Value
	Modulation	GFSK
	Operating Frequency	2403MHz~2480MHz
	channel	78 channel 2.4GHz ISM Band
	Storage temperature	-20 °C ... +60 °C
	Operating temperature	0 °C ... +40 °C
Mouse	Battery type mouse	One alkaline battery, type AA
Mouse	Supply voltage mouse	1.2~1.65V
Mouse	Current consumption mouse	max. 50 mA
USB Transceiver	Supply voltage dongle	DC 5.0 V ±5 %
USB Transceiver	Current consumption dongle	max..100 mA



FEDERAL COMMUNICATIONS COMMISSION (FCC) STATEMENT

This equipment has been tested and found to comply with the limits for a Class B digital device, Pursuant to Part 15 the FCC rules. These limits are designed to provide reasonable protection against harmful interference in a residential installation. This equipment generates uses and can radiate radio frequency energy and, if not installed and used in accordance with the instructions, may cause harmful interference to radio communications. However, there is no guarantee that interference will not occur in a particular installation. If this equipment does cause harmful interference will not occur in a particular installation. If this equipment does cause harmful interference to radio or television reception, which can be determined by turning the equipment off and on, the user is encouraged to try to correct the interference by one or more of the following measures:

- Reorient or relocate the receiving antenna.
- Increase the separation between the equipment and receiver.
- Connect the equipment into an outlet on a circuit different from that to which the receiver is connected.
- Consult the dealer or an experienced radio/TV technician for help.

FCC Caution: Any changes or modifications not expressly approved by the party responsible for compliance could void the user's authority to operate this equipment.

This device complies with Part 15 of the FCC Rules. Operation is subject to the following two conditions: (1) This device may not cause harmful interference, and (2) this device must accept any interference received, including interference that may cause undesired operation.

This device and its antenna(s) must not be co-located or operating in conjunction with any other antenna or transmitter.

This Class B digital apparatus complies with Canadian ICES-003.

Cet appareil numérique de la classe B est conforme à la norme NMB-003 du Canada.

Laser and LED Specifications:

Laser Mouse:

This device complies with International Standard IEC 60825-1: (1993), +A1+A2(IEC 60825-1:2001-8) for a class1.

Class 1 Laser Device

Beam description: Collimated (parallel)beam of infrared light(invisible to the user)

Laser power output:<716 microwatts(at 832 nanometers) to 834 microwatts(at 865 nanometers)

Emitted laser wavelength:nominal:850 nanometers, range:(832-865 nanometers)

A Class 1 laser product is safe under reasonably foreseeable conditions of operation as described by IEC 60825-1.

However,it is recommended that you not direct the laser beam(which is emitted from the bottom of the device)at anyone's eyes.



Optical(LED) Mouse:

This device complies with International Standard IEC 60825-1: (1993), +A1+A2(IEC 60825-1:2001-8) .

This product uses LEDs that are consider Class1 (IEC 60825-1:1993+A1+A2)

LED power output:<67.8μ W (photochemical limit),< 4.2mW (thermal limit).

LED nominal wavelength:470nm(blue),635nm(red).

A Class 1 product is safe under reasonably foreseeable conditions of operation as described by IEC 60825-1.

However, it is recommended that you not direct the light (which is emitted from the bottom of the device)at anyone's eyes.



IMPORTANT BATTERY INFORMATION

- Keep batteries out of reach of children.
- Insert the batteries in the proper direction as indicated by the positive (+) and negative (-) markings in the battery compartment.
- Do not mix old and new batteries or batteries of different types (for example, carbon and alkaline batteries).
- Always remove old, weak, or worn-out batteries promptly and recycle or proper disposal of them in accordance with Local and National Disposal Regulations.
- If a battery leaks, remove all batteries and recycle or dispose of them in accordance with the battery manufacture's instructions and Local and National Disposal Regulations. Before inserting new batteries, thoroughly clean the compartment with a damp paper towel, or follow the battery manufacture's recommendations for cleanup. If fluid from the battery comes into contact with skin or clothes, flush skin with water immediately.
- Remove the batteries if your device is to be stored for an extended period of time without being used.

PRODUCT DISPOSAL INFORMATION

Dispose of this product in accordance with Local and National Disposal Regulations