



**RadioPopper JrX Radio Wireless
Owners Manual**

RadioPopper is owned and manufactured by Leap Devices, LLC in Phoenix Arizona. This product was designed, produced, and manufactured in the USA.

FCC STATEMENT

This equipment has been tested and found to comply with the limits for a class B digital device, pursuant to part 15 of the FCC Rules. These limits are designed to provide reasonable protection against harmful interference in a residential installation. This equipment generates, uses and can radiate radio frequency energy and if not installed and used in accordance with the instructions, may cause harmful interference to radio communications. However, there is no guarantee that interference will not occur in a particular installation. If this equipment does cause harmful interference to radio or television reception, which can be determined by turning the equipment off and on, the user is encouraged to try to correct the interference by one or more of the following measures:

- * Reorient or relocate the receiving antenna.
- * Increase the separation between the equipment and receiver.
- * Connect the equipment into an outlet on a circuit different from that to which the receiver is connected.
- * Consult the dealer or an experienced radio/TV technician for help.

This equipment has been verified to comply with the limits for a class B computing device, pursuant to FCC Rules. Operation with non-approved equipment is likely to result in interference to radio and TV reception.

The user is cautioned that changes and modifications made to the equipment without the approval of manufacturer could void the user's authority to operate this equipment.

FCC ID: V4TJRTX304

This device complies with Part 15 of the FCC Rules.
Operation is subject to the following two conditions:

- (1) This device may not cause harmful interference and
- (2) this device must accept any interference received, including interference that may cause undesired operation.

Table of Contents

IMPORTANT NOTE:

To comply with FCC RF exposure compliance requirements, the following antenna installation and device operating configurations must be satisfied - This device and its antenna(s) must not be co-located or operating in conjunction with any other antenna or transmitter.

PRODUCT PATENT(S) PENDING

Introduction	4
Specifications and Warnings	6
Parts Descriptions	8
Installation	10
Option Switch Operation	12
Limited Warranty	15

RadioPopper JrX Radio Wireless System

Introduction

Thank you for your purchase of the RadioPopper JrX wireless radio system. We hope you'll find this system to be a valuable tool in your creative lighting, giving you flexibility and control never before possible.

The RadioPopper JrX system is a high quality and highly reliable radio triggering system. The JrX provides long range triggering of lighting equipment, as well as integration and compatibility with RadioPopper JrX units. The JrX is also forward compatible with upcoming "X System" devices.

Please read this short manual entirely before installing or operating your RadioPopper JrX wireless system. Proper installation is key to correct operation.

If you have any troubles along the way, feel free to call or email.

support@radiopopper.com

RadioPopper JrX Radio Wireless System

Compatible Hardware:

The JrX System has been tested and found to be compatible with the following flash hardware. See our website for updates as we test and certify compatibility with additional hardware.

Transmitter:

May be used with any camera with a standard hotshoe mount. May also be used via an external PC Sync cable appropriate to your particular brand of camera.

Receiver General Triggering:

JrX Receiver will trigger most lighting devices via the standard sync connector.

Receiver "Studio" Data Port Triggering:

JrX Receiver "Studio" version enables the 'telephone' style Data Port. This port is compatible with all current model studio lighting system from Alien Bees, White Lightning, and Zeus.

PX Triggering / Receiving:

The JrX Transmitter will trigger PX Receiver units tuned to the same radio channel. The PX Transmitter will trigger JrX Receiver units tuned to the same radio channel.

Specifications:

Both JrX Transmitter and JrX Receiver have similar specifications as follows.

Dimensions : 2.0" x 2.0" x 0.8" (50mm x 50mm x 20mm)

Weight: 2.0 ounces / 60 grams (Including battery and antenna during normal operation)

Battery: One "CR123" Size Battery, 3.0 volt

Battery Life: Approx 50 Hours total power-on time per battery.

Radio Frequency: 902-928 Mhz, ISM Band

Radio Range: 300 ft to 1750 ft depending on conditions and environment.

Specifications and Warnings

WARNING!!! WARNING!!! WARNING!!!!

PLEASE read this section in detail for important warnings and notices.

USE ONLY THE SUPPLIED TRANSMITTER ANTENNA!

Using any antenna other than the one supplied for use with your JrX Transmitter is a violation of Federal Law and may actually cause damage to the radio inside the transmitter. This will also promptly void your warranty. Your JrX Transmitter has been carefully tuned to broadcast the maximum signal strength allowable by law. Altering the antenna characteristics is more likely to “de-tune” or degrade performance than to improve it.

INSERT THE BATTERY IN THE CORRECT DIRECTION!

Inserting the batteries “backwards” could possibly damage the electronic components inside JrX Transmitter and JrX Receiver units. The little “bump” on the AAA always points away from the spring. A graphic is provided at the base of the AAA battery holder, as well as on the back side of the circuit board for reference. Further, you should observe for the Green Power LED blinking a few times about one second after you insert the battery - indicating proper insertion.

DO NOT REMOVE OR TAMPER WITH THE CIRCUIT BOARD!

Some of the components inside your JrX Transmitters and JrX Receivers are especially susceptible to electrostatic shock (they're easily ‘zapped’ by static electricity) - just touching them could damage them. Your circuit board is grounded to the case - as long as it's not removed everything is safe. Breaking the glue seal and removing or tampering with your circuit board will promptly void your warranty.

YOUR POPPERS CAN'T SWIM!! KEEP THEM DRY!!

The new splash-proof design of the JrX goes a long way to keeping the wet stuff out. However, they are *not* “waterproof”. Don't use them outside in the rain, to photograph objects under water, or in any other environment that may allow water to enter the physical enclosure or battery area.

If you dunk them, it may be too late. Should you do manage to expose a RadioPopper to anything wet, remove the batteries as quickly as possible and allow it 24 hours to dry. You may find it has come back to life. Allowing anything wet inside the case of your JrX Transmitter or JrX Receiver will promptly void the warranty.

CONTACT US IF YOU GET CONFUSED!

You're a valued customer and we really do care about you. (And not in that automated “your call is very important to us but we're going to leave you on hold for an hour anyway” customer service recording sort of way). Seriously, if you've got questions, we're going to do everything possible to take care of you as quickly and as personally as possible. The phone number is on our website and you can always email us at support@radiopopper.com

JrX Transmitter - Top View

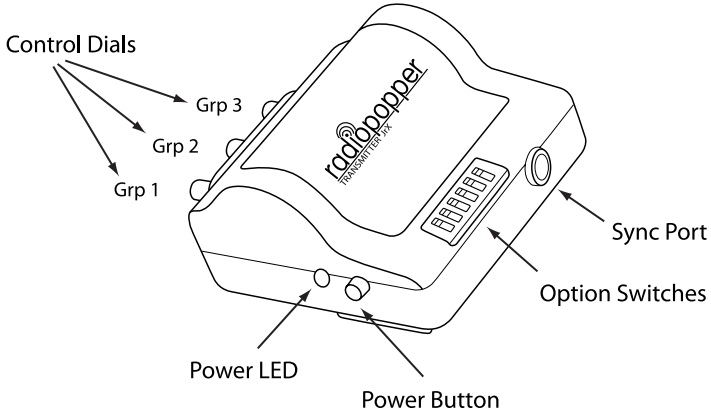

JrX Transmitter - Bottom View

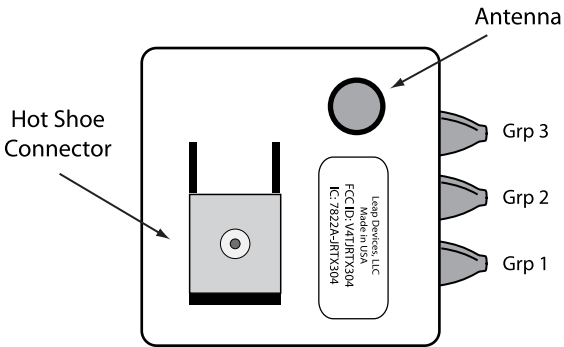

JrX Receiver

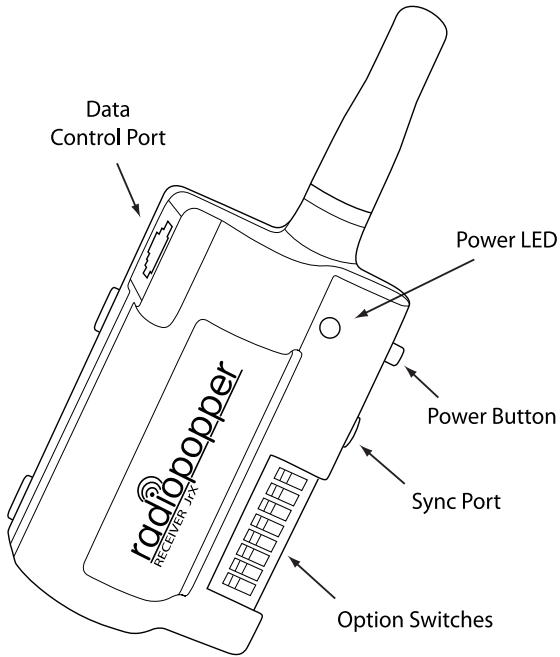

RadioPopper JrX Radio Wireless System

Installation & Basic Operation: RadioPopper JrX Transmitter

- 1)** Remove the battery compartment door on the top side of the unit. Insert a single CR123 Lithium battery. Take care to follow the direction / polarity indications printed inside the battery clip. Secure the battery by pressing it straight down into the clip - it will click into place. Replace the battery compartment door.
- 2)** To power on the JrX Transmitter, press and hold the power button for approximately two seconds. The Power LED will light to indicate the unit is powered on and operational.
- 3)** You may trigger the JrX Transmitter in one of two ways. You may either slide the transmitter onto your camera's hot shoe connector, in which case the JrX Transmitter will activate and broadcast a trigger signal each time you activate your camera's shutter. You may optionally connect a sync cord to the sync port provided on the side of the JrX Transmitter. Activating this sync cord will also cause your JrX Transmitter to activate and broadcast a trigger signal.
- 4)** Configure the option switches as required to set your desired channel and options. Please refer to page 12 for instructions and reference as to the proper settings of the option switches.
- 5)** You may adjust the light intensity level of up to three groups of remote lighting devices using the group adjustment dials on the side of the JrX Transmitter unit. When installed on a camera hot shoe with the Power button and Power LED facing toward you, the closest dial to you is Group 1, the middle dial is Group 2, and the furthest dial from you is Group 3. Turn the dials clockwise to increase lighting intensity level, turn them counter clockwise to decrease the lighting intensity level. Please refer to page 12 for instructions and details regarding the use of the group adjustment dials.
- 6)** Depending on the settings of the Option Switches, you may tap the Power button one time to cause a test activation, or to read the light level settings of the group dials and send those settings to your remote lights. In case of the latter, you may hold the Power button for a half second to cause a test activation.
- 7)** Press and hold the Power button for approximately two seconds to power off the unit. When the unit powers off the Power LED will go dark.
- 8)** The Power LED will strobe momentarily each time the JrX Transmitter is triggered, or each time a test activation occurs.

Installation

Installation & Basic Operation: RadioPopper JrX Receiver

1) Remove the battery compartment door on the top side of the unit. Insert a single CR123 Lithium battery. Take care to follow the direction / polarity indications printed inside the battery clip. Secure the battery by pressing it straight down into the clip - it will click into place. Replace the battery compartment door.

2) Connect the JrX Receiver to your lighting equipment - a studio strobe unit, power pack, mono light, or battery powered strobe unit. Connect the appropriate cable between the Sync Port on the side of the JrX Receiver to the trigger port or hot shoe connector of your lighting equipment. The cable that inserts into the JrX Receiver is a male 1/8" mini-phono plug. The sync port accepts mono or stereo type connectors. If you are using White Lightning, Alien Bees, or Zeus brand studio lights, you may optionally attach the light via the RJ-11 / Telephone style Data Port connector provided on the JrX Receiver. NOTE: The Data Port connector is only enabled in the "Studio" version of the JrX Receiver. This port is NOT enabled in the "Basic" version of the JrX Receiver. For more information about the use of the Data Port to control compatible studio lights, please refer to the section on page 12.

IMPORTANT NOTE: If using the Data Port Connector, it is NOT necessary to connect an additional cable to the Sync Port to achieve activation of the attached light. However, some lights provide an optical slave triggering function where they will activate when observing light from other sources. When using a light with an optical slave, connected by the Data Port connector, and being used in conjunction with PX units include E TTL or iTTL type communications, it is important to disable the optical triggering function by placing a plug or connector in the sync port of the light itself.

3) To power on the JrX Receiver, press and hold the power button for approximately two seconds. The Power LED will light to indicate the unit is powered on and operational. The JrX Receiver will perform a self-test and will activate the attached light a couple times. If a JrX Receiver "Studio" unit is attached to compatible lighting via the Data Port, you will see the modeling lamp of that light cycle up and down during this self test. The self test is complete in approximately five seconds at which time the unit begins normal operation.

4) Configure the radio channel, group setting, and other settings using the Option Switches. Please refer to page 12 for details as to the settings of these switches.

5) Tap the Power button one time to cause the attached light to emit a test fire.

6) To power off the unit, press and hold the Power button for approximately two seconds until the Power LED goes dark.

RadioPopper JrX Radio Wireless System

Option Switch Operation:

Adjust the settings on your JrX Transmitter and JrX Receiver units using the Option Switches provided along the side of either unit. The switches are labeled from “1” to “6” on the JrX Transmitter, and from “1” to “8” on the JrX Receiver. Please refer to the following description and tables for details.

Radio Channel - The radio channel on your JrX Transmitter or JrX Receiver is set by the positions of the first four switches. It is not so much important that you know what combination of switches creates a given channel - just make sure to match the on/off pattern of the first four switches on your JrX Transmitter to the on/off pattern of the first four switches on your JrX Receiver and the two units will be on the same channel and should operate together.

You may want to dial in a specific channel to allow a JrX Transmitter to trigger a PX Receiver, or to allow a JrX Receiver to be triggered by a PX Transmitter. To set a specific channel, refer to the switch position and channel list on the following page. The channel numbers given correspond to the channel numbers listed in the “Ch” display of you PX units.

Group Setting - Switch positions “5” and “6” on your JrX Receiver are used to set the Group number of the particular JrX Receiver. The group settings are used by the JrX Receiver “Studio” version to control the light intensity level set on compatible lighting equipment attached via the Data Port connector.

Model Lamp Tracking - Switch position “8” on your JrX Receiver “Studio” version turns on modeling lamp tracking. When turned on, the modeling lamp of the attached light will be proportional to the light intensity setting.

Group Switch Positions



No Group



Group 1



Group 2



Group 3

Channel Switch Positions



1



9



2



10



3



11



4



12



5



13



6



14



7



15



8



16

RadioPopper JrX Radio Wireless System

Canon is a registered trademark of Canon Inc. in the United States and may also be a registered trademark or trademark in other countries. ITTL stands for Intelligent Through The Lens, the trade-marked name for Nikon's exposure measurement system on SLR cameras. Nikon is a registered trademark of Nikon Corporation. All other product and brand names are trademarks of their respective owner.

Limited Warranty

LIMITED WARRANTY

The Limited Warranty set forth below is given by Leap Devices LLC (hereafter "Leap") in the United States with respect to the RadioPopper JxX Transmitter and / or RadioPopper JxX Receiver packaged with this Limited Warranty and identified by model number within this Limited Warranty (each a "Product") when purchased and used in the United States or in Canada.

This Limited Warranty is only effective upon presentation of this warranty card and proof of purchase.

A Product, when delivered to you in new condition in its original container at the point of its initial retail sale, is warranted against defects in materials or workmanship as follows: for a period of one (1) year from the date of original purchase, defective parts or a defective Product returned to Leap or its authorized service providers, and proven to be defective upon inspection, will be repaired with new or comparable rebuilt parts or exchanged for a refurbished Product, as determined by Leap or the authorized service provider, in their sole discretion. Replaced parts and exchanged Products will become the property of Leap.

When returning a Product for warranty service, the shipping charges must be prepaid and the Product should be shipped in its original container, or an equivalent, properly packaged container to withstand the hazards of shipment and fully insured. A copy of this warranty card and proof of purchase should be enclosed, as well as a description of the problem. Repairs will be made and the Product will be returned, shipped at NO CHARGE, within the country of repair. The Product must be received for warranty service by Leap before the expiration of this Limited Warranty.

This warranty only covers defective materials or workmanship encountered in normal use and service of a Product and does not apply in the following cases:

- (a) If a circuit board is removed from the plastic enclosure for any reason or if the original factory glue seal between the circuit board and plastic enclosure is disturbed in any way. Tampering with or removing the circuit board from the enclosure VOIDs this warranty.
- (b) Loss or damage due to neglect and/or abuse causing deterioration, mishandling, accident or failure to follow operating instructions including but not limited to operation of a JxX Transmitter with no antenna attached, or operation with an antenna other than that provided with the product originally, or inserting the batteries backward for any length of time.
- (c) If a Product is defective as a result of leaking batteries or damage due to water or other liquid, or any environmental conditions.
- (d) Defective materials or workmanship where the defect is due to a Product having been serviced or modified by other than Leap or a Leap authorized service provider.
- (e) Malfunction resulting from the use of accessories, attachments, supplies, parts or devices (including, without limitation, batteries) that do not conform to Leap specifications.
- (f) Damage resulting during shipment. (Claim must be presented to and examined by the shipper).
- (g) Damage or service resulting from modifications or alternations to a Product in any way (including any alteration or removal if its serial number or identification marks).

NO IMPLIED WARRANTY, INCLUDING ANY IMPLIED WARRANTY OF MERCHANTABILITY OR FITNESS FOR A PARTICULAR PURPOSE, APPLIES TO A PRODUCT AFTER THE APPLICABLE PERIOD OF THE EXPRESS LIMITED WARRANTY STATED ABOVE, AND NO OTHER EXPRESS WARRANTY OR GUARANTY, EXCEPT AS MENTIONED ABOVE, GIVEN BY ANY PERSON OR ENTITY WITH RESPECT TO A PRODUCT SHALL BIND LEAP (SOME STATES AND PROVINCES DO NOT ALLOW LIMITATIONS ON HOW LONG AN IMPLIED WARRANTY LASTS, SO THE ABOVE LIMITATION MAY NOT APPLY TO YOU). LEAP SHALL NOT BE LIABLE FOR LOSS OF REVENUES OR PROFITS, INCONVENIENCE, EXPENSE FOR SUBSTITUTE EQUIPMENT OR SERVICE, STORAGE CHARGES, LOSS OR CORRUPTION OF DATA, OR ANY OTHER SPECIAL, INCIDENTAL OR CONSEQUENTIAL DAMAGES (INCLUDING, WITHOUT LIMITATION, ANY LOSS OF FILM OR DIGITAL IMAGE FILES) CAUSED BY THE USE OR MISUSES OF, OR INABILITY TO USE, A PRODUCT, REGARDLESS OF THE LEGAL THEORY ON WHICH THE CLAIM IS BASED, AND EVEN IF LEAP HAS BEEN ADVISED OF THE POSSIBILITY OF SUCH DAMAGES. IN NO EVENT SHALL RECOVERY OF ANY KIND AGAINST LEAP BE GREATER IN AMOUNT THAN THE PURCHASE PRICE OF THE PRODUCT SOLD BY LEAP AND CAUSING THE ALLGED DAMAGE. WITHOUT LIMITING THE FOREGOING, YOU ASSUME ALL RISK AND LIABILITY FOR LOSS, DAMAGE OR INJURY TO YOU AND YOUR PROPERTY AND TO OTHERS AND THEIR PROPERTY ARISING OUT OF THE USE OR MISUSE OF, OR INABILITY TO USE, THE PRODUCT NOT CAUSED SOLELY AND DIRECTLY BY THE NEGLIGENCE OF LEAP (SOME STATES AND PROVINCES DO NOT ALLOW THE EXCLUSION OR LIMITATION OF INCIDENTAL OR CONSEQUENTIAL DAMAGES, SO THE ABOVE EXCLUSION OR LIMITATION MAY NOT APPLY TO YOU). THIS LIMITED WARRANTY SHALL NOT EXTEND TO ANYONE OTHER THAN THE ORIGINAL PURCHASER OF A PRODUCT, OR THE PERSON FOR WHOM IT WAS PURCHASED AS A GIFT AND STATES YOUR EXCLUSIVE REMEDY.

Leap Devices LLC, 4910 E. Elliot Rd. #100, Phoenix, AZ 85044

