

## H7R Core

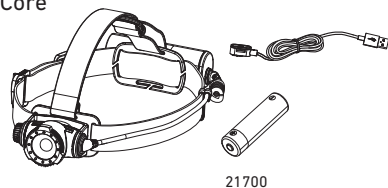

## H7R Work

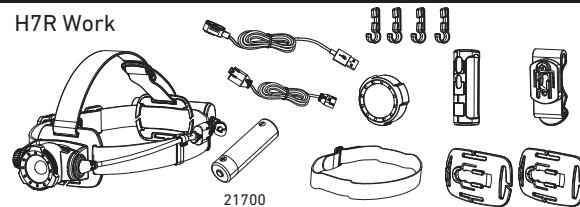

## H7R Signature

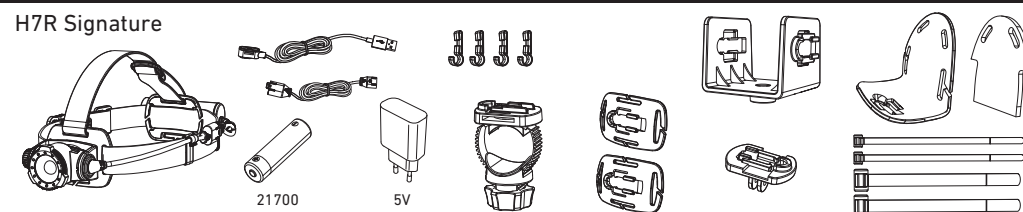

## Battery Replacement

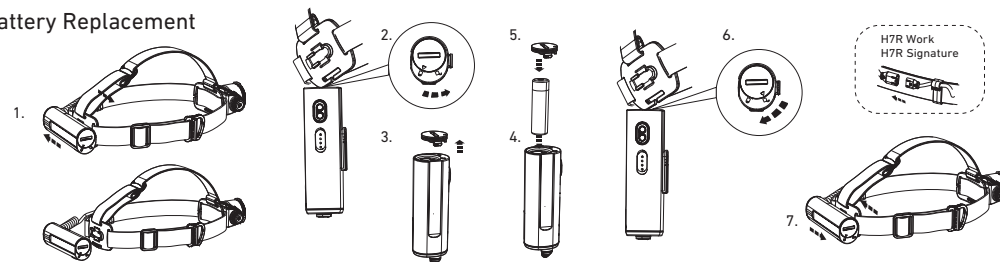

## Transportation Lock

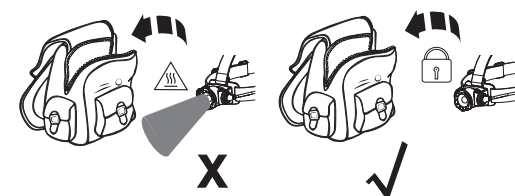
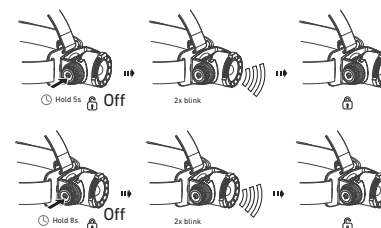

## Operation

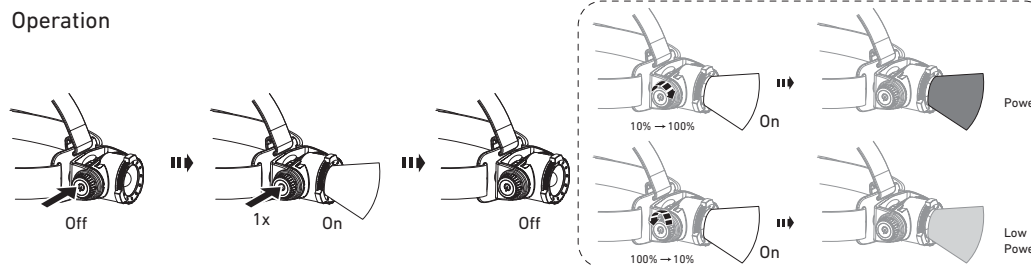

## Backup mode

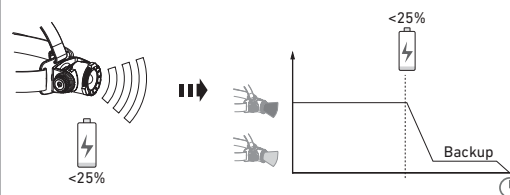

## Battery Indicator

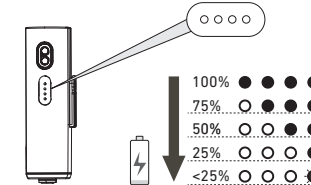

## App Mode

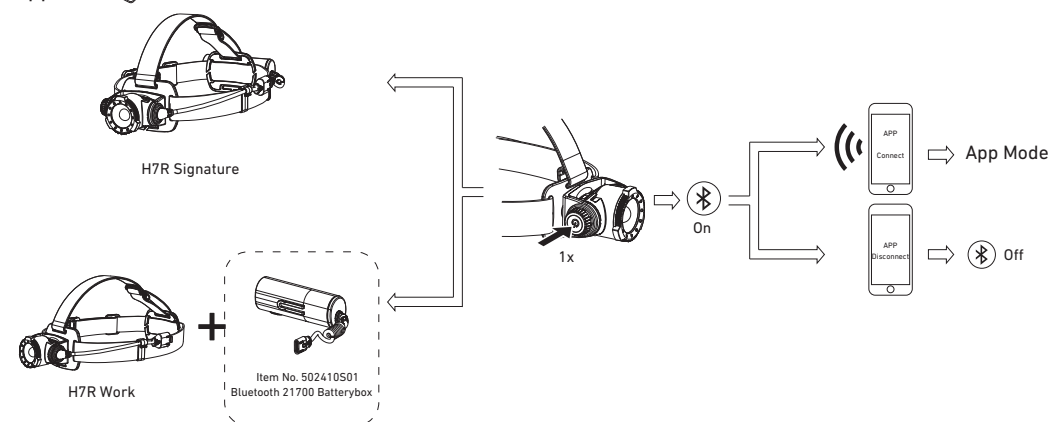

## Magnetic Charging System

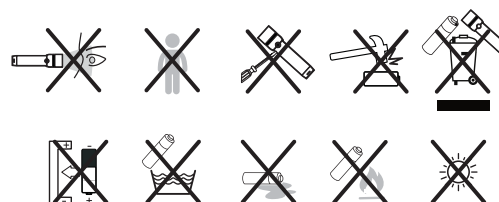
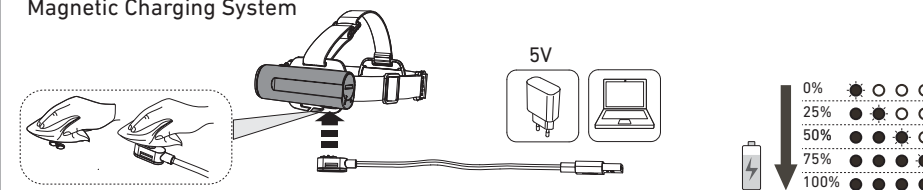

**Ledlenser GmbH & Co. KG**  
Kronenstr. 5-7 • 42699 Solingen • Germany  
Phone +49 212/5948-0 Fax +49 212/5948-200  
info@ledlenser.com



H7R\_V01  
10.06.2020  
1J12A0346

## Boost

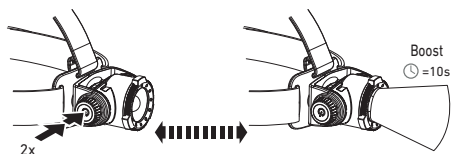

## Advanced Focus System

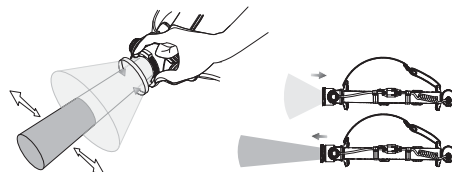

## Tripod Mount (H7R Signature)

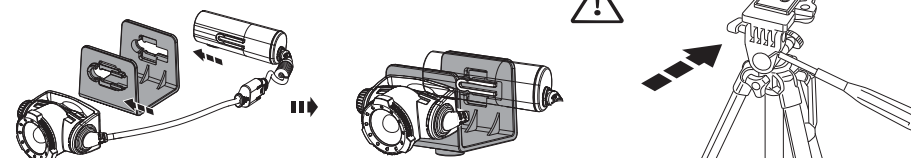

## Lamp Head Rotation

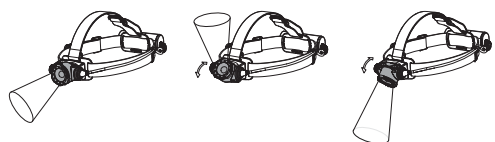

## Belt Clip (H7R Work)

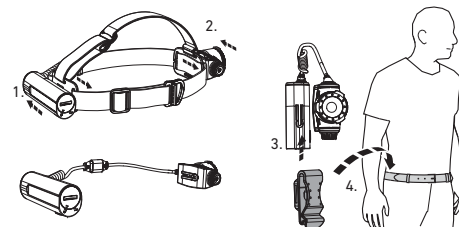

## Universal Mounting Bracket (H7R Signature)

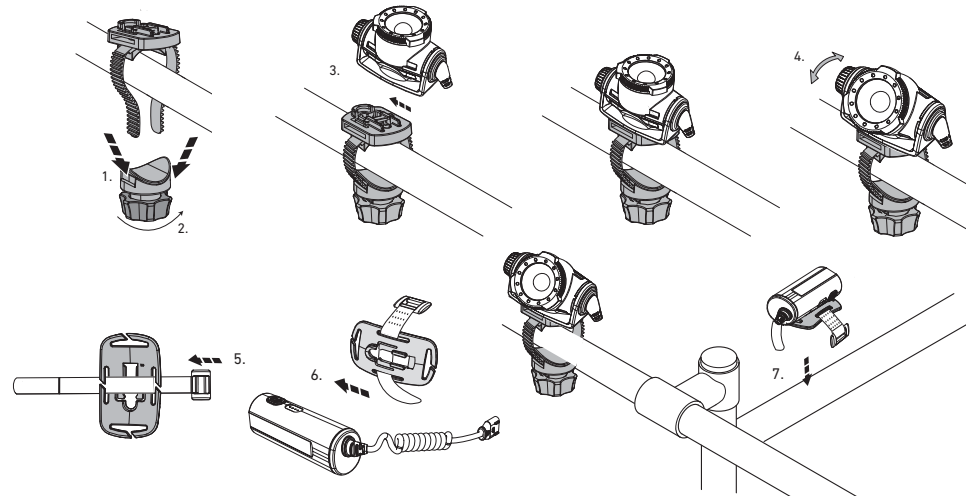

## Protective Covers (H7R Work)

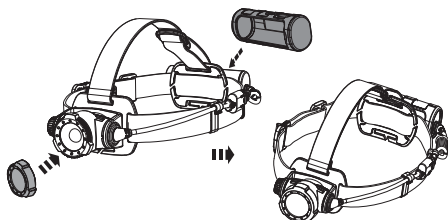

## Extension Cable (H7R Work &amp; H7R Signature)

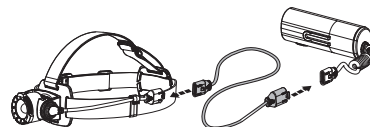

## Transparent Silicone Helmet Band (H7R Work)

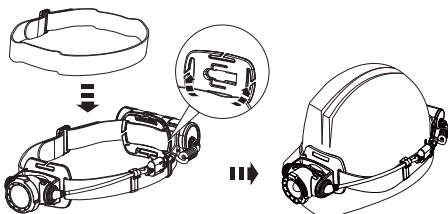

## Helmet Connecting System (H7R Signature)

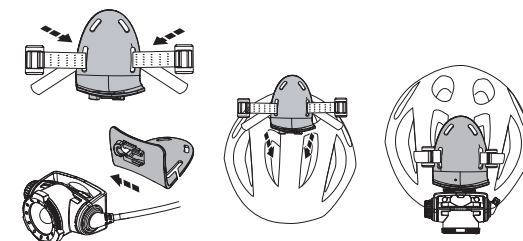
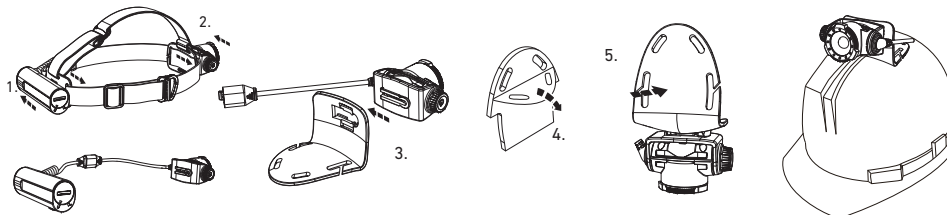

## Helmet Fixing Clips (H7R Work &amp; H7R Signature)

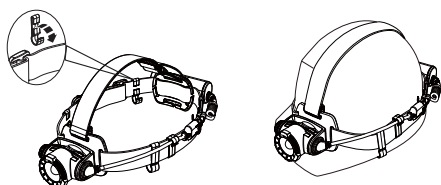

## GoPro Mount (H7R Signature)

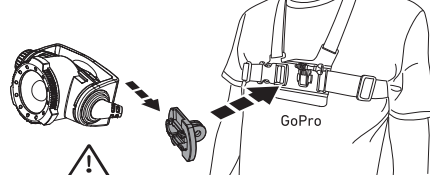

## Further Information

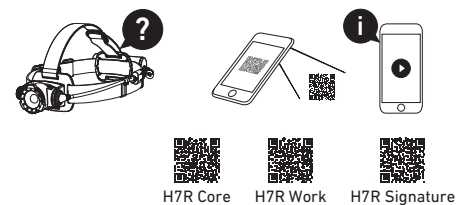

## Recycling

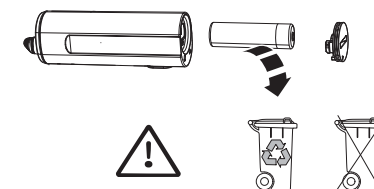

## **FCC Statement**

This device complies with Part 15 of the FCC Rules. Operation is subject to the following two conditions:

(1) This device may not cause harmful interference.

(2) This device must accept any interference received, including interference that may cause undesired operation.

2. Changes or modifications not expressly approved by the party responsible for compliance could void the user's authority to operate the equipment.

Note: This equipment has been tested and found to comply with the limits for a class B digital device, pursuant to Part 15 of the FCC Rules. These limits are designed to provide reasonable protection against harmful interference in a residential installation.

This equipment generates uses and can radiate radio frequency energy and, if not installed and used in accordance with the instructions, may cause harmful interference to radio communications. However, there is no guarantee that interference will not occur in a particular installation. If this equipment does cause harmful interference to radio or television reception, which can be determined by turning the equipment off and on, the user is encouraged to try to correct the interference by one or more of the following measures:

- Reorient or relocate the receiving antenna.
- Increase the separation between the equipment and receiver.
- Connect the equipment into an outlet on a circuit different from that to which the receiver is connected.
- Consult the dealer or an experienced radio/TV technician for help.

The device has been evaluated to meet general RF exposure requirement. The device can be used in portable exposure condition without restriction.