

Quick Start Guide

Step 1:

Get the HubSpace app in Apple store or Google Play.



Step 2:

Create an account and sign in.

Step 3:

From the home screen press the “+” symbol in the upper right hand corner.

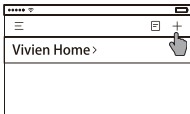

Step 4:

The next screen is a list of possible devices that can be added. Select “Security Kit” and follow the instruction of the app to set up this Security Kit.

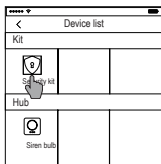

When new, out of the box, adding the Security Kit will also add all of the devices that shipped with it. These include two door/window sensors, one motion sensor, one keypad and one siren hub.



Step 5:

Remove the plastic stickers on door/window sensors, motion sensor and keypad.

Step 6:

Follow the installation instructions on User Guide.

Safety Information



WARNING: Keep out of reach of children. This product contains small magnets and other small parts, which can cause choking or injury if ingested.



WARNING: Any battery has the potential to leak harmful chemicals that can damage skin, clothing or the inside of the alarm. To avoid risk of injury, do not allow any substance leaked from the battery to come in contact with eyes of skin. Any battery has the potential to rupture and may even explode if exposed to fire or other forms of excessive heat. Use caution at all times when handling batteries. To reduce the risk of personal injury or harm to your alarm, take the following precautions:

- Do not use different brands of batteries in the same device.
- When replacing batteries always replace the whole set.
- Do not use rechargeable or reusable batteries.
- Do not allow children to install batteries unsupervised.
- Follow battery manufacturer's instructions for the proper handling, storage and disposal of batteries.



WARNING: Used batteries should be disposed of at an appropriate recycling center. Do not discard with normal household trash. **DO NOT BURN.**



WARNING: Clean the mounting surface with a gentle degreaser agent. Please note that some surfaces may be unsuitable for the mounting adhesive pads provided.



WARNING: Security system devices cannot compensate for loss of life or property.



WARNING: Risk of personal injury. Prolonged exposure to alarm siren may cause permanent hearing loss.



WARNING: This product cannot be linked to a monitored security system. DEFIANT is not responsible or liable for any damage, vandalism, theft or other actions that may occur while this product is in use.



WARNING: Keep batteries away from children. This product contains coin/button cell batteries.

- If the coin/button cell battery is swallowed, it can cause severe internal burns in just 2 hours and can lead to death. Keep away from infants and small children at all times.
- If battery is swallowed or placed inside any part of the body, immediately seek EMERGENCY medical attention.
- Battery may rupture if the incorrect type of battery is used. Follow the instructions in this manual.



CAUTION: Do not install

- In wet locations.
- Outside the premises (outdoors).
- Near the metal objects and mirrors that cause radio signal attenuation or shading it.
- Near the powerful main wiring.

Warranty

1 YEAR LIMITED WARRANTY

This product is guaranteed to be free of defects in materials and workmanship for 1 year from the date of purchase. Guarantee does not include normal wear and tear, bulbs or batteries. Contact the Customer Service Team or visit www.HOMEDEPOT.com.

zigbee

Wireless Protocol: zigbee 3.0

This device is fully zigbee 3.0 certified and will work with other open zigbee 3.0 certified systems.



zigbee
certified
product

FCC Regulation

This equipment complies with FCC radiation exposure limits set forth for an uncontrolled environment. This equipment should be installed and operated with a minimum distance of 20cm between the radiator and any part of your body.

This device complies with Part 15 of the FCC Rules. Operation is subject to the following two conditions: (1) this device may not cause harmful interference, and (2) this device must accept any interference received, including interference that may cause undesired operation.

FCC Caution:

Changes or modifications not expressly approved by the part responsible for compliance could void the user's authority to operate the equipment.

FCC Statement:

"This equipment has been tested and found to comply with the limits for a Class B digital device, pursuant to part 15 of the FCC Rules. These limits are designed to provide reasonable protection against harmful interference in a residential installation. This equipment generates, uses and can radiate radio frequency energy and, if not installed and used in accordance with the instructions, may cause harmful interference to radio communications. However, there is no guarantee that interference will not occur in a particular installation. If this equipment does cause harmful interference to radio or television reception, which can be determined by turning the equipment off and on, the user is encouraged to try to correct the interference by one or more of the following measures:

- Reorient or relocate the receiving antenna.
- Increase the separation between the equipment and receiver.
- Connect the equipment into an outlet on a circuit different from that to which the receiver is connected.
- Consult the dealer or an experienced radio/TV technician for help."

PLANNING INSTALLATION

Compare all parts in the package with the Package Contents list. If any part appears missing or damaged, do not install this product. Contact Customer Support.

ABOUT WIRELESS EQUIPMENT

Wireless systems are reliable and tested to high standards; however, it is important to consider that there are some limitations due to their transmitting power and range:

- Receivers may be blocked by radio signals occurring on or near operating frequencies, regardless of the code selected.
- A receiver can only respond to one transmitted signal at a time.
- Wireless equipment should be tested regularly to determine whether there are sources of interference and to protect against faults.

INSTALLATION LOCATION

DETERMINE THE LOCATION OF THE SIREN HUB, WHICH SHOULD BE PLACED:

- Within a few feet of an electrical outlet
- Where it is easily accessible
- Away from doors or windows that could be accessed by intruders
- Away from extreme temperature sources (radiators, ovens, stoves etc.) and large metal objects that could interfere with the wireless performance.

Pre-Installation (continued)

Product Introduction

Siren Hub

Your home security hub connects the alarm system to your Wi-Fi network and other smart home devices. It also sounds the alarm to alert you when a security breach has occurred.

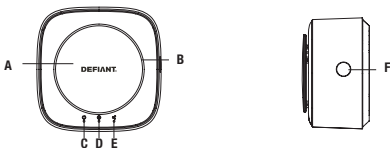

Part	Description
A	Siren
B	Strobe Warning Light
C	Power Indicator
D	WAN Indicator
E	LAN Indicator
F	Reset button

Items	Description
Siren	Sounds the alarm: When there has been a security breach
Strobe Warning Light	The round red LEDs will start flashing when there is a security breach
Reset button	Setup mode: Press the button 3 times within 3 seconds Factory reset: Hold the button for 10 seconds
Power Indicator	On: The device is powered on and works normally Off: The device is powered off Flashing: System is currently adding a device
WAN Indicator	On: Connected to the cloud Off: Disconnected from the cloud Flashing: Data is being send to/from the cloud
LAN Indicator	On: Connected to your home router Off: Disconnected from the router Flashing: Data is being send to/from the router Setup mode: Will flash once per second when trying to connect to a device or a Wi-Fi network

Operation

1 Setting the Security Levels

- Home Security Starter Kit has 4 different security levels you'll use when you're home or away. You can easily switch between them on the HubSpce App and Keyad.

Status	Response	Detections		Notifications
Arm Away Use when no one is home	The alarm sounds when a door or window opens, or when there's motion in a room	Motion Sensor	Door /Window Sensor	Alarm and Security Alerts
		Y	Y	Y
Arm Stay Use when you're home and want partial coverage	The alarm sound when the selected active sensors are triggered	User defined	User defined	Y
Disarm Use when you don't want security coverage	The alarm won't sound	N	N	N
SOS When there is an emergency and an alert is needed	The alarm sounds when you tap SOS on the App, or press the SOS button for 3 seconds on the keypad or key fob	N	N	Y

- The security system comes pre-configured with the default security settings as defined below. These settings can later be changed by the user in the alarm setting menu.

	What's detected	Entry Timer	Exit Timer	Siren Volume	Alarm Duration	Strobe Light
Arm Away	Motion Sensor Door/Window Sensor	30s	30s	High	1min	On
Arm Stay	Door/Window Sensor	30s	10s	High	1min	On