

Fig. 115

11. Hold the elevator with one hand (→ Fig. 116-1), loosen the locking mechanism (→ Fig. 116-2) at the elevator and fold it back (→ Fig. 116-3).
12. Continue to hold the elevator with one hand and remove the rack from the elevator with the other hand (→ Fig. 116-4). Make sure that no slides slip out of the rack.
13. Now release the elevator and take the removed rack out of the instrument.

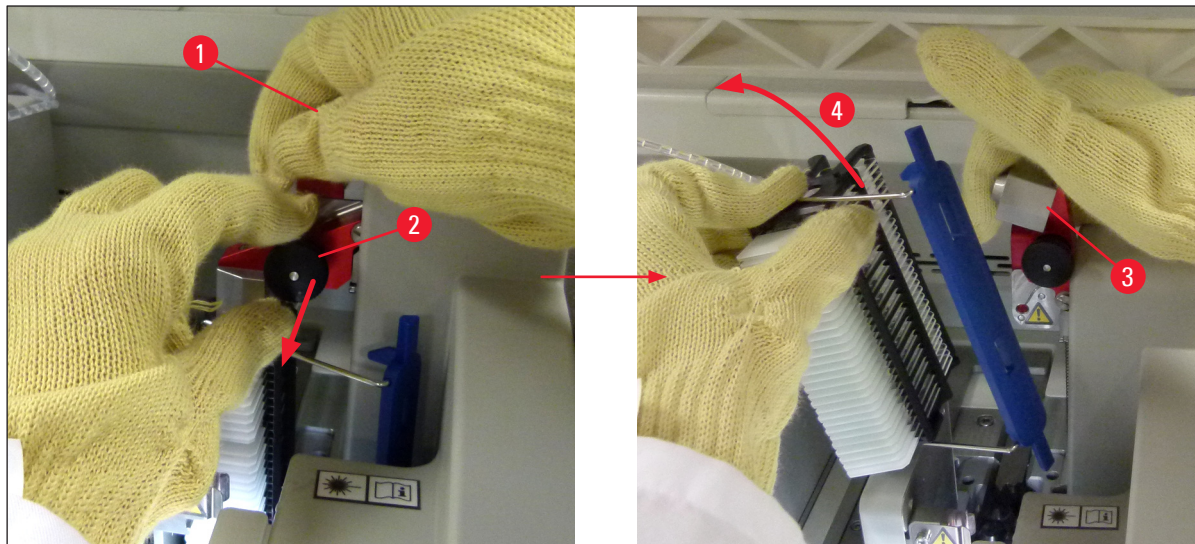

Fig. 116

14. Close the locking mechanism of the elevator again (→ Fig. 117-1) and push the elevator a few centimeters downward (→ Fig. 117-2).

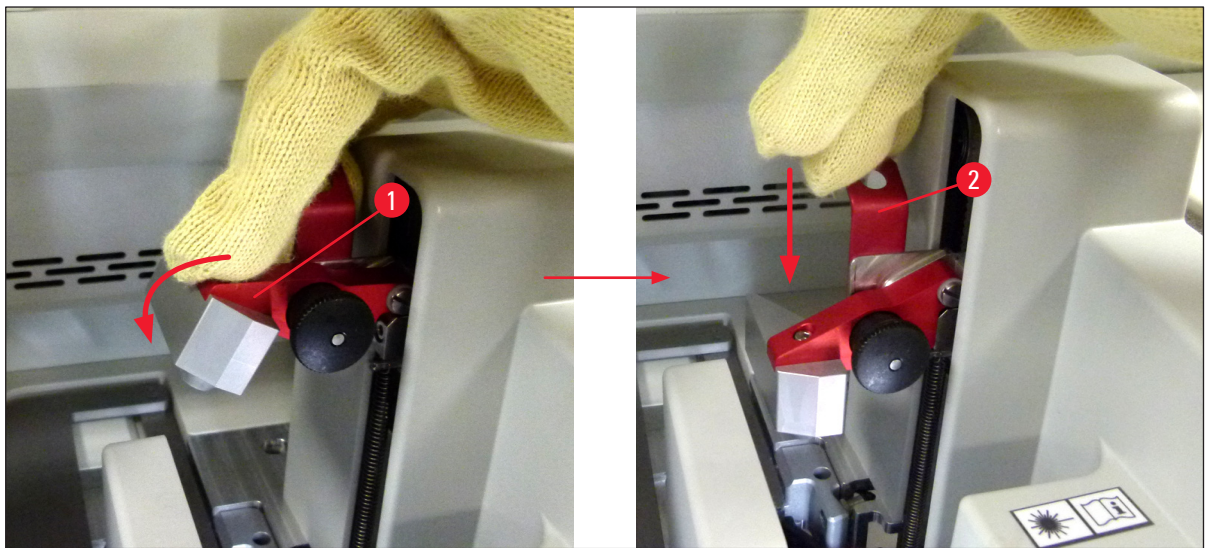

Fig. 117

15. Remove the needle from the parking location and insert it into the holder of the coverslip line. Make sure that the needle is positioned correctly.
16. Close the hood.

**Note**

- After initializing the instrument again, the coverslip line can be used for processing again.
- If the coverslip line continues to be defective, notify Leica Service. Do not continue to use the defective coverslip line in the meantime.

**8.3.3 Removing the rack from the lower area of the left elevator**

1. Moving the unload drawer into removal position (rescue position)
2. Reach to the left elevator with your left hand through the unload drawer (or through the load drawer after the vessels have been removed).
3. Press the rack downwards and out of the elevator (hold the holder from below using your little finger) and push it toward the back.
4. The rack can also be removed upwards using the coverslip line and the elevator. To do so, please note the action as described in step 2.

### 8.3.4 Removing the rack from the oven or from behind the oven



#### Warning

- Danger of explosion! Easily flammable reagents in the oven
- There is a potential for respiratory tract irritation through evaporating flammable reagents.
- Caution! Hot surfaces! The oven door and the interior of the oven are hot. Avoid contact if possible to prevent burns.

1. Open access to the oven (→ Fig. 118-1).
2. Open the oven door (→ Fig. 118-2) fully upwards (→ Fig. 118-3), the magnet holds the oven door in place (→ Fig. 118-4).
3. If the rack is not attached to the gripper (→ Fig. 118-5), the rack can be removed from the oven (→ Fig. 118-6).



#### Warning

It is possible that the mounting medium is not yet sufficiently dried. Because of this, remove the rack only with great caution to prevent sliding of the coverglasses on the slides.

4. Store the rack safely outside the instrument.
5. Detach the oven door from the magnet carefully (→ Fig. 118-7) and close it (→ Fig. 118-8).



#### Warning

Close the oven door carefully to prevent crushing your hand.



#### Note

You must feel the oven door click into place in the lock.

6. Finally, close the access to the oven (→ Fig. 118-1).



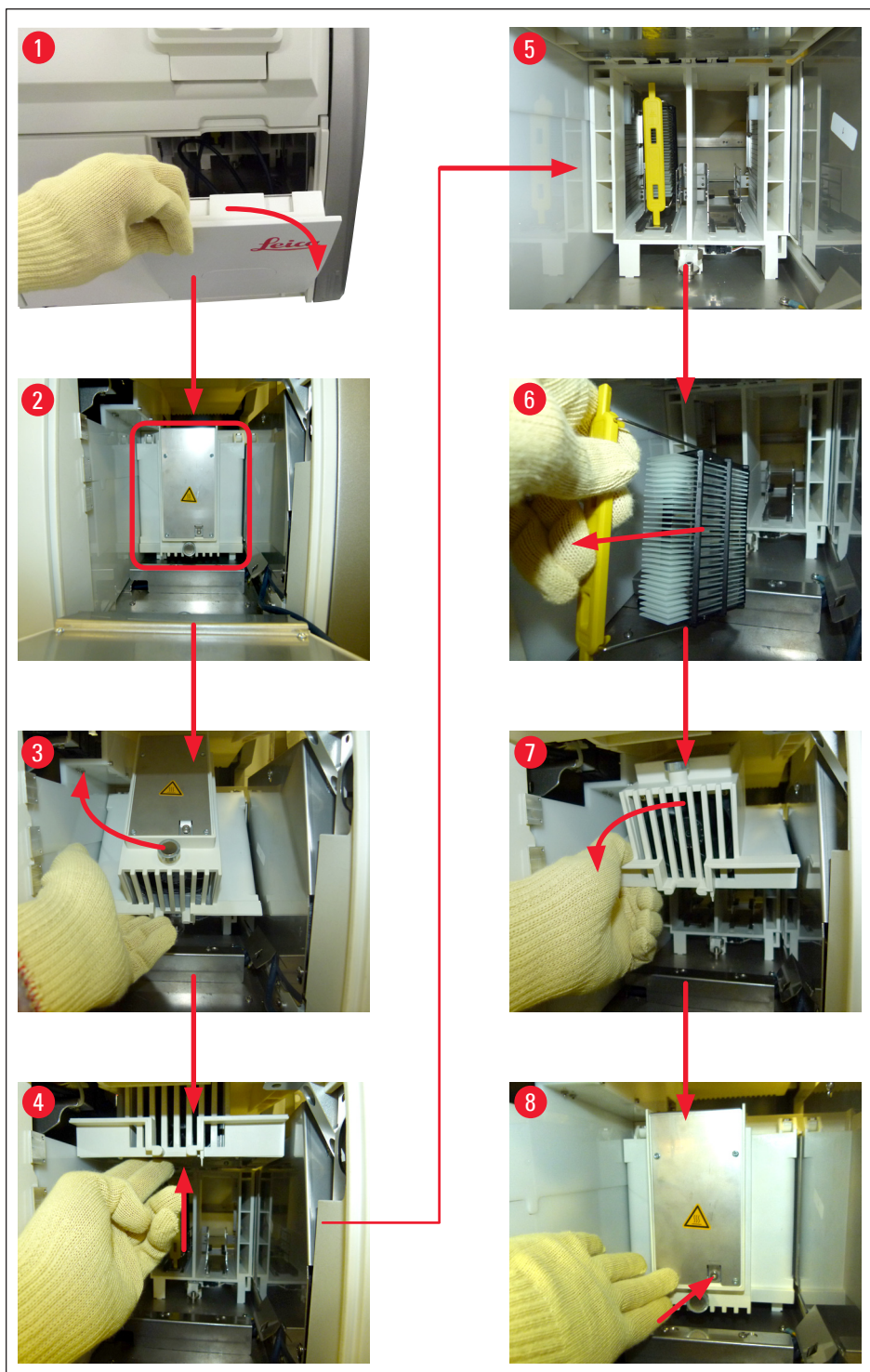

Fig. 118

### 8.3.5 Removal of the rack from the rotator

1. Moving the unload drawer into removal position (rescue position).
2. Insert your hand carefully into the instrument and remove the rack (→ Fig. 119-1) from the rotator (→ Fig. 119-2).



Fig. 119

### 8.3.6 Removal of the rack from the gripper above the rotator

1. Moving the unload drawer into removal position (rescue position).
2. Insert your hand carefully into the instrument and remove the rack from the gripper arm. To do so, grasp the handle and pull it forward, along with the rack, toward the load drawer.

### 8.3.7 Removal of a rack from the transfer station of the HistoCore SPECTRA ST

- ① If a malfunction occurs in workstation mode while the transfer device of the HistoCore SPECTRA ST transfers a rack to the HistoCore SPECTRA CV using the transfer station, the user must check where the rack is located.
1. Open the hood of the HistoCore SPECTRA ST.
  2. Check whether the rack is still visible from the transfer station (→ Fig. 120-1).

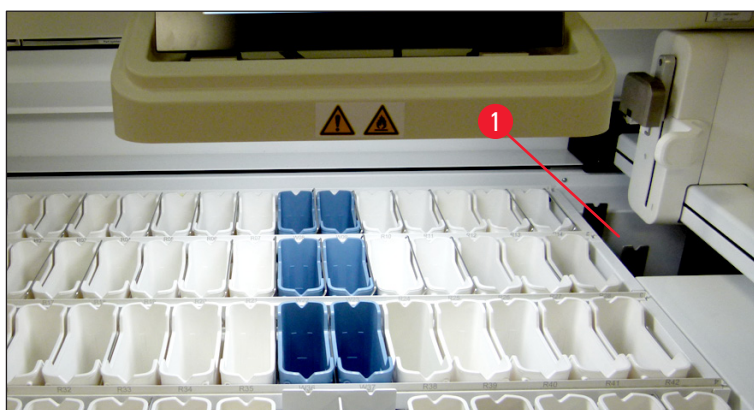

Fig. 120

3. If this is the case, push the sledge (→ Fig. 121-1) for the transfer station back into the HistoCore SPECTRA ST manually (→ Fig. 121-2) and remove the rack (→ Fig. 121-3) from the holder (→ Fig. 121-4).

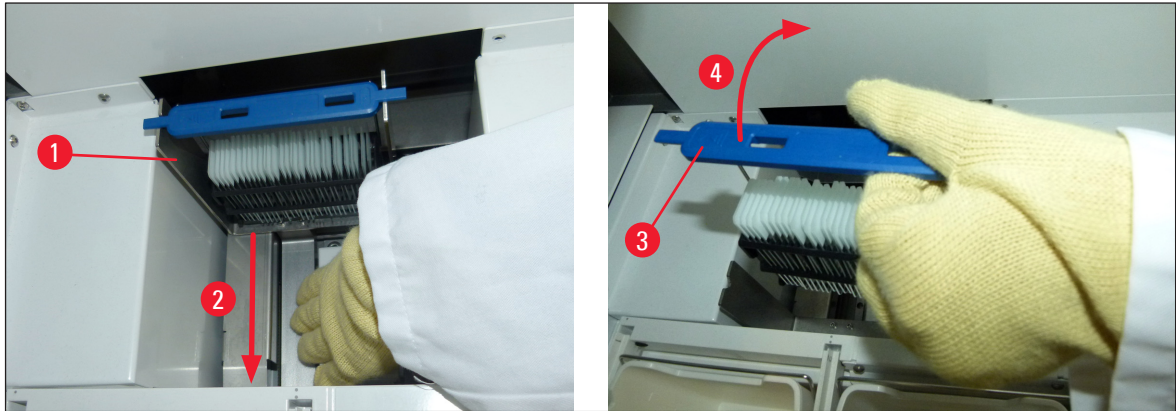

Fig. 121

4. Following this, remove the rack from the instrument and store it safely.
5. After the instrument fault has been corrected, insert the rack in the load drawer of the HistoCore SPECTRA CV to start processing.

#### 8.4 Replacing main fuses



##### Warning

The instrument should be shut down using the **Main Switch** and disconnected from the power supply in the case of an instrument failure. The main fuses can then be inspected.

A suitable flat-head screwdriver must be used to prevent damage to the fuse holders.

Beware of defective fuses! Potential risk of injury due to broken glass! Wear suitable protective clothing (safety goggles, cut-resistant gloves (→ P. 19 – 3.1 Standard delivery – packing list)).

1. To do so, open the hood and unscrew the two fuse holders (→ Fig. 122-1) on the top of the right cover with a flat-head screwdriver
2. Check the fuse being used for damage.



Fig. 122

3. Remove the defective fuse from the holder and replace it with a new fuse.
4. Installation occurs in the reverse sequence of operations.



## 9. Optional Accessories and Consumables

### 9.1 Optional accessories

Designation	Order No.
Rack for 30 slides* (3 pcs. per package)	14 0512 52473
Handle for rack for 30 slides* (yellow, 3 pcs. per package)	14 0512 52476
Handle for rack for 30 slides* (light blue, 3 pcs. per package)	14 0512 52477
Handle for rack for 30 slides* (dark blue, 3 pcs. per package)	14 0512 52478
Handle for rack for 30 slides* (pink, 3 pcs. per package)	14 0512 52479
Handle for rack for 30 slides* (red, 3 pcs. per package)	14 0512 52480
Handle for rack for 30 slides* (green, 3 pcs. per package)	14 0512 52481
Handle for rack for 30 slides* (black, 3 pcs. per package)	14 0512 52482
Handle for rack for 30 slides* (gray, 3 pcs. per package)	14 0512 52483
Handle for rack for 30 slides* (white, 3 pcs. per package)	14 0512 52484
Reagent vessel, assembly, each consisting of 1 pc.:	14 0512 47086
Reagent vessel	14 0512 47081
Reagent vessel cover	14 0512 47085
Reagent vessel handle	14 0512 47084
Label cover S	14 0512 53748
Label cover, blank	14 0512 47323
Waste tray	14 0514 49461
Solvent container kit (2 pcs.)	14 0514 54195
Prime bottle, assembly, consisting of:	14 0514 53931
Lab bottle, 150 ml	14 0514 56202
Screw cap	14 0478 39993
Prime bottle insert	14 0514 57251
28x3 mm O-ring	14 0253 39635
Cleaning bottle	14 0514 57248
Suction cup	14 3000 00403
Rack storage rails for the unload drawer	14 0514 55967
Active carbon filter set, consisting of:	14 0512 53772
Active carbon filter	14 0512 47131
Exhaust air hose set, consisting of:	14 0514 54815
Exhaust air hose, 2 m	14 0422 31974
Hose clamp	14 0422 31973
Cut-resistant gloves, size M, 1 pair	14 0340 29011



Designation	Order No.
Tool kit HistoCore SPECTRA CV, consisting of:	14 0514 54189
Screwdriver, 5.5x150	14 0170 10702
Leica brush	14 0183 30751
T16A fuse	14 6000 04696



Fig. 123

**Exhaust hose**

1 set, consisting of the following:

- Exhaust hose of length: 2 m
- Hose clamp

**Order No.:**

**14 0422 31974**

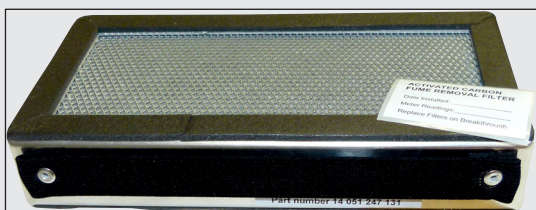

Fig. 124

**Active carbon filter**

1 set, consisting of 2 pcs.

**Order No.:**

**14 0512 53772**



Fig. 125

**Waste tray**

**Order No.:**

**14 0514 49461**



Fig. 126

## Needle cleaning container

1 kit, consisting of 2 pcs.

Order No.:

14 0514 54195



Fig. 127

## Reagent vessel

Assembly, incl. reagent vessel cover

Order No.:

14 0512 47086



Fig. 128

**Racks**

30 specimen slides (3 pcs. per package)

**Order No.:**

**14 0512 52473**



Fig. 129

**Handle for racks**

30 specimen slides (3 pcs. per package)

**Color**

- yellow
- light blue
- dark blue
- pink
- red
- light green
- black
- gray
- white

**Order No.:**

14 0512 52476  
 14 0512 52477  
 14 0512 52478  
 14 0512 52479  
 14 0512 52480  
 14 0512 52481  
 14 0512 52482  
 14 0512 52483  
 14 0512 52484



Fig. 130

**Prime bottle**

Assembly, consisting of:

- Lab bottle, 150 ml
- Screw cap
- Prime bottle insert
- 28x3 mm O-ring

**Order No.:**

**14 0514 53931**