

Wireless Door/window Sensor

Model 108WR

- Detect door/window open output wireless trigger signal
- 2 AAA size batteries operation (not Included)
- Low power consumption--- Long battery life
- Wireless RF transmission about 40~70 meters (Open space)
- Battery low/trigger indicator LED
- Magnetic switch left/right side either way is workable
- Compatible with additional wire magnetic sensor

INSTALLATION

1. Remove the screw from the main unit bottom and take out the cover.
2. Install 2 "AAA" alkaline batteries (not included) on the battery compartment, ensure the polarity is correct(Fig.1).
3. Replace the cover and screw.
4. Mount the magnetic door/window sensor
- a. Mount the magnetic door/window sensor by double -side tape Choose a suitable location, stick the main unit to door/window frames by attached double-side tape. Then stick the magnetic unit (smaller unit) to the door/window by attached double-side tape and make sure to align the "►" mark to right "◄" mark on the main unit and "◄" facing "►" at no more than 1/4" apart as shown below(Fig.2) .

(Fig.1)

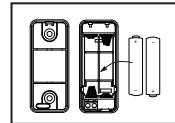

(Fig.2)

- b. Mount the magnetic door/window sensor by screws
- 1). Remove the screw from the battery compartment cover. Use the housing Bottom to mark the mounting location, then drill two holes to fix and install anchors and screws, replace the cover with screws. (Fig.3)

(Fig.3)



- 2). Use a pen or hard small objects to remove the magnetic unit. Use the housing bottom to mark the mounting location, then drill two holes to fix and install anchors and screws, replace the cover the screws. (Fig.4)

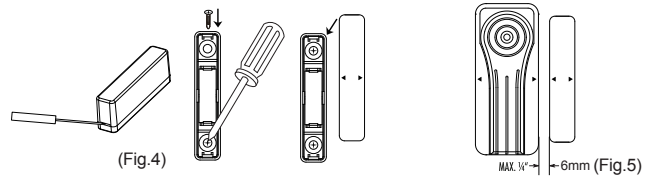

(Fig.4)

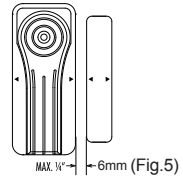

MAX. 1/4" 6mm (Fig.5)

- 3). Make sure to align the "►" mark to right "◄" mark on the main unit and "◄" facing "►" at no more than 1/4" apart as shown below (Fig.5)
5. External Magnetic sensor terminal you can additional wire magnetic sensor to expanding you desired detection area.
- a. Remove the screw from the battery compartment cover.
- b. Remove the screw from terminal and take out connect wire.
- c. Measure the length of wire needed to connect the sensor to the transmitter, then cut the wire to the correct length. Strip about 1/2 inch of insulation from the wire ends, and twist the wires together, parallel another wire as shown below.

- d. Connect the sensor switch on door to the main terminal post using the wire you just cut. (There is no polarity need to be taken care of, any terminal will be fine, as long as the wires from a loop)
- e. Connect another sensor switch screw to another switch terminal post by using the parallel another wire as shown below. (Fig.7)

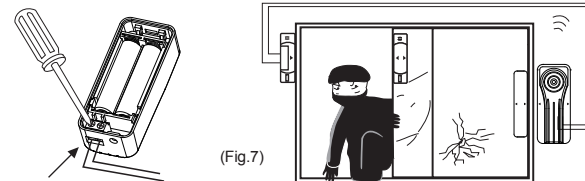

(Fig.7)

- f. If you connect more than one sensor to the main unit, connect them in series as shown below. (Fig.8)

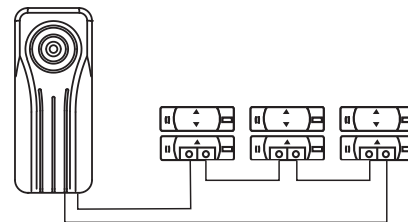

(Fig.8)

NOTE: After select a location, you should test the sensor transmitting range before mount it permanently, turn the CHIME switch to ON of 116S, 116X, T015S, T016S, 528, 625R, 639S main unit or press HOME button of T018S, T055S, T056S, T058S, T068S, T062S main unit, then open/close the magnetic switch of door/window sensor to trigger, you will hear the main unit sounds "DING DONG" chime if signal is received successfully, if not, change location as required.

LEARNING CODE TO MAIN UNIT

The wireless door/window sensor compatible 116S, 116X, T015S, T016S, T018S, T055S, T056S, T058S/VS, T068S, 639S, 526SL, 527SL, 528, 422R, 688R, 423R, 600R, 621S, 625R main unit, must learn code to main unit then use, learn code operation see main unit manual.

OPERATION

After 5 seconds installed battery, the unit will into standby mode. Once the door/window opened or vibration detected, the unit will output wireless radio signal and LED flash.

BATTERY LOW INDICATOR

When battery goes low, the LED will light on 3 seconds and off 1 second, change 2 new "AAA" batteries immediately, otherwise the sensor might not detect properly.

WARNING

To eliminate any risk or damage, when battery is low make sure change the battery immediately, or take out the battery when the device will be out of use for a long period, to avoid any battery leakage to damage this device.

FCC Statement

This equipment has been tested and found to comply with the limits for a Class B digital device, pursuant to Part 15 of the FCC Rules. These limits are designed to provide reasonable protection against harmful interference in a residential installation. This equipment generates uses and can radiate radio frequency energy and, if not installed and used in accordance with the instructions, may cause harmful interference to radio communications. However, there is no guarantee that interference will not occur in a particular installation. If this equipment does cause harmful interference to radio or television reception, which can be determined by turning the equipment off and on, the user is encouraged to try to correct the interference by one or more of the following measures:

- Reorient or relocate the receiving antenna.
- Increase the separation between the equipment and receiver.

- Connect the equipment into an outlet on a circuit different from that to which the receiver is connected.
- Consult the dealer or an experienced radio/TV technician for help.

This device complies with part 15 of the FCC Rules. Operation is subject to the following two conditions:(1) This device may not cause harmful interference, and (2) this device must accept any interference received, including interference that may cause undesired operation.

Changes or modifications not expressly approved by the party responsible for compliance could void the user's authority to operate the equipment.

The wireless door/window sensor compatible model with the following:

Motion Detector Alarm System Model 116S	Motion Detector Alarm For IP Camera Model 116X	Wireless Security/Safety Alarm With Auto Dialer Model T015S	Auto Dialer With Motion Sensor & Alarm Model T016S
Wireless Security Alarm /Auto Dialer System Model T018S	WirelessSecurity/ Safety Alarm System With Auto Dialer Model T055S	Wireless Security/ Safety Alarm System With Auto Dialer Model T056S	Wireless Security/ Safety Alarm System With Auto Dialer Model T058VS/T058S
GSM/PSTN Auto Dialer With Wireless Security/ Safety Alarm System Model T068S	Visitor Chime And Watch Dog/Alarm Model 639S	Wireless Outdoor Siren With Flash Light Model 526L/526F	Wireless Outdoor Siren With Flash Light Model 527L/527F
Built-in Alarm/Chime/ Mute/Flash Led Light Wireless Receiver Model 528	Wireless Receiver Model 600R	Wireless Outdoor Siren With Flash Light Model 621S	Wireless Control AC Socket Model 422R
Wireless Control AC Socket Model 688R	Wireless Control Lampholder Model 423R	Wireless Alert with 6 Sounds and Flash LED Model 625R	