

**INSTALLATION AND QUICK START GUIDE**

**WARNINGS AND CAUTIONS:**

- **TO AVOID FIRE SHOCK OR DEATH; TURN OFF POWER** at circuit breaker or fuse and test that power is off before wiring, servicing, installing or removing device.
- To be installed and/or used in accordance with electrical codes and regulations.
- If you are unsure about any part of these instructions, consult an electrician.
- To ensure that there is adequate room for wires, Leviton recommends using 3-1/2 inch deep wall boxes, at a minimum. For single-gang applications, this would be an 18-cubic inch wall box, at a minimum.
- Use this device with **copper or copper clad wire only**.

**DESCRIPTION**

The LevNet RF Receptacle (WSG15) is designed to use wireless communication and provide remote control of your lighting. The device will control lighting or equipment attached to the receptacle by receiving a wireless signal (315MHz) from other EnOcean enabled wireless devices.

Devices can be learned directly into the unit via the Programming Mode Selection Menu or wireless via the Leviton ComWi software and WSCOM-03W.

The WSG15 receptacle has a 50-100 ft. reception range depending upon the environment and transmission device. Range will be reduced by signals having to transmit through walls. **NOTE:** Some motorized devices, such as a power drill, can significantly reduce the effective range of the WSG15.

Transmit range for WSG15, when utilized as a repeater or for initial setup/commissioning is between 20-50 ft.

**FEATURES**

- Able to switch single (WSG15-0DZ) or dual (WSG15-TDZ) outlets ON/OFF remotely
- Scene Capable
- ON/OFF LED
- Can be remotely configured and commissioned using the LevNetRF ComWi software and EnOcean WSCOM hardware
- Includes repeater function (Level 1 or 2) to increase wireless reception to other devices
- Ease of installation – No new wiring
- Built-in tamper resistant barrier designed to limit improper insertion of small objects into receptacle contact slots

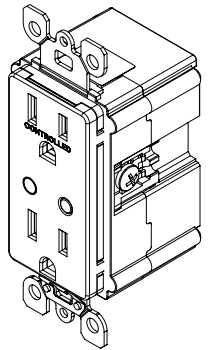

Single Controlled Top Outlet

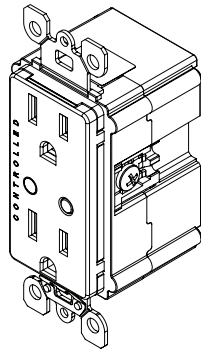

Dual Controlled Outlets

**COMPATIBLE DEVICES**

Most EnOcean Alliance enabled devices which conform to the EnOcean Equipment Profile (EEP) are compatible with the WSG15 receptacle. This includes but is not limited to room controllers, occupancy sensors, key cards, unpowered switches, door and window sensors made by Leviton as well as other EnOcean Alliance companies which support EEP 2.1 and above.

**EQUIPMENT NEEDED FOR INSTALLATION**

- Slotted/Phillips Screwdriver
- Pencil
- Electrical Tape
- Cutters
- Pliers
- Ruler

**INSTALLATION**

**Changing the color of your receptacle:**

Your receptacle includes five color options. The receptacle ships with the white frame attached. To change color of the frame, proceed as follows:

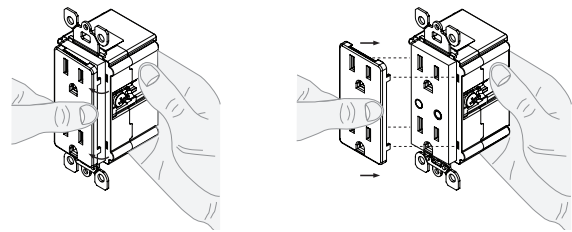

Push in side at tab to release

Line up tabs and press in sides one at a time to attach

**INSTALLING YOUR RECEPTACLE**

**NOTE:** Use check boxes  when Steps are completed.

**Step 1 WARNING: TO AVOID FIRE SHOCK OR DEATH; TURN OFF POWER** at circuit breaker or fuse and test that power is off before wiring!

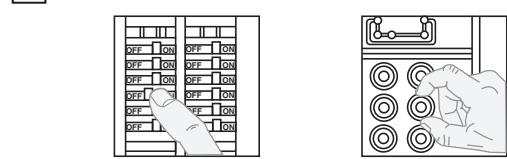

**Step 2 Identifying your wiring application (most common):**

**NOTE:** If the wiring in your wall box does not resemble this configuration, consult an electrician.

**Single Pole**

1. Line (Hot)
2. Neutral
3. Ground

**Step 3 Wiring the receptacle:**

This receptacle can be wired using side wire terminal screws or through backwire openings. Choose appropriate wire stripping specifications accordingly.

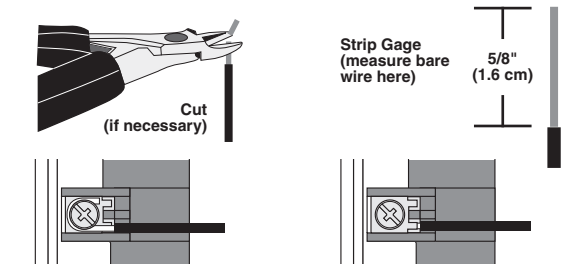

**Side Wire Connection**  
Side wire terminals accept #14-12 AWG solid copper wire only.

**Back Wire Connection**  
(either hole may be used)  
Back wire openings accept #14-12 AWG solid copper wire only.

- Make sure that the ends of the wires from the wall box are straight (**cut if necessary**).
- Remove insulation from each wire in the wall box as shown.

**Connect wires per WIRING DIAGRAM as follows:**

- Green or bare copper wire in wall box to Green terminal screw.
- Line Hot wall box wire to terminal screw (Black) marked "LINE".
- Line Neutral wall box wire to terminal screw (Silver) marked "NEUTRAL".
- Proceed to Step 4.

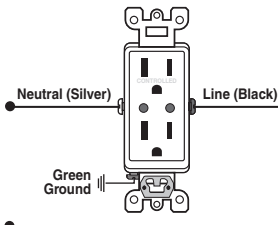

**Step 4 Testing your Receptacle prior to mounting in wall box:**

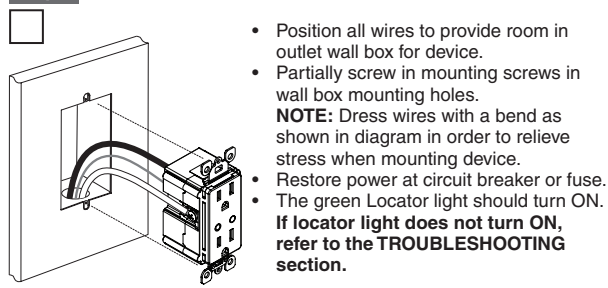

- Position all wires to provide room in outlet wall box for device.
- Partially screw in mounting screws in wall box mounting holes.
- NOTE:** Dress wires with a bend as shown in diagram in order to relieve stress when mounting device.
- Restore power at circuit breaker or fuse.
- The green Locator light should turn ON. **If locator light does not turn ON, refer to the TROUBLESHOOTING section.**

**Step 5 Receptacle Mounting: TURN OFF POWER AT CIRCUIT BREAKER OR FUSE.**

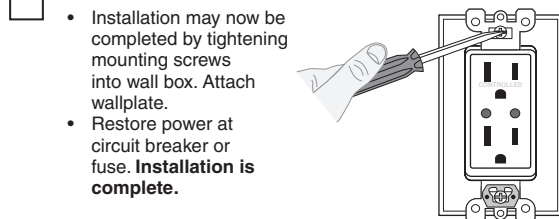

- Installation may now be completed by tightening mounting screws into wall box. Attach wallplate.
- Restore power at circuit breaker or fuse. **Installation is complete.**

**INSTALLING SOFTWARE (OPTIONAL)**

For additional details refer to the ComWi Installation & Operation instructions. Consult the factory for details.

**Programming Instructions:**

All devices are learned in a "reduced sensitivity" mode to avoid interference from other devices which may be active in areas close by. This reduction of sensitivity reduces the range so devices learned to the WSG15 receptacle should be within 10 ft when learning.

**Factory Defaults (only accessible via ComWi software):**

- Occupancy Sensor Timeout: 20 minutes
- Momentary Egress Delay: 0 seconds
- Repeater Mode: ON, Level 1

**Time-Outs:**

When used with an occupancy sensor the WSG15 has six time-out settings: 2, 5, 10, 15, 20, or 30 min. (a longer timeout is recommended when using self powered devices in dark spaces). The values of time-out defaults to 20 minutes and can only be changed using the ComWi software with WSCOM tool.

**Walk-Through Time Delay:**

The walk-through feature is only active in the Auto-On/Auto-Off mode with time delay > 2 minutes. This feature is useful when a room is momentarily occupied. When enabled, the Sensor will turn the lights OFF shortly after the person leaves the room. The walk-through feature works in the following manner: When a person enters the room, the lights will turn ON. If the person leaves the room before the walk-through time-out of 2.5 minutes, the Sensor will turn the lights OFF within 2.5 minutes of no occupancy detected. If the room is occupied for longer than 2.5 minutes, the Sensor will enter the Occupied Mode with the time-out duration specified by Factory Default settings or configuration set by the ComWi software.

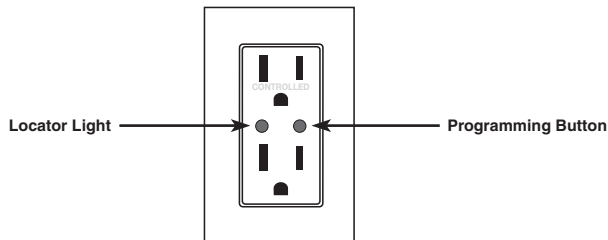

There are five distinct programming modes, each represented by a different Amber Blink:

Amber Blinks	Mode	Details
1	Rocker	<ul style="list-style-type: none"> <li>• Door and Window Sensors – "Normal" mode. OPEN = OFF (magnet is not near sensor), CLOSED = ON (magnet near sensor).</li> <li>• Switches – Sets the device to use the "I" side to turn the light ON and the "O" side to turn the light OFF. Acts light normal rocker light switch.</li> <li>• Occupancy sensor – Manual-ON/Auto-OFF mode which turns the light OFF when unoccupied. Has a 30 second Vacancy period before lights can only be turned ON via switch. Default delay time is 20 minutes.</li> <li>• SLT Device – "Normal" mode. Similar to a switch which turns lights ON and keeps lights ON when active.</li> </ul>
2	Momentary	<ul style="list-style-type: none"> <li>• Door and Window Sensors – "Inverted" mode. OPEN = ON (magnet is not near sensor), CLOSED = OFF (magnet near sensor).</li> <li>• Switches and Key Cards – Press turns the lights ON and release turns them OFF. Intended for key card devices to turn lights ON when card is inserted and OFF when removed. Only applies to the actual button pressed on the device (ignores the other side of a Decora® rocker switch).</li> <li>• Occupancy sensor – Auto-ON/Auto-OFF mode. Turns lights ON with detection of occupancy and lights OFF when unoccupied (after time delay). Default delay time is 20 minutes.</li> </ul>
3	Toggle	<ul style="list-style-type: none"> <li>• Door and Window Sensors – "Inverted" mode. OPEN = ON (magnet is not near sensor), CLOSED = OFF (magnet near sensor).</li> <li>• Switches/Key Cards – The state of the lights will toggle with the press of the switch or insertion of a Key Card. Only applies to the actual button pressed on the device (ignores the other side of a Decora® rocker switch). Removing the Key Card will be ignored.</li> <li>• Occupancy sensor – Auto-ON/Auto-OFF mode with 2.5 minute Walk-Thru Enabled. Turns lights ON with detection of occupancy and lights OFF when unoccupied. Default delay time is 20 minutes.</li> </ul>
4	Scene	<ul style="list-style-type: none"> <li>• Door and Window Sensors – "Inverted" mode. OPEN = ON (magnet is not near sensor), CLOSED = OFF (magnet near sensor).</li> <li>• Switch and Key card devices – Restores the state of the lights to what they were when the device was learned. Only applies to the actual button pressed on the device (ignores the other side of a Decora® rocker switch).</li> </ul>
5	Clear All	<ul style="list-style-type: none"> <li>• Clears all devices from memory and returns device to factory default configuration.</li> </ul>

**NOTE:** If a NEW occupancy sensor is learned, then all learned occupancy sensors for that unit will default to this current state learned. For example, if the first occupancy sensor is learned as Manual-ON/Auto-OFF and the second occupancy sensor is learned to Auto-ON/Auto-OFF, then all occupancy sensors will default to the last learned occupancy state, which is Auto-ON/Auto-OFF in this case.

Follow these directions for the standard way to program and configure the WSG15 Receptacle.

1. Enter Programming Mode by pressing and holding the Programming Button for 15 Seconds until the LED on the receptacle begins flashing Amber slowly 1x per second. This is the Mode Selection Menu of programming.
2. Press the Programming Button to advance between the five programming modes. The Amber LED will blink to represent the Programming Mode.
3. Press and hold the Programming Button 3-5 seconds to enter the desired Programming Learn Mode. The LED will blink Red (empty) or Green (memory) upon entering the Programming Learn Mode.
4. Press the Programming Button for 1-2 seconds to leave the programming mode and go back to the Mode Selection Menu (Amber blink).
5. Device will exit Programming Mode after 20 seconds of inactivity.

**NOTE:** Amber flashing LED represents the Mode Selection Menu of programming. No buttons can be learned into a receiver with Amber flashing lights. A Red or Green flashing LED represents the Programming Learn Mode.

**Rocker Mode Programming Instructions (LED flashing Amber 1x per second)**

1. Upon entering Programming Mode, the device will automatically begin in Rocker Mode (Amber LED flashing 1x per sec).
2. To Learn a device in Rocker Mode press and hold the Programming Button for 3-5 seconds until the LED changes from Amber to Red or Green to signify you are now in the Programming Learn Mode.
3. When learning a wireless switch to the LevNet RF Receptacle, press one end of a switch rocker. When learning a transmitter other than a wireless switch or keycard, press the LEARN button on the transmitter (**see appropriate transmitter instruction sheet**). The LED on the receptacle will turn Amber and the load will toggle states for 2 seconds indicating that the receptacle has stored the transmitter's unique ID in its memory. **NOTE:** The LED will change from Flashing Red to Flashing Green on the first learned device or increase the number of Green flashes to represent a device was learned. **NOTE:** Pressing the transmitter switch again will unlearn the unique ID. The load will not toggle and the Green LED will light up for 2 seconds before going back to a Red or Green blink. **NOTE:** If only one transmitter is desired then skip to Step 6.
4. To program additional transmitters to communicate with this receptacle in Rocker Mode, wait until LED flashing resumes. Repeat the instructions in Step 3 until the unique IDs of all desired transmitters are stored in the Rocker Mode memory of the receiver (up to 20). The Green tracking blinks for up to 20 devices learned, however, the Programming Mode will exit after 20 seconds of inactivity so it will not be possible to tell if 20 devices are learned.
5. To program additional transmitters to communicate with this receptacle in another Mode, press the receiver switch/programming button and return to the Mode Selection Menu (Amber LED flashing). The Amber LED will be flashing 1x per second for Rocker Mode. Pressing the receiver switch button will advance the Amber flashing to the next Programming Mode, Momentary Mode (Amber flash 2x per second). Follow Steps 3 and 4 to program transmitters to Momentary Mode.
6. To exit Learn Mode, just wait; the receiver automatically exits Learn Mode after 20 seconds (indicated by the ceasing of the LED flashing).



# ARTWORK PRINT SPECIFICATIONS



**PART NUMBER** DI-000-WSG15-02A-X5    **REV** \_\_\_\_\_    **DESCRIPTION** Instruction sheet

**SPECIFICATIONS :**

<p><b>Dimensions:</b> <u>11" x 17"</u></p> <p>* <b>Thickness:</b> <u>40 lb.</u></p> <p>* <b>Material:</b> <u>Offset</u></p> <p>* <b>Finish:</b> _____</p> <p>_____ :</p> <p>* <b>For manuals - designates cover specifications</b></p>	<p>* <b>Color(s):</b> <u>1</u> over <u>1</u></p> <p>1: <u>Black</u> <input checked="" type="checkbox"/> <b>Spot</b></p> <p>2: _____ <input type="checkbox"/> <b>Spot</b></p> <p>3: _____ <input type="checkbox"/> <b>CMYK</b></p> <p>4: _____ <input type="checkbox"/> <b>CMYK</b></p>	<p>* <b>Fonts:</b></p> <p>1: <u>Helvetica</u></p> <p>2: _____</p> <p>3: _____</p> <p>4: _____</p>
--	--	---

**Die Line Key:**    - . . . - Perforate  
 \_\_\_\_\_ Die Cut    - - - - - Fold Line    - - - - - Kiss Cut    . . . . . Cellophane    \_\_\_\_\_ Glue

**MANUAL INTERIORS / BINDERY / FOLD SCHEME :**

<p><b>Body Material:</b> _____</p> <p><b>Thickness:</b> _____</p> <p><b>Bindery</b></p> <p><input type="checkbox"/> Die cut    <input checked="" type="checkbox"/> <b>Fold</b>    <input type="checkbox"/> Saddle Stitch</p> <p><input type="checkbox"/> Perfect Bind    <input type="checkbox"/> Drill    <input type="checkbox"/> Trim</p>	<p><b>Color(s):</b> _____ over _____</p> <p>1: _____ <input type="checkbox"/> <b>Spot</b></p> <p>2: _____ <input type="checkbox"/> <b>Spot</b></p> <p>3: _____ <input type="checkbox"/> <b>CMYK</b></p> <p>4: _____ <input type="checkbox"/> <b>CMYK</b></p>	<p><b>Fonts:</b></p> <p>1: _____</p> <p>2: _____</p> <p>3: _____</p> <p>4: _____</p>
--	--	--

**PROCESS :**

Offset     Flexo

Other \_\_\_\_\_

**Line Screen:** \_\_\_\_\_

**Angle:** \_\_\_\_\_

**Resolution:** \_\_\_\_\_

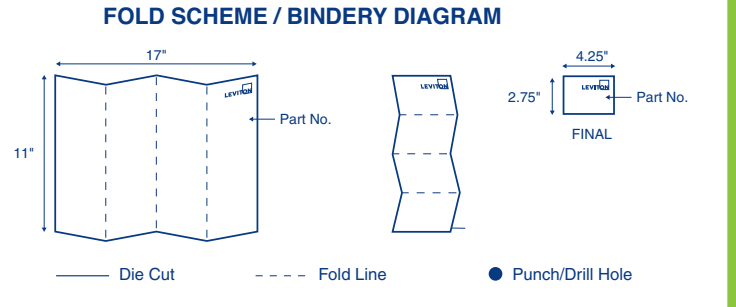

**COMMENTS :**

\_\_\_\_\_

\_\_\_\_\_

The information in this document is the exclusive PROPRIETARY property of LEVITON MANUFACTURING COMPANY, INC. It is disclosed with the understanding that acceptance or review by the recipient constitutes an undertaking by the recipient. (1) to hold this information in strict confidence, and (2) not to disclose, duplicate, copy, modify or use the information for any purpose other than that for which disclosed.

**FOR LEVITON USE ONLY**

<input checked="" type="checkbox"/> <b>Approvals:</b> <input checked="" type="checkbox"/> <b>Plant</b> <u>08</u> <u>J. Tang</u>	<input checked="" type="checkbox"/> <b>CQA</b> <u>J. Rhinestine</u>	<input checked="" type="checkbox"/> <b>PM</b> <u>J. Elzie</u>
<input type="checkbox"/> <b>Mktg</b> _____	<input checked="" type="checkbox"/> <b>Eng</b> <u>D. Wright</u>	<input checked="" type="checkbox"/> <b>S &amp; A</b> <u>K. Vannice</u>
<input type="checkbox"/> <b>Cust</b> _____	<input checked="" type="checkbox"/> <b>Other</b> <u>V. LoNigro</u>	<input type="checkbox"/> <b>Other</b> _____

**PN-ARN:** LE0132-4008    **ECO Number:** \_\_\_\_\_    **Pilot Rev:** \_\_\_\_\_

**Artist:** D. Hunt    **Artwork Release Date:** \_\_\_\_\_

**Notes:** \_\_\_\_\_





# ARTWORK PRINT SPECIFICATIONS



**PART NUMBER** DI-000-WSG15-52A-X5    **REV** \_\_\_\_\_    **DESCRIPTION** Instruction sheet

**SPECIFICATIONS :**

<p><b>Dimensions:</b> <u>11" x 17"</u></p> <p>* <b>Thickness:</b> <u>40 lb.</u></p> <p>* <b>Material:</b> <u>Offset</u></p> <p>* <b>Finish:</b> _____</p> <p>_____ :</p> <p>* <b>For manuals - designates cover specifications</b></p>	<p>* <b>Color(s):</b> <u>1</u> over <u>1</u></p> <p>1: <u>Black</u>    <input checked="" type="checkbox"/> <b>Spot</b></p> <p>2: _____    <input type="checkbox"/> <b>CMYK</b></p> <p>3: _____</p> <p>4: _____</p>	<p>* <b>Fonts:</b></p> <p>1: <u>Helvetica</u></p> <p>2: _____</p> <p>3: _____</p> <p>4: _____</p>
--	--	---

**Die Line Key:**    - . . - Perforate  
 \_\_\_\_\_ Die Cut    - - - - - Fold Line    - - - - - Kiss Cut    . . . . . Cellophane    ||||| Glue

**MANUAL INTERIORS / BINDERY / FOLD SCHEME :**

<p><b>Body Material:</b> _____</p> <p><b>Thickness:</b> _____</p> <p><b>Bindery</b></p> <p><input type="checkbox"/> Die cut    <input checked="" type="checkbox"/> <b>Fold</b>    <input type="checkbox"/> Saddle Stitch</p> <p><input type="checkbox"/> Perfect Bind    <input type="checkbox"/> Drill    <input type="checkbox"/> Trim</p>	<p><b>Color(s):</b> _____ over _____</p> <p>1: _____    <input type="checkbox"/> <b>Spot</b></p> <p>2: _____    <input type="checkbox"/> <b>CMYK</b></p> <p>3: _____</p> <p>4: _____</p>	<p><b>Fonts:</b></p> <p>1: _____</p> <p>2: _____</p> <p>3: _____</p> <p>4: _____</p>
--	--	--

**PROCESS :**

Offset     Flexo

Other \_\_\_\_\_

**Line Screen:** \_\_\_\_\_

**Angle:** \_\_\_\_\_

**Resolution:** \_\_\_\_\_

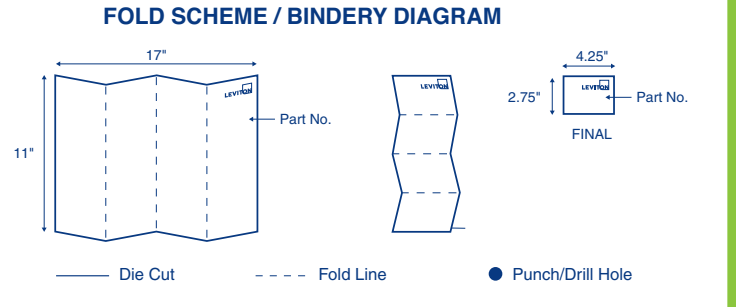

**COMMENTS :**

\_\_\_\_\_

\_\_\_\_\_

The information in this document is the exclusive PROPRIETARY property of LEVITON MANUFACTURING COMPANY, INC. It is disclosed with the understanding that acceptance or review by the recipient constitutes an undertaking by the recipient. (1) to hold this information in strict confidence, and (2) not to disclose, duplicate, copy, modify or use the information for any purpose other than that for which disclosed.

**FOR LEVITON USE ONLY**

**Approvals:**     **Plant** 08 J. Tang     **CQA** \_\_\_\_\_     **PM** \_\_\_\_\_

**Mktg** \_\_\_\_\_     **Eng** \_\_\_\_\_     **S & A** \_\_\_\_\_

**Cust** \_\_\_\_\_     **Other** L. Audrain     **Other** \_\_\_\_\_

**PN-ARN:** LE0132-4008    **ECO Number:** \_\_\_\_\_    **Pilot Rev:** \_\_\_\_\_

**Artist:** D. Hunt    **Artwork Release Date:** \_\_\_\_\_

**Notes:** \_\_\_\_\_







# ARTWORK PRINT SPECIFICATIONS



**PART NUMBER** DI-000-WSG15-42A-X5    **REV** \_\_\_\_\_    **DESCRIPTION** Instruction sheet

**SPECIFICATIONS :**

<p><b>Dimensions:</b> <u>11" x 17"</u></p> <p>* <b>Thickness:</b> <u>40 lb.</u></p> <p>* <b>Material:</b> <u>Offset</u></p> <p>* <b>Finish:</b> _____</p> <p>_____ :</p> <p>* <b>For manuals - designates cover specifications</b></p>	<p>* <b>Color(s):</b> <u>1</u> over <u>1</u></p> <p>1: <u>Black</u>    <input checked="" type="checkbox"/> <b>Spot</b></p> <p>2: _____    <input type="checkbox"/> <b>CMYK</b></p> <p>3: _____</p> <p>4: _____</p>	<p>* <b>Fonts:</b></p> <p>1: <u>Helvetica</u></p> <p>2: _____</p> <p>3: _____</p> <p>4: _____</p>
--	--	---

**Die Line Key:**    - . . . - Perforate  
 \_\_\_\_\_ Die Cut    - - - - - Fold Line    - - - - - Kiss Cut    . . . . . Cellophane    ||||| Glue

**MANUAL INTERIORS / BINDERY / FOLD SCHEME :**

<p><b>Body Material:</b> _____</p> <p><b>Thickness:</b> _____</p> <p><b>Bindery</b></p> <p><input type="checkbox"/> Die cut    <input checked="" type="checkbox"/> <b>Fold</b>    <input type="checkbox"/> Saddle Stitch</p> <p><input type="checkbox"/> Perfect Bind    <input type="checkbox"/> Drill    <input type="checkbox"/> Trim</p>	<p><b>Color(s):</b> _____ over _____</p> <p>1: _____    <input type="checkbox"/> <b>Spot</b></p> <p>2: _____    <input type="checkbox"/> <b>CMYK</b></p> <p>3: _____</p> <p>4: _____</p>	<p><b>Fonts:</b></p> <p>1: _____</p> <p>2: _____</p> <p>3: _____</p> <p>4: _____</p>
--	--	--

**PROCESS :**

Offset     Flexo

Other \_\_\_\_\_

**Line Screen:** \_\_\_\_\_

**Angle:** \_\_\_\_\_

**Resolution:** \_\_\_\_\_

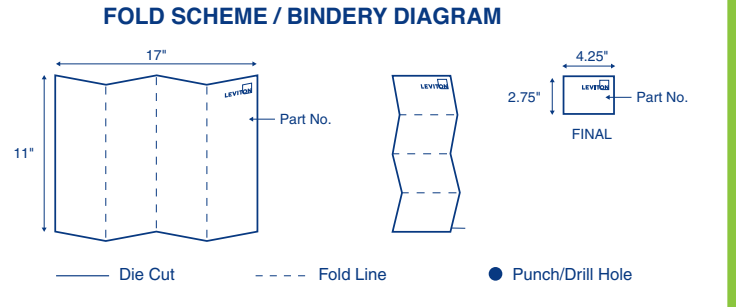

**COMMENTS :**

\_\_\_\_\_

\_\_\_\_\_

The information in this document is the exclusive PROPRIETARY property of LEVITON MANUFACTURING COMPANY, INC. It is disclosed with the understanding that acceptance or review by the recipient constitutes an undertaking by the recipient. (1) to hold this information in strict confidence, and (2) not to disclose, duplicate, copy, modify or use the information for any purpose other than that for which disclosed.

**FOR LEVITON USE ONLY**

**Approvals:**  **Plant** 08 J. Tang     **CQA** \_\_\_\_\_     **PM** \_\_\_\_\_

**Mktg** \_\_\_\_\_     **Eng** \_\_\_\_\_     **S & A** \_\_\_\_\_

**Cust** \_\_\_\_\_     **Other** L. Sierra     **Other** \_\_\_\_\_

**PN-ARN:** LE0132-4008    **ECO Number:** \_\_\_\_\_    **Pilot Rev:** \_\_\_\_\_

**Artist:** D. Hunt    **Artwork Release Date:** \_\_\_\_\_

**Notes:** \_\_\_\_\_