



ENGLISH



User Guide

GT540R



Printed in Korea

P/N : MMBB0391701(1.0) **WR**

www.lg.com



GT540R User Guide - English

Congratulations on your purchase of the advanced and compact GT540R phone by LG, designed to operate with the latest digital mobile communication technology.

- Some of the contents of this manual may not apply to your phone depending on your phone's software or your service provider.
- This handset has a touch screen keypad and is not recommended for people with impaired vision.
- Copyright ©2010 LG Electronics, Inc. All rights reserved. LG and the LG logo are registered trademarks of LG Group and its related entities. All other trademarks are the property of their respective owners.
- Google™, Google Maps™, Gmail™, YouTube™, Google Talk™ and Android Market™ are trademarks of Google, Inc.



Contents

Important notice	6	LG Home	21
1. Phone memory	6	Android Home	23
2. Optimising Battery Life	6	Adding widgets to your home screen	24
3. Installing an Open Source OS..	7	Getting back to a recently used application.....	24
4. Using Unlock pattern	8	Google Account Set-up	27
5. Using Safe Mode and Hard Reset	8	Creating your Google account ..	27
6. Connecting to Wi-Fi networks..	9	Signing in your Google account..	27
7. Using a microSD card.....	10	Calls	29
8. Opening and Switching Applications.....	10	Making a call	29
9. Connecting your phone to a computer via USB.....	11	Calling your contacts.....	29
Getting to know your phone .	13	Answering and rejecting a call..	29
Installing the SIM card and battery	15	Adjusting call volume	29
Charging your phone.....	16	Making a second call	29
Installing the memory card ...	17	Viewing your call logs.....	30
Formatting the memory card..	18	Call settings.....	30
Your Home screen	19	Contacts.....	32
Touch-screen tips	19	Searching for a contact	32
Note.....	19	Adding a new contact.....	32
Touch calibration.....	19	Favorite contacts.....	33
Lock and unlock screen.....	20	Creating a group	33
Using your home screen	20	Messaging/E-mail.....	34
Select your default home screen	20	Messaging.....	34
		Sending a message.....	34

Entering text	35	Using the advanced settings ..	43
T9 mode	35	Viewing your saved photos ...	45
Abc mode.....	35	Video camera.....	46
123 Mode	36	Getting to know the viewfinder	46
Entering accented letters.....	36	Shooting a quick video	47
Example	36	After shooting a video.....	47
Setting up your email	36	Using the advanced settings ..	47
Sending an email using your new account.....	36	Watching your saved videos..	48
Retrieving your email.....	37	Your photos and videos	49
Changing your email account's settings.....	37	Viewing your photos and videos..	49
Threaded box	37	Adjusting the volume when viewing a video	49
Changing your message settings	38	Setting a photo as wallpaper..	49
Social Networking	39	Editing your photos	49
Adding your account to your phone	39	Rotating your photo.....	50
Viewing and updating your status	40	Adding text to a photo	50
Removing accounts on your phone	40	Adding an effect to a photo...50	
Camera	41	Cropping a photo	51
Getting to know the viewfinder..	41	Tuning your photo	51
Using the focus mode.....	42	Adding frames	51
Taking a quick photo	42	Adding clipart	51
Once you've taken the photo	43	Using the drawpad	52
		Adding stamps.....	52
		Resizing	52
		Editing your videos	52
		Trimming the length of the video..	52
		Selecting transition style.....	52

Contents

Adding subtitles	53	Google applications	62
Adding edit effects	53	Google Maps	62
Grabbing a frame	53	Android Market	62
Adding dubbing to your video ..	54	Gmail	63
Multimedia.....	55	Google Talk.....	63
Timeline view.....	55	Rogers	64
My Images options menu.....	56	Utilities.....	65
Sending a photo.....	56	Setting your alarm.....	65
Sending a video	56	Using your calculator.....	65
Using an image.....	56	Adding an event to your calendar	66
Creating a slideshow	56	Changing your calendar view	66
Checking your photo	56	Quickoffice	66
Media Player	57	Voice recorder	67
Video editor	57	Recording a sound or voice...	67
Storyboard.....	57	Browser	68
Music Movie	58	Browser.....	68
Auto cut	58	Accessing the Web.....	68
Playing a game	58	Using the Web tool bar	68
Transferring files using USB mass storage devices.....	59	Using options.....	68
Music.....	59	Adding and accessing bookmarks	69
Playing a song	59	Changing Web browser settings..	69
Using the radio	60		
Searching for stations	60		
Resetting channels.....	61		
Listening to the radio.....	61		

Settings	70	Accessories	77
Wireless controls	70	Technical data	78
Sound & display	70	Troubleshooting	79
Data synchronization	71	For Your Safety	81
Security & location	71	Safety Guidelines	88
To lock your screen by using the Pattern Lock	72		
Applications.....	72		
SD card & phone storage.....	72		
Date and time	73		
Locale and text	73		
Search	73		
Accessibility.....	73		
Speech synthesis	73		
About phone	73		
Wi-Fi	74		
1. How to set up Wi-Fi	74		
2. Wi-Fi network profile support	74		
3. How to obtain the MAC address	75		
Software update	76		
Phone Software update	76		
DivX Mobile 	76		

Important notice

Please check to see if any problems you have encountered with your phone are described in this section, before taking the phone in for service or calling a service representative.

1. Phone memory

When available space on your phone memory is less than 10%, your phone can not receive a new message. You need to check your phone memory and delete some data such as applications or messages to make more memory available.

To manage the application

1. On the home screen, touch **Applications** tab and select **Settings> Applications> Manage applications**.
2. When all applications appear, scroll and select the application you want to uninstall.
3. Tap **Uninstall** and touch OK to uninstall application you desired.

2. Optimising Battery Life

You can extend your battery's life between charges by turning off features that you don't need to run constantly in the background. You can also monitor how applications and system resources consume battery power.

To extend the life of your battery

- Turn off radio communications that you aren't using. If you aren't using Wi-Fi, Bluetooth®, or GPS, turn them off.
- Turn down screen brightness and set a shorter screen timeout.
- Turn off automatic syncing for Gmail, Calendar, Contacts, and other applications.
- Some applications you've downloaded may cause your battery's life to be reduced.

To check the battery charge level

1. On the home screen, touch **Applications** tab and select **Settings> About phone> Status**.
2. The battery status (charging, not charging) and level (as a percentage of fully charged) are displayed at the top of the screen.

To monitor and control what uses the battery

1. On the home screen, touch **Applications** tab and select **Settings> About phone> Battery use**.
2. The top of the screen displays battery usage time. Either how long since last connected to a power source or, if connected to a power source, how long you were last running on battery power. The body of the screen lists applications or services using battery power from greatest amount to least.

3. Installing an Open Source OS

If you install an open source OS on your phone, and do not use the OS provided by the manufacturer, this may cause your phone to malfunction.



WARNING: If you install and use an OS other than the one provided by the manufacturer, your phone is no longer covered by the warranty.



WARNING: To protect your phone and personal data, download applications only from trusted sources, such as Android Market. If some applications are not properly installed on your phone, your phone may not work normally or a serious error can be occurred. You will need to uninstall those applications and all of its data and settings from the phone.

Important notice

4. Using Unlock pattern

Set unlock pattern to secure your phone. Opens a set of screens that guide you through drawing a screen unlock pattern.



WARNING: Precautions to take when using the Pattern Lock

It is very important that you remember the unlock pattern you set. You will not be able to access your phone if you use an incorrect pattern 5 times. After attempting the unlock pattern 5 times, you can touch the Forget Pattern Option and use your Google account information to unlock your phone.

If you do not have Google account, you don't create the Google account on the phone, or you forget it, you can use **Hard Reset**.

5. Using Safe Mode and Hard Reset

Using Safe mode

* To recover from malfunction state of your phone

1. Turn off your phone and reboot. While your phone is powering back on, press and hold the Home key during Android Logo is displayed. Your phone will boot all the way to the main screen and display "safe mode" in lower left corner.
2. Select **Settings>Applications>Manage applications**, and choose the application then select an **Uninstall** icon.
3. After uninstalling the application, turn off and reboot your phone.

* Using Hard Reset (Factory Reset)

If it does not restore to the original condition, use **Hard Reset** to initialize your phone.

When your phone turns on and the lock screen displays, press and hold the volume up + Home + Search keys all at the same time (for five seconds). When the pop up screen is shown, choose OK to reset your phone.

Please note, after you perform **Hard Reset**, all your data and applications on your phone will be erased and cannot be reversed.



WARNING:

If you perform Hard Reset, all user applications and user data will be deleted. Please remember to back up any important data before performing **Hard Reset**.

6. Connecting to Wi-Fi networks

To use Wi-Fi on your phone, you access a wireless access point, or “hotspot.” Some access points are open and you can simply connect to them. Others

are hidden or implement other security features, so you must configure your phone so it can connect to them.

Turn off Wi-Fi when you're not using it, to extend the life of your battery.

To turn Wi-Fi on and connect to a Wi-Fi network

1. On the home screen, touch **Applications** tab and select **Settings > Wireless controls > Wi-Fi settings**.
2. Touch **Wi-Fi** to turn it on and begin scan for available Wi-Fi networks.
 - List of available Wi-Fi networks is displayed. Secured networks are indicated by a lock icon.
3. Touch a network to connect to it.
 - If the network is open, you are prompted to confirm that you want to connect to that network by touching **Connect**.

Important notice

- If the network is secured, you're prompted to enter a password or other credentials. (Ask your network administrator for details.)
4. The Status bar displays icons that indicate Wi-Fi status.

7. Using a microSD card

Pictures, along with Music and Video files, can only be saved to external memory.

Before using the built-in camera, you need to insert a micro SD memory card to your phone first.

Without inserting a memory card, you will not be able to save pictures and videos you had taken.

NOTE: Applications can only be saved to the phone's internal memory.



WARNING:

Do not insert or remove the memory card when the phone is on. Otherwise, it may damage the memory card as well as your phone, and the data stored on the memory card may be corrupted. To remove the memory card safely, please select **Home Screen > Applications Settings > SD Card&phone storage > Unmount SD card.**

8. Opening and Switching Applications

Multi-tasking is easy with Android because open applications keep running even when you open another application. There's no need to quit an application before opening another. Use and switch among several open applications. Android manages each application, stopping and

starting them as needed, to ensure that idle applications don't consume resources unnecessarily.

To stop the application you use

1. On the home screen, touch **Applications** tab and select **Settings> Applications> Manage applications**.
2. Scroll to the desire application and touch **Force stop** to stop using it.

9. Connecting your phone to a computer via USB

NOTE: You need LG PC Suite to use GT540R as USB mass storage.

GT540R does not support:

- PC Connection via Bluetooth
- LG Air Sync (Web Sync, R-Click)
- OSP (On Screen Phone)
- To-do in Calendar
- Memo
- E-mail
- Java Application

User's guide for PC Suite IV is in Help menu after install PC Suite IV.

1. Use the USB cable with your phone to connect the phone to a USB port on your computer. You receive a notification that the USB is connected.
2. Open the Notification drawer and touch USB connected.
3. Touch **Mount** to confirm that you want to transfer files between your phone's microSD card and the computer.

Important notice

When the phone is connected as USB storage, you receive a notification. Your phone's microSD card is mounted as a drive on your computer. You can now copy files to and from the microSD card.

NOTE: Unlock screen when using data connection

Your display will go dark if untouched for a period of time when using data connection. To turn on your LCD screen, just touch it.

Note: When uninstalling PC Suite IV, USB and Bluetooth Drivers are not automatically removed. Therefore, they must be uninstalled manually.

Tip! To use a microSD card on you phone again, you need to open the Notification drawer and touch "Turn off USB storage".

During this time, you can't access the microSD card from your phone, so you can't use applications that rely on the microSD card, such as Camera,

Gallery and Music.

To disconnect your phone from the computer, carefully follow your computer's instructions to disconnect USB devices correctly, to avoid losing information on the card.

1. Safely disconnect the USB device on your computer.
2. Open the Notification drawer and touch **Turn off USB storage**.
3. Touch **Turn off** in the dialog that opens.

Getting to know your phone

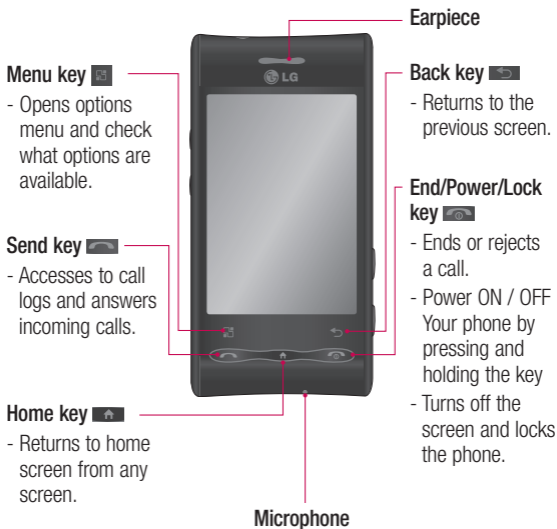

Getting to know your phone

Volume keys

- On the home screen: controls ringer volume.
- During a call: controls your earpiece volume.
- When playing a track: controls volume.

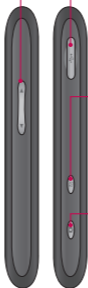

Charger, micro USB cable connector

Search key

- Searches the web and contents in your phone.

Camera key

- Goes to the camera menu directly by pressing and holding the key.

Stereo earphone connector

Camera lens

microSD memory card slot

Charger, micro USB cable connector

Search key

Back cover

Battery

SIM card slot

Camera key

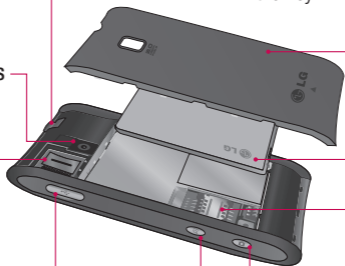

Installing the SIM card and battery

Before you can start exploring your new phone, you'll need to set it up. To insert the SIM card and battery:

- 1 With the back of the phone facing you, remove the back cover. To remove the back cover, firmly press your thumbs on either side of the back cover, and slide the cover below the camera lens.

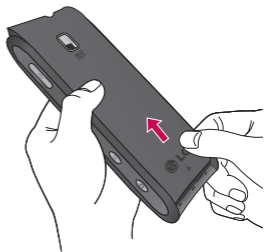

- 2 Slide the SIM card into the SIM card holder. Make sure the gold contact area on the card is facing downwards.

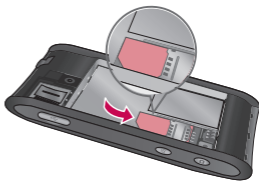

Getting to know your phone

- 3 Insert the battery into place by aligning the gold contacts on the phone and the battery, then gently press the battery until it snaps into space.

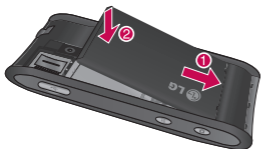

- 4 Replace the back cover of the phone and slide it down into place until the latch clicks.

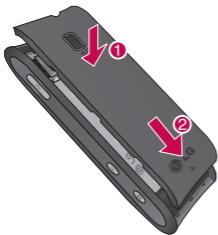

Charging your phone

Slide back the cover of the charger connector on the side of your GT540R. Insert the charger, and plug it into an electrical outlet. Your GT540R must be charged until you can see .

NOTE: The battery must be fully charged initially to improve battery lifetime.

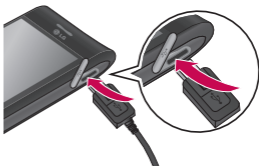

NOTE: The GT540R has an internal antenna. Be careful not to scratch or damage this rear area, as that will cause loss of performance.

Installing the memory card

To store multimedia files such as captured images by using a built-in camera, you must insert a memory card to your phone.

To insert a memory card:

NOTE: The GT540R supports up to a 32GB memory card.

- 1 Turn the phone off before inserting or removing the memory card. Remove the back cover.

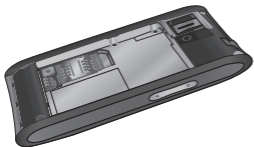

- 2 Open the slot protection and insert the memory card into the slot. Make sure the gold contact area is facing downwards.



- 3 Close the slot protection.

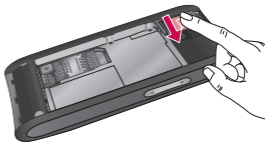

Getting to know your phone

WARNING:

Do not insert or remove the memory card when the phone is on. Otherwise, it may damage the memory card as well as your phone, and the data stored on the memory card may be corrupted.

Formatting the memory card

Your memory card may already be formatted. If it isn't, you must format it before you use it.

NOTE: All files on the card are deleted when you format the card.

- 1 On the home screen, touch **Applications** tab to open the applications menu.
- 2 Scroll and touch **Settings**.
- 3 Scroll and touch **SD card & phone storage**.
- 4 Unmount SD Card.
- 5 Touch **Format SD card**, then confirm your choice.
- 6 If you set the pattern lock, input the pattern lock and select **Erase Everything**. The card will then be formatted and ready to use.

NOTE: If there is content on your memory card, the folder structure may be different after formatting since all the files will have been deleted.

Tip!

If your memory card is already Unmount, you can use the following step to format it.

Touch **Applications > Settings > SD card & phone storage > Format SD Card**.

Your Home screen

Touch-screen tips

Here are some tips on how to navigate around your phone.

Touch - To choose a menu/option or open an application, touch it.

Touch and hold - To open an options menu or grab an object you want to move, touch and hold it.

Drag - To scroll through a list or move slowly, drag across the touch screen.

Flick - To scroll through a list or move quickly, flick across the touch screen (drag quickly and release).

Note

- To select an item, touch the centre of the icon.
- Do not to press too hard; the touch screen is sensitive enough to pick up a light, firm touch.

- Use the tip of your finger to touch the option you want. Be careful not to touch any other keys.

Touch calibration

Calibrating the device screen involves tapping the centre of a cross as it moves around the screen. This process ensures that when you tap the screen, the tapped item is activated.

If your phone does not accurately respond to screen taps, follow these steps to re-calibrate.

1. Tap **Application > Settings > Sound & display**, and scroll to the **Touch settings**.
2. Touch **Touch calibration**, and follow the instructions on the screen.
3. After calibration is completed, choose between **Check calibration** and **Save without check**, then complete Calibration.

Your Home screen

Lock and unlock screen

Whenever your GT540R is not in use, it will return to the lock screen.

If you do not use the phone for a while, the home screen or other screen you are viewing, is replaced with the lock screen when the screen blacks out, to conserve the battery. To wake up your phone, press **Send, Home,** or **Power** key. The lock screen will appear. Touch the lock icon and drag your finger to the right to unlock. The last screen you were working on opens.

Using your home screen

Touch the **Applications** tab at the bottom of the screen. You can then view all your installed applications.



Applications

NOTE: Some screen images may be different depending on your phone provider.

Select your default home screen

The user interface is based on two types of home screens: **LG Home** and **Android Home**.

You can set your favorite home screen as the default.

If you want to change the default home settings, choose **Home selector** from the applications menu.

LG Home

Simply swipe your finger to the left or right to view them. You can also customize each panel with widgets, shortcuts which are shortcuts to your favorite applications, folders and wallpapers.

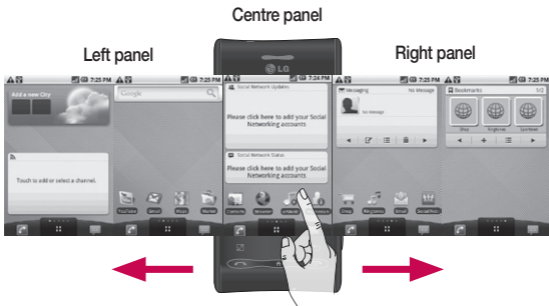

Tip!

Small dots at the application tab on the bottom of the screen indicate which panel you're viewing.

Your Home screen

In your LG home screen, you can view quick keys on the bottom of the screen. The quick keys provide easy, one-touch access to the functions you use the most.

Touch the **Phone** icon to bring up the touch-dialling pad to make a call.



Touch the **Message** icon to access the messaging menu. Here, you can create a new message.

Touch the **Applications** icon to open the applications menu.
Just touch to scroll through your applications.

Android Home

Simply swipe your finger to the left or right to view them. You can also customize each panel with widgets, shortcuts which are shortcuts to your favorite applications, folders and wallpapers.

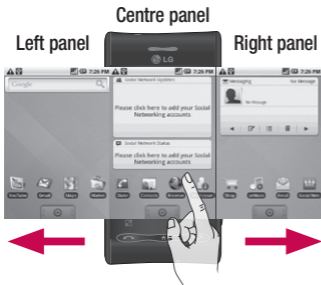

Touch the **Applications** icon to open the applications menu. Just touch and slide up or down the screen to scroll through your applications.



Applications

Your Home screen

Adding widgets to your home screen

You can customize your home screen by adding shortcuts, widgets, folders or wallpaper to it. For more convenience using your phone, add your favorite widgets on the home screen.

NOTE: LG Home and Android Home provide this function.

To add an desired icon to your home screen:

- 1 On the home screen, touch **Menu** key and select **Add**.
- 2 On the **Add to Home screen** menu, touch the type of item you want to add.
- 3 For example, select **Folders** from the list and tap it.
- 4 Select **Contacts with phone numbers** from the list and tap it.

- 5 You will see a new folder's icon on the home screen. Drag it to the desired location on the desired panel and release your finger from the screen.

To remove an application icon from the home screen:

- 1 Touch and hold that icon. The **Applications** icon will be change as the **Trash** icon.
- 2 Drag and drop an application icon to the Trash icon.

Getting back to a recently used application

- 1 Touch and hold the **Home** key. The screen will show you a pop up with icons of applications that you've used recently.
- 2 Touch an icon to open its application. Or, touch **Back** key to return to the current application.

Notification drawer

The notification drawer runs across the top of your screen. Touch and slide the notification drawer down with your finger. Or, on the home screen, touch **Menu** key and select **Notifications**. Here, you can check Wi-Fi, Bluetooth, GPS status as well as other notifications.













Viewing the status bar

The status bar uses different icons to display phone information, such as signal strength, new messages, battery life, and active Bluetooth and data connections.









Below is a table explaining the meaning of icons you're likely to see in the status bar.









[Status bar]

Icon	Description
	No SIM card
	No signal
	Wi-Fi is on and connected
	Wired headset
	Call forward
	Call hold
	Speakerphone
	Call mute
	Missed call
	Bluetooth on
	Bluetooth connected
	System warning
	Alarm
	New voicemail

Your Home screen

Icon	Description
	Flight mode
	Silent
	Vibrate
	No SD card
	Battery fully charged
	Battery is charging
	Data in
	Data out

Icon	Description
	Data in and out
	USB to PC
	Download
	Upload
	GPS is acquiring
	GPS is on
	Service message
	Setting message

Google Account Set-up

The first time you open the Google application on your phone, you will be required to sign in with your existing Google account. If you do not have a Google account, you're prompted to create one.

Creating your Google account

- 1 On the home screen, touch **Applications** tab  to open the applications menu.
- 2 Tap **Gmail**, and tap **Next > Create** to start the Gmail set up wizard.
- 3 Touch a text field to open the touch keyboard, and enter your name and username for your Google account. When you enter the text, you can move to the next text field by touching **Next** on the keyboard.

- 4 When you're finished to input name and username, tap **Next**. Your phone is communicating with Google servers and checking username availability.
- 5 Enter and re-enter your password. Then follow the instructions and enter the required and optional information about the account. Wait while the server creates your account.

Signing in your Google account

- 1 Enter your e-mail address and password, then tap **Sign in**. Wait for signing in.
- 2 After sign in, you can use Gmail and take advantages of Google services on your phone.



Google Account Set-up

- 3 Once you have set up your Google account on your phone, your phone will be automatically synchronised with your Google account on the web. (It depends on your synchronization settings.)

After sign in, you can use Gmail, Google Calendar, Android Market and Google Map; download applications from Android Market; back up your settings to Google servers; and take advantage of other Google services on your phone.

Calls

Making a call

- 1 Touch  to open the keypad.
- 2 Enter the number on the keypad. To delete a digit, touch the **Clear** icon .
- 3 Touch the **Call** icon  to make a call.
- 4 To end a call, touch **End**.

TIP! To enter “+” to make international calls, touch and hold down .

Calling your contacts

- 1 Touch  to open your contacts.
- 2 Scroll through the contact list or enter the first letter(s) of the contact you want to call by touching **Search**.
- 3 In the list, touch the contact you want to call, then select the number to use if there is more than one for that contact.

Answering and rejecting a call

When your phone rings, press the **Send** key to answer. You can also drag the **Call** icon  to the right.

Press the **End** key to reject an incoming call.

TIP! When the phone rings, touch and slide the silent icon  to the left if you want to switch to silent mode.



Adjusting call volume

To adjust the volume during a call, use volume up & down key on the left side of the phone.

Making a second call

- 1 During your initial call, Touch the **Menu** key then touch . Then, select the number you want to call.

Calls

- 2 Dial the number, or search your contacts.
- 3 Touch the **Call** icon  to connect the call.
- 4 Both calls will be displayed on the call screen. Your initial call will be locked and put on hold.
- 5 Touch  to toggle between calls. Or touch  to make a conference call.
- 6 To end active calls, touch **End call**. If there is no active call, it will end the **Hold call**. To end all calls at the same time, touch the **Menu** key and select **End call**.

NOTE: You will be charged for each call you make.

Viewing your call logs

On the home screen, press the **Send** key to view **Call log**.

View a complete list of all dialed, received, and missed voice calls.

TIP! Touch any single call log entry to view the date, time, and duration of the call.

TIP! Touch the **Menu** key, then touch **Clear call log** to delete all the recorded items.

Call settings

You can configure phone call settings, such as call forwarding, call waiting, and other special features offered by your carrier.

- 1 On the home screen, touch **Applications** tab to open the applications menu.
- 2 Scroll and touch **Settings**.
- 3 Tap **Call settings**, and choose options that you want to adjust.

Fixed Dialing Numbers – Select Fixed Dialing Numbers to turn on and compile a list of numbers that can be called from your phone. You'll need your PIN 2 code, which is available from your operator. Only numbers within the fixed dial list can be called from your phone.

Voicemail – Set up your voicemail number.

Call forwarding – You can configure how your calls are forwarded when you're on the phone, when you don't answer, and so on. Choose from **Always forward**, **Forward when busy**, **Forward when unanswered**, or **Forward when unreachable**.

Then enter the number to forward to.

NOTE: Diverting calls will incur charges. Please contact your network operator for details.

Call barring – Select when you would like calls to be barred. Enter the call barring password. Please check with your network operator about this service.

Call costs – View the charges applied to your calls. This service is network dependent; some operators do not support this function.

Call duration – View the duration of all calls including all, dialed, received calls and the last call.

Additional call settings – This lets you change the following settings:

Caller ID : Choose whether to display your number on an outgoing call.

Call Waiting : If call waiting is activated, the handset will notify you of an incoming call while you are on a call.

Select line : Allows to select line.

Contacts

You can add contacts on your phone and synchronise them with the contacts in your Google Account or other accounts that support syncing contacts.

Searching for a contact

There are two ways to search for a contact:

On the Home screen

- 1 On the home screen, touch  to open your contacts.
- 2 Touch **Search** and enter the contact name using the keypad.

TIP! To search by group, touch the **Contacts** tab at the top of the screen and select **Groups**. This will display a list of all your groups.

From the main menu

- 1 On the home screen, touch **Applications** tab to open the applications menu.

- 2 Touch **Settings**, and select **Search**.

Adding a new contact

- 1 On the home screen, touch , and enter the new contact's number, then touch the **Menu** key, touch **Save number** and then **New contact**.
- 2 If you want to add a picture to the new contact, touch . You can use a saved picture or take a new one.
- 3 Touch a text field to open the touch keyboard, and enter a new contact's name.
- 4 Select the contact type by tapping **Phone** tab and choose from **Phone**, **SIM** and **Google**.
- 5 Touch a category of contact information and enter the details about your contact.
- 6 Touch **Done** to save the contact.

Favorite contacts

You can classify frequently called contacts as favorites.

To add a contact to your favorites

- 1 On the home screen, touch  to open your contacts.
- 2 Touch a contact to view its details.
- 3 Touch the star to the right of the contact's name. The star turns gold.

To remove a contact from your favorites list

- 1 On the home screen, touch  to open your contacts.
- 2 Touch the **Favorites** tab and choose a contact to view its details.
- 3 Touch the gold star on the right of the contact's name. The star turns grey and the contact is removed from your favorites.

Creating a group

- 1 On the home screen, touch  to open your contacts.
- 2 Touch **New Group** and then enter a name for the new group.
- 3 You can set a ringtone for the newly created group.
- 4 Touch **Done** to save the group.

NOTE: If you delete a group, the contacts assigned to that group will not be lost. They will remain in your contacts.

Messaging/E-mail

Messaging

Your GT540R combines SMS and MMS into one intuitive, easy-to-use menu.

Sending a message

- 1 Touch **Messaging** icon on the home screen, and touch **New message** to open a blank message.
- 2 Enter a contact name in the **To** field. As you enter the contact name, matching contacts appear. You can touch a suggested recipient or continue entering the contact name. You can add multiple contacts.
NOTE: You will be charged for a text message for every person you send the message to.
- 3 Touch a message field to start entering your message. Enter the text message using the keypad screen.

- 4 Touch the **Menu** key to open the options menu. Choose from **Preview, Call, Add subject, Attach, Send, and More (Insert smiley, Discard, All threads, and Add to Contacts)**.
- 5 Touch **Send** to send your message.
- 6 The message screen opens, with your message after your name. Responses appear on the screen. As you view and send additional messages, a message thread is created.



WARNING: The 160-character limit may vary from country to country depending on how the SMS is coded.





WARNING: If an image, video, or audio file is added to an SMS message, it will be automatically converted into an MMS message, and you will be charged accordingly.

NOTE: When you get an SMS message during a call, there is no alert, but you will see it on the indicator bar.

Entering text

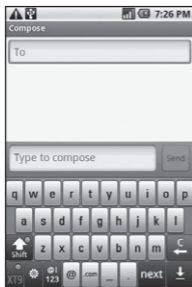
Keypad



 Touch to turn on T9 predictive text.

 Tap to change between the number, symbol, and text keypads.

Touch  to view the **Editor Settings, Keypad types, Writing Language, User Dictionary** and **Input Method**.

Use  to swap between lowercase and uppercase. The coloured circle on the button tells you if uppercase is locked on (green) or if it is just on for one character (orange).

To enter a space, touch .

T9 mode

The T9 mode uses a built-in dictionary to recognize the words you're writing based on the sequence of keys you've touched. It predicts the word you are inputting and suggests alternatives.

Abc mode

This mode allows you to enter letters by touching the key labelled with the required letter once, twice, three or four times until the letter is displayed.

Messaging/E-mail

123 Mode

This mode allows you to enter numbers in a text message (a telephone number, for example) more quickly. Touch the keys corresponding to the required digits before manually switching back to the appropriate text entry mode.

Entering accented letters

When you select French or Spanish as the text entry language, you can enter special French or Spanish characters (e.g., “à”).

After the corresponding letter character disappears, press the same key repeatedly until you see the special character you want.

Example

To input, press and hold the “a” key.

After the letter “a...” disappears, keep your finger pressed on the screen and slide left or right to select the desired character.

Setting up your email

Keep in touch while on the move by using your GT540R to send emails. It's quick and simple to set up a LG push, POP3 or IMAP4 email account.

- 1 On the home screen, touch **Applications** tab and tap **Email** to view the mail boxes for each email account. Or, you can also touch **Email** on the home screen to access directly.
- 2 If the email account is not set up, start the email setup wizard.

TIP! If an email account is already set up, the wizard is not activated automatically.

Sending an email using your new account

- 1 Touch **Email** icon on the home screen, and then touch **Compose icon** to open a new blank message.

- 2 Enter the recipient's address, then write your message. You can also attach images, videos, audio files, and various document file formats.
- 3 Touch **Send icon** to send your email.

TIP! During an active Wi-Fi connection, emails are sent and received using Wi-Fi.

Retrieving your email

You can automatically or manually check your account for new email.

To check manually:

- 1 Touch **Email icon** on the home screen.
- 2 Then touch the account you want to use.
- 3 Choose **Refresh** and your GT540R will then connect to your email account and retrieve your new messages.

Changing your email account's settings

You can change your email settings based on your own preferences.

- 1 Touch **Email icon** on the home screen, and tap the desired account.
- 2 Touch the **Menu** key to open the options menu, and tap **Settings**.
- 3 You can adjust the following options: **Account Setup** and **General Settings**.

Threaded box

Messages (SMS, MMS) exchanged with another party can be displayed in chronological order so that you can conveniently see an overview of your conversation.

NOTE: When you send an MMS message, there will be no delivery report, but you will see the  icon.

Messaging/E-mail

Changing your message settings

Your GT540R message settings are predefined, so you can send messages immediately. You can change the settings based on your preferences.

Touch **Messaging** icon on the home screen, then touch the **Menu** key. Tap **Settings**.

< SMS settings >

Delivery reports – Activate to receive confirmation that your messages have been delivered.

Manage SIM Card Messages – Manage the messages stored on your SIM card.

Validity period – Choose how long your messages are stored in the message centre.

Text message centre – Enter the details of your message centre.

< MMS settings >

Delivery reports – Choose to request a delivery report.

Read reports – Choose to request a read report for each message you send.

Auto-retrieve – Activate to retrieve messages automatically.

Roaming auto-retrieve – Activate to retrieve messages while roaming.

Set priority – Choose the priority level of your MMS.

Validity period – Choose how long your message is stored in the message centre.

Creation mode

Restricted: In this mode, the MMS Client device only creates and sends messages with content belonging to the Core MM Content Domain.



WARNING: In this mode, the MMS Client device guides the user in creating and sending messages with content belonging to the Core MM Content Domain. This guidance is provided through warning dialogs.

Free: In this mode, the MMS Client allows the user to add any content to the message.

Receive advertisement – Allows receiving advertisement messages.

< Other settings >

Service message – Choose whether to receive or block service messages.

Notification settings – Activate to display message notifications in the status bar. Also select a ringtone and activate vibrate to alert you of new messages.

Info. Service settings – Choose whether to receive, block, or view or edit channels to receive information service messages (cell broadcast messages). Also choose the languages of information service messages.

Social Networking

With your phone, you can enjoy the social networking and manage your micro-blog in on-line communities. You can update your current status and view your friends' status updates real-time.

You can add your Facebook, Twitter or Bebo accounts to your phone. If you don't have an account, you can visit their sites to set it up.

NOTE! An additional costs may be incurred when connecting and using online services. Check your data charges with your network provider.

Adding your account to your phone

- 1 Touch **SNS** icon on the home screen.
- 2 Touch **Add account** to add a social networking account.
- 3 Select the kind of account to add.

Messaging/E-mail

- 4 Enter your e-mail address and password that you set up on your community, then tap **Log in**.
- 5 Wait while your details are checked with your community.
- 6 Check your community is turned **ON**. If you tap your community, you can see the current status of your social community.

TIP! If you add a social networking widget on your home screen, the widget will show your status when your phone updates from the network.

You can also access the social community directly by touching up the widget.

Viewing and updating your status

- 1 Choose a community you want to access.
- 2 The community home will be appear. You can see the current status of your social community.

- 3 If you want to update your status, tap **Status** and write the current status, then touch **Share**.

Note: This is dependent on network services.

Removing accounts on your phone

- 1 In the list of SN (Social Networking) manager, touch **Menu** key and touch **Remove account**.
- 2 Choose and check a community you want to delete your account, then tap **Remove account**.
- 3 Tap **OK** to confirm.

Camera

Getting to know the viewfinder

Brightness – This defines and controls of the amount of sunlight entering the image. Slide the brightness indicator along the bar, towards “-” for a lower brightness image, or towards “+” for a higher brightness image.

Zoom – Zoom in or zoom out. Alternatively you can use the side volume keys.

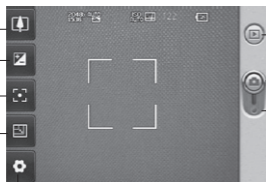

Gallery – This enables you to access your saved photos from within the camera mode. Simply touch, and your gallery will appear on the screen.

Taking a photo

Video mode – Slide down this icon to switch to video mode.

Settings – Touch this icon to open the settings menu. See **Using the advanced settings**.

Image size – Touch to set the size (in pixels) of the picture you take. Select a pixel value from the numerical options: 3M (2048x1536), 2M (1600x1200), 1M (1280x960), VGA (640x480), QVGA (320x240).

Focus – Touch this icon to select the options menu. See **Using the focus mode**.

Note: You need to insert a memory card first to take a picture. Without inserting a memory card, you will not be able to save the picture you had taken.

Camera

TIP! You can close all the shortcut options to give a clearer viewfinder screen. Just touch the centre of the viewfinder once. To recall the options, touch the screen again.

Using the focus mode

You can select the focus mode as following options;

Auto Focus – Set the camera to focus automatically.

Macro – Macro mode allows you to take extreme close-ups. If you are trying to take a close-up shot but the focus box remains red, try turning the macro mode on.

Face tracking – If you set Face tracking and take a photo, your camera detects and focuses on human faces automatically.

After saving a photo in your Gallery, you can give a new nickname to someone in the photo by touching and holding the face. It will be placed on the People bar in your Gallery. You can also connect to Contacts

to match the photo with the contact.

NOTE: Zoom is not supported in Face tracking mode.

Manual Focus – Set the camera to focus manually.

Taking a quick photo

- 1 Press and hold the camera key on the right side of the phone.
- 2 Holding the phone horizontally, point the lens towards the subject you want to photograph.
- 3 Press the capture button lightly, and a focus box will appear in the centre of the viewfinder screen.
- 4 Position the phone so you can see the subject in the focus box.
- 5 When the focus box turns green, the camera has focused on your subject.
- 6 Press the capture button and hold it down.

Once you've taken the photo

Your captured photo will appear on the screen.



Share Touch to share your photo as **Bluetooth**, **Email**, **Gmail**, **Messaging**, **Picasa**, or **SNS**.

NOTE: Additional charges may apply when MMS messages are downloaded while roaming.

Set as Touch to use the image as **Contact icon**, **Lock screen** or **Wallpaper**.

Rename Touch to edit the name of the selected picture.

Edit Touch to edit the image using various tools.

-  Touch to view a gallery of your saved photos.
-  Touch to delete the image.
-  Touch to take another photo immediately. Your current photo will be saved.

 Touch to return to the previous menu.

Using the advanced settings

In the viewfinder, touch  to open all advanced options.

You can change the camera setting by scrolling the wheel. After selecting the option, touch the Back key.

Image quality – Choose from **Super Fine**, **Fine**, and **Normal**. The finer the quality, the sharper the photo. However, the file size will increase as a result, which means you'll be able to store fewer photos in the memory.

White balance – Choose from **Auto**, **Incandescent**, **Sunny**, **Fluorescent**, and **Cloudy**.

Shot mode – Choose from **Normal**, **Continuous shot**, **Beauty shot**, **Frame shot**, **Panorama**, **Art shot**, and **Smile shot**.

Camera

Timer – The self-timer allows you to set a delay after the shutter is pressed. Select **Off**, **3 seconds**, **5 seconds**, or **10 seconds**. This is ideal if you want to be included in a photo.

ISO – The ISO rating determines the sensitivity of the camera's light sensor. The higher the ISO, the more sensitive the camera will be. This is useful under darker conditions when you cannot use the flash. Select from ISO values of **Auto**, **100**, **200**, and **400**.

Scene mode – Choose from **Auto**, **Portrait**, **Landscape**, **Sports**, **Night**, and **Sunset**.

Color effect – Choose a colour tone for your new photo.

Once you've made your selection, use the Back key to close the colour tone menu. You are then ready to take a picture.

NOTE: You can change a colour picture to black and white or sepia, but you cannot change a black-and-white or sepia picture to colour.

Captured image – Choose from **Hold**, **On**, **Off**. If you select On, after taken picture screen is shown for 1 second, and it goes to the preview right away.

Grid screen – Choose from **Off**, **2x2**, or **3x3**.

Shutter sound – Select one of the four shutter sounds.

GEO-Tagging – Activate to use your phone's location-based services. Take pictures wherever you are and tag them with the location. If you upload tagged pictures to a blog that supports geotagging, you can see the pictures displayed on a map.

NOTE: This function is only available when GPS is active.

Hide icons – Choose the camera setting icons to hide manually or automatically.

Blink detection – Turn this on to display a red box around the face that was blinking in the preview image screen.

Reset – Restore all camera default settings.

TIP! When you exit the camera, all settings will return to their defaults, except image size and image quality. Any nondefault settings must be reset, such as colour tone and ISO. Check these before you take your next photo.

TIP! The settings menu is superimposed over the viewfinder, so when you change elements of the image colour or quality, you will see a preview of the image change behind the settings menu.

Viewing your saved photos

- 1 You can access your saved photos from within the camera mode. Just touch  and your gallery will appear on the screen.

Video camera

Getting to know the viewfinder

Brightness – This defines and controls of the amount of sunlight entering the Video. Slide the brightness indicator along the bar, towards “-” for a lower brightness Video, or towards “+” for a higher brightness Video.

Zoom – Zoom in or zoom out. Alternatively you can use the side volume keys. Before starting record a video, you can use the zoom function. You can not control the zoom function during recording.

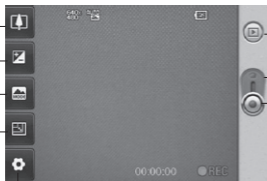

Gallery – This enables you to access your saved photos & Videos from within the video camera mode. Simply touch, and your gallery will appear on the screen.

Camera mode – Slide up this icon to switch to camera mode.



Start recording

Settings – Touch this icon to open the settings menu. See **Using the advanced settings**.

Video size – Touch to set the size (in pixels) of the video you record. Choose your video image size from VGA (640x480), QVGA (320x240) or QCIF (176x144).

Scene mode – Set the camera to adjust to the environment. Choose from **Auto, Portrait, Landscape, Sports, Sunset** and **Night**.

Shooting a quick video

- 1 Press and hold the camera key on the right side of the phone.
- 2 Then slide the capture button down position, the icon will change to .
- 3 The video camera's viewfinder will appear on the screen.
- 4 Holding the phone horizontally, point the lens towards the subject of the video.
- 5 Press the capture button once to start recording.
- 6 REC will appear at the bottom of the viewfinder with a timer showing the length of the video.
- 7 Touch  on the screen to stop recording.

After shooting a video

A still image representing your video will appear on the screen.

Share Touch to share your video as **Bluetooth**, **Email**, **Gmail**, **Messaging** or **YouTube**.

NOTE: Additional charges may apply when MMS messages are downloaded while roaming.

Play Touch to play the video.

Rename Touch to edit the name of the selected video.

Edit Touch to enter editing mode on this video.

 Touch to access the media player and view the saved videos.

 Touch to delete the video you just made, and confirm by touching Yes. The viewfinder will reappear.

 Touch to shoot another video right away. Your current video will be saved.

 Touch to return to the previous menu.

Using the advanced settings

Using the viewfinder, touch  to open all the advanced options. Adjust the video camera setting by scrolling the wheel. After selecting the option, touch the **Back** key.

Video camera

Color effect – Choose a colour tone to use for your new view.

White balance – The white balance ensures any the white areas in your video are realistic. To enable your camera to adjust the white balance correctly, you may need to determine the light conditions. Choose from **Auto**, **Incandescent**, **Sunny**, **Fluorescent**, and **Cloudy**.

Duration – Set a duration limit for your video. Choose between **Normal** and **MMS** to limit the maximum size to send as an MMS message.

TIP! When choosing MMS duration, the Video quality will be set as QCIF and you can shoot longer videos.

Audio recording – Choose **Mute** to record a video without sound.

Hide icons – Select whether to hide the icons in the video camera menu automatically or manually.

Recorded video – Choose from **Hold**, **On**, **Off**. If you select **On**, after recorded video screen is shown for 1 second, and it goes to the preview right away.

Reset – Reset all the video camera settings.

TIP! You can change a video shot in colour to black and white or sepia, but you cannot change a black-and-white or sepia video to colour.

Watching your saved videos

- 1 In the viewfinder, touch .
- 2 Your gallery will appear on the screen.
- 3 Touch a video once to bring it to the front of the gallery. It starts to play automatically.

Your photos and videos

Viewing your photos and videos

- 1 Touch  on the camera preview screen.
- 2 Your gallery will appear on the screen.
- 3 Touch the video or photo to open it fully.

TIP! Flick left or right to view other photos or videos.

Adjusting the volume when viewing a video

To adjust the volume of a video while it is playing, use the volume keys on the left side of the phone.

Setting a photo as wallpaper

- 1 Touch the photo you want to set as wallpaper to open it.
- 2 Touch the screen to open the options menu.
- 3 Touch **Set as**, then touch **Set Wallpaper**.

Editing your photos

You can do lots of great things to your photos to change them, add to them, or liven them up.

- 1 Open the photo you want to edit, then touch the **Menu** key.
- 2 Touch **Edit** to change your photo:



Rotate & Flip – Rotate or flip your photo for fun or a better view.



Crop – Crop your photo. Choose a square or circular crop area, then move your finger across the screen to select the area.



Tuning – This helps you adjust a picture using automatic colour, brightness, and so on.



Effect – Touch to apply the effect options to a photo.



Frame – Add frames to the photo.

Your photos and videos



Text – Add text to a picture.



Clipart – Add clipart to a photo.



Drawpad – Draw on your photo, freehand. Select the line thickness from the four options, then choose the colour you want.



Stamp – Decorate your photo with stamps. Choose from the different stamps, then touch your photo where you want to place them.



Resize – Resize your photo.



Save the changes you made to the photos.



Delete your photo edits.

Rotating your photo



Rotate 90° counterclockwise



Rotate 90° clockwise



Flip vertically



Flip horizontally

Adding text to a photo

- 1 On the editing screen, touch .
- 2 Select the colour of the text, then choose one of the bubble shapes.
- 3 Enter your text using the keypad, then touch **Done**.
- 4 Move the text by touching it and sliding it to where you want it.





Adding an effect to a photo





- 1 On the editing screen, touch .
- 2 You can apply any of the various options to the photo.
- 3 To undo an effect, simply touch

Cropping a photo





- 1 On the editing screen, touch  .
- 2 Choose the shape you want to use to crop the picture.
- 3 Drag the box over the area you want to crop. Move the selected area by dragging.
- 4 When you are finished with your selection, touch **Done**.

Tuning your photo





- 1 On the editing screen, touch  . Use the tuning toolbar to adjust your photo's tuning as you like.
- 2 **AUTO** Choose to adjust the tuning settings automatically.
- 3  Choose to compare before and after tuning.
- 4  Adjust the brightness and contrast of the photo.
- 5  Adjust highlights and shadows.

- 6  Balance your photo's colour.
- 7  Adjust the saturation of your photo.
- 8  Adjust your photo's sharpness.
- 9  Denoise.

Adding frames

- 1 On the editing screen, touch  .
- 2 Touch  or  to choose a frame.
- 3 Touch  to check the whole frame.

Adding clipart



- 1 Touch  on the editing screen.
- 2 Touch  , then select clipart.
- 3 Adjust the size of the clipart.
- 4 Rotate clipart using  and  .

Your photos and videos

Using the drawpad

- 1 Touch  on the editing screen.
- 2 Touch  to select the shape.
- 3 Also, set the colour and thickness.
- 4 You can delete the drawing you added using .

Adding stamps

- 1 Touch  on the editing screen.
- 2 Touch  to see which stamps are available.
- 3 Touch the screen where you want to add the stamp to the photo.
- 4 Adjust the colour using .





Resizing

- 1 Touch  on the editing screen.
- 2 Scroll the bar to resize the photo.



Editing your videos

The video editing features are available for the MPEG-4 format.



Trimming the length of the video

- 1 Select **Edit** , then choose .
- 2 Touch . Then set the new start and end points. Touch **OK** and select **Next Icon**.
- 3 Touch  to return to the gallery and discard the changes.

Selecting transition style

- 1 Select a transition style, then touch  to preview it.
- 2 Touch  **2 sec**, then drag the bar to adjust the duration time.
- 3 Touch **OK** to save the transition. Touch **Apply** to apply the currently selected transition. Choose **Apply To All** to apply the currently selected transition to all video files in the storyboard.

Adding subtitles



- 1 Open the video you want to edit.
- 2 Select **Edit**, then select  to add subtitles to the video.
- 3 Touch , then pause playback to set the start point for text appearance.
- 4 Touch **Start**, then choose the text style. Enter your text using the keypad, then select **Done**.
- 5 Touch the area of the screen where you want the text to appear, then touch **OK**.
- 6 Replace the existing file, or save as a new file.
- 7 Repeat these steps to add more text.

Adding edit effects

- 1 Open the video you want to edit.
- 2 Select **Edit**, then select .
- 3 Select an effect to add to the photo.



Grabbing a frame

Capture a picture from the video.

- 1 Open the video you want to edit.
- 2 Select **Edit**, then and select .
- 3 Play the video, then touch  to capture the screen you want while the video is playing.
- 4 The frame is saved to the phone as a still image file.

Your photos and videos

Adding dubbing to your video

- 1 Open the video you want to edit.
- 2 Select **Edit**, then choose .
- 3 Touch . The **My Sounds** folder will open. Choose the track you want to add to your video.
- 4 The original audio track on your video will be deleted.
- 5 If the audio is shorter than the video, choose whether to play it **Once** or to **Repeat** it.
- 6 Replace the existing file, or save as a new file.
- 7 Or you can record a new file and insert live dubbing by touching .
- 8 Touch **OK** to save the current dubbing.

Multimedia

You can store multimedia files to a memory card to have easy access to all your image and video files.

Touch **Applications** tab, then select **Gallery**. You can open a list of catalogue bars that store all your multimedia files.

Note: Make sure you install a memory card into the phone to save photos and access all your pictures. Without a memory card, the phone will not display any photos or videos.

There are seven catalogue bars as shown below.

All  : Displays all your pictures and videos.

Favorite  : If you touch and hold a photo or video, the option screen will appear allowing you to tag the photo as a favorite. This **Favorite** bar will show your favorite photos and videos.

Camera  : Displays all your photos.

Image  : Displays all your images.

Video  : Displays all your videos.

Tag  : Like the **Favorite** bar, you can tag photos. This bar displays your tagged photos and videos.

People  : From camera, if you set **Focus > Face tracking** and take a photo, it will be placed on the **People** bar. You can give a new nickname to someone in the photo. Or connect to **Contacts** to match the photo with the contact.

Timeline view

GT540R Gallery provides a timeline view of your photos and videos. On the left side of the screen, the date you took your photos will be displayed, from the oldest to the newest. If you select a specific date, all the photos you took on that day will be grouped over a white background.

Multimedia

My Images options menu

Select a photo, then touch and hold to see the available options.

Sending a photo

- 1 To send a photo, touch and hold the photo you want.
- 2 Select **Share**. Choose from **Bluetooth**, **Email**, **Gmail**, **Messaging**, **Picasa** or **SNS**.
- 3 When you choose **Email**, **Gmail** or **Messaging**, your photo will be attached to a message, then you write and send the message normally.

TIP! If you have a SNS account and set it up on your phone, you can share your photo to SNS community.

Sending a video

- 1 To send a video, touch and hold the video you want.
- 2 Select **Share**. Choose from **Bluetooth**, **Email**, **Gmail**, **Messaging**, or **YouTube**.

- 3 When you choose **Email**, **Gmail** or **Messaging**, your video will be attached to a message, then you write and send the message normally.

Using an image

Choose images to use as wallpaper or identify callers.

- 1 Touch and hold a photo, then select **Set As**.
- 2 Choose from **Contact icon**, **Wallpaper** or **Lock screen**.

Creating a slideshow

If you want to view all the images on your phone, you can create a slideshow so you don't have to open and close each image.

- 1 Touch and hold a photo, then select **Slideshow**.

Checking your photo

You can view a photo's detailed information, such as **Name**, **Date**, **Time**, **Resolution**, **Size**, **Type**, and **Tag**.

- 1 Touch and hold a photo, then select **Detail**.

Media Player

The **Media Player** folder displays a list of videos you downloaded to or recorded on your phone.

Watching a video

- 1 Select **Media Player** on the Applications tab.
- 2 Touch **Video** and select a video to play.







TIP! The GT540R supports DivX video playback to ensure greater content availability.

Touch **Music** and select a music to play. You can play songs, categorise songs by **Album**, **Artist** and **Genres**, or create a **Playlist**.

Video editor

- 1 On the home screen, touch **Applications** tab and select **Video editor** .

Storyboard

- 1  **Set BGM** – Add background music to the storyboard, or change the sound.
- 2  **Import Files** – Add media files to the storyboard. You can add up to 32 media files.
- 3  **Clip Manager** – Manage the added media files. If no media files were added, the button is disabled.
- 4  **Preview** – Preview the video file you created.
- 5  **Save** – Save the video file you created.
- 6  **Add Text** – Add a text frame into storyboard.

You must touch  first to edit the video.

-  – Touch to select all the files, but the maximum is 32 files.

Multimedia

 – Touch to deselect all the files.

25/32 – This shows the selected file number.

 Touch to go to the next step.

Music Movie

1 Flip left and right to check the various styles. For **Music Movie**, you can select only photos.

 – Return to the **Video editor** screen.

 – Display the style name and description.

 – Preview the style.

 – Touch to select photos.

2 After you select photos, touch  to proceed to the next step.

3 Touch  to select all the photos, then touch .

4 Select the music, then set it as the background music.

5 Add movie title using the keypad, then save it.

6 Touch  to play the complete video file.

7 Touch  to save the video file you created.

Auto cut

There are three style templates: **Portrait**, **Landscape**, and **Motion objects**.

1 Touch , then select a video. Go to the next step.

2 Touch  to preview the video file.

3 Touch  to save the file.

Playing a game

1 You can download a range of games from the Google market.

2 To Launch tap on the a game or an application.

NOTE: Additional charges may apply when using this service to download games or applications that are not free.

NOTE: Java game and application installation are only possible through the Web.

Transferring files using USB mass storage devices

To transfer files using USB devices:

- 1 Connect the GT540R to a PC using a USB cable.
- 2 Choose **Settings > SD Card & Phone Storage > Activate Mass Storage Only**.
- 3 In the status bar, drag the USB icon.
- 4 Choose **USB Connected and Mount**.
- 5 You can view the mass storage contents on your PC and transfer the files.

NOTE: You need to install and SD card first. Without an SD card, you cannot use USB mass storage.

Music

Your GT540R has a built-in music player that lets you play all your favorite tracks. To access the music player, touch **Music**. From here, you can access a number of folders:



Artists – Browse your music collection by artist.

Albums – Browse your music collection by album.



Songs – Contains all the songs you have on your phone.

Playlists – Contains the playlists you created.

Playing a song

- 1 On the home screen, touch **Applications** tab and select **Music**.
- 2 Touch **Songs**.
- 3 Select the song you want to play.
- 4 Touch  to pause the song.
- 5 Touch  to skip to the next song.

Multimedia

- 6 Touch  to go back to the first part of the song. Touch  two times to go back to the previous song.

To change the volume while listening to music, press the up and down volume keys on the left side of the phone.

Touch and hold any song in the list. It will display **Play, Add To Playlist, Use as Ringtone, Delete,** and **Search** as options.

NOTE: Music file copyrights may be protected by international treaties and national copyright laws.

Therefore, it may be necessary to obtain permission or a licence to reproduce or copy music. In some countries, national laws prohibit private copying of copyrighted material. Before downloading or copying the file, please check the national laws of the relevant country concerning the use of such material.

Using the radio

Your GT540R has a built-in FM radio so you can tune in to your favorite stations and listen on the go.

NOTE: You must attach your headphones to listen to the radio. Insert them into the headphone jack.

Searching for stations

You can tune in to radio stations by searching for them manually or automatically. They will then be saved to specific channel numbers, so you don't have to keep re-tuning in.

You can store up to 48 channels on your phone.

To tune in automatically

- 1 On the home screen, touch **Applications** tab and select **FM radio**.
- 2 Touch the **Menu** key.

- 3 Touch **Auto Scan**, then touch **Ok**. Assign the stations found to channel numbers by selecting **Set**, **Skip**, or **Stop**.

NOTE: You can also manually tune in to a station using the wheel displayed next to the radio frequency.

Resetting channels

- 1 On the home screen, touch **Applications** tab and select **FM radio**.
- 2 Choose **Reset Channel** to reset the current channel, or choose **Reset All Channels** to reset all the channels.

Listening to the radio

- 1 On the home screen, touch **Applications** tab and select **FM radio**.
- 2 Touch the channel number of the station you want to listen to.

TIP! To improve radio reception, extend the headset cord, which functions as the radio antenna.

WARNING

If you connect a headset not specifically made for radio reception, radio reception may be poor.

Google applications

- 1 First, set up a Google account. Enter your user name and password.
- 2 After signing in, your contacts, email, and calendar in your Google account will automatically synchronise with your GT540R.

Tip! If you change your Google account after signing in, or you want to log out, please use the below step: **Applications > Settings > Applications > Manage applications > Google Apps > Clear data.**

Google Maps

Check your current location and traffic and receive directions to your destination. The GT540R must be connected to Wi-Fi or 3G/GPRS.

NOTE: Google Maps does not cover all cities and countries.

NOTE: While viewing **Street View** for a location, Touch the **Menu** key then touch **Compass Mode** to turn compass mode on.

Android Market

Android Market lets you download useful applications and games. If you install applications and games from Android Market, they appear in the GT540R menu.

You can post comments about an application or flag it if you find it is incompatible with the GT540R.

- 1 Select a category to browse its contents.
- 2 Choose an application to install.

NOTE: When you want to finish the game, use the **Home** or **Back** key. You will return to the home screen. Or use the **Menu** key of the game.

Gmail

Gmail is configured when you first set up your phone. Depending on your synchronization settings, Google on your phone is automatically synchronised with your Gmail account on the web. The inbox conversations list is your default Gmail view.

Touch the **Menu** key, then touch **Refresh** to send or receive new emails and to synchronise your emails with your Google account on the web.

Google Talk

Google Talk is Google's instant messaging program. It lets you communicate with other people who also use Google Talk.

Rogers

Shop - Browse and shop for ringtones, games, videos and more content to personalize your phone and make it more fun.



Weather - The Weather icon provides you with the weather report right on your phone, including the current weather and five-day forecast for your city, any Canadian or international city. Weather also provides you with full weather conditions including: five-day forecasts with forecasts for high and low temperature, and weather conditions, wind chill and wind speed, humidity and sunrise and sunset.

News - Keeping on top of the local, national and international news is as easy as clicking on the News icon. You can search for news and select and set your news feeds for quick access to your favorite information sources for Headlines, Sports, Business, Technology, Health and many other topics.

My Account - My Account puts the power of account information in the palm of your hand. My Account lets you check your Rogers account balance, review the number of minutes you have used, determine your data usage and more. Getting important account information on the go has never been easier.

Utilities

Setting your alarm

- 1 On the home screen, touch **Applications** tab and select **Alarm Clock**.
- 2 If you want to add a new alarm, touch **New Alarm**. There are preset alarms you can activate.
- 3 Touch  to turn on the alarm, and set the time you want the alarm to sound. After you set the time, the GT540R will let you know how much time is left before the alarm sounds.
- 4 Choose a ringtone, and turn on **Vibrate**, if you want. Set the repeat.
- 5 Choose **Label** to name the alarm.
- 6 Set the Snooze interval. Select from Snooze off, 5 min, 10 min, 20 min, 30 min or 1 hour.
- 7 Touch , then return to the first Alarm Clock screen.

- 8 Touch and hold the clock on the screen, when you lift your finger different types of clocks will be displayed. Choose one to change your clock face.
- 9 You can delete all the alarms by touching the **Menu** key and choose **Delete alarm**.

Using your calculator

- 1 On the home screen, touch **Applications** tab and select **Calculator**.
- 2 Touch the number keys to enter numbers.
- 3 For simple calculations, touch the function you want (+, -, x, or ÷), followed by =.
- 4 For more complex calculations, touch the **Menu** key, touch the **Advanced panel**, then choose **sin**, **cos**, **tan**, **log**, and so on.

Utilities

Adding an event to your calendar

- 1 On the home screen, touch **Applications** tab and select **Calendar**.
- 2 First, you must create a Google account to use Calendar.
- 3 Select the date you want to add an event to.
- 4 Touch the **Menu** key, then touch **New event**.
- 5 Touch **What**, then enter the event name. Check the date and enter the time you want your event to begin. Enter the time and date the event finishes in the lower date and time boxes.
- 6 Also, touch **Where**, then enter the location.
- 7 If you would like to add a note to your event, touch **Description** and enter the details.

- 8 If you want to repeat the alarm, set **Repetition**, and set **Reminders**, if necessary.
- 9 Touch **Done** to save the event in the calendar. A coloured square in the calendar will mark all days that have saved events. An alarm will sound at the event start time to help you stay organised.

Changing your calendar view

- 1 On the home screen, touch **Applications** tab and select **Calendar**. Touch the **Menu** key.
- 2 Select the calendar view for a particular day, week, or month.

Quickoffice

You can manage and view document files. The supported file types are PDF, DOC, TXT, XLS, and ZIP.

- 1 Choose **Memory Card**. You can see the files and folder list.
- 2 If you choose **Recent Documents**, files you recently viewed will be displayed.
- 3 Touch and hold any file, and the options **Rename**, **Properties**, and **Delete** will appear.
- 4 Choose a file, then touch the **Menu** key to view the **Open**, **Register**, **Update**, **Properties**, and **About** options. There are additional options, depending on the file type.

PDF: Go To Page, Fit Page, Fit Width



DOC/TXT: Search

XLS: Worksheet – Choose **Summary View** or **Full View**.

Voice recorder

Use the voice recorder to record voice memos or other audio files.

Recording a sound or voice

- 1 On the home screen, touch **Applications** tab and select **Voice Recorder**.
- 2 Touch  to begin recording.
- 3 Touch  to end recording.
- 4 Touch the **Menu** key and select **Set as** to set as the **Phone ringtone**.

NOTE: Touch **Go to list** to access your album. You can listen to the saved recording.

Sending the voice recording

- 1 Once you have finished recording, you can send the audio clip by touching the **Menu** key and **Share**.
- 2 Choose from **Bluetooth**, **Email**, **Gmail**, and **Messaging**. When you select **Email**, **Gmail**, and **Messaging**, the voice recording will be added to the message that you write and send it normally.

Browser

Browser

Browser gives you a fast, full-colour world of games, music, news, sports, entertainment, and much more, right on your mobile phone. Wherever you are and whatever you're into.

Accessing the Web

1 On the home screen, touch **Applications** tab and select **Browser**.

2 You will move to the website.

NOTE: Additional charges apply when connecting to these services and downloading content. Check data charges with your network provider.

Using the Web tool bar

Touch  to open the toolbar.

1 Touch  to refresh the web page.

2 Touch  to go forward one page.

3 Touch  to go backward one page.

4 Touch  to add bookmark.

5 Touch  to open another website in a new window.

6 Touch  to change the browser settings.

Using options

Touch the **Menu** key to view options.

 **Go** – Enter a web address and go to that page.

 **Exit** – Close browser.

 **Bookmarks** – Add/Show Bookmark, show Most Visited Site and History.

 **Windows** – Show all your open windows.

 **Find on page** – Marks all the letters you enter.

 **More**

- **Select Text** – Touch and select the lines you want to copy. You can paste it to any input box.
- **Page Info** – Show page information.

- **Share Page** – Send page by **Email, Gmail** or **Messaging**.
- **Downloads** – Show download history.
- **Setting** – Set browser settings.

Adding and accessing bookmarks

For easy and fast access to your favorite websites, you can add bookmarks and save web pages.

- 1 On the home screen, touch **Applications** tab and select **Browser**.
- 2 Touch the **Menu** key then select **Menu > Bookmarks**.
Or touch .
A list of your bookmarks will appear on the screen.
- 3 Select **Add bookmark...**, then enter a name for the bookmark followed by its URL.
- 4 Touch **OK**. Your bookmark will now appear in the bookmark list.

- 5 To access the bookmark, simply touch the bookmark. You will be connected to the bookmarked page.

Changing Web browser settings

Touch the **Menu** key then select **More > Settings**.

You can change the page layout (e.g., text size, text encoding), change the home page, manage cache, cookie, and security settings, and so on.

Settings

On the home screen, touch **Applications** tab then scroll and touch **Settings**.

Wireless controls

Here, you can manage Wi-Fi and Bluetooth. Also, you can set mobile networks, airplane mode.

Wi-Fi – Touch to checkmark: Turns on Wi-Fi to connect to available Wi-Fi networks.

Wi-Fi settings – Set network notification, or add a Wi-Fi network.

Bluetooth – Touch to checkmark: Turns on Bluetooth to connect to Bluetooth devices.

Bluetooth settings – Set device name & discoverable, scan for other devices.

Mobile network – Turn on mobile network.

Mobile network settings – Set options for roaming, network, and APNs.

Airplane mode – After setting Airplane mode, all wireless connections will be disabled.

Sound & display

Silent mode – Turn on to silence all sounds, except media & alarms.

Ringer volume – Set volume for incoming calls and other notifications.

Media volume – Set volume for music and videos.

Phone ringtone – Set default ringtone.

Phone vibrate – Set to vibrate for incoming calls.

Notification ringtone – Set default notification ringtone.

Audible touch tones – Set to sound when you use the keypad.

Audible selection – Set to sound when you make a screen selection.

Vibration feedback – Set to use vibration feedback.

SD Card notifications – Disable SD card notification sounds.

Orientation – Set to switch orientation automatically when you rotate the phone.

Animation – Set to display an animation when you open or close windows.

Brightness – Adjust the brightness of the screen.

Screen timeout – Set the time for screen timeout.

Touch calibration – Reset your screen for ease of use.

Data synchronization

Select which applications are synchronised.

Security & location

Use wireless networks – If you check Use wireless networks, your phone will be determine your approximate location by using Wi-Fi and mobile networks.

Enable GPS Satellites – If you check Enable GPS satellites, your phone will be determine your location to street-level accuracy.

Share with Google – If you check Share with Google, your phone will be check your current location when you use Google search.

When you check this option, you're asked whether you consent to allowing Google to use your location when providing these services.

Set unlock pattern – Set unlock pattern to secure your phone. Opens a set of screens that guide you through drawing a screen unlock pattern.

Set up SIM card lock – Set up SIM card lock or change SIM PIN.

Visible passwords – Select to show passwords as you type them or deselect to hide passwords as you type them.

Settings

Install from SD card – choose to install encrypted certificates from your SD card.

Set password – set or change the credential storage password.

To lock your screen by using the Pattern Lock

- 1 On the home screen, touch **Applications** tab and select **Settings**.
- 2 Touch **Security & location**, and select **Set unlock pattern**.
- 3 The first time you do this, a short tutorial about creating an unlock pattern appears.
- 4 You're prompted to draw and redraw your own pattern. The next time you turn on your phone or wake up the screen, you're prompted to draw your unlock pattern to unlock the screen.

Applications

You can manage applications and set up quick launch shortcuts.

Unknown Sources – Default setting to install non-Market applications.

Manage Applications – Manage and remove installed applications.

Development – Set options for application development, such as **USB Debugging**, **Stay Awake**, and **Allow Mock Locations**.

SD card & phone storage

SD Card – Check total space and available space. Touch **Unmount SD card** for safe removal. **Format the SD card**, if you want to delete all data from the SD card.

Internal phone storage – Check the **Available space**. Choose **Factory Data Reset** if you want to delete all data from the phone.

Date and time

Set date, time, time zone, and formats.

Locale and text

Set local language and region, text input, and autocorrect options.

Search

You use the Search settings to configure Google search, Quick Search Box, and the data on the phone that you want to include in searches.

Accessibility

You use the Accessibility settings to configure any accessibility plug-ins you have installed on your phone.

Note: Requires additional plug-ins to become selectable.

Speech synthesis

You use the Text-to-Speech settings to configure the Android text-to-speech synthesiser, for applications that can take advantage of it.

About phone

View legal information, and check phone status and software version.

Wi-Fi

Wireless Manager allows you to manage Internet connections your phone's Wi-Fi (a wireless LAN). It allows the phone to connect to local wireless networks or access the Internet wirelessly. Wi-Fi is faster and has a greater range than Bluetooth wireless technology. It allows fast emailing and Internet browsing.

NOTE: The GT540R supports WEP and WPA/WPA2-PSK security. If your Wi-Fi service provider or network administrator sets encryption for network security, fill in the key in the pop-up window. If encryption is not set, this pop-up window will not be shown. You can obtain the key from your Wi-Fi service provider or network administrator.

1. How to set up Wi-Fi

- 1 Touch the **Settings** tab, then Wireless controls, then turn **Wi-Fi** on.
- 2 AP (Access Point) Search
 - Searches for which AP it can connect to.
- 3 AP Connect
 - Connects to the desired AP from the AP search list.
 - If the AP is security type WEP or WPA/WPA2-PSK, enter the security key.

2. Wi-Fi network profile support

- 1 Wi-Fi profile support (how to connect to a frequently used AP or hidden AP)
 - 1) If the AP does not appear in the search list, you can connect to it by saving it as a profile.

Wi-Fi

- 2) Saving a frequently used AP as a profile makes it easier to enter the security key when connecting to an AP with that security type.
 - 3) If the AP does not support DHCP, you can connect to the AP using a static IP address.
- 2** Description of each field in the Wi-Fi profile.
- 1) Network Name: SSID (ID)
 - 2) Security Type: WEP and WPA/WPA2-PSK support.
 - 3) Security Key: Saves the security key.
 - 4) IP/DNS Setting: This allows you to set to Automatic or Static, depending on whether the AP supports DHCP.
For Static, enter the field value of the IP address and DNS server to use with the static IP address when connecting.

- 3** How to save the Wi-Fi profile
- 1) Select the Add Wi-Fi Network menu at the bottom of Wi-Fi Networks, then enter the SSID and Security Type.
 - 2) After connecting to an AP with this security type, the profile will be saved automatically.

3. How to obtain the MAC address

To set up a connection in some wireless networks with MAC filters, you may need to enter the MAC address of your GT540R into the router.

You can find the MAC address in the following user interface:

Settings > Wireless controls > Wi-Fi settings > Menu > Advanced > MAC Address

Software update

Phone Software update

LG Mobile Phone Software update from internet

For more information on installing and using this program, please visit http://ca.lgservice.com/index_b2c.jsp

This feature allows you to update your software to the latest version quickly and conveniently over the Internet without needing to visit our service centre.

As the mobile phone firmware update requires the user's full attention for the duration of the update process, please make sure to check all instructions and notes that appear at each step before proceeding. Please note that removing the USB data cable or battery during the upgrade may seriously damage you mobile phone.

As the manufacturer takes no responsibility for loss of data during the update process, you are advised to back up any

important information in advance for safekeeping.

DivX Mobile

ABOUT DIVX VIDEO: DivX® is a digital video format created by DivX, Inc. This is an official DivX Certified device that plays DivX video. Visit www.divx.com for more information and software tools to convert your files into DivX video.

ABOUT DIVX VIDEO-ON-DEMAND: This DivX Certified® device must be registered in order to play DivX Video-on-Demand (VOD) content. To generate the registration code, locate the DivX VOD section in the device setup menu. Go to vod.divx.com with this code to complete the registration process and learn more about DivX VOD.

DivX Certified to play DivX® video up to 320 x 240

Accessories

These accessories are available for use with the GT540R. (Items described below may be optional.)

Charger



Data cable

Connect your GT540R and PC.



Battery



User Guide

Learn more about your GT540R.



Stereo headset



NOTE:

- Always use genuine LG accessories.
- Failure to do this may void your warranty.
- Accessories may vary in different regions.

Technical data

Ambient Temperatures

Max: +55°C (discharging), +45°C (charging)

Min: -10°C

Troubleshooting

This section lists some problems that you might encounter while using your phone. Some problems require that you call your service provider, but most of problems you encounter are easy to correct yourself.

Symptom	Possible causes	Possible Corrective measures
No connection to the network	Signal is weak or you're outside of the carrier network.	Move to a window or open space. Check service provider coverage map.
Codes do not match	When you want to change a security code you have to confirm the new code by entering it again. The two codes that you have entered do not match.	Contact your Service Provider.
Function cannot be set	Not supported by Service Provider or registration required.	Contact your Service Provider.
Calls not available	Dialing error or service limitations.	Check the number dialed and check the reception. Contact your service provider.
Calls not available	Dialing error New SIM card inserted Prepaid Charge limit reached	New network not authorized. Check for new restrictions. Contact Service Provider or reset limit with PIN 2.

Troubleshooting

Symptom	Possible causes	Possible Corrective measures
Phone cannot be switched on	On/Off key pressed too briefly.	Press On/Off key for at least two seconds.
	Battery is not charged.	Charge battery. Check charging indicator in the display.
	Battery contacts are dirty.	Clean the battery contacts.
Charging error	Battery totally empty.	Charge battery.
	Contact problem.	Check power supply and connection to the phone. Check the battery contacts, clean them if necessary.
	No power from outlet.	Plug in to a different socket or check voltage.
	Charger defective. Wrong charger. Battery defective.	Test with another charger. Only use original LG accessories. Replace battery.
Network connection is lost.	Signal too weak.	Reconnection to another service provider if network mode is automatic.
Number not permitted	The Fixed Dial Number function is on.	Check the Settings menu and turn the function off.
Phone locked up and does not function	Restarting the phone	<ol style="list-style-type: none">1 Turn the phone off.2 Remove the battery cover.3 Install the battery.4 Lock the cover.5 Turn the phone on again.

For Your Safety

Important Information

This user guide contains important information on the use and operation of this phone. Please read all the information carefully for optimal performance and to prevent any damage to or misuse of the phone. Any changes or modifications not expressly approved in this user guide could void your warranty for this equipment.

Before You Start

Safety Instructions



WARNING:

To reduce the possibility of electric shock, do not expose your phone to high humidity areas, such as the bathroom, swimming pool, etc.

Always store your phone away from heat. Never store your phone in settings that may expose it to temperatures less than 32°F or greater than 104°F, such as outside during extreme weather conditions or in your car on a hot day. Exposure to excessive cold or heat will result in malfunction, damage and/or catastrophic failure.

Be careful when using your phone near other electronic devices. RF emissions from your mobile phone may affect nearby in adequately shielded electronic equipment. You should consult with manufacturers of any personal medical devices such as pacemakers and hearing aides to determine if they are susceptible to interference from your mobile phone.

For Your Safety

Turn off your phone in a medical facility or at a gas station. Never place your phone in a microwave oven as this will cause the battery to explode.

Safety Information

Read these simple guidelines. Breaking the rules may be dangerous or illegal. Further detailed information is given in this user guide.

- Never use an unapproved battery since this could damage the phone and/or battery and could cause the battery to explode.
- Never place your phone in a microwave oven as it will cause the battery to explode.
- Do not dispose of your battery by fire or with hazardous or flammable materials.
- Make sure that no sharp-edged items come into contact with the battery. There is a risk of this causing a fire.
- Store the battery in a place out of reach of children.
- Be careful that children do not swallow any parts such as rubber plugs (earphone, connection parts of the phone, etc.). This could cause asphyxiation or suffocation.
- Unplug the power cord and charger during lightning storms to avoid electric shock or fire.
- When riding in a car, do not leave your phone or set up the hands-free kit near to the air bag. If wireless equipment is improperly installed and the air bag is activated, you may be seriously injured.
- Do not use a hand-held phone while driving.
- Do not use the phone in areas where its use is prohibited. (For example: aircraft).

- Do not expose the battery charger or adapter to direct sunlight or use it in places with high humidity, such as a bathroom.
- Never store your phone in temperatures less than -4°F or greater than 122°F.
- Do not use harsh chemicals (such as alcohol, benzene, thinners, etc.) or detergents to clean your phone. There is a risk of this causing a fire.
- Do not drop, strike, or shake your phone severely. Such actions may harm the internal circuit boards of the phone.
- Do not use your phone in high explosive areas as the phone may generate sparks.
- Do not damage the power cord by bending, twisting, pulling, or heating.
- Do not use the plug if it is loose as it may cause a fire or electric shock.
- Do not place any heavy items on the power cord. Do not allow the power cord to be crimped as it may cause fire or electric shock.
- Do not handle the phone with wet hands while it is being charged. It may cause an electric shock or seriously damage your phone.
- Do not disassemble the phone.
- Do not place or answer calls while charging the phone as it may short-circuit the phone and/or cause electric shock or fire.
- Only use the batteries, antennas, and chargers provided by LG. The warranty will not be applied to products provided by other suppliers.

For Your Safety

- Only authorized personnel should service the phone and its accessories. Faulty installation or service may result in accidents and consequently invalidate the warranty.
- Do not hold or let the antenna come in contact with your body during a call.
- An emergency call can be made only within a service area. For an emergency call, make sure that you are within a service area and that the phone is turned on.
- Use accessories, such as earphones and headsets, with caution. Ensure that cables are tucked away safely and do not touch the antenna unnecessarily.

Memory card information and care

- Always insert/ remove the memory card while the handset power is off. If you remove it while the power is on, it may be damaged.
- If a damage cannot be fixed, format the memory card.
- The memory card cannot be used for recording copyright protected data.
- Do not write forcefully on the memo area.
- Carry and store the memory card in its case.
- Do not allow the memory card to get wet.
- Do not leave the memory card in extremely hot location.
- Do not disassemble or modify the memory card.

FCC RF Exposure

Information



WARNING:

Read this information before operating the phone.

In August 1996, the Federal Communications Commission (FCC) of the United States, with its action in Report and Order FCC 96-326, adopted an updated safety standard for human exposure to radio frequency (RF) electromagnetic energy emitted by FCC regulated transmitters. Those guidelines are consistent with the safety standard previously set by both U.S. and international standards bodies.

The design of this phone complies with the FCC guidelines and these international standards.

CAUTION

Use only the supplied and approved antenna. Use of unauthorized antennas or modifications could impair call quality, damage the phone, void your warranty and/or result in violation of FCC regulations. Do not use the phone with a damaged antenna. If a damaged antenna comes into contact with skin, a minor burn may result. Contact your local dealer for a replacement antenna.

Body-worn Operation

This device was tested for typical body-worn operations with the back of the phone kept 2cm (0.79 inches) between the user's body and the back of the phone. To comply with FCC RF exposure requirements, a minimum separation distance of 2cm (0.79 inches) must be maintained between the user's body and the back of the phone. Third-party belt-clips,

For Your Safety

holsters, and similar accessories containing metallic components should not be used.

Body-worn accessories that cannot maintain 2cm (0.79 inches) separation distance between the user's body and the back of the phone, and have not been tested for typical body-worn operations may not comply with FCC RF exposure limits and should be avoided.

Vehicle Mounted External Antenna (optional, if available)

A minimum separation distance of 20cm (8 inches) must be maintained between the user/bystander and the vehicle mounted external antenna to satisfy FCC RF exposure requirements. For more information about RF exposure, visit the FCC website at www.fcc.gov

FCC Part 15 Class B Compliance

This device and its accessories comply with part 15 of FCC rules. Operation is subject to the following two conditions:

(1) This device and its accessories may not cause harmful interference, and (2) this device and its accessories must accept any interference received, including interference that may cause undesired operation.

Cautions for Battery

- Do not disassemble.
- Do not short-circuit.
- Do not expose to high temperature: 60°C (140°F).
- Do not incinerate.

Battery Disposal

- Please dispose of your battery properly or bring to your local wireless carrier for recycling.
- Do not dispose in fire or with hazardous or flammable materials.

Adapter (Charger) Cautions

- Using the wrong battery charger could damage your phone and void your warranty.
- The adapter or battery charger is intended for indoor use only.

Do not expose the adapter or battery charger to direct sunlight or use it in places with high humidity, such as the bathroom.

Avoid damage to your hearing

- Damage to your hearing can occur if you are exposed to loud sound for long periods of time. We therefore recommend that you do not turn on or off the handset close to your ear. We also recommend that music and call volumes are set to a reasonable level.
- If you are listening to music whilst out and about, please ensure that the volume is at a reasonable level so that you are aware of your surroundings. This is particularly imperative when attempting to cross the street.

Safety Guidelines

TIA Safety Information

Provided herein is the complete TIA Safety Information for Wireless Handheld phones. Inclusion of the text covering Pacemakers, Hearing Aids, and Other Medical Devices is required in the owner's manual for CTIA Certification. Use of the remaining TIA language is encouraged when appropriate.

Exposure to Radio Frequency Signal

Your wireless handheld portable telephone is a lowpower radio transmitter and receiver. When it is ON, it receives and also sends out radio frequency (RF) signals. In August, 1996, the Federal Communications Commissions (FCC) adopted RF exposure guidelines with safety levels for handheld wireless phones.

Those guidelines are consistent with the safety standards previously set by both U.S. and international standards bodies:

ANSI C95.1 (1992) *

NCRP Report 86 (1986)

ICNIRP (1996)

Those standards were based on comprehensive and periodic evaluations of the relevant scientific literature. For example, over 120 scientists, engineers, and physicians from universities, government health agencies, and industry reviewed the available body of research to develop the ANSI Standard (C95.1).

* American National Standards Institute; National Council on Radiation Protection and Measurements; International Commission on Non-Ionizing Radiation Protection

The design of your phone complies with the FCC guidelines (and those standards).

Antenna Care

Use only the supplied or an approved replacement antenna. Unauthorized antennas, modifications, or attachments could damage the phone and may violate FCC regulations.

Phone Operation

NORMAL POSITION: Hold the phone as you would any other telephone with the antenna pointed up and over your shoulder.

Tips on Efficient Operation

For your phone to operate most efficiently:

- Do not touch the antenna unnecessarily when the phone is in use. Contact with the antenna affects call quality and may cause the phone to operate at a higher power level than otherwise needed.

Driving

Check the laws and regulations on the use of wireless phones in the areas where you drive. Always obey them. Also, if using your phone while driving, please:

- Give full attention to driving - driving safely is your first responsibility;
- Use hands-free operation, if available;
- Pull off the road and park before making or answering a call if driving conditions so require.

Electronic Devices

Most modern electronic equipment is shielded from RF signals.

However, certain electronic equipment may not be shielded against the RF signals from your wireless phone.

Safety Guidelines

Pacemakers

The Health Industry Manufacturers Association recommends that a minimum separation of six (6") inches be maintained between a handheld wireless phone and a pacemaker to avoid potential interference with the pacemaker.

These recommendations are consistent with the independent research by and recommendations of Wireless Technology Research.

Persons with pacemakers:

- Should ALWAYS keep the phone more than six inches from their pacemaker when the phone is turned ON;
- Should not carry the phone in a breast pocket.
- Should use the ear opposite the pacemaker to minimize the potential for interference.
- If you have any reason to suspect that interference is taking place, turn your phone OFF immediately.

Hearing Aids

Some digital wireless phones may interfere with some hearing aids. In the event of such interference, you may want to consult your service provider.

Other Medical Devices

If you use any other personal medical device, consult the manufacturer of your device to determine if they are adequately shielded from external RF energy. Your physician may be able to assist you in obtaining this information.

Health Care Facilities

Turn your phone OFF in health care facilities when any regulations posted in these areas instruct you to do so. Hospitals or health care facilities may use equipment that could be sensitive to external RF energy.

Vehicles

RF signals may affect improperly installed or inadequately shielded electronic systems in motor vehicles. Check with the manufacturer or its representative regarding your vehicle.

You should also consult the manufacturer of any equipment that has been added to your vehicle.

Posted Facilities

Turn your phone OFF in any facility where posted notices so require.

Aircraft

FCC regulations prohibit using your phone while in the air. Turn your phone OFF before boarding an aircraft.

Blasting Areas

To avoid interfering with blasting operations, turn your phone OFF when in a 'blasting areas or in areas posted: 'Turn off two-way radio'. Obey all signs and instructions.

Potentially Explosive Atmosphere

Turn your phone OFF when in any area with a potentially explosive atmosphere and obey all signs and instructions. Sparks in such areas could cause an explosion or fire resulting in bodily injury or even death.

Areas with a potentially explosive atmosphere are often, but not always, marked clearly.

Potential areas may include: fueling areas (such as gasoline stations); below deck on boats; fuel or chemical transfer or storage facilities; vehicles using liquefied petroleum gas (such as propane or butane); areas where

Safety Guidelines

the air contains chemicals or particles (such as grain, dust, or metal powders); and any other area where you would normally be advised to turn off your vehicle engine.

For Vehicles Equipped with an Air Bag

An air bag inflates with great force. DO NOT place objects, including either installed or portable wireless equipment, in the area over the air bag or in the air bag deployment area. If in-vehicle wireless equipment is improperly installed and the air bag inflates, serious injury could result.

Safety Information

Please read and observe the following information for safe and proper use of your phone and to prevent damage. Also, keep the user guide in an accessible place at all the times after reading it.

Charger and Adapter Safety

- The charger and adapter are intended for indoor use only.

Battery Information and Care

- Please dispose of your battery properly or take it to your local wireless carrier for recycling.
- The battery does not need to be fully discharged before recharging.
- Use only LG-approved chargers specific to your phone model since they are designed to maximize battery life.
- Do not disassemble or impact the battery as it may cause electric shock, short-circuit, and fire. Store the battery in a place out of reach of children.
- Keep the battery's metal contacts clean.

- Replace the battery when it no longer provides acceptable performance. The battery can be recharged several hundred times before replacement.
- Recharge the battery after long periods of non-use to maximize battery life.
- Battery life will vary due to usage patterns and environmental conditions.
- Use of extended backlighting, MEdia Net Browsing, and data connectivity kits affect battery life and talk/standby times.
- The self-protection function of the battery cuts the power of the phone when its operation is in an abnormal state. In this case, remove the battery from the phone, reinstall it, and turn the phone on.
- Actual battery life will depend on network configuration, product settings, usage patterns, battery and environmental conditions.

Explosion, Shock, and Fire Hazards

- Do not put your phone in a place subject to excessive dust and keep the minimum required distance between the power cord and heat sources.
- Unplug the power cord prior to cleaning your phone, and clean the power plug pin when it is dirty.
- When using the power plug, ensure that it is firmly connected. If it is not, it may cause excessive heat or fire.
- If you put your phone in a pocket or bag without covering the receptacle of the phone (power plug pin), metallic articles (such as a coin, paperclip or pen) may short-circuit the phone. Always cover the receptacle when not in use.

Safety Guidelines

- Do not short-circuit the battery. Metallic articles such as a coin, paperclip or pen in your pocket or bag may short-circuit the + and – terminals of the battery (metal strips on the battery) upon moving. Short-circuit of the terminal may damage the battery and cause an explosion.
- When the phone is not used for a long period time, store it in a safe place with the power cord unplugged.
- Using the phone in proximity to receiving equipment (i.e., TV or radio) may cause interference to the phone.
- Do not use the phone if the antenna is damaged. If a damaged antenna contacts skin, it may cause a slight burn. Please contact an LG Authorized Service Centre to replace the damaged antenna.

General Notice

- Using a damaged battery or placing a battery in your mouth may cause serious injury.
- Do not place items containing magnetic components such as a credit card, phone card, bank book or subway ticket near your phone. The magnetism of the phone may damage the data stored in the magnetic strip.
- Talking on your phone for a long period of time may reduce call quality due to heat generated during use.
- Do not immerse your phone in water. If this happens, turn it off immediately and remove the battery. If the phone does not work, take it to an LG Authorized Service Centre.
- Do not paint your phone.
- The data saved in your phone might be deleted due to careless use, repair of the phone, or upgrade of the software. Please backup your important phone numbers.

(Ring tones, text messages, voice messages, pictures, and videos could also be deleted.) The manufacturer is not liable for damage due to the loss of data.

- When you use the phone in public places, set the ring tone to vibration so as not to disturb others.
- Do not turn your phone on or off when putting it in your ear.

FDA Consumer Update

The U.S. Food and Drug Administration Centre for Devices and Radiological Health Consumer Update on Mobile Phones.

1. Do wireless phones pose a health hazard?

The available scientific evidence does not show that any health problems are associated with using wireless phones. There is no proof, however, that wireless phones

are absolutely safe. Wireless phones emit low levels of radio frequency energy (RF) in the microwave range while being used. They also emit very low levels of RF when in the standby mode. Whereas high levels of RF can produce health effects (by heating tissue), exposure to low level RF that does not produce heating effects causes no known adverse health effects. Many studies of low level RF exposures have not found any biological effects. Some studies have suggested that some biological effects may occur, but such findings have not been confirmed by additional research. In some cases, other researchers have had difficulty in reproducing those studies, or in determining the reasons for inconsistent results.

Safety Guidelines

2. What is the FDA's role concerning the safety of wireless phones?

Under the law, the FDA does not review the safety of radiation emitting consumer products such as wireless phones before they can be sold, as it does with new drugs or medical devices. However, the agency has authority to take action if wireless phones are shown to emit radio frequency energy (RF) at a level that is hazardous to the user. In such a case, the FDA could require the manufacturers of wireless phones to notify users of the health hazard and to repair, replace, or recall the phones so that the hazard no longer exists. Although the existing scientific data do not justify FDA regulatory actions, the FDA has urged the wireless phone industry to take a number of steps, including the following:

- Support needed research into possible biological effects of RF of the type emitted by wireless phones;
- Design wireless phones in a way that minimizes any RF exposure to the user that is not necessary for device function; and
- Cooperate in providing users of wireless phones with the best possible information on possible effects of wireless phone use on human health. The FDA belongs to an interagency working group of the federal agencies that have responsibility for different aspects of RF safety to ensure coordinated efforts at the federal level. The following agencies belong to this working group:
 - National Institute for Occupational Safety and Health

- Environmental Protection Agency
- Occupational Safety and Health Administration (Administración de la seguridad y salud laborales)
- Occupational Safety and Health Administration
- National Telecommunications and Information Administration

The National Institutes of Health participates in some interagency working group activities, as well.

The FDA shares regulatory responsibilities for wireless phones with the Federal Communications Commission (FCC). All phones that are sold in the United States must comply with FCC safety guidelines that limit RF exposure. The FCC relies on the FDA and other health agencies for safety questions about wireless phones.

The FCC also regulates the base stations that the wireless phone

networks rely upon. While these base stations operate at higher power than do the wireless phones themselves, the RF exposures that people get from these base stations are typically thousands of times lower than those they can get from wireless phones. Base stations are thus not the subject of the safety questions discussed in this document.

3. What kinds of phones are the subject of this update?

The term ‘wireless phone’ refers here to handheld wireless phones with built-in antennas, often called ‘cell’, ‘mobile’, or ‘PCS’ phones. These types of wireless phones can expose the user to measurable radiofrequency energy (RF) because of the short distance between the phone and the user’s head. These RF exposures are limited by FCC safety guidelines that were developed with the advice of the FDA and other federal health and

Safety Guidelines

safety agencies. When the phone is located at greater distances from the user, the exposure to RF is drastically lower because a person's RF exposure decreases rapidly with increasing distance from the source. The so-called 'cordless phones,' which have a base unit connected to the telephone wiring in a house, typically operate at far lower power levels, and thus produce RF exposures far below the FCC safety limits.

4. What are the results of the research done already?

The research done thus far has produced conflicting results, and many studies have suffered from flaws in their research methods. Animal experiments investigating the effects of radiofrequency energy (RF) exposures characteristic of wireless phones have yielded conflicting

results that often cannot be repeated in other laboratories. A few animal studies, however, have suggested that low levels of RF could accelerate the development of cancer in laboratory animals. However, many of the studies that showed increased tumor development used animals that had been genetically engineered or treated with cancer causing chemicals so as to be predisposed to develop cancer in the absence of RF exposure. Other studies exposed the animals to RF for up to 22 hours per day. These conditions are not similar to the conditions under which people use wireless phones, so we don't know with certainty what the results of such studies mean for human health. Three large epidemiology studies have been published since December 2000. Between them, the studies investigated

any possible association between the use of wireless phones and primary brain cancer, glioma, meningioma, or acoustic neuroma, tumors of the brain or salivary gland, leukemia, or other cancers. None of the studies demonstrated the existence of any harmful health effects from wireless phone RF exposures. However, none of the studies can answer questions about longterm exposures, since the average period of phone use in these studies was around three years.

5. What research is needed to decide whether RF exposure from wireless phones poses a health risk?

A combination of laboratory studies and epidemiological studies of people actually using wireless phones would provide some of the data that are needed. Lifetime animal exposure studies could be

completed in a few years. However, very large numbers of animals would be needed to provide reliable proof of a cancer promoting effect if one exists. Epidemiological studies can provide data that is directly applicable to human populations, but 10 or more years follow-up may be needed to provide answers about some health effects, such as cancer.

This is because the interval between the time of exposure to a cancer-causing agent and the time tumors develop - if they do may be many, many years. The interpretation of epidemiological studies is hampered by difficulties in measuring actual RF exposure during day-to-day use of wireless phones. Many factors affect this measurement, such as the angle at which the phone is held, or which model of phone is used.

Safety Guidelines

6. What is the FDA doing to find out more about the possible health effects of wireless phone RF?

The FDA is working with the U.S. National Toxicology Program and with groups of investigators around the world to ensure that high priority animal studies are conducted to address important questions about the effects of exposure to radiofrequency energy (RF). The FDA has been a leading participant in the World Health Organization International Electromagnetic Fields (EMF) Project since its inception in 1996. An influential result of this work has been the development of a detailed agenda of research needs that has driven the establishment of new research programs around the world. The project has also helped develop a series of public information documents on EMF issues.

The FDA and the Cellular Telecommunications & Internet Association (CTIA) have a formal Cooperative Research and Development Agreement (CRADA) to do research on wireless phone safety. The FDA provides the scientific oversight, obtaining input from experts in government, industry, and academic organizations. CTIA funded research is conducted through contracts with independent investigators. The initial research will include both laboratory studies and studies of wireless phone users. The CRADA will also include a broad assessment of additional research needs in the context of the latest research developments around the world.

7. How can I find out how much radiofrequency energy exposure I can get by using my wireless phone?

All phones sold in the United States must comply with Federal Communications Commission (FCC) guidelines that limit radiofrequency energy (RF) exposures.

The FCC established these guidelines in consultation with the FDA and the other federal health and safety agencies. The FCC limit for RF exposure from wireless telephones is set at a Specific Absorption Rate (SAR) of 1.6 watts per kilogram (1.6 W/kg). The FCC limit is consistent with the safety standards developed by the Institute of Electrical and Electronic Engineering (IEEE) and the National Council on Radiation Protection and Measurement. The exposure limit takes into consideration the body's ability to remove

heat from the tissues that absorb energy from the wireless phone and is set well below levels known to have effects. Manufacturers of wireless phones must report the RF exposure level for each model of phone to the FCC. The FCC website (<http://www.fcc.gov/oet/rfsafety>) gives directions for locating the FCC identification number on your phone so you can find your phone's RF exposure level in the online listing.

8. What has the FDA done to measure the radiofrequency energy coming from wireless phones?

The Institute of Electrical and Electronic Engineers (IEEE) is developing a technical standard for measuring the radiofrequency energy (RF) exposure from wireless phones and other wireless handsets

Safety Guidelines

with the participation and leadership of FDA scientists and engineers. The standard, 'Recommended Practice for Determining the Spatial- Peak Specific Absorption Rate (SAR) in the Human Body Due to Wireless Communications Devices: Experimental Techniques,' sets forth the first consistent test methodology for measuring the rate at which RF is deposited in the heads of wireless phone users. The test method uses a tissuesimulating model of the human head. Standardized SAR test methodology is expected to greatly improve the consistency of measurements made at different laboratories on the same phone. SAR is the measurement of the amount of energy absorbed in tissue, either by the whole body or a small part of the body. It is measured in watts/kg (or

milliwatts/g) of matter. This measurement is used to determine whether a wireless phone complies with safety guidelines.

9. What steps can I take to reduce my exposure to radiofrequency energy from my wireless phone?

If there is a risk from these products - and at this point we do not know that there is - it is probably very small. But if you are concerned about avoiding even potential risks, you can take a few simple steps to minimize your exposure to radiofrequency energy (RF). Since time is a key factor in how much exposure a person receives, reducing the amount of time spent using a wireless phone will reduce RF exposure. If you must conduct extended conversations by wireless phone every day, you could place more distance

between your body and the source of the RF, since the exposure level drops off dramatically with distance. For example, you could use a headset and carry the wireless phone away from your body or use a wireless phone connected to a remote antenna. Again, the scientific data do not demonstrate that wireless phones are harmful. But if you are concerned about the RF exposure from these products, you can use measures like those described above to reduce your RF exposure from wireless phone use.

10. What about children using wireless phones?

The scientific evidence does not show a danger to users of wireless phones, including children and teenagers. If you want to take steps to lower exposure to radiofrequency

energy (RF), the measures described above would apply to children and teenagers using wireless phones. Reducing the time of wireless phone use and increasing the distance between the user and the RF source will reduce RF exposure. Some groups sponsored by other national governments have advised that children be discouraged from using wireless phones at all. For example, the government in the United Kingdom distributed leaflets containing such a recommendation in December 2000. They noted that no evidence exists that using a wireless phone causes brain tumors or other ill effects. Their recommendation to limit wireless phone use by children was strictly precautionary; it was not based on scientific evidence that any health hazard exists.

Safety Guidelines

11. What about wireless phone interference with medical equipment?

Radiofrequency energy (RF) from wireless phones can interact with some electronic devices. For this reason, the FDA helped develop a detailed test method to measure electromagnetic interference (EMI) of implanted cardiac pacemakers and defibrillators from wireless telephones. This test method is now part of a standard sponsored by the Association for the Advancement of Medical Instrumentation (AAMI). The final draft, a joint effort by the FDA, medical device manufacturers, and many other groups, was completed in late 2000. This standard will allow manufacturers to ensure that cardiac pacemakers and defibrillators are safe from wireless phone EMI. The FDA has tested hearing aids for

interference from handheld wireless phones and helped develop a voluntary standard sponsored by the Institute of Electrical and Electronic Engineers (IEEE). This standard specifies test methods and performance requirements for hearing aids and wireless phones so that no interference occurs when a person uses a 'compatible' phone and a 'compatible' hearing aid at the same time. This standard was approved by the IEEE in 2000. The FDA continues to monitor the use of wireless phones for possible interactions with other medical devices. Should harmful interference be found to occur, the FDA will conduct testing to assess the interference and work to resolve the problem.

12. Where can I find additional information?

For additional information, please refer to the following resources:

FDA web page on wireless phones

(<http://www.fda.gov/cdrh/phones/index.html>)

Federal Communications Commission (FCC) RF Safety Program

(<http://www.fcc.gov/oet/rfsafety>)

International Commission on Non-Ionizing Radiation Protection

(<http://www.icnirp.de>)

World Health Organization (WHO) International EMF Project

(<http://www.who.int/emf>)

National Radiological Protection Board (UK)

(<http://www.nrpb.org.uk/>)

10 Driver Safety Tips

Your wireless phone gives you the powerful ability to communicate by voice almost anywhere, anytime. An important responsibility accompanies the benefits of wireless phones, one that every user must uphold.

When operating a car, driving is your first responsibility.

When using your wireless phone behind the wheel of a car, practice good common sense and remember the following tips:

1. Get to know your wireless phone and its features such as speed dial and redial. Carefully read your instruction manual and learn to take advantage of valuable features most phones offer, including automatic redial and memory. Also, work to memorize the phone keypad so you can use the speed dial function without taking your attention off the road.

Safety Guidelines

2. When available, use a handsfree device. A number of handsfree wireless phone accessories are readily available today. Whether you choose an installed mounted device for your wireless phone or a speaker phone accessory, take advantage of these devices if available to you.
3. Position your wireless phone within easy reach. Make sure you place your wireless phone within easy reach and where you can reach it without removing your eyes from the road. If you get an incoming call at an inconvenient time, if possible, let your voicemail answer it for you.
4. Suspend conversations during hazardous driving conditions or situations. Let the person you are speaking with know you are driving; if necessary, suspend the call in heavy traffic or hazardous weather conditions. Rain, sleet, snow and ice can be hazardous, but so is heavy traffic. As a driver, your first responsibility is to pay attention to the road.
5. Do not take notes or look up phone numbers while driving. If you are reading an address book or business card, or writing a “to-do” list while driving a car, you are not watching where you are going. It is common sense. Don’t get caught in a dangerous situation because you are reading or writing and not paying attention to the road or nearby vehicles.
6. Dial sensibly and assess the traffic; if possible, place calls when you are not moving or before pulling into traffic. Try to plan your calls before you begin your trip or attempt to coincide your calls with times you may be stopped at a stop sign, red light or otherwise

stationary. But if you need to dial while driving, follow this simple tip — dial only a few numbers, check the road and your mirrors, then continue.

7. Do not engage in stressful or emotional conversations that may be distracting. Stressful or emotional conversations and driving do not mix; they are distracting and even dangerous when you are behind the wheel of a car. Make people you are talking with aware you are driving and if necessary, suspend conversations which have the potential to divert your attention from the road.
8. Use your wireless phone to call for help. Your wireless phone is one of the greatest tools you can own to protect yourself and your family in dangerous situations — with your phone at your side, help is only three numbers away. Dial 911 or other local emergency number in the case of fire, traffic accident, road hazard or medical emergency. Remember, it is a free call on your wireless phone!
9. Use your wireless phone to help others in emergencies. Your wireless phone provides you a perfect opportunity to be a “Good Samaritan” in your community. If you see an auto accident, crime in progress or other serious emergency where lives are in danger, call 911 or other local emergency number, as you would want others to do for you.
10. Call roadside assistance or a special wireless nonemergency assistance number when necessary. Certain situations you encounter while driving may require attention, but are not urgent enough to

Safety Guidelines

merit a call for emergency services. But you can still use your wireless phone to lend a hand. If you see a broken-down vehicle posing no serious hazard, a broken traffic signal, a minor traffic accident where no one appears injured or a vehicle you know to be stolen, call roadside assistance or other special non-emergency wireless number.

For more information, please call to 888-901-SAFE, or visit our website www.wow-com.com

Consumer Information on SAR (Specific Absorption Rate)

This Model Phone Meets the Government's Requirements for Exposure to Radio Waves.

Your wireless phone is a radio transmitter and receiver. It is designed and manufactured not

to exceed the emission limits for exposure to radiofrequency (RF) energy set by the Federal Communications Commission (FCC) of the U.S. Government. These limits are part of comprehensive guidelines and establish permitted levels of RF energy for the general population. The guidelines are based on standards that were developed by independent scientific organizations through periodic and thorough evaluation of scientific studies. The standards include a substantial safety margin designed to assure the safety of all persons, regardless of age and health.

The exposure standard for wireless mobile phones employs a unit of measurement known as the Specific Absorption Rate, or SAR. The SAR limit set by the FCC is 1.6W/kg. *

Tests for SAR are conducted using standard operating positions specified by the FCC

with the phone transmitting at its highest certified power level in all tested frequency bands.

Although SAR is determined at the highest certified power level, the actual SAR level of the phone while operating can be well below the maximum value. Because the phone is designed to operate at multiple power levels to use only the power required to reach the network, in general, the closer you are to a wireless base station antenna, the lower the power output.

Before a phone model is available for sale to the public, it must be tested and certified to the FCC that it does not exceed the limit established by the government-adopted requirement for safe exposure. The tests are performed in positions and locations (e.g., at the ear and worn on the body) as required by the FCC for each model.

The highest SAR value for this model phone when tested for use at the ear is 0.92 W/kg and when worn on the body, as described in this user's manual, is 0.51 W/kg.

(Body-worn measurements differ among phones models, depending upon available accessories and FCC requirements.) While there may be differences between SAR levels of various phones and at various positions, they all meet the government requirement for safe exposure.

The FCC has granted an Equipment Authorization for this model phone with all reported SAR levels evaluated as in compliance with the FCC RF emission guidelines. SAR information on this model phone is on file with the FCC and can be found under the Display Grant section of <http://www.fcc.gov/oet/fccid> after searching on FCC ID BEJGT540G.

Safety Guidelines

Additional information on Specific Absorption Rates (SAR) can be found on the Cellular Telecommunications Industry Association (CTIA) website at <http://www.wow-com.com>

- * In the United States and Canada, the SAR limit for mobile phones used by the public is 1.6 watts/kg (W/kg) averaged over one gram of tissue. The standard incorporates a substantial margin of safety to give additional protection for the public and to account for any variations in measurements.
- * Product meets current FCC & IC Radio Frequency Exposure Guidelines.
FCC ID: BEJGT540G,
IC ID: 2703C-GT540R

LIMITED WARRANTY STATEMENT

1. WHAT THIS WARRANTY COVERS:

LG offers you a limited warranty that the enclosed subscriber unit and its enclosed accessories will be free from defects in material and workmanship, according to the following terms and conditions:

1. The limited warranty for the product extends for ONE (1) year beginning on the date of purchase of the product by the original end user.
2. The limited warranty extends only to the original end user of the product and is not assignable or transferable to any subsequent purchaser/end user.
3. This warranty is good only to the original end user of the product during the warranty period as long as it is in Canada.
4. Upon request from LG, the consumer must provide information to reasonably prove the date of purchase.
5. During the applicable warranty period, LG will repair or replace at LG's sole option, without charge to the original end user, any defective component part of the phone or accessory.
6. LG may use rebuilt, reconditioned or new parts or components when repairing any product or replace a product with a rebuilt, reconditioned or new product.

2. WHAT THIS WARRANTY DOES NOT COVER:

1. Defects or damages resulting from use of the product in other than its normal and customary manner.
2. Defects or damages from abnormal use, abnormal conditions, improper storage, exposure to moisture or dampness, unauthorized modifications, unauthorized connections, unauthorized repair, misuse, neglect, abuse, accident, alteration, improper installation or other acts which are not the fault of LG, including damage caused by spills of food or liquids.
3. Breakage or damage to antennas unless caused directly by defects in material or workmanship.
4. The fact that the Customer Service Department at LG was not notified by the original end user of the alleged defect or malfunction of the product, during the warranty period.
5. Products which have had their serial numbers removed or made illegible.

6. Damage resulting from use of non-LG approved accessories.
7. All plastic surfaces and all other externally exposed parts that are scratched or damaged due to normal customer use.
8. Products serviced by non-authorized persons or companies.

Notes:

1. This limited warranty supersedes all other warranties, expressed or implied either in fact or by operations of law, statutory or otherwise, including, but not limited to any implied warranty of merchantability or fitness for a particular purpose.
2. Shipping damage is the sole responsibility of the shipping company.

3. EXCLUSION OF LIABILITY:

No other express warranty is applicable to this product.

THE DURATION OF ANY IMPLIED WARRANTIES, INCLUDING THE IMPLIED WARRANTY OF MARKETABILITY, IS LIMITED TO THE DURATION OF THE EXPRESS WARRANTY HEREIN. LG ELECTRONICS CANADA, INC. SHALL NOT BE LIABLE FOR THE LOSS OF THE USE OF THE PRODUCT, INCONVENIENCE, LOSS OR ANY OTHER DAMAGES, DIRECT OR CONSEQUENTIAL, ARISING OUT OF THE USE OF, OR INABILITY TO USE, THIS PRODUCT OR FOR ANY BREACH OF ANY EXPRESS OR IMPLIED WARRANTY, INCLUDING THE IMPLIED WARRANTY OF MARKETABILITY APPLICABLE TO THIS PRODUCT.

4. HOW TO GET WARRANTY SERVICE:

To obtain warranty service, please call the following telephone number from anywhere in Canada:

LG Electronics Canada, Inc.

Toll Free: 1-888-LG-Canada (1-888-542-2623)

http://www.lg.com/ca_en



LG

**Electronics Canada Inc.
Mississauga, Ontario**