

LINE 6

**TONE
CORE**

Pilot's Handbook for Über Metal
Pilotenhandbuch für Über Metal
Manuel de pilotage pour Über Metal
Manual del Piloto para el Über Metal
Pilotenhandboek voor Über Metal

U.S Patent No. 7,711,442

40-00-0185

Electroponic Limited Edition available @ www.line6.com

Rev F

**Line 6, ToneCore, Constrictor, Crunchtone, Echo Park, Space Chorus,
Tap Tremolo and Über Metal are trademarks of Line 6, Inc.**

CAUTION

This equipment has been tested and found to comply with the limits for a Class B digital device pursuant to Part 15 of FCC Rules. Operation is subject to the following two conditions: (1) This device may not cause harmful interference, and (2) this device must accept any interference received, including interference that may cause undesired operation.

WARNING

To reduce the risk of fire or electric shock, do not expose this appliance to rain or moisture.



The exclamation point within a triangle means, "Caution!" Please read the information next to all caution signs.



The lightning symbol within a triangle means, "Electrical caution!" It indicates the presence of information about operating voltage and potential risks of electrical shock.



Line 6, Inc.:

The POD, Clifton House, Butler's leap.
Rugby, Warwickshire, United Kingdom, CV 21 3RQ

26580 Agoura Road,
Calabasas, CA 91302-1921 USA



**You should read these Important Safety Instructions.
Keep these instructions in a safe place.**



Before using your ToneCore, carefully read the applicable items of these operating instructions and the safety suggestions.

1. Obey all warnings on the pedal and in the ToneCore Pilot's Handbook.
2. Connect optional power supply only to AC power outlets rated 100-120V or 200-240V 47-63Hz (see indications on optional power supply).
3. Do not perform service operations beyond those described in the ToneCore Pilot's Handbook. Service is required when the apparatus has been damaged in any way, such as:
 - power-supply cord or plug is damaged
 - liquid has been spilled or objects have fallen into the apparatus
 - the unit has been exposed to rain or moisture
 - the unit does not operate normally or changes in performance in a significant way
 - the unit is dropped or the enclosure is damaged.
4. Do not place near heat sources, such as radiators, heat registers, or appliances which produce heat.
5. Guard against objects or liquids entering the enclosure. Do not use or place unit near water.
6. Unplug the power supply when not in use for extended periods of time. Unplug the power supply during lightning storms.
7. Clean only with a damp cloth.
8. Only use attachments/accessories specified by the manufacturer.
9. Prolonged listening at high volume levels may cause irreparable hearing loss and/or damage. Always be sure to practice "safe listening."

Über Metal Pilot's Handbook

Output your ToneCore to your amplifier, or route it through another effect pedal.

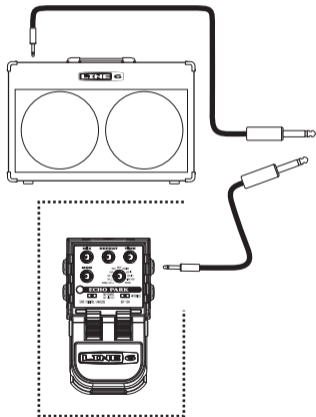

Connect your guitar using a standard guitar cable.

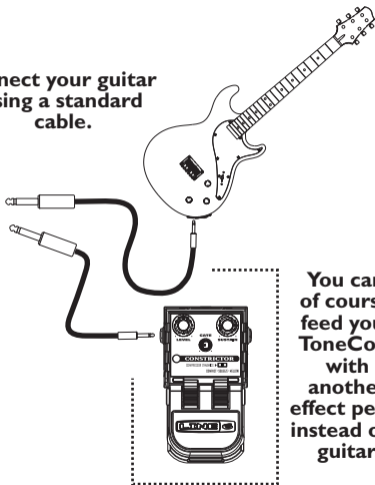

You can, of course, feed your ToneCore with another effect pedal instead of a guitar.

Greetings and salutations! Thank you for inviting the mighty Line 6 Über Metal high gain distortion pedal into your life.

Effect On-Off / Power Indicator Light

The Power Indicator Light on your ToneCore uses two colors to indicate the pedal's state:

- Light not lit – Effect is bypassed (off)
- GREEN – Effect is engaged (on)
- RED (flashing) – Batteries should be replaced
This low power indication will override all other states

Connections and Power Indicator Light

In Jack

Here's where it all begins. Use a standard guitar cable to connect your guitar, or the output of another effect to use in combination with your ToneCore. ***Like most pedals, inserting a plug into this jack will turn on the power to your ToneCore. Disconnect the plug from this jack when the ToneCore is not being used.***

Out Jack

Use a standard guitar cable to connect to the input of a guitar amp, or the input of another effect that will feed your amp.

Power Jack

Connect an optional ToneCore-compatible Line 6 power supply like the DC-1, and you'll never need a 9-volt battery again!

Foot Switch

Stomp on this to turn Über Metal's effect sound processing on and off.

Über Metal Pilot's Handbook

LEVEL



SCOOP



DRIVE



BASS



MID



TREBLE



ÜBER METAL



METAL • PULVERIZE • INSANE

OFF • 1 • 2

Controls

Level

Higher levels will hit the amp or effect fed by the Über Metal with more signal level, giving you more volume. If the level is high enough, it may also cause unwanted distortion within the receiving amp or pedal.

Mid & Scoop

Mid chooses a frequency from 250Hz to 4kHz. Scoop then removes sound at this frequency, with maximum scoop at the fully clockwise setting. Turn it fully counter-clockwise for a slight Mid boost.

Drive

This controls the amount of distortion created within your Über Metal. Especially when you've got it set high, you may need to use the Gate to tame unwanted noise.

Bass & Treble

Bass and Treble are more/less controls for your low and high frequencies. Point the knob straight up to leave your tone unaltered.

Model Switch

Give this a flick to reconfigure the virtual circuitry inside your Über Metal, and enjoy three distinctly different sound “flavors”.

Metal creates screaming distortion, from heavy grind to molten metal! Bow down, infidels.

Pulverize gives you a distortion similar to a high gain tube amp. Mmmm, it's warm and meaty!

Insane has more skin-peeling gain and sustain than anything else available, and boy does it sound good.

Gate

Off – Disables the Gate.

Gate 1 – A soft and mild noise gate, self-adjusting to your current Drive knob setting (cool, huh?).

Gate 2 – A heavy, fast-clamping gate. Great for those aggressive metal chords and palm muting.

Battery Access Instructions

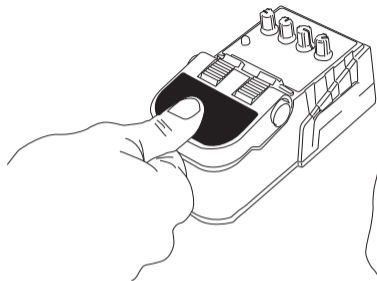

1) Depress pedal fully.

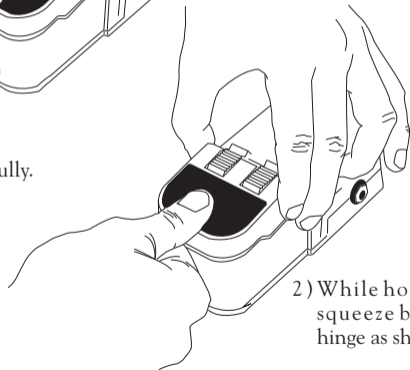

2) While holding pedal, squeeze both sides of hinge as shown.

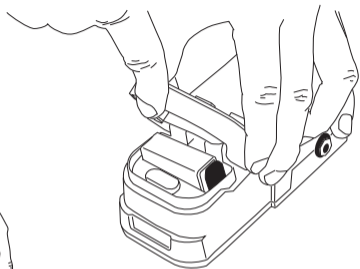

3) Squeezing hinge, raise pedal to reveal battery.

Battery Access Instructions

Power Supply

Connect an optional Line 6 DC-1 power supply and you'll never need a 9-volt battery again! It is also compatible with most popular 9 Volt DC stomp boxes. Using the power supply will disconnect the battery.



POWER REQUIREMENTS

	Min	Nominal	Max
Supply Voltage	6 VDC	9.6 VDC	16 VDC
Supply Current @ 9.6VDC	40mADC	60mADC	100mADC
Power @ 9.6VDC	0.4 Watt	0.6 Watt	1 Watt

Example Tones

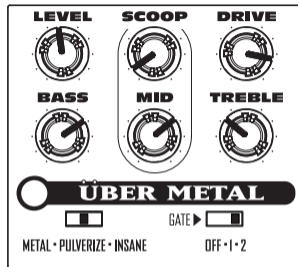
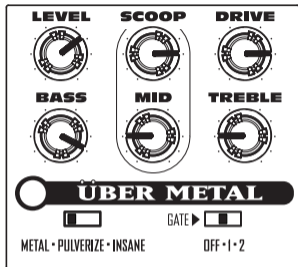

Early Metal

Journey back with us to the world of vintage metal. Large numbers of smoke pots and 4x12 cabinets are highly recommended.

80's Metal

Squeeze into your Spandex and pull out the AquaNet—this is hair metal at its best! You'll want to use a guitar with humbuckers for best results. Perhaps a dayglo yellow one would do the trick.

Monster Metal

It slices, it dices, it shears off body parts! The aggressive gate setting is perfect for choppy chordal rhythms and other forms of Nu Metal madness.

Your Tone Settings

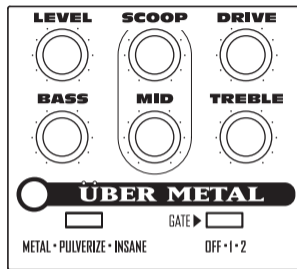
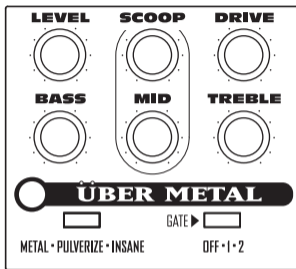
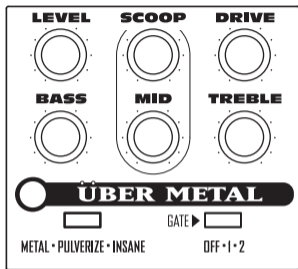

Mark the knob and switch settings for your favorite tones above.