

**SHARPER  
IMAGE**

Bluetooth Speakers Bulb



**User Guide  
SBT5007**

**In the box**

Bluetooth Speakers Bulb



**Installing the App**

1. Start the App Store on your iOS device or Google Play Store app on your Android device.
2. Search for the "Switcher by Sharper Image" app.
3. Once found, press the install button on Switcher's app page.

**Pairing the Speaker**

1. Screw the SBT5007 into a standard E26 light socket and switch the light on.
2. Keep the speaker and your Bluetooth-enabled device within 3 feet of the each other during the pairing process.
3. Set your mobile phone or other Bluetooth-enabled device to search for Bluetooth devices.
4. When your mobile phone (or other Bluetooth-enabled device) finds the Switcher, select SBT5007 from the list of found devices.
5. After a successful confirmation, the SBT5007 will be listed as connected in your Bluetooth menu.

**NOTE:** Your Switcher Lightbulb & Speaker is now paired to the media player on your mobile device. To fully control the various functions of the speaker, you must follow the steps in the "Connecting the Lightbulb to your Device" section.

Manufacturer: LINPA WORLD., Ltd

**Pairing the Speaker (cont'd)**

**On an iPhone**  
• Go to **SETTINGS > BLUETOOTH**  
(Make sure Bluetooth is turned ON)

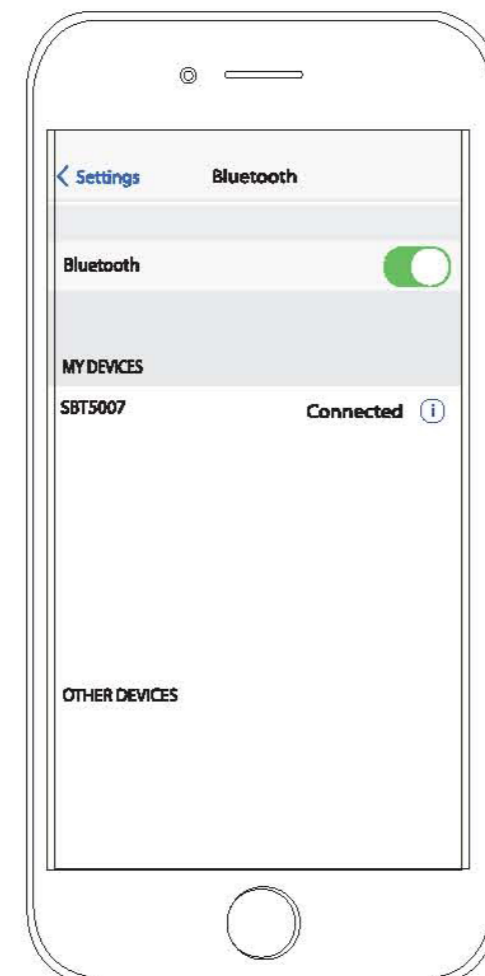

**On an Android Phone**  
• Go to **SETTINGS > BLUETOOTH > MENU**  
Search for devices (Make sure Bluetooth is turned ON)

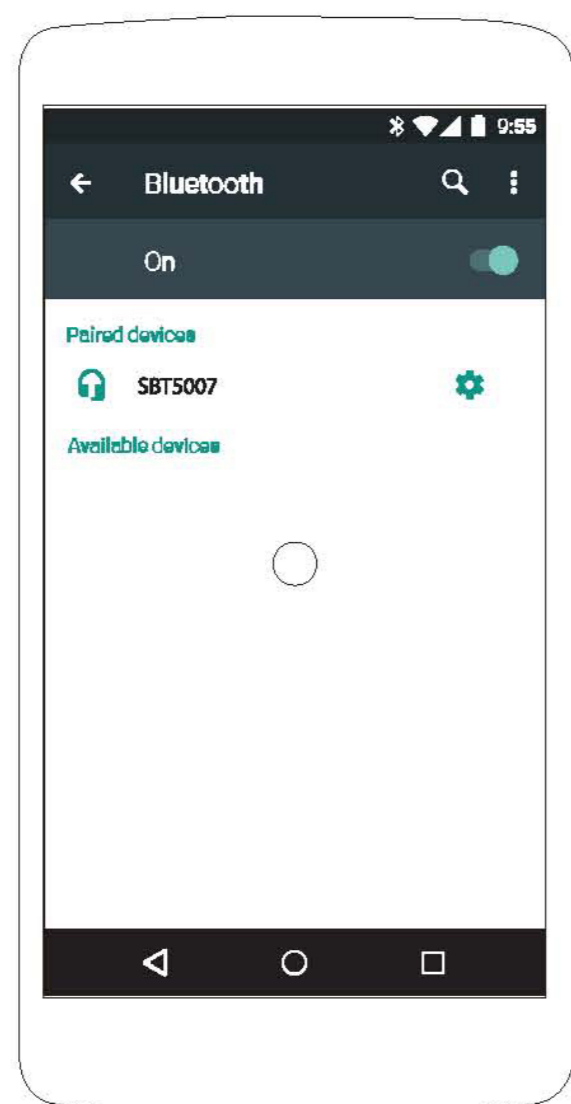

**NOTE:** If you would like to connect the speaker to another device, you must unpair the speaker from the currently paired device first. On your device's Bluetooth settings, select SBT5007 then select "unpair" or "forget device." The speaker will return to pairing mode.

**i** The screenshots above are typical of many Bluetooth-enabled devices in the market today, and are used to assist in the explanation of the pairing process. Your Bluetooth-enabled device's interface and interaction with the speaker may differ slightly from the illustrations above.

**Connecting the Lightbulb to Your Device**

1. Make sure the SBT5007 is connected to a light socket and switch the light on.
2. Start the Switcher app on your mobile device.
3. Select the [📶] icon to view a list of nearby devices.
4. Select your Switcher bulb. If it is not paired, you will be prompted to pair your Bluetooth-enabled device. Refer to the "Pairing the Lightbulb" section of this guide for further instructions.
5. Once it is connected, the device will be listed as "connected."



**Deleting a Lightbulb**

1. Start the Switcher app on your mobile device.
2. Press the [📶] button on the menu bar.
3. Locate SBT5007 from the list of paired devices.
4. Touch the screen and slide your finger to the left.
5. Press [Delete] to remove the SBT5007 from the list of paired devices.



• Select your bulb from the list of paired devices and slide your finger to the left.

• Press [Delete] to remove the bulb from the list of paired devices.

**Navigating the Switcher App**

- Connect**  
Lists all available Bluetooth-paired devices within range to connect to the Switcher Lightbulb & Speaker.
- Music**  
Click the music tab to select tracks from your device's library; control media playback.
- Colors**  
The Colors tab allows you to control the color and brightness of the lightbulb.
- ON/OFF**  
Click [🔌] to toggle the lightbulb on and off.
- Settings**  
The settings tab allows you to set or cancel a timer to turn off the Switcher

**Playing Music**

1. Start the Switcher app on your mobile device.
2. You will be prompted to connect your device if you have not already.
3. Once connected, press the [📶] button on the menu bar.
4. Select a song and use the [🎵] [🔊] buttons to control playback and your connected device's volume control to adjust volume.

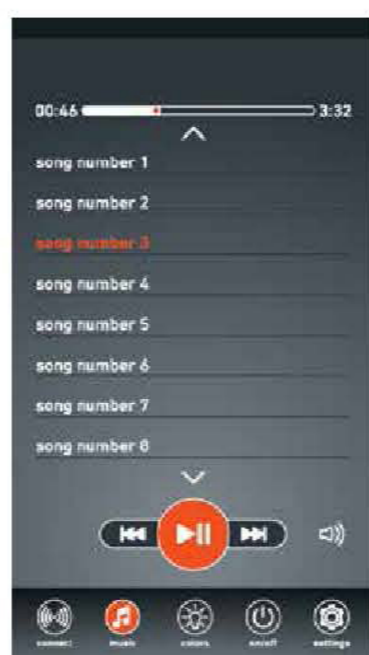

**Note:** Switcher will automatically locate any music installed on your device.

**i** You can also use other media players for music playback. Once the Switcher Lightbulb & Speaker is paired to your device, simply start your media player of choice and control playback through the controls in this app.

**Changing Colors**

1. Start the Switcher app on your mobile device.
2. Once connected, press on the [📶] button on the menu bar.
3. Select the color of light you would like the Switcher Lightbulb & Speaker to emit in the color field or by pressing on the circular preset buttons.

**Note:** Select a preset or customize the lighting option by toggling the [🔌] button at the bottom of the screen.

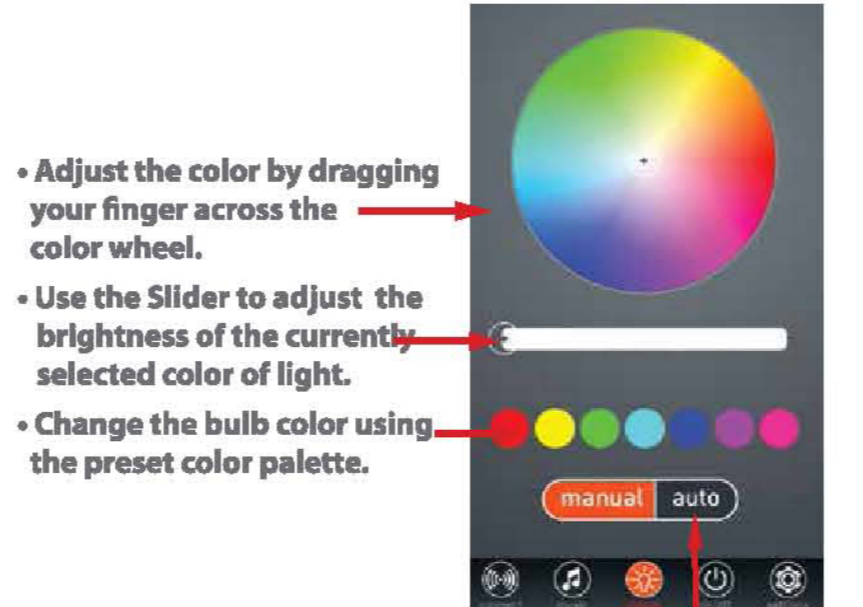

- Adjust the color by dragging your finger across the color wheel.
- Use the Slider to adjust the brightness of the currently selected color of light.
- Change the bulb color using the preset color palette.

The [🔌] button makes the Bulb flash each preset color.

**Changing Colors (cont'd)**

**Dimming the Lightbulb**

1. Start the Switcher app on your mobile device.
2. Press the [📶] button on the menu bar.
3. Use the slider bar to adjust the brightness of the currently selected color of light.
4. Use the dot bar to adjust the brightness of white light.

**Note:** The bars can only be used in [🔌] mode.

**Setting the Timer**

1. Start the Switcher app on your mobile device.
2. Press the [⌚] button at the bottom of the screen.
3. Use the clock's hour and minute hands to set the length of time before the Switcher Lightbulb & Speaker turns off.



4. Once you are done, press the [🔌] button to set your timer.

**Note:** You can cancel a timer by pressing the [cancel timer] button on the settings page.

**Renaming the Lightbulb**

1. Start the Switcher app on your mobile device.
2. Once connected, press the [📶] button on the menu bar.
3. Press the [Rename Device] button.
4. Type the new device name in the dialog box and press [Reset] to confirm your entry.

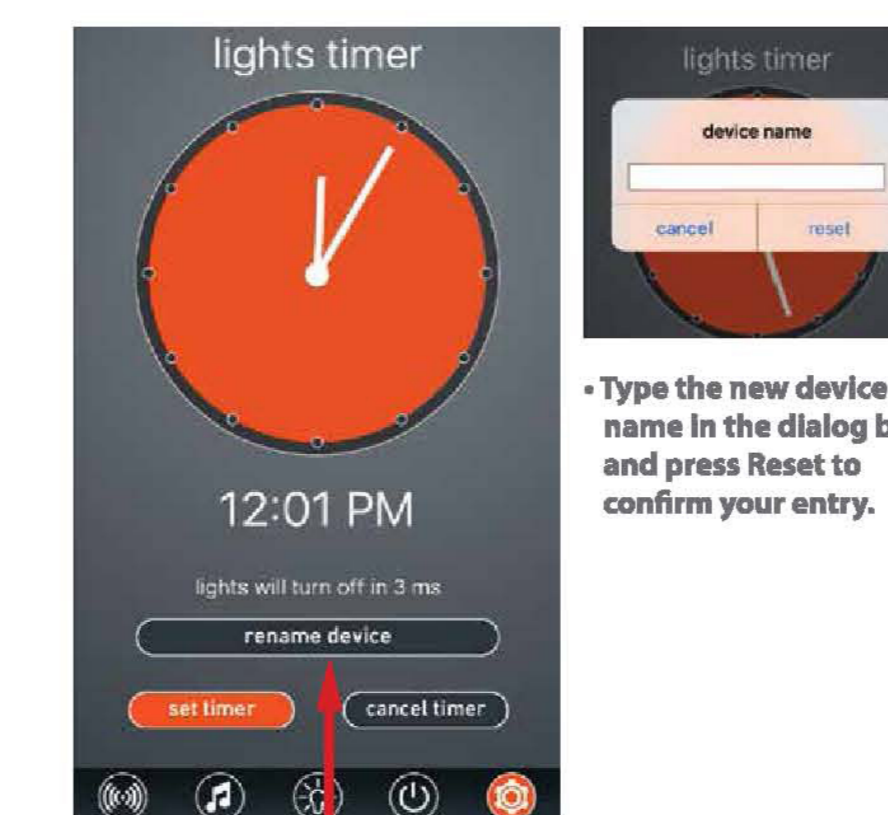

• Press the "Rename device" button

**Troubleshooting Tips**

**i** I can pair the Switcher Light & Speaker with my Bluetooth device, but I cannot hear any music.

1. Make sure your Bluetooth device supports A2DP profile.
2. Turn up the volume on your Bluetooth device.
3. You may have to unpair the speaker, then re-pair to your device.

**i** My Bluetooth device is not able to pair with the Switcher Light & Speaker.

1. Make sure the bulb is properly connected to the lamp before beginning the pairing process.
2. Keep the bulb and Bluetooth-enabled device within 3 feet of each other during the pairing process.
3. Check that YOUR device's Bluetooth feature is turned ON.
4. Try repeating the pairing process. Consult the "Pairing the Speaker" section of this manual.
5. Make sure the lamp the bulb is screwed into is plugged into a working electrical outlet.

**i** I cannot get the speaker into pairing mode.

1. Make sure the SBT5007 is turned ON before beginning the pairing process.
2. Make sure that your device's Bluetooth feature is powered ON and ready to search for Bluetooth devices.
3. Make sure the lamp the bulb is screwed into is plugged into a working electrical outlet.

**Device and Software Compatibility**

This item is compatible with iOS version 8.0 and above, Android version 4.3 and above and Bluetooth version 4.0 and above.

**Legal information**

**READ CAREFULLY AND KEEP THIS MANUAL**

Caution: Any changes or modifications not expressly approved could void the user's authority to operate the equipment.

**Note:** This equipment has been tested and found to comply with the limits for a Class B digital device, pursuant to part 15 of the FCC Rules. These limits are designed to provide reasonable protection against harmful interference in a residential installation. This equipment generates, uses and can radiate radio frequency energy and, if not installed and used in accordance with the instructions, may cause harmful interference to radio communications. However, there is no guarantee that interfering the equipment off and on, the user is encouraged to try to correct the interference by one or more of the following measures:

- Reorient or relocate the receiving antenna.
- Increase the separation between the equipment and receiver.
- Connect the equipment into an outlet on a circuit different from that to which the receiver is connected.
- Consult the dealer or an experienced radio/TV technician for help.

This device complies with Part 15 of the FCC Rules. Operation is subject to the following two conditions: (1) this device may not cause harmful interference, and (2) this device must accept any interference received, including interference that may cause undesired operation.

**Limited Warranty (cont'd)**

**90 Days Limited Warranty**  
In the unlikely event that this product is defective, or does not perform properly, you may within ninety (90) days from your original date of purchase return it to the authorized service center for repair or exchange.

**TO OBTAIN WARRANTY SERVICE:**

- Call the Customer Support number located below, or go to our website portal to receive an SRO number.
  - Provide proof of the date of purchase within the package (Dated bill of sale).
  - Prepay all shipping costs to the authorized service center, and remember to insure your return.
  - Include a return shipping address (no P.O. Boxes), a telephone contact number, and the defective unit within the package.
  - Describe the defect or reason you are returning the product.
- Your product will be repaired or replaced, at our option, for the same or similar model of equal value if examination by the service center determines this product is defective. Products received damaged as a result of shipping will require you to file a claim with the carrier.

The shipping address of the authorized service center is:  
**Southern Telecom, Inc.**  
**Attention: Customer Service (2nd Floor)**  
**14-C 53rd Street**  
**Brooklyn, NY 11232**

Should you have any questions or problems concerning this product, please contact our customer service department at:

Customer Support:  
Phone: 1-877-768-8481  
Monday-Friday 8AM-10PM(EST)

www.southern telecom.com  
Click on "Product Support"

**Warranty service not provided**  
This warranty does not cover damage resulting from accident, misuse, abuse, improper installation or operation, lack of reasonable care, and unauthorized modification. This warranty is voided in the event any unauthorized person opens, alters or repairs this product. All products being returned to the authorized service center for repair must be suitably packaged.

Limitation of Warranty:  
• THE WARRANTY STATED ABOVE IS THE ONLY WARRANTY APPLICABLE TO THIS PRODUCT. ALL OTHER WARRANTIES, EXPRESS OR IMPLIED (INCLUDING ALL IMPLIED WARRANTIES OF MERCHANTABILITY OR FITNESS FOR A PARTICULAR PURPOSE) ARE HEREBY DISCLAIMED. NO VERBAL OR WRITTEN INFORMATION GIVEN BY AIT, INC. ITS AGENTS, OR EMPLOYEES SHALL CREATE A WARRANTY OR IN ANY WAY INCREASE THE SCOPE OF THIS WARRANTY.

• REPAIR OR REPLACEMENT AS PROVIDED UNDER THIS WARRANTY IS THE EXCLUSIVE REMEDY OF THE CONSUMER. AIT, INC. SHALL NOT BE LIABLE FOR INCIDENTAL OR CONSEQUENTIAL DAMAGES RESULTING FROM THE USE OF THIS PRODUCT OR ARISING OUT OF ANY BREACH OF ANY EXPRESS OR IMPLIED WARRANTY ON THIS PRODUCT. THIS DISCLAIMER OF WARRANTIES AND LIMITED WARRANTY ARE GOVERNED BY THE LAWS OF THE STATE OF NEW YORK. EXCEPT TO THE EXTENT PROHIBITED BY APPLICABLE LAW, ANY IMPLIED WARRANTY OF MERCHANTABILITY OR FITNESS FOR A PARTICULAR PURPOSE ON THIS PRODUCT IS LIMITED TO THE APPLICABLE WARRANTY PERIOD SET FORTH ABOVE.

Some states do not allow the exclusion nor limitation of incidental or consequential damages, or limitations on how long an implied warranty lasts so the above limitations on exclusions may not apply to you. This warranty gives you specific legal rights, and you also may have other rights that vary from state to state.

This device is not intended for use with emergency exits or not for emergency lighting

Sharper Image® name and logo are registered trademarks. Manufactured and marketed by Southern Telecom under license. © Sharper Image. All Rights Reserved.

**SHARPER  
IMAGE**