

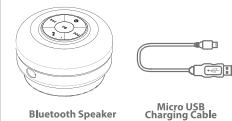

Location of controls

- Top View** **Side View**
-
1. [] button - Power ON / OFF / Indicator light
 2. [H] button - Quick press = Previous song Press & Hold = Volume down
 3. [M] button - Quick press = Next song Press & Hold = Volume up
 4. [] button - Play / Pause music
 5. [] button - Answer / End call
 6. Microphone
 7. DC 5V charging socket (under the rubber cover)
 8. Suction cup



Charging the Bluetooth Speaker

1. Pull open the rubber cover on the side of the speaker.
2. Connect the small end of the Micro USB charging cable into the 5V-DC charging socket on the side of the speaker.
3. Connect the other end of the USB cable to your computer's USB port.
4. The RED indicator light is illuminated.
5. The RED indicator light shuts off when the speaker is fully charged. (Approximately 4 hours)
6. Be sure to close the rubber cover on the side of the speaker (especially when coming into contact with water).



User Manual

Water resistance

This speaker is water resistant. It may be used in a shower and can get wet, but cannot be submerged in water.

1. Make sure the DC 5V water resistant protector is sealed before coming into contact with any water.
2. You can stick the Bluetooth Speaker to the shower wall with the suction cup by pressing on the front of the speaker.

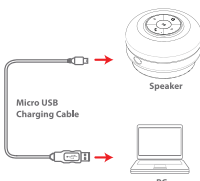

NOTE: Make sure you charge your speaker for 6 hours before using it for the first time. You can use the Bluetooth Speaker while charging.

Pairing the speaker with a Bluetooth enabled device

1. Turn OFF the Bluetooth Speaker by pressing and holding the [] button until you hear a single beep, and the indicator light shuts off.
2. Press and hold the [] button until the BLUE indicator light on the front of the speaker flashes quickly. A series of tones will sound.
3. Keep your Bluetooth Speaker and Bluetooth enabled device within 3 feet of each other during the pairing process.
4. Set your mobile phone or other Bluetooth enabled device to search for Bluetooth devices.

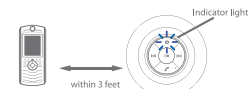

On an iPhone
Go to SETTINGS > BLUETOOTH (Make sure Bluetooth is turned ON)

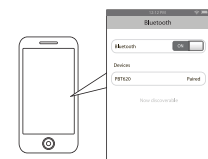

On a BlackBerry
Go to SETTINGS/OPTIONS > BLUETOOTH (Make sure Bluetooth is turned ON)



On an Android Phone
Go to SETTINGS > BLUETOOTH > MENU > Search for devices (Make sure Bluetooth is turned ON)



On other Cell Phones/Devices
Review the instruction manual that came with your phone/device.

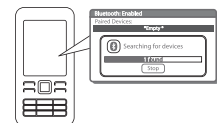

5. When the Bluetooth-enabled device finds the speaker, select "PBT620" from the list of found devices.

6. If required, enter the password 0000. Select OK or Yes to pair the two units.

7. After a successful pairing, a series of tones will sound, and the LED indicator light will blink BLUE slowly.

NOTE: The screenshots show an typical of many Bluetooth-enabled devices in the market today and are used to assist in the explanation of the pairing process. Your Bluetooth-enabled device's interface and interaction with the Bluetooth Speaker may slightly differ from the illustrations above.

Using your Bluetooth Speaker

Powering ON / OFF

- To turn ON, press and hold the [] button until you hear a series of tones, and the indicator light flashes BLUE.
- To turn OFF, press and hold the [] button until you hear a tone, and the indicator lights shuts off.

Answering / Ending a call

- To answer a call, press the [] button
- To end a call, press the [] button

Adjusting the Volume
Press and hold the [H] or [M] button to adjust the volume to the desired level.

NOTE: You may also adjust the volume from your Bluetooth device's volume control.

To make a call

- Dial the number and press the SEND button on your mobile phone, the call is automatically transferred to the speaker.



Redialing the last number called

- Quick press the [] button twice. The last number called will be redialed.

Playing Music

To enjoy wireless music on your Bluetooth Speaker, make sure you are connected to a Bluetooth enabled device. Once connected you can press PLAY on your Bluetooth device or you can push in the [M] button on the PBT620 Bluetooth Speaker. Once playback has begun, you can control the music from the control buttons of the Bluetooth speaker.

Adjusting the volume

- Press and hold the [H] or [M] button to adjust the volume to the desired level. When maximum or minimum volume is reached you will hear a beep.

NOTE: You may also adjust the volume from your mobile phone's volume control.

Play/Pause*

Press the [] button to pause the music. To resume the music, press the [] button again.

Skipping Songs* (With devices that have AVRC Bluetooth profile)

Press the [H] button to go to the next song.

Press the [M] button to go to the previous song

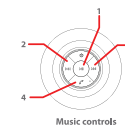

1. [] button - Play / Pause music
2. [H] button - Quick press = Previous song Press & Hold = Volume down
3. [M] button - Quick press = Next song Press & Hold = Volume up
4. [] button - Answer / End call

NOTE: You may answer & end calls while listening to music. The music will stop when a call is answered, and will restart when the call is ended.

*The Bluetooth Speaker is compatible with any brand of Bluetooth-enabled phone or music device that supports Advanced Audio Distribution Profile (A2DP) and Audio Video Remote Control Profile (AVRCP).

In order for Bluetooth devices to communicate with one another properly, they must utilize the same Bluetooth profile. To determine the profiles supported by your device (mobile phone, gaming console, computer or mp3 player), please refer to the device's user guide.

Certain Bluetooth features including those listed may not be supported by all compatible Bluetooth-enabled devices, and/or the functionality of such features may be limited in certain devices.

Troubleshooting tips

NOTE: I can pair the Bluetooth Speaker with my Bluetooth device, but I cannot hear any music.

- Make sure your Bluetooth device supports A2DP profile.
- Turn up the volume on your Bluetooth device.
- You may have to unpair the speaker, and then re-pair it to your mobile phone.

NOTE: I cannot get the Bluetooth Speaker into pairing mode.

1. Make sure the Bluetooth Speaker is turned off.
2. Keep your Bluetooth Speaker and Bluetooth enabled device within 3 feet of each other during the pairing process.
3. Press and hold the [] button until the BLUE indicator light on the front of the speaker flashes.
4. Your speaker is now in Pairing Mode

NOTE: My Bluetooth Device is not able to pair with the Bluetooth Speaker.

1. Make sure the Bluetooth Speaker is turned off.
2. Keep your Bluetooth Speaker and Bluetooth enabled device within 3 feet of each other during the pairing process.
3. Press and hold the [] button until the BLUE indicator light on the front of the speaker flashes.
4. Check that your device's bluetooth feature is turned ON.
5. Try repeating the pairing process, see "Pairing the speaker with a Bluetooth enabled device."

Safety information

- Observe all signs in the designated areas where some electronic device or RF radio products are required to be switched off. These could include airplanes, hospitals, blasting areas, and potentially explosive atmospheres.

Legal information

READ AND KEEP THESE INSTRUCTIONS.

Caution: Any changes or modifications not expressly approved could void the user's authority to operate the equipment.

Note: This equipment has been tested and found to comply with the limits for a Class B digital device, pursuant to part 15 of the FCC Rules. These limits are designed to provide reasonable protection against harmful interference in a residential installation. This equipment generates, uses, and can radiate radio frequency energy and, if not installed and used in accordance with the instructions, may cause harmful interference to radio communications. However, there is no guarantee that interference will not occur in a particular installation. If this equipment does cause harmful interference to radio or television reception, which can be determined by turning the equipment off and on, the user is encouraged to try to correct the interference by one or more of the following measures:

- Reorient or relocate the receiving antenna.
- Increase the separation between the equipment and receiver.
- Connect the equipment into an outlet on a circuit different from that to which the receiver is connected.
- Consult the dealer or an experienced radio/TV technician for help.

This device complies with Part 15 of the FCC Rules. Operation is subject to the following two conditions: (1) this device may not cause harmful interference, and (2) this device must accept any interference received, including interference that may cause undesired operation.

Limited Warranty

The product as supplied and distributed here by All, Inc. ("All") to the original consumer purchaser is warranted by All against defects in materials and workmanship for a period of one year from your date of purchase ("Warranty"). It is the policy of All that this product is defective, or does not perform properly, you may within one year from your original date of purchase return it to the authorized service center for repair or exchange.

TO OBTAIN WARRANTY SERVICE:

- Call the Customer Support number located below, or go to our website portal to receive an RMA number.
- Provide proof of the date of purchase within the package (date of sale).
- Provide all shipping costs to the authorized service center, and presenter to insure your return.
- Include a return shipping address (no P.O. Boxes), a telephone contact number, and the defective unit within the package.
- Describe the defect or reason you are returning the product.

Your product will be repaired or replaced, at our option, for the same or similar model of equal value. Examination by the service center determines if the product is defective. Products received damaged as a result of shipping, will require you to file a claim with the carrier.

The shipping address of the authorized service center is:

All, Inc.
All, Customer Service (2nd Floor)
142 5th Street
Brooklyn, NY 11222

IN NO EVENT WILL ALL, ITS MANUFACTURERS, DISTRIBUTORS OR PLR PHISONS BE LIABLE FOR INCIDENTAL, SPECIAL, PUNITIVE OR CONSEQUENTIAL DAMAGES SUCH AS, BUT NOT LIMITED TO, LOSS OF PROFITS, BUSINESS, SAVINGS, DATA OR RECORDS RELATED TO THE PRODUCT, EXCEPT AS STATED HEREIN. NO OTHER WARRANTIES SHALL APPLY.

Should you have any questions or problems concerning this product, please contact our customer service department at:

Customer Support:
Phone: 1-877-766-8481
Monday-Friday 9AM-5PM (EST)

www.southernite.com
Click on "Product Support"

Polaroid, Polaroid & Pave, Polaroid Color Spectrum and Polaroid Classic Border Logo are trademarks of P. P. Holdings, LLC, used under license. All other trademarks are the property of the respective owner, who has not been reviewed, endorsed or approved by this product. P. P. Holdings, LLC does not manufacture this product or provide any Manufacturer's Warranty or support.
© 2013 All Rights Reserved

