



1006 series

Specifications

- UL 10C, 3 hour fire-rated (fail secure only)
- ANSI A250.13-2003 windstorm listed
- UL 1034, burglary-resistant listed
- ANSI/BHMA 156.31, Grade 1
- NFPA-252 fire door conformant
- ASTM-E152 fire door conformant
- MEA New York City accepted
- Florida Building Code approved
- Patented design

Frame application

- Steel
- Aluminum
- Wood

Electrical (continuous duty)

- .45 Amps @ 12VDC
- .25 Amps @ 24VDC

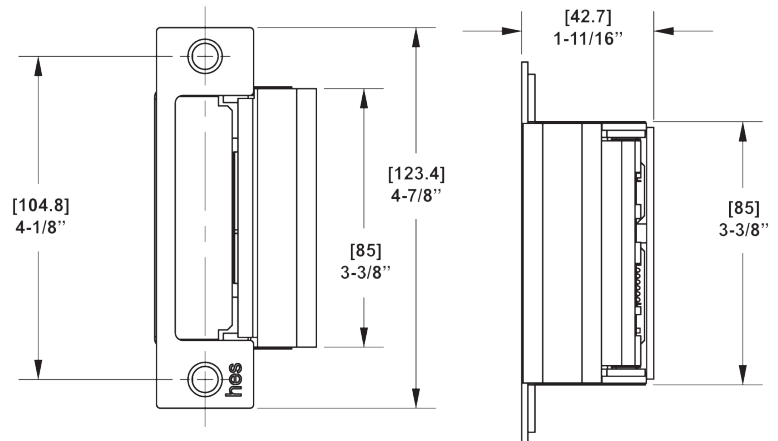
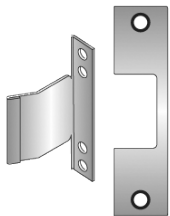

diagram shown with N option

Stocking Part #'s

- 1006-12/24VDC-630
- 1006-12/24VDC-BLK
- 1006-F-12/24VDC-630 (Fail Safe)



4-7/8" x 1-1/4"

E For use with:
Corbin/Ruswin Security Bolt,
Weiserbolt, and
normally extended 1" tubular
deadbolts.
ANSI/BHMA Numbers: #E09391,
#E09392, #E09393

Stocking Part #'s

- E-OPTION-630



4-7/8" x 1-1/4"

J For use with:
Cylindrical locksets up to 3/4"
throw and all locksets with
center-lined bolts. ANSI/BHMA
Numbers: #E09321, #E09322,
#E09323

Stocking Part #'s

- J-OPTION-630

K For use with:

Mortise locksets with a deadlatch positioned above
the latchbolt.

Compatible Locksets:

Baldwin, Marks, PDQ, Others

ANSI/BHMA Numbers: #E09321, #E09322, #E09323

KM For use with:

Mortise locksets with a
deadlatch positioned below the latchbolt.

Compatible Locksets:

Accurate, Arrow, Best*, Corbin/Ruswin, Falcon
(1992 M Series), Sargent (7800, 8200 & 9200 se-
ries), Yale (8800)

*For Best 45H & 47H deadlatch below, and Best 34H
- 37H deadlatch above.

ANSI/BHMA Numbers: #E09321, #E09322, #E09323

KD For use with:

Mortise locksets with a deadlatch positioned above
the latchbolt.

Compatible Locksets:

Jackson, Sargent (7700 & 8100), Schlage, Yale (8700)

ANSI/BHMA Numbers: #E09321, #E09322, #E09323



4-7/8" x 1-1/4"

Stocking Part #'s

- K-OPTION-630
- KD-OPTION-630
- KM-OPTION-630



5000 and 5200 series

Standard Features

- Tamper resistant
- Static strength 1,500 lbs.
- Dynamic strength 70 ft-lbs.
- Endurance rating 500,000 cycles
- Field selectable fail secure/ fail safe
- Dual voltage 12 or 24 VAC/VDC
- In-frame horizontal adjustment
- Non-handed
- Internally mounted solenoid
- Accommodates 5/8" - 3/4" latchbolt (with 1/8" door gap)
- Strike body depth 1-3/16"
- Plug-in connector
- Trim enhancer included
- Five year warranty



Specifications

- UL 1034, burglary-resistant listed
- ANSI/BHMA 156.31, Grade 1
- MEA New York City accepted
- Patented design

Frame application

- Steel
- Aluminum
- Wood

Electrical

- .24 Amp @ 12VDC
- .12 Amp @ 24VDC
- DC continuous duty/AC intermittent duty

The 5000 series is a compact, high performance electric strike designed for low profile openings where there is limited space behind the jamb. This includes narrow style aluminum jambs and jambs with protruding glass inside. The field selectable fail secure/fail safe unit is easy to install and accommodates 5/8" latchbolts.

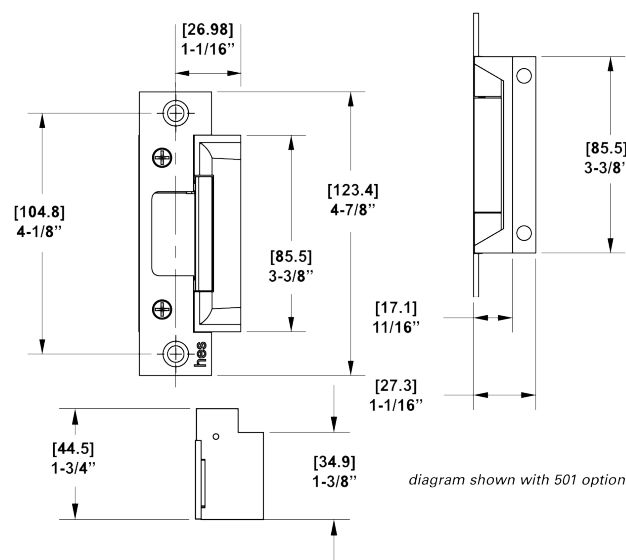

Stocking Part #'s

- 5000-12/24VDC

Designed with the installer in mind, the 5200 series raises the standard in adaptability for electric strikes. Offering features such as an all new innovative approach to in-frame horizontal adjustability, the electric strike is the perfect fit for multiple applications. The field selectable fail secure/fail safe unit is easy to install and accommodates 3/4" latchbolts.

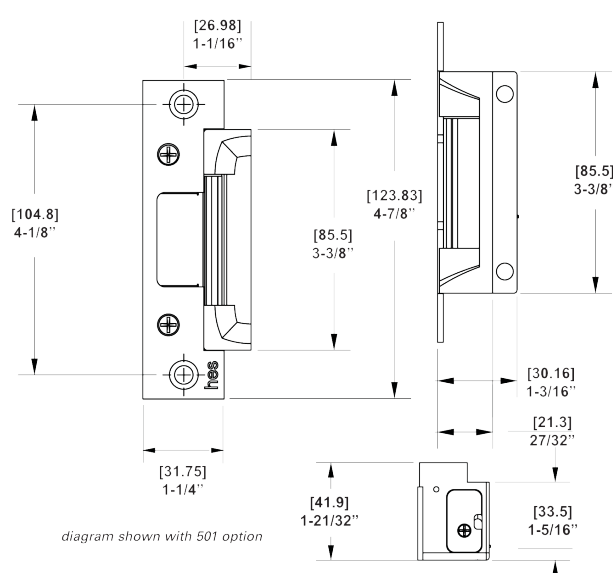

Stocking Part #'s

- 5200-12/24VDC

5000 and 5200 series FacePlates

501 For use with:
Cylindrical locksets in
ANSI metal jambs.

Stocking Part #'s

- 501-OPTION-613
- 501-OPTION-630



4-7/8" x 1-1/4"

501B For use with:
Cylindrical locksets. Includes
universal mounting tabs. Aluminum
doors and frames with
radius front.

Stocking Part #'s

- 501B-OPTION-628



4-7/8" x 1-1/4"

radius corners
& radius faceplate

502 For use with:
Cylindrical locksets.
Includes universal mount-
ing tabs. Aluminum
frames.

Stocking Part #'s

- 502-OPTION-630



7-15/16" x 1-7/16"

503 For use with:
Cylindrical locksets. In-
cludes universal mount-
ing tabs.

Stocking Part #'s

- 503-OPTION-630



6-7/8" x 1-1/4"

radius corners
& flat faceplate

5900 series - Concealed Frame application

- Steel
- Aluminum
- Wood

Electrical

- .24 Amps @12VDC
- .12 Amps @ 24VDC
- DC Continuous Duty
- AC Intermittent Duty

Stocking Part #'s

- 5900-12/24VDC
- 591-OPTION-630 (4-7/8" x 1-1/4" square corner)



Standard Features

- Concealed
- No cutting on frame required
- Vertical adjustability to accommodate door sag
- Tamper resistant
- Field selectable fail safe/fail secure
- Dual voltage 12 or 24 VAC/VDC
- Non-handed
- Internally mounted solenoid
- Accommodates 1/2-5/8" latchbolts (with 1/8" door gap)
- Strike body depth 1-1/16"
- Plug-in connector
- Five year warranty

7000 series



The 7000 series has a modular design to accommodate both cylindrical and rim exit locksets. The 7000 series will accommodate various types of latchbolts from 5/8" to 3/4" throw. The unique design of the keeper module allows the unit to operate under excessive door loading. The 7000 series has an internally mounted solenoid for ease of installation in metal, aluminum and wood jambs. The heavy-duty construction of the 7000 series electric strikes makes them ideal for high usage applications.

Specifications

- UL 1034, burglary-resistant listed
- ANSI/BHMA 156.31, Grade 2
- MEA New York City accepted
- Patented design

Frame application

- Steel
- Aluminum
- Wood

Electrical (continuous duty)

- .45 Amp @ 12VDC
- .25 Amp @ 24VDC

Standard Features

- Stainless steel construction
- Tamper resistant
- Static strength 1,000 lbs.
- Dynamic strength 50 ft-lbs.
- Endurance 500,000 cycles
- Field selectable fail secure/fail safe
- Accommodates up to 30 lbs. pre-load
- Horizontal adjustment (783S, 786S and 789S options)
- Non-handed
- Internally mounted solenoid
- Strike body depth 1-11/16"
- Plug-in connector
- Trim enhancer (701 and 702 options)
- Pocket adapter (789S option)
- Three year limited warranty

Stocking Part #'s

- 7000-12VDC
- 7000-24VDC

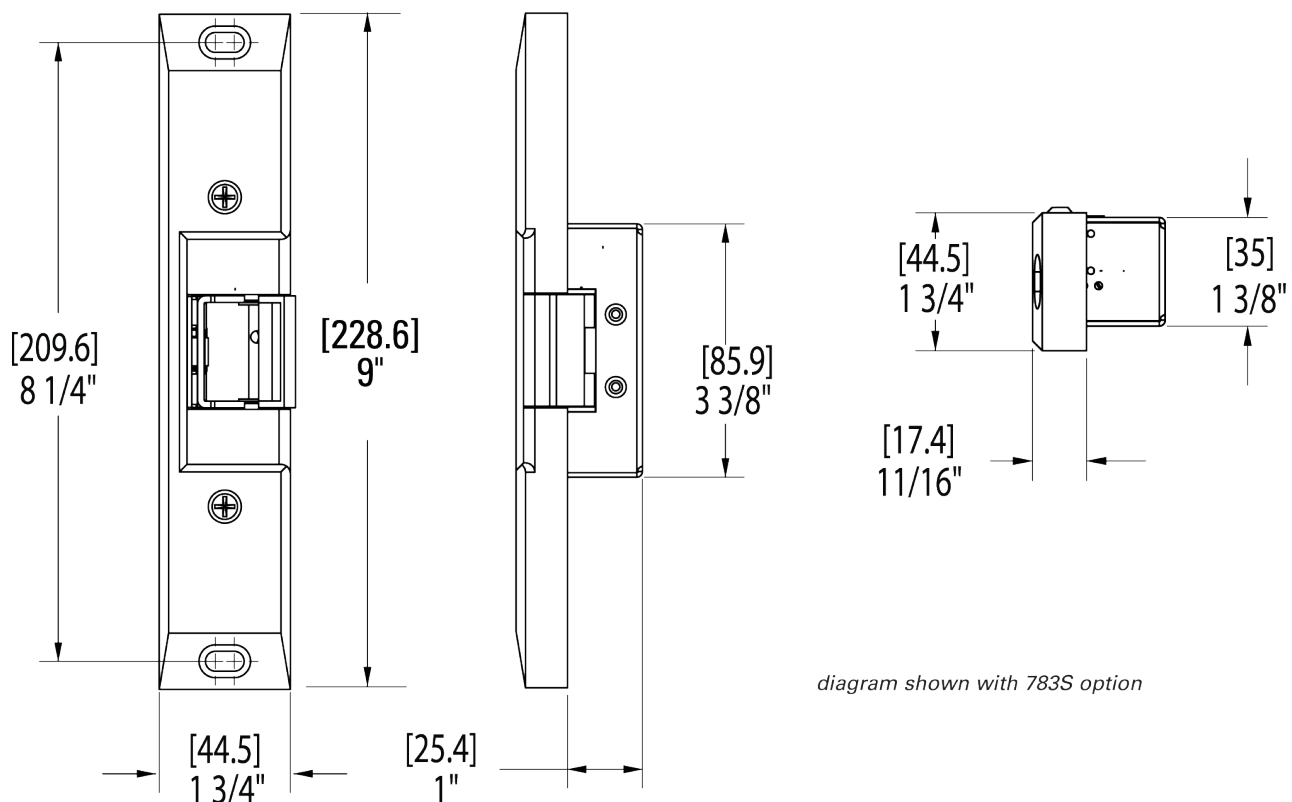

7000 series Faceplates



701 For use with:
Cylindrical locksets up to 5/8"
throw.
ANSI/BHMA Numbers: #E09322,
#E09323

Stocking Part #'s

- 701-OPTION-630

4-7/8" 1-1/4"



702 For use with:
Cylindrical locksets up to 5/8"
throw.
ANSI/BHMA Numbers: #E09322,
#E09323

Stocking Part #'s

- 702-OPTION-630

7-15/16" x 1-7/16"



783S For use with:
Rim exit devices in metal jambs with up to a 3/4" pullman latch. Compatible Locksets:
American Device, Arrow, Doramatic, Monarch, Precision, Sargent, Von Duprin, Yale
ANSI/BHMA Numbers: #E09312, #E09313

Stocking Part #'s

- 783S-OPTION-630

9" x 1-3/4" x 11/16"

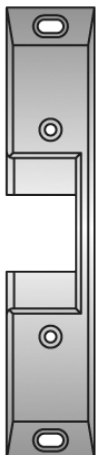

789S For use with:
Rim exit devices in aluminum jambs with up to a 3/4" pullman latch. Includes keeper
pocket adapter.
Compatible Locksets:
American Device, Arrow, Doramatic, Jackson, Monarch, Precision, Sargent, Von
Duprin, Yale
ANSI/BHMA Numbers: #E09312, #E09313

Stocking Part #'s

- 789S-OPTION-630

9" x 1-3/4" x 11/16"



9400 series



The HES 9400 electric strike is completely surface-mounted with a unique 1/2" slim-line form that is ideal for 1/2" throw rim exit devices in steel, aluminum or wood frames. The product is UL 1034 listed and exceeds ANSI/BHMA Grade 1 standards. Designed with a smooth new profile, the 9400 series features a cover that conceals the mounting screws and offers a sleek surface for superior looks and added strength.

Specifications

- UL1034 burglary-resistant rated
- ANSI/BHMA, A156.31 Grade 1 (#E09371, #E09372, #E09373)
- Patent # 6,390,520 & patent pending

Frame application

- Metal
- Wood

Electrical

- .45Amps@12VDC continuous duty
- .25Amps@24VDC continuous duty

Standard Features

- Completely surface mounted
- Decorative cover for sleek new look
- Stainless steel construction
- Tamper resistant
- Static strength 1,500 lbs.
- Dynamic strength 70 ft-lbs.
- Endurance 500,000 cycles
- Field selectable fail safe/fail secure
- Dual voltage 12 or 24 VDC
- Horizontal adjustment
- Non-handed
- Internally mounted solenoid
- Accommodates up to 1/2" pullman latch
- Five year limited warranty

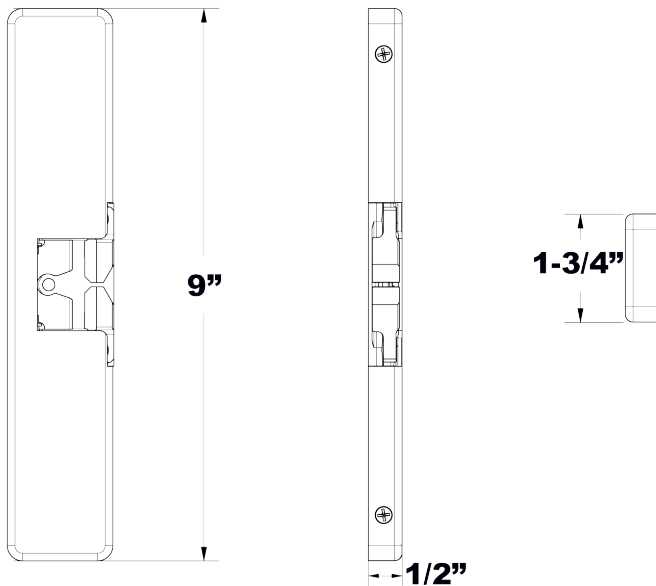

Stocking Part #'s

- 9400-12/24VAC/DC-630

9500 series Fire Rated



The 9500 series Genesis™ is completely surface mounted, featuring all components completely encased within its 3/4" thick stainless steel housing—requiring no cuts to the jamb. Designed for use with 3/4" exit devices, the Genesis series is field selectable to either fail secure or fail safe operation and can be operated with either 12 or 24 Volts DC. The 9500 Genesis™ is the perfect solution for fire-rated rim exit applications.

Stocking Part #'s

- 9500-12/24VDC-630

Specifications

- UL 10C fire-rated, 1-1/2 hr (fail secure only)
- CAN4-S104 (ULC-S104) fire door conformant
- WHI fire door listed
- UL1034 burglary-resistant listed
- ANSI/BHMA 156.31, Grade 1 (#E09371, #E09372)
- NFPA-252 fire door conformant
- ASTM-E152 fire door conformant
- California fire marshal listed
- UBC-7-2-94, Uniform Building Code
- Patented design

Frame application

- Steel
- Wood

Electrical (continuous duty)

- .45 Amps @ 12VDC
- .25 Amps @ 24VDC

Standard Features

- Completely surface mounted
- Stainless steel construction
- Tamper resistant
- Static strength 1,500 lbs.
- Dynamic strength 70 ft-lbs.
- Endurance 500,000 cycles
- Field selectable fail safe/fail secure
- Dual voltage 12 or 24 VDC
- Horizontal adjustment
- Non-handed
- Internally mounted solenoid
- Accommodates up to 3/4" pullman latch
- Five year limited warranty

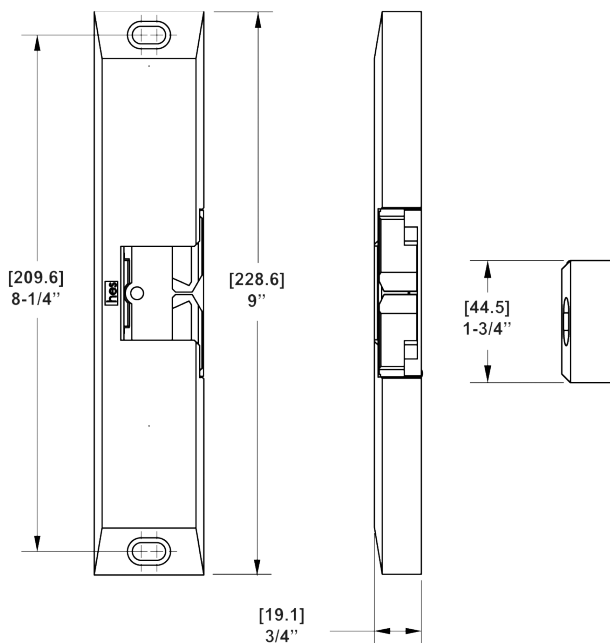



9600 series



Completely surface mounted, the 9600 series Genesis™ is the first of its kind. The 9600 accommodates rim exit devices in metal or wood jams. The 9600 features an internally mounted solenoid and two stainless steel, independently-operating locking mechanisms. The 9600 is easy to install, with all components of the 9600 encased in the 3/4" thick stainless steel housing, requiring no cuts to the jamb prior to installation.

Specifications

- UL1034 burglary-resistant rated
- ANSI/BHMA, 156.31 Grade 1 (#E09731, #E09732)
- Patented design

Frame application

- Steel
- Aluminum*
- Wood

Electrical (continuous duty)

- .45 Amps @ 12VDC
- .25 Amps @ 24VDC

Standard Features

- Completely surface mounted
- Stainless steel construction
- Tamper resistant
- Static strength 1,500 lbs.
- Dynamic strength 70 ft-lbs.
- Endurance 500,000 cycles
- Field selectable fail safe/fail secure
- Dual voltage 12 or 24 VDC
- Horizontal adjustment
- Non-handed
- Internally mounted solenoid
- Accommodates up to 3/4" pullman latch
- Five year limited warranty

Stocking Part #'s

- 9600-12/24VAC/DC-630

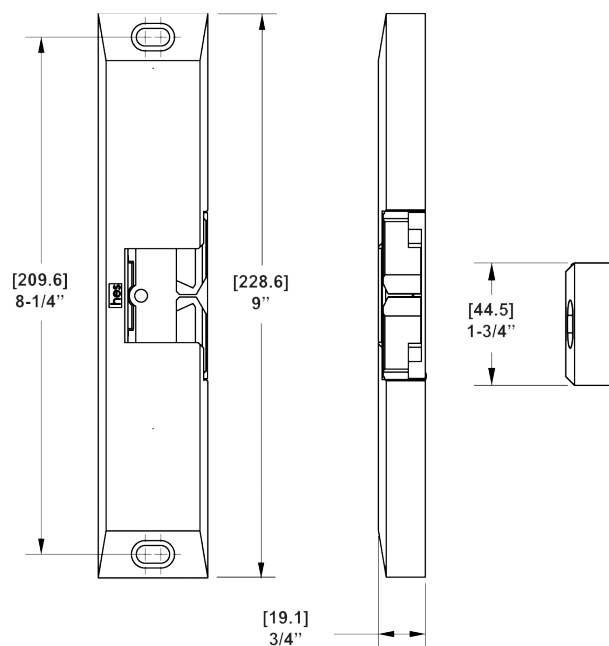



4500 series

The 4500 series is the first electric strike designed for installation in 2" UL 10C fire-rated frames with 1/2" drywall penetration. Based on the design of the popular 5000 series, the 4500 electric strike features a low profile 1-3/8" depth, heavy-duty cast stainless steel construction and horizontal adjustment for simple installation. Its strength is derived from a unique keeper pin locking design, enabling the 4500 to exceed the ratings of the frame, door and locking hardware. Designed for use with cylindrical and mortise locksets up to a 3/4" throw.



Specifications

- UL 10C fire rated, 3 hour (fail secure only)
- CAN4-S104 (ULC-S104) fire door conformant
- WHI fire door listed
- UL 1034 burglary-resistant listed
- ANSI/BHMA 156.31, Grade 1 (#E09321, #E09322, #E09323)
- NFPA-252 fire door conformant
- ASTM-E152 fire door conformant
- California Fire Marshall Listed
- UBC-7-2-94, Uniform Building Code
- Patented design

Frame application

- Steel
- Aluminum
- Wood

Electrical

- .24 Amps @ 12VDC
- .12 Amps @ 24VDC
- DC continuous duty/AC intermittent duty

NOTE: Relocation of the strike prep may be required for Schlage L Series and Yale 8700 mortise locks. Best 40 Series requires a minimum 1/4" door gap.

Stocking Part #'s

- 4500-12/24VAC/DC-630

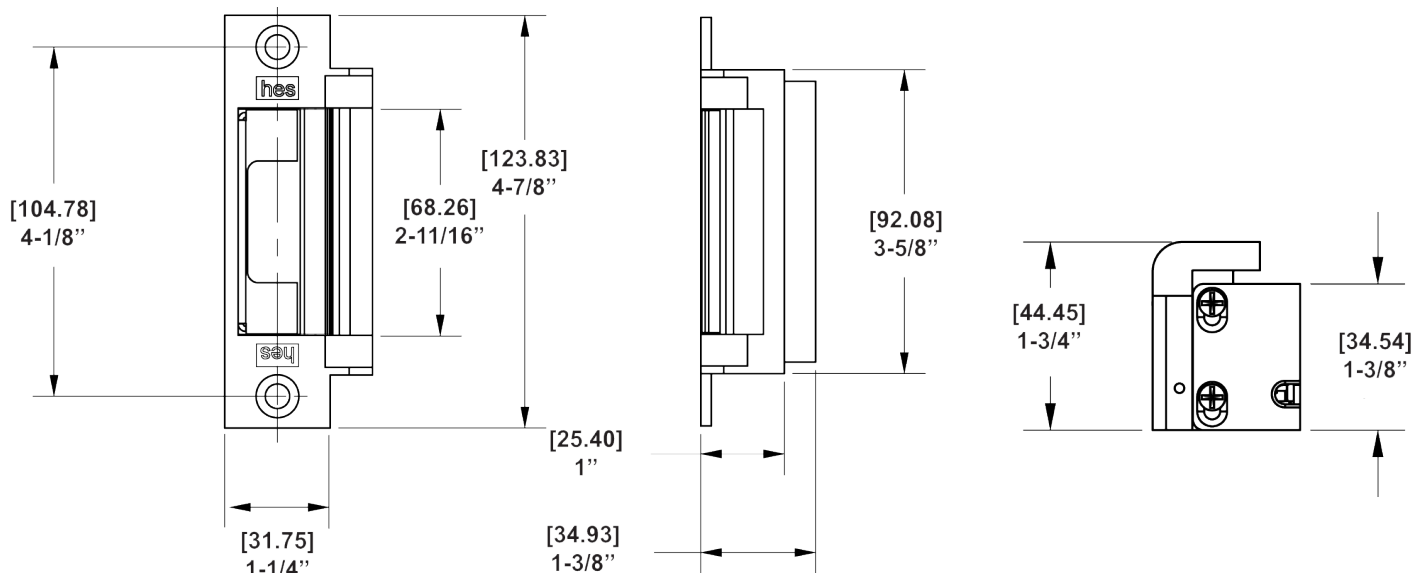



7500 series

The 7500 series electric strike is ideal for fire-rated applications with pre-load conditions which may be caused by a warped or misaligned door, weather stripping, a smoke seal or any other condition that could cause door bind. The solenoid is internally mounted for compactness, making the 7500 series electric strikes easy to install in hollow metal, concrete filled metal, wood and aluminum jambs.



Specifications

- UL 10C, 3 hour fire-rated (fail secure only)
- UL 1034, burglary-resistant listed
- ANSI/BHMA 156.31, Grade 1 (#E09321, #E09322, #E09323)
- NFPA-252 fire door conformant
- ASTM-E152 fire door conformant
- MEA New York City accepted
- UBC-7-2-94, Uniform Building Code
- Patented design

Frame application

- Steel
- Aluminum
- Wood

Electrical (continuous duty)

- .45 Amps @ 12VDC
- .25 Amps @ 24VDC

Stocking Part #'s

- 7501-12VDC-630

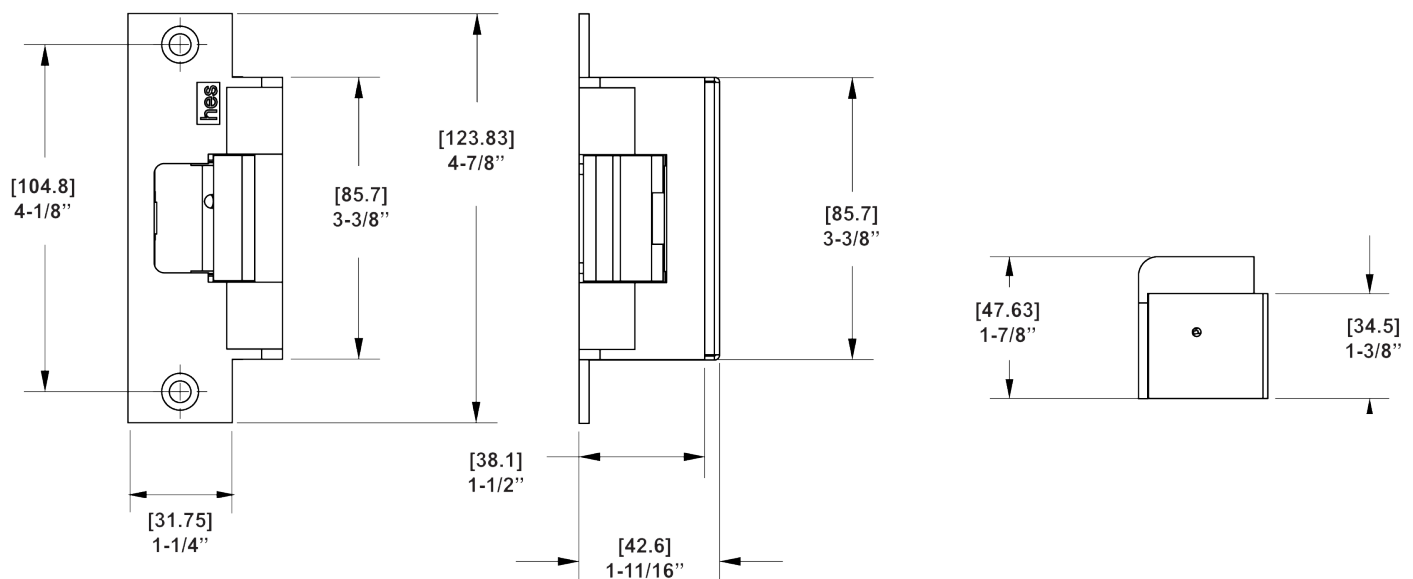



8300 series

The best choice for retrofit into fire-rated frames

Introducing the fire-rated, concealed 8300 series, a compact, high performance product for use with cylindrical locksets. Designed for fast, easy installation, the 8300 fits into a standard 1" ANSI/BHMA A156.115 dustbox, with little or no modification to the frame, and offers vertical adjustability to accommodate door sag and misalignment. Best of all, this unique electric strike complies with NFPA 80-07 guidelines for retrofit into fire-rated frames, so you can save money, save time, and save lives!

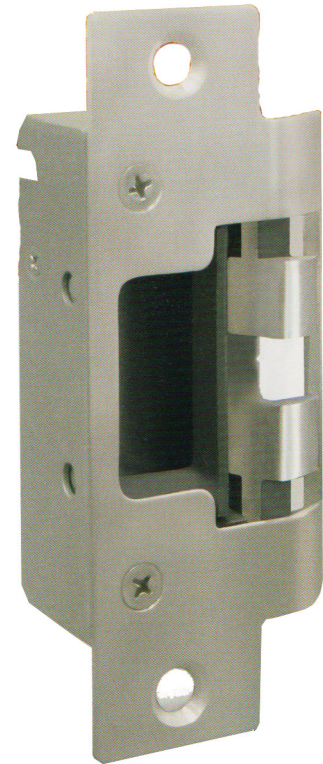

Specifications

- UL 10C, fire-rated, 3 hour (fail secure only)
- CAN4-S104 (ULC-S104) fire door conformant
- NFPA 80-07 compliant
- UL 1034, burglary-resistant listed
- ANSI/BHMA A156.31, Grade 1
- NFPA-252 fire door conformant
- ASTM-E152 fire door conformant
- UBC-7-2-94, uniform building code
- Patent #5,934,720 and patent pending

Stocking Part #'s

- 8300-12/24VDC

Face Plates

- 801-OPTION-630

Frame application

- Metal
- Wood

Electrical

- .24 Amp @ 12VDC/VAC
- .12 Amp @ 24VDC/VAC
- ^a DC continuous duty/AC intermittent duty only

Parts



2003

- MOV Protects against possible inrush and reverse surges



2009P

- Plug-in LED Visible operation indicator



152

- Universal mounting tabs Mount inside hollow metal and aluminum jambs



2001

- Plug-in bridge rectifier Converts AC to DC. 35 V, 1 Amp

2005

- SMART Pac II™

In-line power control able to receive input voltages from 12-32V AC or DC. Built-in bridge rectifier provides 12 or 24VDC output. Under continuous duty the output VDC is reduced by 25% to extend the life of the electric strike. Includes in-line fuse, MOV, and 2-8 second adjustable timer



2006P

- Plug-in buzzer Audible operation indicator