

Installation

Logitech® Cordless Mini Optical Mouse Cordless Mini Optical Mouse

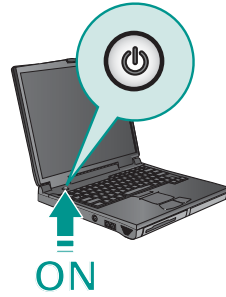

1



English Turn **ON** computer.
Español **ACTIVE** el ordenador.

Français Mettez l'ordinateur **sous tension**.
Português **Ligue** o computador.

2

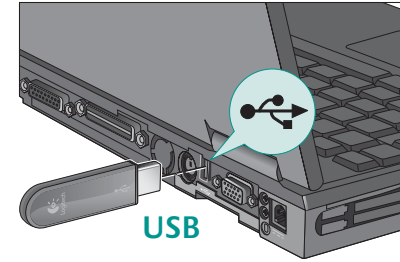

English Plug receiver into computer's USB port.
Español Conecte el receptor al puerto USB del ordenador.

Français Branchez le récepteur sur le port USB de l'ordinateur.
Português Ligue o receptor à porta USB do computador.

3

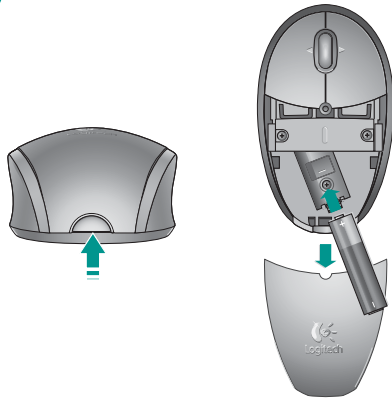

English Press button to open battery door, remove door, and install battery.

Français Press button to open battery door, remove door, and install battery.

Español Press button to open battery door, remove door, and install battery.

Português Press button to open battery door, remove door, and install battery.

4



English To enjoy all the features of your product, download software at <http://www.logitech.com>. Click Downloads, click Mice, and click on the picture of the Cordless Mini Optical Mouse.

Français To enjoy all the features of your product, download software at <http://www.logitech.com>. Click Downloads, click Mice, and click on the picture of the Cordless Mini Optical Mouse.

Español To enjoy all the features of your product, download software at <http://www.logitech.com>. Click Downloads, click Mice, and click on the picture of the Cordless Mini Optical Mouse.

Português To enjoy all the features of your product, download software at <http://www.logitech.com>. Click Downloads, click Mice, and click on the picture of the Cordless Mini Optical Mouse.

i

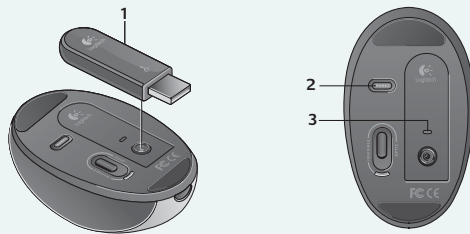

English 1) Attach receiver to mouse for convenient storage when traveling. Mouse turns off. Remove receiver to turn mouse on. 2) Reset button. 3) Power LED. When receiver is detached from base, mouse is turned on and the LED turns green.

Español 1) Attach receiver to mouse for convenient storage when traveling. Mouse turns off. Remove receiver to turn mouse on. 2) Reset button. 3) Power LED. When receiver is detached from base, mouse is turned on and the LED turns green.

Français 1) Attach receiver to mouse for convenient storage when traveling. Mouse turns off. Remove receiver to turn mouse on. 2) Reset button. 3) Power LED. When receiver is detached from base, mouse is turned on and the LED turns green.

Português 1) Attach receiver to mouse for convenient storage when traveling. Mouse turns off. Remove receiver to turn mouse on. 2) Reset button. 3) Power LED. When receiver is detached from base, mouse is turned on and the LED turns green.

i

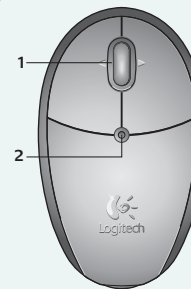

English 1) Tilt wheel plus zoom. Enables scrolling up, down, left, and right. Click and roll the wheel to zoom in and out. Install the software to activate side-to-side scrolling and zoom. 2) Battery LED. Turns green briefly when mouse is turned on. Flashes red when mouse batteries are low.

Español 1) Tilt wheel plus zoom. Enables scrolling up, down, left, and right. Click and roll the wheel to zoom in and out. Install the software to activate side-to-side scrolling and zoom. 2) Battery LED. Turns green briefly when mouse is turned on. Flashes red when mouse batteries are low.

Français 1) Tilt wheel plus zoom. Enables scrolling up, down, left, and right. Click and roll the wheel to zoom in and out. Install the software to activate side-to-side scrolling and zoom. 2) Battery LED. Turns green briefly when mouse is turned on. Flashes red when mouse batteries are low.

Português 1) Tilt wheel plus zoom. Enables scrolling up, down, left, and right. Click and roll the wheel to zoom in and out. Install the software to activate side-to-side scrolling and zoom. 2) Battery LED. Turns green briefly when mouse is turned on. Flashes red when mouse batteries are low.



English Mouse Not Working. 1) Receiver must be plugged into USB port; computer must be on. Try receiver in different USB port. 2) Check battery installation. Replace batteries if Battery LED flashes red. 3) Press Reset button on bottom of mouse. 4) If none of the above has worked, use the Logitech Device Reconnection Utility. **Windows:** Access the utility via Start\Programs\Logitech(Mouse and Keyboard) Reconnection Utility. (If you don't have a touchpad, press the Start Menu key to open the Start menu, and use the Left/Right, Up/Down arrow keys to navigate.) **Macintosh:** Download the utility at www.logitech.com/v200mac. Follow the on-screen instructions, and click OK after the mouse is active.

Español Mouse Not Working. 1) Receiver must be plugged into USB port; computer must be on. Try receiver in different USB port. 2) Check battery installation. Replace batteries if Battery LED flashes red. 3) Press Reset button on bottom of mouse. 4) If none of the above has worked, use the Logitech Device Reconnection Utility. **Windows:** Access the utility via Start\Programs\Logitech(Mouse and Keyboard) Reconnection Utility. (If you don't have a touchpad, press the Start Menu key to open the Start menu, and use the Left/Right, Up/Down arrow keys to navigate.) **Macintosh:** Download the utility at www.logitech.com/v200mac. Follow the on-screen instructions, and click OK after the mouse is active.

Français Mouse Not Working. 1) Receiver must be plugged into USB port; computer must be on. Try receiver in different USB port. 2) Check battery installation. Replace batteries if Battery LED flashes red. 3) Press Reset button on bottom of mouse. 4) If none of the above has worked, use the Logitech Device Reconnection Utility. **Windows:** Access the utility via Start\Programs\Logitech(Mouse and Keyboard) Reconnection Utility. (If you don't have a touchpad, press the Start Menu key to open the Start menu, and use the Left/Right, Up/Down arrow keys to navigate.) **Macintosh:** Download the utility at www.logitech.com/v200mac. Follow the on-screen instructions, and click OK after the mouse is active.

Português Mouse Not Working. 1) Receiver must be plugged into USB port; computer must be on. Try receiver in different USB port. 2) Check battery installation. Replace batteries if Battery LED flashes red. 3) Press Reset button on bottom of mouse. 4) If none of the above has worked, use the Logitech Device Reconnection Utility. **Windows:** Access the utility via Start\Programs\Logitech(Mouse and Keyboard) Reconnection Utility. (If you don't have a touchpad, press the Start Menu key to open the Start menu, and use the Left/Right, Up/Down arrow keys to navigate.) **Macintosh:** Download the utility at www.logitech.com/v200mac. Follow the on-screen instructions, and click OK after the mouse is active.

English Important Ergonomics Information. Read Comfort Guidelines in the Important Information document, and at <http://www.logitech.com>. **International Standards and Safety.** This optical device complies with International Standard IEC 825-1:1993. **Class 1 LED Product. CAUTION:** Use of controls or adjustments or performance of procedures other than those specified herein may result in hazardous radiation exposure. This optical device has no serviceable parts. User observable light is 15 microwatts in normal operation. This device is rated as a commercial product for operation at 32° F (0° C) to 104° F (40° C).

Warning! Read the battery warning in the Important Information document.

Battery Life Disclaimers. Battery life may vary depending on usage. To maximize battery life, snap the receiver onto the base to turn the mouse off when not in use.

Warranty and FCC. Your product comes with a 3-year limited warranty, is UL tested, and is FCC and CE compliant. For more information, refer to the Important Information document. For CE compliance, go to <http://www.logitech.com>.

Español Important Ergonomics Information. Read Comfort Guidelines in the Important Information document and at <http://www.logitech.com>. **International Standards and Safety.** This optical device complies with International Standard IEC 825-1:1993. **Class 1 LED Product. CAUTION:** Use of controls or adjustments or performance of procedures other than those specified herein may result in hazardous radiation exposure. This optical device has no serviceable parts. User observable light is 15 microwatts in normal operation. This device is rated as a commercial product for operation at 32° F (0° C) to 104° F (40° C).

Warning! Read the battery warning in the Important Information document.

Battery Life Disclaimers. Battery life may vary depending on usage. To maximize battery life, snap the receiver onto the base to turn the mouse off when not in use.

Warranty and FCC. Your product comes with a 3-year limited warranty, is UL tested, and is FCC and CE compliant. For more information, refer to the Important Information document. For CE compliance, go to <http://www.logitech.com>.

Français Important Ergonomics Information. Read Comfort Guidelines in the Important Information document, and at <http://www.logitech.com>. **International Standards and Safety.** This optical device complies with International Standard IEC 825-1:1993. **Class 1 LED Product. CAUTION:** Use of controls or adjustments or performance of procedures other than those specified herein may result in hazardous radiation exposure. This optical device has no serviceable parts. User observable light is 15 microwatts in normal operation. This device is rated as a commercial product for operation at 32° F (0° C) to 104° F (40° C).

Warning! Read the battery warning in the Important Information document.

Battery Life Disclaimers. Battery life may vary depending on usage. To maximize battery life, snap the receiver onto the base to turn the mouse off when not in use.

Warranty and FCC. Your product comes with a 3-year limited warranty, is UL tested, and is FCC and CE compliant. For more information, refer to the Important Information document. For CE compliance, go to <http://www.logitech.com>.



www.logitech.com

© 2005 Logitech. All rights reserved. Logitech, the Logitech logo, and other Logitech marks are owned by Logitech and may be registered. All other trademarks are the property of their respective owners. Logitech assumes no responsibility for any errors that may appear in this manual. Information contained herein is subject to change without notice.

© 2005 Logitech. Tous droits réservés. Logitech, le logo Logitech et les autres marques Logitech sont la propriété exclusive de Logitech et sont susceptibles d'être des marques déposées. Toutes les autres marques sont la propriété exclusive de leurs détenteurs respectifs. Logitech décline toute responsabilité en cas d'erreurs dans ce manuel. Les informations énoncées dans le présent document peuvent faire l'objet de modifications sans avis préalable.

623791-0403.A



Hotline Technical Help (Aide Technique)

+1 702 269 3457

www.logitech.com/support

Português Important Ergonomics Information. Read Comfort Guidelines in the Important Information document and at <http://www.logitech.com>. **International Standards and Safety.** This optical device complies with International Standard IEC 825-1:1993. **Class 1 LED Product. CAUTION:** Use of controls or adjustments or performance of procedures other than those specified herein may result in hazardous radiation exposure. This optical device has no serviceable parts. User observable light is 15 microwatts in normal operation. This device is rated as a commercial product for operation at 32° F (0° C) to 104° F (40° C).

Warning! Read the battery warning in the Important Information document.

Battery Life Disclaimers. Battery life may vary depending on usage. To maximize battery life, snap the receiver onto the base to turn the mouse off when not in use.

Warranty and FCC. Your product comes with a 3-year limited warranty, is UL tested, and is FCC and CE compliant. For more information, refer to the Important Information document. For CE compliance, go to <http://www.logitech.com>.

FCC Caution

1. The device complies with Part 15 of the FCC rules. Operation is subject to the following two conditions:
 - (1) This device may not cause harmful interference.
 - (2) This device must accept any interference received, including interference that may cause undesired operation.

2. Changes or modifications to this unit not expressly approved by the party responsible for compliance could void the user authority to operate the equipment.