



# Bluetooth<sup>®</sup> Speaker System Z600

Setup Guide



English . . . . .	2
Deutsch . . . . .	8
Français . . . . .	14
Italiano . . . . .	20
Español . . . . .	26
Português . . . . .	32
Nederlands . . . . .	38
Svenska . . . . .	44
Dansk . . . . .	50
Norsk . . . . .	56
Suomi . . . . .	62

[www.logitech.com/support](http://www.logitech.com/support)

## Your speaker system

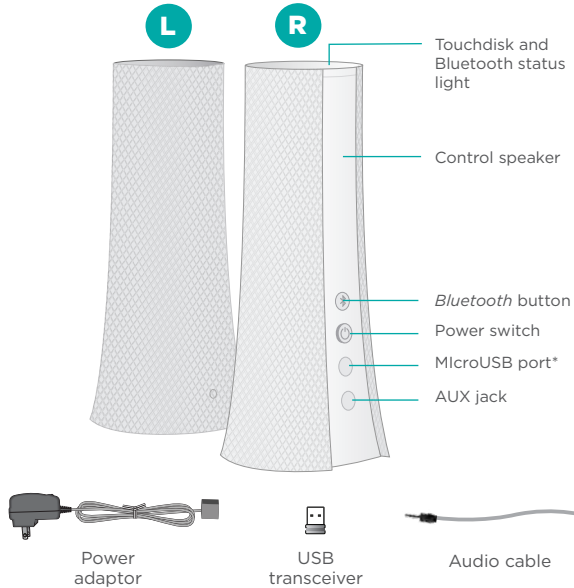

\*For authorized service only

## Attach cables

Connect the speaker wires to the Y-connector and plug the power supply into an outlet.

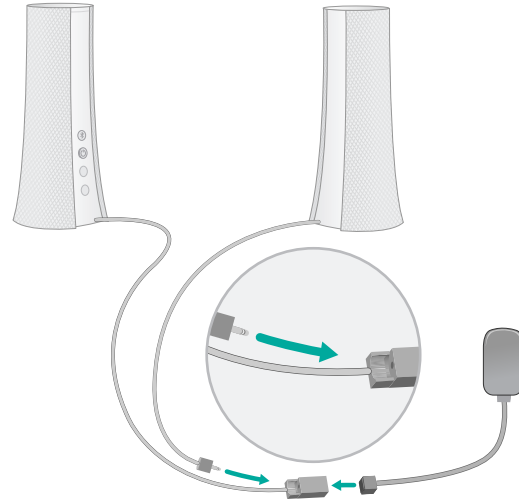

## Wireless choices

To better fit your personal style and audio devices, the speaker system offers a choice of wireless connection options.

### USB transceiver

Use the transceiver to play audio from your laptop.

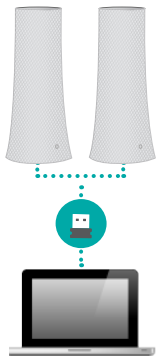

### Bluetooth devices

Use *Bluetooth* wireless technology to play audio from multiple devices or a device lacking USB.



## First-time setup (laptop)

### On the control speaker

Press the power button.

A tone tells you the speakers are powered on and ready for use.

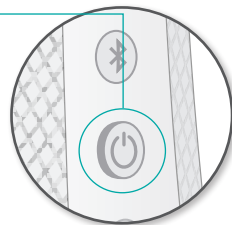

### On your laptop

Plug the USB transceiver into a USB port. Any audio played on the laptop is output on the speakers.

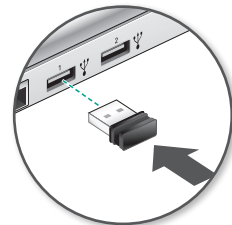

Your laptop automatically becomes the **primary device** with a permanent connection to the speaker system. For more information, see “About the Primary Device.”