

## Using the Keyboard (VGP-WKB11)

A wireless keyboard is supplied with your computer.

The wireless keyboard uses a standard key arrangement with additional keys that perform specific functions.

### Using the Wireless Keyboard

One AA alkaline battery is supplied with your wireless keyboard. Before attempting to use the wireless keyboard, remove the battery compartment cover (1) from the bottom of the wireless keyboard and install the supplied AA battery (2) into the battery compartment.

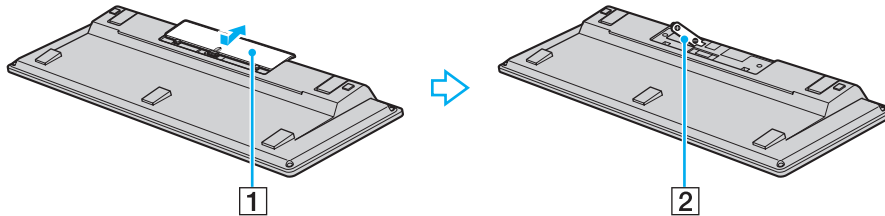

If the wireless keyboard does not operate properly, the battery may need to be replaced. If you do not intend to use the wireless keyboard for an extended period of time, remove the battery to avoid possible damage from battery leakage.

If the wireless keyboard is left unused for 20 minutes or longer, your computer enters Sleep mode. To bring it back into Normal mode, press any key on the wireless keyboard.



To maintain good communication, operate the wireless keyboard within the distance limitations of keyboard: approximately 32.8 feet (10 m) from your computer.

You cannot use the wireless keyboard in conjunction with the HDMI/VIDEO input function ([page 60](#)).

Avoid using any wireless devices that exchange radio signals on the 2.4 GHz band near your wireless keyboard. These devices may create radio interference, causing the keyboard to stop working properly.

Do not place metal furniture or objects near your computer or wireless keyboard, as this may create radio interference, causing the keyboard to stop working properly.

Be sure to use an alkaline battery. Using an incompatible battery can damage the wireless keyboard.

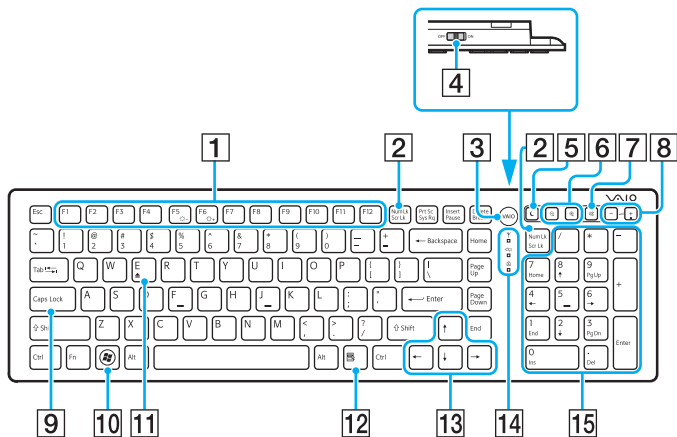

Illustrated above is the English keyboard as an example.

**1** Function keys

Perform certain tasks. The task associated with each function key varies among software applications except the following combinations with the **Fn** key to change the LCD brightness of your computer screen.

**Fn+F5**: Decrease lighting intensity of the LCD screen.

**Fn+F6**: Increase lighting intensity of the LCD screen.



While using the HDMI/VIDEO input function, you cannot use the function keys on the wireless keyboard to change the LCD brightness. To change the brightness while using the HDMI/VIDEO input function, see **Using the HDMI/VIDEO Input Control Buttons (page 62)** for the procedure.

**2** Num Lk/Scr Lk key

Activates/deactivates Num Lk mode. To activate/deactivate Scr Lk mode, use this key in conjunction with the **Fn** key.

When Num Lk or Scr Lk mode is activated or deactivated, the



(Num lock) or



(Scroll lock) icon appears on the taskbar along with a pop-up message to indicate a mode change.



You can keep the Num lock and/or Scroll lock icon on the taskbar. To do so, right-click the  $\Delta$  icon on the taskbar, click **Customize notification icons**, and then select **Show icon and notifications** for your desired icon.

**3** VAIO button

Launches the **Media Gallery**.

**4** Power switch

Slide the switch to turn the wireless keyboard on and off.

**5** Sleep button

Provides a lower level of power consumption.

For details on power management, see **Using the Power Saving Mode (page 27)**.

**6** Zoom buttons

Change the size of an image or a document displayed on some software.

Press  to make the view look smaller and further away (zoom out).

Press  to make the view look bigger and closer (zoom in).

See the help file included with the **VAIO Control Center** for more information.

**7** Muting button\*

Turns the volume on and off.

**8** Volume control buttons\*

Increase (+) or decrease (-) the volume.

**9** **Caps Lock** key

Activates/deactivates Caps Lock mode where letters are all typed in upper case.

**10** Windows key

Displays the **Start** menu.

**11** **E** key

Ejects the optical disc drive tray when used in conjunction with the **Fn** key.

**12** Applications key

Displays a context-sensitive shortcut menu (if any).

**13** Directional arrow keys

Move the pointer on the computer screen.

**14** Indicator lights

 (Battery): Stays off while the AA battery for the wireless keyboard is sufficient and blinks when the battery is running out of power.

 (Caps lock): Turns on when Caps Lock mode is activated.

 (Connect): Stays off while the wireless keyboard is properly connected with your computer; and blinks for about 10 minutes when the connection is cut off, for example, when the computer is turned off or enters Sleep mode.

**15** Numeric keypad

Use the numeric keypad to type numbers or to perform basic math calculations.

\* Disabled while you are using the HDMI/VIDEO input function.

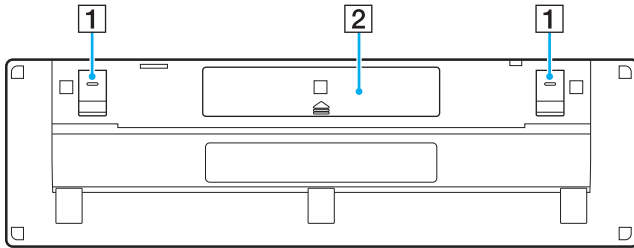

- 1** Keyboard feet  
Flip open to put the wireless keyboard in a more 'ergonomic' position.
- 2** Battery compartment ([page 32](#))  
Storage compartment for the AA battery.

### **Federal Communication Commission Interference Statement**

This equipment has been tested and found to comply with the limits for a Class B digital device, pursuant to Part 15 of the FCC Rules. These limits are designed to provide reasonable protection against harmful interference in a residential installation. This equipment generates, uses and can radiate radio frequency energy and, if not installed and used in accordance with the instructions, may cause harmful interference to radio communications. However, there is no guarantee that interference will not occur in a particular installation. If this equipment does cause harmful interference to radio or television reception, which can be determined by turning the equipment off and on, the user is encouraged to try to correct the interference by one of the following measures:

- Reorient or relocate the receiving antenna.
- Increase the separation between the equipment and receiver.
- Connect the equipment into an outlet on a circuit different from that to which the receiver is connected.
- Consult the dealer or an experienced radio/TV technician for help.

FCC Caution: Any changes or modifications not expressly approved by the party responsible for compliance could void the user's authority to operate this equipment.

This device complies with Part 15 of the FCC Rules. Operation is subject to the following two conditions: (1) This device may not cause harmful interference, and (2) this device must accept any interference received, including interference that may cause undesired operation.

### **Industry Canada Statement**

This device complies with RSS-210 of the Industry Canada Rules. Operation is subject to the following two conditions:

- 1) this device may not cause interference and
- 2) this device must accept any interference, including interference that may cause undesired operation of the device

台灣使用應注意事項：

經型式認證合格之低功率射頻電機，非經許可，公司、商號或使用者均不得擅自變更頻率、加大功率或變更原設計之特性及功能。

低功率射頻電機之使用不得影響飛航安全及干擾合法通信；經發現有干擾現象時，應立即停用，並改善至無干擾時方得繼續使用。前項合法通信，指依電信法規定作業之無線電通信。低功率射頻電機須忍受合法通信或工業、科學及醫療用電波輻射性電機設備之干擾。

Product Name : 2.4GHz Cordless Keyboard

Model Name : VGP-WKB11

Brand Name : **Sony**

Number of channels	12 channels
Type of Modulation	GFSK
Transmitter or Transceiver	Transceiver
frequency hopping or not frequency hopping	not frequency hopping
Channel switching frequency range	2405MHz to 2474MHz
Carrier frequencies	2405, 2408, 2414, 2417, 2432, 2435,2441, 2444, 2462, 2465, 2471, 2474 MHz
Channel bandwidth	Typical of 2MHz
Modulation	GFSK 2Mbps
Method of frequencies generation	16MHz crystal + PLL LO (TX) = channel frequency + 2MHz LO (RX)= 8/7 x ( TX+2)
Transmitter aggregate Data rate or modulation bit rate	1 Mbps
duty cycle	Transmitter ON : 0.08 ms Transmitter OFF : 7.92 ms Then Duty cycle = ON/(ON+OFF) = 0.08 ms / 8 ms = 1 %
Transmission range	30 foot typical, free space.
Antenna	PCB printed antenna, meander quarter wave
Antenna Gain	Antenna gain : Max gain is -1.17dBi
Effective radiated power:	Power conducted --> 0dBm
Antenna Type	Printed meander line on PCB
Power source:	1 set of AA batteries
Nominal DC voltage	1.5V
operating voltage	1.1~1.6V 40mA
Extreme Temperature range	0 °C to +40 °C