



Getting started with  
Première utilisation  
Logitech® **Ultrathin Keyboard Cover i5**



## Contents

English . . . . .	3	Español . . . . .	19
Français . . . . .	11	Português . . . . .	27
<b>www.logitech.com/support</b>  . . . . .			35

## Know your product

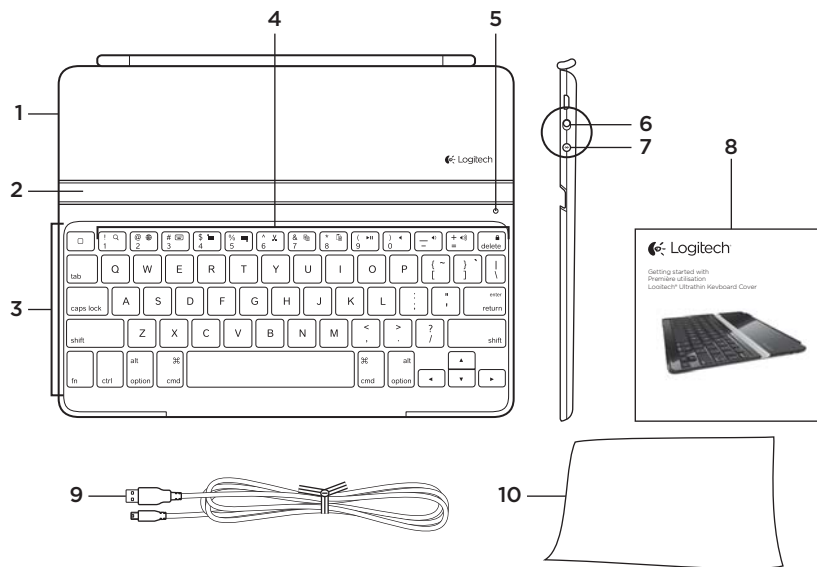

1. Protective cover
2. iPad holder
3. Keyboard
4. Function keys
5. Status light

6. On/Off switch
7. Bluetooth connect button
8. Documentation
9. Micro-USB charging cable
10. Cleaning cloth

---

## Set up your product

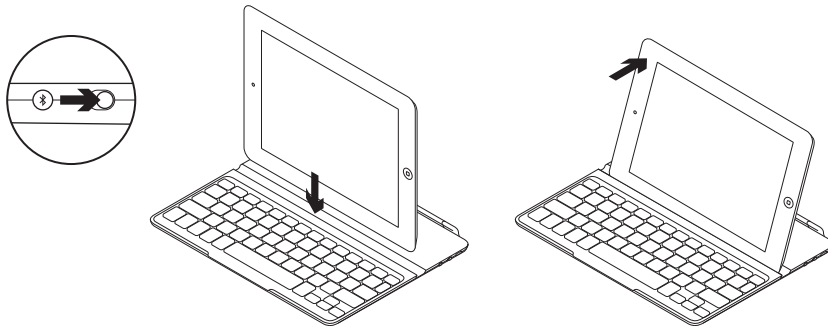

1. Turn on the Keyboard Cover:
  - Bluetooth discovery starts automatically and continues for 15 minutes. The Status light blinks blue.
  - If the Status light briefly turns red, charge the batteries. For more information, see “Charge the batteries.”
2. Make sure your iPad’s Bluetooth feature is on. Select Settings > General > Bluetooth > On.
3. Select “Logitech Ultrathin KB cover” on the iPad’s Devices menu.
4. If your iPad requests a PIN, enter the code using the Keyboard Cover and not your iPad’s virtual keyboard. After the Bluetooth connection is made, the Status light briefly turns blue, and then it turns off.
5. Place the iPad on the Keyboard Cover.

---

## Charge the batteries

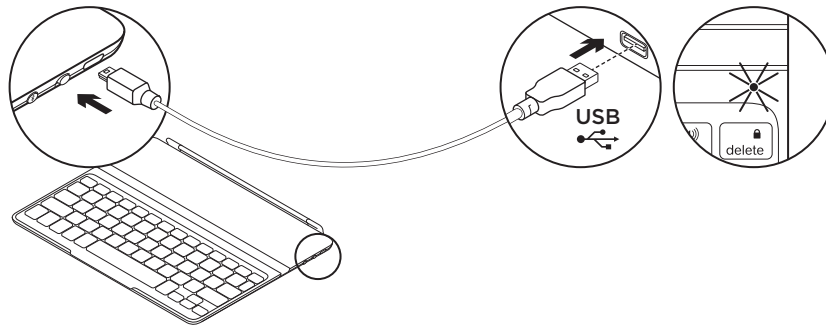

1. Plug the Micro-USB Charging cable into the Keyboard Cover and a USB port on a computer. The Status light blinks green.
2. Charge the batteries until the Status light turns solid green.

### **Battery information:**

- A fully charged battery provides about 6 months of power when the Keyboard Cover is used about two hours a day.
- Charge the batteries when the Status light briefly turns red after the Keyboard Cover turns on.
- When not in use, turn off the Keyboard Cover to conserve battery power.
- The Keyboard Cover enters sleep mode if powered on and not used. Press any key to wake.

---

### Visit Product Central

There's more information and support online for your product. Take a moment to visit Product Central to learn more about your new Keyboard Cover.

Browse online articles for setup help, usage tips, or information about additional features.

Connect with other users in our Community Forums to get advice, ask questions, and share solutions.

At Product Central, you'll find a wide selection of content:

- Tutorials
- Troubleshooting
- Support community
- Software downloads
- Online documentation
- Warranty information
- Spare parts (when available)

Go to [www.logitech.com/support/ultrathinkeyboardcover](http://www.logitech.com/support/ultrathinkeyboardcover)

## Use your product



### Product features

- 1. Home** Displays the iPad Home screen.
- 2. Fn + 1 = Search** Launches the iPad search function.
- 3. Fn + 2 = Switch language** Switches the keyboard language.
- 4. Fn + 3 = Virtual keyboard** Shows/hides the virtual keyboard.
- 5. Fn + 4 = Select left** Selects text on the left, word by word.
- 6. Fn + 5 = Select right** Selects text on the right, word by word.
- 7. Fn + 6 = Cut**
- 8. Fn + 7 = Copy**
- 9. Fn + 8 = Paste**
- 10. Fn + 9 = Play/Pause**
- 11. Fn + 0 = Mute**
- 12. Fn + dash = Volume down**
- 13. Fn + plus = Volume up**
- 14. Fn + delete = Lock screen** Locks or unlocks the iPad screen.

### Status light indications

Light	Description
Blinking green	The battery is charging.
Green	The battery is charged (more than 5%).
Red	Battery power is low (less than 5%). Charge the batteries.
Blinking blue	Fast: Keyboard Case is in discovery mode. Slow: Keyboard Case is trying to reconnect to your Apple device.
Solid blue	Bluetooth pairing is successful.

---

### Storing the iPad for travel

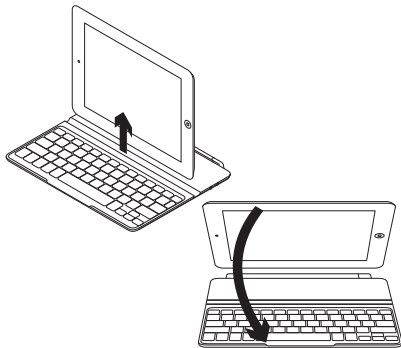

1. Lift the iPad from the Keyboard Cover.
2. Rotate the iPad, with the screen side down, so the Home button is on the right.
3. Place the iPad on to the Keyboard Cover. A magnetic clip holds the iPad in position.

### Connecting to a different iPad

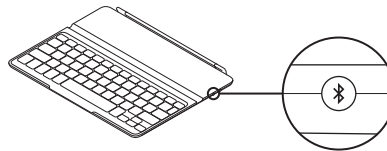

1. Make sure the Keyboard Cover is turned on.
2. Check that your iPad's Bluetooth feature is on. Select Settings > General > Bluetooth > On.
3. Press the Bluetooth Connect Button. The Keyboard Cover is discoverable for 3 min.
4. Select "Logitech Ultrathin KB cover" on the iPad's Devices menu.
5. If your iPad requests a PIN, enter the code using the Keyboard Cover and not your iPad's virtual keyboard. After the Bluetooth connection is made, the Status light briefly turns blue, and then it turns off.
6. Place the new iPad on the Keyboard Cover.



---

## Troubleshooting

### **The Keyboard Cover does not work**

- Press any key to wake the Keyboard Cover from sleep mode.
- Turn the Keyboard Cover Off and than back On.
- Recharge the internal batteries. For more information, refer to “Charge the batteries.”
- Re-establish the Bluetooth connection between the Keyboard Cover and iPad:
- Verify that iPad’s Bluetooth feature is turned on.
- Choose “Logitech Ultrathin KB cover” from the Devices menu on your iPad. The Status light briefly turns blue after the Bluetooth connection is made.

## What do you think?

Please take a minute to tell us.  
Thank you for purchasing our product.

**[www.logitech.com/ithink](http://www.logitech.com/ithink)**

---

### Battery disposal at product end of life

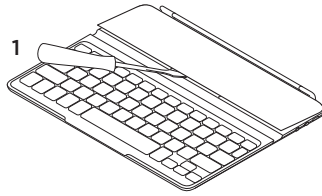

1. Pry off top cover of keyboard with screwdriver.

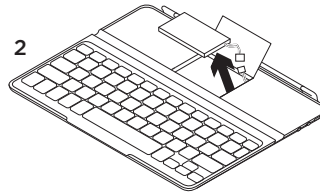

2. Detach battery from circuit board and remove battery.



3. Dispose of your product and its battery according to local laws.