



Logitech[®]

Cordless Presenter[™]
Setup

© 2002 Logitech. All Rights Reserved. Logitech, the Logitech logo, and other Logitech marks are owned by Logitech and may be registered. All other trademarks are the property of their respective owners. Logitech assumes no responsibility for any errors that may appear in this manual. Information contained herein is subject to change without notice.

Part Number: **622978-0403**

Limited Warranty. Logitech warrants that any hardware product accompanying this documentation shall be free from significant defects in material and workmanship for a period of five (5) years from the date of purchase. Logitech's limited warranty is nontransferable and is limited to the original purchaser. This warranty gives you specific legal rights, and you may also have other rights which vary under local laws.

Remedies. Logitech's entire liability and your exclusive remedy for any breach of warranty shall be, at Logitech's option, to: (a) repair or replace the hardware, provided that the hardware is returned to the point of purchase or such other place as Logitech may direct, with a copy of the sales receipt, or (b) refund the price paid. Any replacement hardware will be warranted for the remainder of the original warranty period or thirty (30) days, whichever is longer. These remedies are void if failure of the hardware has resulted from accident, abuse, or misapplication. **DISCLAIMER OF WARRANTY.** THE WARRANTIES EXPRESSLY SET FORTH IN THIS AGREEMENT REPLACE ALL OTHER WARRANTIES.

LOGITECH AND ITS SUPPLIERS EXPRESSLY DISCLAIM ALL OTHER WARRANTIES, INCLUDING, BUT NOT LIMITED TO, THE IMPLIED WARRANTIES OF MERCHANTABILITY AND FITNESS FOR A PARTICULAR PURPOSE AND NON-INFRINGEMENT OF THIRD-PARTY RIGHTS WITH RESPECT TO THE HARDWARE. NO LOGITECH DEALER, AGENT, OR EMPLOYEE IS AUTHORIZED TO MAKE ANY MODIFICATION, EXTENSION, OR ADDITION TO THIS WARRANTY. Some jurisdictions do not allow limitations on how long an implied warranty lasts, so the above limitation may not apply to you.

LIMITATION OF LIABILITY. IN NO EVENT WILL LOGITECH OR ITS SUPPLIERS BE LIABLE FOR ANY COSTS OF PROCUREMENT OF SUBSTITUTE PRODUCTS OR SERVICES, LOST PROFITS, LOSS OF INFORMATION OR DATA, OR ANY OTHER SPECIAL, INDIRECT, CONSEQUENTIAL, OR INCIDENTAL DAMAGES ARISING IN ANY WAY OUT OF THE SALE OF, USE OF, OR INABILITY TO USE ANY LOGITECH PRODUCT OR SERVICE, EVEN IF LOGITECH HAS BEEN ADVISED OF THE POSSIBILITY OF SUCH DAMAGES. IN NO CASE SHALL LOGITECH'S AND ITS SUPPLIERS' TOTAL LIABILITY EXCEED THE ACTUAL MONEY PAID FOR THE LOGITECH PRODUCT OR SERVICE GIVING RISE TO THE LIABILITY. Some jurisdictions do not allow the exclusion or limitation of incidental or consequential damages, so the above limitation or exclusion may not apply to you. The above limitations will not apply in case of personal injury where and to the extent that applicable law requires such liability.

FCC Compliance and Advisory Statement. This hardware device complies with Part 15 of the FCC Rules. Operation is subject to the following two conditions:

1) this device may not cause harmful interference, and 2) this device must accept any interference received, including interference that may cause undesired operation. This equipment has been tested and found to comply with the limits for a Class B digital device, pursuant to Part 15 of the FCC Rules. These limits are designed to provide reasonable protection against harmful interference in a residential installation. This equipment generates, uses, and can radiate radio frequency energy and, if not installed or used in accordance with the instructions, may cause harmful interference to radio communications. However, there is no guarantee that interference will not occur in a particular installation. If this equipment does cause harmful interference to radio or television reception, which can be determined by turning the equipment off and on, the user is encouraged to try to correct the interference by one or more of the following measures: 1) reorient or relocate the receiving antenna; 2) increase the separation between the equipment and the receiver; 3) connect the equipment to an outlet on a circuit different from that to which the receiver is connected; 4) consult the dealer or an experienced radio/TV technician for help. Any changes or modifications not expressly approved by the party responsible for compliance could void the user's authority to operate the equipment. Where shielded interface cables have been provided with the product or specified additional components or accessories elsewhere defined to be used with the installation of the product, they must be used in order to ensure compliance with FCC regulations.

Canadian DOC Statement. This digital device does not exceed the Class B limits for radio noise emissions from digital apparatus specified in the interference-causing equipment standard entitled "Digital Apparatus," ICES-003 of the Department of Communications.

Cet appareil numérique respecte les limites bruits radioélectriques applicables aux appareils numériques de Classe B prescrites dans la norme sur le matériel brouilleur: "Appareils Numériques," NMB-003 édictée par le Ministère des Communications.

This device complies with RSS-210 of Industry and Science Canada. Operation is subject to the following two conditions: 1) this device may not cause interference, and 2) this device must accept any interference, including interference that may cause undesired operation of the device.

© 2002 Logitech. Tous droits réservés. Logitech, le logo Logitech et les autres marques Logitech sont la propriété exclusive de Logitech et sont susceptibles d'être des marques déposées. Toutes les autres marques sont la propriété exclusive de leurs détenteurs respectifs. Logitech décline toute responsabilité en cas d'erreurs dans ce manuel. Les informations énoncées dans le présent document peuvent faire l'objet de modifications sans avis préalable.

Garantie limitée. Logitech certifie que les produits matériels accompagnant cette documentation sont exempts de tout défaut de fabrication et sont garantis pendant une période de cinq (5) ans à compter de la date d'achat. La garantie de Logitech est limitée à l'acheteur initial et ne peut faire l'objet d'un transfert. La présente garantie vous confère certains droits légaux spécifiques. Vous pouvez détenir d'autres droits variant selon les lois locales. **Recours.** En cas de rupture de garantie l'intégralité de la responsabilité de Logitech et votre recours exclusif consisteront, au choix de Logitech, à: (a) réparer ou remplacer le matériel, sous réserve que le matériel soit renvoyé au point de vente ou à tout autre lieu indiqué par Logitech, accompagné d'une copie du justificatif d'achat, ou (b) rembourser le prix d'achat. Tout matériel remplacé sera garanti jusqu'à échéance de la garantie d'origine ou pour une durée de trente (30) jours, en fonction de la période la plus longue. Ces recours sont nuls si la défaillance du matériel est due à un accident, à un mauvais traitement ou à une utilisation inappropriée. **Renoncement de garantie.** LES GARANTIES PREVUES DANS CET ACCORD REMPLACENT TOUTES LES AUTRES GARANTIES. LOGITECH ET SES FOURNISSEURS EXCLUENT EXPRESSEMENT TOUTES AUTRES GARANTIES, Y COMPRIS SANS QUE CETTE ENUMERATION SOIT LIMITATIVE, TOUTES GARANTIES IMPLICITES DU CARACTERE ADEQUAT POUR LA COMMERCIALISATION OU UN USAGE PARTICULIER, AINSI QUE LES GARANTIES DE RESPECT DE DROITS DE TIERS CONCERNANT LE MATERIEL. AUCUN DISTRIBUTEUR, AGENT OU EMPLOYE DE LOGITECH N'EST AUTORISE A EFFECTUER DES MODIFICATIONS, DES EXTENSIONS OU DES AJOUTS DANS CETTE GARANTIE. Certaines juridictions ne reconnaissent pas les limitations de durée des garanties implicites; il est donc possible que la limitation susmentionnée ne s'applique pas à votre cas.

Limites de responsabilité. LOGITECH OU SES FOURNISSEURS NE SAURAIENT ETRE TENUS RESPONSABLES DES COÛTS D'APPROVISIONNEMENT EN PRODUITS OU SERVICES DE REMPLACEMENT, DU MANQUE A GAGNER, DE LA PERTE D'INFORMATIONS OU DE DONNEES, OU DE TOUT AUTRE DOMMAGE PARTICULIER, INDIRECT, CONSECUTIF OU ACCESSOIRE DECOULANT DE LA VENTE, DE L'UTILISATION OU DE L'IMPOSSIBILITE D'UTILISER UN PRODUIT OU UN SERVICE LOGITECH, MEME SI LOGITECH A ETE INFORMEE DE L'EVENTUALITE DE TELS DOMMAGES. LA RESPONSABILITE DE LOGITECH ET DE SES FOURNISSEURS NE SAURAIT EN AUCUN CAS DEPASSER LE MONTANT DEBOURSE POUR L'ACQUISITION DU PRODUIT OU DU SERVICE LOGITECH LUI DONNANT LIEU. Certaines juridictions n'autorisent pas l'exclusion ou la limitation des dommages accessoires ou consécutifs; il est donc possible que la limitation ou l'exclusion susmentionnée ne s'applique pas à votre cas. Les limites susmentionnées ne s'appliqueront pas en cas de préjudice corporel lorsque et dans la mesure où la loi en vigueur prévoit l'existence de cette responsabilité.

Déclaration FCC. Cet équipement a été testé et déclaré conforme à la section 15 du règlement de la FCC. Son fonctionnement est soumis aux conditions suivantes: 1) l'équipement concerné ne doit pas causer d'interférences dangereuses, et 2) il doit accepter toute interférence reçue, y compris les interférences risquant d'engendrer un fonctionnement indésirable. Cet équipement a été testé et déclaré conforme aux limitations prévues dans le cadre de la catégorie B des appareils numériques défini par

la section 15 du règlement de la FCC. Ces limitations sont stipulées aux fins de garantir une protection raisonnable contre les interférences gênantes en installation résidentielle. Cet équipement génère, utilise et diffuse des ondes radio, et s'il n'est pas installé ni utilisé en conformité avec les instructions dont il fait l'objet, peut causer des interférences gênantes avec les communications radio. Cependant, nous ne pouvons vous garantir qu'une interférence ne se produira pas dans une installation particulière. Si cet équipement produit des interférences graves lors de réceptions radio ou télévisées qui peuvent être détectées en allumant et en éteignant l'équipement, vous êtes invités à les supprimer de plusieurs manières: 1) Réorienter ou déplacer l'antenne de réception; 2) Augmenter la distance séparant l'équipement et le récepteur; 3) Connecter l'équipement à un circuit différent de celui auquel le récepteur est connecté; 4) Contacter votre revendeur ou un technicien radio/TV qualifié. Toutes modifications ou tous changements effectués sans l'accord exprès de la partie responsable de la conformité aux normes pourraient contraindre l'utilisateur à ne plus utiliser son équipement. Afin d'assurer la conformité avec les règlements FCC, les câbles d'interface blindés fournis avec le produit doivent être utilisés, ainsi que tout autres composants ou accessoires également spécifiés, lors de l'installation du produit.

Déclaration du Ministère des Communications Canadien. Cet appareil numérique est conforme aux limitations concernant l'émission d'interférences radio par des appareils numériques de catégorie B, telles que stipulées dans le cadre de la norme Appareils numériques ICES-003 édictée par le Ministère canadien de l'Industrie.

Cet équipement a été déclaré conforme à la norme RSS-210 édictée par le Ministère canadien des Sciences et de l'Industrie. Son fonctionnement est soumis aux conditions suivantes: 1) l'équipement concerné ne doit pas causer d'interférences, et 2) il doit accepter toute interférence reçue, y compris les interférences risquant d'engendrer un fonctionnement indésirable.

Contents

English	1
Español	7
Français	13
Português	19

Welcome!

Give professional presentations with your Logitech® Cordless Presenter™ without the hassle of cords or the limitation of line-of-sight operation with your notebook computer or PC. This cordless device uses Bluetooth™ Technology to transmit data up to 30 feet (10 meters). With its technical simplicity and comfortable shape, it lets you focus on your delivery. Conveniently placed Forward and Back buttons help you page through slides effortlessly, and a built-in laser pointer gives you the option of highlighting key concepts on-screen with the touch of a button. Change modes with a single switch to use your Logitech® Cordless Presenter™ on a tabletop as a two-button optical mouse with scroll buttons. And while in Mouse Mode, you can assign special operations, such as double-click, to one of the mouse buttons using Logitech's MouseWare® software.

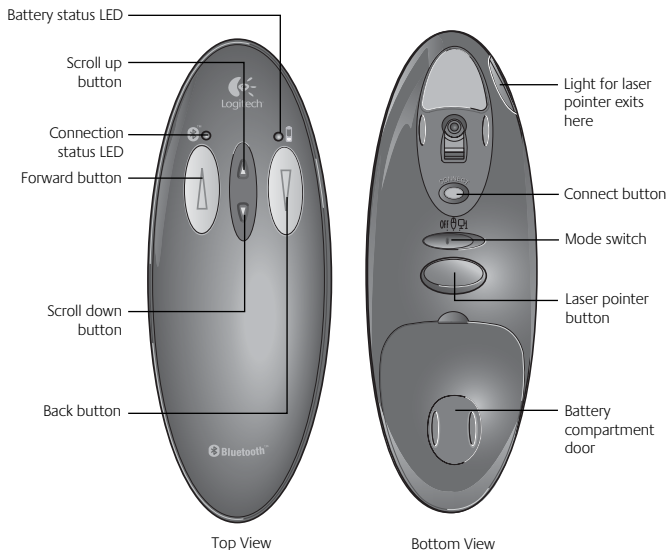

Logitech® Cordless Presenter™

Connect the Mini-receiver

The Logitech® Cordless Presenter™ communicates with your notebook computer or desktop PC via a mini-receiver.

The mini-receiver plugs directly into the USB port of your computer (picture 1).

For added convenience, use the extension cable (picture 2).

The mini-receiver's red LED will blink quickly for 15 minutes until a radio frequency connection is made with the presentation device. You make this connection by pressing the Connect button on the Logitech® Cordless Presenter™.

If this connection is not made within 15 minutes after plugging the mini-receiver into the USB port, the mini-receiver will time out. (The mini-receiver's red LED will blink slowly.) To establish a connection, press the Connect button on the mini-receiver (picture 3), then press the Connect button on the presentation device.

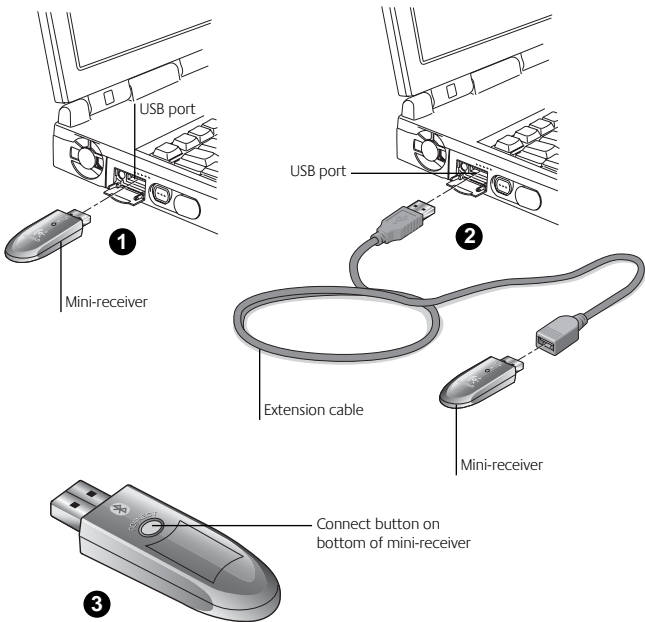

Install the Batteries

The Logitech® Cordless Presenter™ uses two AA alkaline batteries. Install the batteries before installing the software.

- 1. Remove the battery door (picture 1).** Place your thumb on the indentation at the top of the battery door. Gently press down and carefully slide the door off.
- 2. Insert the batteries (picture 2).** Use the diagram inside the battery compartment to install the batteries correctly.
- 3. Replace the battery door (picture 3).** Align the battery door in the groove that outlines the battery compartment. Carefully slide the battery door forward to secure it. Do not force the door; it should *slide* easily into place.

Battery Status LED

- The Battery Status LED above the Back (right) button is green for two seconds after the presentation device is switched on.
- The Battery Status LED turns red and blinks slowly when battery power is low. (Replace the batteries.)
- The Battery Status LED is red continuously when battery power is nearly gone. (Replace the batteries immediately.)

Battery Life

When not in use, make sure to move the Mode Switch to the **Off** position to conserve battery power. Depending upon usage, battery life is estimated to be from 60-to-100 hours.

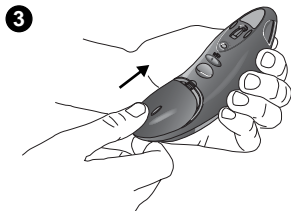
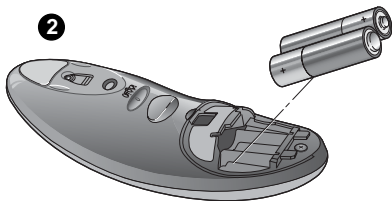
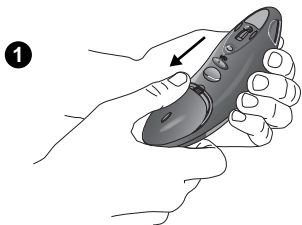

Battery Warning!

When battery power is low for the presentation device, the cursor on your screen may not move, or may move erratically when you move the presentation device. Or the MouseWare[®] software may display a dialog box in Windows[®] 98, Windows[®] 98 SE, Windows[®] 2000, Windows[®] Me, and Windows[®] XP suggesting that you change the batteries. It is recommended that you promptly change your batteries to avoid any battery leakage.

If your batteries leak, use normal precaution and follow the battery manufacturer's recommendations.

When replacing batteries, use alkalines. You may use other battery types, but do not mix them with alkaline batteries.

Note that the battery level indicator in the Mouse Properties is calibrated for alkaline batteries only, and will not give an accurate indication of battery life for batteries other than alkalines.

Discard all used batteries according to the battery manufacturer's instructions. Exercise care when handling batteries.

When batteries are misused, they may explode or leak, causing burns and personal injury. Do not open a battery or mutilate, dispose of in a fire, expose to heat above 130° F (54° C), immerse in water, install improperly, or recharge.

Conducting materials, such as rings, bracelets, and keys, can short out a battery causing it to overheat and possibly leak or explode. When you are not using your presentation device for long periods of time, remove the batteries and store them in a dry place at normal room temperature.

Install the Software

To use all the features of the Logitech[®] Cordless Presenter[™], make sure to install the software.

- 1. With your computer running, insert the software CD into the CD-ROM drive of the computer.**
- 2. Follow the on-screen instructions to finish installing the software.**
- 3. Use the software wizard to setup the presentation device.**

Establish a Connection - Important!

1. Make sure you have connected the mini-receiver to the USB port of your computer, installed the batteries in the presentation device, and have installed the software.
2. Turn on the presentation device by moving the Mode switch to either Mouse Mode or Presentation Mode.
3. Press and release the Connect button on the presentation device (picture 1). The presentation device emits a “beep.” The Connection Status LED above the Forward (left) button is red and blinks fast until a connection is made; then it turns green and blinks slowly. You have now established a connection between the presentation device and the mini-receiver.
4. If a connection has not been made and the Connection Status LED on the presentation device is slowly blinking red, press the Connect button on the bottom of the mini-receiver (picture 2), then press the Connect button on the presentation device.

Connection Status LED and Communication Range

- After connection, the Connection Status LED blinks green to indicate each time a data packet has been sent from the presentation device to the mini-receiver.
- Should the presentation device move out of range from the mini-receiver, the Connection Status LED on the presentation device turns red and blinks fast as long as the presentation device is out of range.

Using the Presentation Device

The Logitech[®] Cordless Presenter[™] has two modes: Presentation Mode and Mouse Mode. Use the Mode switch on the bottom of the presentation device to turn on the device and to switch between these two modes.

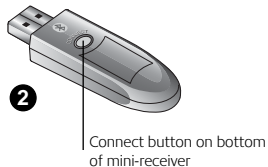
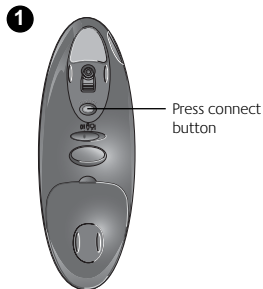

Presentation Mode

In Presentation Mode, the Forward (left) button displays the next screen (or page). The Back (right) button displays the previous screen (or page). You can change these button assignments using MouseWare®.

The Laser Pointer button on the button of the presentation device is operational in both Presentation and Mouse Modes. Point the device at the screen and press this button to project a red dash, which you can use as a pointer during your presentations.

Note The scrolling buttons do not work in Presentation Mode, nor can you use the presentation device as a traditional two-button mouse in this mode and navigate on screen.

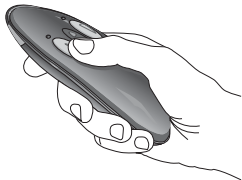
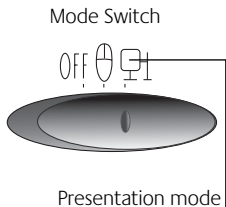

Mouse Mode

In Mouse Mode, the Forward (left) button performs a “click/select” function. The Back (right) button performs a “context/alt select” function. You can change these button assignments using MouseWare®.

To scroll up, press the Scroll Up button. To scroll down, press the Scroll Down button. Note that the scrolling buttons will make a “buzzing” sound when pressed.

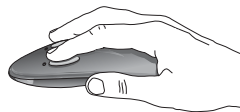
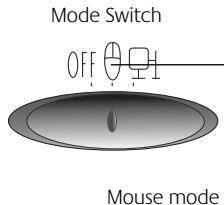

Scrolling Buttons

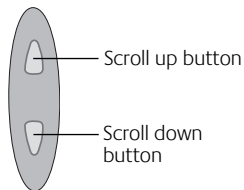

Laser Pointer Warning!

- Do **not** allow minors to use the laser pointer unsupervised. Laser pointers are not toys.
- **Avoid** direct eye exposure.
- **Never** shine the laser pointer at anyone. The laser pointer is designed to illustrate inanimate objects.
- Do **not** point the laser pointer at mirror-like surfaces. A reflected beam can act like a direct beam on the eye.

Power Saving

After 30 minutes of inactivity, the Logitech® Cordless Presenter™ enters a power saving state. To re-activate the presentation device, press a button, move the device (Mouse Mode), or press one of the scrolling buttons (Mouse Mode). It takes about five seconds to re-establish a radio-frequency link with the mini-receiver.

Carrying Case

Please use the carrying case to protect the Logitech® Cordless Presenter™. The laser window on this device is sensitive to dust, scratching, and finger prints. Clean the laser window occasionally with a soft cloth.

Using MouseWare®

In both Presentation and Mouse Modes, the functionality of the Forward and Back (left and right) buttons can be changed using the Buttons page in MouseWare®. However, you cannot modify the scrolling buttons.

To launch MouseWare®, select Start/Programs/Logitech MouseWare/Mouse Properties, or click the mouse icon on the Taskbar. To change button assignments, click the Button's Tab. Refer to the online help for more information about making button assignments.



Troubleshooting*

Presentation Device Does Not Work After Installation

- Make sure you have connected the mini-receiver correctly. Make sure you have installed the batteries correctly. Verify that the batteries are good.
- Make sure you have switched the presentation device on to either Presentation Mode or Mouse Mode. If you are working in Presentation Mode, make sure you are within 30 feet (10 meters) of the mini-receiver and you have set the Mode Switch to Presentation Mode. If you are working in Mouse Mode, make sure you have set the Mode Switch to Mouse Mode.
- Manually establish communication between the mini-receiver and the presentation device. Press the Connect button on the mini-receiver first, then press the Connect button on the presentation device.

Presentation Device Does Not Work With Other Bluetooth™ Devices

A specific Bluetooth™ profile is required for the Logitech® Cordless Presenter™. It is recommended that the Logitech® Cordless Presenter™ only be used with its mini-receiver.

The Back (Right) Button Does Not Work With PowerPoint® 97.

Make sure that you have installed the MouseWare® software.

Important Ergonomic Information

Long periods of repetitive motions using an improperly set-up workspace, incorrect body position, and poor work habits may be associated with physical discomfort and injury to nerves, tendons, and muscles. If you feel pain, numbness, weakness, swelling, burning, cramping, or stiffness in these areas, see a qualified health professional. For more information, please read the Comfort Guidelines located on the Logitech® software CD and on the Logitech® web site at <http://www.logitech.com/comfort>.

Product Warranty

Your product comes with a limited five-year warranty. For more information, refer to the Product Warranty section of the User's Guide located on the Logitech® software CD.

For troubleshooting information, also refer to the User's Guide on the Logitech® software CD, which was copied to your computer's hard drive.

Logitech Addresses and Phone Numbers*

Country	Address	Product Information (Infoline)	Technical Help (Hotline)
Benelux (B, LUX, NL) LOGITECH Northern Europe B.V.	Maanlander 14C NL - 3824 MP <u>Amersfoort</u>	☎ +31 (0)10-243 88 97 <i>Nederlands</i> ☎ +32 (0)2-626 89 63 <i>Français (Belg.)</i> ☎ ++32 (0)2-626 89 61 <i>Vlaams (Belg.)</i>	☎ +31 (0)10-243 88 98 <i>Nederlands</i> ☎ +32 (0)2-626 89 62 <i>Français (Belg.)</i> ☎ +32 (0)2-626 89 60 <i>Vlaams (Belg.)</i>
Denmark LOGITECH Representation Office	Århusgade 88, 4.sal DK - 2100 <u>København Ø</u>	☎ +45 35-44 55 16	☎ +45 35-44 55 17
Deutschland & Eastern European countries LOGITECH GmbH	Streiflacher Straße 7 D - 82110 <u>Germering</u>	☎ +49 (0)69-92 032 165	☎ +49 (0)69-92 032 166
España LOGITECH España BCN, S.L.	Entenza, 332-334 , Atico 2º E - 08029 <u>Barcelona</u>	☎ +34 91-375 33 68	☎ +34 91-375 33 69
France LOGITECH France SARL	26-28 Rue Danielle Casanova F - 75002 <u>Paris</u>	☎ +33 (0)1-43 62 34 13	☎ +33 (0)1-43 62 34 14
Hungary LOGITECH Magyarország	Vamhaz Krt. 10. 1/13 1053 <u>Budapest</u> - HUNGARY	☎ +41 (0)21-863 54 00 <i>English</i>	☎ +41 (0)21-863 54 01 <i>English</i>
Italia LOGITECH Italia S.r.l	Rosenholmweien 40 N - 1411 <u>Kolbotn</u>	☎ +39 02-215 1062	☎ +39 02-214 0871
Norway LOGITECH Representation Office	Centro Direzionale Colleoni Palazzo Andromeda 3 I - 20041 <u>Agrate Brianza</u> , MI	☎ +47 (0)23-500 084	☎ +47 (0)23-500 083
Österreich LOGITECH Representation	Rohrergasse 32 A - 1130 <u>Wien</u>	☎ +43 (0)1-502 221 349	☎ +43 (0)1-502 221 348
Schweiz/Suisse/Svizzera LOGITECH Europe S.A. (Switzerland)	Täferenstrasse 16 CH - 5405 <u>Baden-Dättwil</u>	☎ D +41 (0)21 863 54 10 ☎ F +41 (0)21 863 54 30 ☎ I +41 (0)21 863 54 60	☎ D +41 (0)21 863 54 11 ☎ F +41 (0)21 863 54 31 ☎ I +41 (0)21 863 54 61
Sweden, Iceland & Finland LOGITECH Nordic AB	Jägerhornsvägen 19 S - 141 75 <u>Kungens Kurva</u>	☎ +46 (0)8-519 920 19 <i>Sweden</i> ☎ +358 (0)9-817 100 21 <i>Finland</i>	☎ +46 (0)8-519 920 20 <i>Sweden</i> ☎ +358 (0)9-817 100 21 <i>Finland</i>
UK + Eire LOGI (U.K.) Ltd.	Unit 8, Shaftsbury Court 18 Chalvey Park GB - <u>Slough</u> , SL1 2ER, Berkshire	☎ +44 (0)207-309 01 27	☎ +44 (0)207-309 01 276

Country	Address	Product Information (Infoline)	Technical Help (Hotline)
---------	---------	-----------------------------------	-----------------------------

Corporate Headquarters

European, Middle Eastern & African Headquarters LOGITECH Europe S.A.	Moulin-du-Choc CH - 1122 <u>Romanel-sur-Morges</u>	☎ +41 (0)21 863 54 00 Fax +41 (0)21 863 54 02	<i>English</i> ☎ +41 (0)21 863 54 01 Fax +41 (0)21 863 54 02 <i>English</i>
Corporate Headquarters LOGITECH Inc.	6505 Kaiser Drive USA - <u>Fremont</u> , CA 94555	☎ +1 800-231 7717	☎ +1 702-269 3457
Asian Pacific Headquarters LOGITECH Far East Ltd.	#2 Creation Road IV Science-Based – Industrial Park ROC - <u>Hsinchu</u> , Taiwan		☎ +886 2-2761 5235
Australia Logitech Australia Computer Peripherals Pty Ltd.	Level 2, 633 Pittwater Road AUS - <u>Dee Why</u> NSW 2099, Australia		☎ +61(0)2-8850 1192
Canada Sales & Marketing Office	5025 Orbitor Dr., Bldg. 6, Suite 200 CDN - <u>Mississauga</u> , ON L4W 4Y5	☎ +1 800-231 7717	☎ +1 702-269 3457
Japan LOGICOOL Co. Ltd.	Ryoshin Ginza East Mirror Bldg., 7F 3-15-10 Ginza Chuo-ku, <u>Tokyo</u> , Japan 104-0061		☎ +81 3-3543 2122 Fax +81 3-3543 2911
In Latin America and the Caribbean:	Contact your local authorized distributor, or call our Customer Support Hotline in the USA, at ☎ +1 (702) 269 3457.		
World Wide Web: http://www.logitech.com		FTP: ftp://ftp.logitech.com/pub	

* Refer to your Registration Card for the most up-to-date addresses and phone numbers.

Note For USA and Canadian customers only: please read the following prior to exchanging or returning your product. To exchange or return your product within the first 30 days, we recommend returning it to the point of purchase. If you return or exchange your product through Logitech, you must first contact Customer Support to obtain a Return Merchandise Authorization (RMA) number. Customer Support will give you an RMA number and a special address for the exchange.



Logitech® on the world wide web: www.logitech.com

©2002 Logitech. All rights reserved. Logitech, the Logitech logo, and other Logitech marks are owned by Logitech and may be registered. All other trademarks are the property of their respective owners. Logitech assumes no responsibility for any errors that may appear in this manual. Information contained herein is subject to change without notice.

Part number: **622978-0403**