

WIRELESS VIDEO MONITORING SYSTEM

LW2730/LW2930 SERIES QUICK START GUIDE

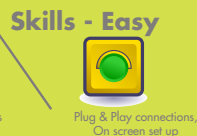

NOTE: AVOID INSTALLING IN A LOCATION WHICH REQUIRES THE WIRELESS SIGNAL TO PASS THROUGH CEMENT, CONCRETE AND METAL STRUCTURES. THIS WILL REDUCE THE TRANSMISSION RANGE.

Getting Started



This system comes with the following components:

- LCD monitor with built-in recorder and wireless receiver*
- Indoor/outdoor color camera(s)*
- Camera stand(s)*
- SD memory card*
- Audio/video cable
- Mounting hardware kit(s)*
- Wireless antennas (for receiver and camera [s])*
- Power adapters*
- User's Guide
- Mini USB cable
- CD

*Monitor size, number of cameras and SD card capacity may vary by model. Check your package for specific content information.

Before you install a camera, carefully plan where and how it will be positioned, and where you will route the cable that connects the camera to the power adapter.

A. Camera Setup

- 1** Attach camera to the mounting stand. Adjust the angle of the camera until the desired view is set. Tighten the thumbscrews to secure the desired camera position.

NOTE: Remove the protective film from the front of the camera. If the film is not removed, it will block the built-in microphone and potentially affect the quality of the picture.



- 2** Attach the included antenna to the camera by screwing it on to the side as shown below.



- 3** Connect one end of the camera Power Adapter to the camera and the other end to an electrical outlet. Make sure the power connector is fully pushed in to avoid water getting in the plug.

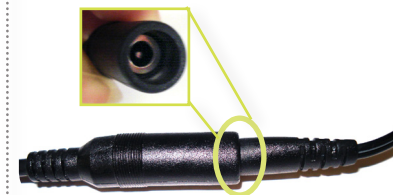

- Cameras are rated for indoor/outdoor installation. Not intended for direct exposure to rain or snow. For outdoor applications install under shelter protected from the elements.
- Wireless cameras require a power source to operate.
- When adding cameras that were not included in the original box, you will need to pair up the camera with the receiver. Please refer to the camera pairing section of the User's Guide.
- This camera includes an Auto Mechanical IR Cut Filter. When the camera changes between day/night lighting, an audible clicking noise may be heard coming from the camera. This clicking is normal, and indicates that the camera filter is working.

B. LCD Receiver Setup

The LCD Receiver can be setup for use on a tabletop, or mounted to a wall or underneath a counter or cupboard. See the User's Guide for full mounting details.

- 1** Connect the antenna by turning it clockwise onto the receiver's antenna jack.



- 2** Pull out the receiver stand for convenient placement on a flat surface.

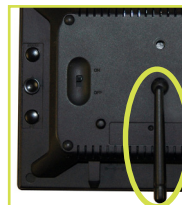

- 3** Insert the included SD card into the SD Card slot on the LCD receiver until you hear a "click." The card will not be flush when completely inserted.



NOTE: The receiver is compatible with most major brands of SD card up to 32 GB.

- 4** Connect one end of the receiver power adapter to the bottom of the receiver and the other end to an electrical outlet.

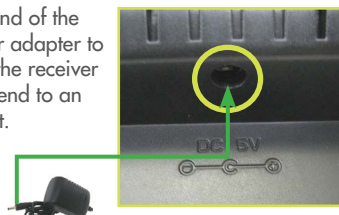

- Make sure to first connect the camera(s) to an electrical outlet before powering on the receiver; this will ensure a proper connection.

- 5** Slide the power switch to the "ON" position. For the LW2730 Series, the switch is located on the back of the screen.



For the LW2930 Series, the switch is located on the side of the screen.



- 6** Adjust the antenna on the receiver as necessary to provide the clearest reception.

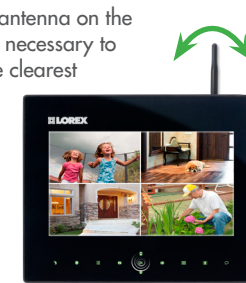

NOTE: If one or more of the cameras do not appear when selected (i.e. Camera 2 is turned on but does not appear on channel 2), follow the pairing process as described in User's Guide.

WIRELESS VIDEO MONITORING SYSTEM

LW2730/LW2930 SERIES QUICK START GUIDE



NOTE: This system supports a USB connection to your PC/Mac to enable remote monitoring using Skype™ and for uploading pictures (PC only). Refer to the User's Guide for detailed set-up instructions.

C. Basic System Setup

Front Panel Buttons - Overview:

- Motion Recording:** Activate/deactivate Motion Recording.
- Manual Recording:** Activate Manual Recording.
- Menu:** Open Main Menu. Return to previous menu / exit menus.
- Volume Control:** Increase / decrease volume on receiver. Scroll left / right in menus.
- Channel Select:** Change channel. Scroll up / down in menus.
- OK:** In menus, confirm selection. While Viewing, open Playback mode.
- Quad / Sequence Mode:** Switch between Sequence and Quad (4-channel) mode.
- Screen Saver Mode:** Activate/deactivate Screen Saver mode.
- Talk:** Activate Intercom (2-way-audio).

Navigating Menu Screens:

Use the system menus to configure settings.

- Press to open the Main Menu.
- Press to move the cursor left and right.
- Press to move the cursor up and down.
- Press to open sub-menus and confirm/save menu selections.
- Press to exit menus without saving changes.

Setting Date/Time:

Set the date and time to ensure that they are properly captured on recordings.

- Press to open the main menu. Press left and right to select **Settings** and press the **OK** button.
 - Select **Date & Time** and press the **OK** button.
 - Press **RIGHT/LEFT** to move the cursor; press **UP/DOWN** to change the year, month, day, hour, minutes, and seconds.
- NOTE:** The system uses a 24-hour clock.
- Press **OK** to save your settings.
 - Press to close any remaining menu windows.

Intercom Feature



Press and hold to talk to the camera. Release to listen to audio.

NOTE: Please make sure the camera(s) is properly connected prior to using the Intercom (available in single camera full screen mode).

Changing Camera View Mode

There are four different viewing modes available on the system: single channel viewing, Auto Sequence Viewing mode (view individual channels automatically in sequence), Quad mode, and Screen Saver mode.

Single Channel View: Press / to switch between channels 1~4 in single channel view.

Auto Sequence View: Auto Sequence Viewing Mode switches between connected channels in full-screen. Press until a single channel is shown on screen. The monitor automatically switches through connected channels.

Quad View: Use Quad mode to view up to four cameras simultaneously. Press button.

Screen Saver View: Press to enable Screen Saver mode.

On-Screen Display (see User's Guide for further details)



1. File Name
2. Signal Indicator
3. Camera Indicator
4. File Icon
5. SD Card icon
6. Overwrite icon
7. Power Failure icon
8. Recording Indicator
9. Time Stamp

D. Recording Video

Three recording modes are available on the system: Manual Recording, Schedule Recording, and Motion Recording.

NOTE: The system can record video to an SD card one channel at a time or quad view (up to 4 channels on one screen). You should always format the SD card prior to initial recording. For details refer to the User's Guide section "Format Memory".

NOTE: Recording overrides other actions on the receiver. You must stop recording on the system in order to perform other actions, such as opening the Main Menu, Quad Mode, etc.

MODE	DESCRIPTION	HOW TO OPERATE
MANUAL RECORDING	• Continuous recording from one camera or entire screen in Quad mode	• Press the Record button to start/stop manual recording
SCHEDULE RECORDING	• Continuous recording from one camera, from Auto Sequence Viewing mode (system records cameras in sequence), or Quad or Screen Saver mode (system records all cameras in Quad mode) according to a weekly schedule	• ATTENTION: Turn off Manual Recording and Motion Recording to enable Schedule Recording • Enter a Start and Stop Time for each day from
MOTION RECORDING (AUTO)	• System only records when motion is detected by a camera • Compatible with Quad mode (recommended) • Compatible with Auto Sequence Viewing mode	• Press to start/stop Motion Recording
SCREEN SAVER + MOTION RECORDING	• Enable Screen Saver to enable digital picture frame mode or turn off the LCD monitor when motion is not detected • You must upload images to the SD card to use digital picture frame mode. A PC is required to upload images to the SD card; Mac is not supported for this function.	• Press to start Motion Recording • Press to enable Screen Saver mode • Cannot enable Screen Saver mode while the monitor is in Quad mode

For information on viewing recordings, refer to the User's Guide section "Playback"

It's all on the Web

For detailed setup information, please refer to your User's Guide. For additional information and accessory purchases, please visit our website www.lorextechnology.com

This product is EXPANDABLE UP TO 4 CAMERAS. To order additional cameras, please visit our website at www.lorextechnology.com

EXTENDING YOUR WIRELESS SIGNAL

Even with a clear line-of-sight between your camera(s) and your receiver, you may experience a lower frame rate simply due to the distance between your wireless devices. Accessory antennas are available that can help extend the range of your wireless signal. Visit www.lorextechnology.com for more details.