

COLOR DIGITAL WIRELESS SURVEILLANCE SYSTEM WITH INDOOR/OUTDOOR NIGHT VISION CAMERA

LW2100 SERIES - QUICK START GUIDE

Time  Under 15 Minutes*
* Installation time may vary based on application and camera location

Tools  Hand Tools

Skills - Easy  Plug & Play connections, On screen set up

Getting Started

The Digital Wireless Surveillance System comes with the following components:

- Digital Wireless Color Camera*
- Camera* Stands
- Slim Wireless Receiver
- Wireless Antenna's for camera* and receiver
- Power Adaptors* for camera* and receiver
- Battery Adaptor Case for camera*
- RCA/BNC Adaptor
- RCA Audio/Video Cable*
- Instruction Manual



*Number of cameras may vary by model. Check your package for specific content information.

A. Connect the Receiver

- 1 Connect the included Wireless Antenna to the receiver
- 2 Connect one end of the RCA Audio Video Cable to the Receiver.



- 3 View your Camera images on any Observation Monitor with standard BNC inputs or TV with RCA inputs**.

- 1 Connect the Video end of the RCA Cable to the Female end of the included RCA/BNC Adaptor. Connect the BNC Adaptor to your Observation System or DVR with standard BNC inputs. Connect the Audio end of the RCA cable to the Audio input on your Observation System or DVR.
- 2 To view camera images on your TV, connect the RCA Video and Audio ends of the RCA Audio/Video cable to the Video and Audio inputs on your TV.

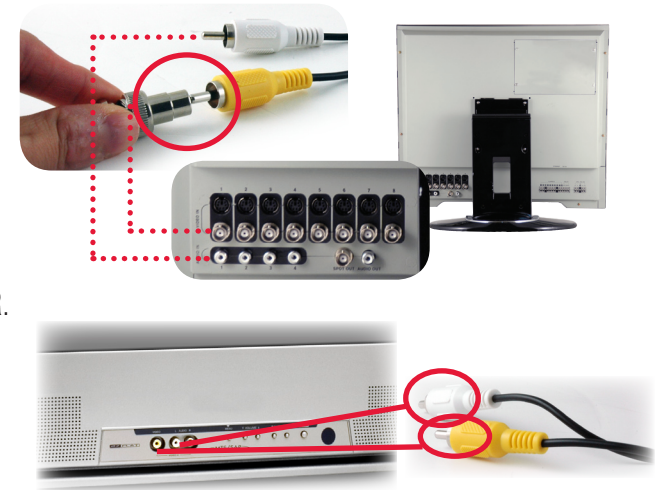

** Requires viewing/recording device with RCA Video or BNC Video input. Viewing/Recording device sold separately.

B. Connect the Camera

- 1 Mount camera stand to the wall
- 2 Connect the Wireless Antenna to the camera.
- 3 Secure Camera to the Stand.
- 4 Connect one end of the Camera Power Adaptor to the camera and the other end to an electrical outlet.

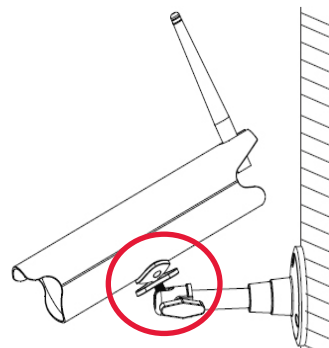
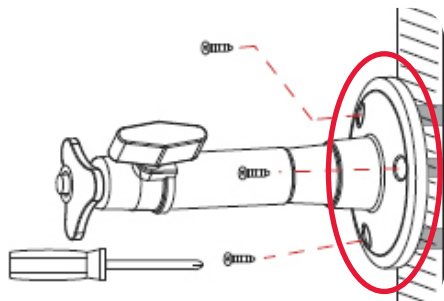

Connect power adaptor to local 120V AC power outlet

NOTE: Before you install a camera, carefully plan where and how it will be positioned, and where you will route the cable that connects the camera to the power adaptor or battery adaptor. Before starting permanent installation, verify its performance by observing the image on a monitor when the camera is positioned where it will be permanently installed.

NOTE: Wireless cameras require a power source (either an electrical outlet or battery power) to operate. If you plan to permanently mount the camera in a location, it is recommended to use the included Camera Power adaptor to prevent interruptions in the image, as the battery adaptor is intended for a temporary power solution.

NOTE: When adding cameras that were not included in the original box, you will need to pair up the camera with the receiver. Please refer to the Camera Pairing Section of the User Manual.

COLOR DIGITAL WIRELESS SURVEILLANCE SYSTEM WITH INDOOR/OUTDOOR NIGHT VISION CAMERA

LW2100 SERIES - QUICK START GUIDE



C. Receiver Function Buttons

Press the Left, Right, Up, Down buttons to navigate in Menu Mode. Use these buttons to Pan/Tilt the image in ZOOM Mode (QVGA Mode Only).

Press the M to enter or exit Menu Mode.

Press the ZOOM Button to Zoom In (QVGA) or Zoom Out (VGA).

Press the CAM Button to switch to a different Camera on the Receiver



Did you know?

You can move your camera around from one room to another with the use of the included battery adaptor.



1. Connect camera to the Battery Adaptor.

NOTE: Decide whether the camera will be permanently wall mounted or placed on a tabletop:

- If you decide to place the camera on a tabletop or other flat surface (ensure to secure the camera with proper screws, thereby preventing it from falling down and damaging the lens and surface) the camera can easily be moved to different locations as desired. (Using this option will allow you to use the Battery adaptor, which provides flexibility by moving the camera from room to room).
- If you decide to permanently mount the camera to a wall, make sure to select a location close to a power outlet.

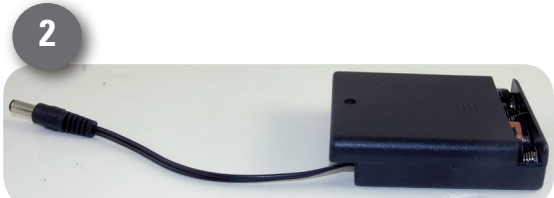

2. Slide open the Battery Adaptor Case to add batteries (not included).

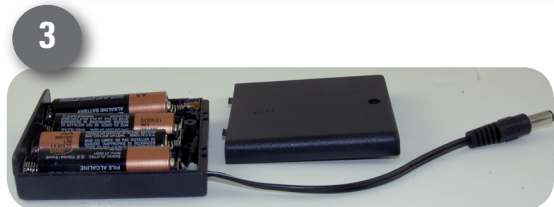

3. Insert 4 x AA Batteries into the Battery Pack. Make sure to correctly line up the Positive (+) and Negative (-) terminals of the batteries.
4. Slide the Battery Pack cover back on.
5. **NOTE:** It is recommended to remove the battery pack from the camera when not in use.

About Digital Wireless

| Digital Wireless | Analog Wireless |
|---|---------------------------------------|
| ✓ 2.4 GHz Digital | 2.4 GHz Analog |
| ✓ Secure privacy ensured | Non Secure, no privacy |
| ✓ Interference FREE | Interference from |
| | |
| ✓ Range up to 450 ft line of sight | Up to 300 ft line of sight |
| ✓ Pairing - hand shake between camera and receiver | No Pairing - fixed channel allocation |
| ✓ FHSS - Frequency Hopping Spread Spectrum Technology | N/A |
| ✓ Supports 2 resolutions VGA: 640 x 480 QVGA: 320 x 240 | Supports only one resolution |
| ✓ Digital PTZ (Pan/Tilt/Zoom) | N/A |
| ✓ Signal strength Indicator | N/A |

The table above shows that Digital Wireless Technology offers many advantages over Analog wireless. When comparing a Digital Wireless solution to a wired solution, it is important to be aware of the bandwidth limitations. Due to bandwidth constraints and depending on the signal strength the frame rate, which is measured in FPS (Frames per Second) may be reduced. For example, a Digital Wireless camera in the highest resolution (VGA 640x480) will feature a lower frame rate compared to a wired solution which provides 30 FPS. It is possible to achieve 30 FPS with Digital Wireless by using the lower resolution (QVGA 320x240). For specific Frame Rate details, please refer to the Viewing Modes section in the User Manual.

It's all on the Web

For detailed setup information, please refer to your User's Manual.
For additional information, please visit our website
www.lorexcctv.com/support

