



Owner's Manual



HCW10B Cool & Warm Mist
Humidifier

IMPORTANT SAFETY INFORMATION: Please carefully read this manual before attempting to install or use this humidifier. For your safety, comply with all safety instructions and warnings contained in this owner's manual to prevent personal injury or property damage.

To view the full line of Luma Comfort products, please visit www.lumacomfort.com.

Contents

Introduction 1

Product Benefits 1

Important Safety Information 1

Parts List 2

Operating Instructions 2

Filling the Water Tank 2

Quick Start Instructions 3

Operating Your Humidifier 4

Timer Function 5

Misting Output 5

Maintenance 5

Technical Support 6

Product Specifications 6

Warranty 7

Introduction

Thank you for purchasing this humidifier from Luma Comfort, the world leader in home appliances and home comfort products.

This owner's manual provides specific operating instructions for your humidifier. Use the humidifier only as instructed in this owner's manual.

Product Benefits

- Provides soothing moisture for personal comfort
- Built-in hygrometer offers custom humidity control from 30% to 70% with both cool and warm mist settings
- Easy to read LED display with programmable 12-hour timer
- Modern design fits in with any decor
- Demineralization cartridge prevents scale buildup
- Energy-efficient and uses ultrasonic technology
- Adds moisture to dry environments and naturally eliminates airborne dust particles
- Near-silent operation – perfect for bedrooms, nurseries and other living spaces

Important Safety Information

These instructions are not meant to cover every possible condition and situation that may occur. Please read all instructions before using this humidifier. Failure to carefully read all instructions may result in possible electric shock or fire hazard, and will void the manufacturer's warranty.

1. Use this humidifier only as instructed in this owner's manual. Other uses may cause electric shock, injury or fire.
2. Close supervision is required if this humidifier is used near children or pets.
3. To protect against electric shock, do not immerse this humidifier or its plug and cord in water.
4. If the humidifier is being transported or will not be in use, disconnect it from the power supply by tightly gripping the plug and pulling it from the power outlet. Do not disconnect the power supply by pulling on the humidifier's power cord.
5. Avoid contact with any of the humidifier's moving parts.
6. Place the humidifier on a level surface.
7. For best results, use purified water in the water tank. The ideal ambient temperature should be between 50 to 122 degrees Fahrenheit.
8. This humidifier's plug is intended to fit into a matching receptacle. Under no circumstances should the plug be altered in any way. An improper connection can result in electric shock.
9. If possible, avoid using extension cords with this humidifier. If an extension cord is absolutely necessary, do not use more than one extension cord to operate more than one unit.
10. Do not insert objects or allow fingers to enter into the humidifier's nozzles or air inlet, as this may cause electric shock or bodily injury. Do not block or tamper with the humidifier while it is in operation.
11. Do not run the power cord under mats or carpeting, and do not cover the power cord with runners. Arrange the power cord away from room traffic and where it can be tripped over.
12. Do not operate this humidifier in the presence of flammable substances or explosives.
13. Do not place the humidifier near an open flame or cooking/heating appliances.
14. This product is not intended for use in commercial or industrial areas.
15. If the humidifier will not be in use, empty the tank of any remaining water.
16. If the humidifier's plug or power cord is damaged, do not attempt to repair the components yourself. Please contact Luma Comfort's customer service hotline at 1-866-737-6390 or have the unit examined by an authorized service provider.

Parts List

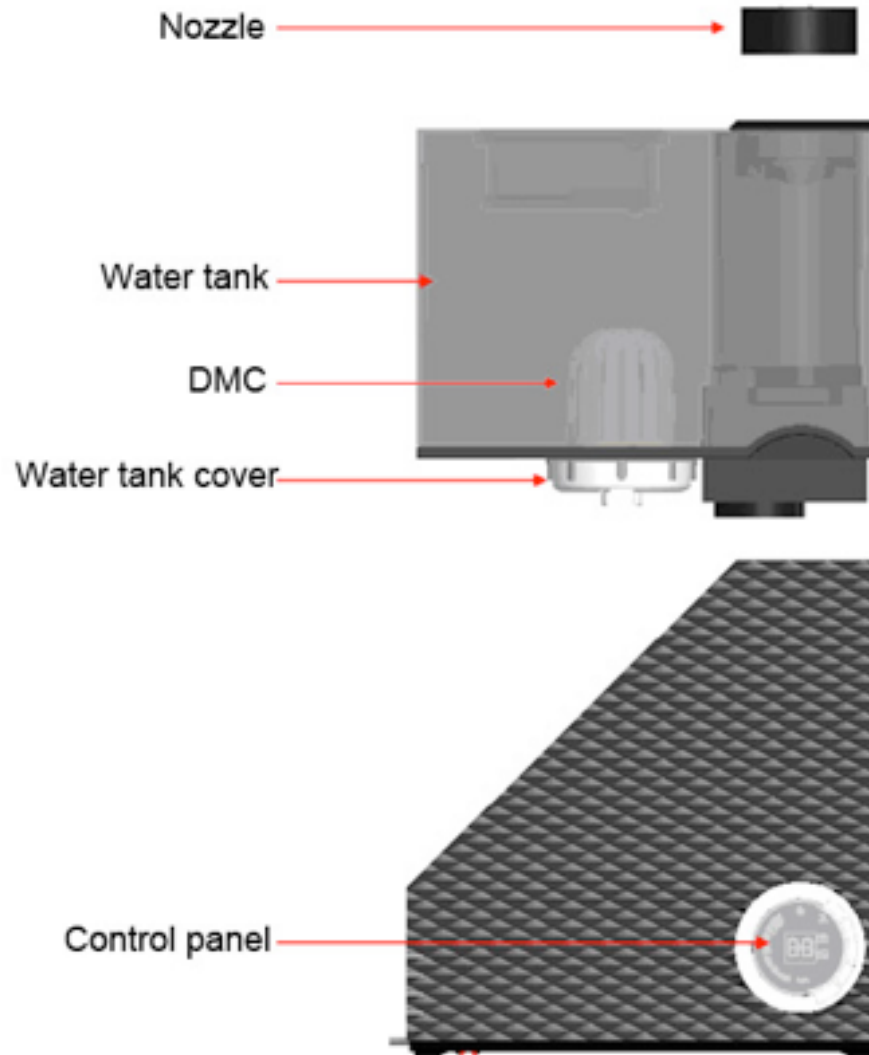

Operating Instructions

Filling the Water Tank

Carefully remove all packaging materials and retain for future storage/use. Make sure there is no residual foam left in any of the components. No tools will be required to assemble this humidifier.

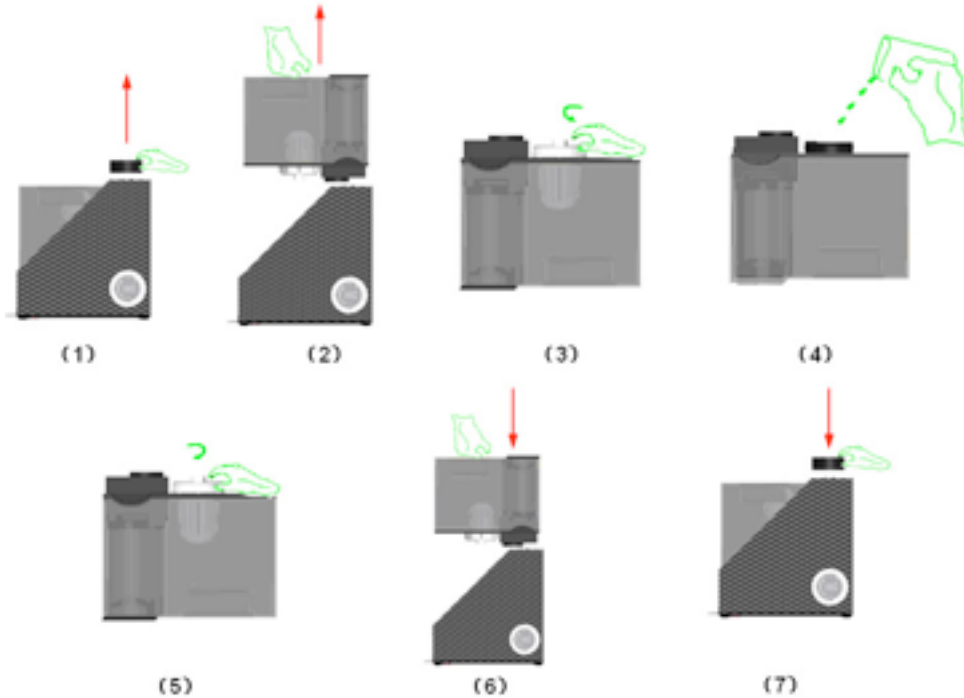

- a. Unscrew the nozzle as indicated in figure 1 and remove the water tank from the base as indicated in figure 2.
- b. Remove the water tank cover as indicated in figure 3 and pour water into the water tank as indicated in figure 4.
- c. Place the water tank cover back onto the tank as indicated in figure 5 and place the entire water tank back into the unit's base as indicated in figure 6. You should hear the water flowing through the tank. If you do not hear water flowing through the tank, remove the water tank and replace it back onto the base.
- d. Screw the nozzle back onto the unit.

Quick Start Instructions

- a. After filling the water tank with water, replace the tank back onto the base, screw in the nozzle and plug the unit into a power supply. The unit will now be on standby mode. Turn the unit on or off by pressing the power button on the control panel.
- b. Once the humidifier is turned on, you can also control the mist volume by pressing the "+" or "-" buttons on the control panel.
- c. If the LED indicator turns red, this means not enough water has flowed through the unit yet. Wait a few seconds for the water to completely flow through the tank. At this point, the indicator light on the control panel will turn from red to blue, which indicates that it should be working properly.
- d. If there is not enough water in the tank, the empty water tank LED indicator light will also turn red. Turn off the humidifier, unplug it from the power supply and add more water to the tank by following the steps listed above.
- e. The humidifier has a memory function. If the unit is turned off without unplugging the power supply, once it is turned on again using the power button, it will revert back to the last mist setting. All of the settings will reset to the default settings if the unit is unplugged from the power supply.

Operating Your Humidifier

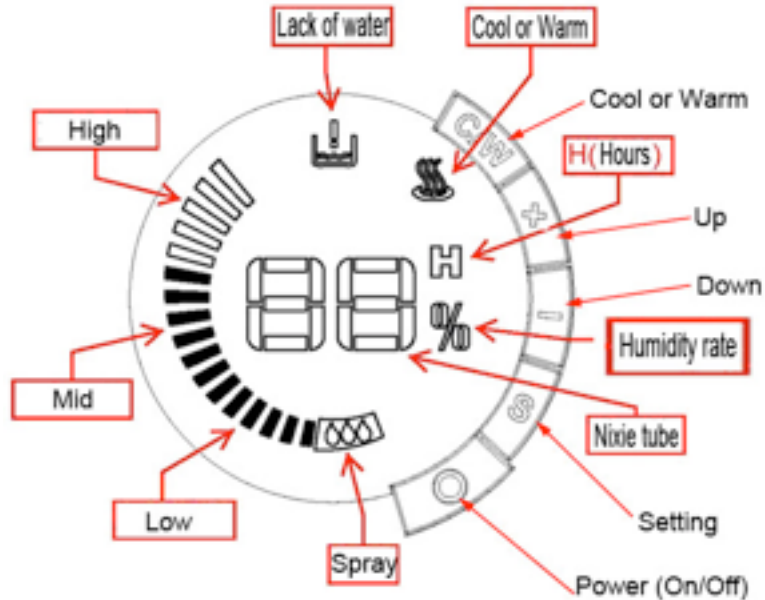

- Plug the humidifier into the power supply. The unit will now be in standby mode. All other keys will be invalid except for the power button.
- Press the power button. The humidifier will detect the water level in the tank. After 2 seconds, if there is sufficient water in the tank, it will begin to operate and the indicator light will turn on.
- The default settings for the humidifier are as follows: medium mist setting, the timer function will be off, the DC fan will be on, the unit will be in cool mist mode and the humidity level will be set to 70%.
- To change the mist mode from cool mist to warm mist, press the C/W button on the control panel. Once the unit is set to warm mist, the C/W indicator light will turn from blue (cool mist) to red (warm mist). The humidifier will then heat the water in the tank. This process can take up to 5 minutes.
- The mist settings and the timer settings are both controlled by the "+" and "-" buttons. To switch from the humidity settings to the timer settings, press the "S" button to adjust the corresponding settings.
- To set the hygrometer, press the "S" button so that the numbers in the center of the control panel with the "%" sign light up. Press the "+" and "-" buttons to set your desired humidity level and wait 5 seconds before adjusting any other settings. The hygrometer can be set from 30% to 70% relative humidity.
- Once your room is at your desired humidity level, the unit will stop adding mist to the air and the fan and atomizer will turn off. It will restart once the relative humidity decreases by 5%.
- If the room's humidity level is at 70%, you will see this image:



This means “Continue.” If this is displayed on the control panel, it means the humidity in your is at the maximum level. Use the “+” and “-” keys to adjust the humidity level. Otherwise the atomizer and fan will stop working until the relative humidity drops by 5%, as indicated above.

Timer Function

- a. Press the “S” button twice so that the “H” indicator light turns on in the control panel. This sets the timer function. Use the “+” and “-” keys to set the timer’s duration. The timer can be set from 1 to 12 hours. After your time has been set, wait for 5 seconds and do not press any other key.
- b. The display will revert back to the humidity level but will alternate between showing the humidity level and the set time.

Misting Output

Humidity mode display

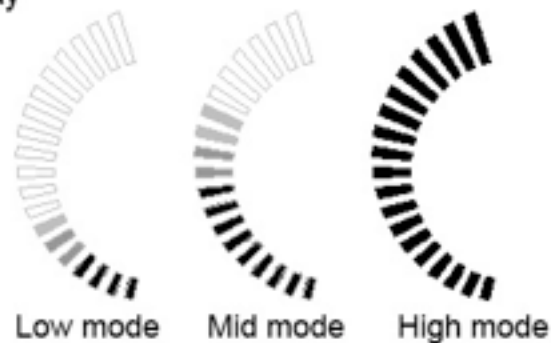

- a. Without pressing the “S” button, pressing the “+” and “-” buttons only will control the misting output. There are three misting output settings – high, mid (medium) and low. After pressing the “+” or “-” buttons, your desired misting output will be shown on the control panel as indicated in the diagram above.
- b. On the high mist volume setting, the unit’s output is 300 ml/h. On the mid mist volume setting, the unit’s output is 210 ml/h. On the low mist volume setting, the unit’s output is 120 ml/h.

Maintenance

Regular cleaning and maintenance is an essential step in maintaining the longevity of your humidifier and ensuring that it operates free of defects. Maintain your humidifier by following these steps:

- Always unplug the humidifier from the power supply before servicing or cleaning.
- Use a soft cloth and a mild soap and warm water solution to clean the unit’s exterior. Do not use harsh cleaners, gasoline, paint thinner, benzene, etc., as these substances can damage the humidifier.
- Thoroughly dry all of the humidifier’s parts with a soft cloth before reconnecting the unit to the power supply.
- Empty the water tank after the humidifier has been in use.
- If the humidifier will not be in use for an extended period of time, place the unit back in its original carton and keep it stored in a clean, dry place.

Technical Support

Luma Comfort is committed to providing a premier service experience. If you are experiencing any technical issues with your product related to either setup or operation, please contact our product support team at 1-866-737-6390 or support@lumacomfort.com.

Product Specifications

Model:	HCW10B
Product Dimensions:	9.8" x 5.6" x 9.9"
Product Weight:	5.1 pounds
Voltage:	110V-120V
Wattage:	105W
Mist Type:	Cool and warm mist
Tank Size:	7.3 pints
Mist Settings:	3
Noise Level (dB):	40
Warranty:	1 year manufacturer's warranty

Warranty

Luma Comfort products are warranted to be free from defects in workmanship or materials for one (1) year from the date of purchase. If the product is found to be defective within this period, Luma Comfort, at its sole option, will repair or replace any components that fail during normal operation. The repairs or replacement will be made at no charge to the customer for parts and labor, assuming that the customer shall be responsible for all transportation costs to and from Luma Comfort.

Luma Comfort retains the right to repair or replace (with a new or newly-refurbished replacement product) the appliance at its sole discretion.

This warranty does NOT apply to the following:

- Products without a proof of purchase
- Products purchased from a source other than an authorized Luma Comfort dealer
- Cosmetic damage such as scratches or dents
- Damage caused by service performed by anyone who is not an authorized service provider of Luma Comfort
- Damage in transit
- Damage caused by accident, abuse, misuse, water, flood, fire, improper installation, maintenance negligence, commercial use for a non-commercial unit, acts of God or any other acts of nature or external causes
- Damage to a product caused by modifications or alterations without the written permission of Luma Comfort
- Normal wear and tear of parts that are designed to be replaced, such as filters or batteries
- Power failure and improper power supply such as low voltage, defective wiring or inadequate fuses
- Use of force or damage caused by external influences
- Complete or partially dismantled appliances

THE WARRANTIES AND REMEDIES CONTAINED HEREIN ARE EXCLUSIVE AND IN LIEU OF ALL OTHER WARRANTIES EXPRESS, IMPLIED, OR STATUTORY, INCLUDING ANY LIABILITY ARISING UNDER ANY WARRANTY OF MERCHANTABILITY OR FITNESS FOR A PARTICULAR PURPOSE, STATUTORY OR OTHERWISE. THIS WARRANTY GIVES YOU SPECIFIC LEGAL RIGHTS, WHICH MAY VARY FROM STATE TO STATE.

IN NO EVENT SHALL LUMA COMFORT BE LIABLE FOR ANY INCIDENTAL, SPECIAL, INDIRECT, OR CONSEQUENTIAL DAMAGES, WHETHER RESULTING FROM THE USE, MISUSE, OR INABILITY TO USE THIS PRODUCT OR FROM DEFECTS IN THE PRODUCT. SOME STATES DO NOT ALLOW THE EXCLUSION OF INCIDENTAL OR CONSEQUENTIAL DAMAGES, SO THE ABOVE LIMITATIONS MAY NOT APPLY TO YOU.

If you believe your product is defective, contact Luma Comfort for warranty service at 1-866-737-6390 or support@lumacomfort.com. In your correspondence with Luma Comfort, please describe the problem and request a return material authorization (RMA) number. You will also need to provide the proof of purchase, return shipping address and a daytime phone number.

After a Luma Comfort representative confirms that your product is defective and is still under warranty, you will receive an RMA and return shipping instructions. Products sent to our headquarters without an RMA will be refused.