

Installation

Radio Frequency Wireless Controller
One Touch Favorite Button

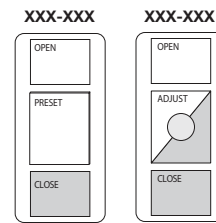

Important Notes:

Please read before installing.

1. Do not paint Wireless Controller.
2. Clean Wireless Controllers with a soft damp cloth only. Do not use any chemical cleaners.
3. Do not mix LR, LRA or LRB frequency products.
4. Device uses two (2) CR 2016 batteries.
5. Meets the Society of Automotive Engineers (SAE) temperature standards: -40°F (-40°C) to 235°F (113°C)
6. The range and performance of the Sivoia® QS Wireless system is highly dependent on a variety of complex factors such as: Distance between system components. Geometry of the home. Construction of walls separating system components or electrical equipment locate near system components.

1 Wireless Controller Operation

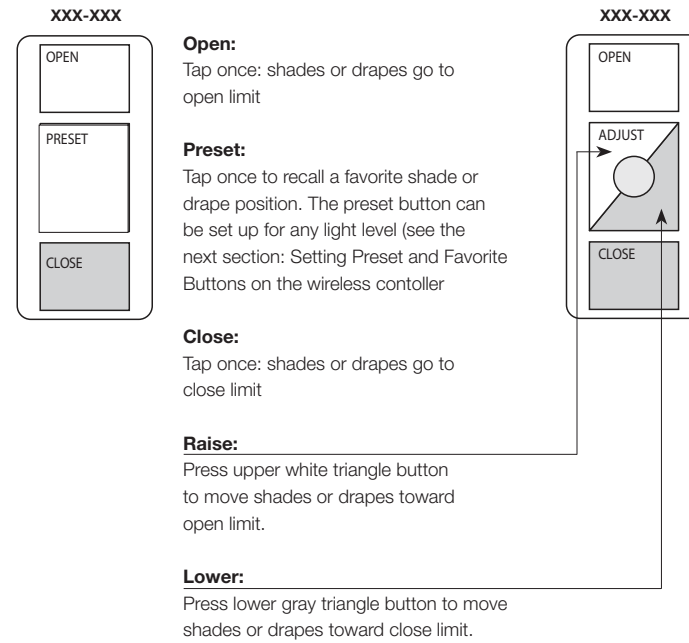

These Wireless Controllers are compatible with most Homelink equipped vehicles. Please see the vehicle manufacturer's instructions for programming information. (LR prefix)

Notes:

- The wireless EDU's must be paired with the Wireless Controller in order for it to operate the wireless EDU.
- Batteries are included and are pre-installed. Battery lifetime is approximately 5 years.

System Capacity:

- Each wireless controller can be paired with as many wireless EDU's that are within its range
- Each wireless EDU can be paired with up to 20 wireless controllers.

2 Basic Programming

Pairing an EDU and wireless controller

2.1 Enter pairing mode

- Press and hold the Open Limit button on the EDU until its LED flashes green then turns steady to enter pairing mode.
- Press and hold the Close Limit button on the EDU until its LED flashes green the LED on the external antenna flashes green.

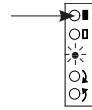
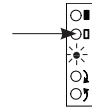

2.2 Pairing controller to EDU

- Simultaneously press and hold Open, Preset, and Close buttons on the wireless controller to be paired (3 seconds) until the LED on the antenna flashes green.
- EDU will jog shade or drape back and forth two times to confirm pairing is complete.

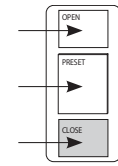

OR

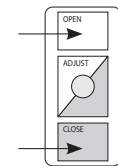

2.3 Pairing additional controllers

- Repeat step 2

2.4 Exit pairing mode

- Press and hold Open Limit button on the EDU until its LED flashes green
- Press and hold Close Limit button until LED flashes green then goes off.

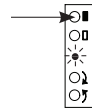
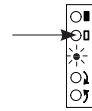

Note:

For all Wireless Switches set up to a Wireless Controller the Raise Button move shades or drapes toward open limit. The Lower Button will produce no change.

3 Troubleshooting

Symptom	Solution
Shade or drape will not move using adjustment buttons on EDU.	EDU is not powered - check EDU Power by unplugging and re-plugging in EDU. LED should flash for 5 seconds. Shade or drape is obstructed on something - Remove obstruction.
Shade or drape does not fully open or fully close.	Limits have been set incorrectly - refer to "Set open limit" and "Set close limit" sections. Shade or drape is obstructed - Remove obstruction.
IR controls will not operate shade or drape.	IR transmitter does not have line-of-sight to IR receiver Out of range - move to within 40 ft (12 m) of IR receiver EDUs not assigned to IR receiver IR receiver not plugged into any EDU within range IR remote control batteries are not providing power - replace them

4 Car Visor Mounting

The Wireless Controller can be mounted to a vehicle's visor, using the supplied visor clip.

4.1 Attach the visor clip to Wireless Controller.

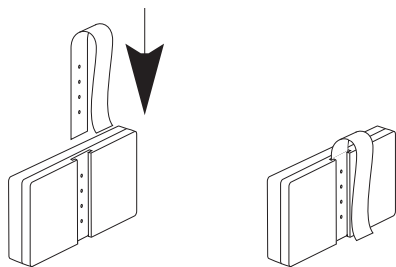

4.2 Mount the Wireless Controller to vehicle's visor.

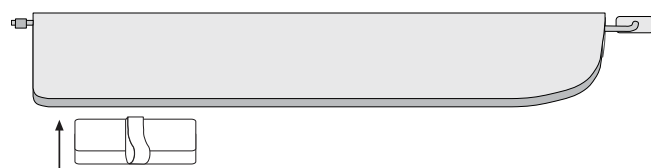

5 Wall Mounting

The Wireless Controller can be mounted to a vehicle's visor, using the supplied visor clip.

5.1 Attach a wall clip to the wall using the supplied screws and wall anchors. When Mounting the Wireless Controller horizontally, make sure that the end stop is at the bottom. Note: Drill pilot holes for the wall anchors using a 3/16 in drill bit.

5.2 Slide Wireless Controller onto wall clip. The wall clip slides into the channel on the back of the Wireless Controller.

FCC Information

Note: This equipment has been tested and found to comply with the limits for a Class B digital device, pursuant to part 15 of the FCC rules. These limits are designed to provide reasonable protection against harmful interference in a residential installation. This equipment generates, uses and can radiate radio frequency energy and, if not installed and used in accordance with the instructions, may cause harmful interference to radio and television reception, which can be determined by turning the equipment off and on. The user is encouraged to try to correct the interference by one or more of the following measures:

- Reorient or relocate the receiving antenna.
- Increase the separation between the equipment and receiver.
- Connect the equipment into an outlet on a circuit different from that to which the receiver is connected.
- Consult the dealer or an experienced radio/TV technician for help.

Note:

Changes or modifications not expressly approved by Lutron Electronics Co. could void the user's authority to operate this equipment.

* This device complies with Part 15 of the FCC Rules.

Operation is subject to the following two conditions:

- (1) This device may not cause harmful interference and
- (2) This device must accept any interference received, including interference that may cause undesired operation.

This Class B digital apparatus complies with Canadian ICES-003.

Technical Assistance

WORLD HEADQUARTERS

Lutron Electronics Co., Inc.
7200 Suter Road
Coopersburg, PA
18036-1299 USA
TEL: +1.610.282.3800
FAX: +1.610.282.1243
Technical support:
1.800.523.9466
or +1.610.282.6701
Toll-free: 1.888.LUTRON1

EUROPEAN HEADQUARTERS

Lutron EA Ltd
6 Sovereign Close
London, E1W 3JF, UK
TEL: +44.(0)20.7702.0657
FAX: +44.(0)20.7480.6899
Technical support: +44.
(0)20.7680.4481
FREEPHONE: 0800.282.107

ASIAN HEADQUARTERS

Lutron GL Ltd.
15 Hoe Chiang Road
#07-03
Singapore 089316
TEL: +65.6220.4666
FAX: +65.6220.4333
Technical support:
800.120.4491
lutronsea@lutron.com

CUSTOMER SERVICE/ ORDERING

UK +44.(0)20.7702.0657 –
09.00 - 18.00 GMT
USA +1.610.282.3800 –
08.00 - 20.00 EST

CUSTOMER SERVICE /E-MAIL

shadinginfo@lutron.com

INTERNET:

www.lutron.com

www.lutron.com/shadingsolutions

USA and Canada (24 hrs/7days):
call: 800.523.9466

Other countries (8 a.m. – 8 p.m. EST)
call: +1.610.282.3800
fax: +1.610.282.3090

email: shadinginfo@lutron.com

ADDITIONAL LUTRON SALES OFFICES:

Germany

TEL: +49.309.710.4590
FAX: +49.309.710.4591
FREEPHONE
00800.5887.6635

France

Lutron Ltc, S.A.R.L.-Paris
90 rue Villiers
92300 Levallois Perret,
France
TEL: +33.1.41.05.42.80
FAX: +33.1.41.05.01.80
FREEPHONE: 0800.90.12.18
lutronfrance@lutron.com

Spain-Madrid

TEL: +34.91.567.84.79
FAX: +34.91.567.84.78
FREEPHONE 0900.948.944

Spain-Barcelona

TEL: +34.93.496.57.42
FAX: +34.93.496.57.50
FREEPHONE 0900.948.944

Hong Kong

TEL: +852.2104.7733
FAX: +852.2104.7633

Beijing

TEL: +86.10.5877.1817
FAX: +86.10.5877.1816

Singapore

LUTRON GL Ltd. -
Singapore
15 Hoe Chiang Road
#7-03 Tower 15
Singapore 089316
TEL: +65.6220.4666
FAX: +65.6220.4333

Japan

TEL: +81.3.5575.8411
FAX: +81.3.5575.8420

Limited Warranty

SCOPE

This limited warranty ("Warranty") covers the Lutron supplied (a) Sivoia® Shade System ("Sivoia Shade System"), (b) Sivoia® Shade System ("Sivoia Shade System"), (c) manual shade system and (d) alternating current or a/c shade system (each of the foregoing being a "System"). Customer acknowledges and agrees that use of the System constitutes acceptance of all terms and conditions of this Warranty.

LIMITED WARRANTY

Subject to the exclusions and restrictions described below, Lutron warrants that each System will be free from manufacturing defects from the date of shipment by Lutron for a period of (a) one year as to the wall controls, interfaces and system accessories of the Sivoia Shade System ("External Sivoia® Components") and (b) eight years as to the other Systems and the electronic drive unit, shade fabric and shade hardware of the Sivoia Shade System. If any manufacturing defect exists in the External Sivoia® QS Components, so long as Customer promptly notifies Lutron of the defect within the one year warranty period and, if requested by Lutron, returns the defective part(s), Lutron will, at its option, either repair the defective part(s) or provide comparable replacement part(s). If any manufacturing defect exists in any of the components of a System other than the External Sivoia Components, so long as Customer promptly notifies Lutron of the defect within the eight year warranty period and, if requested by Lutron, returns the defective part(s), Lutron will, at its option, either repair the defective part(s) or issue a credit to the Customer against the purchase price of comparable replacement part(s) purchased from Lutron as provided below: Replacement parts for the System provided by Lutron or, at its sole discretion, an approved vendor may be new, used, repaired, reconditioned, and/or made by a different manufacturer.

Number of years from date of shipment	Percentage of cost of replacement parts credited by Lutron
Up to 2	100%
More than 2 but not more than 5	50%
More than 5 but not more than 8	25%
More than 8	0%

EXCLUSIONS AND RESTRICTIONS

This Warranty will be void, and Lutron and its suppliers will have no responsibility under this Warranty, if Lutron or its representatives cannot access any components of the System to inspect, diagnose problems with or repair the System or any of its components as a result of concealment or inaccessibility of such components within a building structure.

This Warranty does not cover, and Lutron and its suppliers are not responsible for:

1. Damage, malfunction or inoperability diagnosed by Lutron or a Lutron approved third party as caused by normal wear and tear, abuse, misuse, incorrect installation, neglect, accident, interference or environmental factors, such as (a) use of incorrect line voltages fuses or circuit breakers; (b) failure to install, maintain and operate the System pursuant to the operating instructions provided by Lutron and the applicable provisions of the National Electrical Code and of the Safety Standards of Underwriter's Laboratories; (c) use of incompatible devices or accessories; (d) improper or insufficient ventilation; (e) unauthorized repairs or adjustments or alterations; (f) vandalism; (g) an act of God, such as fire, lightning, flooding, tornado, earthquake, hurricane or other problems beyond Lutron's control; or (h) direct exposure to corrosive materials.
2. On-site labor costs to diagnose issues with, and remove, repair, replace, adjust, reinstall and/or reprogram the System or any of its components.
3. Components and equipment external to the System, such as, non-Lutron lighting and automation systems; building wiring audio-visual equipment; and non-Lutron time clocks, photosensors and motion detectors.
4. The cost of repairing or replacing other property that is damaged when any System does not work properly, even if the damage was caused by the System.

THIS WARRANTY IS IN LIEU OF ALL OTHER EXPRESS WARRANTIES. ALL IMPLIED WARRANTIES, INCLUDING THE IMPLIED WARRANTIES OF MERCHANTABILITY AND OF FITNESS FOR A PARTICULAR PURPOSE, ARE LIMITED TO EIGHT YEARS FROM THE DATE OF SHIPMENT, EXCEPT THAT SUCH IMPLIED WARRANTIES ARE LIMITED TO ONE YEAR FROM THE DATE OF SHIPMENT AS TO THE EXTERNAL Sivoia COMPONENTS. NO LUTRON AGENT, EMPLOYEE OR REPRESENTATIVE HAS ANY AUTHORITY TO BIND LUTRON TO ANY AFFIRMATION, REPRESENTATION

OR WARRANTY CONCERNING THE SYSTEMS. UNLESS AN AFFIRMATION, REPRESENTATION OR WARRANTY MADE BY AN AGENT, EMPLOYEE OR REPRESENTATIVE IS SPECIFICALLY INCLUDED HEREIN, OR IN STANDARD PRINTED MATERIALS PROVIDED BY LUTRON, IT DOES NOT FORM A PART OF THE BASIS OF ANY BARGAIN BETWEEN LUTRON AND CUSTOMER AND WILL NOT IN ANY WAY BE ENFORCEABLE BY CUSTOMER.

IN NO EVENT WILL LUTRON OR ANY OTHER PARTY BE LIABLE FOR EXEMPLARY, CONSEQUENTIAL, INCIDENTAL OR SPECIAL DAMAGES (INCLUDING, BUT NOT LIMITED TO DAMAGES FOR PERSONAL INJURY, FAILURE TO MEET ANY DUTY, INCLUDING OF GOOD FAITH OR REASONABLE CARE, NEGLIGENCE, OR ANY OTHER LOSS WHATSOEVER), NOR FOR ANY REPAIR WORK UNDERTAKEN WITHOUT LUTRON'S PRIOR WRITTEN CONSENT ARISING OUT OF OR IN ANY WAY RELATED TO THE INSTALLATION, DEINSTALLATION, USE OF OR INABILITY TO USE THE SYSTEM OR OTHERWISE UNDER OR IN CONNECTION WITH ANY PROVISION OF THIS WARRANTY, EVEN IN THE EVENT OF THE FAULT, TORT (INCLUDING NEGLIGENCE), STRICT LIABILITY, BREACH OF CONTRACT OR BREACH OF WARRANTY OF LUTRON OR ANY OTHER PARTY, AND EVEN IF LUTRON OR SUCH OTHER PARTY WAS ADVISED OF THE POSSIBILITY OF SUCH DAMAGES. NOTWITHSTANDING ANY DAMAGES THAT CUSTOMER MIGHT INCUR FOR ANY REASON WHATSOEVER (INCLUDING, WITHOUT LIMITATION, ALL DIRECT DAMAGES AND ALL DAMAGES LISTED ABOVE), THE ENTIRE LIABILITY OF LUTRON AND OF ALL OTHER PARTIES UNDER THIS WARRANTY ON ANY CLAIM FOR DAMAGES ARISING OUT OF OR IN CONNECTION WITH THE MANUFACTURE, SALE, INSTALLATION, DELIVERY, USE, REPAIR, OR REPLACEMENT OF THE SYSTEM, AND CUSTOMER'S SOLE REMEDY FOR THE FOREGOING, WILL BE LIMITED TO THE AMOUNT PAID BY CUSTOMER FOR THE SYSTEM. THE FOREGOING LIMITATIONS, EXCLUSIONS AND DISCLAIMERS WILL APPLY TO THE MAXIMUM EXTENT ALLOWED BY APPLICABLE LAW, EVEN IF ANY REMEDY FAILS ITS ESSENTIAL PURPOSE.

THIS WARRANTY GIVES YOU SPECIFIC LEGAL RIGHTS. YOU MAY ALSO HAVE OTHER RIGHTS WHICH VARY FROM STATE TO STATE. SOME STATES DO NOT ALLOW LIMITATIONS ON HOW LONG AN IMPLIED WARRANTY LASTS OR THE EXCLUSION OR LIMITATION OF INCIDENTAL OR CONSEQUENTIAL DAMAGES, SO THE ABOVE LIMITATIONS OR EXCLUSIONS MAY NOT APPLY TO YOU. WARRANTY CLAIMS, TECHNICAL ASSISTANCE AND WARRANTY INFORMATION.

Contact the Lutron Technical Support Center at the numbers provided below or your local Lutron sales representative with questions concerning the installation or operation of the System or this Warranty, or to make a warranty claim. Please provide the exact model number when calling.

The product may be covered under one or more of the following U.S. patents: D456,783; and corresponding patents pending. U.S. and foreign patents pending. Lutron and the Sunburst logo are registered trademarks, and Sivoia® is a trademark of Lutron Electronics Co., Inc.

Worldwide Headquarters | USA

Lutron Electronics Co., Inc.
7200 Suter Road
Coopersburg, PA 18036-1299 USA
TEL: 1.610.282.3800
FAX: 1.610.282.3090
Technical Support: 1.800.523.9466 or 1.610.282.6701
Toll Free: 1.888.LUTRON
EMAIL: shadinginfo@lutron.com
WEB: www.lutron.com/shadingsolutions

Europe Headquarters | United Kingdom

Lutron EA Ltd
6 Sovereign Close
London, E1W 3JF, UK
TEL: +44.(0)20.7702.0657
FAX: +44.(0)20.7480.6899
Technical Support: +44.(0)20.7480.6899
FREEPHONE: 0800.282.107

Asian Headquarters | Singapore

Lutron GL Ltd
15 Hoe Chiang Road
#07-03
Singapore, 089316
TEL: +65.6220.4666
FAX: +65.6220.4333
Technical Support: 800.120.4491

©2009 LUTRON Electronics Co., Inc.
P/N 045-170 REV. A