

UNCLASSIFIED

REGRADED xstream BY AUTHORITY

OF E.O. 0501

BY [Signature]

ON 14 Jul

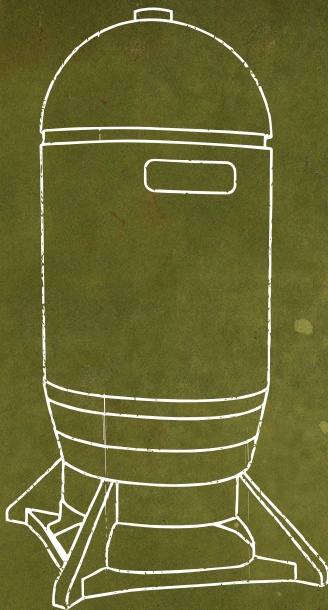
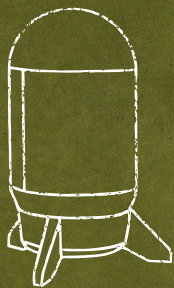

ENERGY STREAM™ M-21

FIELD OPERATIONS MANUAL

SECTION I: PREFACE

The circulation of this document shall be limited to those persons who are authorized to have the information in the performance of their personal entertainment duties.

This document contains guidelines pertaining to instruction and training in the mechanical operation of the EnergyXStream™ M-21 multimedia speaker system. Intended users include, but are not limited to, [REDACTED] gamers, music enthusiasts and others who will use this document as proper fortification to engage the M-21 in a highly successful, frontal audio assault.

[REDACTED]

The term "SUBWOOFER" refers to a loudspeaker designed for the specific reproduction of very low bass frequencies. The term "SATELLITE" refers to a loudspeaker designed for the specific reproduction of midrange and high frequencies. Actions regarding the placement, hookup, [REDACTED] and maintenance of the M-21 are as follows. Efforts were made to standardize hookup procedures and terminology.

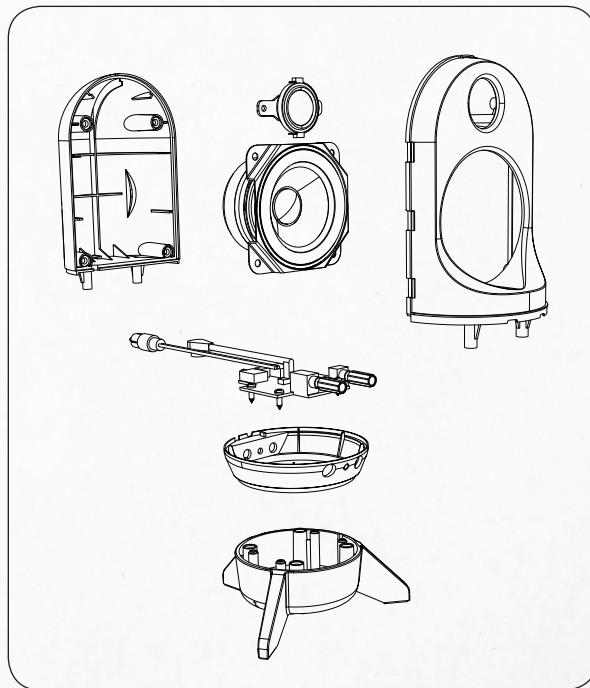

SECTION II: COMPONENT LIST

COMPONENT 1: SUBWOOFER

COMPONENT 2: SATELLITE, LEFT CHANNEL

COMPONENT 3: SATELLITE, RIGHT CHANNEL

(WITH SYSTEM CONTROLS AND CONNECTIONS)

COMPONENT 4: 3.5MM TO 3.5MM CORD

COMPONENT 5: RCA TO 3.5MM ADAPTER

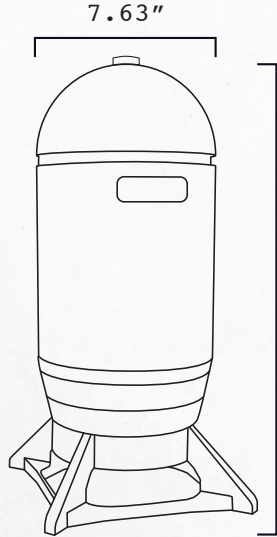

COMPONENT 1

19.25"



COMPONENT 2

3.5"

7.69"

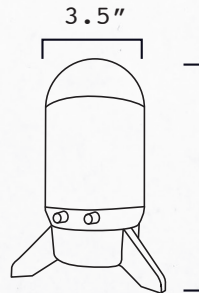

COMPONENT 3

3.5"

7.69"

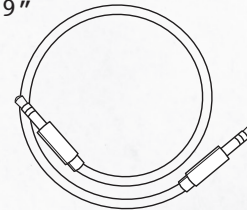

COMPONENT 4

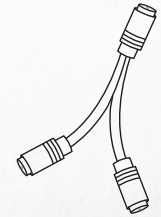

COMPONENT 5

SECTION III: ASSEMBLY

Assembly of the M-21 MUST be completed in the following manner to assure a decisive victory:

