



Klipsch[®]
REFERENCE

RSB-8

TABLE OF CONTENTS

- 1-2 - INSIDE
- 3-4 - SOUNDBAR
- 5 - SOUNDBAR PLACEMENT
- 6-9 - DTS® PLAY-FI™ WIRELESS STREAMING TECHNOLOGY
- 10 - HOW TO USE CONNECT
- 11 - CONNECTIONS - WIFI NETWORK
- 12 - CONNECTIONS - HDMI-ARC
- 13 - TURN HDMI CEC ON
- 13 - TURN OFF TV SPEAKERS
- 14 - CONNECTIONS - DIGITAL OPTICAL
- 15 - CONNECTIONS - 3.5MM AUXILIARY
- 16 - SUBWOOFER PLACEMENT
- 17 - SUBWOOFER WIRELESS CONNECTION
- 18 - SUBWOOFER RECONNECT
- 19-20 - REMOTE
- 21-22 - SURROUND MODES
- 23-24 - BLUETOOTH® WIRELESS TECHNOLOGY
- 25-26 - TV REMOTE PROGRAMMING
- 27 - REMOTE CONTROL CODES
- 28 - LED ON/OFF
- 29 - FACTORY RESET
- 29 - CARE AND CLEANING

INSIDE

CONTENU • CONTENIDO • INHALT • CONTENUTO • CONTEÚDO • 目录

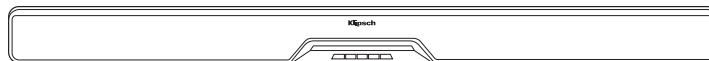

Soundbar

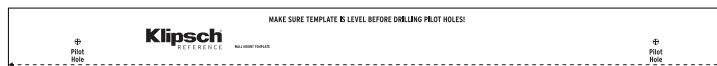

Wall-Mount Template

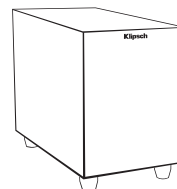

Subwoofer



Remote

<p>Soundbar</p> <p>Barre de son Barra de sonido Soundbar SoundBar Barra sonora 条形音箱</p>	<p>6.5" Subwoofer</p> <p>Caisson de graves Subwoofer Subwoofer Subwoofer Subwoofer 低音炮</p>	<p>Wall-Mount Template</p> <p>Gabarit de montage mural Plantilla de montaje en la pared Wandbefestigungsschablone Dima per il fissaggio a parete Modelo para instalação na parede 挂壁模板</p>	<p>Remote</p> <p>Télécommande Control remoto Fernbedienung Telecomando Control remoto 遥控器</p>
--------------------------------------------------------------------------------------------------------------------	-----------------------------------------------------------------------------------------------------------------------	-----------------------------------------------------------------------------------------------------------------------------------------------------------------------------------------------------------------------	--------------------------------------------------------------------------------------------------------------------------

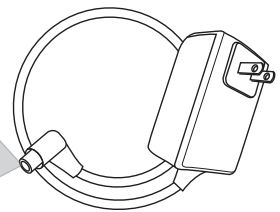
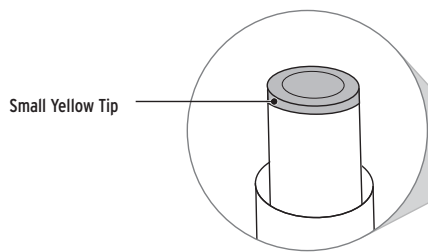

**DC Power Cord -
Soundbar**

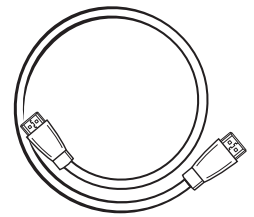

HDMI Cable

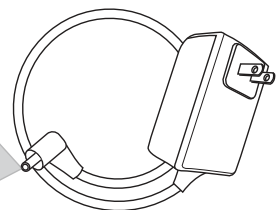
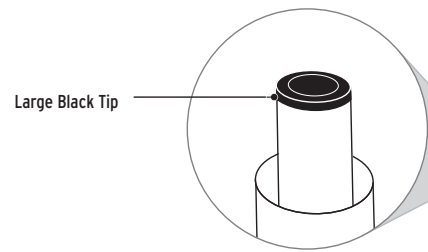

**DC Power Cord -
Subwoofer**

International Adapters Included.
 Adaptateurs Internationaux Inclus.
 Contiene Adaptadores Internacionales.
 Internationale Adapter Im Lieferumfang Enthalten.
 Sono Inclusi Adattatori Internazionali.
 Adaptadores Internacionais Incluídos.
 中国出售的产品不包括国际电源适配器

Large Black Tip	Small Yellow Tip	DC Power Cord	HDMI Cable
Grand embout noir Punta grande negra Große schwarze Spitze Punta nera grande Ponta preta grande 黑色粗端	Petit embout jaune Punta pequeña amarilla Kleine gelbe Spitze Punta gialla piccola Ponta amarela pequena 黄色细端	Cordon d'alimentation c.c. Cordón de alimentación de CC Gleichstromkabel Cavo di alimentazione CC Cabo de alimentação de CC 直流电源线	Câble HDMI Cable de HDMI HDMI-Kabel Cavo HDMI Cabo HDMI HDMI 电缆

SOUNDBAR

BARRE DE SON • BARRA DE SONIDO • SOUNDBAR • SOUNDBAR • BARRA SONORA • 条形音箱

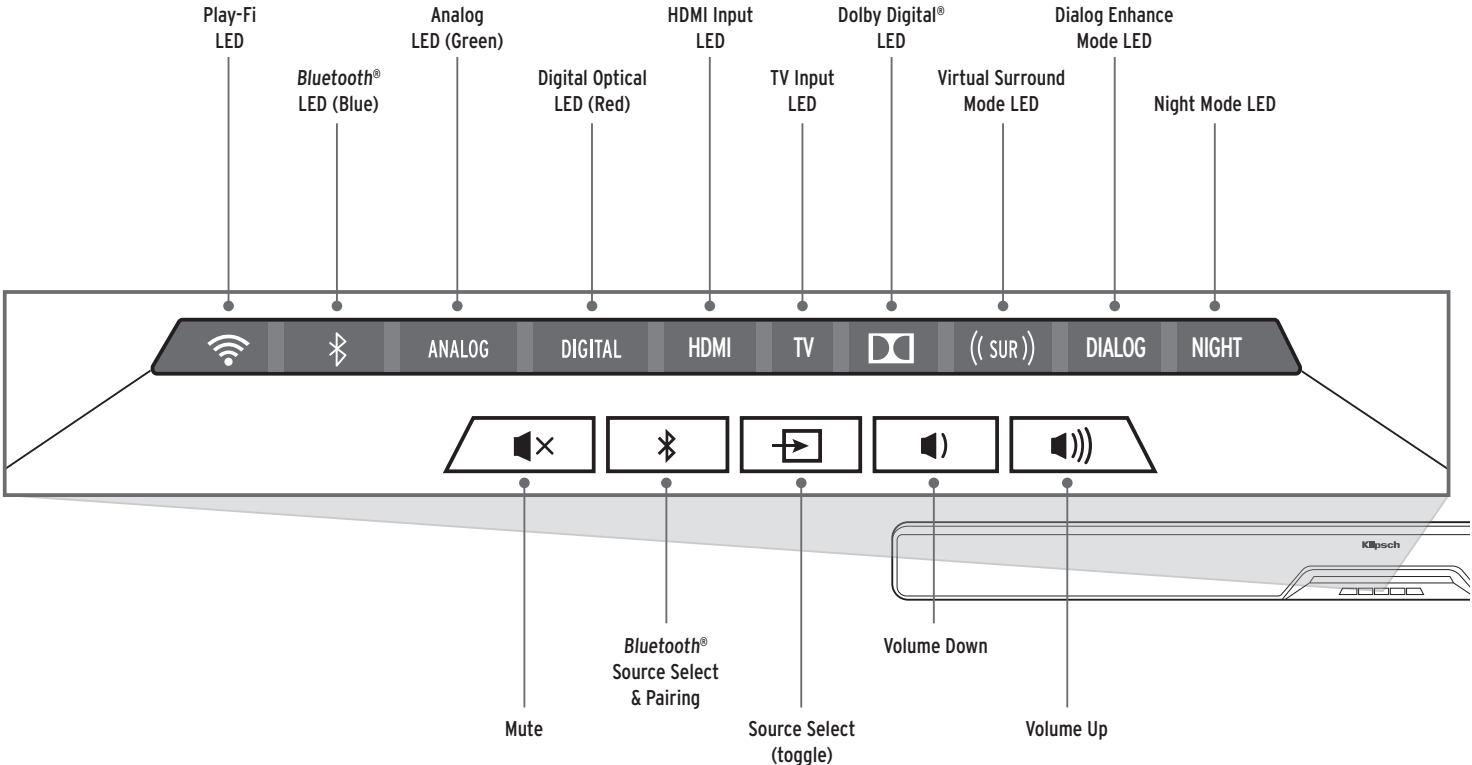

Mute Sourdine Silenciador Stummschaltung Disattivazione audio Desativar áudio 静音	Bluetooth® Source Select & Pairing Sélection de la source Bluetooth® et appariement Selección y vinculación de fuente Bluetooth® Bluetooth®-Quellenwahl und Pairing Selezione e associazione segnale Bluetooth® Seleção e emparelhamento de fonte Bluetooth® Bluetooth® 电源选择与配对	Source Select (Toggle) Sélection de la source (commutation) Selección de fuente (cíclica) Quellenwahl (Umschalten) Selezione segnale (in sequenza ciclica) Seleção da fonte (Alternar) 电源选择 (切换)	Volume Down Volume bas Bajada de volumen Leiser Riduzione volume Diminuir o volume 音量减小	Volume Up Volume haut Subida de volumen Lauter Aumento volume Aumentar o volume 音量增大
-----------------------------------------------------------------------------------------------------------	--------------------------------------------------------------------------------------------------------------------------------------------------------------------------------------------------------------------------------------------------------------------------------------------------------------	---------------------------------------------------------------------------------------------------------------------------------------------------------------------------------------------------------------------------	------------------------------------------------------------------------------------------------------------------	---------------------------------------------------------------------------------------------------------------

Play-Fi LED DEL Play-Fi LED de fuente Play-Fi Play-Fi-LED LED segnale Play-Fi LED do Play-Fi Play-Fi LED D	Bluetooth® LED (Blue) DEL Bluetooth (Bleu) LED de fuente Bluetooth (Azul) Bluetooth-LED (Blau) LED segnale Bluetooth (Blu) LED do Bluetooth (Azul) 蓝牙 LED 灯 (蓝色)	Analog LED (Green) DEL Analogique (Vert) LED de fuente analógica (Verde) Analog-LED (Grün) LED segnale analogico (Verde) LED analógico (Verde) 模拟 LED 灯 (绿)	Digital Optical LED (Red) DEL Optique numérique (Rouge) LED de fuente óptica digital (Rojo) Digital-optische LED (Rote) LED segnale ottico digitale (Rosso) LED ótico digital (Vermelho) 数字光学 LED 灯 (红)	HDMI 1 LED (White) DEL HDMI 1 Indicador LED de HDMI 1 HDMI-1-LED LED HDMI 1 LED HDMI 1 HDMI 1 LED
-------------------------------------------------------------------------------------------------------------------------------------	-------------------------------------------------------------------------------------------------------------------------------------------------------------------------------------------	--------------------------------------------------------------------------------------------------------------------------------------------------------------------------------------	----------------------------------------------------------------------------------------------------------------------------------------------------------------------------------------------------------------------------------	----------------------------------------------------------------------------------------------------------------------------

TV Source LED DEL Source TV Indicador LED de fuente de TV TV-Quellen-LED LED segnale TV LED de fonte - TV 电视电源 LED	Dolby Digital LED DEL Dolby Digital LED de Dolby Digital Dolby-Digital-LED LED segnale Dolby Digital LED Dolby Digital 杜比数字 LED 灯	Virtual Surround Mode LED DEL Mode ambiophonique virtuel LED de modalidad de surround virtual LED Virtueller Surroundmodus LED modalità surround virtuale LED do modo surround virtual 虚拟环绕声模式 LED 灯	Dialog Enhance Mode LED DEL Mode d'égalisation d'accentuation vocale LED de modalidad de equalización de mejoramiento de voz LED EQ-Modus für verbesserte Stimmen LED modalità equalizzatore potenziamento vocale LED do modo de EQ de melhoria de voz 音效增强均衡器模式 LED 灯	Night Mode LED DEL Mode nocturne LED de modalidad nocturna Nachtmodus-LED LED modalità notturna LED do modo noturno 夜间模式 LED 灯
---------------------------------------------------------------------------------------------------------------------------------------------	------------------------------------------------------------------------------------------------------------------------------------------------------------	-------------------------------------------------------------------------------------------------------------------------------------------------------------------------------------------------------------------------------	-------------------------------------------------------------------------------------------------------------------------------------------------------------------------------------------------------------------------------------------------------------------------------------------------	---------------------------------------------------------------------------------------------------------------------------------------------------------

SOUNDBAR PLACEMENT

POSITIONNEMENT DE LA BARRE DE SON • UBICACIÓN DE LA BARRA DE SONIDO • SOUNDBAR-PLATZIERUNG • COLLOCAZIONE DEL SOUNDBAR • POSIÇÃO DA BARRA SONORA • 条形音箱布置

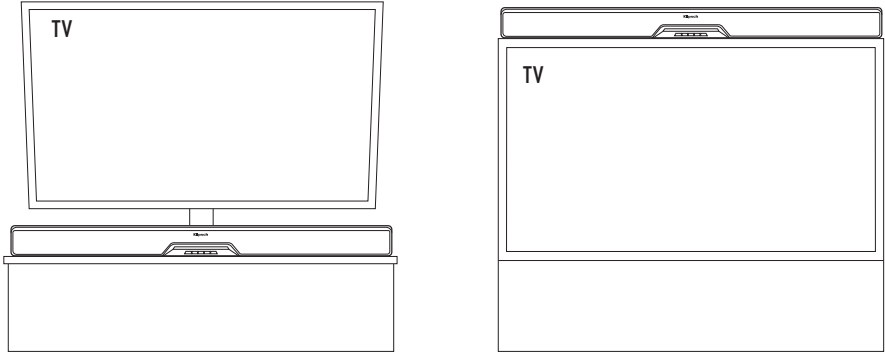
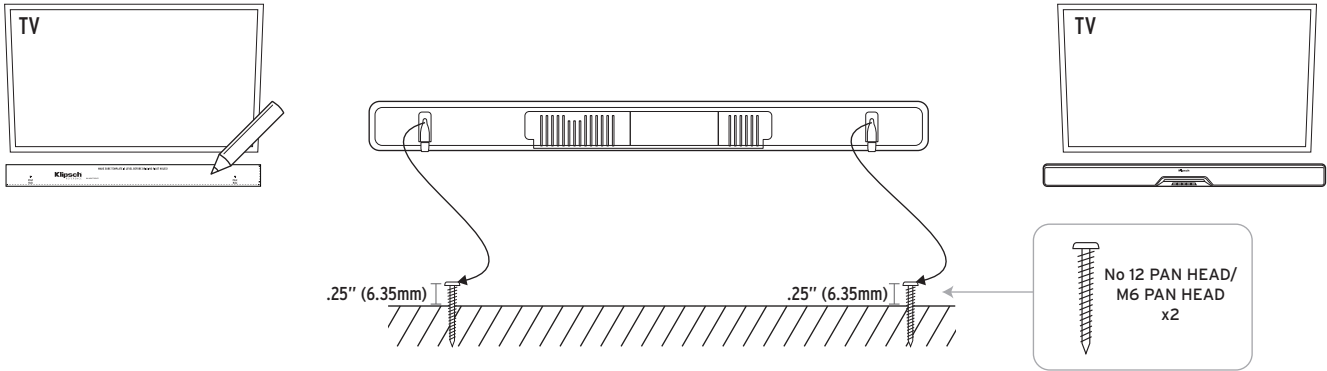

DTS PLAY-FI WIRELESS STREAMING TECHNOLOGY

TECNOLOGIE DE DIFFUSION SANS FIL DTS PLAY-FI • TECNOLOGÍA DE STREAMING INALÁMBRICO PLAY-FI DE DTS • DTS PLAY-FI DRAHTLOSE STREAMING-TECHNOLOGIE • TECNOLOGIA STREAMING WIRELESS DTS PLAY-FI • TECNOLOGIA DE STREAMING SEM FIO DTS PLAY-FI FIO DTS PLAY-FI • DTS PLAY-FI 无线串流技术

CONNECT TO YOUR WIFI NETWORK

The RSB-8 features DTS Play-Fi wireless multi-room streaming technology. Download the Klipsch Stream app, and listen to music from your personal library, internet streaming services like Tidal®, Pandora®, Spotify®, Amazon Prime Music®, iHeart Radio®, Sirius XM Radio, Deezer®, and independent internet radio stations like Disney, BBC, NPR, etc.

SE CONNECTER AU RÉSEAU Wi-Fi

Le RSB-8 est doté de la technologie de diffusion multi-pièce sans fil DTS Play-Fi. Téléchargez l'application Klipsch Stream et écoutez de la musique à partir de votre bibliothèque personnelle, des services de diffusion en ligne tels que Tidal®, Pandora®, Spotify®, Amazon Prime Music®, iHeart Radio®, Sirius XM Radio, Deezer®, et des stations de radio en ligne indépendantes telles que Disney, BBC, NPR, etc.

CONECTE A SU RED DE WiFi

El altavoz RSB-8 tiene tecnología de streaming inalámbrico multihabitación Play-Fi de DTS. Descargue la aplicación Klipsch Stream y escuche música de su biblioteca personal; sus servicios de streaming por Internet, tales como Tidal®, Pandora®, Spotify®, Amazon Prime Music®, iHeart Radio®, Sirius XM Radio, Deezer®, y sus emisoras de radio por Internet independientes, tales como Disney, BBC, NPR, etc.

VERBINDEN SIE IHR WLAN

Das RSB-8-System bietet die drahtlose Streaming-Technologie DTS Play-Fi für mehrere Räume. Laden Sie die App Klipsch Stream herunter und hören Sie Musik aus Ihrer persönlichen Bibliothek oder über Internet-Streaming-Dienste wie Tidal®, Pandora®, Spotify®, Amazon Prime Music®, iHeart Radio®, Sirius XM Radio, Deezer® und unabhängige Internet-Radiosender wie Disney, BBC, NPR, usw.

COLLEGAMENTO ALLA RETE WI-FI

Il SoundBar RSB-8 presenta la tecnologia streaming multi-sala wireless DTS Play-Fi. Scarica l'app Klipsch Stream e ascolta musica dalla tua collezione personale, da servizi di streaming Internet come Tidal®, Pandora®, Spotify®, Amazon Prime Music®, iHeart Radio®, Sirius XM Radio, Deezer® e da stazioni radio Internet indipendenti come Disney, BBC, NPR, ecc.

CONEXÃO À REDE WIFI

A RSB-8 tem tecnologia de streaming multi-ambientes sem fio DTS Play-Fi. Baixe o aplicativo Klipsch Stream e ouça músicas de sua biblioteca pessoal, serviços de streaming da internet, como Tidal®, Pandora®, Spotify®, Amazon Prime Music®, iHeart Radio®, Sirius XM Radio, Deezer®, e estações de rádio na internet independentes, como Disney, BBC, NPR, etc.

连接至您的WiFi 网络

RSB-8 支持 DTS Play-Fi 无线多房间串流技术。下载 Klipsch 串流应用程序，聆听源自您的个人音乐库，诸如 Tidal®、Pandora®、Spotify®、Amazon Prime Music®、iHeart Radio®、Sirius XM Radio、Deezer® 之类互联网串流服务以及类似 Disney、BBC、NPR 等独立互联网无线电台的音乐。

DTS PLAY-FI WIRELESS STREAMING TECHNOLOGY

TECNOLOGIE DE DIFFUSION SANS FIL DTS PLAY-FI • TECNOLOGÍA DE STREAMING INALÁMBRICO PLAY-FI DE DTS • DTS PLAY-FI DRAHTLOSE STREAMING-TECHNOLOGIE • TECNOLOGIA STREAMING WIRELESS DTS PLAY-FI • TECNOLOGIA DE STREAMING SEM TECNOLOGIA DE STREAMING SEM FIO DTS PLAY-FI FIO DTS PLAY-FI • DTS PLAY-FI 无线串流技术

NETWORK AND SYSTEM REQUIREMENTS

- WiFi Router 802.11g or better
- iOS device with version 6.0 operating system or newer
OR
Android Smartphone/tablet with version 2.2 operating system or newer
- The password to your home WiFi network (if you have a WPS-enabled router, you don't need this)

CONFIGURATIONS DE SYSTÈME ET DE RÉSEAU REQUIRES

- Router WiFi 802.11g ou meilleur
- appareil iOS avec système d'exploitation de version 6.0 ou plus récente
OU
Smartphone/tablette Android avec système d'exploitation de version 2.2 ou plus récente
- Le mot de passe du réseau Wi-Fi de votre domicile (si vous avez un routeur compatible WPS, vous n'en aurez pas besoin)

REQUISITOS DE RED Y SISTEMA

- Router WiFi 802.11g o más reciente
- Dispositivo iOS con sistema de operación versión 6.0 o más reciente
O BIEN
Teléfono inteligente o tableta Android con sistema de operación versión 2.2 o más reciente
- La contraseña de la red Wi-Fi de su casa (si tiene un router WPS, no necesita esto)

NETZWERK- UND SYSTEMANFORDERUNGEN

- WLAN-Router 802.11g oder besser
- iOS-Gerät mit Betriebssystem 6.0 oder neuer
ODER
Android-Smartphone/ Tablet mit Betriebssystem 2.2 oder neuer
- Das Passwort für Ihr WLAN (wenn Sie einen WPS-fähigen Router haben, benötigen Sie das nicht)

REQUISITI DI RETE E DI SISTEMA

- Router Wi-Fi 802.11g o superiore
- Dispositivo iOS con sistema operativo versione 6.0 o successiva
OPPURE
Smartphone/ tablet Android con sistema operativo versione 2.2 o successiva
- La password della rete Wi-Fi domestica (non necessaria se si usa un router compatibile con WPS)

REQUISITOS DE SISTEMA E REDE

- Roteador WiFi 802.11g ou melhor
- Dispositivo iOS com a versão 6.0 do sistema operacional ou mais recente
OU
Smartphone/tablet Android com a versão 2.2 do sistema operacional ou mais recente
- A senha da rede WiFi doméstica (se o roteador for habilitado para WPS, não é necessária)

网络和系统要求

- WiFi 路由器 802.11g 或更佳性能
- 带有 6.0 或更新版本操作系统的 iOS 装置 或 带有 2.2 或更新版本操作系统的 Android 智能手机/平板电脑
- 您家里 WiFi 网络的密码 (如果您拥有支持 WPS 的路由器, 则不需要此密码)

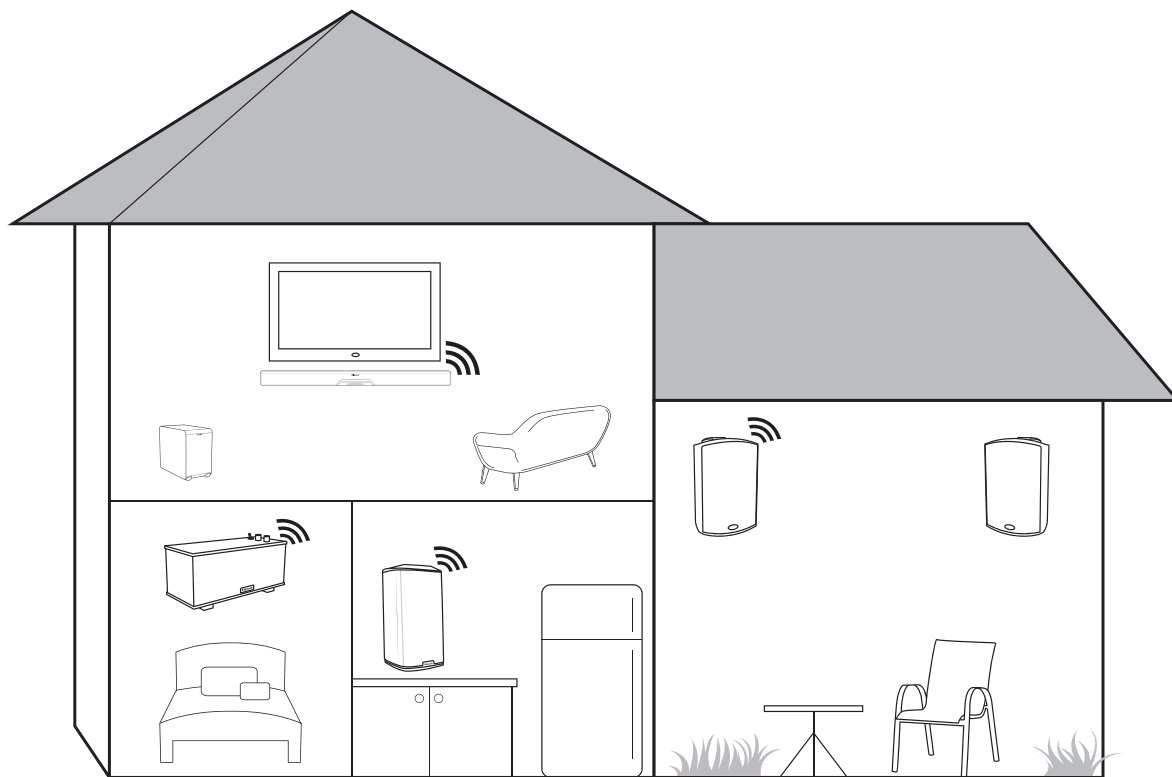

DTS PLAY-FI WIRELESS STREAMING TECHNOLOGY

TECNOLOGIE DE DIFFUSION SANS FIL DTS PLAY-FI • TECNOLOGÍA DE STREAMING INALÁMBRICO PLAY-FI DE DTS • DTS PLAY-FI DRAHTLOSE STREAMING-TECNOLOGIE • TECNOLOGIA STREAMING WIRELESS DTS PLAY-FI • TECNOLOGIA DE STREAMING SEM FIO DTS PLAY-FI FIO DTS PLAY-FI • DTS PLAY-FI 无线串流技术

ADD OTHER KLIPSCH WIRELESS MULTI-ROOM STREAMING SPEAKERS

From the Klipsch Stream app:

1. Choose "Settings"
2. Add "DTS Play-Fi Device"
3. Follow the instructions on your mobile device.

AJOUTER D'AUTRES HAUT-PARLEURS DE DIFFUSION MULTI-PIÈCES SANS FIL KLIPSCH

Dans l'application Klipsch Stream :

1. Choisir « Settings » (Réglages)
2. Ajouter « DTS Play-Fi Device » (Appareil DTS Play-Fi)
3. Suivez les instructions sur votre appareil mobile.

AGREGUE ALTAVOCES KLIPSCH DE STREAMING INALÁMBRICO MULTIHABITACIÓN

En la aplicación Klipsch Stream:

1. Escoja "Settings" (Configuraciones)
2. Agregue "DTS Play-Fi Device" (Dispositivo Play-Fi de DTS)
3. Siga las instrucciones que aparecen en su dispositivo móvil.

WEITERE DRAHTLOSE KLIPSCH-LAUTSPRECHER FÜR DAS STREAMING IN MEHREREN RÄUMEN HINZUFÜGEN

Gehen Sie in der App Klipsch Stream folgendermaßen vor:

1. Wählen Sie „Settings“ (Einstellungen)
2. Fügen Sie „DTS Play-Fi Device“ (DTS Play-Fi-Gerät) hinzu
3. Folgen Sie den Anweisungen auf Ihrem Mobilgerät.

PER AGGIUNGERE ALTRI ALTOPARLANTI STREAMING MULTISALA WIRELESS KLIPSCH

Dall'app Klipsch Stream:

1. Scegliere "Settings" (Impostazioni).
2. Aggiungere "DTS Play-Fi Device" (Dispositivo DTS Play-Fi).
3. Seguire le istruzioni sul dispositivo mobile.

ADIÇÃO DE OUTRAS CAIXAS ACÚSTICAS DE STREAMING MULTIAMBIENTES SEM FIO DA KLIPSCH

No aplicativo Klipsch Stream:

1. Escolha "Settings" (Configurações).
2. Adicione "DTS Play-Fi Device" (Dispositivo DTS Play-Fi).
3. Siga as instruções exibidas no dispositivo móvel.

从 Klipsch 串流应用程序

添加其他 Klipsch 无线多房间串流扬声器：

1. 选择“设置”
2. 添加“DTS Play-Fi 装置”
3. 遵循移动装置上的说明进行操作。

HOW TO USE CONNECT



You'll need Spotify Premium to use Connect, see details overleaf.

1. Add your new device to the same wifi network as your phone, tablet or PC (see product user instructions for details).

2. Open the Spotify app on your phone, tablet or PC, and play any song.

3. If you're using the app on a phone - tap the song image in the bottom left of the screen. For tablet and PC move to step 4.

4. Tap the Connect icon 

5. Pick your device from the list. If you can't see it, just check it's connected to the same wifi network as your phone, tablet or PC.

All done! Happy listening.

Licenses

The Spotify Software is subject to third party licenses found here:

www.spotify.com/connect/third-party-licenses.

CONNECTIONS - WIFI NETWORK (NOTE: PLAY-FI REQUIRES USE OF AN 802.11G WIRELESS ROUTER OR BETTER)

CONNEXIONS - RÉSEAU WI-FI (REMARQUE : PLAY-FI NÉCESSITE L'UTILISATION D'UN ROUTEUR SANS FIL 802.11G OU MIEUX) • CONEXIONES - RED WI-FI (NOTA: PLAY-FI REQUIERE UN ROUTER INALÁMBRICO 802.11G O MÁS RECIENTE) • ANSCHLÜSSE - WLAN (HINWEIS: PLAY-FI ERFORBERT DIE VERWENDUNG EINES WLAN-ROUTERS NACH DER NORM 802.11G ODER BESSER) • CONNESSIONI - RETE WI-FI (NOTA: PLAY-FI RICHIEDE L'USO DI UN ROUTER WIRELESS 802.11G O SUPERIORE) • CONEXÕES - REDE WIFI (OBSERVAÇÃO: O PLAY-FI REQUER O USO DE UM ROTEADOR SEM FIO 802.11G OU MELHOR) • 连接 - WIFI 网络 备注 : PLAY-FI 需要使用 802.11G 或性能更好的无线路由器

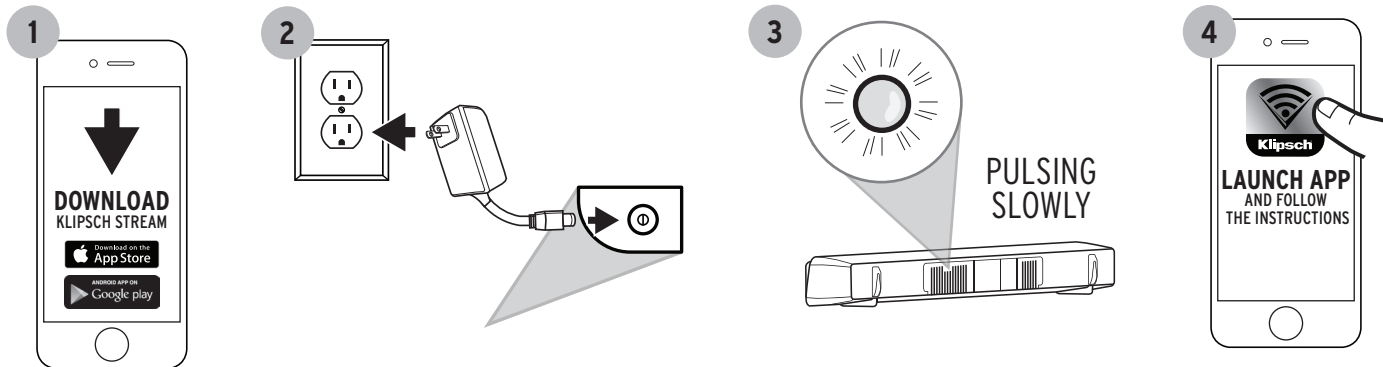

IF

ICON IS NOT PULSING
 SI L'ICÔNE NE CLIGNOTE PAS
 SI EL ICONO NO ESTÁ OSCILANDO
 WENN SYMBOL NICHT BLINKT
 SE L'ICONA NON LAMPEGGIA
 SE O ÍCONE NÃO ESTIVER PULSANDO
 如果图标未脉动

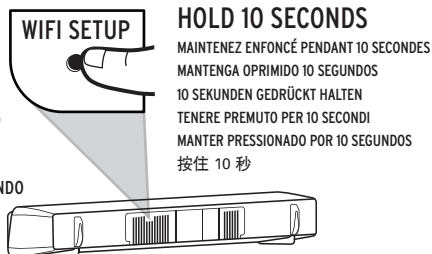

IF

YOU HAVE A WPS ROUTER
 SI VOUS AVEZ UN ROUTEUR WPS
 SI TIENE UN ROUTER WPS
 WENN SIE EINEN WPS-ROUTER
 HABEN
 SE SI USA UN ROUTER WPS
 SE O ROTEADOR FOR WPS
 如果您拥有 WPS 路由器

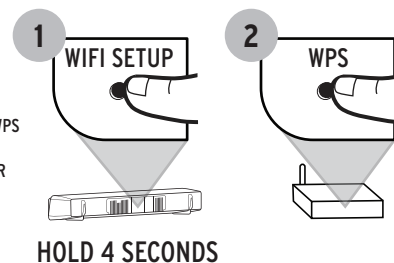

CONNECTIONS - HDMI-ARC

CONNEXIONS - HDMI-ARC • CONEXIONES - HDMI-ARC • ANSCHLÜSSE - HDMI-ARC • CONNESSIONI - HDMI-ARC • CONEXÕES - HDMI-ARC • 连接 - HDMI-ARC

A Basic TV HDMI input will not transfer the TV audio signal to the Soundbar. The RSB-8 Soundbar will only receive TV audio through HDMI-ARC (with CEC turned ON), Optical or Analog connection.

Une entrée TV HDMI de base ne transférera pas le signal audio TV vers la barre de son. La barre de son RSB-8 ne recevra l'audio TV qu'au moyen d'une connexion HDMI-ARC (avec CEC sur MARCHÉ (ON)), Optique ou Analogique.

Una entrada básica de HDMI de una TV no transfiere la señal de audio de la TV a la barra de sonido. La barra de sonido RSB-8 solo recibirá el audio de la TV a través de una conexión óptica o analógica de tipo HDMI-ARC (con el CEC encendido).

Ein einfacher HDMI-Eingang kann das TV-Audiosignal nicht an die Soundbar übertragen. Die RSB-8 Soundbar kann das das TV-Audiosignal nur über HDMI-ARC (bei aktiviertem CEC), eine optische oder analoge Verbindung empfangen.

Il normale input televisivo HDMI non permette di trasmettere i segnali audio televisivi alla soundbar. La soundbar RSB-8 riceve i segnali audio televisivi soltanto dai connettori HDMI-ARC (con CEC impostata su ON), ottici o analogici.

Uma entrada HDMI TV básica não transfere o sinal de áudio da TV para a barra de som. A barra de som RSB-8 recebe áudio da TV somente através de uma conexão HDMI-ARC (com CEC ligado), óptica ou analógica.

一个基本的电视 HDMI 输入端不会将电视音频信号传送到声霸扬声器。RSB-8 声霸扬声器只能通过 HDMI-ARC (CEC 打开状态下) 接收电视音频、光学或类比信号。

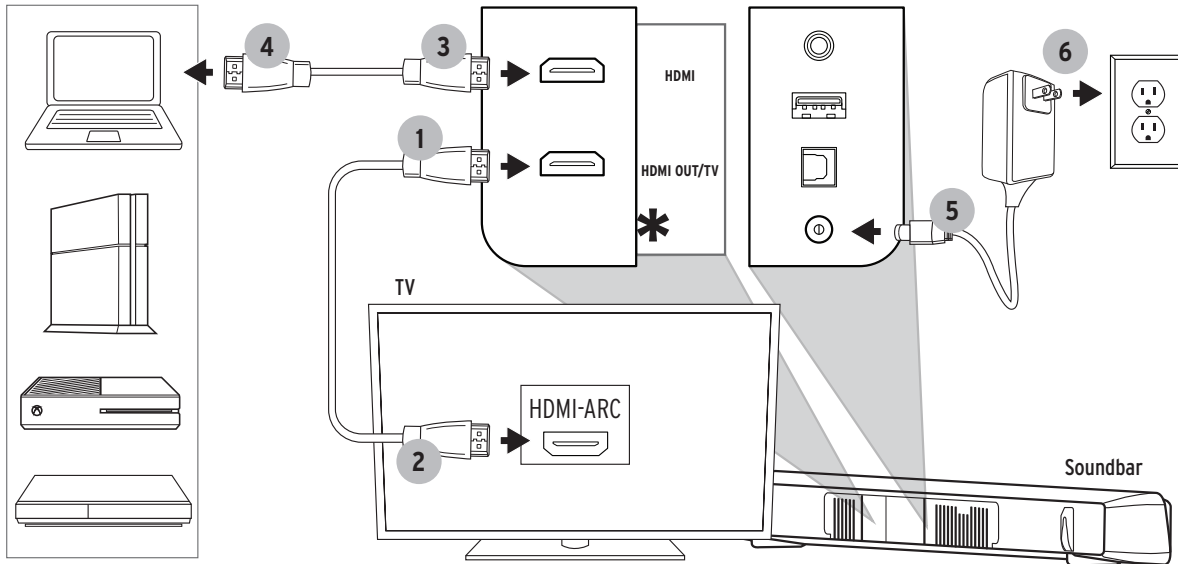

TURN HDMI CEC ON (OFF BY DEFAULT)

ALLUMER HDMI CEC (ÉTEINT PAR DÉFAUT) • ACTIVACIÓN DEL CEC DE HDMI (PREDETERMINADAMENTE DESACTIVADO) • HDMI-CEC EINSCHALTEN (NORMALERWEISE AUS) • ATTIVAZIONE DI HDMI CEC (DISATTIVATA PER IMPOSTAZIONE PREDEFINITA)
 COMO LIGAR O HDMI CEC (DESLLIGADO POR PADRÃO) • 开启 HDMI CEC 功能 (默认关闭)

1 Hold 3 seconds



Hold 3 Seconds

Appuyer pendant 3 secondes
 Mantenga oprimido durante 3 segundos
 3 Sekunden gedrückt halten
 Tenere premuto per 3 secondi
 Manter pressionado por 3 segundos
 保持 3 秒

Current Source Flashes

La source active clignote
 La fuente activa destella
 Aktuelle Quelle blinkt
 La sorgente in funzione lampeggia
 A fonte atual piscará
 当前源闪烁

2 Current Source Flashes 2X

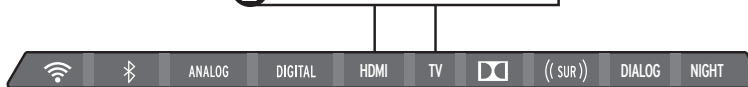

Repeat Steps to Turn Off

Répétez les étapes pour éteindre
 Repita los pasos para desactivar
 Zum Ausschalten Schritte wiederholen
 Ripetere i passaggi per disattivare
 Repita o mesmo procedimento para desligar
 重复步骤以关闭

Current Source Flashes 3X

NOTE CEC must be turned ON to enable audio through an HDMI-ARC connection

REMARQUE CEC doit être sur MARCHÉ (ON) pour activer l'audio sur une connexion HDMI-ARC.

NOTA El CEC debe estar encendido para permitir que el audio pase a través de una conexión de HDMI-ARC

HINWEIS CEC muss EINGESCHALTET sein, damit Audio über eine HDMI-ARC-Verbindung möglich ist

N.B. per consentire la trasmissione dei segnali audio attraverso i connettori HDMI-ARC è necessario che la funzione CEC sia ON.

OBSERVAÇÃO O CEC deve estar ligado para permitir que o áudio seja transmitido através de uma conexão HDMI-ARC.

注 CEC 必须要打开才能激活音频信号传送至HDMI-ARC 端的功能。

TURN OFF TV SPEAKERS

MISE HORS TENSION DES HAUT-PARLEURS DU TÉLÉVISEUR • APAGADO DE LOS ALTAVOCES DEL TELEVISOR • TV-LAUTSPRECHER DEAKTIVIEREN • SPEGNIMENTO DEGLI ALTOPARLANTI DEL TELEVISORE
 DESLIGUE OS ALTO-FALANTES DA TV • 关闭电视机扬声器

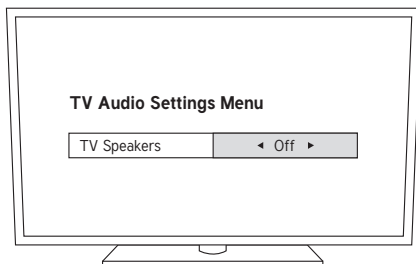

(Recommended)

OR

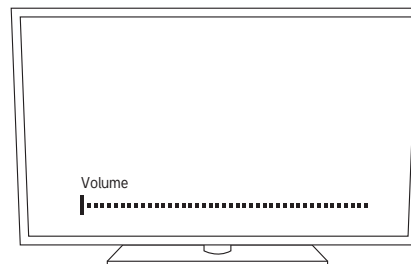

CONNECTIONS - DIGITAL OPTICAL (IF TV HAS NO OPTICAL OUT SEE NEXT PAGE)

CONEXÕES - ÓTICA DIGITAL (SE A TV NÃO TIVER SAÍDA ÓTICA, CONSULTE A PRÓXIMA PÁGINA) • CONEXIONES - DIGITAL ÓPTICA (SI EL TELEVISOR NO TIENE SALIDA ÓPTICA, VEA LA PÁGINA SIGUIENTE.) • ANSCHLÜSSE - DIGITAL-OPTISCH (WENN TV KEINEN OPTISCHEN AUSGANG HAT, SIEHE NÄCHSTE SEITE) • CONNESSIONI - OTTICA DIGITALE (SE IL TELEVISORE NON HA UN'USCITA OTTICA, VEDERE ALLA PAGINA SUCCESSIVA) • CONEXÕES - ÓTICA DIGITAL (SE A TV NÃO TIVER SAÍDA ÓTICA, CONSULTE A PRÓXIMA PÁGINA) • 连接 - 数字光学 (如果电视没有光学输出, 请参见下一页)

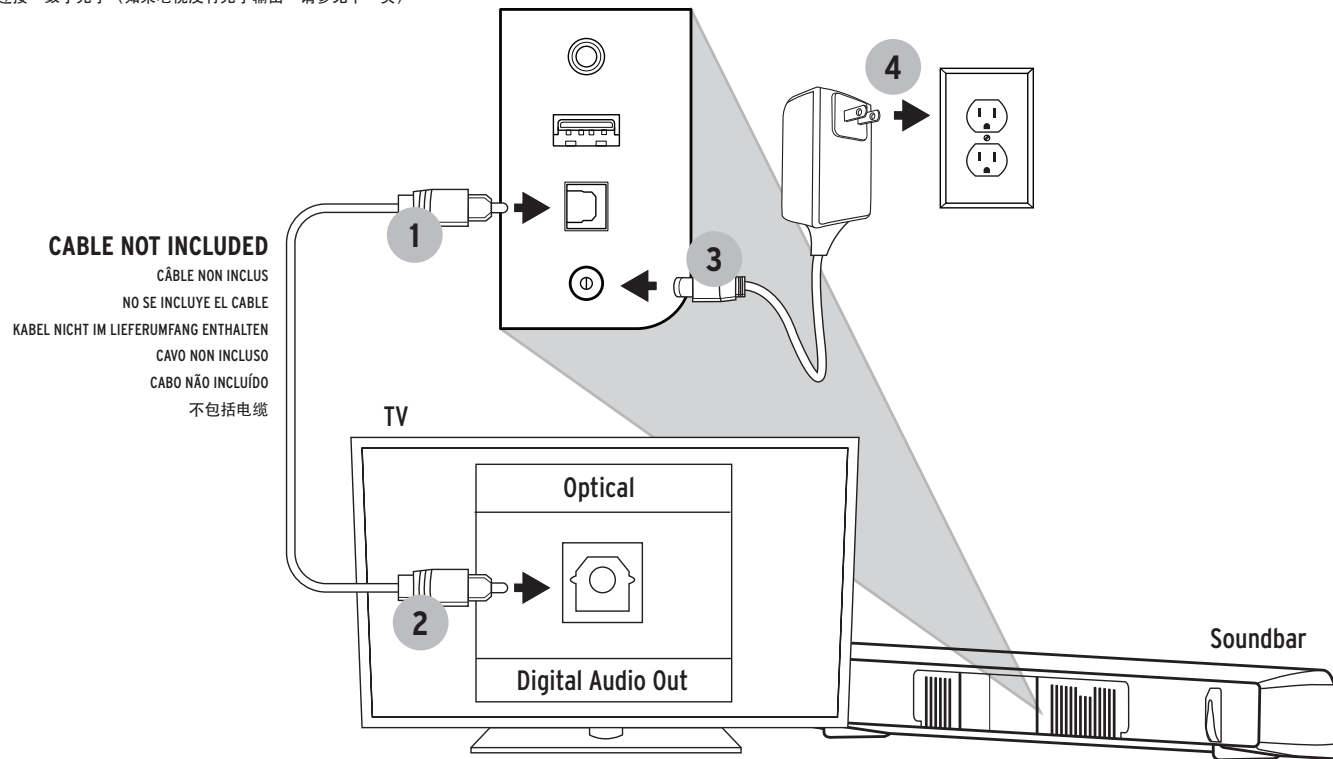

CONNECTIONS - 3.5mm AUXILIARY

CONNEXIONS - AUXILIAIRE 3,5MM • CONEXIONES - 3.5 MM AUXILIAR • ANSCHLÜSSE - 3,5-MM-AUX • CONNESSIONI - INGRESSO AUSILIARIO DA 3,5 MM • CONEXÕES - AUXILIAR DE 3,5 MM • 连接 - 3.5MM 辅助电缆

CABLE NOT INCLUDED
CÂBLE NON INCLUS
NO SE INCLUYE EL CABLE
KABEL NICHT IM LIEFERUMFANG
ENTHALTEN
CAVO NON INCLUSO
CABO NÃO INCLuíDO
不包括电缆

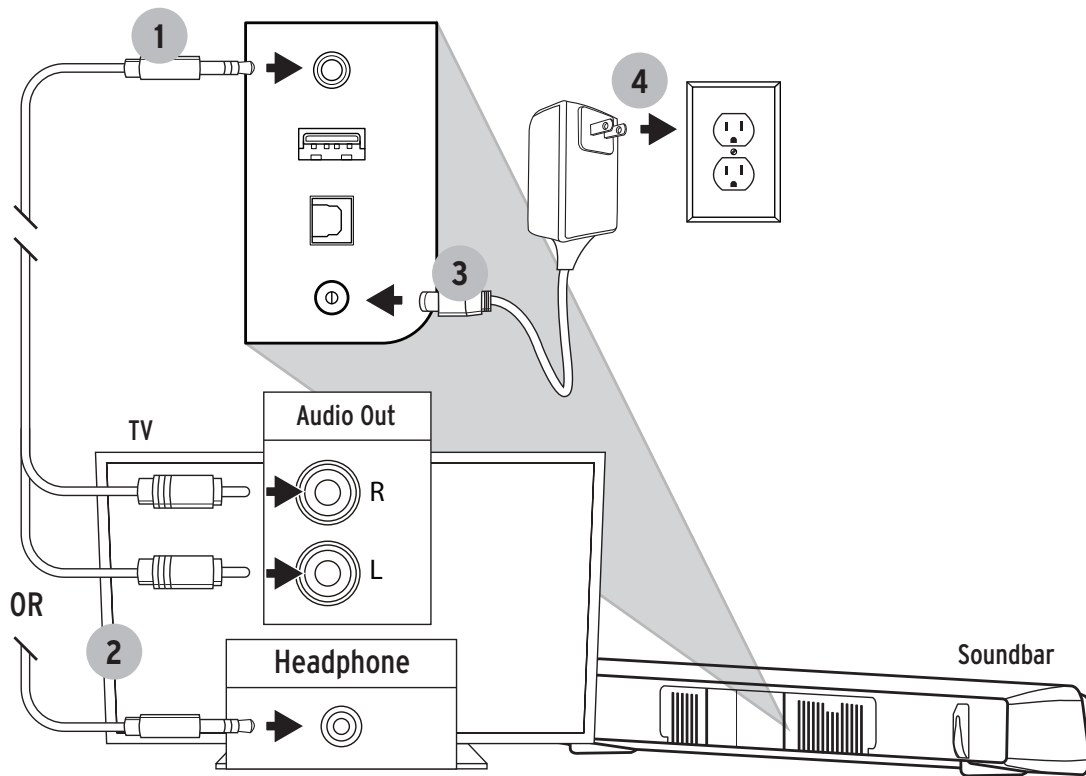

SUBWOOFER PLACEMENT

POSITIONNEMENT DU CAISSON DE GRAVES • UBICACIÓN DEL SUBWOOFER • SUBWOOFER-PLATZIERUNG • COLLOCAZIONE DEL SUBWOOFER • POSIÇÃO DO SUBWOOFER • 低音炮布置

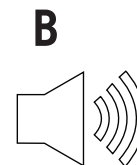
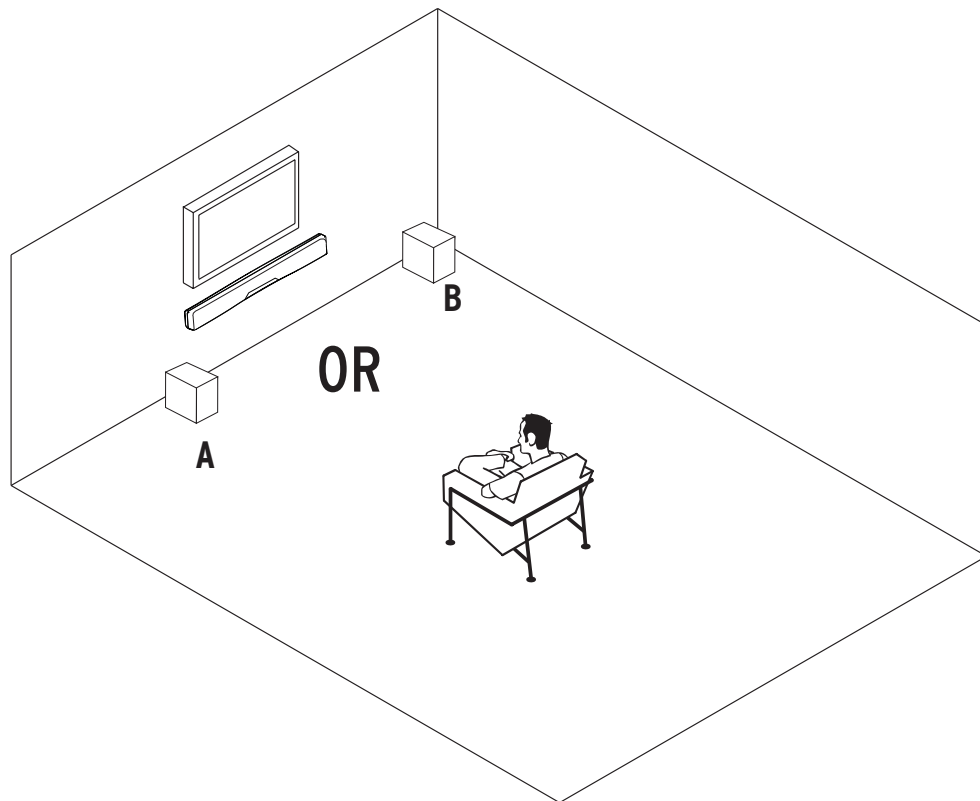

SUBWOOFER WIRELESS CONNECTION

CONNEXION SANS FIL DU CAISSON DE GRAVES • CONEXIÓN INALÁMBRICA DEL SUBWOOFER • DRAHTLOSE VERBINDUNG ZUM SUBWOOFER • CONNESSIONE WIRELESS CON IL SUBWOOFER • CONEXÃO SEM FIO DO SUBWOOFER • 低音炮无线连接

1 Soundbar - Power On



30 ft. (9m)
MAX

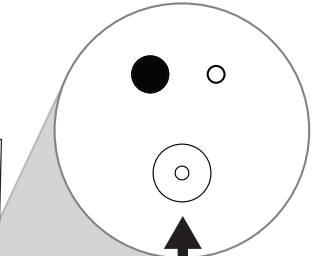
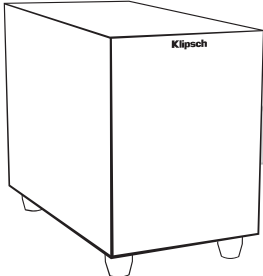

2

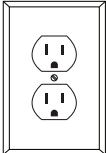

3

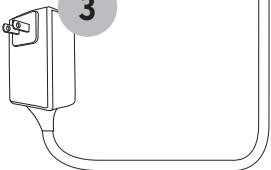

SUBWOOFER RECONNECT

RECONNECTER • RECONECTAR • ERNEUT VERBINDEN • RICONNESSIONE • RECONECTAR • 重新连接

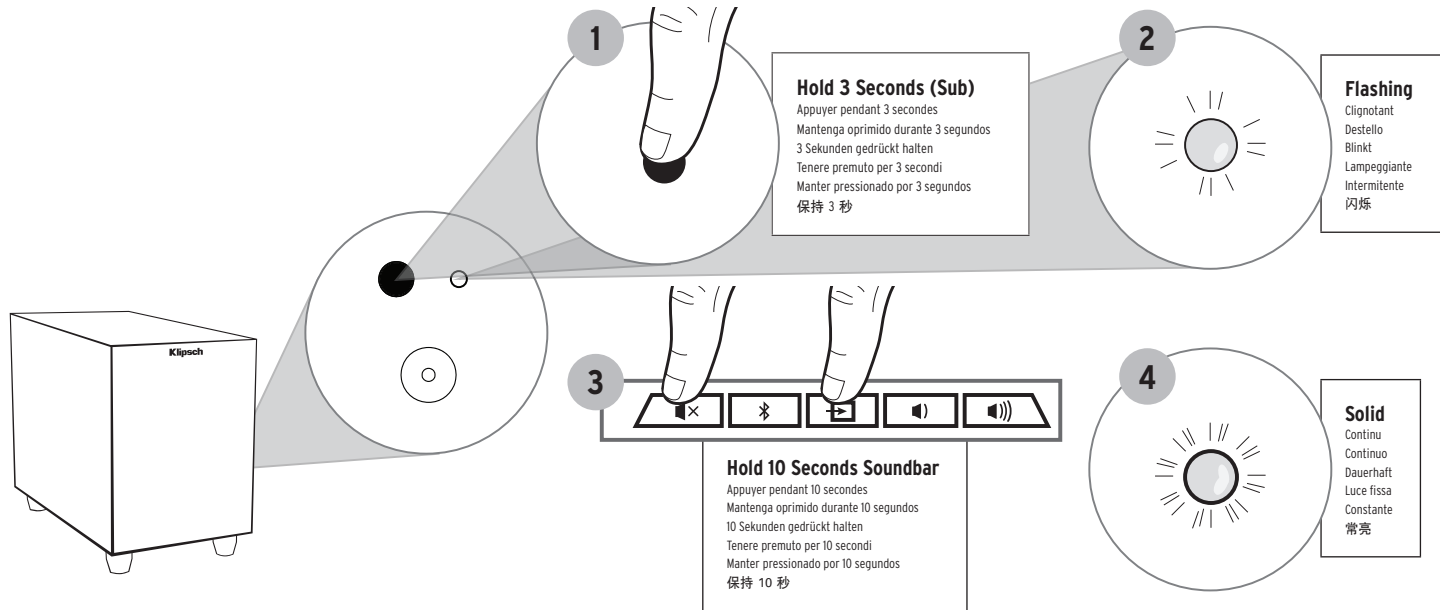

REMOTE

TÉLÉCOMMANDE • CONTROL REMOTO • FERNBEDIENUNG • TELECOMANDO • CONTROLE REMOTO • 遙控器

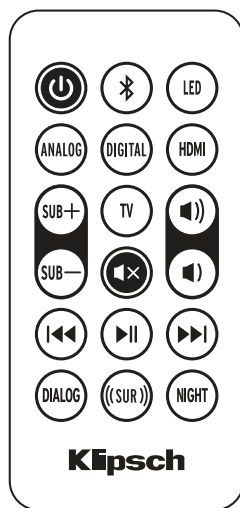

 Bluetooth® Source Select

 On/Off

 LEDs On/Off (Soundbar)

 Dialog Enhance Mode On/Off

 Virtual Surround Mode On/Off

 Night Mode On/Off



 Analog Source Select



 Digital Optical Source Select

 TV Source Select (HDMI-ARC)

 HDMI Source Select

 Track Backward
 Play/Pause
 Track Forward

 Subwoofer Level Down
 Subwoofer Level Up

 System Volume Up
 System Volume Down

 Mute

<p>Bluetooth® Source Select</p> <p>Sélection de la source Bluetooth® Selección de fuente Bluetooth® Bluetooth®-Quellenwahl Selezione segnale Bluetooth® Seleção de fonte Bluetooth® 蓝牙源选择</p>	<p>On / Off</p> <p>Sous tensio / Hors tension Encendido / Apagado Ein / Aus Acceso / Spento Ligar / Desligar 开/关</p>	<p>LEDs On/Off (Soundbar)</p> <p>Volume haut - Caisson de graves Subida de volumen - Subwoofer Lauter - Subwoofer Aumento volume - Subwoofer Aumentar o volume- Subwoofer 音量增大</p>	<p>Analog Source Select</p> <p>Sélection de la source analogique Selección de fuente analógica Analog-Quellenwahl Selezione segnale analogico Seleção de fonte analógica 模拟源选择</p>	<p>Digital Optical Source Select</p> <p>Sélection de la source optique numérique Selección de fuente óptica digital Digital-optische Quellenwahl Selezione segnale ottico digitale Seleção de fonte ótica digital 数字光学源选择</p>	<p>TV Source Select</p> <p>Sélection de la source TV Selección de fuente Televisor TV-Quellenwahl Selezione segnale TV Seleção de fonte TV 电视源选择</p>
-----------------------------------------------------------------------------------------------------------------------------------------------------------------------------------------------------------------------------------------------------------------------	----------------------------------------------------------------------------------------------------------------------------------------------------------------------------------------------	------------------------------------------------------------------------------------------------------------------------------------------------------------------------------------------------------------------------------------------------------------	------------------------------------------------------------------------------------------------------------------------------------------------------------------------------------------------------------------------------------------------------------	-------------------------------------------------------------------------------------------------------------------------------------------------------------------------------------------------------------------------------------------------------------------------------------------------------	------------------------------------------------------------------------------------------------------------------------------------------------------------------------------------------------------------------------------

<p>Dialog Enhance Mode On/Off</p> <p>Marche/Arrêt Mode d'égalisation d'accentuation vocale Activación/desactivación de ecuación de mejoramiento de voz EQ-Modus für verbesserte Stimmen Ein/Aus Equalizzatore potenziamento vocale On/Off Ativar/desativar o modo de EQ de melhoria de voz 音效增强均衡器开/关</p>	<p>Virtual Surround Mode On/Off</p> <p>Marche/Arrêt Mode ambiophonique virtuel Activación/desactivación de modalidad de surround virtual Virtueller Surroundmodus Ein/Aus Modalità surround virtuale On/Off Ativar/desativar o modo surround virtual 虚拟环绕声模式开/关</p>	<p>Night Mode On/Off</p> <p>Marche/Arrêt Mode nocturne Activación/desactivación de modalidad nocturna Nachtmodus Ein/Aus Modalità notturna On/Off Ativar/desativar o modo noturno 夜间模式开/关</p>	<p>HDMI Source Select</p> <p>Sélection de la source HDMI Selección de fuente HDMI HDMI Quellenwahl Selezione segnale HDMI Seleção de fonte HDMI HDMI 源选择</p>
-----------------------------------------------------------------------------------------------------------------------------------------------------------------------------------------------------------------------------------------------------------------------------------------------------------------------------------------------------------------------------------	---------------------------------------------------------------------------------------------------------------------------------------------------------------------------------------------------------------------------------------------------------------------------------------------------------------------------------------------	-----------------------------------------------------------------------------------------------------------------------------------------------------------------------------------------------------------------------------------------------------------------------	--------------------------------------------------------------------------------------------------------------------------------------------------------------------------------------------------------------------------------------

<p>Track Backward</p> <p>Reculer Retroso de pista Voriger Titel Brano precedente Retroceder 快退</p>	<p>Play/Pause</p> <p>Lecture/pause Reproducción/pausa Wiedergabe/Pause Riproduzione / Pausa Reproduzir/Pausar 播放/暂停</p>	<p>Track Foward</p> <p>Avancer Avance de pista Nächster Titel Brano successivo Avançar 快进</p>	<p>Subwoofer Level Down</p> <p>Volume bas - Caisson de graves Bajada de volumen - Subwoofer Leiser - Subwoofer Riduzione volume - Subwoofer Diminuir o volume - Subwoofer 音量减小</p>	<p>Subwoofer Level Up</p> <p>Volume haut - Caisson de graves Subida de volumen - Subwoofer Lauter - Subwoofer Aumento volume - Subwoofer Aumentar o volume- Subwoofer 音量增大</p>	<p>System Volume Up</p> <p>Volume haut Subida de volumen Lauter Aumento volume Aumentar o volume 音量增大</p>	<p>Mute</p> <p>Sourdiere Silenciador Stummschaltung Disattivazione audio Desativar áudio 静音</p>	<p>System Volume Down</p> <p>Volume bas Bajada de volumen Leiser Riduzione volume Diminuir o volume 音量减小</p>
----------------------------------------------------------------------------------------------------------------------------------------------------------------------------	-------------------------------------------------------------------------------------------------------------------------------------------------------------------------------------------------	-----------------------------------------------------------------------------------------------------------------------------------------------------------------------	------------------------------------------------------------------------------------------------------------------------------------------------------------------------------------------------------------------------------------------------------------	--------------------------------------------------------------------------------------------------------------------------------------------------------------------------------------------------------------------------------------------------------	-----------------------------------------------------------------------------------------------------------------------------------------------------------------------------------	-------------------------------------------------------------------------------------------------------------------------------------------------------------------------	--------------------------------------------------------------------------------------------------------------------------------------------------------------------------------------

SURROUND MODES

MODES AMBIPHONIQUES • MODALIDADES SURROUND • SURROUND-MODI • MODALITÀ SURROUND • MODOS SURROUND • 环绕声模式



DOLBY AUDIO™

- Only active if receiving a Dolby® Digital signal
- Manufactured under license from Dolby Laboratories. Dolby, Dolby Audio and the double-D symbol are trademarks of Dolby Laboratories

DOLBY AUDIO™

- Actif seulement avec réception d'un signal Dolby Digital

DOLBY AUDIO™

- Activa solo cuando hay señal Dolby Digital

((SUR))

VIRTUAL SURROUND MODE

- Klipsch Custom DSP
- Independent of the EQ settings (Natural, Voice, Night)
- Can be **ON** regardless of Dolby Digital status

MODE AMBIPHONIQUE VIRTUEL

- DSP personnalisé de Klipsch
- Indépendant des réglages d'égaliseur (Naturel, accentuation vocale, nocturne)
- Peut être en marche indépendamment du statut Dolby Digital

MODALIDAD DE SURROUND VIRTUAL

- Procesador de Señal Digital (Digital Signal Processor, DSP) personalizado de Klipsch
- Independiente de las configuraciones de equalización (natural, mejoramiento de voz, nocturna)
- Puede estar activa independientemente del estado de Dolby Digital

DIALOG

DIALOG ENHANCE MODE

- Optimizes EQ for Dialog
- Can be **ON** regardless of Dolby Status or Virtual Surround Mode
- Only one EQ profile active at one time (Natural, Dialog Enhanced, or Night)

MODE D'ÉGALISATION D'ACCENTUATION VOCALE

- Optimise l'égalisation pour les dialogues
- Peut être en marche indépendamment du statut Dolby Digital
- Seulement un profil d'égalisation actif à la fois (Naturel, accentuation vocale ou nocturne)

MODALIDAD DE ECUALIZACIÓN DE MEJORAMIENTO DE VOZ

- Optimiza la equalización para el diálogo
- Puede estar activa independientemente del estado de Dolby Digital
- Puede haber solo un perfil de equalización activo a la vez (natural, mejoramiento de voz, nocturno)

NIGHT

NIGHT MODE

- Reduces Dynamic Range
- Subwoofer OFF
- Can be **ON** regardless of Dolby Status or Virtual Surround Mode
- Only one EQ profile active at one time (Natural, Voice Enhanced, or Night)

MODE NOCTURNE

- Réduit la gamme dynamique
- Haut-parleur d'extrêmes graves désactivé
- Peut être en marche indépendamment du statut Dolby Digital
- Un seul profil d'égalisation actif à la fois (Naturel, accentuation vocale ou nocturne)

MODALIDAD NOCTURNA

- Reduce el rango dinámico
- Subwoofer APAGADO
- Puede estar activa independientemente del estado de Dolby Digital
- Puede haber solo un perfil de equalización activo a la vez (natural, mejoramiento de voz, nocturno)



DOLBY AUDIO™

- Nur bei Empfang eines Dolby-Digital-Signals aktiv

DOLBY AUDIO™

- Attiva solo se viene ricevuto un segnale Dolby Digital

DOLBY AUDIO™

- Ativo somente durante a recepção de um sinal Dolby Digital

杜比数字技术

- 仅当收到杜比数字信号时才有效

((SUR))

VIRTUELLER SURROUNDMODUS

- Klipsch Spezial-DSP
- Unabhängig von EQ-Einstellungen (Natürlich, verbesserte Stimme, Nacht)
- Kann unabhängig vom Dolby-Digital-Status EIN sein

MODALITÀ SURROUND VIRTUALE

- DSP personalizzato Klipsch
- Indipendente dalle impostazioni dell'equalizzatore (Naturale, Potenziamento vocale, Notturna)
- Può essere On indipendentemente dallo stato Dolby Digital

MODO SURROUND VIRTUAL

- DSP personalizado da Klipsch
- Independente das configurações do EQ (Natural, Voz melhorada, Noturno)
- Pode estar ATIVADO independentemente do status do Dolby Digital

虚拟环绕声模式

- Klipsch 定制 DSP
- 独立于均衡器设置 (自然、音效增强、夜间)
- 不管杜比数字状态如何, 均可“打开”(ON)

DIALOG

EQ-MODUS VERBESSERTE STIMME

- Optimiert EQ für Dialog
- Kann unabhängig vom Dolby-Digital-Status EIN sein
- Es kann jeweils nur ein EQ-Profil aktiv sein (Natürlich, verbesserte Stimme, Nacht)

MODALITÀ EQUALIZZATORE POTENZIAMENTO VOCALE

- Ottimizza l'equalizzatore per i dialoghi
- Può essere On indipendentemente dallo stato Dolby Digital
- Solo un profilo alla volta dell'equalizzatore è attivo (Naturale, Potenziamento vocale, Notturna)

MODO DE EQ DE MELHORIA DE VOZ

- Otimiza a EQ para diálogos
- Pode estar ATIVADO independentemente do status do Dolby Digital
- Somente um perfil de EQ ativo de cada vez (Natural, Voz melhorada ou Noturno)

音效增强均衡器模式

- 优化均衡器, 以实现模拟效果
- 不管杜比数字状态如何, 均可“打开”(ON)
- 一次仅限一种均衡器模式有效 (自然、音效增强或夜间模式)

NIGHT

NACHTMODUS

- Reduziert Dynamikbereich
- Kann unabhängig vom Dolby-Digital-Status EIN sein
- Subwoofer aus
- Es kann jeweils nur ein EQ-Profil aktiv sein (Natürlich, verbesserte Stimme, Nacht)

MODALITÀ NOTTURNA

- Riduce la gamma dinamica
- Subwoofer spento
- Può essere On indipendentemente dallo stato Dolby Digital
- Solo un profilo alla volta dell'equalizzatore è attivo (Naturale, Potenziamento vocale, Notturna)

MODO NOTURNO

- Reduz a faixa dinâmica
- Subwoofer desligado
- Pode estar ATIVADO independentemente do status do Dolby Digital
- Somente um perfil de EQ ativo de cada vez (Natural, Voz melhorada ou Noturno)

夜间模式

- 缩小动态范围
- 低音炮关闭
- 不管杜比数字状态如何, 均可“打开”(ON)
- 一次仅限一种均衡器模式有效 (自然、音效增强或夜间模式)

BLUETOOTH® WIRELESS TECHNOLOGY

TECNOLOGÍA INALÁMBRICA **BLUETOOTH®** • CONFIGURACIÓN DE TECNOLOGIA WIRELESS **BLUETOOTH®** • DRAHTLOSE **BLUETOOTH®**-TECHNOLOGIE-SETUP • CONFIGURAZIONE TECNOLOGIA WIRELESS **BLUETOOTH®** • CONFIGURAÇÃO DE TECNOLOGIA SEM FIO **BLUETOOTH®** • **BLUETOOTH®** 蓝牙无线电子技术

PAIR

CONNEXION
CONEXIÓN
VERBINDEN
COLLEGAMENTO
CONECTAR
连接

1 Hold 3 Seconds
Appuyer pendant 3 secondes
Mantenga oprimido durante 3 segundos
3 Sekunden gedrückt halten
Tenere premuto per 3 secondi
Manter pressionado por 3 segundos
保持 3 秒

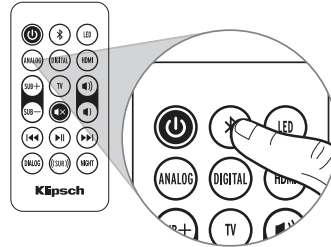

OR
OU
O BIEN
ODER
OPPURE
OU
或

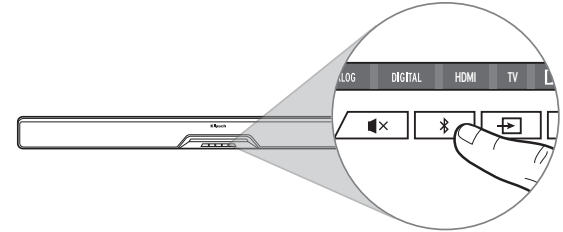

2 Flashing

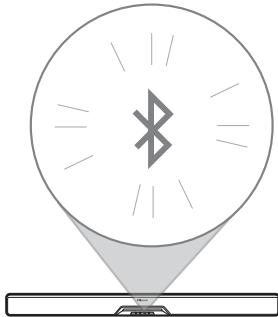

Flashing

Clignotant
Destello
Blinkt
Lampeggiante
Intermittente
闪烁

3

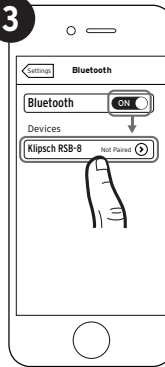

4

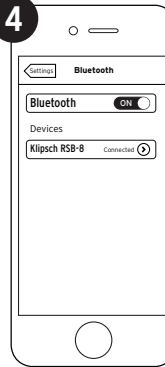

5 Solid

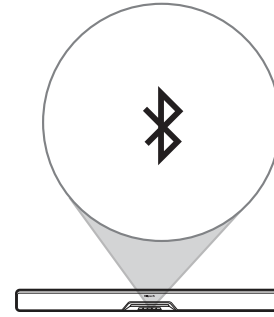

Solid

Continuo
Continuo
Dauerhaft
Luce fissa
Costante
常亮

* Example only. Your device may differ.

• À titre d'exemple seulement. Votre appareil peut être différent. • Este es solo un ejemplo. Es posible que su dispositivo sea diferente. • Nur als Beispiel. Ihr Gerät kann anders aussehen
• Solo a titolo esemplificativo. Lo specifico dispositivo può essere diverso. • Apenas para exemplo. O dispositivo pode ser diferente. • 仅为示例。实际设备可能有所不同

BLUETOOTH® WIRELESS TECHNOLOGY

TECNOLOGÍA INALÁMBRICA *BLUETOOTH*® • CONFIGURACIÓN DE TECNOLOGIA WIRELESS *BLUETOOTH*® • DRAHTLOSE *BLUETOOTH*®-TECHNOLOGIE-SETUP • CONFIGURAZIONE TECNOLOGIA WIRELESS *BLUETOOTH*® • CONFIGURAÇÃO DE TECNOLOGIA SEM FIO *BLUETOOTH*® • *BLUETOOTH*® 蓝牙无线电子技术

RECONNECT

- RECONNECTER
- RECONNECTAR
- ERNEUT VERBINDEN
- RICONNESSIONE
- RECONNECTAR
- 重新连接

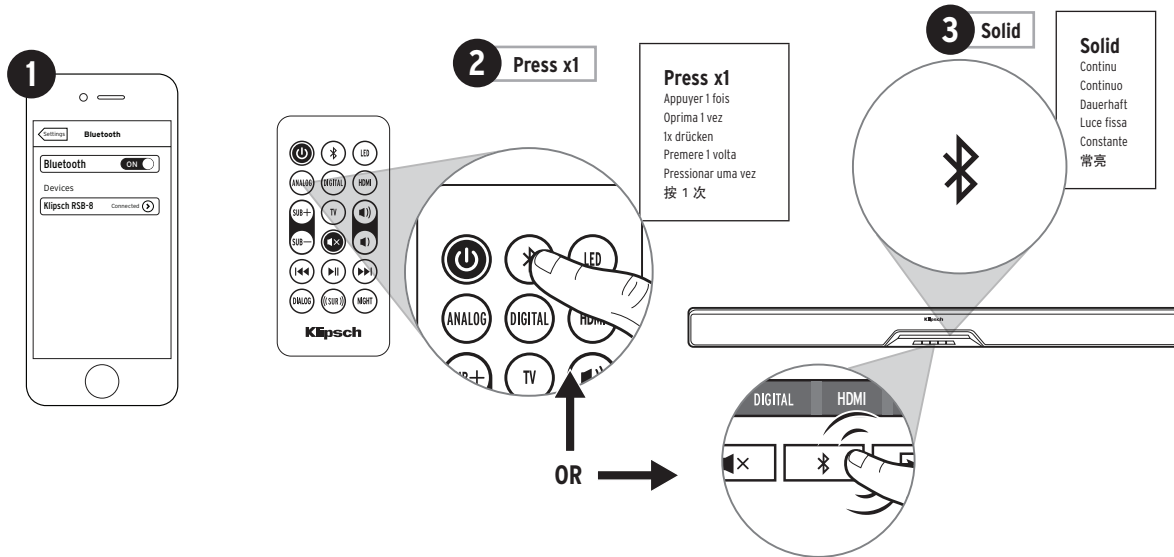

...ETUOTH >> ANALOG >> DIGITAL >> **BLUETOOTH** >> ANALOG >> DIGITAL

TV REMOTE PROGRAMMING

PROGRAMMATION À DISTANCE DU TÉLÉVISEUR • PROGRAMACIÓN DEL CONTROL REMOTO DEL TELEVISOR • PROGRAMMIEREN DER TV-FERNBEDIENUNG • PROGRAMMAZIONE CON IL TELECOMANDO TV • PROGRAMAÇÃO DO CONTROLE REMOTO DA TV • 电视机遥控器编程

If you want to use the TV remote to control the soundbar, you can program the soundbar to take commands from your TV remote

Si vous souhaitez utiliser la télécommande du téléviseur pour contrôler la barre de son, vous pouvez programmer la barre de son pour recevoir des commandes depuis votre télécommande TV.

Si desea controlar la barra de sonido con el control remoto del televisor, puede programar la barra de sonido para que acepte los comandos del control remoto del televisor.

Wenn Sie die Soundbar mit der TV-Fernbedienung kontrollieren wollen, können Sie diese darauf programmieren, Befehle von Ihrer TV-Fernbedienung zu empfangen.

Se si desidera usare il telecomando del televisore per controllare il SoundBar, è possibile programmare appropriatamente il SoundBar.

É possível programar a barra de som para aceitar os comandos do controle remoto da TV.

如果您想要使用电视遥控器控制条形音箱，则可将条形音箱编程为从电视遥控器接收命令。

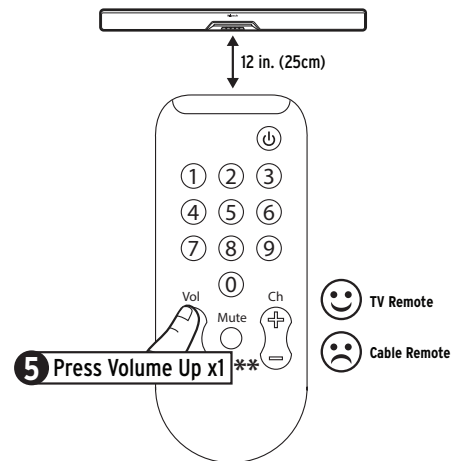
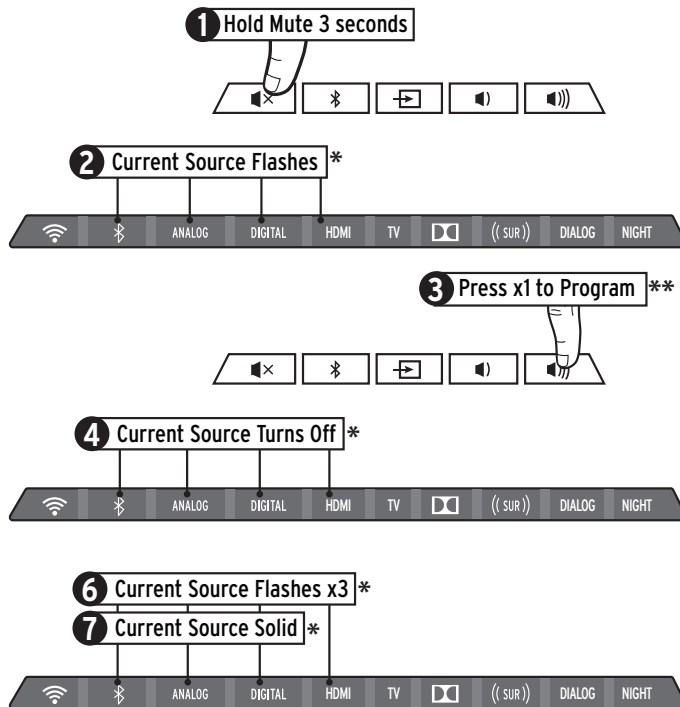

<p>1 Hold Mute 3 Seconds Appuyer sur la Sourdine pendant 3 secondes Mantenga oprimido el silenciador durante 3 segundos Stummschaltung 3 Sekunden gedrückt halten Tenere premuto il pulsante Silenziamento per 3 secondi Manter pressionado o botão desligar áudio por 3 segundos 按住“静音”按钮 3 秒钟</p>	<p>2 Current Source Flashes La source active clignote La fuente activa destella Aktuelle Quelle blinkt La sorgente in funzione lampeggia A fonte atual piscará 当前源闪烁</p>	<p>3 Press x1 to Program Appuyer 1 fois pour programmer Oprima una vez para programar 1x drücken, um zu programmieren Press una volta per programmare Pressionar uma vez para programar 按一次进行编程</p>	<p>4 Current Source Turns Off La source active s'éteint La fuente activa se apaga Aktuelle Quelle abgeschaltet La sorgente si disinserisce A fonte atual desligará 当前源关闭</p>
------------------------------------------------------------------------------------------------------------------------------------------------------------------------------------------------------------------------------------------------------------------------------------------------------------------------------------------	---------------------------------------------------------------------------------------------------------------------------------------------------------------------------------------------------------------	------------------------------------------------------------------------------------------------------------------------------------------------------------------------------------------------------------------------------------------	-------------------------------------------------------------------------------------------------------------------------------------------------------------------------------------------------------------------

<p>5 Press Volume Up x1 Appuyer sur Volume haut 1 fois Oprima la subida de volumen una vez Lauter-Taste 1x drücken Premere una volta il pulsante di aumento volume Pressionar uma vez o botão Volume + 按“调高音量” (+) 按钮一次</p>	<p>6 Current Source Flashes x3 La source active clignote 3 fois La fuente activa destella 3 veces Aktuelle Quelle blinkt 3x La sorgente in funzione lampeggia tre volte A fonte atual piscará 3 vezes 当前源闪烁 3 次</p>	<p>7 Current Source Solid Source active continue La fuente activa brilla fijamente Aktuelle Quelle leuchtet dauerhaft La spia della sorgente in funzione rimane accesa Fonte atual acesa 当前源常亮</p>
------------------------------------------------------------------------------------------------------------------------------------------------------------------------------------------------------------------------------------------------------------------	----------------------------------------------------------------------------------------------------------------------------------------------------------------------------------------------------------------------------------------------------------	-----------------------------------------------------------------------------------------------------------------------------------------------------------------------------------------------------------------------------------------

* Only Source LEDs active at the time will be effected

Seules les DEL de sources actives à ce moment seront affectées

Se efectúan solo las funciones de los indicadores LED activos en el momento

Betrifft nur die momentan aktiven Quell-LEDs

Solo i LED del segnale attivi al determinato istante segneranno

Somente os LEDs das fontes ativos no momento serão afetados

*只有当时有效的源 LED 灯将受影响。

** To program Volume Down and Mute buttons repeat the steps shown and replace steps 3 and 5 with the button you want to program.

Pour régler les boutons de Volume bas et de Sourdine, répéter les étapes indiquées et remplacez les étapes 3 et 5 par le bouton que vous souhaitez programmer.

Para programar los botones de bajada de volumen y de silenciador, repita los pasos indicados y sustituya el botón de los pasos 3 y 5 por el botón que desea programar.

Um die Leiser- und Stummschaltungs-Tasten zu programmieren, die gezeigten Schritte wiederholen und Schritte 3 und 5 mit der zu programmierenden Taste ersetzen.

Per programmare i pulsanti Riduzione volume e Silenziamento, ripetere i passaggi illustrati e sostituire i passaggi 3 e 5 con il pulsante che si desidera programmare.

Para programar os botões de diminuir o volume e desligar o áudio, repita os passos indicados e substitua as etapas 3 e 5 com o botão que deseja programar.

要对“调低音量” (-) 与“静音”按钮进行编程，请重复所示步骤，然后用您想编程的按钮替换第 3 步和第 5 步。

REMOTE CONTROL CODES (FOR UNIVERSAL OR CABLE REMOTES)

RCA*	41609 OR 43915
DIRECTV	31609 OR 31023
XFINITY**	31309 OR 31023
BRIGHT HOUSE	288
AT&T (SILVER)	5156 OR 5023
AT&T (BLACK)	5156

* MUST HAVE AUDIO/AUX BUTTON OR AUDIO-SB BUTTON

** RED CENTER BUTTON

NOTE: NOT ALL UNIVERSAL REMOTES ARE COMPATIBLE

HEX CODES - SET 1	
VOLUME UP	0x 856A 9F60
VOLUME DOWN	0x 856A 9E61
MUTE	0x 856A 9966

HEX CODES - SET 3	
VOLUME UP	0x A55A 0AF5
VOLUME DOWN	0x A55A 0BF4
MUTE	0x A55A 12ED

HEX CODES - SET 4	
VOLUME UP	0x 859A 817E
VOLUME DOWN	0x 859A 827D
MUTE	0x 859A 8778

LED ON/OFF

DEL MARCHÉ/ARRÊT • ENCENDIDO/APAGADO DE INDICADORES LED • LED AN/AUS • LED ACCESO/SPENTO • LED LIGA/DESLIGA • LED 灯开/关

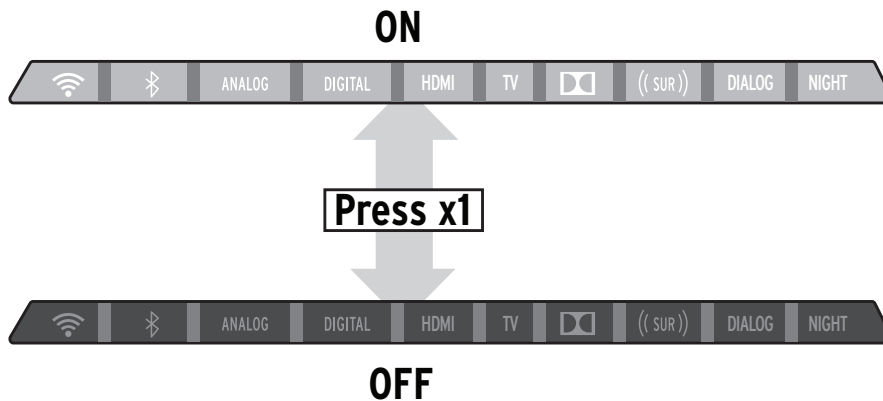
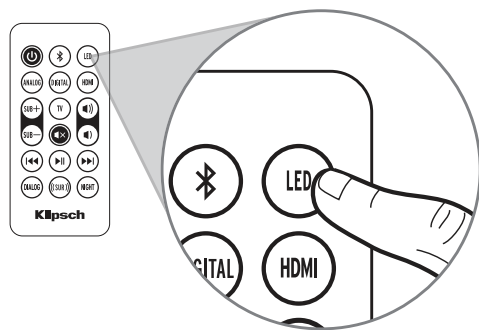

<p>Press x1 Appuyer 1 fois Oprima 1 vez Ix drücken Premere 1 volta Pressionar uma vez 按 1 次</p>	<p>ON / OFF Sous tension / Hors tension Encendido / Apagado Ein / Aus Acceso / Spento Ligar / Desligar 开/关</p>
--------------------------------------------------------------------------------------------------------------------------------	-----------------------------------------------------------------------------------------------------------------------------------------------

NOTE: LEDs will turn off after 5 seconds of inactivity
REMARQUE : Les DEL s'éteindront après 5 secondes d'inactivité
NOTA: Los indicadores LED se apagan después de 5 segundos de inactividad
HINWEIS: LEDs schalten sich nach 5 Sekunden Inaktivität aus
NOTA: i LED si spegneranno dopo 5 secondi di inattività.
OBSERVAÇÃO: Os LEDs desligarão depois de 5 segundos de inatividade
注意: LED 灯休止 5 秒之后将关闭。

FACTORY RESET

RÉINITIALISATION • RESTABLECIMIENTO DE FÁBRICA • RÜCKSETZUNG AUF WERKSEINSTELLUNG • RIPRISTINO IMPOSTAZIONI DI FABBRICA • RESTABELECIMENTO DAS CONFIGURAÇÕES DE FÁBRICA • 恢复出厂设置

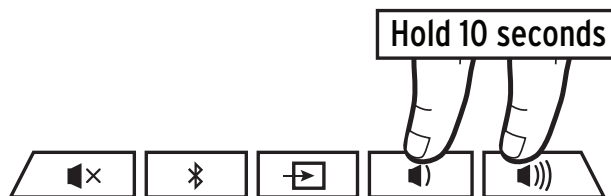

Hold 10 Seconds

Appuyer pendant 10 secondes
Mantenga oprimido durante 10 segundos
10 Sekunden gedrückt halten
Tenere premuto per 10 secondi
Manter pressionado por 10 segundos
保持 10 秒

Clears *Bluetooth*® pairing history and user programmed IR commands

Efface l'historique d'appariement *Bluetooth*® et les commandes IR programmées par l'utilisateur

Borra el historial de sincronización de *Bluetooth*® y los comandos programados por el usuario

Löscht *Bluetooth*®-Kupplungsdaten und benutzerprogrammierte IR-Befehle

Vengono cancellati la cronologia delle associazioni *Bluetooth*® e i comandi programmati dall'utente sul telecomando a infrarossi

Limpa o histórico de pareamento *Bluetooth*® e os comandos de IR programados pelo usuário

清除蓝牙® 配对历史记录及用户编程的 IR 指令。

CARE AND CLEANING

ENTRETIEN ET NETTOYAGE • CUIDADO Y LIMPIEZA • PFLEGE UND REINIGUNG • CURA E PULIZIA • CUIDADOS E LIMPEZA • 保养与清洁

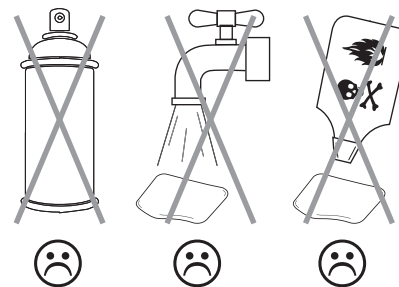

Klipsch®

KEEPERS OF THE SOUND™

3502 WOODVIEW TRACE, INDIANAPOLIS, IN, USA

KLIPSCH.COM

©2016, Klipsch Group, Inc. Klipsch Group, Inc. is a wholly-owned subsidiary of Vox International Corporation.

Klipsch and Keepers of the Sound are trademarks of Klipsch Group, Inc., registered in the United States and other countries.

The *Bluetooth*® word mark is a registered trademark owned by Bluetooth SIG, Inc. and any use of such mark by Klipsch Group, Inc. is under license.

Manufactured under license from Dolby Laboratories. Dolby, Dolby Audio and the double-D symbol are trademarks of Dolby Laboratories.

DTS and Play-Fi are registered trademarks of DTS, Inc.