

## CHOOSING YOUR FLYING FIELD

- 1 ➤ The flying field you choose should be a large, open field with grass. There should not be any vehicles, buildings, power lines, trees, large rocks or anything else that your model can crash into.

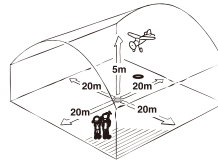

- 2 ➤ Size of hall etc. should be as per diagram on right. (Be sure to obtain appropriate permission)

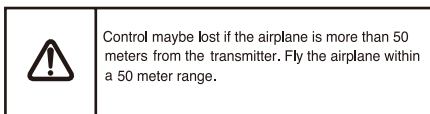

## CHOOSING A DAY TO FLY

- Calm weather with either no wind or wind speed of 1~2m is suitable for flying.

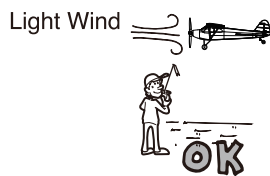

## PRE-FLIGHT CHECK

- 1 ➤ Check for any bends or damaged parts on main wing, fuselage or tail wing.



- 4 ➤ In case motor starts rotating accidentally, have an assistant hold the rear part of the plane securely.



- 2 ➤ Be sure propeller & spinner are properly attached!

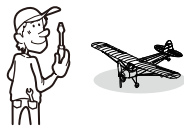

- 5 ➤ Check plane responds properly to control signals.

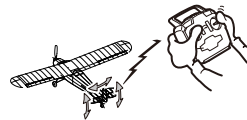

- 3 ➤ Switch transmitter ON and connect battery, and advise any people nearby. Make sure there is no one near the propeller.

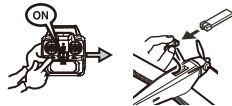

- 6 ➤ Test the range of the radio signal. Step back about 10 m and check for any unusual behaviour.

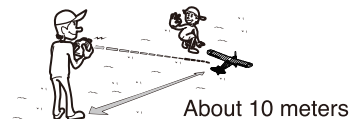

## TAKE OFF

- ▶ Check plane responds properly to control signals.

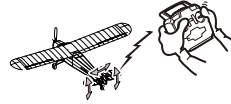

- ▶ Apply full throttle while facing into the wind, hold the plane horizontally and launch with a pushing motion.

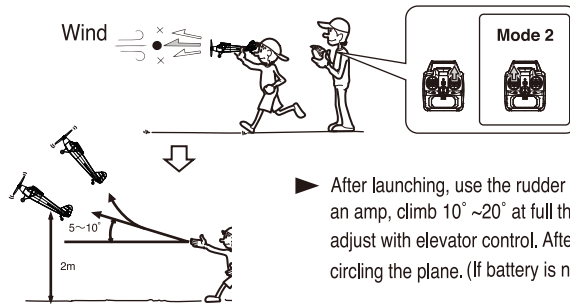

- ▶ After launching, use the rudder to stop plane from tilting left or right. If using an amp, climb 10° ~20° at full throttle. If plane doesn't climb accordingly, adjust with elevator control. After reaching an altitude of about 2m, beginning circling the plane. (If battery is not charged properly, plane will not ascend).

## ADJUSTING TRIMS

- ▶ Adjusting trim for horizontal flight.

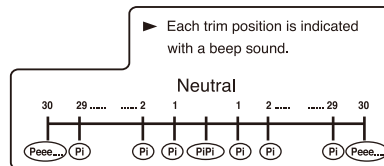

- ▶ Take finger of rudder stick and if plane flies to the right, adjust rudder trim.

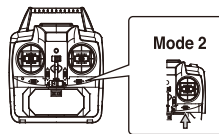

- ▶ Take finger of elevator stick and if plane flies upwards, adjust elevator trim.

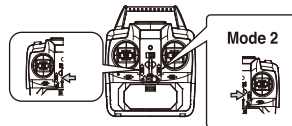
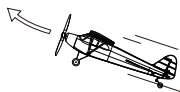

- ▶ Adjust elevator and rudder trims so plane flies straight and horizontal when sticks are free.



## Flight

- ▶ Continue circling left in an oval pattern until accustomed to flying. If plane nose dips, adjust elevator control.

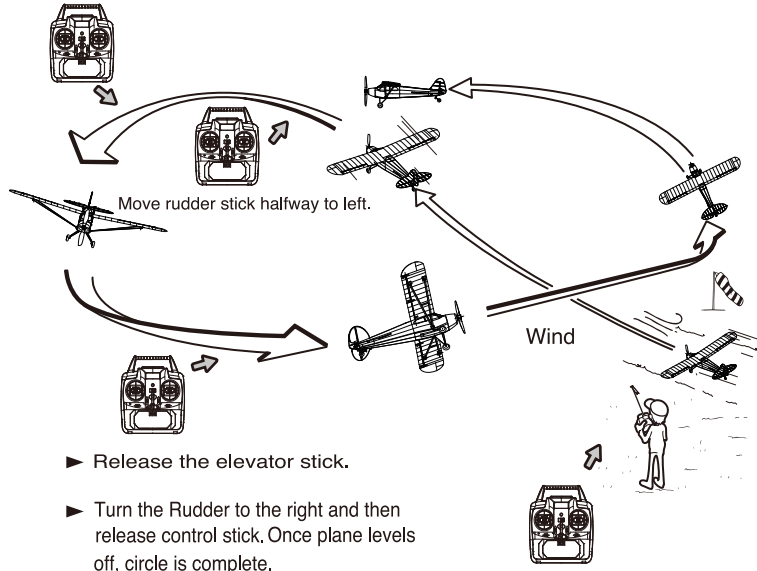

- ▶ Release the elevator stick.
- ▶ Turn the Rudder to the right and then release control stick. Once plane levels off, circle is complete.

- ▶ Move control sticks slowly.

## LANDING

- ▶ When battery runs low, the auto-cut mechanism will stop propeller from spinning, so aim for flight times of about 3 minutes then land.

- ▶ When landing, make a wide turn with the wind, and then land into the wind.

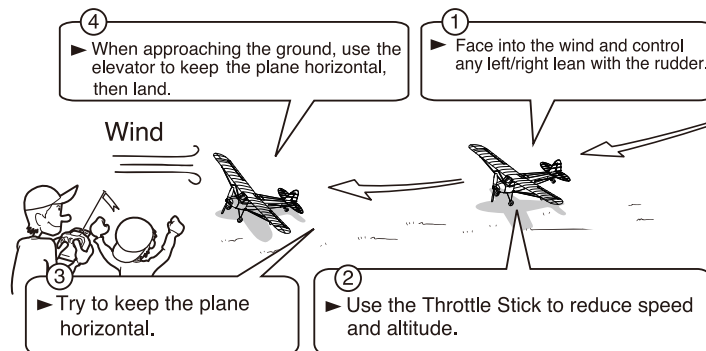
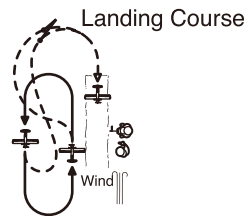

---

## AFTER LANDING

---

- 1 Disconnect Battery

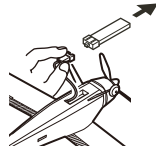

▶ Hold connector when disconnecting battery, do not pull the cord.

- 2 Then, switch transmitter OFF.

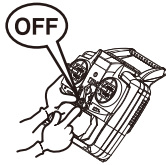

Caution: hot after flight !

Allow battery to cool down before recharging.

---

## AFTER-FLIGHT MAINTENANCE

---

- 1  ▶ Remove battery from airplane when not in use.

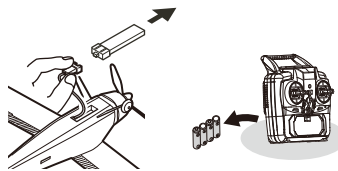

- 2  ▶ For next flight, check that no screws have loosened and replace any scratched or damaged parts.

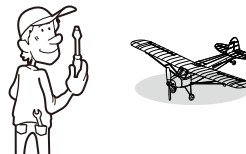

- 3  ▶ Clean away any dirt etc. and perform proper maintenance.



## FCC INFORMATION

This device complies with Part 15 of the FCC Rules. Operation is subject to the following two conditions:

1. This device may not cause harmful interference, and 2. This device must accept any interference received, including interference that may cause undesired operation.

**Note:** This equipment has been tested and found to comply with the limits for a Class B digital device, pursuant to part 15 of the FCC Rules. These limits are designed to provide reasonable protection against harmful interference in a residential installation. This equipment generates, uses and can radiate radio frequency energy and, if not installed and used in accordance with the instructions, may cause harmful interference to radio communications. However, there is no guarantee that interference will not occur in a particular installation. If this equipment does cause harmful interference to radio or television reception, which can be determined by turning the equipment off and on, the user is encouraged to try to correct the interference by one or more of the following measures:

- Reorient or relocate the receiving antenna.
- Increase the separation between the equipment and receiver.
- Connect the equipment into an outlet on a circuit different from that to which the receiver is connected.
- Consult the dealer or an experienced radio/TV technician for help.

**Caution:** Any changes or modifications not expressly approved by the party responsible for compliance could void the user's authority to operate this equipment.

**RF Exposure:** This equipment complies with FCC radiation exposure limits set forth for an uncontrolled environment. This transmitter must not be colocated or operating in conjunction with any other antenna or transmitter.