

CRAIG®

PORTABLE TOWER
with Color Changing Lights and
Bluetooth® Wireless Technology

Owner's Manual

PLEASE READ BEFORE OPERATING THIS EQUIPMENT.

Model: CHT892

FCC NOTICE:

This equipment has been tested and found to comply with the limits for a Class B digital device, pursuant to Part 15 of the FCC Rules. These limits are designed to provide reasonable protection against harmful interference in a residential installation. This equipment generates, uses and can radiate radio frequency energy and, if not installed and used in accordance with the instructions, may cause harmful interference to radio communications. However, there is no guarantee that interference will not occur in a particular installation. If this equipment does cause harmful interference to radio or television reception, which can be determined by turning the equipment off and on, the user is encouraged to try to correct the interference by one or more of the following measures:

- Reorient or relocate the receiving antenna.
- Increase the separation between the equipment and receiver.
- Connect the equipment into an outlet on a circuit different from that to which the receiver is connected.
- Consult the dealer or an experienced radio/TV technician for help.
- This equipment complies with FCC radiation exposure limits set forth for an uncontrolled environment. This equipment should be installed and operated with minimum distance 20cm between the radiator & your body.

FCC WARNING:

To assure continued operation, follow the attached installation instructions and use only shield cables when connecting to other devices. Changes or modifications not expressly approved by the party responsible for compliance could void the user's authority to operate the equipment.

LOCATION OF CONTROLS:

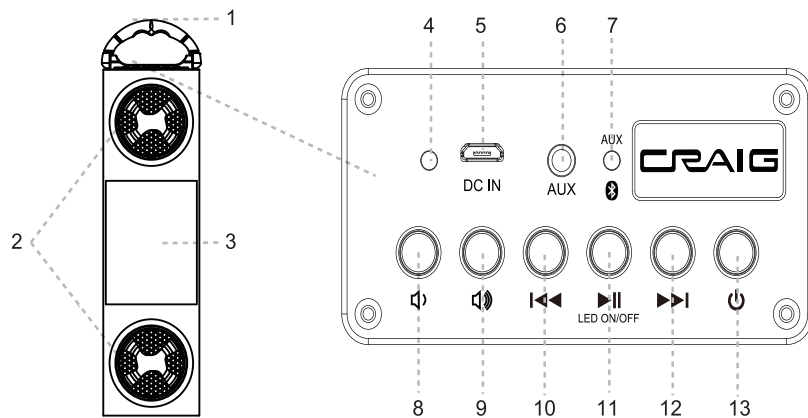

1. Carry Handle
2. Speakers with Decorative LED Lights
3. Decorative LED Lights
4. CHARGING Indicator
5. DC IN Jack (Micro USB Port, for charge only)
6. AUX (IN) Jack
7. Mode Indicators

8. (Volume Down) Button
9. (Volume Up) Button
10. Button
11. - LED ON/OFF Button
12. Button
13. Button

POWER SOURCE:

The unit has a built-in Li-ion rechargeable battery, recharge it before first time use or when it is drained as follows:

1. Connect the Micro USB Plug from the supplied USB Connection Cable to the Micro USB Port on the top of the unit.
2. Connect the full sized USB Plug from the supplied USB Connection Cable to any Personal Computer or USB Charger (Computer and USB Charger not included) to start charging as the the illustrated below:

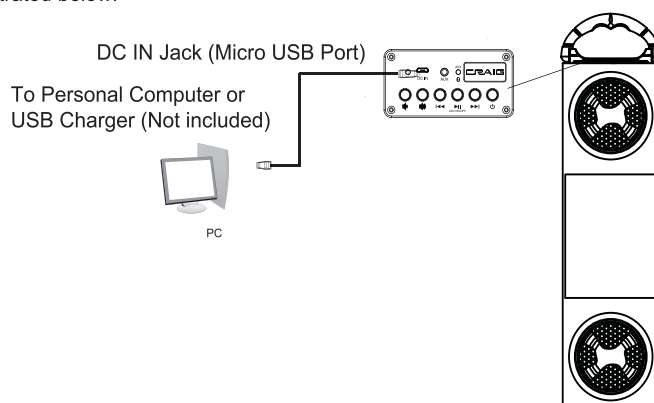

3. During charging, the Red CHARGING Indicator on the top of unit will illuminate. When finished, it will turn off.

Notes:

1. During charging, you can also play and listen music at the same time.
2. Your battery will last longer if you're following these simple guidelines for caring and storing:
 - A. Before first time use, charge it approximately 4 hours until the unit is fully charged.
 - B. Recharge and store the unit within the temperature range of 5°C~35°C (40°F~95°F).
 - C. Do not charge longer than 24 hours. Excessive charging or running the unit until battery fully drains will damage battery. Battery life will be extended if you keep the battery fully charged.
 - D. Battery life naturally shortens slowly over time.
 - E. The rechargeable battery incorporated in this product is not user replaceable.

OPERATION:

BT (Bluetooth) pairing:

First time use or re-pairing the unit to a new BT Device, pair as follows:

1. Press the  Button on the top of unit to turn on the unit. The Blue indicator on the top of unit will illuminate and blink.
2. Power on the external BT Device and enter to BT searching mode. Start pairing following the on screen instructions from the external BT Device. After paired, the unit will sound a prompt tone and the Blue Indicator will stop blinking.
3. If pairing is complete you may now play music with your external BT Device.

5. During playback:
 - Press the ►| Button on the top of unit to pause, press again to resume normal playback.
 - Press the ◀|) or |▶ Buttons repeatedly to adjust volume level as desired.
 - Press the ◀◀ or ▶▶ Buttons repeatedly to skip tracks.
 - Pressing and holding the ►| - LED ON/OFF Button to turn off the Decorative LED Lights; pressing and holding again to turn it on.
6. When finished listening, pressing and holding the ⏻ Button to shut off the unit. The Bluetooth Indicator will turn off.

Notes:

- When the external BT Device searched the unit, our model number "CHT892" will appear on the display of external BT Device.
- If while pairing you are asked for a code please try "0000" or "1234".

Normal operation after pairing:

1. Power on the external BT Device and enter to BT mode as usual.
2. Power on the unit as previously instructed. The Blue indicator on the top of unit will illuminate and blink.
3. Wait a few seconds until the unit is automatically paired to the external BT Device. The Blue Indicator will stop blinking.
4. After pairing is complete you may now play music with your external BT Device.

AUX (in) :

To listen from an external Audio Player such as a MP3 Player, Discman ...etc.

1. Connect one end of the supplied Audio Connection Cable to the AUX Out/Line Out/Phone Jack on the external Audio Player.
2. Power on the unit as previously instructed the connect the other end of the cable to the AUX (In) Jack on the top of unit as the illustrated below. The unit will automatically switching to AUX (In) Mode and the color of the Blue Indicator on the top of unit will turn to Green.

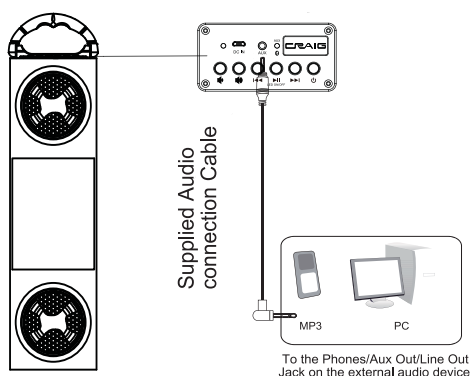



3. Power on and play the music on the connected Player as usual. (Make sure the volume level of the connected Audio Player is turned to high level.)
4. During playback:
 - Press the ►| Button on the top of unit to mute, press again to turn the sound back.
 - Press the ◀|) or |▶ Buttons repeatedly to adjust volume level as desired.
 - Pressing and holding the ►| -LED ON/OFF Button to turn off the Decorative LED Lights; pressing and holding again to turn it on.
5. When finished listening, pressing and holding the ⏻ Button to shut off the unit. The Green Indicator will turn off.

NOTE:



When the Audio Connection Cable was inserted into the AUX (in) Jack. BT will be auto cut. Unplug the cable from the AUX (in) Jack before use BT.

TROUBLESHOOTING

Check the following before requesting service:

SYMPTOM	POSSIBLE CAUSE	POSSIBLE SOLUTION
Can't power on	Battery drained	Recharge the battery as page 2
No sound or sound weak	Volume of the unit was set to minimum position	Increase the volume by press the  Button
	Volume level of the paired/connected device is in low level	Rise the volume level of the paired/connected device
Sound distortion	Volume level too high	Reduce the volume level by press the  Button
	Volume level of the connected/paired device too high	Reduce the volume level of the connected/paired device
BT not functioning	The external BT device had NOT paired to the unit	Pair the external BT device to the unit as page 3
	The external BT device too far from the unit	Place the external BT device close to the unit

SPECIFICATIONS:

Power source:----- DC  3.7V, 1200mAh (4.4WH) rechargeable Li-ion Battery
 Recharge by DC  5V through DC IN Jack (Micro USB Port)
 Impedance of the speakers:----- 2 x 5 W; 2 ohm
 Audio power:----- 2 x 3 W (Total 6 W, RMS)
 BT Version:----- 5.0
 BT Operation Distance:----- 32 Feet in open area

PACKAGE INCLUDES:

1 x Owner's Manual
 1 x USB Connection Cable (For charging only)
 1 x Audio Connection Cables with 3.5mm Plugs

SPECIFICATIONS AND ACCESSORIES ARE SUBJECT TO CHANGE WITHOUT NOTICE

LIMITED WARRANTY

Craig warrants this product to be free from manufacturing defects in material and workmanship under normal use for a period of 90 days from date of purchase. If service is required, please return the product to the store where it was purchased for exchange; or, pack the unit in the original packing material with all accessories if applicable, a copy of your sales receipt and a Cashier's check or Money Order for \$7.00 (to cover shipping and handling costs) payable to Craig Electronics Inc. For consumers in Canada, please make sure that the cashier check or money order is redeemable through a U.S. bank. Ship your product freight pre-paid. Your unit will be repaired, replaced or if the unit can not be repaired or replaced, a refund will be forwarded to you within four weeks of receipt of your unit. Please ship your unit to:

Craig Electronics Inc.
1160 NW 163 Drive
Miami, FL 33169

This warranty is void if the product has been: a) Used in a commercial application or rental. b) Damaged through misuse, negligence, or abuse. c) Modified or repaired by anyone other than an authorized Craig service center. d) Damaged because it is improperly connected to any other equipment.

Note: This warranty does not cover: a) Ordinary adjustments as outlined in the Owner's Manual which can be performed by the customer. b) Damage to equipment not properly connected to the product. c) Any cost incurred in shipping the product for repair. d) Damage to the product not used in the USA.

This warranty is not transferable and only applies to the original purchase. Any implied warranties, including the warranty of merchantability, are limited in duration to the period of this expressed warranty and no warranty whether expressed or implied shall apply to the product thereafter.

Under no circumstance shall Craig be liable for any loss or consequential damage arising out of the use of this product. This warranty gives specific legal rights. However, you may have other rights which may vary from state to state. Some states do not allow limitations on implied warranties or exclusion of consequential damage. Therefore, these restrictions may not apply to you.

To Obtain Service on your Product
email: service@craigelectronics.com