

Aux In

Requires a 3.5mm audio cable (not included).

1. Connect a 3.5mm audio cable to the **Aux In** on the soundbar and the audio output on an audio device.
2. The soundbar will automatically switch to **Aux Mode**.
3. Use the controls on the connected device to select and play audio. Be sure the volume on your connected device is audible when you begin playing. *Only the volume control on the soundbar will work in Aux In mode.*

Light Modes

- Press the **Power/Mode/Lights** button twice to cycle through LED light modes: breathing, fast flash, slow flash, steady, and lights off.
- The LED lights have five colors: Red, Blue, Green, Light Blue, and White.

Voice Prompts

To turn voice prompts on/off, press the power button three times. The soundbar will chime when voice prompts are successfully turned on/off.

FCC WARNINGS

WARNING: Changes or modifications to this unit not expressly approved by the party responsible for compliance could void the user's authority to operate the equipment.

NOTE: This equipment has been tested and found to comply with the limits for a Class B digital device, pursuant to Part 15 of the FCC Rules. These limits are designed to provide reasonable protection against harmful interference in a residential installation. This equipment generates, uses, and can radiate radio frequency energy and, if not installed and used in accordance with the instructions, may cause harmful interference to radio communications. However, there is no guarantee that interference will not occur in a particular installation. If this equipment does cause harmful interference to radio or television reception, which can be determined by turning the equipment off and on, the user is encouraged to try to correct the interference by one or more of the following measures:

- Reorient or relocate the receiving antenna.
- Increase the separation between the equipment and receiver.
- Connect the equipment into an outlet on a circuit different from that to which the receiver is connected.
- Consult the dealer or an experienced radio/TV technician for help.

ADDITIONAL WARNINGS

- WARNING: To prevent fire or shock hazards, do not expose this unit to rain or moisture.
- WARNING : Where the mains plug or appliance coupler is used as the disconnect device, such disconnect device shall remain readily operable.
- Lithium batteries, like all rechargeable batteries, are recyclable and should be recycled or disposed of according to state and local guidelines. They should never be disposed of in normal household waste and they should never be incinerated, as they might explode. Contact your local government for disposal or recycling practices in your area.



WARNING : This product can expose you to chemicals including lead, which is known to the State of California to cause cancer and birth defects or other reproductive harm. For more information go to: www.P65Warnings.ca.gov. **This product meets and complies with required Federal product guidelines.**

International Support

To download this User's Guide in English, Spanish, or French, or to get answers to frequently asked questions, visit the support section at:
www.iLiveElectronics.com

Para descargar este Manual del Usuario en Inglés, Español y Francés, o para obtener respuestas a preguntas frecuentes, visite la sección de apoyo en:
www.iLiveElectronics.com

Pour télécharger ce guide de l'utilisateur en Anglais, Espagnol ou Français, ou pour obtenir des réponses à des questions fréquemment posées, consultez la rubrique d'assistance sur:
www.iLiveElectronics.com

Contact Information

Website: www.iLiveElectronics.com

Email Support: proinfo@dpiinc.com

Email Parts: partsinfo@dpiinc.com

Phone Support: 1-888-999-4215

Warranty

For Warranty Information and the most up-to-date version of this User's Guide, go to:
www.iLiveElectronics.com.



Specifications are subject to change without notice.
Copyright © 2023 Digital Products International (DPI, Inc.)
All other trademarks appearing herein are the property of their respective owners.



18 in Multimedia Sound Bar
User's Guide for Model ISB184 v3285-01

Features

- Bluetooth v5.4
- Wireless range: 33 ft.
- 18" sound bar
- Voice prompts announce speaker functions
- Color changing LEDs
- Aux In
- MicroSD and USB inputs (up to 64GB)
- USB-C port for battery recharge
- DC battery power: built-in rechargeable battery
- Battery life: approx. 4 hours at 50% volume

Includes

- USB to USB C
- User's guide

Overview & Controls

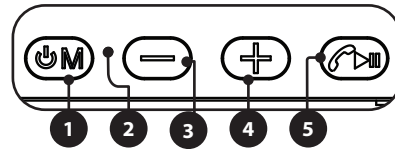

1. Power ON/OFF, Mode, and Lights

- Press and hold to turn soundbar on/off.
- Press twice to cycle through LED light modes.

2. LED Indicator Light

3. Volume Down/Previous Track

- Press once to decrease volume.
- Press and hold to go to the previous track.

4. Volume Up/Next Track

- Press once to increase volume.
- Press and hold to go to the next track.

5. Play/Pause/Call

- Press to play/pause current track or to answer a call.
- Press and hold to pair/unpair a device.

Inputs

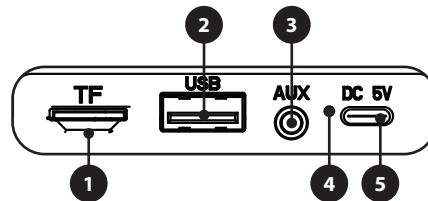

1. MicroSD Slot

2. USB Port

3. Aux In

4. LED Charging Indicator

5. DC Power Input

Battery Power

- Charge fully before use. For best results, charge while the soundbar is off. The charge time is approximately 4 hours.
- When the soundbar is charging, the **LED Charging Indicator** will display a solid red light. When charging is complete, the indicator will turn off.
- Using a **USB-C** cable (included), connect the DC power input on the soundbar to the USB port of a powered-on computer or USB power adaptor (not included) to charge the soundbar.

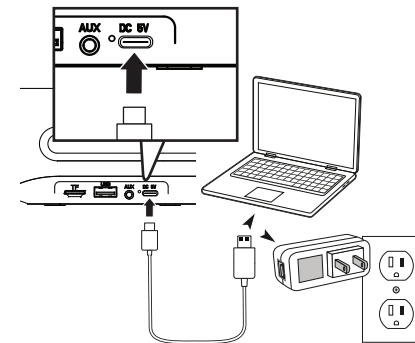

Pairing Bluetooth & Playing Audio

Note: This model features automatic Bluetooth pairing.

1. Power on the soundbar, a voice will announce "Bluetooth," when the unit is ready to pair. The **LED Indicator Light** will also flash blue. *When pairing, remain within 3 feet of the unit.*
2. Using the controls on your Bluetooth device, select **iLive ISB184** in the Bluetooth Settings to pair. A voice will announce "Bluetooth is connected," and the Bluetooth LED Indicator will turn a solid blue when the soundbar is successfully paired to your device. *If need be, refer to the user's manual for your specific device for more information.*
3. Use the controls on the connected Bluetooth device to select tracks, play, pause, or answer an incoming call.

TWS

1. Power on **two ISB184 soundbars**, both in Bluetooth mode.
2. Press the **Play/Pause/Call** button twice on one soundbar to activate TWS.
3. A voice will announce "Speaker connected" to indicate the two units are connected. Audio will now play through both soundbars.

USB and MicroSD

Supports USB drives and MicroSD cards up to 64GB.

1. Insert a USB drive or MicroSD card into the matching port on the soundbar.
2. The soundbar will automatically switch to **External Media Mode**.
3. Use the controls on the connected device to select and play audio.

