



RC CRUISER

Item No. 513032 - 27 MHz
Item No. 513049 - 49 MHz

Age 4+ years
Adult Battery Installation Required



INTRODUCTION

Start your engines! Because now your Mini's can cruise to the silly, wonderful world of Lalaloopsy™ in their very own Cruiser!

CONTENTS

- a) 1 Mini Lalaloopsy™ RC Cruiser
- b) 1 Remote Control
- c) 1 Mini Lalaloopsy™ Charlotte Charades™ Doll

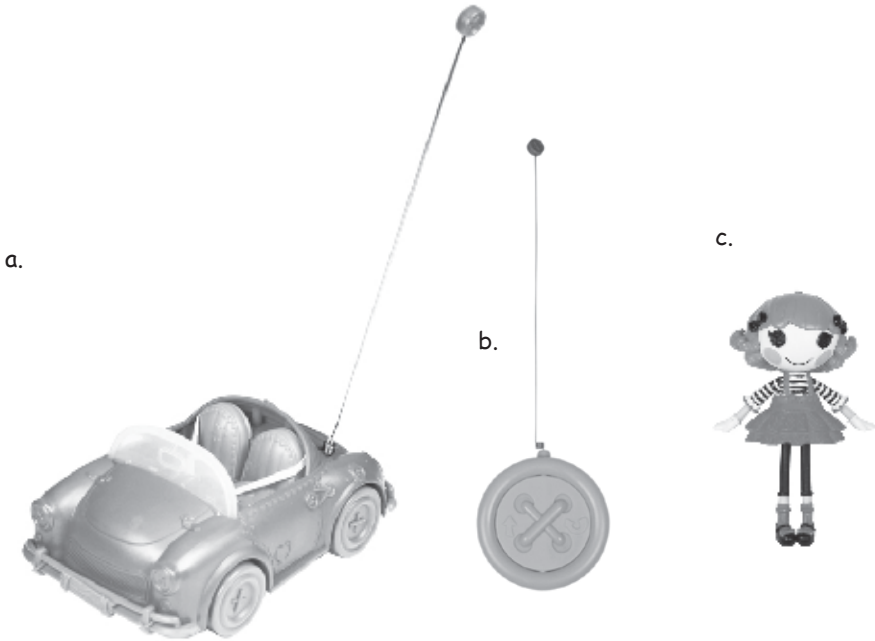

Illustrations are for reference only. Styles may vary from actual contents.

BEFORE YOU BEGIN

CRUISER

An ADULT must install batteries in the *Cruiser*. Here's how:

1. Switch the ON/OFF switch to "OFF." Using a Phillips screwdriver (not included), remove the screw and battery compartment cover located on the bottom of the *Cruiser*. (Fig. 1)
2. Install three (3) AA alkaline batteries (not included) making sure the (+) and (-) ends face the proper direction as indicated inside the battery compartment.
3. Replace the compartment cover and tighten the screw.

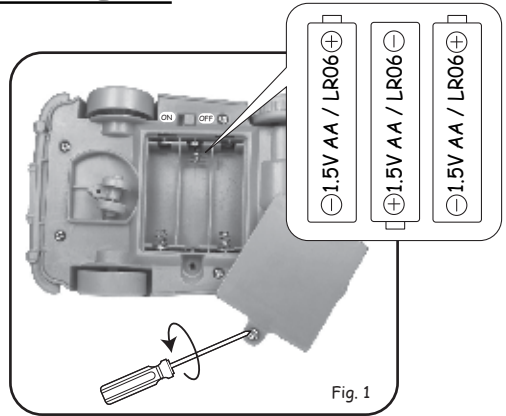

REMOTE CONTROL

An ADULT must install batteries in the Remote Control. Here's how:

1. Switch the ON/OFF switch to "OFF." Using a Phillips screwdriver (not included) remove the screw and battery compartment cover on the back of the Remote Control. (Fig. 2)
2. Install two (2) AAA alkaline batteries (not included) making sure the (+) and (-) ends face the proper direction as indicated inside the battery compartment. (Fig. 2)
3. Replace the compartment cover and tighten the screw.

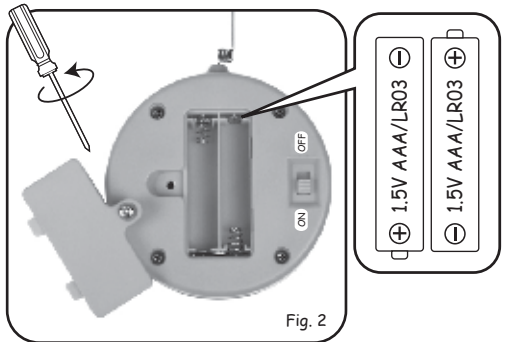

FASTEN YOUR SEAT BELTS!

Before going for a drive, make sure that your dolls are in place and buckled up:

1. Lift the elastic band. (Fig. 3)
2. Secure your doll in the seat under the elastic band. (Fig. 4) Ready to roll!

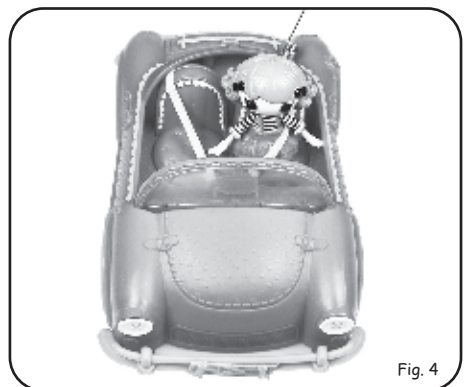
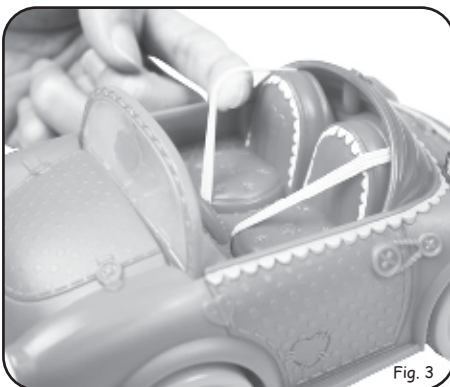

OPERATING THE CRUISER

1. Slide the ON/OFF switch on the bottom of the **Cruiser** to the "ON" position.
2. Slide the ON/OFF switch on the back of the Remote Control to the "ON" position.
3. Place the **Cruiser** on a flat, level surface.
4. Straighten the Antenna.
5. Use the Remote Control to drive your **Cruiser** by doing the following:
 - a. Press down on the left side of the Remote Control to go forward. (Fig. 5)
 - b. Press down the right side of the Remote Control to back up and turn to the left. (Fig. 6)

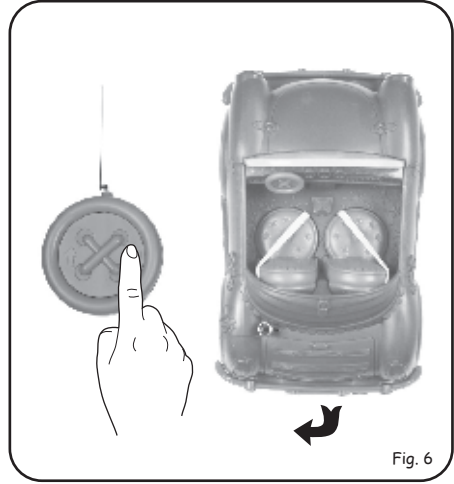
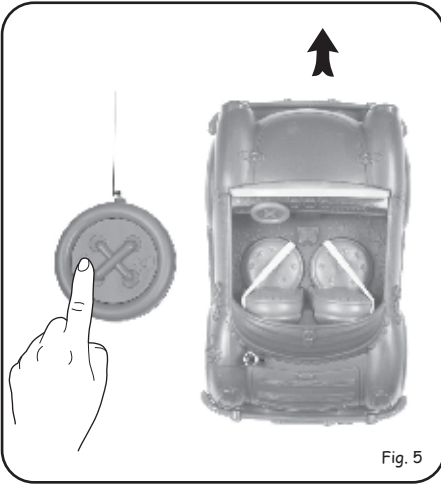

IMPORTANT INFORMATION

- When driving two RC **Cruiser**, they must be of different radio frequencies (e.g. one **Cruiser** 49MHz and one **Cruiser** 27MHz) or they may not perform as designed.
- When **Cruiser** is not being played with, turn the ON/OFF switches on both the **Cruiser** and Remote "OFF" to save battery power.
- Your **Cruiser** is controlled by radio frequency. It may interfere with nearby devices such as cordless phones, hair dryers, radios, walkie-talkies, or other radio controlled devices. If this occurs, move the **Cruiser** to a location away from the interference.
- The **Cruiser** must remain in remote control range to operate correctly. The range depends on the surrounding area and on the strength of the battery. Obstructions such as buildings, fences, etc., between the remote control transmitter and the **Cruiser**, reduce the range.
- If the **Cruiser** runs slowly, replace the batteries.
- **KEEP AWAY FROM WATER!** Do not run your **Cruiser** through puddles, or expose it to liquid of any kind as moisture may damage the unit.

CAUTION:

- **DO NOT** sit or stand on any part of the **Cruiser**.
- **DO NOT** lift and/or drop the **Cruiser** as doing so may cause bodily injury to the user and irreparable damage to the **Cruiser**.
- Play with the **Cruiser** on the floor or ground only.
- **DO NOT** operate this **Cruiser** during thunderstorms.
- Keep hair, fingers, loose clothing and other items away from rotating wheels of the unit.

TROUBLESHOOTING:

IF THERE IS NO FUNCTION BETWEEN THE REMOTE CONTROL AND THE **CRUISER**:

- Make sure the Remote Control and the **Cruiser** switches are in the "ON" position.
- Make sure the batteries are inserted properly.
- Replace the old batteries with new alkaline batteries.
- Move the Remote Control closer to the **Cruiser** to determine the best communication between the two.

FCC COMPLIANCE

NOTE: This equipment has been tested and found to comply with the limits for a Class B digital device, pursuant to Part 15 of the FCC Rules. These limits are designed to provide reasonable protection against harmful interference in a residential installation. This equipment generates, uses and can radiate radio frequency energy and, if not installed and used in accordance with the instructions, may cause harmful interference to radio communications. However, there is no guarantee that interference will not occur in a particular installation. If this equipment does cause harmful interference to radio or television reception, which can be determined by turning the equipment off and on, the user is encouraged to try to correct the interference by one or more of the following measures:

- Reorient or relocate the receiving antenna.
- Increase the separation between the equipment and receiver.
- Connect the equipment into an outlet on a circuit different from that to which the receiver is connected.
- Consult the dealer or an experienced radio/TV technician for help.

This device complies with Part 15 of the FCC Rules. Operation is subject to the following two conditions:

- (1) This device may not cause harmful interference.
- (2) this device must accept any interference received, including interference that may cause undesired operation.

Warning : Changes or modifications to this unit not expressly approved by the party responsible for compliance could void the user's authority to operate the equipment.

SAFE BATTERY USAGE

- Use alkaline batteries for best performance and longer life.
- Use only the type battery recommended for the unit.
- Batteries should be replaced only by an adult.
- Insert batteries with the correct polarity (+ and -).
- Do not mix old and new batteries.
- Do not mix alkaline, standard (carbon-zinc), or rechargeable(nickel-cadmium) batteries.
- Do not short-circuit batteries.
- When not used for an extended time, remove batteries to prevent possible leakage and damage to the unit.
- Do not mix rechargeable and non-rechargeable batteries.
- Rechargeable batteries are to be removed from the toy before charging.
- Rechargeable batteries are to be recharged only under adult supervision.
- Do not recharge non-rechargeable batteries.
- Exhausted batteries are to be removed from the toy.
- Do not dispose of batteries in fire as they may leak or explode.



'Let's care for the environment!' The wheelie bin symbol indicates that the product must not be disposed of with other household waste. Please use designated collection points or recycling facilities when disposing of the item. Do not treat old batteries as household waste. Take them to a designated recycling facility.

Please keep this manual as it contains important information.



0811-0-E

www.lalaloopsy.com
© MGA Entertainment, Inc.
LALALOOPSY™, MINI LALALOOPSY™ and
LALALOOPSY LITTLES™ are trademarks of MGA
in the U.S. and other countries.
All logos, names, characters, likenesses,
images, slogans, and packaging
appearance are the property of MGA.
16300 Roscoe Blvd.
Van Nuys, CA 91406 U.S.A.
(800) 222-4685
Printed in China

The preferred method of contact for
Customer Service is through our e-mail
contact form at www.mgae.com

