

SAFE BATTERY USAGE

- Use alkaline batteries for best performance and longer life.
- Use only the type battery recommended for the unit.
- Batteries should be replaced only by an adult.
- Insert batteries with the correct polarity (+ and -).
- Do not mix old and new batteries.
- Do not mix alkaline, standard (carbon-zinc), or rechargeable (nickel-cadmium) batteries.
- Do not short-circuit batteries.
- When not used for an extended time, remove batteries to prevent possible leakage and damage to the unit.
- Do not mix rechargeable and non-rechargeable batteries.
- Rechargeable batteries are to be removed from the toy before charging.
- Rechargeable batteries are to be recharged only under adult supervision.
- Do not recharge non-rechargeable batteries.
- Exhausted batteries are to be removed from the toy.
- Do not dispose of batteries in fire as they may leak or explode.

FCC COMPLIANCE

NOTE: This equipment has been tested and found to comply with the limits for a Class B digital device, pursuant to Part 15 of the FCC Rules. These limits are designed to provide reasonable protection against harmful interference in a residential installation. This equipment generates, uses and can radiate radio frequency energy and, if not installed and used in accordance with the instructions, may cause harmful interference to radio communications. However, there is no guarantee that interference will not occur in a particular installation. If this equipment does cause harmful interference to radio or television reception, which can be determined by turning the equipment off and on, the user is encouraged to try to correct the interference by one or more of the following measures:

- Reorient or relocate the receiving antenna.
- Increase the separation between the equipment and receiver.
- Connect the equipment into an outlet on a circuit different from that to which the receiver is connected.
- Consult the dealer or an experienced radio/TV technician for help.

This device complies with Part 15 of the FCC Rules. Operation is subject to the following two conditions: (1) This device may not cause harmful interference, and (2) this device must accept any interference received, including interference that may cause undesired operation.

Warning: Changes or modifications to this unit not expressly approved by the party responsible for compliance could void the user's authority to operate the equipment.



'Let's care for the environment!'

The wheelie bin symbol indicates that the product must not be disposed of with other household waste. Please use designated collection points or recycling facilities when disposing of the item. Do not treat old batteries as household waste. Take them to a designated recycling facility.

Please keep this manual as it contains important information.



0516-0-E

www.bratz.com
© MGA Entertainment, Inc.
BRATZILLAZ™, BRATZ® and BRATZ BOYZ® are trademarks of MGA in the U.S. and other countries. All logos, names, characters, likenesses, images, slogans, and packaging appearance are the property of MGA.
16300 Roscoe Blvd.
Van Nuys, CA 91406 U.S.A.
(800) 222-4685
Printed in China

The preferred method of contact for Customer Service is through our e-mail contact form at www.mgae.com

Visit mga.com to register your product and to enter our sweepstakes (No purchase necessary)



RC Hoverboard

5+ YEARS

WARNING:
CHOKING HAZARD—Small parts.
Not for children under 3 years.

SKU: 545613 / 545620

ADULT SUPERVISION AND BATTERY INSTALLATION REQUIRED

CONTENTS

- | | |
|---|--|
| A. 1 Doll with Fashion Cloe™ (545613) OR Yasmin™ (545620) | E. 1 Pair of Doll Elbow Pads |
| B. 1 Pair of Doll Shoes | F. 1 Doll Helmet |
| C. 1 Pair of Earrings | G. 1 Hoverboard for Doll (Cloe™: 27 MHz, Yasmin™: 49 MHz) |
| D. 1 Pair of Doll Knee Pads | H. 1 Remote Control |
| | I. 1 Doll Stand |

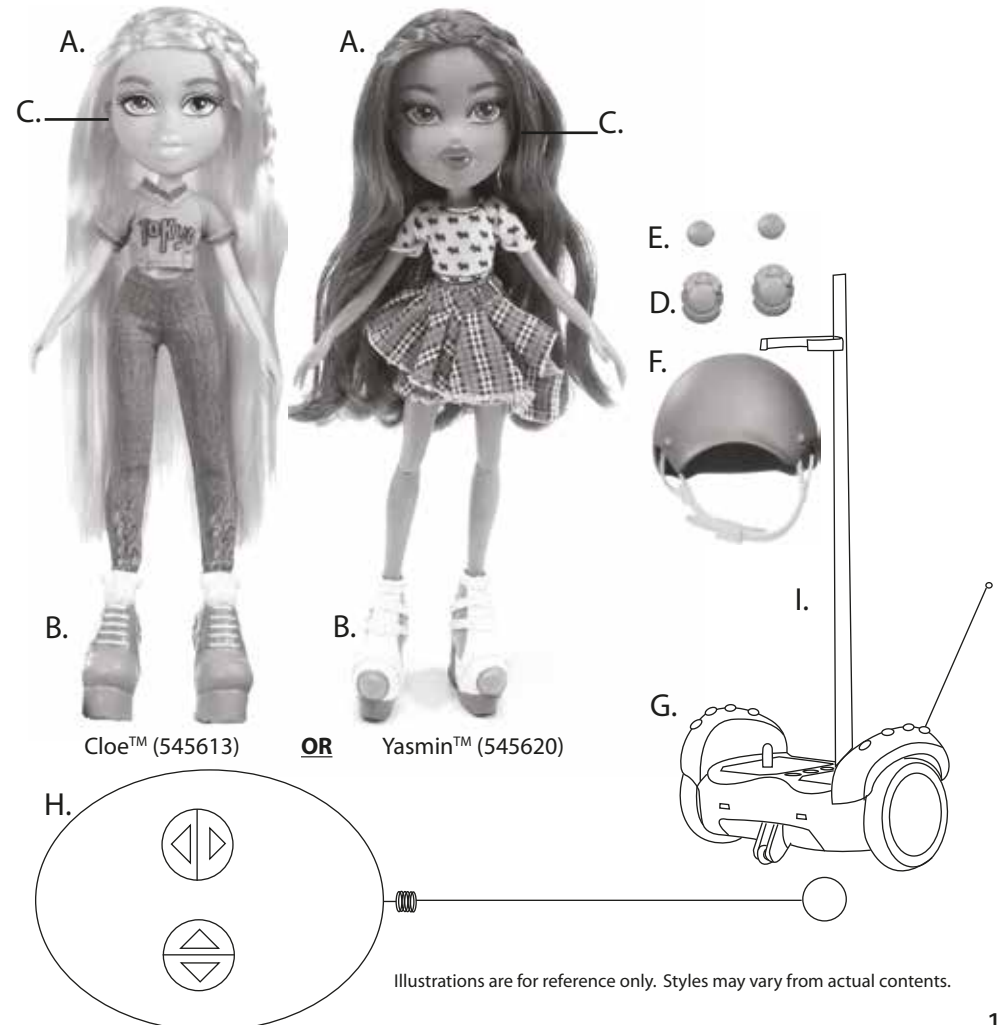

Illustrations are for reference only. Styles may vary from actual contents.

BATTERY INSTALLATION

Before playing, an adult must install fresh alkaline batteries in the HOVERBOARD and REMOTE.

HOVERBOARD

The batteries included in the hoverboard are for in-store demonstration purposes and should be replaced before use. Here's how:

1. Using a Phillips screwdriver (not included) remove the screw and battery compartment cover from the underside of the hoverboard.
2. Install three (3) fresh 1.5V AAA alkaline batteries (not included) making sure the (+) and (-) ends face the proper direction as indicated inside the battery compartment.
3. Replace the compartment cover and tighten the screw.

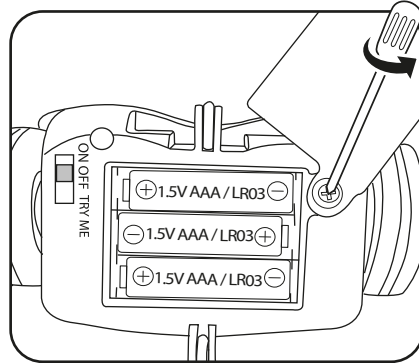

REMOTE CONTROL

1. Using a Phillips screwdriver (not included) remove the screw and battery compartment cover from the back side of the remote.
2. Install two (2) fresh 1.5V AAA alkaline batteries (not included) making sure the (+) and (-) ends face the proper direction as indicated inside the battery compartment.
3. Replace the compartment cover and tighten the screw.

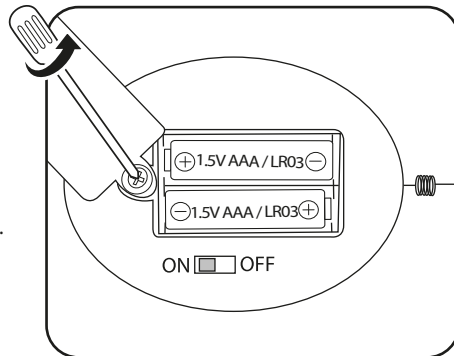

IMPORTANT NOTE:

In the event of a malfunction, reset the item by removing and replacing the batteries. If function is still not restored, replace the batteries with fresh alkaline batteries.

QUICK START

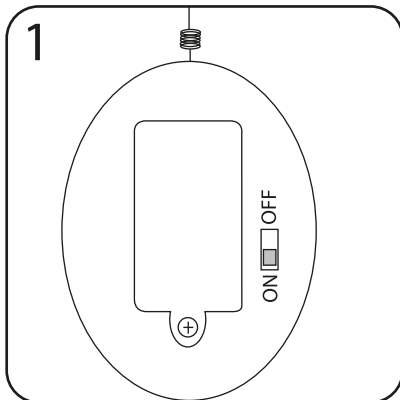

Turn ON the remote.

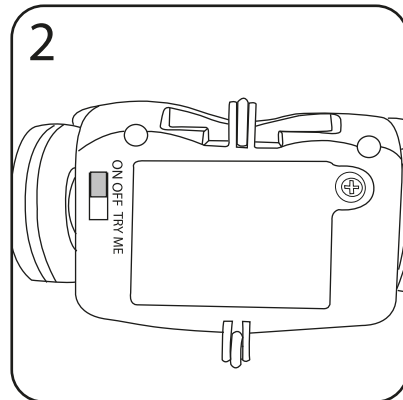

Move the switch on the hoverboard from "TRY ME" to "ON."

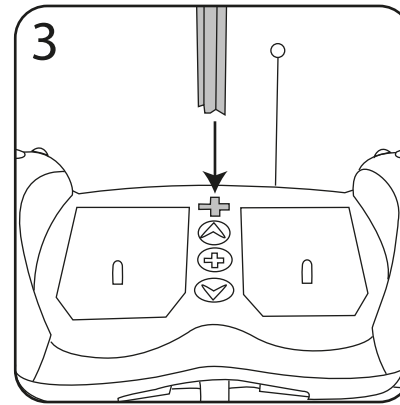

Insert the doll stand into the opening on top of the hoverboard.

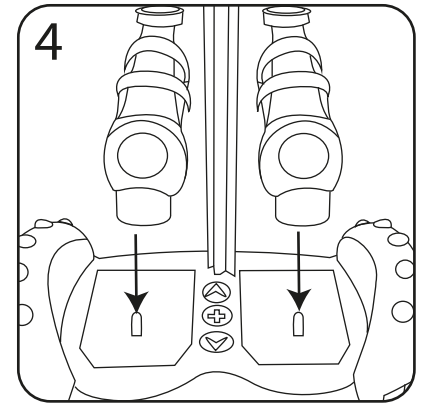

Place the doll's shoes on the pegs on top of the hoverboard and connect the doll's waist to the doll stand.

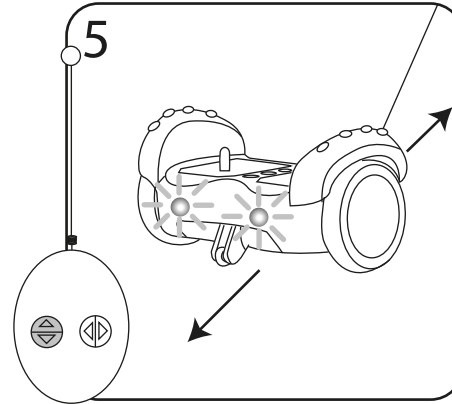

Press the or button to move the hoverboard forward or in reverse. The lights on the hoverboard light up while the hoverboard is in forward motion.

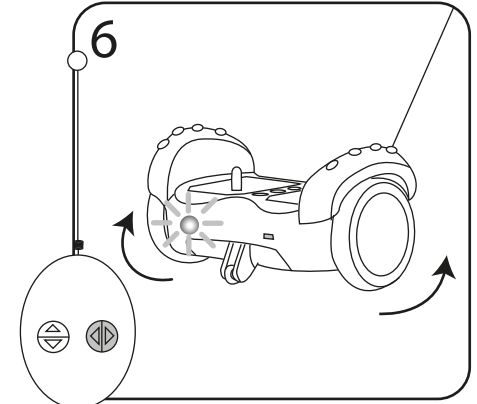

Press the or button to spin to the left or spin to the right. The left or right light on the hoverboard will light up in the direction you are turning.

IMPORTANT INFORMATION

- Only one hoverboard of the same MHz can be used at a time. Purchase a Cloe™ and Yasmin™ hoverboard to play at the same time.
- The hoverboard must remain in remote control range to operate correctly. The range depends on the surrounding area and on the strength of the battery. Obstructions such as buildings, fences, etc., between the remote control transmitter and the hoverboard reduce the range.
- Your Bratz® remote control hoverboard is controlled by radio frequency. It may interfere with nearby devices such as cordless phones, radios, walkie-talkies, or other radio controlled devices. If this occurs, move the hoverboard to a location away from the interference.
- If the doll comes with a jacket or vest, remove it before attaching the elbow pads.
- Always turn the hoverboard and the remote to the "OFF" position after playing to conserve battery power.
- Do not use the unit in the street, anywhere there is vehicular traffic, or in heavily traveled pedestrian areas.
- Do not stand or sit on or throw the unit as doing so can result in injury to the person and damage to the unit.
- Do not run the hoverboard into furniture, walls, pets, people etc., as doing so may cause injury to the people and pets and irreparable damage to the unit.
- Keep long hair and loose apparel such as shoestrings away from the turning wheels of the hoverboard.
- Do not drive the hoverboard through water or mud.
- Use on a flat, level surface. The unit operates on some low-pile carpet, but best performance is achieved on smooth flooring.
- Do not expose the hoverboard or remote to moisture of any kind.
- DO NOT wash doll's hair with water and/or soap.
- DO NOT dry doll's hair with a hair dryer or subject hair to very high heat in any manner.
- DO NOT operate this hoverboard during thunderstorms.