

User Manual

WIRELESS
HEADSET
MF250

MF250 with Crystal Audio Quality



ENCLOSURES



Bluetooth Headset



Ear hook



A/C power adapter



3 different size ear rubber (Small, Medium, Large)



User manual

Product Components Hands-Free Unit

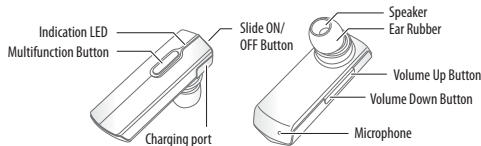

HOW TO USE

POWER ON/ OFF

- Power On : Please slide the button to ON side.
- Power Off : Please slide the button to opposite direction of ON.

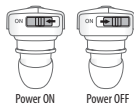

PAIRING

Before you use headset, please pair your headset with mobile phone first.

1. Slide the button to ON. [Ensure headset is turned ON]

2. Press and hold the Multi-Function Button for 4 sec. until Blue & Red LED light flash repeatedly.
3. Search the headset via your mobile phone. Please follow the instruction of your mobile phone.
4. When you find your headset, Please select it and confirm by "Yes" or "OK"
5. PIN Number is '0000'(4 zeros).

- SIMPLE PAIRING: If your mobile phone supports bluetooth core spec 2.1, then you don't need to put PIN number to pair. (This function is only available when your mobile phone supports bluetooth version 2.1)
- EASY PAIRING: If you use headset for the first time, headset will go pairing mode directly.

MAKING A CALL

- Last number re-dial : Press Multi-Function button shortly.
- Voice dial : Press Multi-Function button for 2 seconds.

Once your mobile phone in voice dialing mode, please follow the step as your mobile phone instructed. You can de-activate voice dial mode by push Multi-Function button for 2 seconds in voice dialing mode.

[Note] Please check if your mobile phone supports voice dialing function.
Please record voice tag first before you use this function.
Please turn the headset off and try auto reconnection if the function does not work properly.

ANSWERING A CALL

Press the Multi-function button briefly to receive call.

REJECT AN INCOMING CALL



4.reference



5.reference

Press and hold Multi-Function button for 2 seconds.

ENDING A CALL

- Press Multi-Function button shortly while you are on the line.
- You can also ending a call from your mobile by push “END” button.

TRANSFERRING A CALL

- Headset to mobile phone: Press and hold Multi-Function button for 2 seconds.
- Mobile phone to headset: Press and hold Multi-Function button for 2 seconds.

MIC MUTE

- Press and hold volume down button for 2 seconds. Then the MIC mute will be activated. You can hear the status indication melody every 5 seconds in MIC mute mode.
- You can de-activate the MIC mute mode by pushing volume down button for 2 seconds.

CALL WAITING [3way calling]

Before you use 3way calling function, please make sure that your mobile phone supports “Handsfree profile”. And please check with your network operator if they support Call hold & Multiparty call service.

1. Connect to incoming call & disconnect your current call.
 - : Press and hold volume down button for 4 seconds.
2. Put your current call in waiting mode and receive incoming call.
 - : Press and hold volume up button for 4 seconds.

[TIP] Call waiting mode by pushing “Send” button on your mobile phone.

MULTIPOINT FUNCTION

The Headset Unit supports simultaneous connection with 2 mobile phones with full control of each unit.

[Note] This feature may not be compatible with certain mobile phones.

1. Multi-Point Connect

Set the device into the pairing-mode first, and search the unit individually from 2 mobile phones. Make sure one mobile phone is connected properly to the unit before trying the other one. You can check connection with the mobile phones through beep and LED flashing.

2. Making a phone call [To use the 2nd mobile phone]

Press the Volume Down button for about 2 seconds until a beep sound is heard to make an last number redial from the second mobile phone. Press the Volume Up button for about 2 seconds until a beep sound is heard to activate voice dial of the second mobile phone.

[Note] Making a phone call [To use the 1st mobile phone] Follow the same instruction a section ‘Making a call’ described already.

3. Receiving a call

Press the Multi-Function button to receive incoming calls.

[Note] Each mobile phone plays different ring tones. When you are on the line with the mobile phone, the connection with the other mobile phone will be disconnected. But it will be automatically re-connected when you terminate the call and keep connection with 2 mobile phones.

RESET OF THE HEADSET

Press and hold Multi-Function button & Volume Down button for 3 seconds. Then all device information and call list of your headset will be reset.

STATUS INDICATION

1. LED Indication

Status	LED Indication
--------	----------------

Power On	Blue LED blinks 3 times
Pairing Mode	Blue & Red LED blink repeatedly
Connectable Mode	Blue LED blinks 1 time every 5 seconds
Connected Mode	Blue LED blinks 2 times every 5 seconds
Active Call Mode	Blue LED blinks 3 times every 5 seconds
Charging in Progress	Red LED turns on
Charging Complete	Red LED turns off

2. Tone Indication

Status	Tone Indication
Power On	Turn-on melody
Connect	3 Short Beep
Incoming Call	Ring melody
Active Call	2 Rising Beep
Ending a Call	2 Falling Beep
Low Battery	Low Battery melody

SPECIFICATIONS

Model Name	MF250
Bluetooth Core Spec	Bluetooth Specification 2.1+EDR
Profile	HSP, HFP1.5
Carrier Frequency	2400 MHz to 2483.5 MHz
Modulation Method	GFSK, 1Mbps, 0.5BT Gaussian
Maximum Data Rate	Asynchronous : 2178.1 kbps / 177.1 kbps Synchronous : 1306.9 kbps / 1306.9 kbps
Bluetooth Class	Class 2
Hopping	1600 hops/sec, 1MHz Channel Space

Transmit Power	0 dBm
Coverage Range	10 Meters
Receiver Sensitivity	-82 dBm / 0.1 % BER
Continuous Talk Time	6 Hours
Standby Time	180 Hours
Weight	10 g
Dimension	18.1(H) x 51.3(L) x 9.5(H) mm
Charging Voltage	DC 5.0 ~ 5.3 V
Charging Time	2 Hours
Operating Temperature	-10° to +50°C
Storage Temperature	-20° to +80°C
Battery	Lithium Polymer 3.7V 90mAh

SAFETY AND GENERAL INFORMATION

1. Please read this guidebook carefully and follow the instruction.
2. To avoid any damage or malfunction of the unit, do not drop it from high place.
3. Keep away unit from humidity, water and any other liquid. And if the unit is exposed by water, moisture and other liquid directly, then do not operate it normally to avoid any electrical shock, explosion and damage of the unit.
4. Do not place or keep the unit near the heat sources such as direct sun light, radiators, stoves or other apparatus which produce heat. It may cause explosion, degrade of performance and reduce battery life.
5. Do not modify, repair & disassemble unit at discretion. [especially battery: it may cause an explosion]
6. Do not place the heavy objects on the unit.
7. Use only supplied and approved charger.
8. Replacement or service must be done at a qualified service center or manufacturer.
9. Unplug this unit when unused for long period of time or during lightning storms.

[CAUTIONS] ELECTRIC SHOCK HAZARD : The battery used in this device may present a risk of fire or chemical burn if mis-treated.

FCC STATEMENT

This device complies with part 15 of the FCC Rules. Operation is subject to the following two conditions:

- (1) This device may not cause harmful interference, and
- (2) This device must accept any interference received, including interference that may cause undesired operation.

[Note] The manufacturer is not responsible for AzNY interference, for example RADIO or TV interference, caused by unauthorized modifications to this equipment. Such modifications could void the user's authority to operate the equipment.

EU

This product is CE marked according to the provision of the R&TTE Directive (99/5/EC).

Here by MOVON Corporation, declares that this product is in compliance with the essential requirements and other relevant provisions of Directive 1999/5/EC.

Please note that this product uses radio frequency bands not harmonized within EU. Within the EU this product is intended to be used in Austria, Belgium, Denmark, Finland, France, Germany, Greece, Ireland, Italy, Luxembourg, The Netherlands, Portugal, Spain, Sweden, United Kingdom and within EFTA in Iceland, Norway and Switzerland. Bluetooth is a trademark owned by the Bluetooth SIG, Inc.

WARRANTY

The condition of this warranty and our responsibilities under this warranty are as follows:

Supplier's warranty is non-transferable. And this warranty is limited to the original purchaser only.

- You must be able to prove the date of original purchase of the unit with a dated receipt.
- The warranty is not applicable if the product has been subject to physical abuse, improper installation, modification or repair by unauthorized third party.
- The responsibility of supplier's products shall be limited to the repair or replacement of the product at its sole discretion.
- Specifically exempt from any warranty are limited-life consumable components subject to normal wear and tear such as batteries, decorates and other accessories.
- A supplier will not take any responsibility if the failure of the unit has resulted from accident, abuse, misuse or any unauthorized repair, modification or disassemble.
- Modification and repair of the unit should be done by authorized and qualified service personnel, center or returned to the manufacturer
- This warranty gives you specific legal rights and you may also have other rights which vary under local laws.

WEEE SYMBOL INFORMATION



Correct Disposal of This Product
(Waste Electrical & Electronic Equipment)

(Applicable in the European Union and other European countries with separate collection systems) This marking shown on the product or its literature, indicates that it should not be disposed with other household wastes at the end of its working life.

To prevent possible harm to the environment or human health from uncontrolled waste disposal, please separate this from other types of wastes and recycle it responsibly to promote the sustainable reuse of material resources.

Household users should contact either the retailer where they purchased this product or their local government office, for details of where and how they can take this item for environmentally safe recycling.

Business users should contact their supplier and check the terms and conditions of the purchase contract. This product should not be mixed with other commercial wastes for disposal.

[IMPORTANT NOTE] To comply with RF exposure requirements, this device may not be co-located with any other transmitter or antenna.