

Bluetooth®
Wireless Stereo Headset
mini Forte

MOVON
www.movon.co.kr

MOVON Corp, Korea. All rights reserved.
MOVON and MOVON logo are registered trademarks of
MOVON Corporation and our Bluetooth products.
Bluetooth is a trademark owned by Bluetooth SIG, INC,
and is used by MOVON Corp, Korea under license.
Designed by MOVON Korea

* Specifications and features are subject to change without notice.



Wireless Stereo Headset

MS500

mini Forte

User Manual

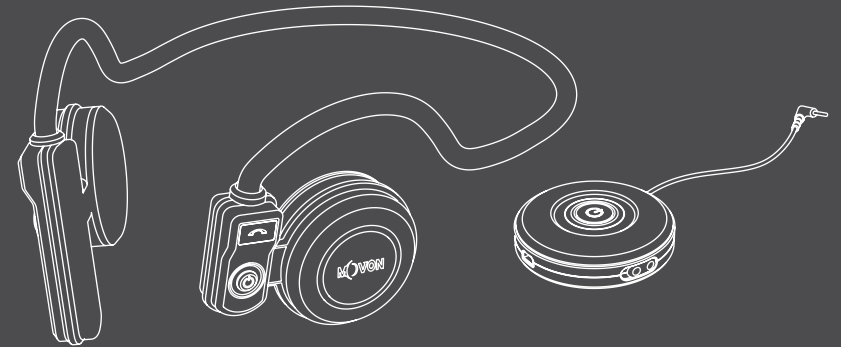

Package Contents

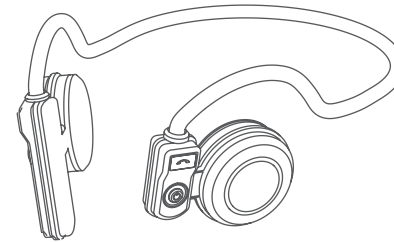

① Headset

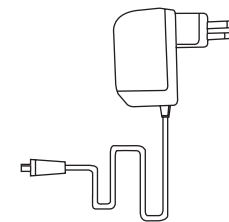

② Charger



③ User Manual

*Optional item
: Audio Dongle

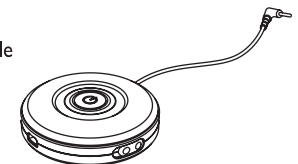

* Overview of Stereo Headset

Left

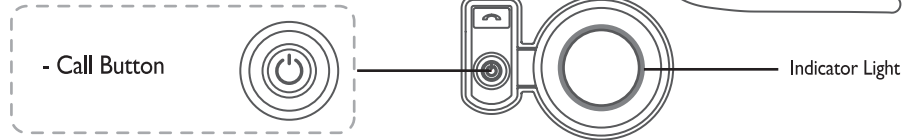

Right

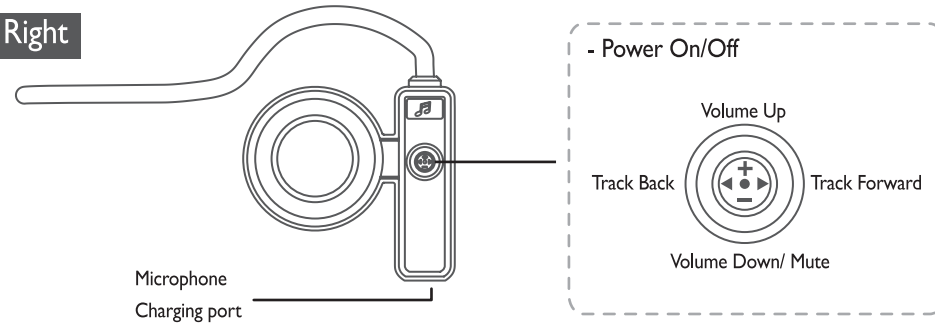

** Optional item **

* Universal Dongle

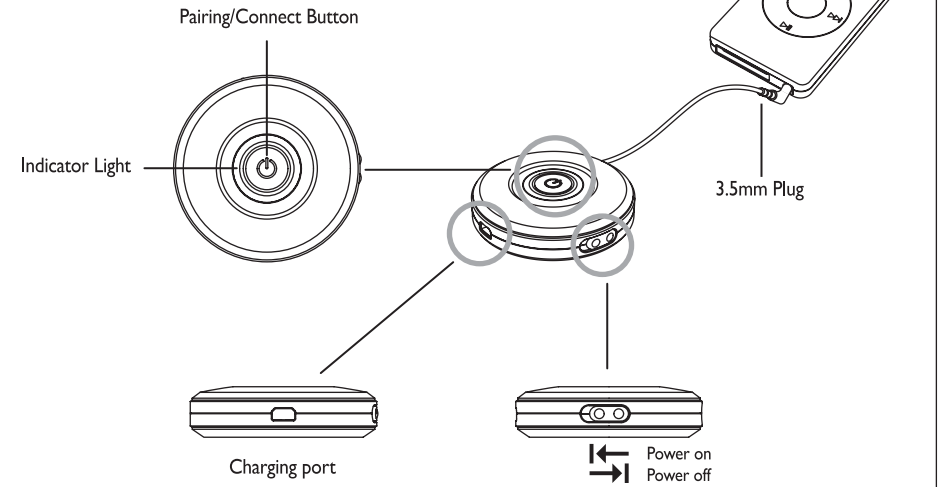

* Turning headset on / off

BASIC OPERATION

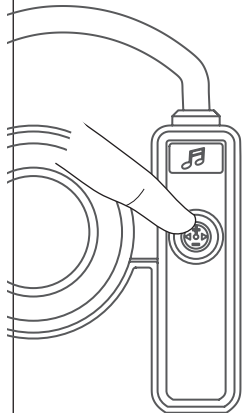

	How to act	Tones	Indicators
Turning headset on	Press and hold the JOG controller for 2 seconds until you see a Blue indicator light flashing.	Turn-On melody	The Blue indicator light will flash while the power is on.
Turning headset off	Press and hold the JOG controller for 4 seconds until you see a Red indicator light flashing.	Turn-Off melody	The Red indicator light will flash while the power is off.



* Pairing headset with Bluetooth Device

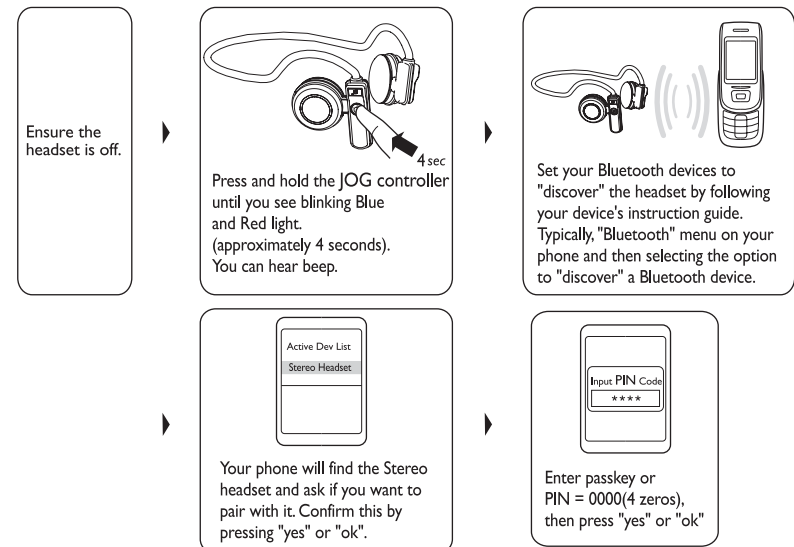

* Pairing headset with Universal Dongle

** Optional item **

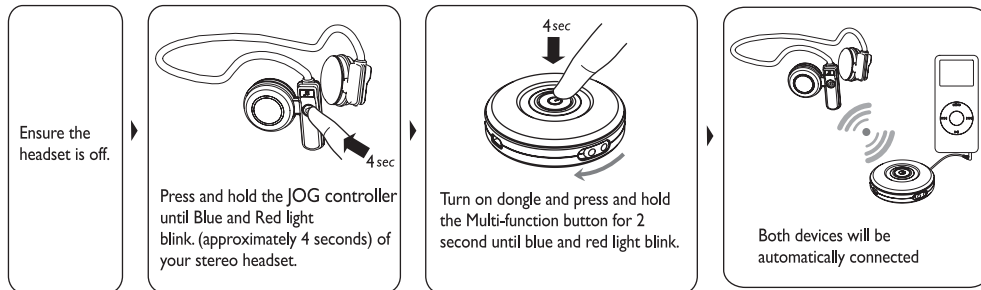

IMPORTANT!

If pairing was successful, the blue indicator light will flash two times every 5 seconds. If unsuccessful, the blue indicator light will flash one time every 5 seconds.

* MUSIC PLAY MODE (Right)

Feature	Action	
Play / Pause / * Resume	Press JOG controller to Play/Pause/Resume	
Stop *	Press and hold JOG controller for 2 second	
Track forward & Backward *	Push Jog controller to front and rear direction to skip to next track or to go back to previous track	
Adjusting volume	Push Jog controller to up and down direction	

* Only works if Bluetooth device supports Bluetooth audio/video remote control profile(AVRCP), does not work when using universal dongle.

* Answering a call while listening music

- During the music playing when a call is received, the music will be paused automatically and you will hear the ringing from the speaker.
- Press the multi-function button on the left briefly to receive a phone call.
- After the phone call, the music automatically comes back.

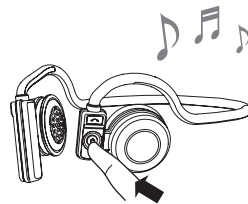

* Rejecting a call while listening music

- Press and hold multi-function button for 2 seconds.

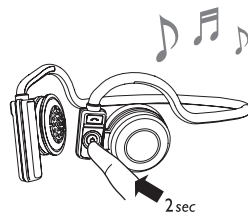

* CALL MODE(Left)

Feature	Action	
Making/ Answering/ Ending calls	Press Call button briefly	
Switching an active call from headset to phone or phone to headset	Press Call button for 2 second while you are making call.	
Last number re-dial	Press Call button briefly	
Activate Voice dial	Press and hold the Call button, you will hear short beep and long beep with two-second interval	
Call reject	Press and hold Call button for 2 second	
Mute	Push JOG Controller to down side for 2 second. You can resume it by push JOG controller to up(down) side one time.	

* Status Indicator

Status	LED Indication	Audio Indication
Power ON	Blue flash	Turn on melody
Power OFF	Red flash	Turn off melody
Standby Mode	Blue flashes 1 time every 5 second	
Active Mode/ On call	Blue flashes 3 times every 5 second	
Charging	Red solid light	
Charging Complete	Light off	
Low Battery	Blue flashes changes to Red	Double tones repeated 1 times every 20 second

* Safety and General Information

1. Please read this guidebook carefully and follow the instruction
2. To avoid any damage or malfunction of the unit do not drop unit from high places
3. Keep away unit from humidity, water and any other liquid. And if the unit is exposed by water, moisture and other liquid directly then don't operate it to avoid any electrical shock, explosion and damage of the unit.
4. Do not place or keep the unit near the heat sources such as direct sun light, radiators, stoves or other apparatus which produce heat. It may cause explosion, degrade of performance and reduce battery life.
5. Do not modify, repair & disassemble unit at discretion (Especially battery: It may cause an explosion)
6. Do not place the heavy objects on the unit.
7. Use only supplied and approved charger.
8. Replacement or service must be done by qualified service center or manufacturer.
9. Unplug this unit when unused for long periods of time or during lightning storms.

⚠ CAUTIONS: ELECTRIC SHOCK HAZARD

The battery used in this device may present a risk of fire or chemical burn if mis-treated.

* FCC & IC STATEMENT

Operation is subject to the following two conditions:

- (1) This device may not cause harmful interference, and
- (2) this device must accept any interference received, including interference that may cause undesired operation.

Note: The manufacturer is not responsible for ANY interference, for example RADIO or TV interference, caused by unauthorized modifications to this equipment.

Such modifications could void the user's authority to operate the equipment.

* EU

This product is CE marked according to the provision of the R&TTE Directive (99/5/EC). Here by MOVON Corporation, declares that this product is in compliance with the essential requirements and other relevant provisions of Directive 1999/5/EC.

For further information please visit www.movon.co.kr

You can find the DoC from following website: www.movon.co.kr/certificate/rtte

Please note that this product uses radio frequency bands not harmonized within EU. Within the EU this product is intended to be used in Austria, Belgium, Denmark, Finland, France, Germany, Greece, Ireland, Italy, Luxembourg, The Netherlands, Portugal, Spain, Sweden, United Kingdom and within EFTA in Iceland, Norway and Switzerland.

Bluetooth is a trademark owned by the Bluetooth SIG, Inc.

* Warranty

The condition of this warranty and our responsibilities under this warranty are as follows:

Supplier's warranty is non-transferable. And this warranty is limited to the original purchaser only.

- " You must be able to prove the date of original purchase of the unit with a dated receipt.
- " The warranty is not applicable if the product has been subject to physical abuse, improper installation, modification or repair by unauthorized third party.
- " The responsibility of supplier's products shall be limited to the repair or replacement of the product at it's sole discretion.
- " Specifically exempt from any warranty are limited-life consumable components subject to normal wear and tear such as batteries, decorates and other accessories.
- " A supplier will not take any responsibility if the failure of the unit has resulted from accident, abuse, misuse, or any unauthorized repair, modification or disassemble.
- " Modification and repair of the unit should be done by authorized and qualified service personnel, Center or returned to the manufacturer
- " This warranty gives you specific legal rights, and you may also have other rights which vary under local laws.



WEEE Symbol Information



Correct Disposal of This Product (Waste Electrical & Electronic Equipment)

(Applicable in the European Union and other European countries with separate collection systems)

This marking shown on the product or its literature, indicates that it should not be disposed with other household wastes at the end of its working life. To prevent possible harm to the environment or human health from uncontrolled waste disposal, please separate this from other types of wastes and recycle it responsibly to promote the sustainable reuse of material resources.

Household users should contact either the retailer where they purchased this product or their local government office, for details of where and how they can take this item for environmentally safe recycling.

Business users should contact their supplier and check the terms and conditions of the purchase contract. This product should not be mixed with other commercial wastes for disposal.

IMPORTANT NOTE: To comply with RF exposure requirements, this device may not be co-located with any other transmitter or antenna