

## ROTARY MOWER

**MODEL NOS.**  
**113-112 113-122**  
**113-132 and 113-142**

### IMPORTANT

## SAFE OPERATION PRACTICES FOR WALK-BEHIND MOWERS

### TRAINING

1. Read the Operating and Service Instruction Manual carefully. Be thoroughly familiar with the controls and the proper use of the equipment.
2. Never allow children to operate a power mower.
3. Keep the area of operation clear of all persons, particularly small children, and pets.
5. If the equipment should start to vibrate abnormally, stop the engine (motor) and check immediately for the cause. Vibration is generally a warning of trouble.
6. Stop the engine (motor) whenever you leave the equipment, before cleaning the mower housing, and when making any repairs or inspections.

### PREPARATION

1. Thoroughly inspect the area where the equipment is to be used and remove all stones, sticks, wire, bones and other foreign objects.
2. Do not operate equipment when barefoot or wearing open sandals. Always wear substantial footwear.
3. Check the fuel before starting the engine. Do not fill the gasoline tank indoors, when the engine is running, or while the engine is still hot. Wipe off any spilled gasoline before starting the engine.
4. Disengage the self-propelled mechanism or drive clutch on units so equipped before starting the engine (motor).
5. Never attempt to make a wheel adjustment while the engine (motor) is running.
6. Mow only in daylight or in good artificial light.
7. Never operate the equipment in wet grass. Always be sure of your footing; keep a firm hold on the handle and walk, never run.
7. When cleaning, repairing or inspecting, make certain the blade and all moving parts have stopped. Disconnect the spark plug wire, and keep the wire away from the plug to prevent accidental starting.
8. Do not run the engine indoors.
9. Shut the engine (motor) off and wait until the blade comes to a complete stop before removing the grass catcher or unclogging chute.
10. Mow across the face of slopes, never up-and-down. Exercise extreme caution when changing direction on slopes. Do not mow excessively steep slopes.
11. Always disconnect electric mowers (line operated) before cleaning, repairing or adjusting.
12. Never operate mower without proper guards, plates or other safety protective devices in place.
13. Keep washout ports and other mower-housing service openings closed when mowing.

### OPERATION

1. Do not change the engine governor settings or overspeed the engine.
2. Do not put hands or feet near or under rotating parts. Keep clear of the discharge opening at all times.
3. Stop the blade(s) when crossing gravel drive, walks or roads.
4. After striking a foreign object, stop the engine (motor), remove the wire from spark plug, thoroughly inspect the mower for any damage, and repair the damage before restarting and operating the mower.

### MAINTENANCE AND STORAGE

1. Check the blade and the engine mounting bolts at frequent intervals for proper tightness.
2. Keep all nuts, bolts, and screws tight to be sure the equipment is in safe working condition.
3. Never store the equipment with gasoline in the tank inside of a building where fumes may reach an open flame or spark. Allow the engine to cool before storing in any enclosure.
4. To reduce fire hazard, keep the engine free of grass, leaves, or excessive grease.
5. Check the grass catcher bags frequently for wear or deterioration. Replace with new bags for safety protection.

**HANDLE ASSEMBLY FOR MODELS 113-132 AND 113-142**

**NOTE: Follow instructions starting with Number 1 and continue through Number 4.**

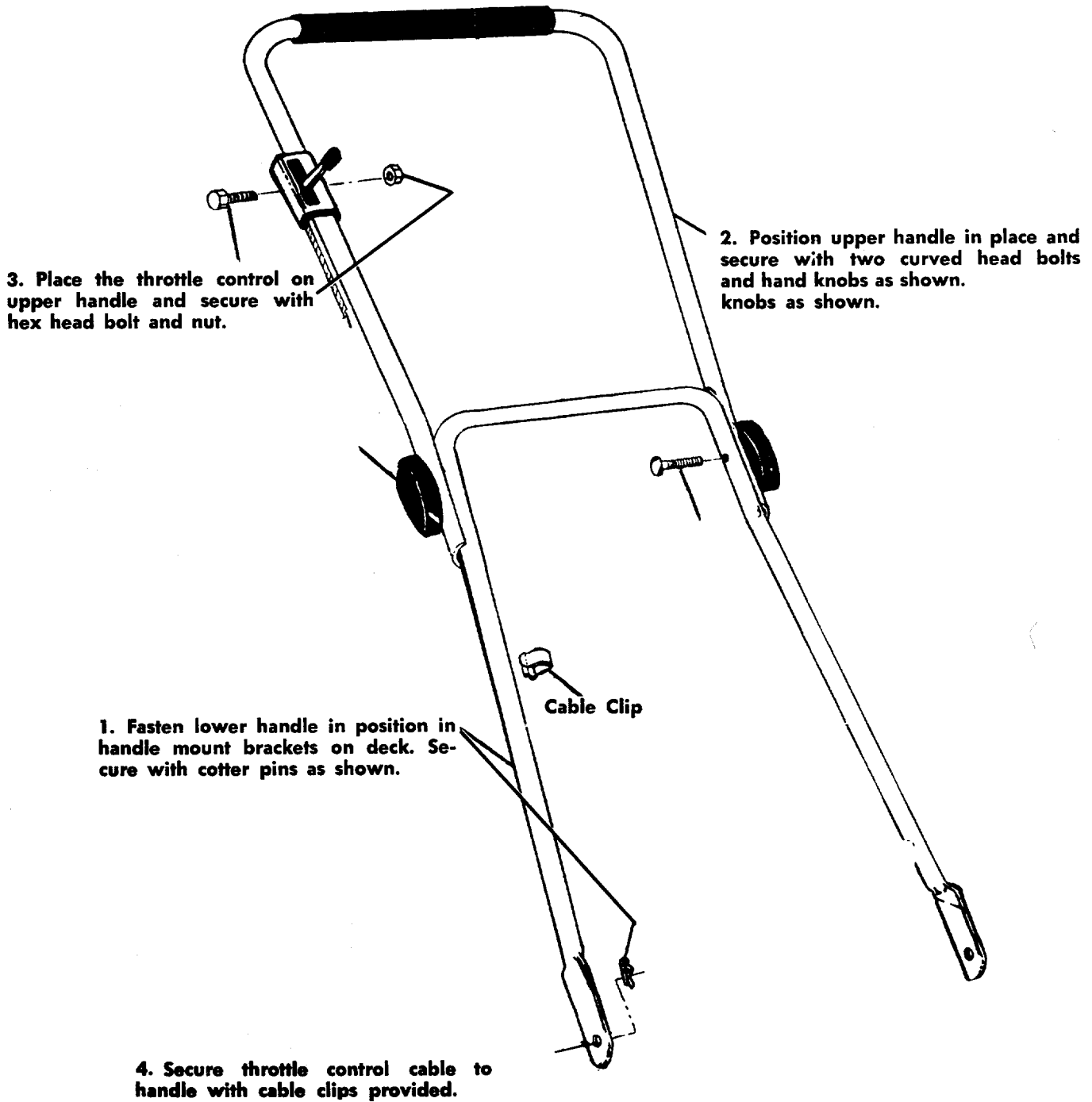

## ASSEMBLY FOR HANDLE MODELS 113-112 AND 113-122

1. Remove the loose hardware from the assembly pack. You will need a screwdriver and a 5/16" wrench, either a socket as shown in figure 1 or an open end wrench.
2. Assemble the lower handle to the handle brackets as shown in figure 2.
3. Secure the handle with cotter hairpins on both sides. See figure 2.
4. Place the handle panel over the lower handle and fasten with the handle panel screw using a 5/16" wrench. See figure 3.
5. Place the upper handle over the lower handle and line up the holes as shown in figure 4.
6. Insert the curved head bolt from the inside and tighten the knob by hand. See figure 4.
7. Place the throttle control in the handle panel and assemble it with the two throttle screws using a screwdriver. See figure 5.
8. Use the cable clip to fasten the throttle control wire to the lower handle.

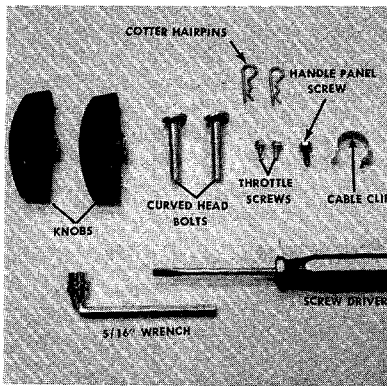

**FIGURE 1.**  
**LOOSE HARDWARE AND TOOLS**

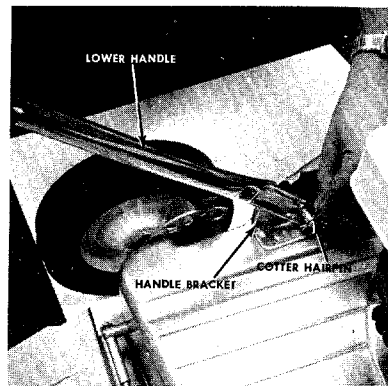

**FIGURE 2.**  
**LOWER HANDLE ASSEMBLY**

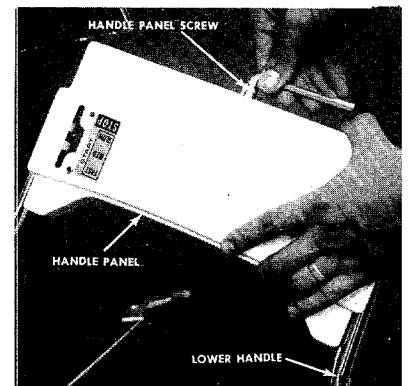

**FIGURE 3.**  
**HANDLE PANEL ASSEMBLY**

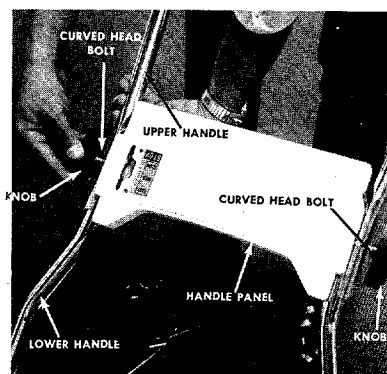

**FIGURE 4.**  
**UPPER HANDLE ASSEMBLY**

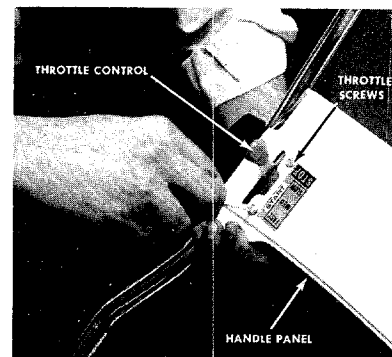
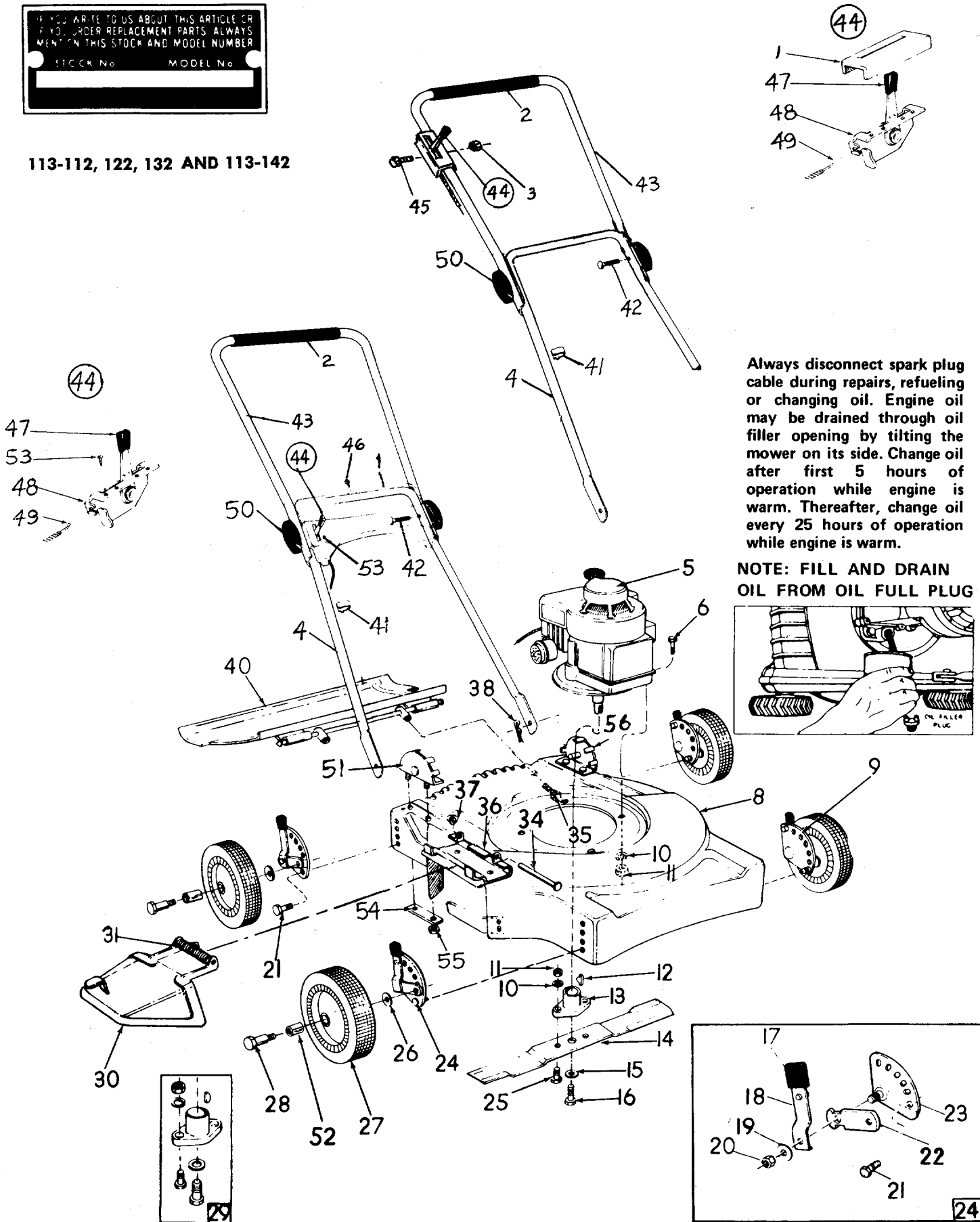

**FIGURE 5.**  
**THROTTLE CONTROL ASSEMBLY**

IF YOU WRITE TO US ABOUT THIS ARTICLE OR  
 FOR ORDER REPLACEMENT PARTS ALWAYS  
 MENTION THIS STOCK AND MODEL NUMBER

STOCK No. \_\_\_\_\_ MODEL No. \_\_\_\_\_

113-112, 122, 132 AND 113-142



Always disconnect spark plug cable during repairs, refueling or changing oil. Engine oil may be drained through oil filler opening by tilting the mower on its side. Change oil after first 5 hours of operation while engine is warm. Thereafter, change oil every 25 hours of operation while engine is warm.

**NOTE: FILL AND DRAIN OIL FROM OIL FULL PLUG**

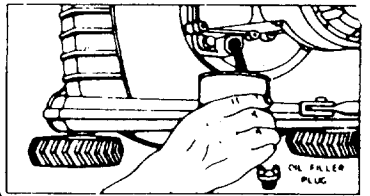

**PARTS LIST FOR MOWER MODELS 113-112, 122, 132 AND 142**

Ref. No.	Part No. 113-112	Color Code	Part No. 113-122	Color Code	Part No. 113-132	Color Code	Part No. 113-142	Color Code	Description	New Part
1	11606		11606		731-180		731-180		Throttle Control - Cover	
2	718-143		718-143		718-143		718-143		Grips	N
3	None		None		712-107		712-107		Hex Center Locknut 1/4-20 Thd.	
4	10024		10024		10024		10024		Lower Handle	
5	-----		-----		-----		-----		Engine	
6	710-158		710-158		710-158		710-158		Hex Hd. Cap Scr. 5/16-24 x 1-1/4" Ig. *	
8	11409-458		11411-458		11409-458		11411-458		Deck Assembly	
9	None		None		10950		10950		Height Adjuster Assembly - comp. L.H.	
10	736-119		736-119		736-119		736-119		Spring Lockwasher 5/16" Scr. *	
11	712-123		712-123		712-123		712-123		Hex Nut 5/16-24 Thd. *	
12	714-365		714-365		714-365		714-365		Hi Pro Key No. 505	
13	10769		10769		10769		10769		Blade Adapter Kit	
14	742-123		742-125		742-123		742-125		Blade	
15	736-217		736-217		736-217		736-217		Spring Lockwasher 3/8" Scr. - Heavy Duty	
16	710-459		710-459		710-459		710-459		Hex Hd. Cap Scr. 3/8-24 x 1-1/2" Ig. - heat treated	
17	None		None		7520		7520		Knob - Height Adjuster	
18	None		None		10949		10949		Spring Lever Ass'y. with Knob	
19	None		None		736-219		736-219		Belleville Washer .400 I.D. x 1.130 O.D.	
20	None		None		712-116		712-116		Elastic Stopnut	
21	None		None		710-209		710-209		Semx Hex Hd. Cap Scr. 3/8-16 x 5/8" Ig.	
22	None		None		10937		10937		Pivot Bar	
23	None		None		10934		10934		Index Plate Ass'y. - R.H.	
	None		None		10935		10935		Index Plate Ass'y. - L.H.	
24	None		None		10951		10951		Height Adjuster Assembly - Comp. R.H.	
25	710-117		710-117		710-117		710-117		Hex Hd. Cap Scr. 5/16-24 x 1" Ig. - heat treated	
26	736-105		736-105		736-105		736-105		Belleville Washer 3/8" Scr.	
27	9392-502		9392-501		9392-502		9392-501		Wheel Assembly - complete	
28	738-213		738-213		738-102		738-102		Axle Bolt	
29	10769		10769		10769		10769		Blade Adapter Kit	
30	11141-458		11141-458		11141-458		11141-458		Chute Deflector	
31	732-253		732-253		732-253		732-253		Torsion Spring	
34	711-555		711-555		711-555		711-555		Pivot Pin	
35	710-513		710-513		710-513		710-513		Hex Hd. Cap Scr. 1/4-28 x .62" Ig. Nylock	
36	11130-458		11130-458		11130-458		11130-458		Adapter Plate	
37	726-106		726-106		726-106		726-106		Push-on Flange Nut	
38	714-104		714-104		714-104		714-104		Hair Pin Cotter	
40	11196-458		11197-458		11193-458		11197-458		Rear Protective Shield Ass'y. - complete	N
41	746-128		746-128		746-128		746-128		Cable Clip	
42	710-405		710-405		710-405		710-405		Curved Hd. Bolt	
43	10011		10011		11204		11204		Upper Handle	
44	11610		11610		11609		11609		Throttle Control - complete	
45	None		None		710-606		710-606		Hex Hd. Cap Scr. 1/4-20 x 1-1/2" Ig. *	
46	710-473		710-473		None		None		Truss Hd. Mach. Scr. #10-24 x .50" Lg.	
47	7470		7470		7470		7470		Throttle Control - Knob	
48	11600		11600		11597		11597		Throttle Control Ass'y.	
49	732-200		732-200		732-141		732-141		Conduit and Wire	
50	9966		9966		9966		9966		Hand Knob	
51	8388		8388		8388		8388		Handle Mount Brkt. Assy.—R.H.	
52	7006		7006		7006		7006		Fortiflex Bearing	
53	710-407		710-407		None		None		Slotted Hex Hd. Self Extr. Scr. #8-32 x .50" Lg.	
54	8405		8405		8405		8405		Reinforcement Plate	
55	712-107		712-107		712-107		712-107		Hex Center Lock Nut 1/4-20 Thd.	
	11679-458		11679-458		11679-458		11679-458		Chute Deflector Ass'y. - complete (Includes Ref. Nos. 30, 32, 34, 36, 37)	N
56	8389		8389		8389		8389		Handle Mount Brkt. Ass'y.—L.H.	

\*For faster service, obtain standard nuts, bolts and washers locally. If these items cannot be obtained locally, order by part number and size as shown on the parts list.

(458 - Arctic Blue) - When ordering parts if color or finish is important, use the appropriate color code shown at left. (e.g. Arctic Blue - 11409 (458)).

**NOTE:** This instruction manual covers various models and all accessories shown do not necessarily apply to your model mower.

The engine is not under warranty by the mower manufacturer. If repairs or service is needed on the engine, please contact your nearest authorized engine service outlet. Check the "Yellow Pages" of your telephone book under "Engines - Gasoline."

Find us fast in the



## OPERATION

**NOTE:** For shipping purposes your mower is set with the wheels in a low cutting height position. For best results raise the cutting position until it is determined which height is best for your lawn. See adjustments.

1. Service engine with gas and oil. See Engine Manual packed with lawn mower for complete instructions for the care and maintenance of engine. **Read Directions Carefully.**
2. When ready to start engine, place throttle control lever, on handle, in "START" position and start engine in accordance with instructions in Engine Manual. After engine starts, move throttle control lever, on handle, to desired engine speed. The engine is stopped by placing control lever on handle in the "STOP" position.
3. Be sure that lawn is clear of stones, sticks, wire or other objects which could damage lawn mower or engine. For best results and to insure more even grass distribution, do not mow when lawn is excessively wet.

## ADJUSTMENTS

**CAUTION:** Do not at any time make any adjustment to lawn mower without first stopping engine and disconnecting spark plug wire.

### **CUTTING HEIGHT** — (For Models 113-112 and 122)

Adjustment may be made by removing and moving wheel studs to desired position. Cutting heights will be raised as wheel studs are moved to a lower hole and lowered as wheel studs are moved to a higher hole in the deck. All wheel studs must be mounted in a relative position to the deck.

### **EASY CUTTING HEIGHT** — (Optional for 113-132 and 142)

An adjusting plate and thumb lever at each wheel position provides cutting height adjustment. Each adjusting plate has five holes. Height of cut will be changed when the thumb lever is moved from one hole to another. Simply depress thumb lever towards wheel and move wheel and lever assembly to desired position. All wheels must be positioned in relative height of cut positions.

**THROTTLE** — If adjustment becomes necessary, the throttle control wire assembly can be reset as follows:

1. Loosen, but do not remove, screw securing throttle control wire assembly at engine.

2. Move throttle control lever on handle to "FAST" position.
3. Move lever, to which control wire is fastened at engine, to full open position and retighten screw to secure throttle control wire assembly.

## LUBRICATION

**IMPORTANT:** — Always stop engine and disconnect spark plug wire before cleaning, lubricating or doing any kind of work on lawn mower.

**WHEELS** — Wheel bearings are of lifetime Fortiflex. They require no lubrication.

**PROTECTIVE SHIELD** — The pivot points on the protective shield should be lubricated periodically with light oil to prevent any rust or binding.

**CHUTE DEFLECTOR** — The torsion spring and pivot point should be lubricated periodically with light oil to prevent any rust or binding. Deflector must work freely.

**THROTTLE** — Periodically lubricate throttle control lever and throttle wire assembly with a few drops of light oil (S.A.E. No. 10 or 20) for ease of operation.

**ENGINE** — Follow engine manual for lubrication instructions.

## MAINTENANCE

**CUTTING BLADE:** The blade may easily be removed for grinding or replacement as follows:

1. Remove bolt and lock washer holding blade and blade adapter to engine crankshaft.
2. Remove blade and blade adapter from engine crankshaft.
3. Remove two bolts, lock washers and nuts holding blade to the blade adapter (if necessary).

When sharpening blade, follow the original angle of grind as a guide. It is extremely important that each cutting edge receives an equal amount of grinding to prevent an unbalanced blade. An unbalanced blade will cause excessive vibration when rotating at high speeds and may cause damage to the mower.

Upon reassembly, make certain all parts are assembled properly and tightened securely.

**DECK** – The underside of mower deck should be cleaned after each period of use as grass clippings, leaves, dirt and other matter will accumulate. This accumulation of grass clippings, etc., is undesirable as it will invite rust and corrosion and may cause an uneven discharge of grass clippings at the next cutting.

The deck may be cleaned by tilting the mower forward or on its side and scraping clean with a suitable tool or by washing with a stream of water from a garden hose. **CAUTION:** Do not direct the stream of water at a hot engine as damage to the engine may result.

**STORAGE** – The following steps should be taken to prepare lawn mower for storage.

1. Clean and lubricate mower thoroughly as described in the preceding instructions.
2. Refer to engine manual for correct engine storage instructions.
3. Coat mower's cutting blade with chassis grease to prevent rusting.

4. Place blocks under deck to raise tires clear of floor.
5. Store mower in a dry, clean area.

## USING YOUR ROTARY MOWER

For the best results do not cut wet grass because it tends to stick to the underside of the mower, thus preventing proper discharge of grass clippings. If wet grass must be cut, reduce walking speed to help distribute the clippings more effectively.

New grass should be treated as wet grass, otherwise a normal walking speed is about the right pace for efficient mowing. The best mowing pattern is one that allows the clippings to discharge towards the uncut part of the lawn. This permits recutting of the clippings to further pulverize them. When cutting high weeds, discharge towards cut portion, then recut at right angles to first direction.

Lawn should be cut in the fall as long as there is growth.

GRASS CATCHER Model No. 193-003 is available as optional equipment for the mowers shown in this manual.

**WARNING:**

1. The mower should not be operated without the entire grass catcher or chute deflector in place.
2. The mower should not be operated without the protective shield on the rear of the deck in place.

**NOTE:**

Under normal usage bag material is subject to wear and should be checked periodically. Be sure any replacement bag complies with the mower manufacturer's recommendations.

For replacement bags, use only factory authorized replacement bag No. 764-119.

**★ IMPORTANT**

After striking a foreign object, stop the engine (motor), remove wire from spark plug. Thoroughly inspect the mower for any damage, and repair the damage before restarting and operating the mower.

**WARRANTY**

For one year from date of purchase, MTD Products Inc will replace for the original purchaser, free of charge, F.O.B. factory or authorized service firm, any part or parts found to be defective in material or workmanship. All transportation charges on parts submitted for replacement under this warranty must be paid by the purchaser. This warranty does not include replacement of parts which become inoperative through misuse, excessive use, accident, neglect, improper maintenance or alterations by unauthorized persons. This warranty does not include the engine, motor, battery, battery charger or any component parts thereof. For service on these units, refer to the applicable manufacturer's warranty.

The above warranty will apply only to the original owner and will be effective only if the warranty card has been properly processed. It will not apply where the unit has been used commercially.

Warranty service is available through your local authorized service dealer or distributor. **UNDER NO CIRCUMSTANCES WILL THE RETURN OF A COMPLETE UNIT BE ACCEPTED BY THE FACTORY UNLESS PRIOR WRITTEN PERMISSION HAS BEEN EXTENDED.**



# PARTS INFORMATION

**DEFECTIVE OR MISSING PARTS** must be reported to the factory immediately. Such claims must include your model number and date of purchase.

## **MOWER, TILLER, SNOW THROWER, TRACTOR, TRAIL BIKE AND MUD BUG PARTS**

Mower, tiller, snow thrower, tractor, trail bike and mud bug parts are available through the authorized service firms listed below. All orders should specify the model number of your unit, parts numbers, de-

scription of parts and the quantity of each part required.

## **BRIGGS & STRATTON, TECUMSEH AND PEERLESS PARTS AND SERVICE**

Briggs & Stratton, Tecumseh and Peerless parts and service should be handled by your nearest authorized engine service firm. Check the yellow pages of your telephone directory under the listing *Engines — Gasoline*, Briggs & Stratton or Tecumseh Lauson — Power Products.

**A 1 Engine & Mower Co.**  
327 East 9th Street  
Salt Lake City, Utah 84102

**American Electric Ignition Co.**  
124 N. W. 8th Street  
Oklahoma City, Oklahoma 73102

**Auto Electric & Carburetor Co.**  
2625 4th Avenue, S.  
P. O. Box 1948  
Birmingham, Alabama 35233

**Automotive Equipment Service Co.**  
3117 Holmes Street  
Kansas City, Missouri 64109

**Bailey's Rebuild Inc.**  
1325 E. Madison Street  
Seattle, Washington 98102

**Brown Equipment Distributor Inc.**  
110 Beech Street  
Corydon, Indiana 47112

**Bullard Supply**  
2409 Commerce Street  
Houston, Texas 77003

**Catto & Putty, Inc.**  
P. O. Box 2408  
510 Soledad Street  
San Antonio, Texas 78205

**Center Supply Company**  
6867 New Hampshire Avenue  
Takoma Park, Maryland 20012

**Charles B. Wright Co.**  
309 4th Avenue, South  
Nashville, Tennessee 37201

**W. B. Clements**  
400 Salem Avenue  
Roanoke, Virginia 24016

**Morton B. Collins Co.**  
300 Birnie Avenue  
Springfield, Massachusetts 01107

**Dixie Sales Company**  
P. O. Box 1408  
327 Battleground Avenue  
Greensboro, North Carolina 27402

**East Point Cycle & Key Shop**  
1617 Whiteway  
East Point, Georgia 30044

**Gamble Distributors**  
West End Avenue  
Carthage, New York 13619

**Garden Equipment Co., Inc.**  
6600 Cherry Avenue  
Long Beach, California 90805

**Henzler, Inc.**  
2015 Lemay Ferry Road  
St. Louis, Missouri 63125

**Frank E. Ives & Son**  
1101 Lincoln Avenue  
Prospect Park, Pennsylvania 19076

**J. W. Jewett Co.**  
981 Folsom Street  
San Francisco, California 94107

**Kenton Supply**  
8216 North Denver Avenue  
Portland, Oregon 97217

**Kimber's Inc.**  
115 W. Geddes St.  
Syracuse, New York 13204

**The Lawnmower Shop**  
1340 El Camino Real  
San Carlos, California 94070

**Marr Brothers**  
423 E. Jefferson  
Dallas, Texas 75203

**Mathews Auto Electric Co.**  
420 East 2nd Street  
Tulsa Oklahoma 74120

**McClure Lawn & Garden Supply**  
1114 Lexington Avenue  
Mansfield, Ohio 44907

**Memphis Cycle & Supply Co.**  
421 Monroe Avenue  
Memphis Tennessee 38103

**Moz-All of Florida, Inc.**  
365 Greco Avenue  
Coral Gables, Florida 33146

**National Central, Div. of  
Joe Sterling, Inc.**  
Drawer "D" 687 Seville Rd.  
Wadsworth, Ohio 44281

**Power Equipment Distributor**  
36463 So. Gratiot Avenue  
Mt. Clemons, Michigan 48043

**Parts & Sales Inc.**  
2101 Industrial Pkwy.  
Elkhart, Indiana 46514

**Parts & Sales Inc.**  
335 West St. Charles Road  
Villa Park, Illinois 60181

**Power Lawn & Garden Equip. Co.**  
2551-2571 J. F. Kennedy Road  
Dubuque, Iowa 52001

**Raub Supply Company,**  
James & Mulberry Sts.  
Lancaster, Pennsylvania 17604

**Radco Distributors**  
2403 Market Street  
P. O. Box 3216  
Jacksonville, Florida 32206

**Richmond Battery & Ignition**  
P. O. Box 25369 — 957 Myers St.  
Richmond, Virginia 23260

**Smith Hardware Company**  
515 N. George Street  
Goldsboro, North Carolina 27530

**South Denver Lawn Equip. Co.**  
527 West Evans  
Denver, Colorado 80223

**Suhren Engine**  
8330 Earhart Blvd.  
New Orleans, Louisiana 70118

**Sutton's Lawn Mower Shop**  
Route 4, Box 343  
North Little Rock, Arkansas 72117

**Warner Equipment**  
7520 Lyndale Avenue, So.  
Minneapolis, Minnesota 55423

## **WARRANTY PARTS AND SERVICE POLICY**

The purpose of warranty is to protect the customer from defects in material and workmanship, defects which are not detected at the time of manufacture.

Our aim is to build into our product quality and reliability. Considerable emphasis is placed on quality control in order to assure our customer of satisfactory product performance. To achieve this goal, it is necessary to gain the cooperation of all concerned, MTD, our sales force and our customers.

MTD's responsibility is to build a quality product and to back up that product. MTD must build this quality product at a competitive price. This cannot be achieved without production in quantity. Quantity production is mass production. In mass production it is always possible for undetected defects to be present when the product reaches the customer. Our warranty is extended to assure the customer that any such defects will be corrected.

Use and maintenance are the responsibility of the customer. MTD cannot assume responsibility for conditions over which it has no control. MTD's responsibility does not cover misuse, excessive use, accident neglect, improper maintenance or alterations by unauthorized persons. Satisfactory product performance can only result when a manufacturer provides and backs up a quality product and the customer follows through with proper use and proper maintenance of that product. When both the manufacturer and the customer recognizes and assumes his responsibility, satisfactory product performance and customer satisfaction are assured.