

PLEASE NOTE:

This equipment has been tested and found to comply with the limits for a Class B digital device, pursuant to Part 15 of the FCC Rules. These limits are designed to provide reasonable protection against harmful interference in a residential installation. This equipment generates, uses and a radiate radio frequency energy and, if not installed and used in accordance with the instructions may cause harmful interference to radio communications. However, there is no guarantee that interference will not occur in a particular installation. If this equipment does cause harmful interference to radio or television reception, which can be determined by turning the equipment off and on, the user is encouraged to try to correct the interference by one or more of the following measures:

- Reorient or relocate the receiving antenna.
- Increase the separation between the equipment and receiver.
- Connect the equipment into an outlet on a circuit different from that to which the receiver is needed.
- Consult the dealer or an experienced Radio/TV technician for help.

TROUBLE SHOOTING

Problems	Reasons	Solutions
Running Problems	The alkaline battery inside the radio control is too weak.	Replace with new alkaline batteries.
	There is a weak or low reception to the radio control.	
Operation Problems	A small object obstructs movement of the tire or axle.	Use tweezers or a paper clip to remove obstruction.
	The vehicle was driven on the carpet and has fabric thread caught in the axle.	Playing on the carpet is not recommended.
Other	The vehicle does not respond to the radio control.	Try playing at another location.
	The radio control's frequency is disrupted by something around the environment.	Some other equipment using the same radio wave could disrupt the radio control. Either play in another location or turn off the other equipment.



Manufactured & Distributed by  
© 2011, Cache Sales, LLC  
Logan, UT 84321 www.ignite-rc.com  
All rights Reserved MADE IN CHINA



INSTRUCTION MANUAL

**\*IMPORTANT:** IF VEHICLE DOES NOT RESPOND PROPERLY, PLEASE REPLACE BATTERIES IN VEHICLE (4 "AA" NOT INCLUDED) AND BATTERY IN CONTROLLER (1 9V NOT INCLUDED).

**\*\*NOTE: THE MANUFACTURER IS NOT RESPONSIBLE FOR ANY RADIO OR TV INTERFERENCE CAUSED BY UNAUTHORIZED MODIFICATIONS TO THIS EQUIPMENT. SUCH MODIFICATIONS COULD VOID THE USER'S AUTHORITY TO OPERATE THE EQUIPMENT.**

**WARNING:**  
Changes or modifications to this unit not expressly approved by the party responsible for compliance could void the user's authority to operate the equipment.

This device complies with Part 15 of the FCC Rules. Operation is subject to the following two conditions:  
1. This device may not cause harmful interference, and  
2. This device must accept any interference received, including interference that may cause undesired operation.

**FC** Tested To Comply  
With FCC Standards  
FOR HOME OR OFFICE USE

**WARNING:**  
CHOKING HAZARD-Small parts.  
Not for children under 3 years.

**PLEASE DO NOT RETURN TO STORE**  
For more information please  
email Consumer Services:  
help@cache-sales.net

COLORS AND DECORATIONS MAY VARY. KEEP CONTENT DETAILS FOR FUTURE REFERENCE.

CHECK LIST

To prevent damage, the contents of the package that are listed below have been packed in the tray and may be out of plain sight. Please remove all contents from the tray.



CONTROLLER

WRECK & RECOVER VEHICLE

DO NOT MIX ALKALINE, STANDARD (CARBON ZINC) OR RECHARGEABLE (NICKEL CADMIUM) BATTERIES.

DO NOT MIX OLD AND NEW BATTERIES.

DO NOT DISPOSE OF BATTERIES IN FIRE, BATTERIES MAY EXPLODE OR LEAK.

USES 4-AA BATTERIES IN VEHICLE (NOT INCLUDED) AND 1-9V BATTERY IN CONTROLLER (NOT INCLUDED)

START UP

Unscrew and remove the battery covers on both the controller and the RC. Insert 4 "AA" batteries (not included) into the RC CAR and 1 "9V" battery (not included) in the controller unit. Then replace the battery covers and tighten the screws (see diagram #1 and #2).

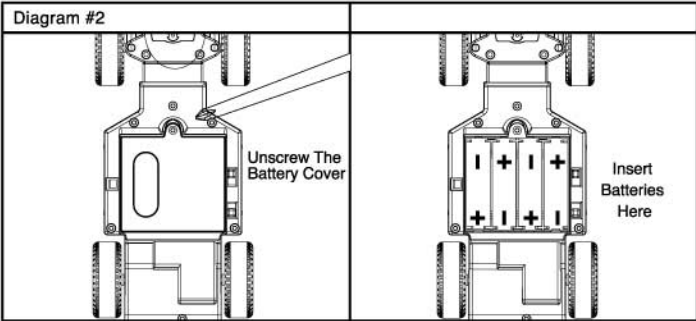
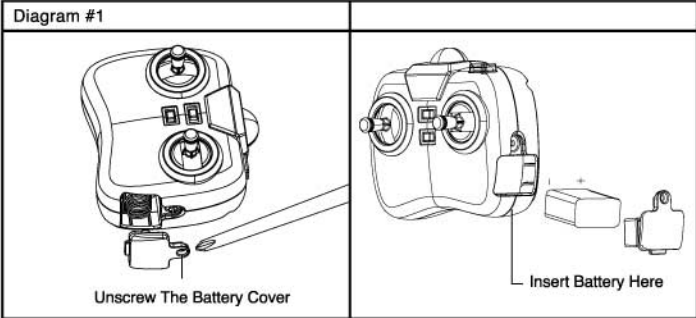

PLEASE NOTE:

- A) Make sure the batteries have been inserted correctly, (+ or -) into vehicle controller.
- B) If the vehicle does no respond properly, please replace the alkaline batteries in the vehicle and/or controller battery.

NOTE

- Do not mix old and new batteries.
- Do not mix alkaline, standard (carbon zinc), or rechargeable (nickel-cadmium) batteries
- Do not dispose of batteries in the fire, batteries may explode or leak.

OPERATING THE VEHICLE

1. Turn the power switch to "ON" on the vehicle (see diagram 3).
2. Turn the power switch to "ON" on the controller (see diagram 4).
3. Match the band A, B, or C for both controller and vehicle (see diagram 3 & 4).
4. Press the left and right levers to drive your car in all directions (see diagram).
5. Adjust the fine tune steering lever located under the car to keep it moving straight. (If vehicle begins to pull to the Left, adjust the control towards the Right. If vehicle begins to pull to the Right, adjust the control towards the Left).
6. Crash vehicle into any solid surface to see crash effects and hear crashing sound.
7. Press the "RECOVER" button (see diagram 5) to return the vehicle to its original state.
8. After use, turn "OFF" the car and the RC controller.
9. If the car is to be unused for a relatively long time, remove all batteries from the car and the RC controller.

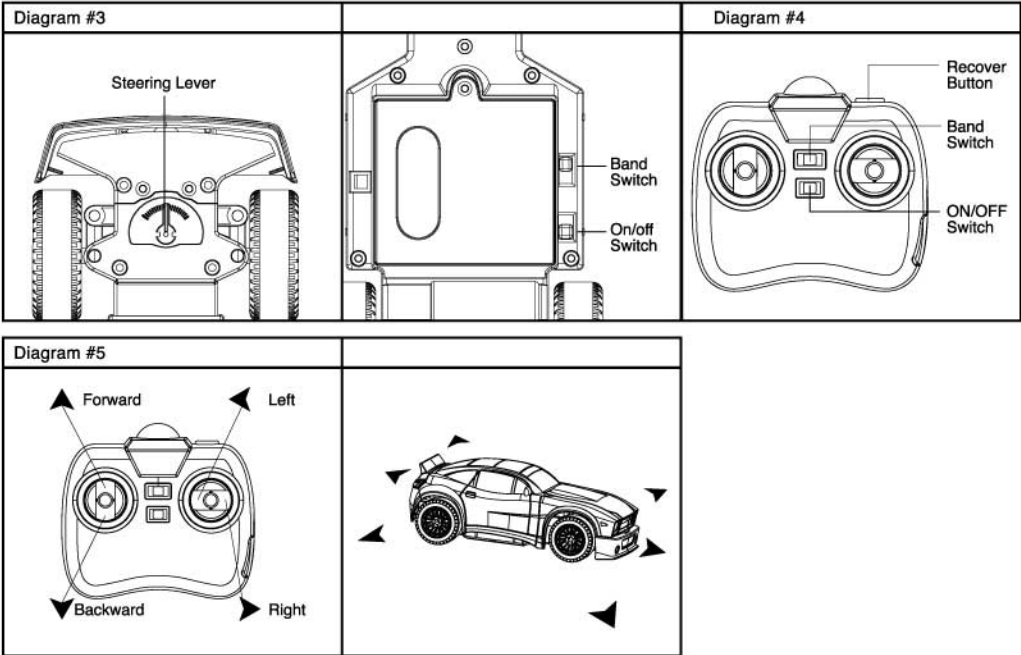

FCC NOTE:

THE ANTENNA PROVIDED IS A UNIQUE ANTENNA. BY INSTALLATION OF UNAUTHORIZED ANTENNA TO THIS EQUIPMENT, SUCH UNAUTHORIZED INSTALLATION COULD VOID THE USE'S AUTHORITY TO OPERATE THE EQUIPMENT.

THE MANUFACTURER IS NOT RESPONSIBLE FOR ANY RADIO OR TV INTERFERENCE CAUSE BY UNAUTHORIZED MODIFICATIONS TO THIS EQUIPMENT. SUCH MODIFICATIONS COULD VOID THE USER'S AUTHORITY TO OPERATE THE EQUIPMENT.