

## 5. Touchpad Reader Operation

### 5.1 Operation

To turn the Touchpad Reader **ON** press [#] for 5 seconds. The reader will perform a self test followed by series of beeps. LED blinks Green, Red, Blue.

### 5.2 Pairing Touchpad Reader

This procedure is done via the ENTR® lock. See also: Pairing Remote Control.

1

Touch **ENTR® lock** screen with palm or fingers for 3 seconds to active.

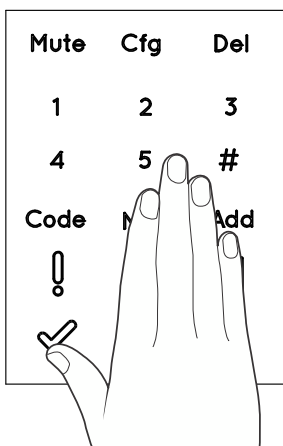

2

Press **[Add]**

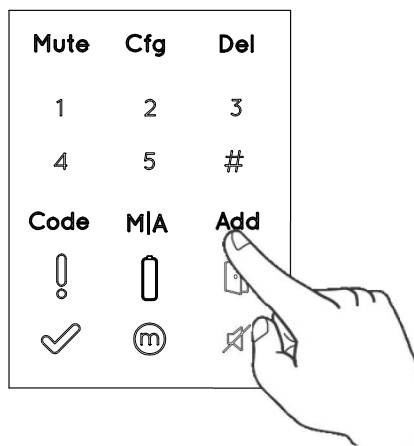

3

Numeric buttons illuminated.  
Type **[PIN code]** → **[#]**  
Numeric buttons blinking.

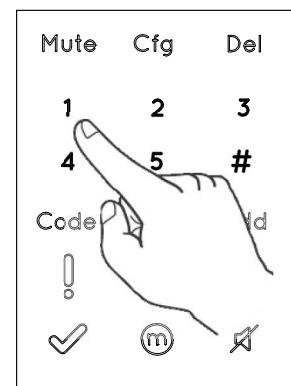

4

Press **[1]** to add Touchpad.  
Illuminated buttons turn off.  
**[OK]** indication blinks for 15 seconds waiting for the Touchpad.

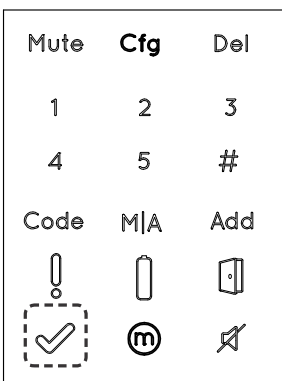





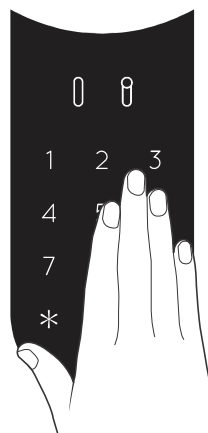

5

Touch the **Touchpad Reader** screen with palm or fingers.  
Press **[77]** → **[#]**  
Blue LED blinking rapidly.



### Pairing OK

[OK] indication blinks once,  
2 short beeps emitted.  
**Touchpad Reader added.**

Mute	Cfg	Del
1	2	3
4	5	#
Code	M/A	Add
		
		

### Pairing failed

[OK] indication blinks for 15 seconds,  
No beeps emitted.  
**In wall reader:** Green LED illuminated  
and 2 beeps emitted.  
**Start the process from stage 1.**

- Hang the Touchpad Reader on the base plate.
- Tighten fixing screw.

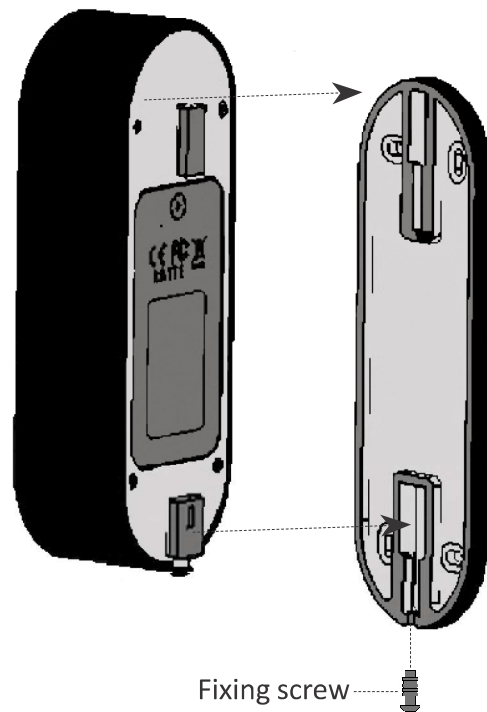

### 5.3 Touchpad Reader Master PIN Code

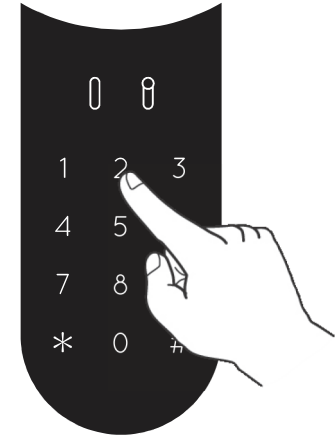
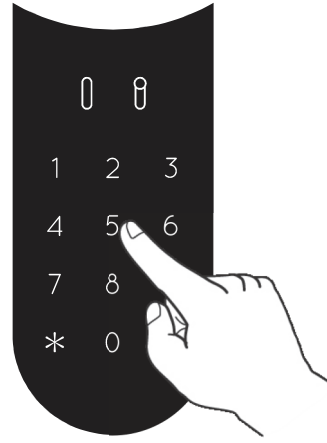
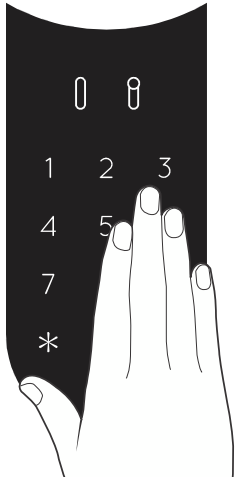

**Master PIN code added**

Green [OK] illuminated for 1 second.  
2 short beeps emitted.

**Master PIN code not added**

Red [Error] illuminated for 1 second.  
1 long beep emitted.

### 5.4 Menu Mode

Entering menu mode: Press [\*] then [Master PIN code] then [#]

### 5.5 Adding PIN Code (up to 20 different codes)

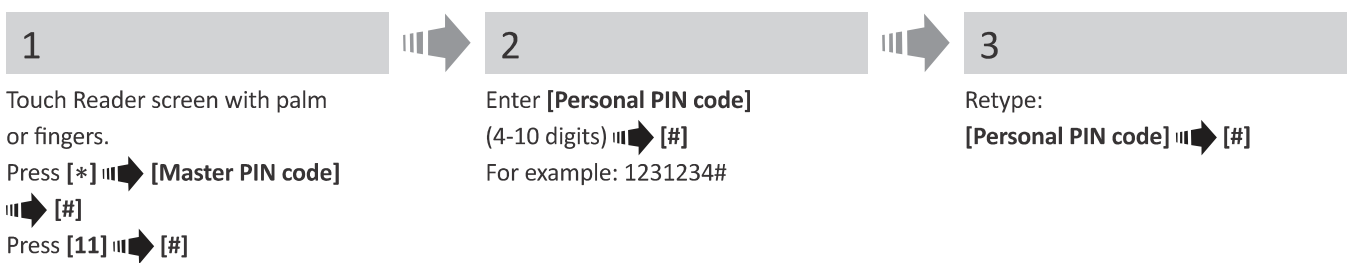

**PIN code added**

Green [OK] illuminated for 1 second,  
2 short beeps emitted

**PIN code not added**

Red [Error] illuminated for 1 second,  
1 long beep emitted.

## 5.6 Open Door

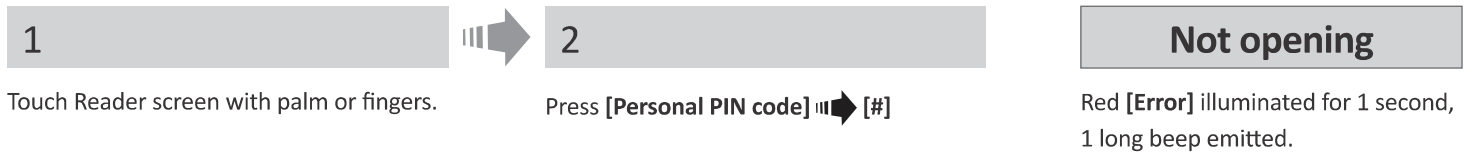

## 5.7 Lock Door



## 5.8 Delete PIN Code

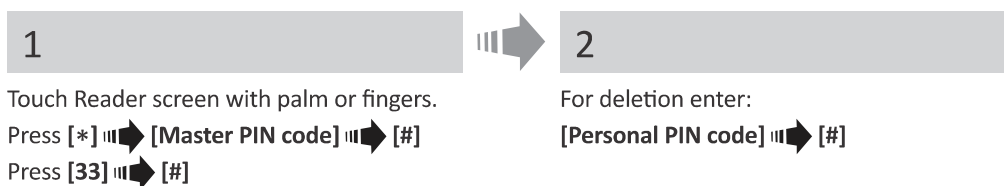

Personal code deleted

Green [OK] illuminated for 1 second,  
2 short beeps emitted.

Personal code not deleted

Red [Error] illuminated for 1 second,  
1 long beep emitted.

## 5.9 Delete all PIN Codes

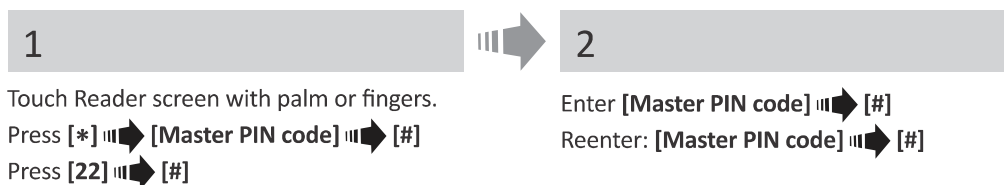

Personal PIN codes deleted

Green [OK] illuminated for 1 second,  
2 short beeps emitted.  
**Note:** Master PIN code can not be deleted.

Personal PIN codes not deleted

Red [Error] illuminated for 1 second,  
1 long beep emitted.

## 5.10 Volume Control

1

Touch Reader screen with palm or fingers.  
Press [\*] → [Master PIN Code] → [#]  
Press [55] → [#]



2

Press [2] to increase the volume, or [8] to decrease the volume.  
Press [#] to confirm volume level.

## 5.11 Factory Reset

The reset action will delete **all** PIN codes (master and personal) and will cut off the Touchpad Reader from the ENTR® lock.

1

Touch Reader screen with palm or fingers.  
Press [\*] → [Master PIN code] → [#]  
Press [99] → [#]



2

Enter [Master PIN code] → [#]

### Personal and master PIN codes deleted

Green [OK] illuminated for 1 second.  
2 short beeps emitted.  
Device performing self test & is factory reset.

### Personal and master PIN codes not deleted

Red [Error] illuminated for 1 second.  
1 long beep emitted.

## 6. Fingerprint Reader

### 6.1 Mounting the Fingerprint Reader

Prior to starting, select the location where the Fingerprint Reader is to be mounted. Avoid direct sun light to the front panel.

- Attach the Fingerprint Reader base plate to the wall.
- Use 4 screws and screw anchors or double sided glued tape.

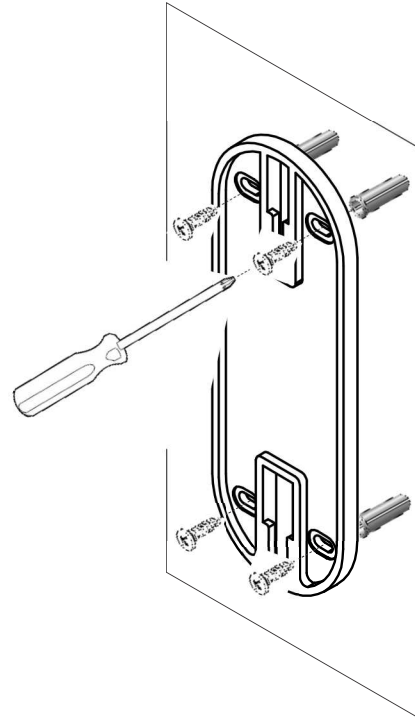

### 6.2 Battery Replacement

1. Using a 2mm Allen key release the lid screw and open the lid.
2. Insert batteries (2xAA) according to the "+" "-" signs. Green LED will illuminate for 2 seconds.
3. Close the lid and tighten the screw.
4. Press [#] for 5 seconds.



The reader will self calibrate, which will be followed by a series of beeps and blinking LEDs.

### 6.3 Adjust Date & Time

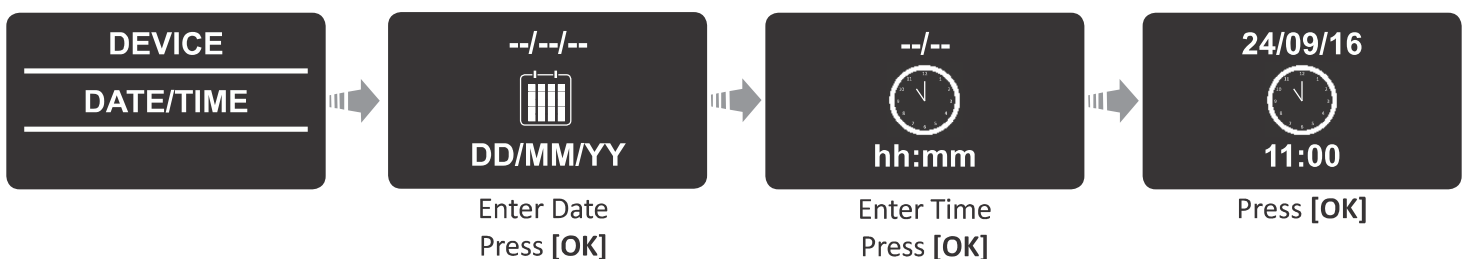

## 6.4 Pairing Fingerprint Reader

This procedure is done via the ENTR® lock.

See also: Pairing Touchpad Reader.

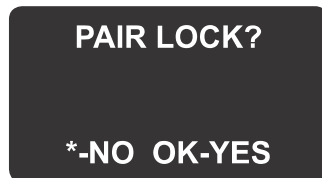
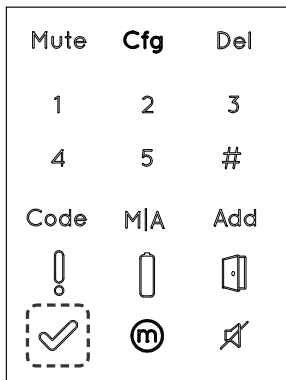
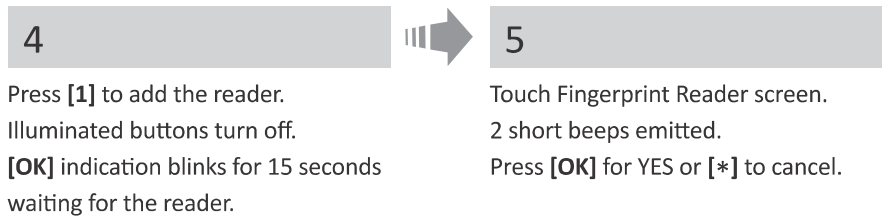
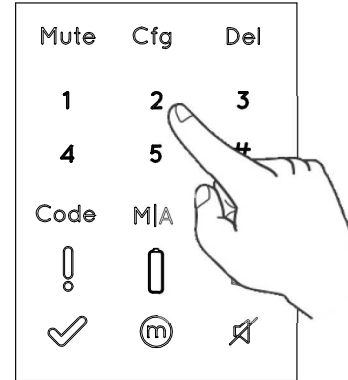
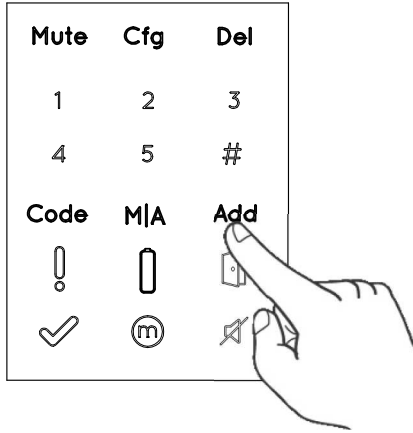
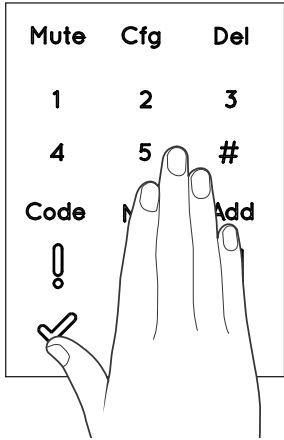
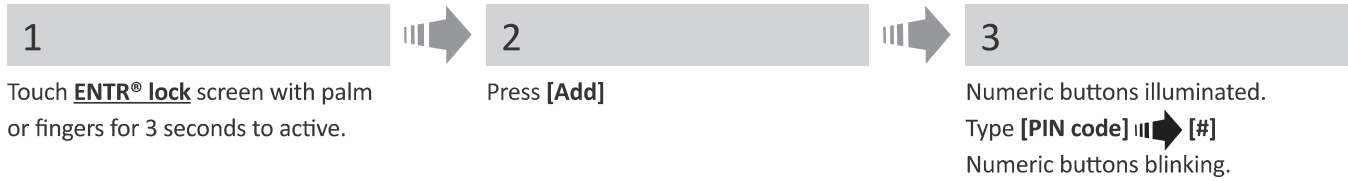

### Pairing OK

**[OK]** indication blinks once.  
2 short beeps emitted.  
Fingerprint Reader added.



### Pairing failed

1 long beep emitted.  
Red LED illuminated for 2 seconds.

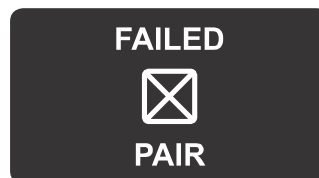

**Note:** At the end of the initial pairing process, a short notice will be displayed.

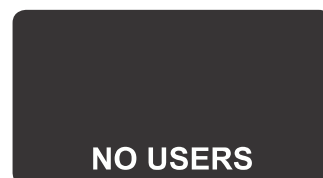

### 6.4.1 Add Master User

Setting a Master User requires both fingerprint and PIN code. It is possible to have up to two Master Users.

**Note:** At any stage you can press and hold the [\*] key to move to standby mode.

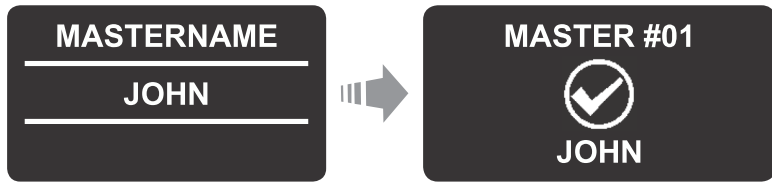

Type in [Master name] [OK]

### 6.4.2 Set Finger

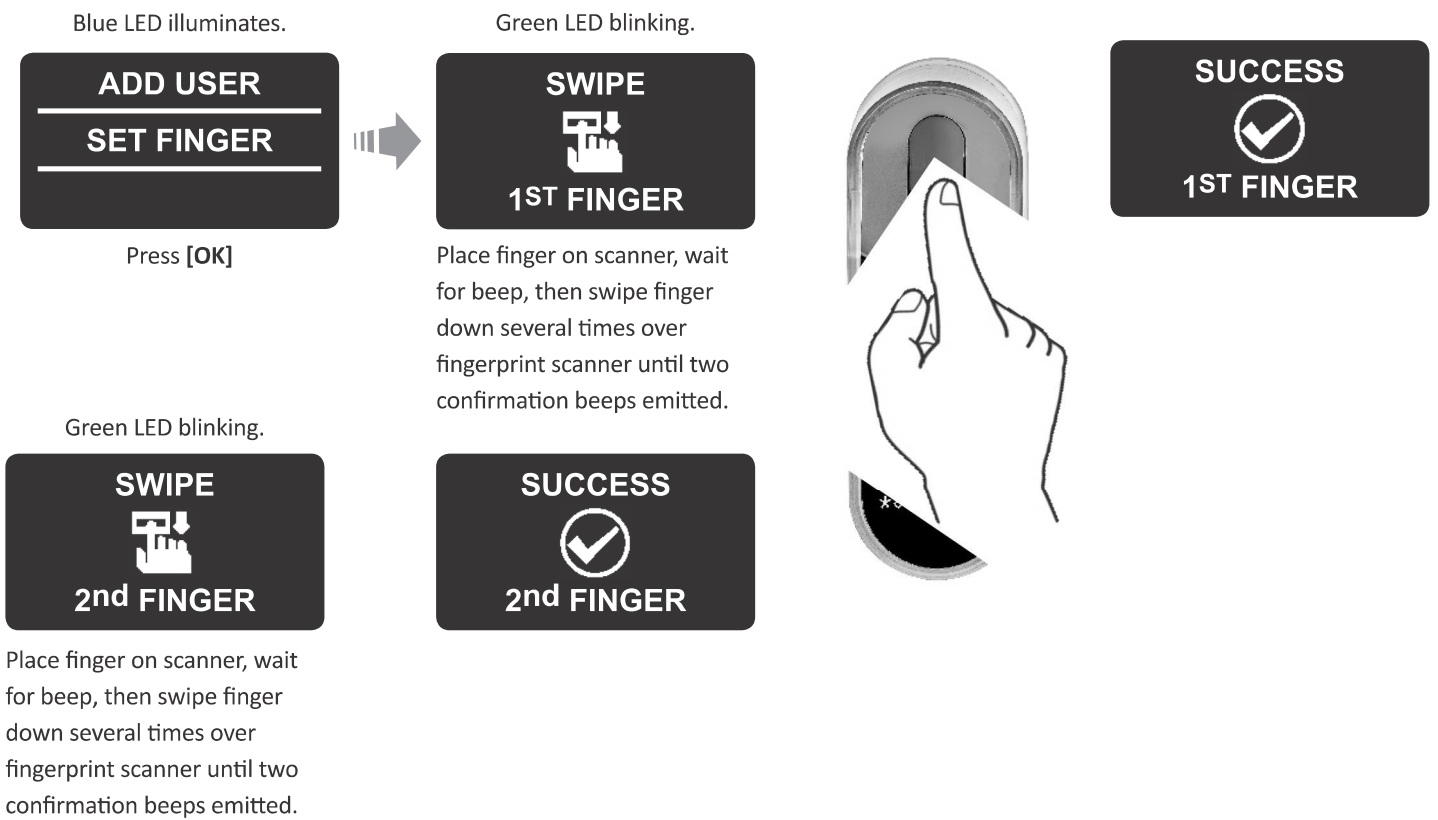

### 6.4.3 Set PIN Code

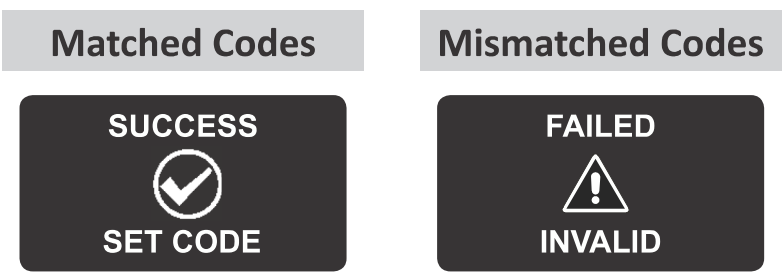
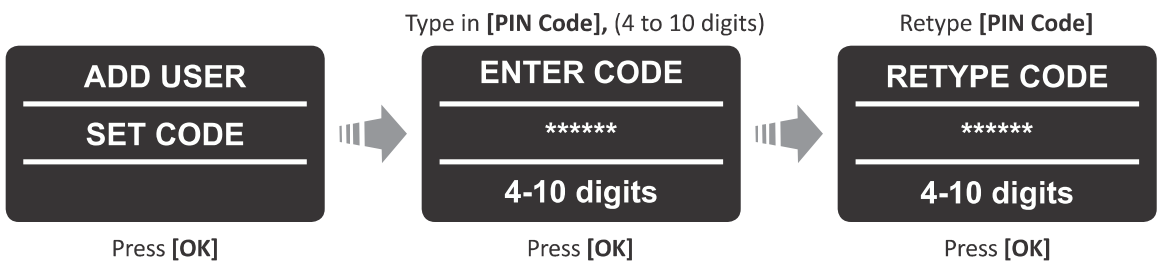



- Hang the reader on the base plate.
- Tighten fixing screw.



## 6.5 Unlock the Door

### OPTION 1:

Place finger on fingerprint scanner.  
 Short beep emitted & white LED is on.  
 Swipe finger over fingerprint scanner  
**Fingerprint authorized:** Blue LED blinking and unlock command is sent.  
**Fingerprint not authorized:** Red LED is ON.  
 The device goes to standby.

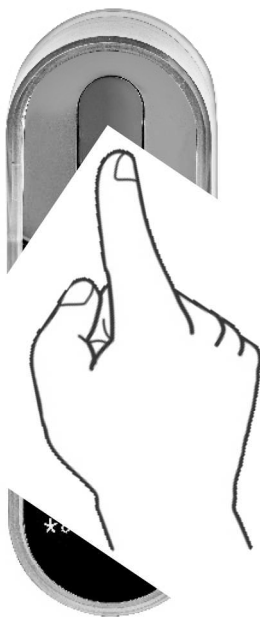

### OPTION 2:

Touch the Fingerprint Touchpad.  
 Screen shows user code.  
 Enter your code  **[OK]**

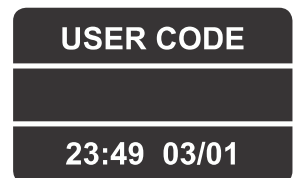

**Note:** In case ENTR® lock hasn't succeed to unlock the door, unlock failed message appear on the screen.



## 6.6 Lock the Door

Touch the Fingerprint Touchpad.

Press [1] → [#]

## 6.7 Low Battery Indication

Warning signal blinking.

### Fingerprint Reader low battery indication

Red LED illuminate for 1s after wake-up,  
2 long beeps emitted.

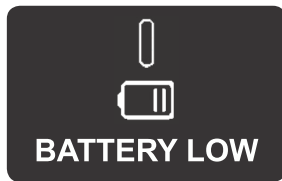

## 6.8 Setting Menu

Touch screen →

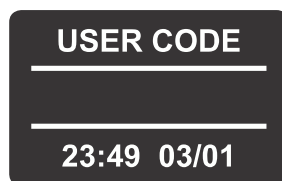

Press [\*]

→

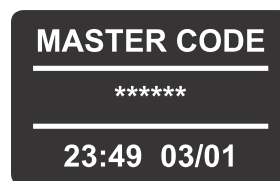

Enter [Master PIN code] → [OK] or  
swipe finger over fingerprint scanner

→

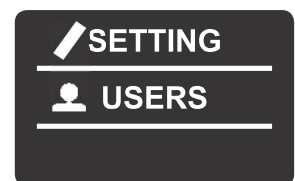

## 6.9 Add User

The unit allows adding up to 20 users. For each user two different fingerprints and one PIN code. Use different user name for each user.

<b>1</b>	<b>2</b>	<b>3</b>	<b>4</b>	<b>User name added</b>
Press [OK]	Press [OK]	Choose [OK] to add 2nd Master User or [*] to add a user. <b>Note:</b> This screen will not appear if two Master Users are defined.	User name added.	Type [USER NAME] [OK]
<b>User name exist</b>	<b>5</b>	<b>6</b>	<b>1st finger added</b>	<b>7</b>
Same user name. Choose different user name.	Press [OK] to set a finger or use [8▼] or [2▲] in order to set a code only.	Swipe 1st finger several times over fingerprint scanner until two confirmation beeps emitted.		Swipe 2nd finger several times over fingerprint scanner until two confirmation beeps emitted.
<b>2nd finger added</b>	<b>8</b>	<b>9</b>	<b>10</b>	
	Press [OK] for YES or [*] for NO.	Type [CODE] [OK]	Retype [CODE] [OK]	

<b>Matched codes</b>	<b>Mismatched codes</b>

Process did not complete. All data typed in will be erased from memory.

## 6.10 Delete User

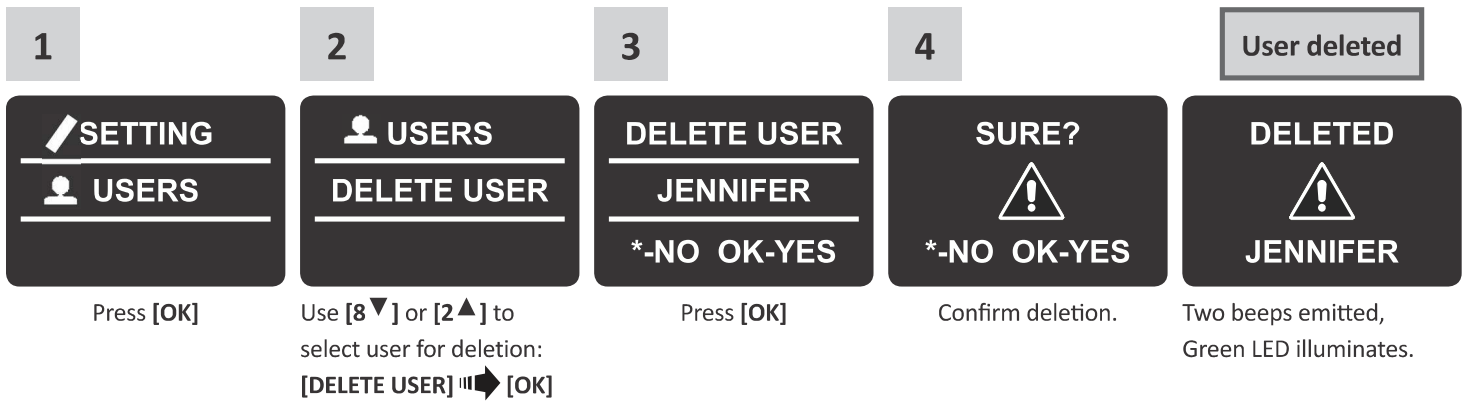
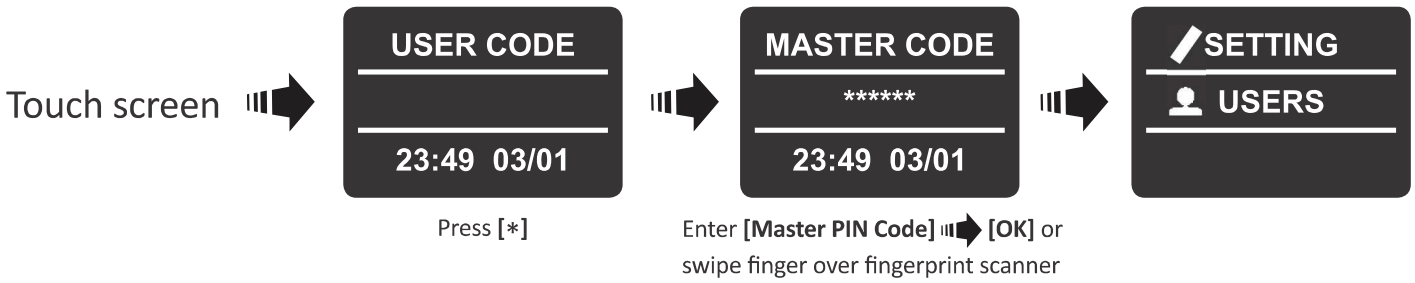

**Note:** The first Master User can't be deleted without doing a factory reset.

## 6.11 Enable/Disable User

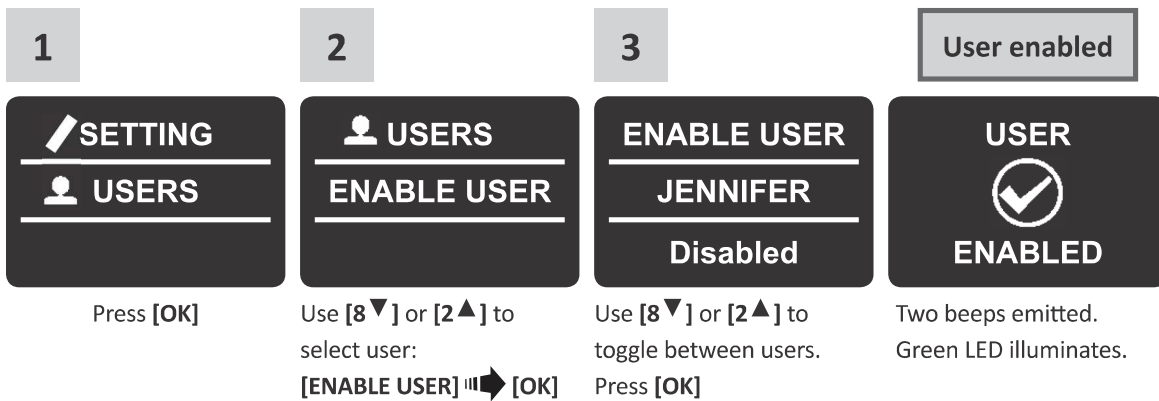
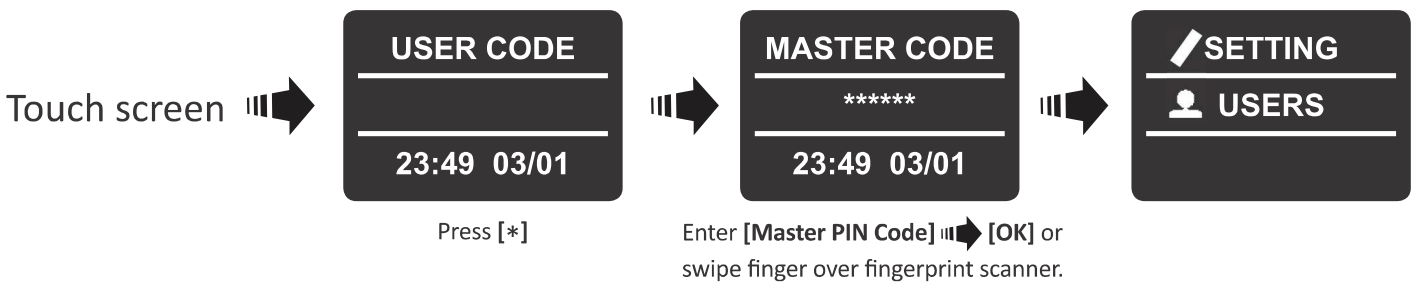

**Note:** Repeat this procedure to disable a user.

## 6.12 Delete All Users

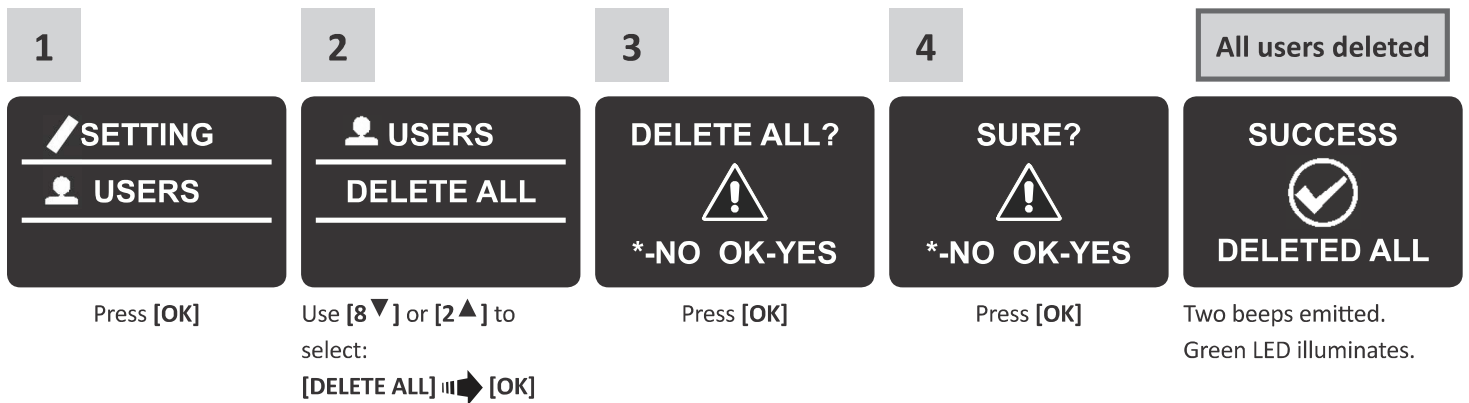
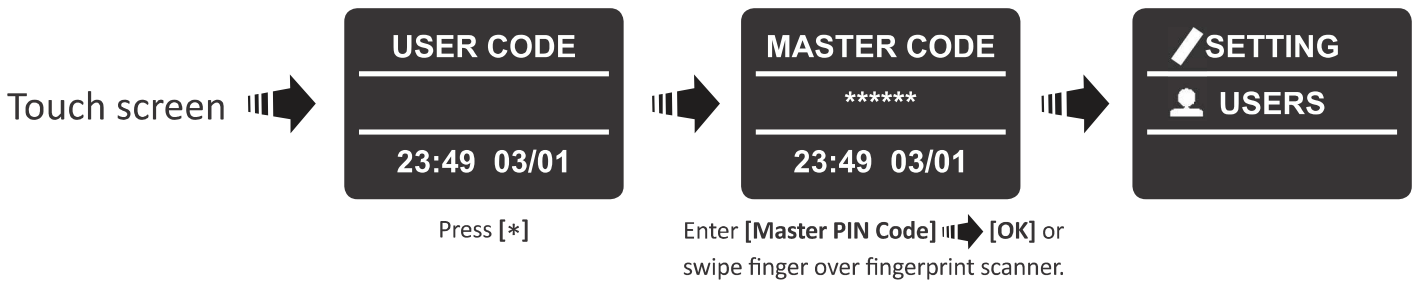

## 6.13 Add Time Schedule

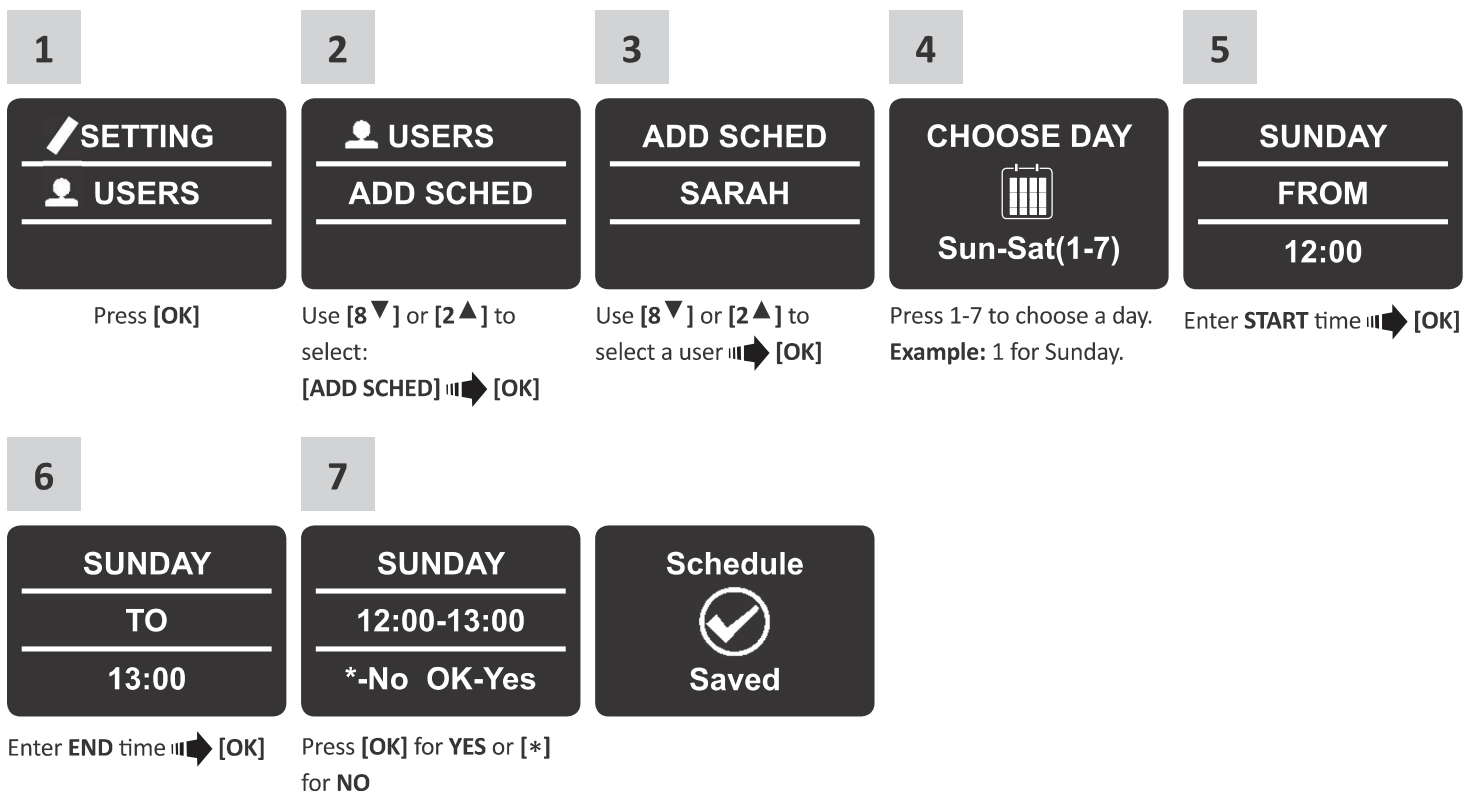

### Notes:

1. Define up to 7 different time schedules for the same user.
2. Press [\*] to go back on every menu.
3. Press [\*] for 3 seconds to exit setting menu.

## 6.14 Edit Time Schedule

<div style="background-color: #ccc; padding: 2px; width: 30px; margin: 0 auto;">1</div> <div style="background-color: #333; color: white; padding: 10px; text-align: center; margin: 5px;"> <b>SETTING</b>  <hr/> <b>USERS</b> </div> <p>Press [OK]</p>	<div style="background-color: #ccc; padding: 2px; width: 30px; margin: 0 auto;">2</div> <div style="background-color: #333; color: white; padding: 10px; text-align: center; margin: 5px;"> <b>USERS</b>  <hr/> <b>EDIT SCHED</b> </div> <p>Use [8 ▼] or [2 ▲] to select: [EDIT SCHED] → [OK]</p>	<div style="background-color: #ccc; padding: 2px; width: 30px; margin: 0 auto;">3</div> <div style="background-color: #333; color: white; padding: 10px; text-align: center; margin: 5px;"> <b>EDIT SCHED</b>  <hr/> <b>SARAH</b> </div> <p>Use [8 ▼] or [2 ▲] to toggle between users → [OK]</p>	<div style="background-color: #ccc; padding: 2px; width: 30px; margin: 0 auto;">4</div> <div style="background-color: #333; color: white; padding: 10px; text-align: center; margin: 5px;"> <b>SUNDAY</b>  <hr/> <b>12:00-13:00</b>  <hr/> *-Back OK-Yes </div> <p>Use [8 ▼] or [2 ▲] to choose the desired schedule to be edited. Pressing on [4 ◀] for 3 seconds shall delete the specific schedule.</p>	<div style="background-color: #ccc; padding: 2px; width: 30px; margin: 0 auto;">5</div> <div style="background-color: #333; color: white; padding: 10px; text-align: center; margin: 5px;"> <b>FRIDAY</b>  <hr/> <b>12:00-13:00</b>  <hr/> ▼ DAY ▲ </div> <p>Use [8 ▼] or [2 ▲] to change schedule day → [OK]</p>
<div style="background-color: #ccc; padding: 2px; width: 30px; margin: 0 auto;">6</div> <div style="background-color: #333; color: white; padding: 10px; text-align: center; margin: 5px;"> <b>FRIDAY</b>  <hr/> <b>11:00-13:00</b>  <hr/> --:mm-HH:MM </div> <p>Use [8 ▼] or [2 ▲] to change the <b>START</b> hour setting. Use [6 ▶] to move to <b>START</b> minutes.</p>	<div style="background-color: #ccc; padding: 2px; width: 30px; margin: 0 auto;">7</div> <div style="background-color: #333; color: white; padding: 10px; text-align: center; margin: 5px;"> <b>FRIDAY</b>  <hr/> <b>12:15-13:00</b>  <hr/> HH:--HH:mm </div> <p>Use [8 ▼] or [2 ▲] to change <b>START</b> minutes setting. Use [6 ▶] to move to the <b>END</b> hour.</p>	<div style="background-color: #ccc; padding: 2px; width: 30px; margin: 0 auto;">8</div> <div style="background-color: #333; color: white; padding: 10px; text-align: center; margin: 5px;"> <b>FRIDAY</b>  <hr/> <b>12:15-17:00</b>  <hr/> HH:mm--:mm </div> <p>Use [8 ▼] or [2 ▲] to change <b>END</b> hour setting. Use [6 ▶] to move to the <b>END</b> minutes.</p>	<div style="background-color: #ccc; padding: 2px; width: 30px; margin: 0 auto;">9</div> <div style="background-color: #333; color: white; padding: 10px; text-align: center; margin: 5px;"> <b>FRIDAY</b>  <hr/> <b>12:15-17:45</b>  <hr/> HH:mm-HH:-- </div> <p>Use [8 ▼] or [2 ▲] to change <b>END</b> minutes setting.</p>	<div style="background-color: #ccc; padding: 2px; width: 30px; margin: 0 auto;">10</div> <div style="background-color: #333; color: white; padding: 10px; text-align: center; margin: 5px;"> <b>FRIDAY</b>  <hr/> <b>12:15-17:45</b>  <hr/> *-NO OK-Yes </div> <p>Press [OK] for YES or [*] for NO.</p>

## 6.15 Volume Control

Touch screen →

**USER CODE**  

---

23:49 03/01

**MASTER CODE**  

---

\*\*\*\*\*  

---

23:49 03/01

**SETTING**  

---

**USERS**

Press [\*]      Enter [Master PIN Code] → [OK] or swipe finger over fingerprint scanner.

<div style="background-color: #ccc; padding: 2px; width: 30px; margin: 0 auto;">1</div> <div style="background-color: #333; color: white; padding: 10px; text-align: center; margin: 5px;"> <b>SETTING</b>  <hr/> <b>DEVICE</b> </div> <p>Use [8 ▼] or [2 ▲] to select: [DEVICE] → [OK]</p>	<div style="background-color: #ccc; padding: 2px; width: 30px; margin: 0 auto;">2</div> <div style="background-color: #333; color: white; padding: 10px; text-align: center; margin: 5px;"> <b>DEVICE</b>  <hr/> <b>VOLUME</b> </div> <p>Use [8 ▼] or [2 ▲] to select: [VOLUME] → [OK]</p>	<div style="background-color: #ccc; padding: 2px; width: 30px; margin: 0 auto;">3</div> <div style="background-color: #333; color: white; padding: 10px; text-align: center; margin: 5px;"> <b>VOLUME</b>  <hr/> <b>HIGH</b> </div> <p>Use [8 ▼] or [2 ▲] to toggle between HIGH, MEDIUM or LOW.</p>	<div style="background-color: #ccc; padding: 2px; width: 30px; margin: 0 auto;">4</div> <div style="background-color: #333; color: white; padding: 10px; text-align: center; margin: 5px;"> <b>VOLUME</b>  <hr/> <b>LOW</b> </div> <p>Press [OK]</p>	<div style="background-color: #333; color: white; padding: 10px; text-align: center; margin: 5px;"> <b>SUCCESS</b>  <hr/> <b>SET VOLUME</b> </div> <p>Two beeps emitted. Green LED illuminates.</p>
---	--	--	--	---

## 6.16 Double Security

After activating the double security option use both methods - swiping a fingerprint and inserting a PIN code to unlock the door.

**Note:** User set up with only one of the settings (fingerprint or PIN code) will not be able to unlock the door.

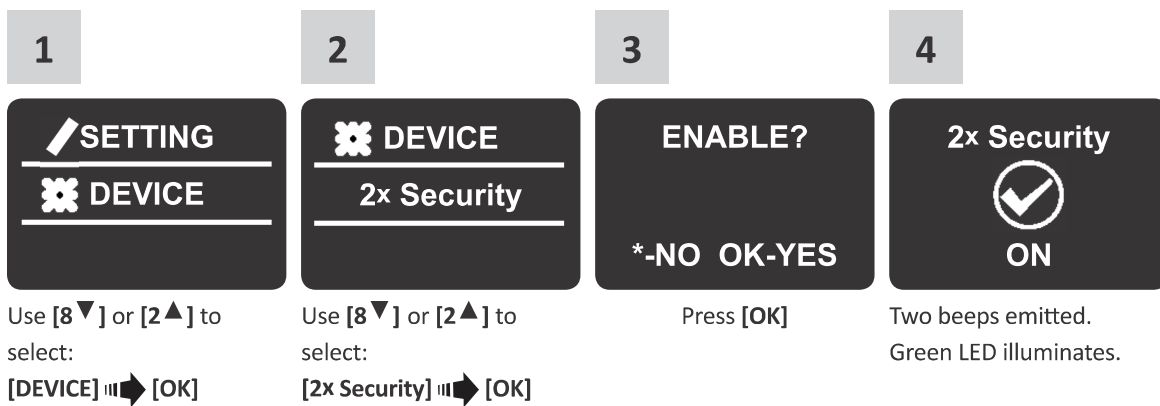
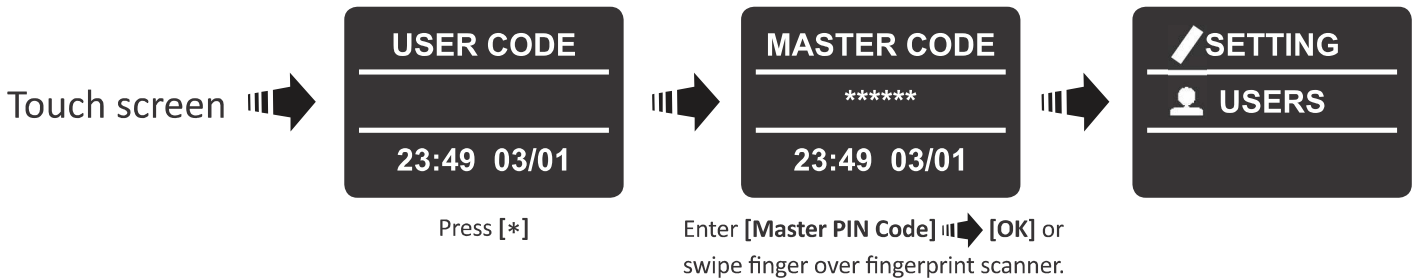

## 6.17 Factory Reset

**Warning:** A factory reset action will delete all information stored in the memory, including users and paired locks.

