

5. Touchpad Reader Operation

5.1 Operation

To turn the Touchpad Reader **ON** press [#] for 5 seconds. The reader will perform a self test followed by series of beeps. LED blinks Green, Red, Blue.

5.2 Pairing Touchpad Reader

This procedure is done via the ENTR® lock. See also: Pairing Remote Control.

1

Touch **ENTR® lock** screen with palm or fingers for 3 seconds to active.

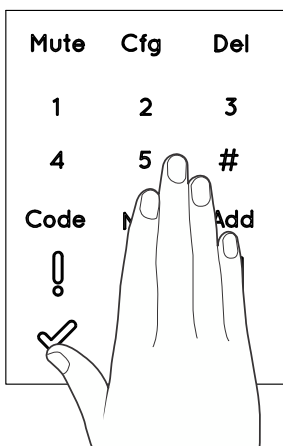

2

Press **[Add]**

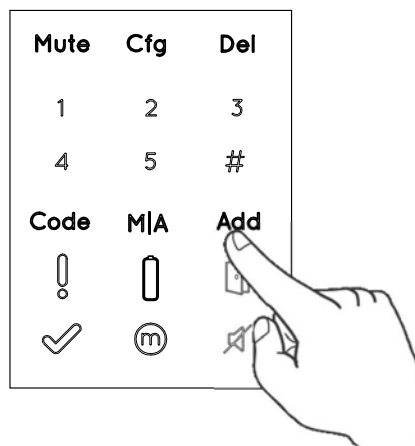

3

Numeric buttons illuminated.
Type **[PIN code]** → **[#]**
Numeric buttons blinking.

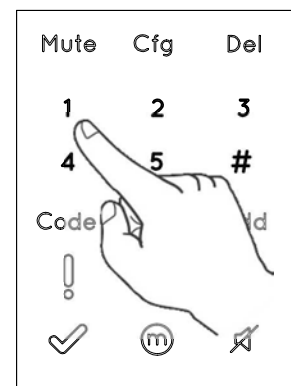

4

Press **[1]** to add Touchpad.
Illuminated buttons turn off.
[OK] indication blinks for 15 seconds waiting for the Touchpad.

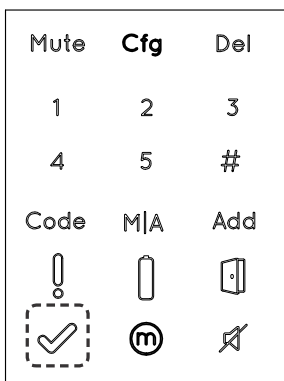





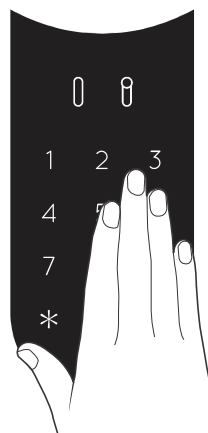

5

Touch the **Touchpad Reader** screen with palm or fingers.
Press **[77]** → **[#]**
Blue LED blinking rapidly.



Pairing OK

[OK] indication blinks once,
2 short beeps emitted.
Touchpad Reader added.

Mute	Cfg	Del
1	2	3
4	5	#
Code	M/A	Add
		
		

Pairing failed

[OK] indication blinks for 15 seconds,
No beeps emitted.
In wall reader: Green LED illuminated
and 2 beeps emitted.
Start the process from stage 1.

- Hang the Touchpad Reader on the base plate.
- Tighten fixing screw.

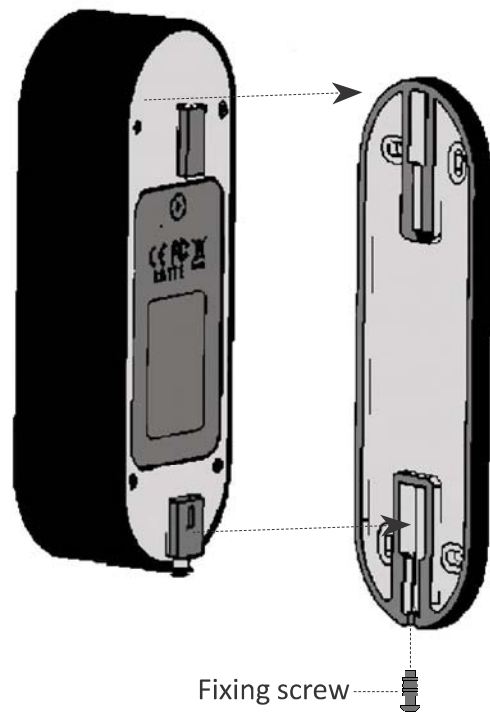

5.3 Touchpad Reader Master PIN Code

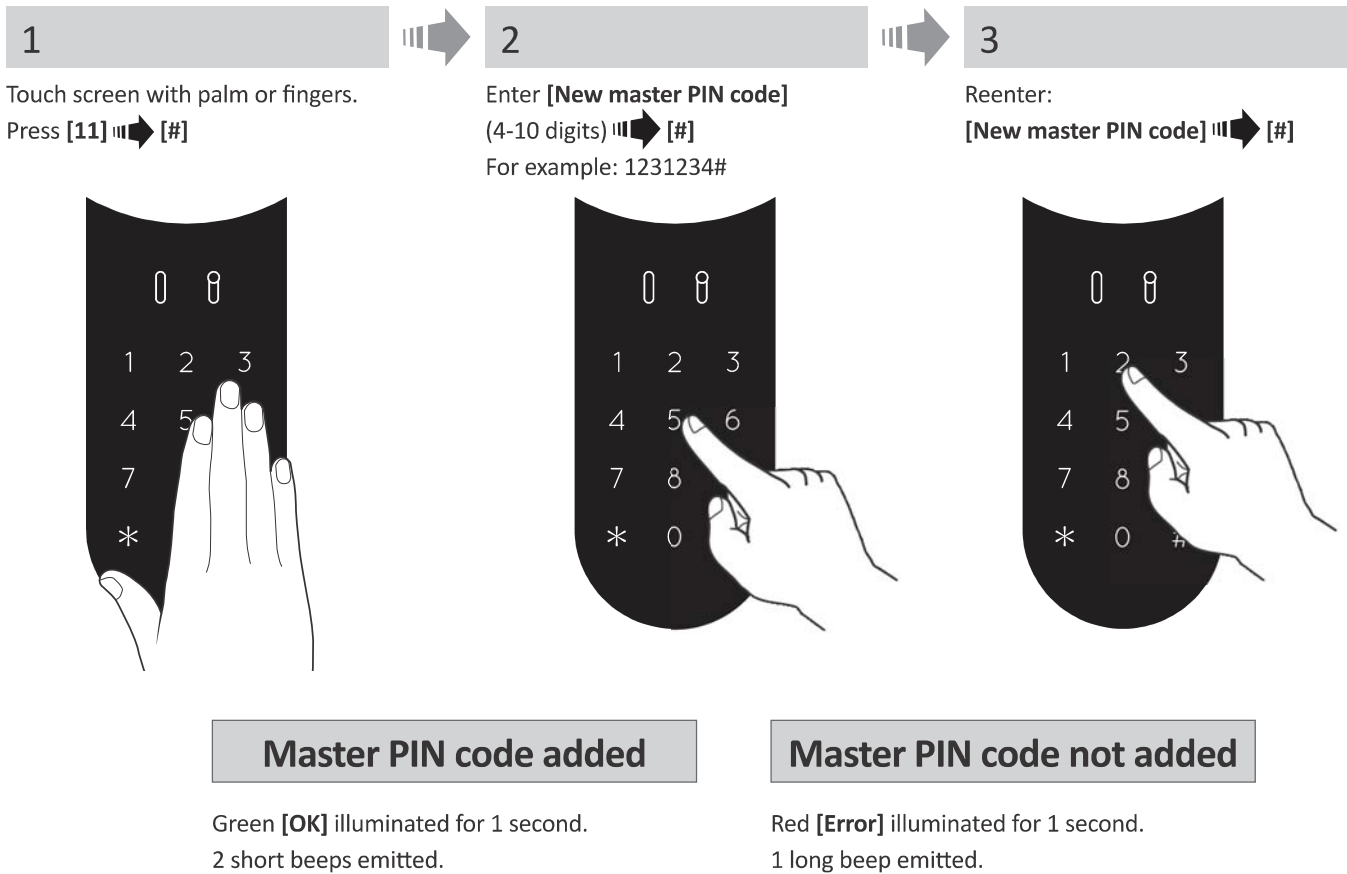

5.4 Menu Mode

Entering menu mode: Press [*] → [Master PIN code] → [#]

5.5 Adding PIN Code (up to 20 different codes)

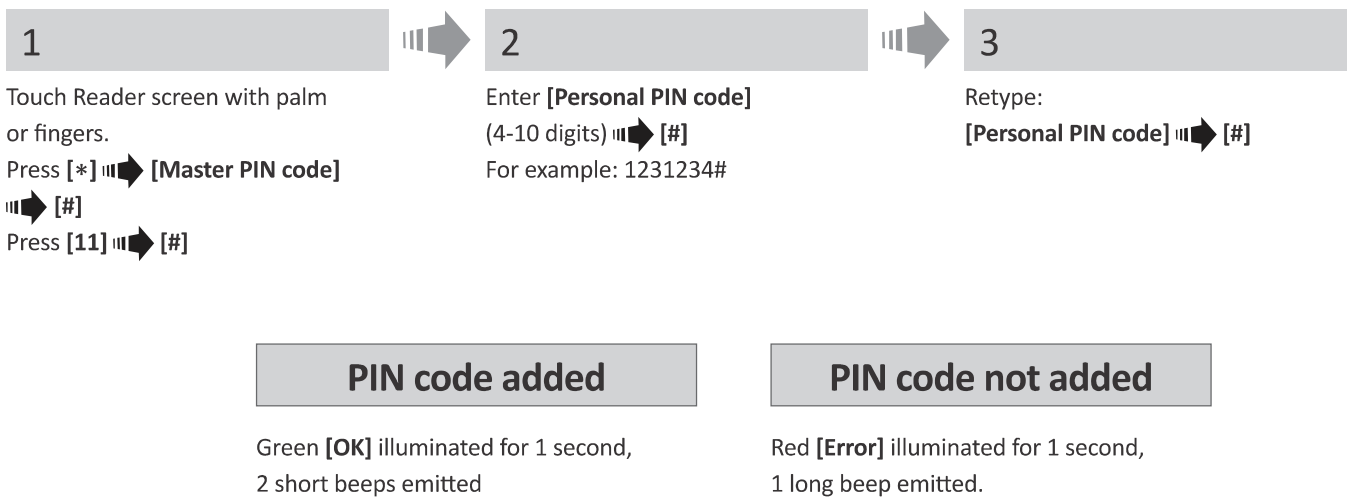

5.6 Open Door

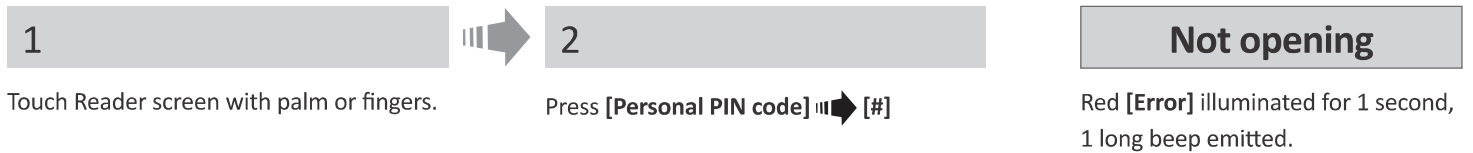

5.7 Lock Door



5.8 Delete PIN Code

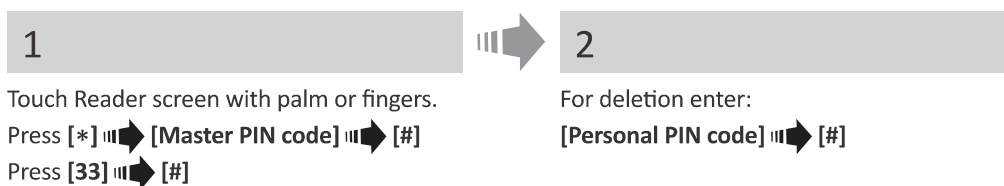

Personal code deleted

Green [OK] illuminated for 1 second,
2 short beeps emitted.

Personal code not deleted

Red [Error] illuminated for 1 second,
1 long beep emitted.

5.9 Delete all PIN Codes

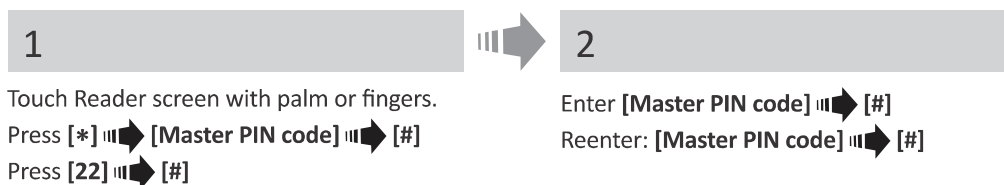

Personal PIN codes deleted

Green [OK] illuminated for 1 second,
2 short beeps emitted.
Note: Master PIN code can not be deleted.

Personal PIN codes not deleted

Red [Error] illuminated for 1 second,
1 long beep emitted.

5.10 Volume Control

1

Touch Reader screen with palm or fingers.
Press [*] → [Master PIN Code] → [#]
Press [55] → [#]



2

Press [2] to increase the volume, or [8] to decrease the volume.
Press [#] to confirm volume level.

5.11 Factory Reset

The reset action will delete **all** PIN codes (master and personal) and will cut off the Touchpad Reader from the ENTR® lock.

1

Touch Reader screen with palm or fingers.
Press [*] → [Master PIN code] → [#]
Press [99] → [#]



2

Enter [Master PIN code] → [#]

Personal and master PIN codes deleted

Green [OK] illuminated for 1 second.
2 short beeps emitted.
Device performing self test & is factory reset.

Personal and master PIN codes not deleted

Red [Error] illuminated for 1 second.
1 long beep emitted.

6. Fingerprint Reader

6.1 Mounting the Fingerprint Reader

Prior to starting, select the location where the Fingerprint Reader is to be mounted. Avoid direct sun light to the front panel.

- Attach the Fingerprint Reader base plate to the wall.
- Use 4 screws and screw anchors or double sided glued tape.

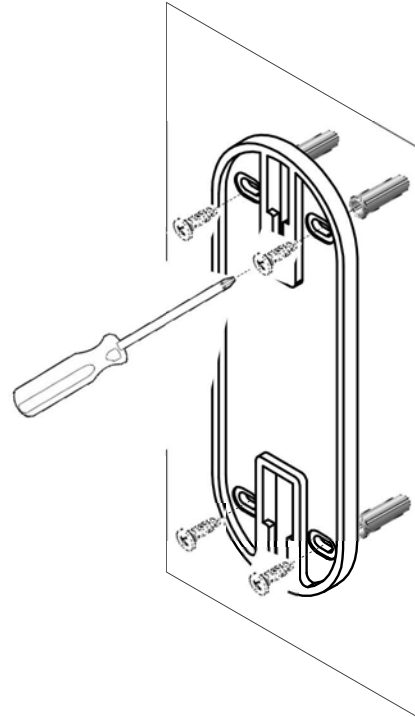

6.2 Battery Replacement

1. Using a 2mm Allen key release the lid screw and open the lid.
2. Insert batteries (2xAA) according to the "+" "-" signs. Green LED will illuminate for 2 seconds.
3. Close the lid and tighten the screw.
4. Press [#] for 5 seconds.



The reader will self calibrate, which will be followed by a series of beeps and blinking LEDs.

6.3 Adjust Date & Time

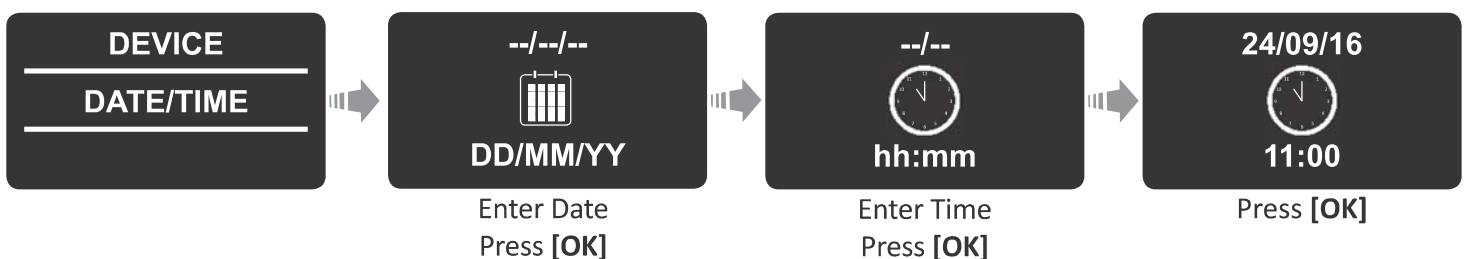

6.4 Pairing Fingerprint Reader

This procedure is done via the ENTR® lock.

See also: Pairing Touchpad Reader.

1

Touch **ENTR® lock** screen with palm or fingers for 3 seconds to active.

2

Press **[Add]**

3

Numeric buttons illuminated. Type **[PIN code]** **[#]**
Numeric buttons blinking.

4

Press **[1]** to add the reader.
Illuminated buttons turn off.
[OK] indication blinks for 15 seconds waiting for the reader.

5

Touch Fingerprint Reader screen.
2 short beeps emitted.
Press **[OK]** for YES or **[*]** to cancel.

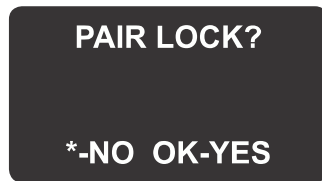
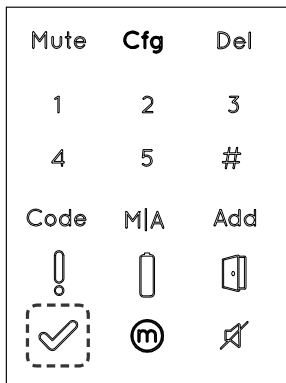

Pairing OK

[OK] indication blinks once.
2 short beeps emitted.
Fingerprint Reader added.



Pairing failed

1 long beep emitted.
Red LED illuminated for 2 seconds.

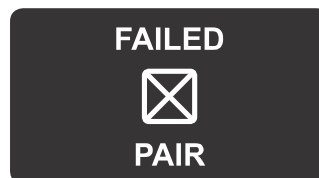

Note: At the end of the initial pairing process, a short notice will be displayed.

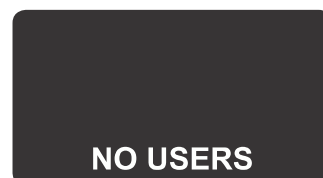

6.4.1 Add Master User

Setting a Master User requires both fingerprint and PIN code. It is possible to have up to two Master Users.

Note: At any stage you can press and hold the [*] key to move to standby mode.

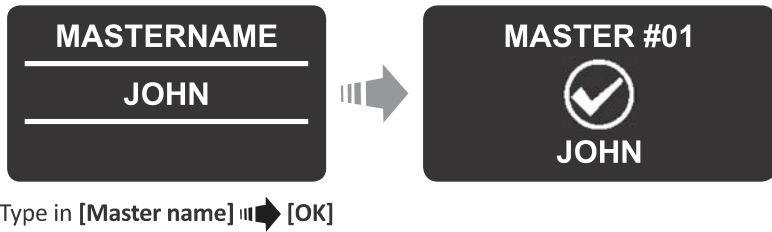

6.4.2 Set Finger

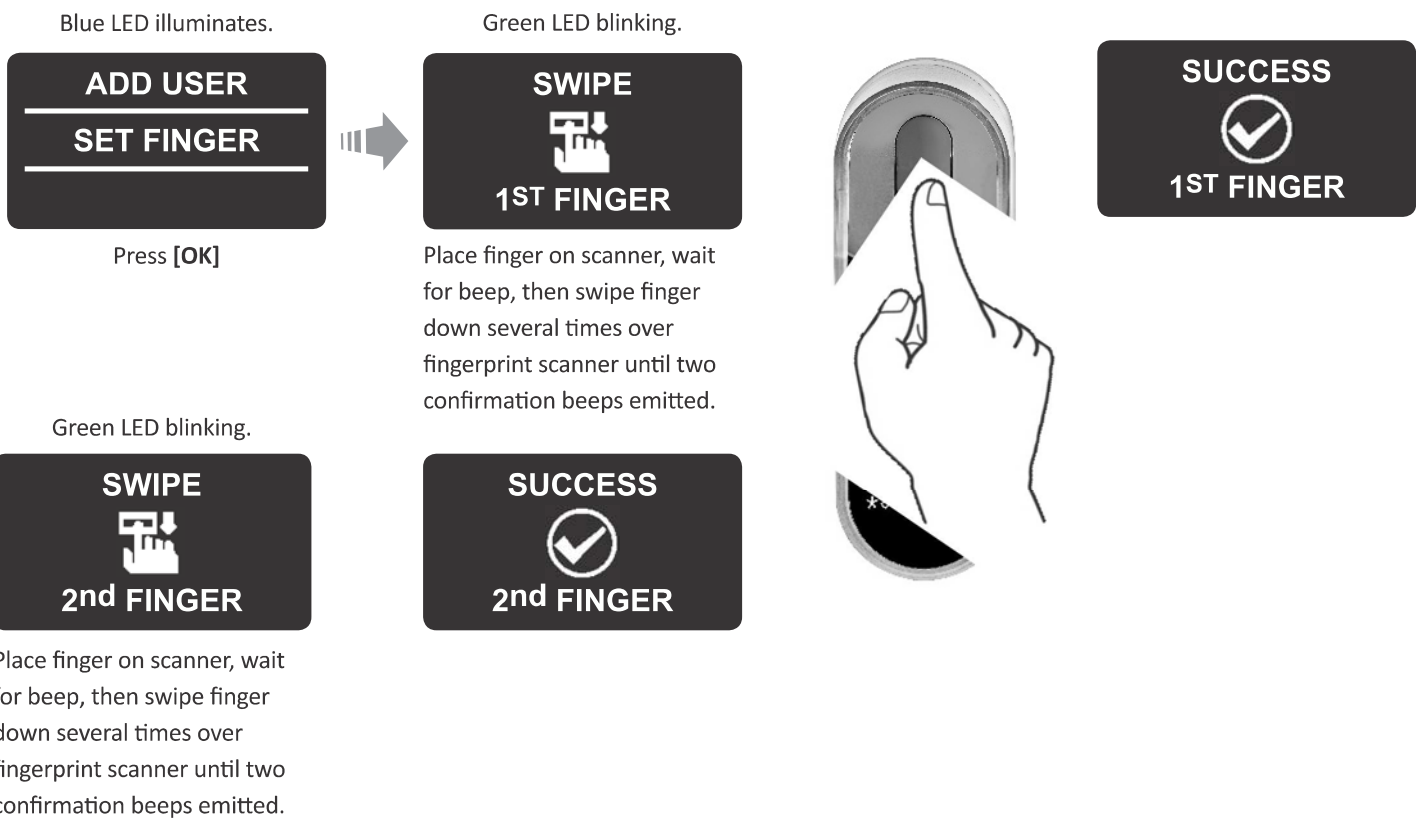

6.4.3 Set PIN Code

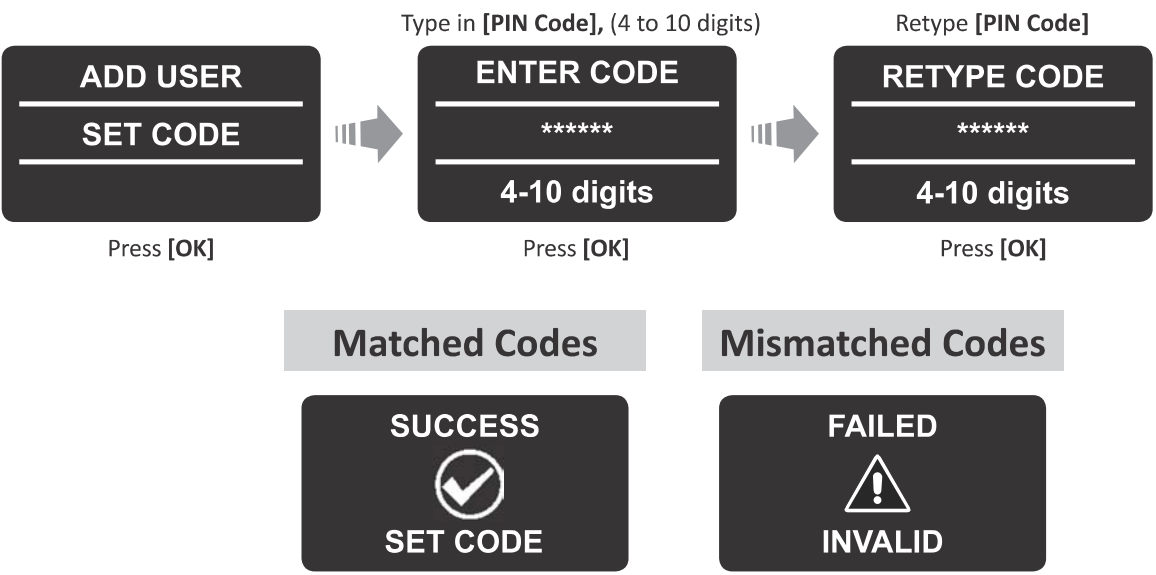

- Hang the reader on the base plate.
- Tighten fixing screw.

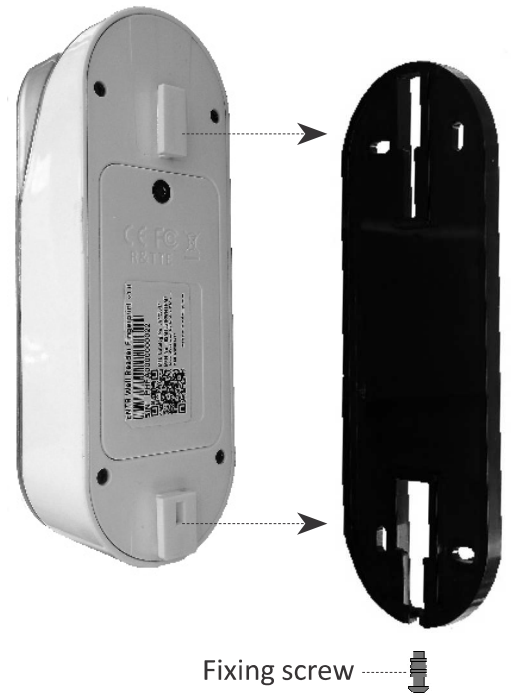

6.5 Unlock the Door

OPTION 1:

Place finger on fingerprint scanner.
 Short beep emitted & white LED is on.
 Swipe finger over fingerprint scanner
Fingerprint authorized: Blue LED blinking and unlock command is sent.
Fingerprint not authorized: Red LED is ON.
 The device goes to standby.

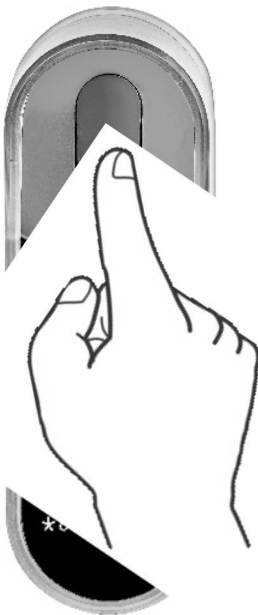

OPTION 2:

Touch the Fingerprint Touchpad.
 Screen shows user code.
 Enter your code  **[OK]**

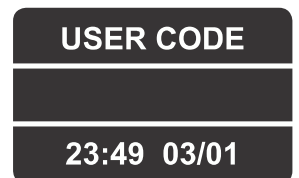

Note: In case ENTR® lock hasn't succeed to unlock the door, unlock failed message appear on the screen.



6.6 Lock the Door

Touch the Fingerprint Touchpad.
Press [1] → [#]

6.7 Low Battery Indication

Warning signal blinking.

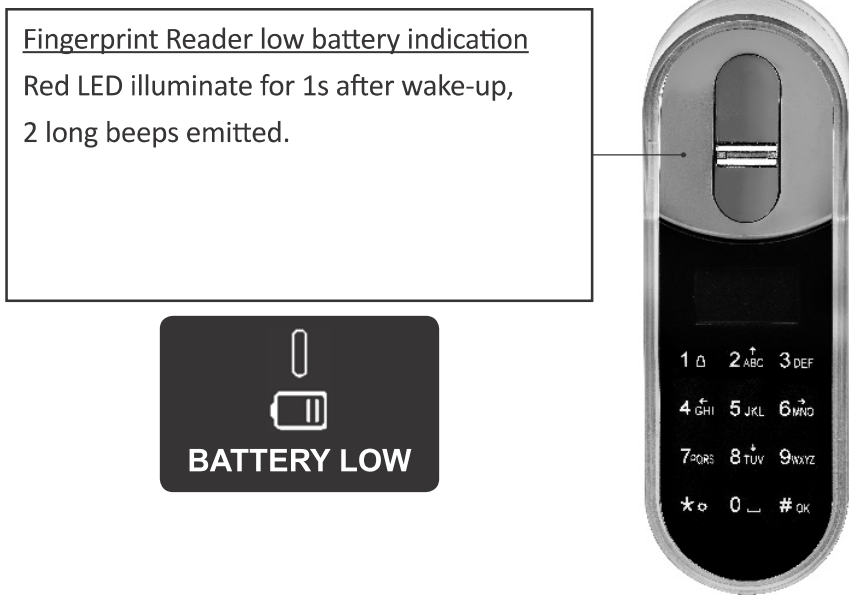

6.8 Setting Menu

